



# **SPARE PARTS CATALOGUE**

**CD-ROM 'ELCAT' 1/2004 07.05.2009**

**9 S 109**

**ZF parts list no.: 1304 051 445**

**customer: HINO MOTORS LTD.**

**Z F F R I E D R I C H S H A F E N A G**

ZF-ELCAT technical information sheet

CD 1/2004 07.05.2  
she

parts list: 1304 051 445 9 S 109 / SG\*LL\*ANGEFL\*DW-WR H-H / HINO MOTORS LTD.

item	text	mod. no.
A10	CUSTOMER:HINO	
	COUNTRY:J	
A14	CUST.SPEC.NO: CODE:	1088B
A16	33070-2112A	
A20	APPLICATION:SOUTH AFRICA	
F06	INSTAL.POSITION:HOR. LH *FLANGE MOUNTED*	
F10	RATIO: 10,24- 0,74 *SG G10,24* 6,57* 4,78* 3,53* 2,61* 1,86* G 1,35* 1,00* 0,74* R 9,44	
F26	PLANET GEAR SET:I=3,530* 4 GEAR	
F34	CONTROL:REMOTE CONTROL*HORIZONTAL RH *H-H GP:PLASTIC PIPING	
F36	POSITION DELETED	6693B
F38	SEPARAT.CLUTCH: SYNCHRONIZED	
F40	INPUT SHAFT : L=320,0*SAE 10C 1 3/4INCH JOURNAL:D=25 G7*SHAFT:D=44,00*BUSH:WITHOUT	
F46	REL.BRG.CARRIER:L= 170,0 D= 57,000 E8 SEALING CAP:WITH	
F50	OUTPUT :STANDARD BEARINGS	
F52	OUTP.FLANGE RA:OD=222 *BOLT= 4XM16X1,50X50 L=103,0*	
F62	GP HOUSING :HEXAGON SCREW	
F64	CONN.OF GEARSHIFT:	
F66	CONTROL SHAFT DIMENSION:A=248,0*	
F68	MEAS.POINT: SHIFTLIVER-LOCATION *	
F96	SET OF SPRINGS:LAYOUT Q1 *INSERTION:W074	
F98	PAWL STOP: SPRING FORCE RG= 60N	
G06	GEAR DETENT:SPRING FORCE NG+GG = 68N	
G10	BALL JOINT:HEXAGON NUT + GEARSHIFT JOINT "	
G16	SELECTION PATTERN:WII	
G26	SPEEDO-DRIVE:I= 1,545*PROTECTING CAP:WITH EXTENSION	
G30	SWITCH: RG*CLOSING *SHIFT RAIL PROTECTING CAP:WITH *	
G32	SWITCH: NG*OPENING * PROTECTING CAP:WITH *	

ZF-ELCAT technical information sheet

CD 1/2004 07.05.2  
she

parts list: 1304 051 445 9 S 109 / SG\*LL\*ANGEFL\*DW-WR H-H / HINO MOTORS LTD.

item	text	mod. no.
G36	SWITCH: GP*CLOSING *	
	PROTECTING CAP:WITH *	
G50	AUXILIARY UNITS:WITHOUT WSK *	
G60	AUXILIARY UNITS/ACCESSORIES	
G64	HEAT EXCHANGER:WITHOUT *	1088B
G66	G.BOX VENTING:BREATHER	
G74	RETARDER:WITHOUT	
G76	CLUTCH HOUSING:WITHOUT*MOUNTING:M18X1,5X 85	
	RELEASE SHAFT:BUSH LOOSE(RELEASE SHAFT)	
	SEAL:SCREW LOOSE(CLOSING COMPON.)	
H50	ELECTRONIC:	
H64	TRANSMITTER INPUT:WITHOUT	
	PROTECTING CAP:WITHOUT	
M00	DRAWING:	
M02	INSTALLATION: 1304 651 071	
M14	SECTION: 1304 051 410	
M16	SECTION: 1304 172 171	
M18	SECTION: 1304 149 012	
M50	ASSEMBLY INSTRUCTIONS:	
M58	ASSEMBLY:OIL FILL+OVERFLO *HOUSING LEFT	
M90	OIL CAPACITY: AP. 8,50L	
M92	OIL GRADE ACC.TO ZF:TE-ML02	
M94	MASS : APPRX. 170,0 KG	
M96	PAINT :DEEP-BLACK *RAL9005 ZFN915W	
M98	PRESERVATION : KA2 T/KI2/ *ZFN 916	
S02	VEHICLE DATA 1:	
S04	MODEL:TRUCK *FM2P 6X 4	
S06	MAX. G.V.M. 32*MAX. G.C.M. 50	
S08	R DYN: 508*	
S10	RA: I= 5,85	
S14	HINO /P11C *KW221/2150*N.M1080/1400	
S18	CLUTCH: DAIKIN *430	

ZF-ELCAT summary of figures

parts list: 1304 051 445 9 S 109 / SG\*LL\*ANGEFL\*DW-WR H-H / HINO MOTORS LTD.

figures list: 1304 062 105 09 S 109 SG\*LL\*ANGEFL\*DW-WR H-H / HINO MOTORS LTD.

\* depending on parts list no.

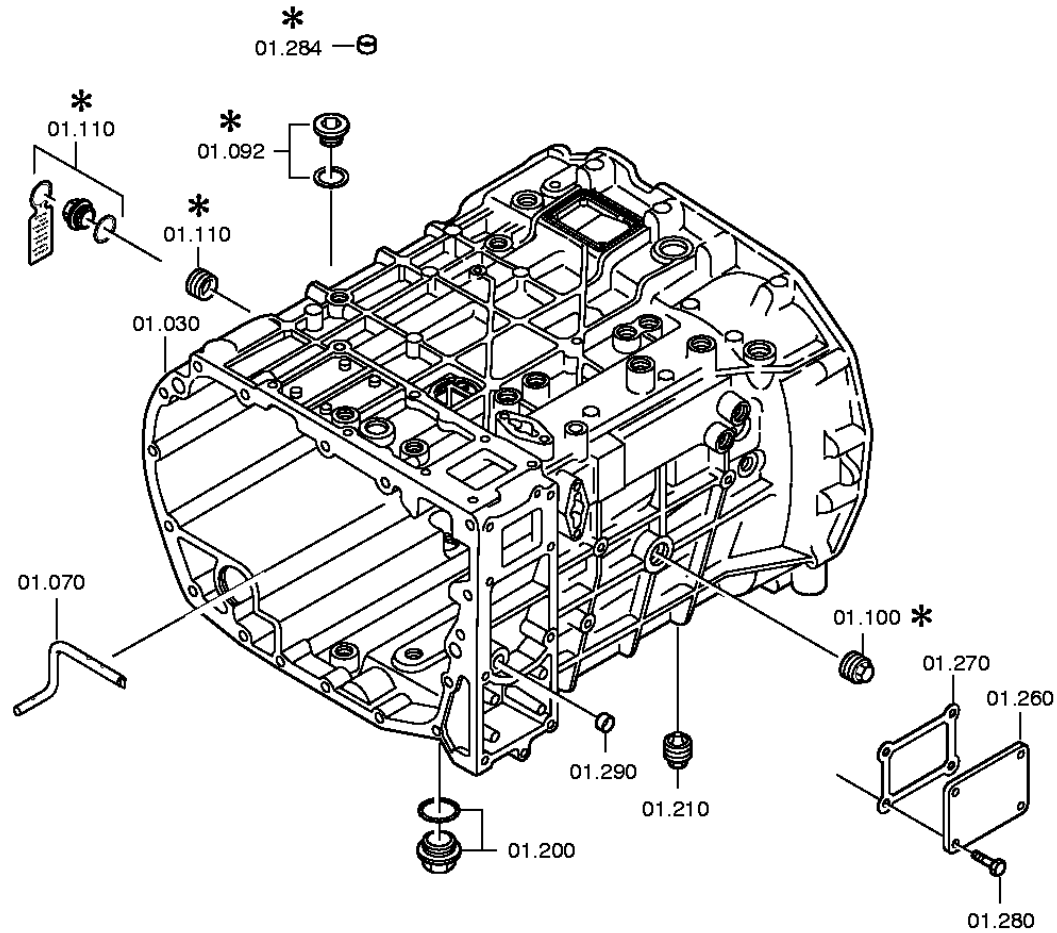

parts list: 1304 051 445 9 S 109 / SG\*LL\*ANGEFL\*DW-WR H-H / HINO MOTORS LTD.  
figure: 062.01.84 GEARBOX HOUSING

\* depending on parts list no.

