

# **YANMAR ENGINES**

## **3TNV88XMS**

## **3TNV88XMS2**

## **3TNV88XGP**

## **4TNV88XMS**

## **4TNV88XMS2**

## **4TNV88XGP**

**(P/N's 186148, 184218, 189177, 189391,  
175746, 175749)**

**Gehl 1448 / 1648 Power Box® Asphalt Pavers**

**Gehl SL3635 / 3935 / 3640 / 3840 / 4240 and**

**Mustang 2022 / 2026 / 2032 / 2041 / 2044 / 2054**

**Skid-Steer Loaders**



# **ENGINE PARTS MANUAL**

Form No.  
**917105**

Revision C  
01/07

## **Introduction**

This manual covers the Yanmar 3TNV88XMS engine (P/N 186148) used in Gehl 3635/3935 and Mustang 2022/2032 skid-steer loaders, the Yanmar 4TNV88XMS engine (P/N 184218) used in Mustang 2044/2054 skid-steer loaders, the Yanmar 3TNV88XMS2 (P/N 189177) used in Gehl 3640/3840 and Mustang 2026 skid-steer loaders, the Yanmar 4TNV88XMS2 (P/N 189391) used in Gehl 4240 and Mustang 2041 skid-steer loaders, the Yanmar 3TNV88XGP (P/N 175746) used in Gehl 1448 Power Box<sup>®</sup> Asphalt Pavers, and, the Yanmar 4TNV88XGP (P/N 175749) used in Gehl 1648 Power Box<sup>®</sup> Asphalt Pavers.

When ordering service parts, specify the correct part number, full description, quantity required, and the engine model number and serial number.

Items shown that do not have a part number are shown for reference purposes only and are not available for purchase. Part numbers may change. Your Gehl or Mustang dealer will have the latest part number.

Gehl<sup>®</sup> Company and the Mustang<sup>®</sup> Manufacturing Co., Inc., reserve the right to make changes or improvements in the design or construction of any part of the unit without incurring the obligation to install such changes on any previously delivered units.

# TABLE OF CONTENTS

## DESCRIPTION

## PAGE

### ENGINE SERVICE PARTS

Cylinder Block . . . . .	1
Gear Housing . . . . .	3
Flywheel Housing and Oil Sump . . . . .	5
Cylinder Head and Bonnet . . . . .	7
Suction Manifold . . . . .	9
Exhaust Manifold . . . . .	13
Camshaft and Driving Gear . . . . .	15
Crankshaft and Piston . . . . .	17
Lubrication Oil System. . . . .	19
Cooling Water System . . . . .	21
Fuel Injection Pump . . . . .	23
Governor . . . . .	25
Fuel Injection Valve . . . . .	27
Fuel Line . . . . .	29
Starting Motor . . . . .	31
Generator . . . . .	37
Tool and Gasket Set . . . . .	39
Numerical Index . . . . .	44

# CYLINDER BLOCK

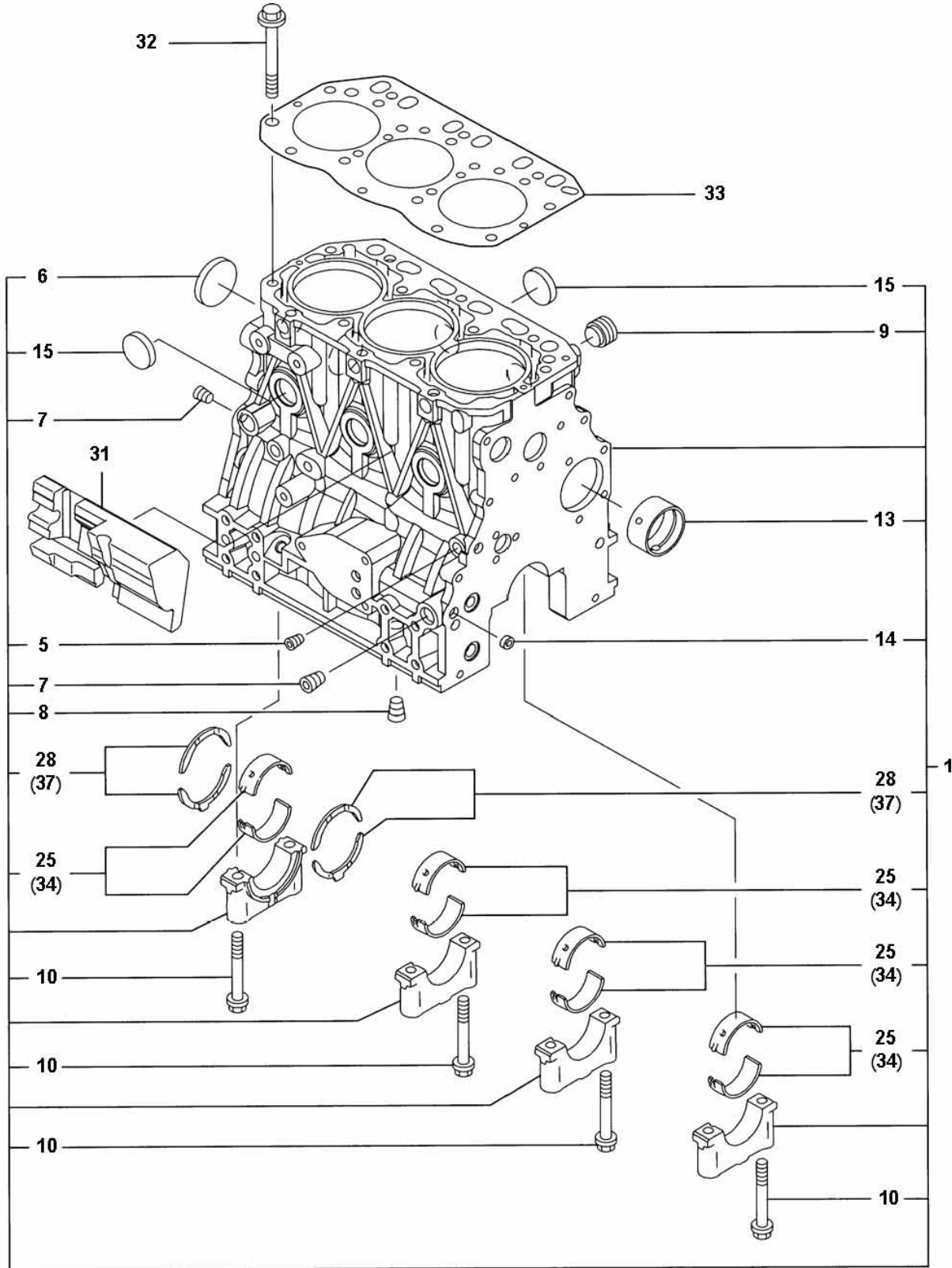

Ref. No.	Part No.	Description	Quantity 3TNV88	Quantity 4TNV88
1	188762	BLOCK ASSY/CYLINDER	1	-
	188768	BLOCK ASSY/CYLINDER	-	1
5	188516	PLUG PT 1/8	1	1
6	425-36240	PLUG 50 MM	1	1
7	425-34721	PLUG PT 1/4	2	2
8	425-34721	PLUG PT 1/4	1	1
9	425-34722	PLUG	1	1
10	425-34730	BOLT/METAL CAP	8	10
13	425-34732	BUSHING/CAMSHAFT	1	1
14	425-34724	PLUG 12 MM	2	-
	188756	PLUG 12 MM	-	2
15	188757	PLUG 30 MM	6	8
25	425-35931	MAIN BEARING SET	4	5
28	425-34731	METAL/THRUST	2	2
31	188538	SPACER	1	1
32	425-34638	STUD/CYL. HEAD	14	18
33	160753	GASKET (NON-ASB.)	1	-
	425-36006	GASKET/CYL. HEAD	-	1
34	425-34734	MAIN METAL .025	4	5
37	425-34735	METAL/THRUST .025 (SET OF TWO)	1	1