

Yanmar

4TNV84T-ZKTBL

Engine

Form No.
917324

Revision B
10/09

Gehl CTL55 and
Mustang MTL312
Compact Track
Loaders



ENGINE PARTS MANUAL

Introduction

This manual covers the Yanmar 4TNV84T-ZKTBL engine, used in Gehl CTL55 - Mustang MTL312 compact track loaders.

When ordering service parts, specify the correct part number, full description, quantity required, and the engine model number and serial number.

Items shown that do not have a part number are shown for reference purposes only and are not available for purchase. Part numbers may change. Your Gehl or Mustang dealer will have the latest part number.

Gehl® Company and the Mustang® Manufacturing Co., Inc., reserve the right to make changes or improvements in the design or construction of any part of the unit without incurring the obligation to install such changes on any previously delivered units.

IMPORTANT

For maximum engine life, when shutting the engine down, allow the engine to idle, without load, for five minutes. This will allow engine components that operate at high temperatures to cool slightly before the engine itself is shut down.

GEHL is a registered trademark of the Gehl Company.

MUSTANG is a registered trademark of the Mustang Manufacturing Co., Inc.

TABLE OF CONTENTS

DESCRIPTION	PAGE
<u>ENGINE SERVICE PARTS</u>	
Cylinder Block	1
Gear Housing	3
Flywheel Housing and Oil Sump	5
Cylinder Head and Bonnet	7
Suction Manifold and Air Cleaner	9
Exhaust Manifold and Silencer	11
Camshaft and Driving Gear	13
Crankshaft and Piston	15
Lubrication Oil System	17
Cooling Water System	19
Fuel Injection Pump	21
Governor	23
Fuel Injection Valve	25
Fuel Filter	27
Starting Motor	29
Electric Parts	31
Tool and Gasket Set	33
Turbine	35
Lubrication Oil Line	37
Generator	39
Numerical Index	42

CYLINDER BLOCK

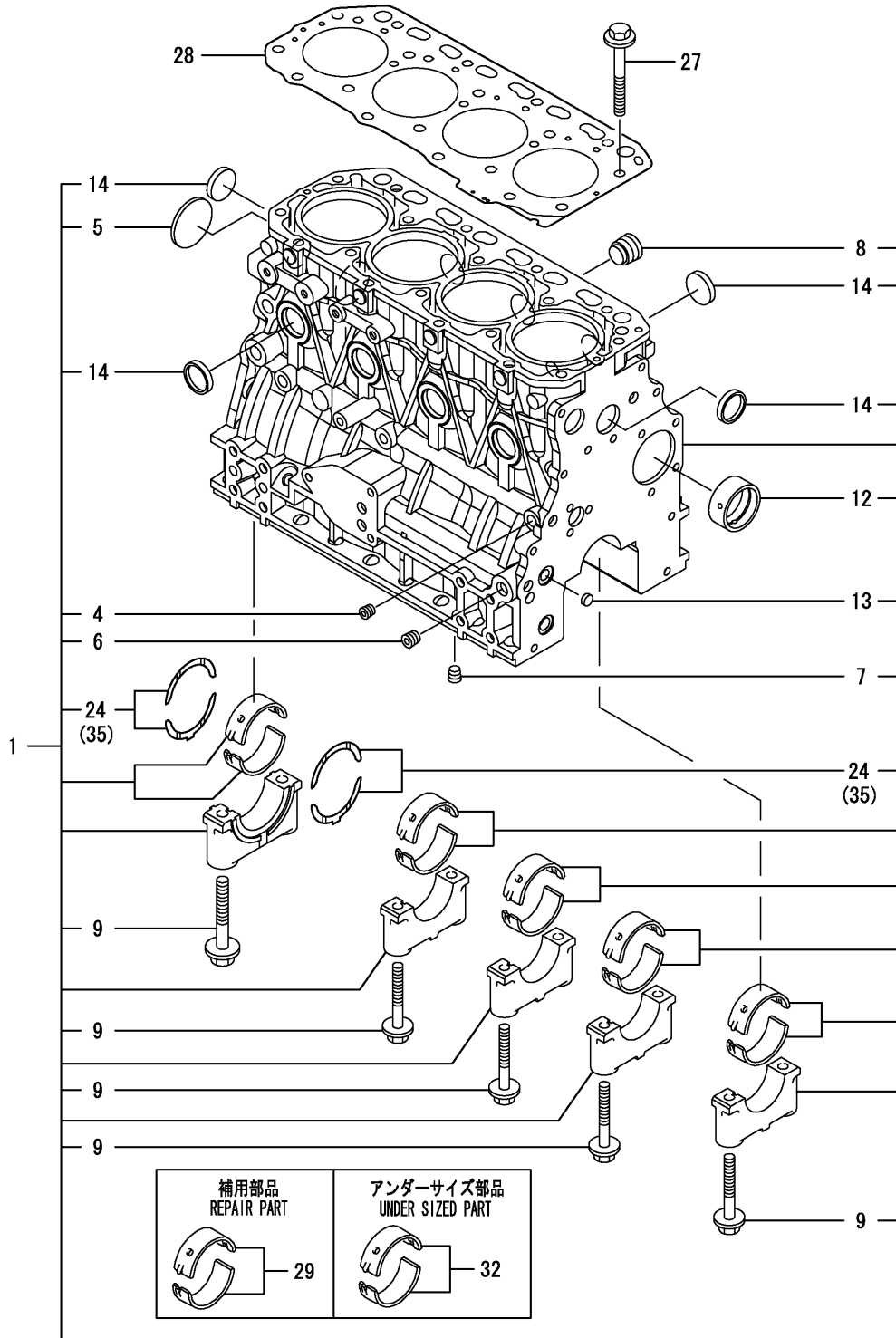

Y00D9950	1. シリンダブロック			
4TNV84T-ZKTBL	1, 08/01	2	3	PLUS

CYLINDER BLOCK

Ref. No.	Part No.	Description	Quantity 4TNV84T
1	197819	BLOCK ASSY, CYLINDER	1
4	425-34723	PLUG PT1/8	1
5	425-36240	PLUG 50	1
6	425-34721	PLUG PT1/4	2
7	425-34721	PLUG PT1/4	1
8	425-34722	PLUG	1
9	425-34730	BOLT, METAL CAP	10
12	197589	BUSH, CAMSHAFT	1
13	425-34725	PLUG 12	2
14	188757	PLUG 30	8
24	425-34731	METAL, THRUST	2
27	425-34638	STUD, CYL. HEAD	18
28	197518	GASKET, HEAD	1
29	270942	MAIN BEARING SET	5
32	270943	MAIN METAL US=0.25	5
35	270944	METAL,THRUST.25(4PIE	1