

Yanmar

3TNV88-BKMS

4TNV88-BKMS

4TNV88-BDMS

Engines

Form No.
917329

Revision A
06/08

**(P/N's 192473, 192474,
and 192494)**

Gehl 3640, 3840, 4240

**Mustang 2026, 2041, 2044
2054**

**Skid-Steer
Loaders**



ENGINE PARTS MANUAL

Introduction

This manual covers the Yanmar 3TNV88-BKMS/4TNV88-BKMS and 4TNV88-BDMS engines (P/N 192473/192474, and 192494, respectively), used in Gehl 3640/3840/4240 and Mustang 2026/2041; and Mustang 2044/2054 skid-steer loaders, respectively.

When ordering service parts, specify the correct part number, full description, quantity required, and the engine model number and serial number.

Items shown that do not have a part number are shown for reference purposes only and are not available for purchase. Part numbers may change. Your Gehl or Mustang dealer will have the latest part number.

Gehl® Company and the Mustang® Manufacturing Co., Inc., reserve the right to make changes or improvements in the design or construction of any part of the unit without incurring the obligation to install such changes on any previously delivered units.

IMPORTANT

For maximum engine life, when shutting the engine down, allow the engine to idle, without load, for five minutes. This will allow engine components that operate at high temperatures to cool slightly before the engine itself is shut down.

GEHL is a registered trademark of the Gehl Company.

MUSTANG is a registered trademark of the Mustang Manufacturing Co., Inc.

TABLE OF CONTENTS

DESCRIPTION	PAGE
<u>ENGINE SERVICE PARTS</u>	
Cylinder Block	1
Gear Housing	3
Flywheel Housing and Oil Sump	5
Cylinder Head and Bonnet	7
Suction Manifold	11
Exhaust Manifold	13
Camshaft and Driving Gear	15
Crankshaft and Piston	17
Lubrication Oil System	19
Cooling Water System	21
Fuel Injection Pump	23
Governor	25
Fuel Injection Valve	27
Fuel Line	29
Starting Motor	31
Generator	33
Tool and Gasket Set	35
Numerical Index	38

CYLINDER BLOCK

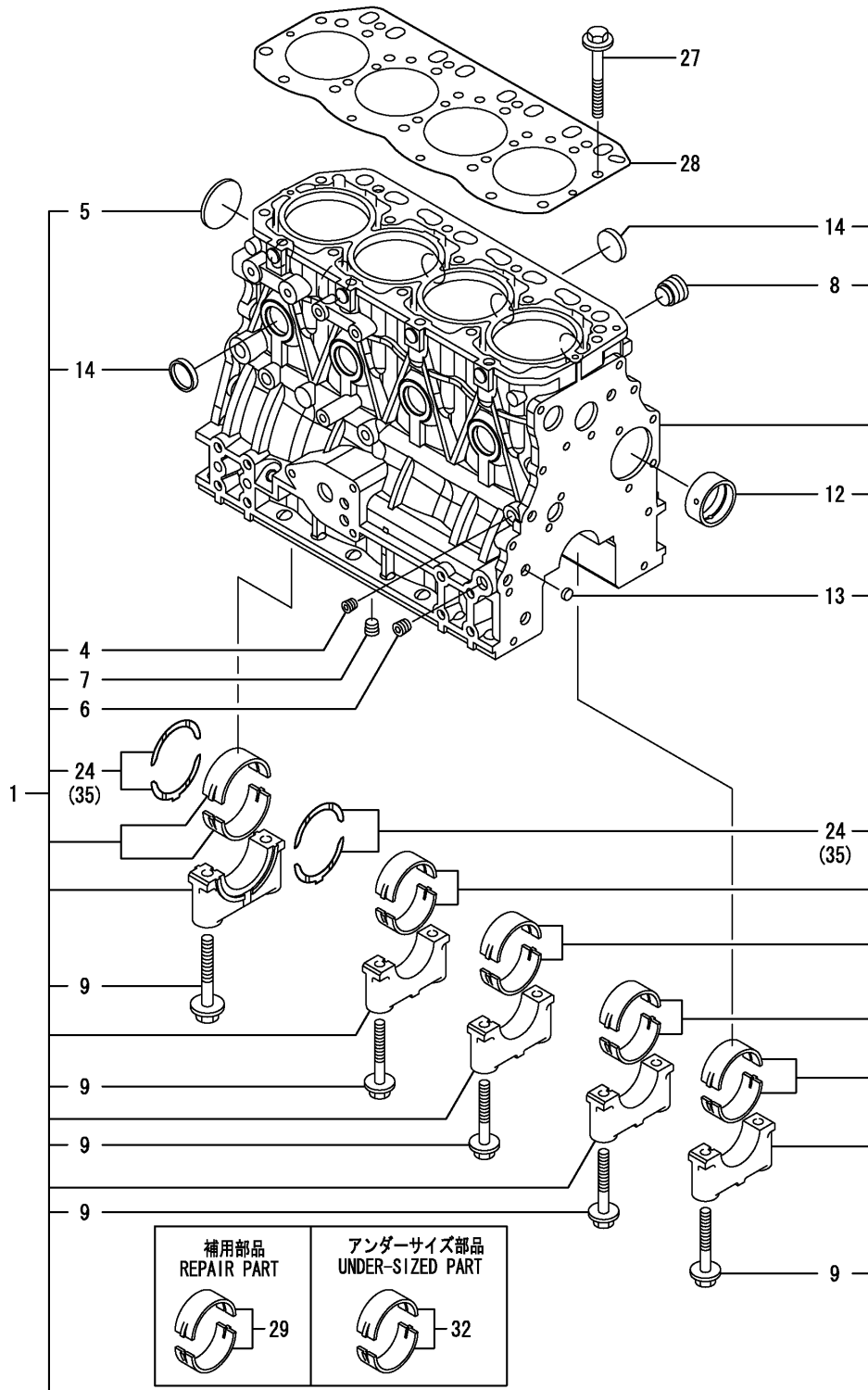

Y00W3330	1. CYLINDER BLOCK			
4TNV88-BKMS	1.08.03	2	3	PLUS