

# Yanmar

## 3TNV82A-BPMS

### Engine

Form No.  
917382

Revision A  
12/08

---

**(PN 195492)**  
**Gehl 1640E and**  
**Mustang 2012**  
**Skid-Steer Loaders**



**ENGINE PARTS MANUAL**

## **Introduction**

This manual covers the Yanmar3TNV82A-BPMS engine, used in Gehl1640E - Mustang 2012 skid-steer loaders.

When ordering service parts, specify the correct part number, full description, quantity required, and the engine model number and serial number.

Items shown that do not have a part number are shown for reference purposes only and are not available for purchase. Part numbers may change. Your Gehl or Mustang dealer will have the latest part number.

Gehl® Company and the Mustang® Manufacturing Co., Inc., reserve the right to make changes or improvements in the design or construction of any part of the unit without incurring the obligation to install such changes on any previously delivered units.

---

## **IMPORTANT**

**For maximum engine life, when shutting the engine down, allow the engine to idle, without load, for five minutes. This will allow engine components that operate at high temperatures to cool slightly before the engine itself is shut down.**

---

**GEHL is a registered trademark of the Gehl Company.**

**MUSTANG is a registered trademark of the Mustang Manufacturing Co., Inc.**

# TABLE OF CONTENTS

DESCRIPTION	PAGE
<b><u>ENGINE SERVICE PARTS</u></b>	
Cylinder Block . . . . .	1
Gear Housing . . . . .	3
Flywheel Housing and Oil Sump . . . . .	5
Cylinder Head and Bonnet . . . . .	7
Suction Manifold and Air Cleaner . . . . .	9
Exhaust Manifold and Silencer . . . . .	11
Camshaft and Driving Gear . . . . .	13
Crankshaft and Piston. . . . .	15
Lubrication Oil System . . . . .	17
Cooling Water System . . . . .	19
Fuel Injection Pump . . . . .	21
Governor. . . . .	23
Fuel Injection Valve . . . . .	25
Fuel Filter . . . . .	27
Starting Motor . . . . .	29
Tool and Gasket Set . . . . .	31
Generator . . . . .	33
Numerical Index . . . . .	36

# CYLINDER BLOCK

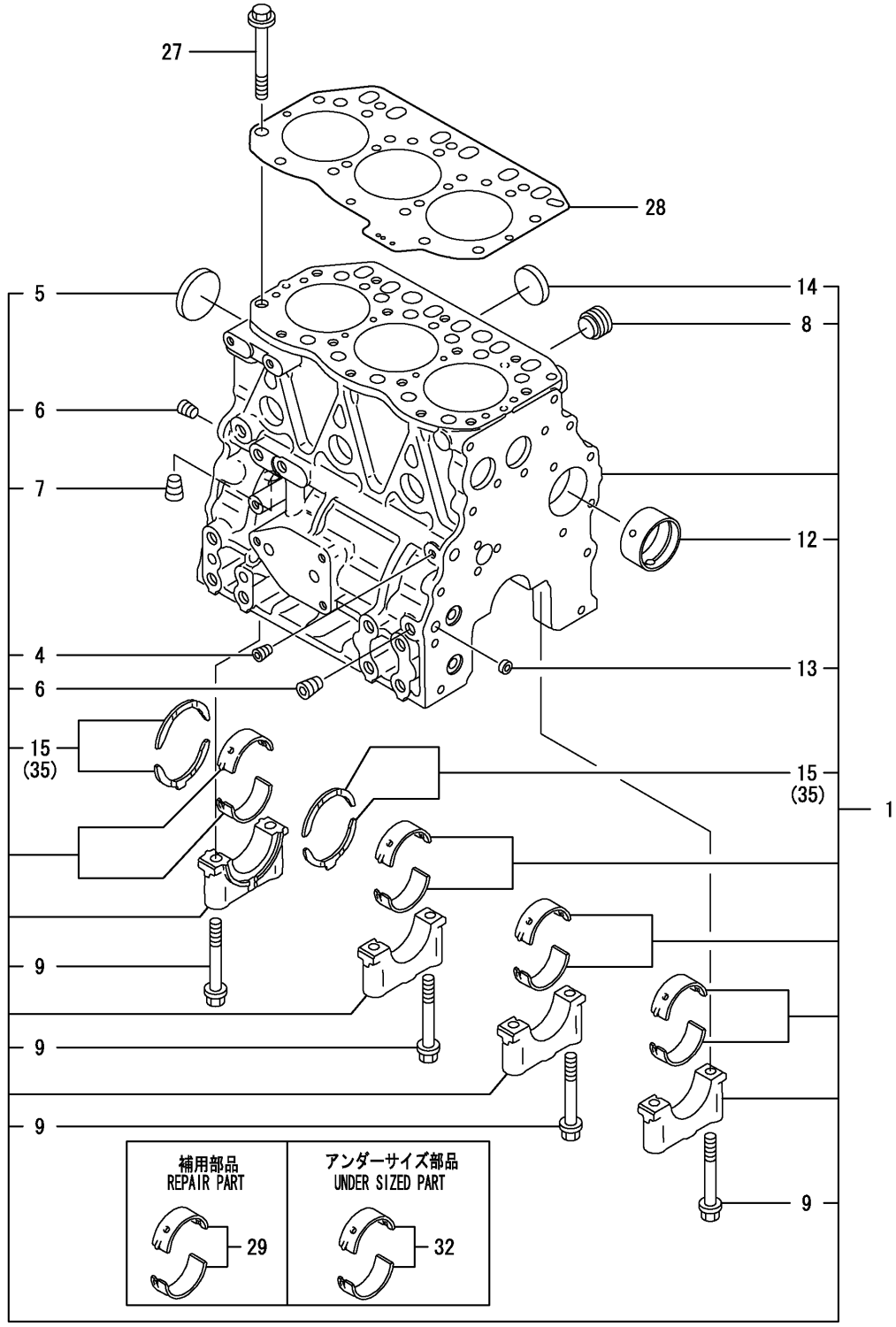

Y00W4660	1, CYLINDER BLOCK			
3TNV82A-BPMS	1, 08/10	2	3	PLUS