



**徐工集团**

# LW300F

轮式装载机

## 零件手册

### WHEEL LOADER PARTS MANUAL

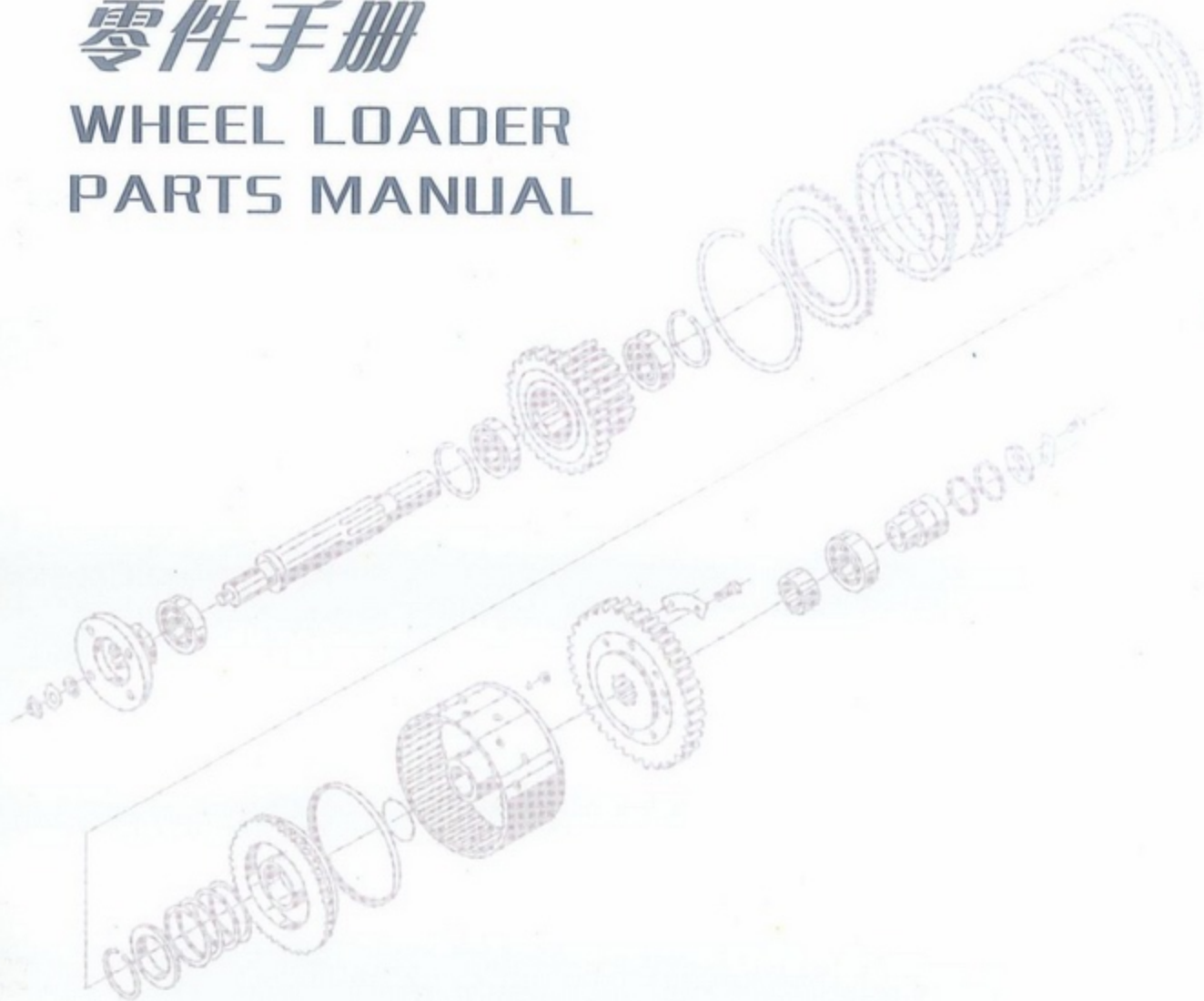

**徐工集团工程机械股份有限公司**  
**XCMG CONSTRUCTION MACHINERY CO., LTD.**

## 前 言

本零件手册仅供选购我公司 LW300F 型轮式装载机零部件时参考。

本零件手册主要介绍了 LW300F 型轮式装载机零部件及各部分的结构和装配关系,供广大用户、销售、及技术人员了解选购、维修和保养时使用。

在本手册零件中,凡是不可拆卸的部件(焊接件、铆接件)一般只标出部件代号,不再另列其组成零件的代号。

订购零部件时,为避免订购和我公司发货失误,请务必注明以下各项详细资料:

轮式装载机的出厂日期和编号

所订购的零部件的代号和名称

所需数量

如果你需要邮购,需详细注明邮往地点、单位和邮政编码。

LW300F 型轮式装载机将根据技术发展和用户的要求不断改进,因此本零件手册也将定期补充修订;如有更改,恕不另行通知。



## FOREWORD

This manual can provide you reference when you purchasing the XCMG LW300F Wheel Loader

This manual mainly introduces the parts, component structures and assemblies of every system of the loader, which can help users, sellers and technicians purchase and service the loader.

In this manual, those parts (including welded parts or riveted parts) which can't be dismantled furthermore have been numbered, so no separate number is given to their composite parts.

When you need to purchase some parts from us, please inform us of the following information clearly to ensure we can deliver you the right staffs you just need.

ex-work date and serial number of the Wheel Loader.

Part No. and Part Description of the parts that you need.

quantity of the parts that you wish to buy.

Please advise us of your mailing address, company name and post code if you wish us to send parts to you by mail.

The LW300F Wheel Loader will be updated technically, so we reserve the right to make changes to this manual at any time without giving prior notice.

## 目 录

### 1.动力传动系统

#### Engine and Transmission system

1.1 LW330F(II).1 发动机系统 Engine System	P01-01
1.2 330E.1.1 柴油箱总成 Fuel Tan	P01-05
1.3 300F 驱动桥系统 Driving System	P01-07
1.4 300F 轮辋体总成 Rim	P01-09
1.5 XRC1132D025/026 桥总成 Axle	P01-11
1.6 82350200 主减速器总成 Main reduction	P01-13
1.7 82214207 差速器总成 Differential	P01-15
1.8 83240200 轮边减速器总成 Planetary Reduction	P01-17
1.9 72006035 制动器总成 Brake	P01-19
1.10 300F 变速箱变矩器总成 Gear-Box and Torque Converter	P01-21
1.11 YJ315X 变矩器总成 Torque Converter	P01-25
1.12 300F 滤清器 Oil Filler	P01-31
1.13 300F 变速泵 Pump	P01-33
1.14 YJ315X 减压阀总成 Pressure Reducing Valve	P01-35
1.15 300F 传动轴总成 Drive Shaft Assy	P01-37
1.16 300F 主传动轴 Main Transmission Shaft	P01-39
1.17 300F 主传动轴 Main transmission Shaft	P01-41
1.18 300F 前传动轴 Front Transmission Shaft	P01-43
1.19 300F 前传动轴 Rear Transmission Shaft	P01-45
1.20 300F 前传动轴 Rear Transmission Shaft	P01-47
1.21 300F 后传动轴 Rear Transmission Shaft	P01-49
1.22 300F 后传动轴 Rear Transmission Shaft	P01-51
1.23 300F 后传动轴 Rear Transmission Shaft	P01-53
1.24 Z3.6 BS428 变速箱箱体部件 Gearbox Body	P01-55
1.25 Z3.6.1 变速箱输入轴总成 Input Shaft	P01-61
1.26 Z3.6.2 变速箱倒档轴总成 Reverse Shaft	P01-63
1.27 Z3.6.3 变速箱中间轴总成 Middle Shaft	P01-65
1.28 Z3.6.4 变速箱输出轴总成 Output Shaft	P01-67
1.29 Z3.6.4.1 变速箱手制动总成 Parking Brake	P01-69
1.30 Z3.6.6 变速箱操纵阀总成 Transmission Control Valve	P01-71
1.31 Z3.6.9 变速箱高低档拨叉机构 Yoke	P01-73
1.32 Z3.7 高低速操纵 Shift Control	P01-75

### 2.车架与附件

#### Chassis and Accessories

2.1 300F.05 前车架 Front Chassis	P02-01
2.2 300F.06 后车架 Rear Chassis	P02-03
2.3 300F.04 台架系统 251700411 Platform System	P02-07
2.4 LW321F(II).18 机罩 Engine Hood	P02-09

### 3.工作装置

#### Working Device

3.1 300F.08 工作连杆系统 Link System	P03-01
--------------------------------	--------

3.2	300F.08II 工作连杆系统(高卸) Link System(High Dumping)	P03-03
3.3	300F.30 铲斗总成 Bucket	P03-05
3.4	LW330F(C).11.3II 铲斗总成 Bucket	P03-07
3.5	夹钳管路 Clamp Pipeline	P03-09
3.6	夹钳体总成 Clamp Assembly	P03-11
3.7	滑叉工作装置 Fork Working Device	P03-13
3.8	抓草机 Clamp	P03-15
3.9	侧卸装置 Side-discharging Device	P03-17

#### 4.操纵与驾驶室 Controls and Cab

4.1	300F.02 变速操纵系统 Shift Control System	P04-01
4.2	300F.10 驾驶室总成 Cab	P04-03
4.3	300F.10.2A 地板总成 Floor	P04-05
4.4	XGZY01-II 座椅总成 Seat Assembly	P04-07
4.5	300F 二联操纵杆系 Control Shank System	P04-09
4.6	300F 三联操纵杆系 Control Shank System	P04-11
4.7	300F.14 空调系统 Air Conditioner	P04-13
4.8	Z3G.22.3 空调压缩机支架 Compressor Bracke	P04-17
4.9	CDZ40K-010 蒸发器总成 Evaporator	P04-19
4.10	CDZ40K-017 冷凝器 Condense	P04-21
4.11	LW326F.21 暖风系统 Heating System	P04-23
4.12	300F 仪表总成 Instrument Box	P04-25
4.13	300F 方向机总成 Steering Machine	P04-27

#### 5.制动系统 Brake System

5.1	300F 制动系统 Brake System	P05-01
5.2	300F 储气缸 Air Tank	P05-05
5.3	300F 加力泵总成 Boosting Pump	P05-07
5.4	300F 气制动阀 Brake Valve	P05-09

#### 6.液压系统 Hydraulic System

6.1	工作液压系统 Working Hydraulic System	P06-01
6.2	转向液压系统 Steering Hydraulic System	P06-05
6.3	液压油箱 Hydraulic Oil Tank	P06-09
6.4	转斗油缸 Tilt Cylinder	P06-11
6.5	左右动臂油缸 Left Right Boom Cylinder	P06-13
6.6	左右转向油缸 Lest And Right Steering Cylinder	P06-15
6.7	DF25B2(30G)分配阀总成 Distributing Valve	P06-17
6.8	夹钳三联液压系统(一)Clamp Hydraulic System	P06-21
6.9	夹钳三联液压系统(二)Clamp Hydraulic System	P06-23
6.10	侧卸三联液压系统 Side Dump Hydraulic System	P06-25

#### 7.电气系统 Electrical System

7.1	电气系统 LW300F Electrical System	P07-01
-----	-------------------------------	--------

# 1.动力与传动系统 Engine and Transmission System

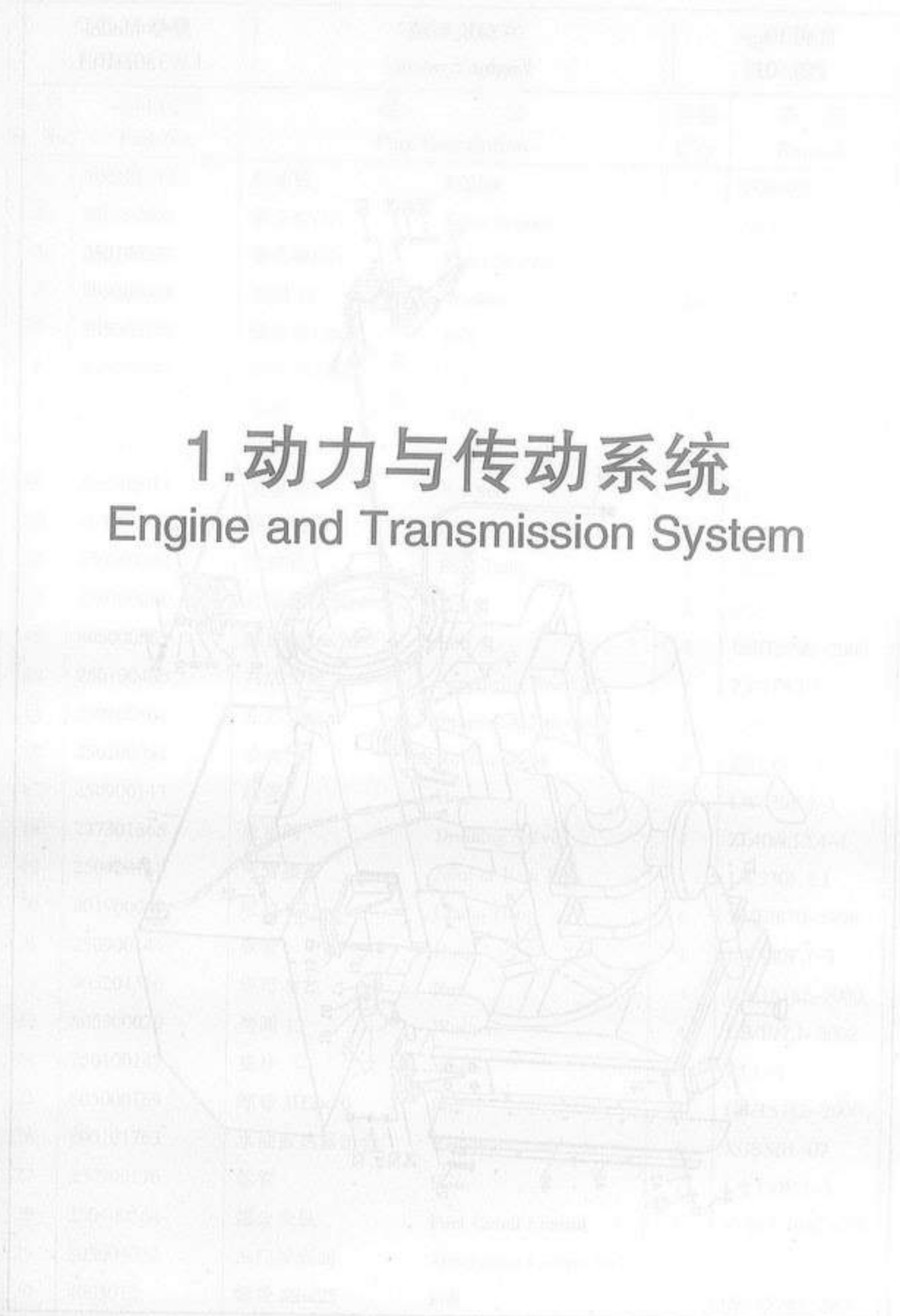



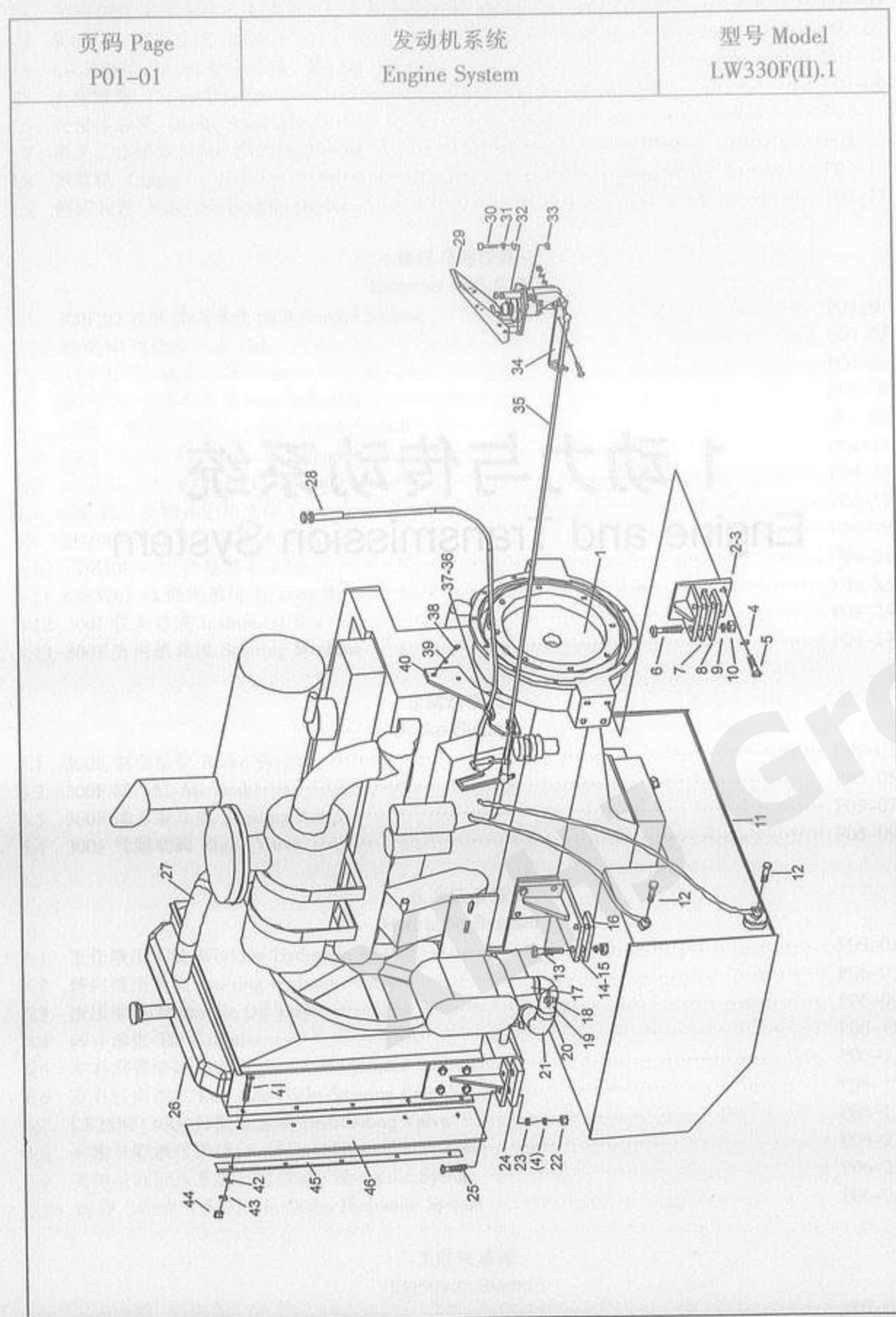

型号 Model LW330F(II).1		发动机系统 Engine System		页码 Page P01-02	
序号 Sr, No.	零件代号 Part No.	名称 Part Description		数量 Q'ty	备注 Remark
1	800101377	柴油机	Engine	1	YC6108G
2	250100463	前支架(右)	Front Support	1	Z3(YC).1.7
3	250100572	前支架(左)	Front Support	1	Z3(YC).1.8
4	805300018	垫圈 12	Washer	20	GB/T93-1987
5	805000716	螺栓 M12×30	Bolt	16	GB/T5783-2000
6	805000411	螺栓 M16×80	Bolt	4	GB/T5782-2000
7	250100459	垫板	Plate	2	Z3(YC).1-3
8	250100352	垫块	Rubber Block	2	Z3(LT).1-2
9	805300011	垫圈 16	Washer	8	GB/T93-1987
10	805200051	螺母 M16	Nut	8	GB/T6170-2000
11	250500362	燃油箱	Fuel Tank	1	330E.1.1
12	250100281	过油螺栓 M14×1.5	Bolt	2	Z3(LT).1-6A
13	805000503	螺栓 M16×70	Bolt	4	GB/T5783-2000
14	250100460	右后支架	Supporting Bracket	1	Z3(YC).1.1
15	250100461	左后支架	Supporting Bracket	1	Z3(LT).1.2
16	250100351	垫块	Rubber Block	2	Z3(LT).1-3
17	250900143	软管	Hose	1	LW330F.1-1
18	227301565	放水阀	Draining Valve	1	ZL40A.12.4-1
19	250900168	弯管接头	Joint of Bent Pipe	1	LW330F.1.1
20	801900068	喉箍 d70	Clamp Hoop	6	JB/T8870-1999
21	250900144	软管	Hose	1	LW330F.1-2
22	805201516	螺母 M12	Nut	4	GB/T6182-2000
23	805300020	垫圈 12	Washer	4	GB/T97.1-2002
24	250100147	垫片	Washer	2	Z3.1-4
25	805000169	螺栓 M12×70	Bolt	4	GB/T5782-2000
26	800101763	水油散热器组合	Radiator	1	XGSX01-07
27	250900176	软管	Hose	1	LW330F.1-3
28	250900564	熄火操纵	Fuel Cutoff Control	1	吉普车用喝风线
29	803004052	油门操纵阀	Accelerator Control Valve	1	XZ1129001
30	4003012	螺栓 M6×25	Bolt	5	GB/T5781-2000

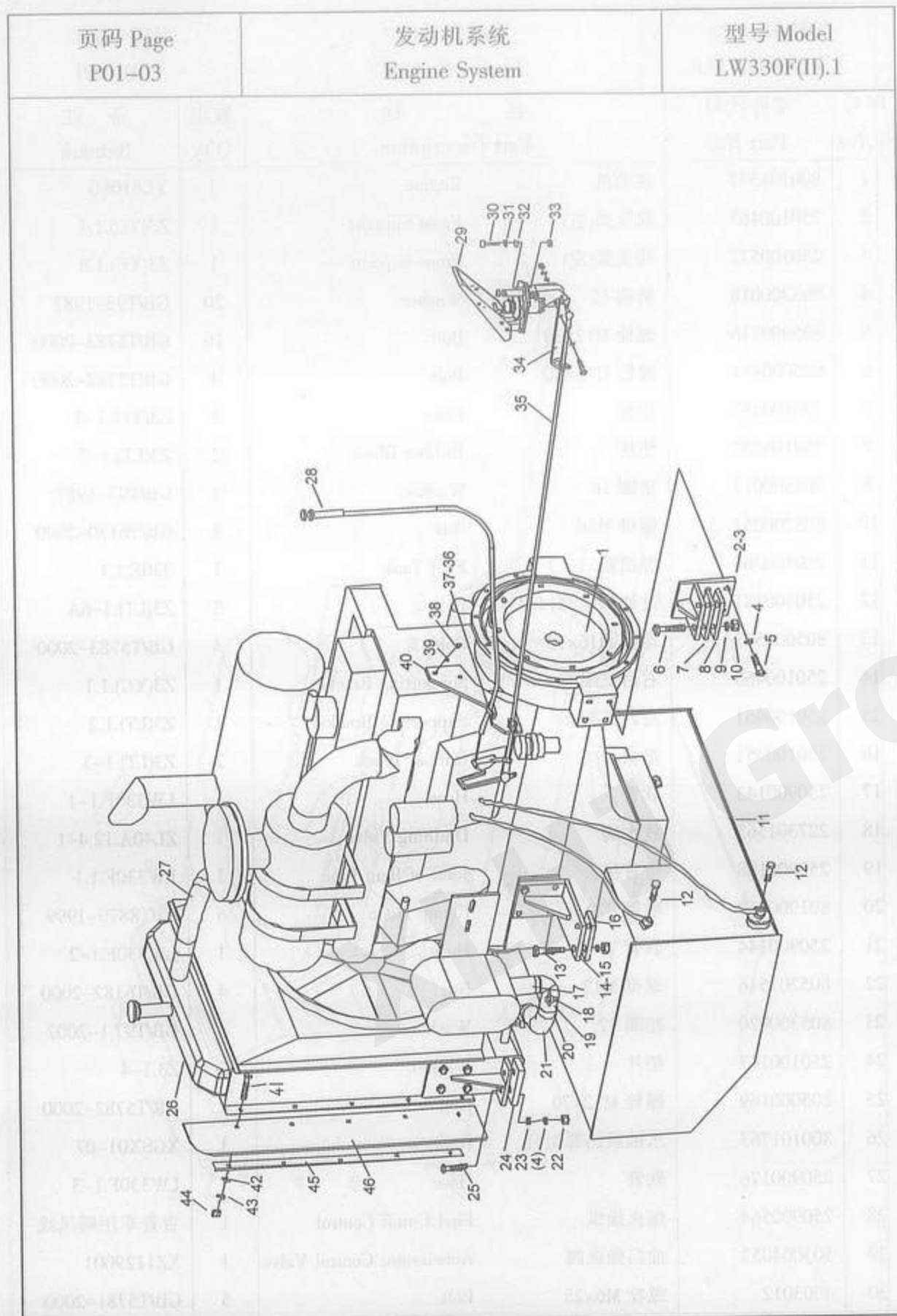

型号 Model LW330F(II).1		发动机系统 Engine System		页码 Page P01-04	
序号 Sr.No.	零件代号 Part No.	名称 Part Description	数量 Q'ty	备注 Remark	
31	805300030	垫圈 6 Washer	6	GB/T93-1987	
32	805300029	垫圈 6 Washer	8	GB/T97.1-2002	
33	805200053	螺母 M6 Nut	3	GB/T6170-2000	
34	252100843	软轴支架 Supporting Bracket	1	Z5G.1.1.7A-1	
35	250900171	操纵软轴 Operating Cable	1	LW330F.1.4	
36	805000008	螺栓 M6×12 Bolt	1	GB/T5783-2000	
37	251900372	弯板 Bent Plate	1	Z3G.1.7-2	
38	805000018	螺栓 M8×20 Bolt	2	GB/T5783-2000	
39	805300010	垫圈 8 Washer	2	GB/T93-1987	
40	250900381	支架 Supporting Bracket	1	LW321F(SS).01-2	
41	805000017	螺栓 M8×25 Bolt	8	GB/T5783-2000	
42	805300069	垫圈 8 Washer	8	GB/T97.1-2002	
43	805300014	垫圈 8 Washer	10	GB/T93-1987	
44	805200045	螺母 M8 Nut	8	GB/T6170-2000	
45	250900245	压板 Pressing Plank	2	LW330F(II).1-1	
46	250900246	胶皮 Rubber Plate	2	LW330F(II).1-2	



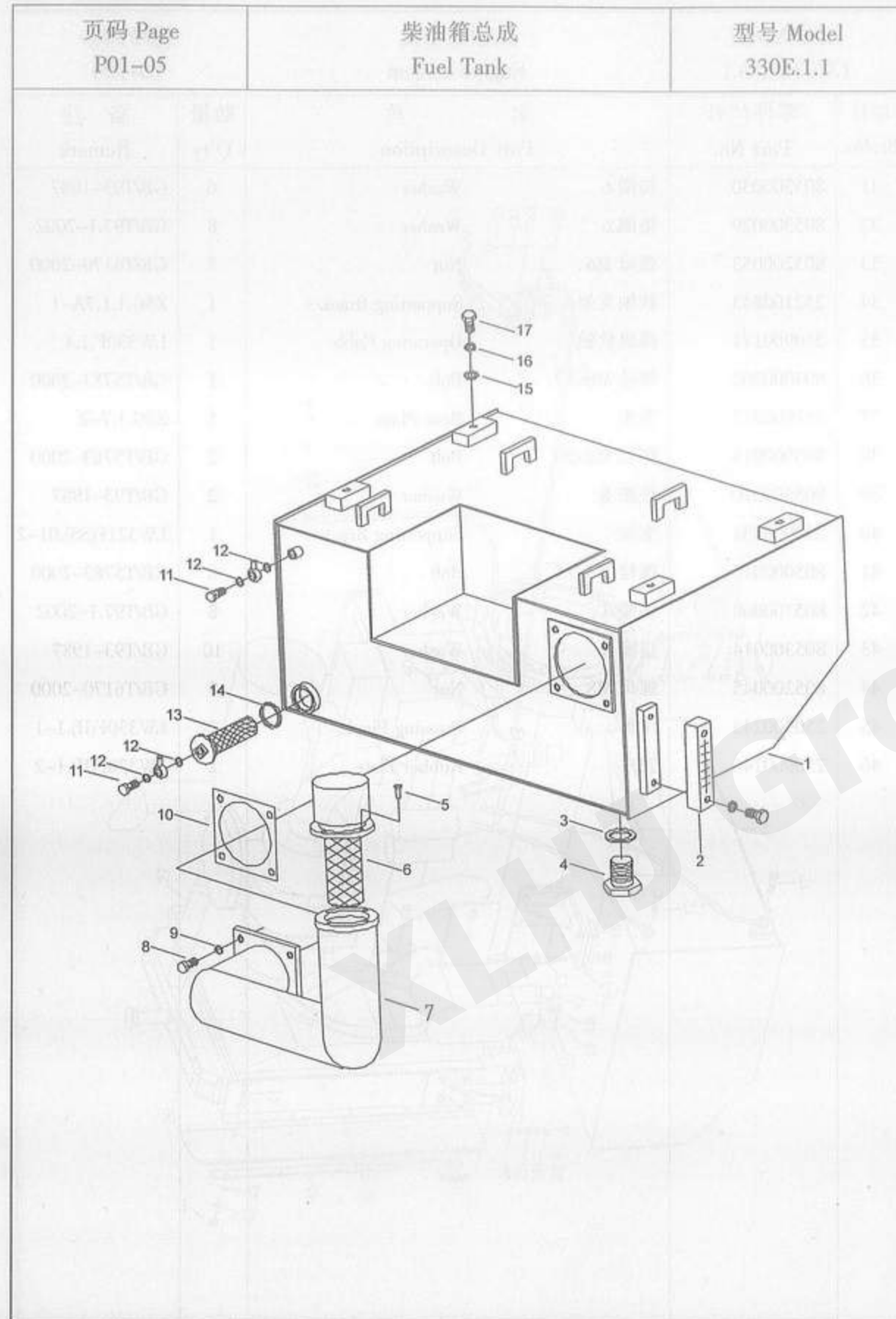

型号 Model 330E.1.1		柴油箱总成 Fuel Tank	页码 Page P01-06	
序号 Sr, No.	零件代号 Part No.	名称 Part Description	数量 Q'ty	备注 Remark
1	250500264	箱体 Tank Body	1	330E.1.1.1
2	803164214	液位计 Level Gauge	1	YWZ-127
3	801100042	O型密封圈 45×3.5 O-Ring	1	GB1235-76
4	250200221	螺塞 Screw Plug	1	ZL40.1.3-7
5	805000033	螺栓 M8×16 Bolt	4	GB/T5783-2000
6	803164217	加油滤清器 Oil Filter	1	XGKL2-10X0.63
7	250100734	加油口 Oil Injecting Hole	1	Z3.1A.1.1A
8	805000018	螺栓 M8×20 Bolt	4	GB/T5783-2000
9	805300010	垫圈 8 Washer	4	GB/T93-1987
10	250100453	密封垫 Seal Washer	1	Z3.1A.1-1
11	250100281	过油螺栓 M14×1.5 Bolt	4	Z3(LT).1-6A
12	805300024	垫圈 14 Washer	4	JB/T982-1977
13	250200471	滤油器总成 Oil Filter	1	XGXL5-10×100
14	803164100	垫圈 45 Washer	1	JB982-1977
15	805300013	垫圈 16 Washer	4	GB/T97.1-2002
16	805300011	垫圈 16 Washer	4	GB/T93-1987
17	805000013	螺栓 M16×35 Bolt	4	GB/T5783-2000

页码 Page P01-07	驱动桥系统 Axle System	型号 Model 300F

型号 Model 300F		驱动桥系统 Axle System	页码 Page P01-08	
序号 Sr.No.	零件代号 Part No.	名称 Part Description	数量 Q'ty	备注 Remark
1	800302227	前驱动桥 Front Axle	1	101419
	800302227	前驱动桥 Front Axle	1	100266
	800302227	前驱动桥 Front Axle	1	6030
2	800302769	轮胎 17.5-25 Tyre	4	GB2980-1991
	250100512	轮辋体总成 Rim	4	
4	800302228	后驱动桥 Rear Axle	1	101419
	800302228	后驱动桥 Rear Axle	1	100266
	800302228	后驱动桥 Rear Axle	1	6030
5	805000671	螺栓 M24×2×220 Bolt	8	GB/T5785-2000
6	805300034	垫圈 24 Washer	16	GB/T93-1987
7	805201458	螺母 M24 Nut	16	GB/T6176-2000
8	805002107	螺栓 M24×2×240 Bolt	8	GB/T5785-2000





页码 Page P01-09	轮辋体总成 Rim	型号 Model 300F



型号 Model 300F		轮辋体总成 Rim	页码 Page P01-10	
序号 Sr.No.	零件代号 Part No.	名称 Part Description	数量 Q'ty	备注 Remark
1	250100511	轮辋体 Rim Body	1	
2	800302767	锁圈 Lock Ring	1	
3	800302766	外轮缘 Outer Rim	1	