

PARTS CATALOG

R-2237

TRIPLEX UPRIGHTS, CASCADE HIGH FREE LIFT QUAD UPRIGHTS, CASCADE FOR WHITE FORK LIFT TRUCKS 2000 - 8000 LB CAPACITY

REPVIEW SLIDE STYLE, M2 CONTENTS

Upright for High Free Lift.....Page A-3,A-5

Lift cylinder with threaded head.....Page A-7

Lift Cylinder Shell welded to Base.....Page A-9

Crosshead for Uprights.....Page A-11,A-12

Carriage and rollers for Uprights.....Page A-13,A-14

Lift Car's Chart for prights.....Page A-15

Carriage Cars for prights.....Page A-16

Upright Mounting at.....Page A-17

TRIPLEX VIEW SLIDE STYLE, M2, 55C A M80 CONTENT

Outer Uprights for 50C, 55C & 80T.....Page B-5-B-7

Inner Uprights for 50C, 55C & 80T.....Page B-5-B-7

Inner Uprights for 50C, 55C & 80T.....Page B-8 - 10

Drawings of accessories.....Page B-13

GET STALL CAR

3 R - 2 7 2

TC TITLE CAR SERVICE

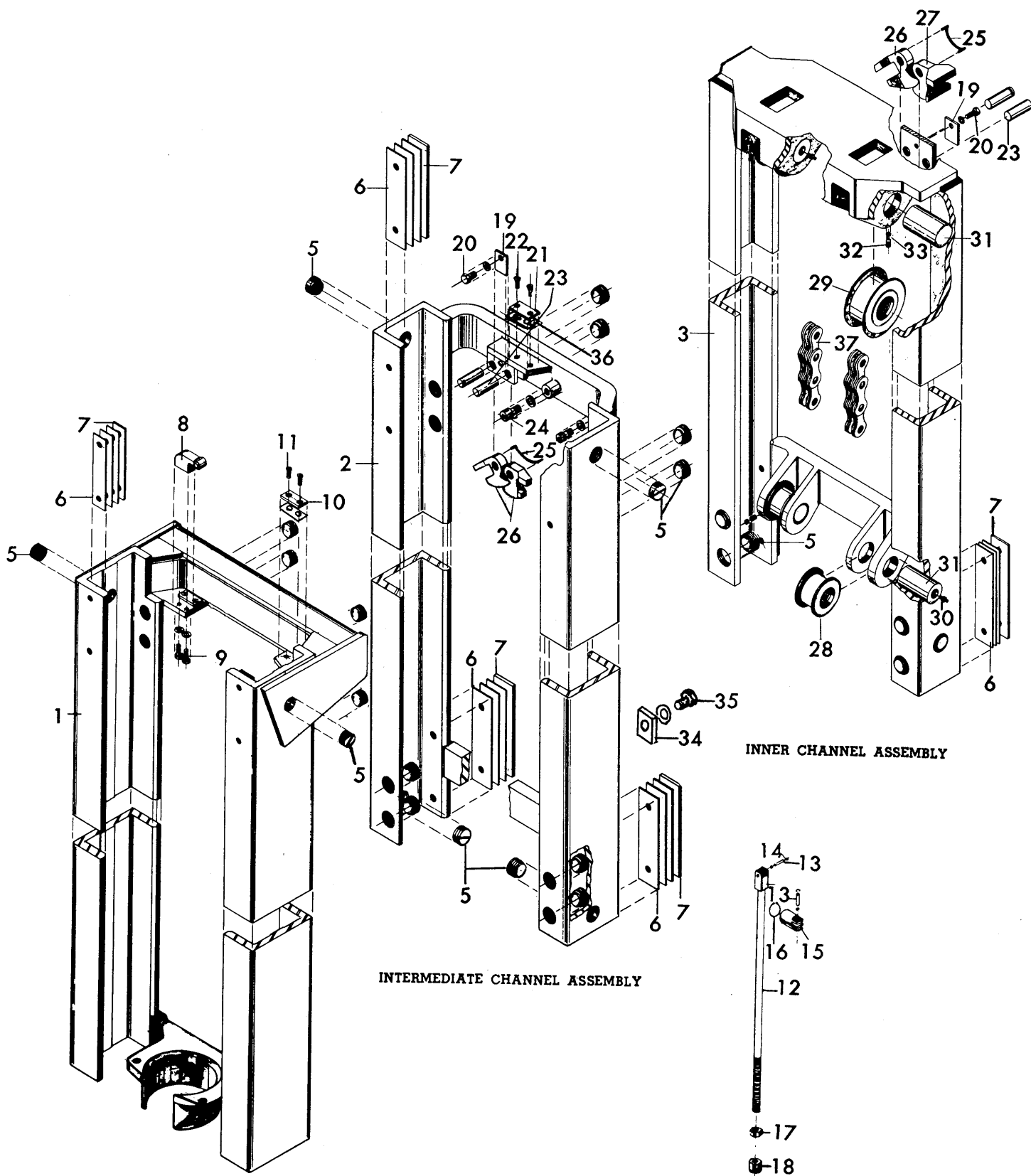

OUTER CHANNEL ASSEMBLY

INTERMEDIATE CHANNEL ASSEMBLY

INNER CHANNEL ASSEMBLY

Ref. No.	Part No.	DESCRIPTION	No. Pcs.
		UPRIGHT FOR TRIPLEX TRI-FREE LIFT M7T (Cascade Viewmast) Group II - for MY60-70 with six roller carriage (Tab. 0012) Uprights Serial No. 5272B0 thru 5323B0 MY60-70B with six roller carriage (Tab.0467) Upright Serial No. 7590T3 thru 7615T3 & after.	
1	-----	+Channel - outer assembly.....	1
2	-----	+Channel - center assembly.....	1
3	-----	+Channel - inner assembly.....	1
		+NOTE: Order above parts by M.F.H. and O.A.H.L.	
4	35P2220	Plug - channel.....	30
5	35P2654	Shim - bearing.....	A.R.
6	35P2655	Bearing - channels.....	8
	-----	Bolt - hex., 3/8"-24 x 1/2".....	16
7	20-7300479	Trip-latch.....	1
8	-----	Bolt - hex., 3/8"-24 x 1-1/4".....	2
9	35P1830	Pad-outer channel.....	1
10	35P1863	Shim - pad.....	-
11	-----	Bolt - hex., 1/4"-28 x 5/8".....	2
12	20-7300480	Rod - lift.....	2
13	35P2658	Pin - rod.....	4
14	35P2657	Pin - cotter, 3/32 x 3/4".....	8
15		50A5005 - Nut, hex. jam, 7/8"-14.....	2
16	35P2738	Nut - hex., (Nylock), 7/8"-14.....	2
17	35P1849	Keeper - pins.....	2
18	-----	Bolt - hex., 3/8"-24 x 1/2".....	2
19	35P1830	Pad - center channel.....	1
20	35P1863	Shim - pad.....	1
21	-----	Bolt - hex., 1/4"-28 x 5/8".....	2
22	20-7300481	Pin - latch.....	4
23	35P1864	Bolt - hex., socket, 5/16"-18 x 1".....	1
24	35P1851	Spring - latch.....	2
25	20-7300464	Latch - lift, 2 on center channel, 1 on outer channel.....	3
26	20-7300466	Latch - lift, double inner channel, L.H.	1
27	35P2662	Sheave - chain, lower.....	2
28	35P2664	Sheave - chain, upper.....	2
29	20-7300122	Washer - thrust, chain roller.....	8
30	-----	Fitting - grease, straight, 1/4"-28.....	4
31	35P2663	Shaft - sheaves.....	4
32	-----	Screw - hex. socket, jam, 5/16"-24 x 5/32".....	4
32	-----	Set Screw - hex. socket, 5/16"-24 x 5/8".....	4
33	-----	Chain - lift, 1" pitch AL844 see chart on page A-15	2
	20-3010247	Decal-Warning,on cross head.....	2

Outer Upright Assembly

Intermediate Upright Assembly

Inner Upright Assembly

