

REPAIR CATALOG

R-2131

WHITE MOBI LIFT

MSA

20, 20.1, 25, 25.1

FORK LIFT TRUCKS

MODEL NO. 8100001 AND LATER.

Prior

53

REGISTRATION

2R

18

Supplement "A" to Repair Catalog R2131

This supplement is to be used in conjunction with Repair Catalog R2131 on the MSA 20, 20 II, 25 and 25 II Fork Lift Trucks. This supplement covers changes, corrections and additions to be added to the Repair Catalog.

- Page 9 Change 35P3381 gasket (ref. #76) to 35P1381 (Corr.)
- Page 10 Change 10R1119 Spark Plug (ref. #106) to 10R1191.
- Page 19 Change 35P1450 Prestolite No. to IBB-2042SS1.
- Page 24 Add conversion kit to change 35A7708 pump (Autopulse)
to 35A8639 pump (Bendix).
35R75 Kit - conversion, with attaching parts 1
- Page 26 Change D1173 coupling (ref. #15) to 35P517.
- Page 32 Change description on 50A2883 ring (ref. #22) to
Ring - back-up, "O" ring.
Change 35A4141 countershaft (ref. #30) to 35A9882
(35A4141).
- Page 36 Change 35A1205 valve (ref. #10) to 35A1250.
- Page 38 Change 35A6300 shaft (ref. #3) to 35A9884 (35A6300).
Change 35A6301 shaft (ref. #4) to 35A9883 (35A6301).
- Page 44 Change 35A6907 clamp (ref. #53) to 35A6107 (Corr.).
- Page 48 Change 35A8595 rod (ref. #18) to 35A8592 and length
to 4-3/16".
- Page 52 Change 36A8526 support (ref. #7) to 36A9853 (36A8526).
- Page 56 Add note to 50A4746 nipple (ref. #29). Used on lift
trucks with 90° boss opening in transmission case.
29 36A9797 Pipe Assembly - transmission case, 1-1/2" O.D. x 90° 1
Used when transmission case is replaced with flush
opening in case.
- Page 60 Change 35P1286 cover (ref. #18) to 10P3074 (35P1286).
- Page 64 Change 36A9442 bracket (ref. #32) to 36A8888
(36A9442).
Change 10A5914 spring (ref. #34) to 10A25890

Page 66 Add repair kit for tilt cylinder
 35R113 *Repair Kit - cylinder (Includes ref #5, 6, 7, 12, 13,
 14, 15 and 18.)

Page 74 Add lift chain to Triplex Tri-Free Lift with BL534
 chain.

Chain for Lift - 5/8" Pitch BL534 - 3x4 lacing.

<u>M.F.H.</u>	<u>O.A.H.L.</u>	<u>Chain Length</u>	<u>M.F.H.</u>	<u>O.A.H.L.</u>	<u>Chain Length</u>
133"	70"	156-7/8"	161"	76"	181-7/8"
137"	70"	156-7/8"	165"	76"	181-7/8"
141"	70"	156-7/8"	169"	76"	181-7/8"
145"	70"	156-7/8"	169"	82"	193-1/8"
149"	70"	163-1/8"	173"	82"	199-3/8"
151"	70"	163-1/8"	177"	82"	199-3/8"
149"	76"	175-5/8"	181"	82"	199-3/8"
153"	76"	175-5/8"	185"	82"	205-5/8"
157"	76"	175-5/8"			

Page 76 Change 35P2048 Repair Kit to 35R70.

Page 92 Change GM147887 clevis (ref. #38) to GM174887 (Corr.).

Page 93 Add note; Parts used on MSA Lift Trucks to No.
 28100235 Inc.

Add the following parts for Auxiliary Valves on MSA
 Lift Trucks Serial No. 28100236 and after.

40	35A3120	Sleeve - power adapter, 7/16"-14 x 1-3/8"	1	1
41	35A3117	Gasket - sleeve	1	1
42		50A1666 Quad Ring - sleeve	1	1
45		50A4425 Elbow - inlet, 7/8"-14 JIC x 90°	2	2
46	10A16285	"O" Ring, elbow	2	2
47		50A4453 Nipple - close, auxiliary valve, 3/4"	1	-
48		50A4579 Coupling - pipe, 3/4"	1	1
49		50A4825 Connector - hose, 3/4" x 1-1/16" JIC	2	2
50	35A8096	Hose and Tube - return, auxiliary valve to tank, 29-11/16" long	1	1
51	35A8097	Hose and Tube - pressure line, control valve to auxiliary valve	1	1
	35A8112	Angle - clip support	1	1
	35A8113	Clip - tubes	1	1
		50A3653 Bolt - hex., 5/16"-18 x 1/2"	2	2
		50A3658 Bolt - hex., 5/16"-18 x 1-1/2"	1	1
		50A3730 Nut - hex., 5/16"-18	1	1

FOREWORD

This catalog contains a complete list of parts for the MSA 20, 20 II, 25, and 25 II Series Lift Trucks. To assist in determining the part numbers and description, the parts in this catalog are grouped according to their location on the Lift Truck. Reference numbers only are shown in each illustration. These numbers correspond to those in the reference number column in the list of parts which precedes each "exploded view".

TYPICAL PARTS ARE SHOWN, AND MAY NOT ALWAYS BE IDENTICAL WITH CURRENT PARTS. REFER TO THE TEXT.

To further assist in locating repair parts, the part numbers are arranged in numerical sequence and indexed on pages 95 thru 102 inclusive.

Component parts of assemblies are listed following the assembly itself and are identified as being part of the assembly by this notation following the description:

Consists of the following.....parts:

or

Includes the following.....parts:

Part numbers only make up an assembly. Hardware items are not to be included.

Parts such as standard bolts, nuts, screws, washers, etc., are indented and listed under the respective individual parts with which they are used. The quantity for many of the shims listed is shown as A.R. (as required). The correct amount of shims should be determined in order to get the proper clearance.

"Right or Left" is determined by facing the mast from the Lift Truck driver's platform.

When in need of repair parts always order the parts from your Mobilift dealer nearest you. All parts orders should plainly specify your name, post office address and whether shipment is to go by parcel post, express or freight.

Before returning repair parts it is necessary to secure written permission from the company authorizing the return of such parts. In the returning of repair parts be sure the package is tagged with your name and address. Prepay transportation charges.

Claims of shortage or breakage should be made to the transportation company on receipt of goods.

It is the policy of White Industrial Division, White Motor Corporation, to improve its products whenever it is possible and practical to do so. We reserve the right to make changes or add improvements in the design or construction at any time without incurring the obligation to install such changes on products previously delivered.



SAFETY FIRST

Most accidents are caused by the failure of some individual to observe simple and fundamental safe rules or precaution. For this reason accidents can be prevented by recognizing the cause of the accidents and doing something about it before the accident occurs.

Regardless of the care used in the design and construction of equipment, there are many points that cannot be completely safeguarded without interfering with accessibility and efficient operation.

A careful operator is the best insurance against an accident.

THE COMPLETE OBSERVANCE OF ONE SIMPLE RULE WOULD PREVENT MANY THOUSAND SERIOUS INJURIES EACH YEAR.

**THAT RULE IS:
"NEVER ATTEMPT TO CLEAN, OIL, OR ADJUST
A MACHINE WHILE IT IS IN MOTION"**

Signed: NATIONAL SAFETY COUNCIL

MSA SERIES LIFT TRUCKS

PARTS GROUP INDEX

	Page		Page
Air Cleaner	15-16	Ignition System	50-51
Auxiliary Valves	92-93	Instrument Panel	50-51
Battery Box	18-20	Lift Cylinder	70-76-82-86
Brakes	40	Lifting Fork	68-72
Brake Linkage	40-41	Load Safety Rack	68-72
Cables	18 thru 22	LP Gas Equipment	26-27
Camshaft	8	Mast	68 thru 86
Carburetor, Gasoline Engine	12	Muffler	11
Choke Control	50-51	Oil Filter, Engine	14
Coil, Ignition	18-22	Oil Filter, Transmission	56
Connecting Rod	8	Oil Pump	8
Control Valve, Lift and Tilt	64	Overhead Guard	54
Control Valve, Transmission	36	Pistons	8
Counterweight	52	Sheave Take-Up Hoses	88
Crankcase	8	Spark Plug - Gasoline	10
Crankshaft	8	Starting Motor	18-22
Cylinder Block and Head	8	Steering Axle	46
Decals and Emblems	73	Steering Gear	42-44
Distributor	19-22	Throttle Controls	48
Drive Axle and Wheels	38	Tilt Cylinder	66
Dual Lever Control	94	Transmission	32-34
Duplex Mast and Lift Cylinders	68-70	Transmission Case	30
Duplex Mast Chart	72	Transmission Controls	36
Engine	8-9-10	Transmission Oil	73
Flywheel	9	Triplex Mast Multi Lift (Knickerbocker)	84-86
Foot Accelerator	48	Triplex Tri-Free Lift (Knickerbocker)	80-82
Forks and Fork Extensions	72	Triplex Tri-Free Lift (Viewmast)	74-79
Frame	52	Valves	8
Fuel Filler	24	Voltage Regulator	18-20
Fuel Pump	24	Wheels, Drive	38
Fuel Strainer	25	Wheels, Steering	46
Gas Manifold	8		
Gasket Sets	9		
Generator	18-20		
Governor	10-20		
Hood	54		
Horn	18-20		
Hose Reel	90		
Hydraulic Oil Lines	56-58		
Hydraulic Pump	60-62	NUMERICAL INDEX	95 thru 102

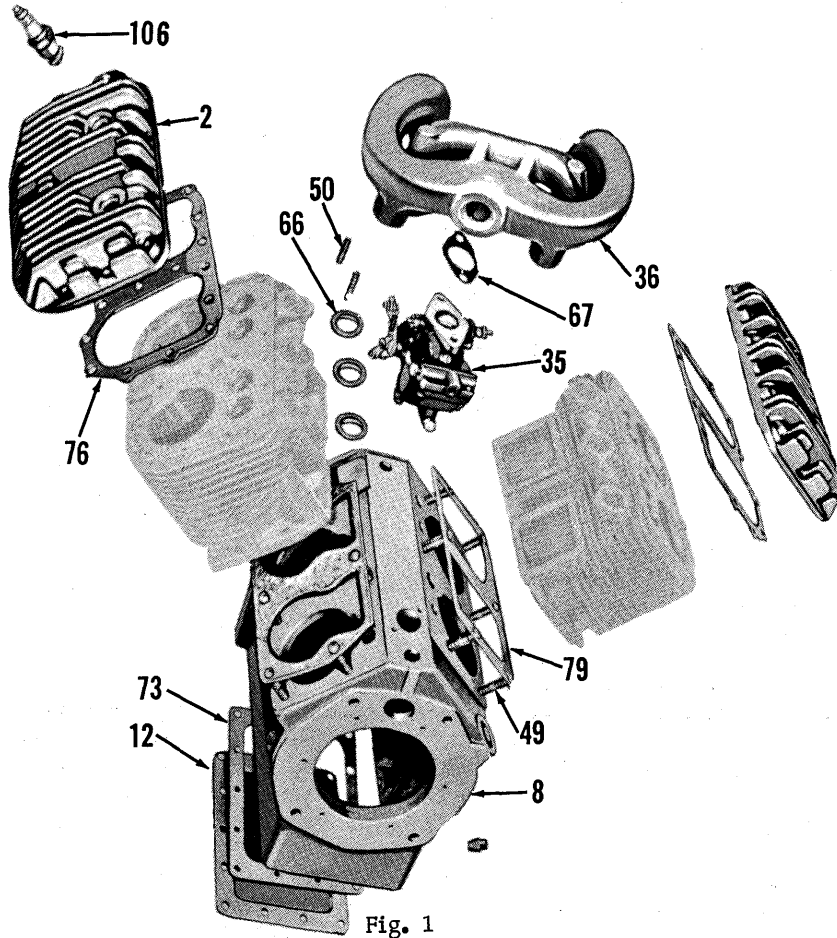

Fig. 1

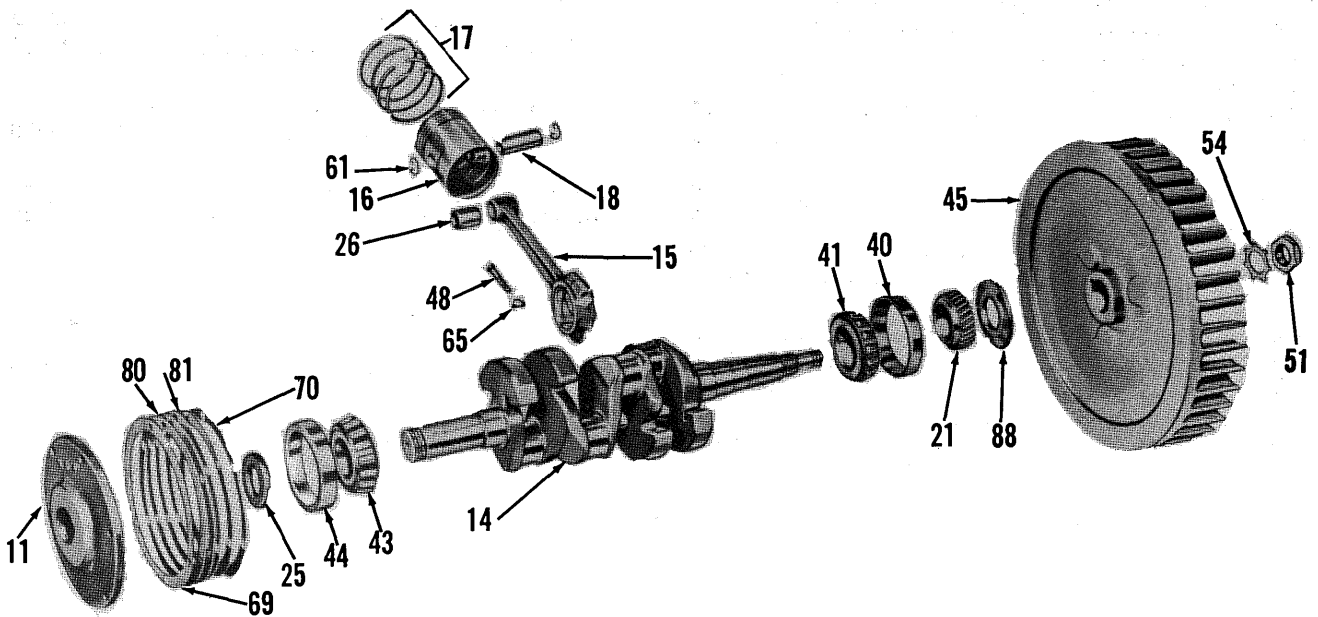

Fig. 2

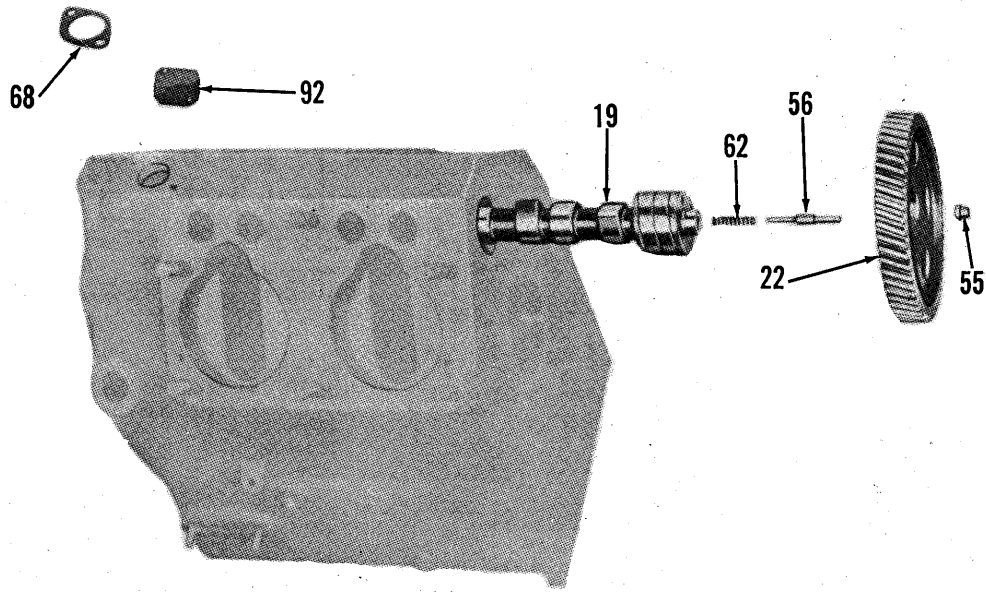

Fig. 3

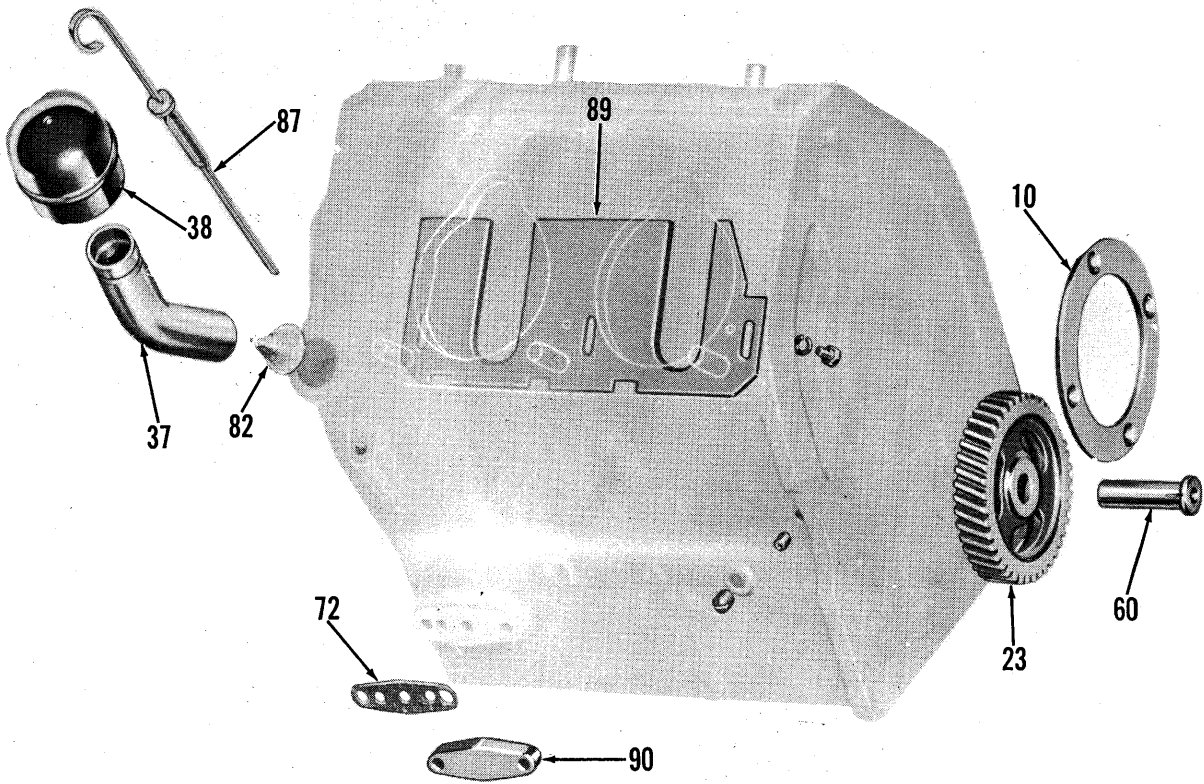

Fig. 4

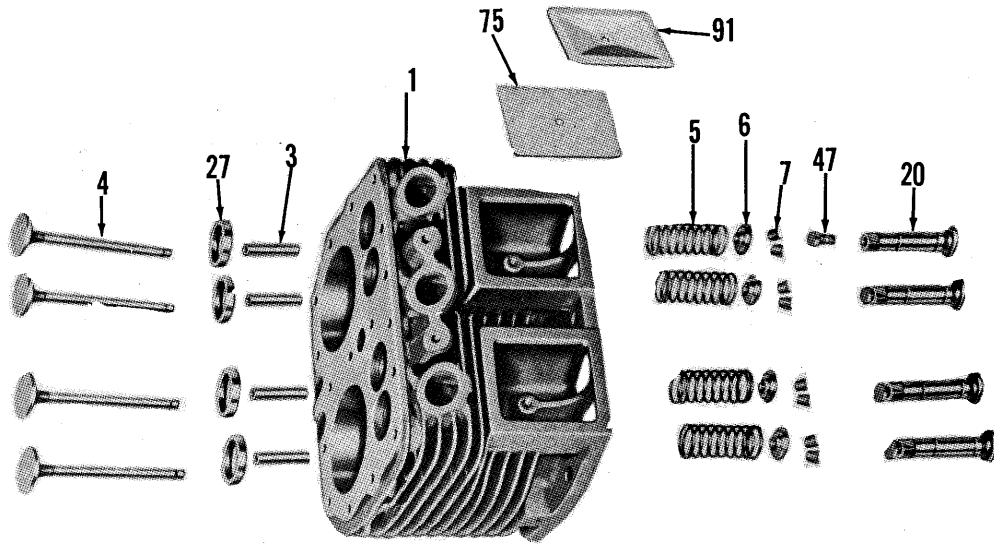

Fig. 5

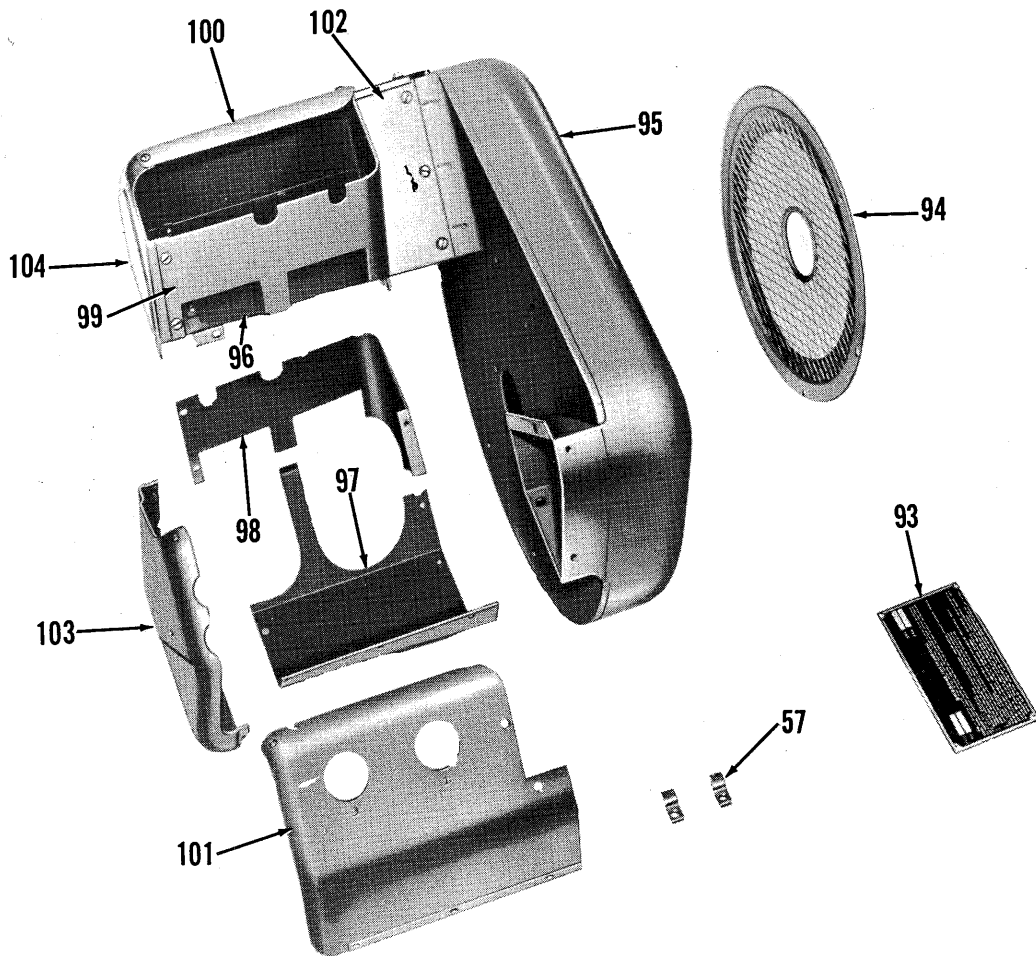

Fig. 6

MSA SERIES LIFT TRUCKS

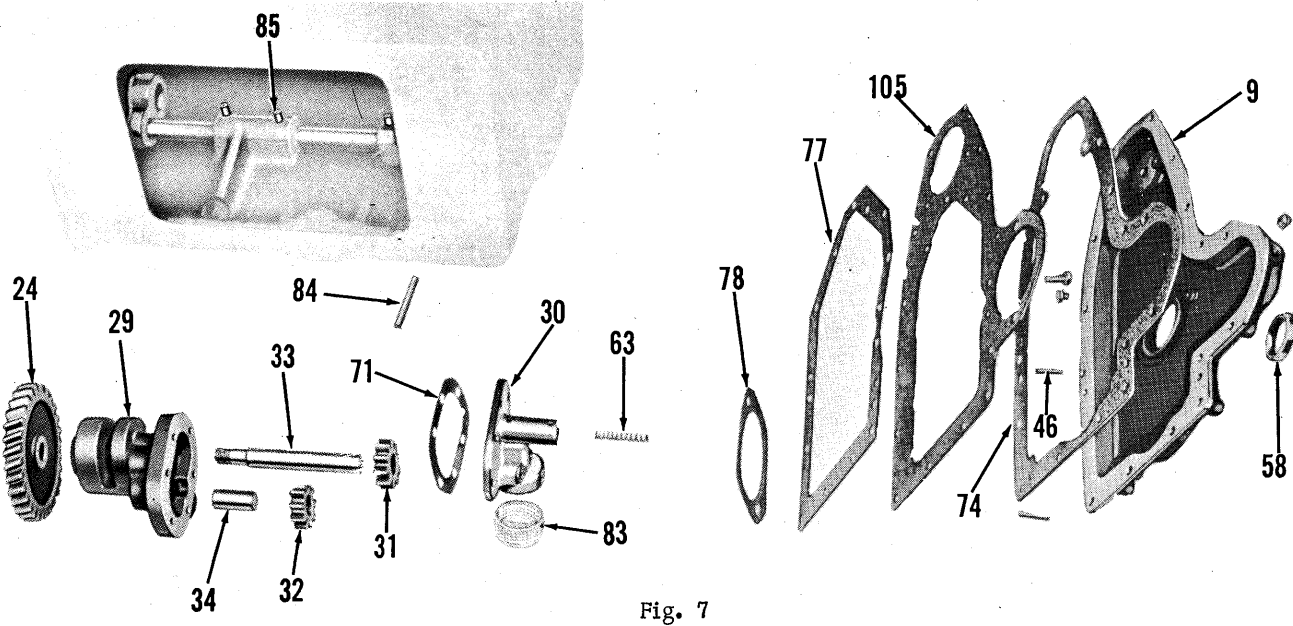
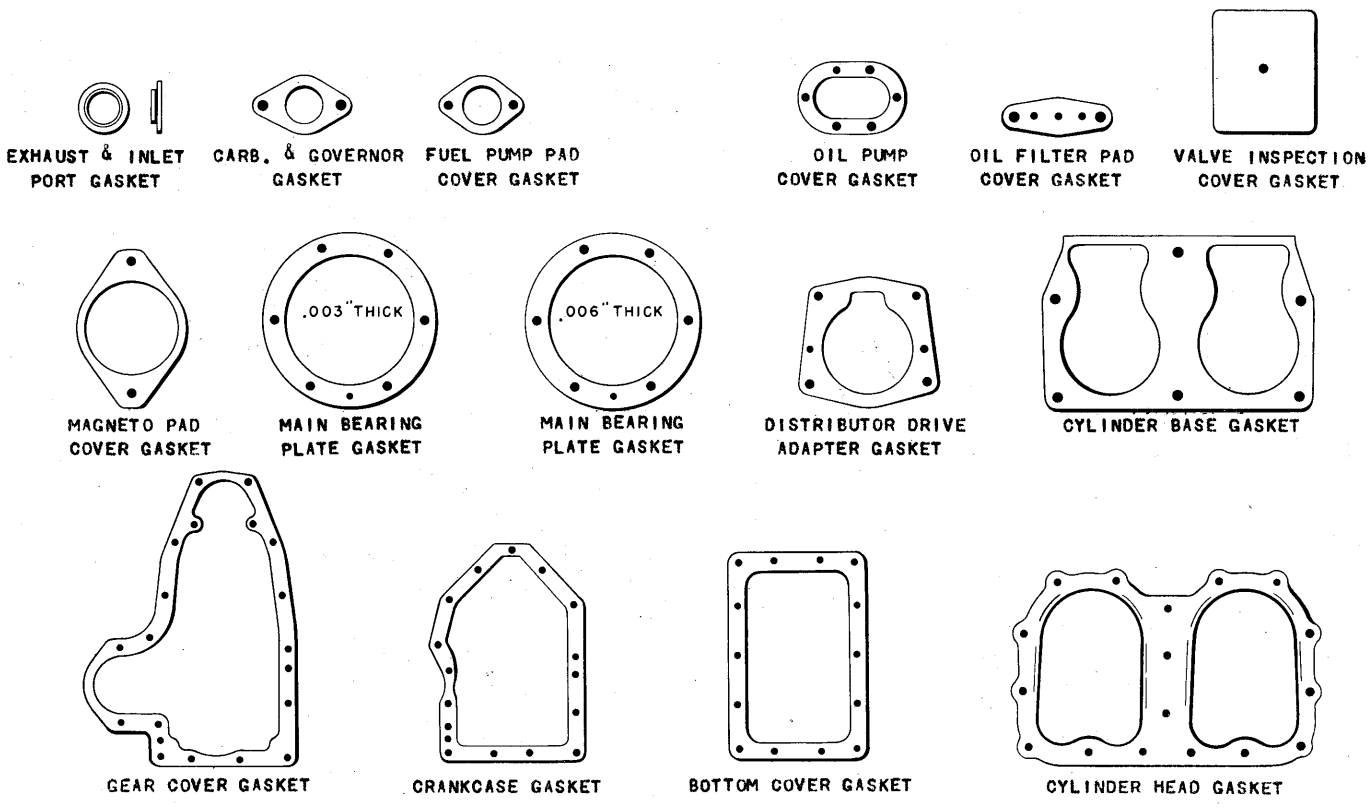

Fig. 7



GASKET SET

Fig. 8