

05W-2202

WORKSHOP MANUAL

Transer

FORCEA

FBC20P,25P,30P-70

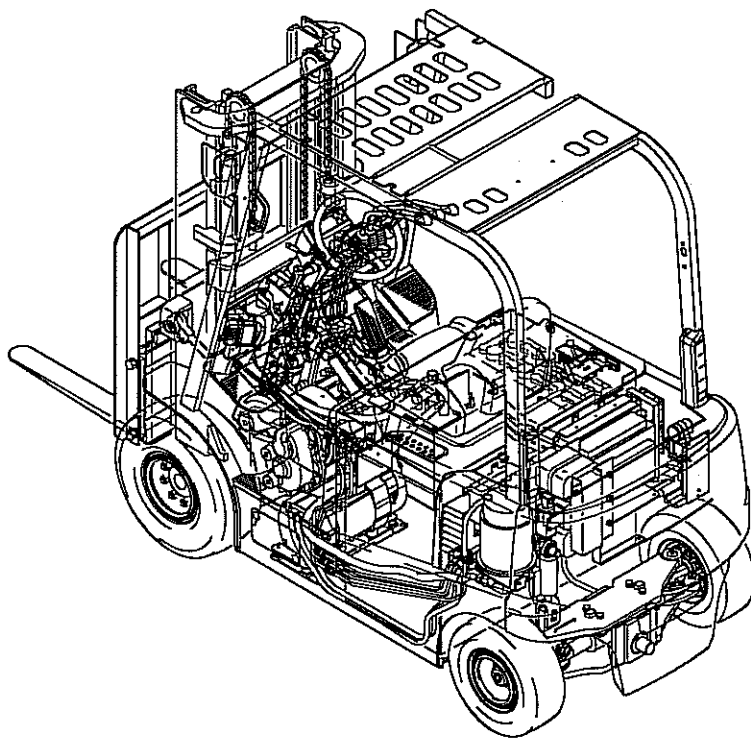

NICHIYU
NIPPON YUSOKI CO.,LTD.
KYOTO, JAPAN

INTRODUCTION

- ▶ Most accident happens due to the disregard of basic safety rules or precautions. In order to prevent accidents from happening, the factors responsible for accidents must be avoided beforehand.

For this reason, please read this manual and fully understand the precautions for safety and the proper procedures and directions for inspection and maintenance before starting operation.

Performing maintenance and repair without adequate knowledge may cause inadvertent accidents.

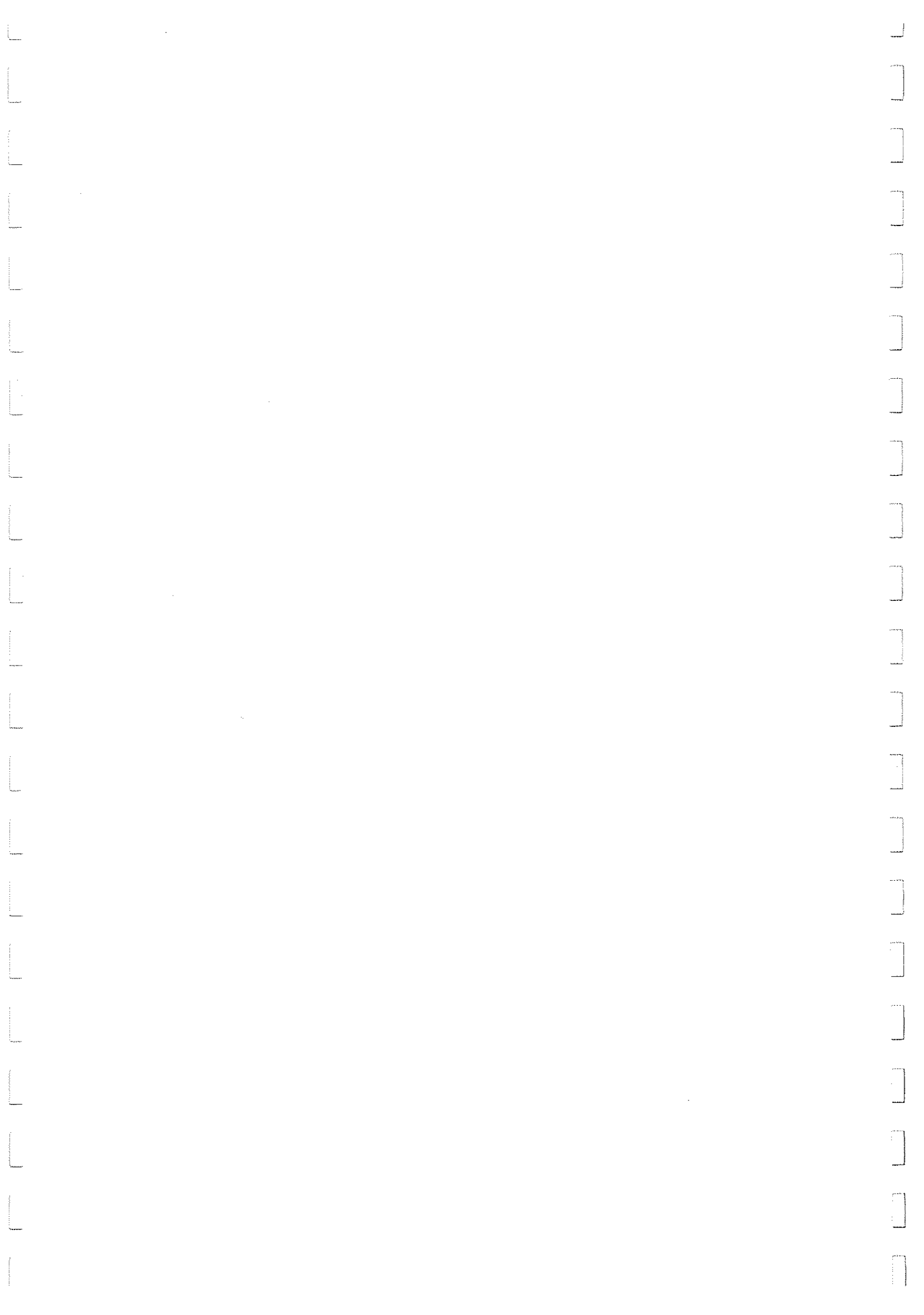

- ▶ It is not possible to cover all the possible cases of accidents in this "WORKSHOP MANUAL". Therefore, attention should be given to precautions other than the ones mentioned in this "WORKSHOP MANUAL". Especially, when repair and maintenance work which are not covered in this "WORKSHOP MANUAL" are carried out, always work under the direction of an instructor who understands the matter.





■ Using this "WORKSHOP MANUAL"

This manual has information about the layout and names of main components, procedures for disassembly, assembly, inspection, adjustment, maintenance, and pinpointing faults which are in effect mainly for the model FBC-70.

Since the parts used in this machine are subject to change for the sake of better quality, performance enhancement, and safety, some portions of the contents and illustrations of the "WORKSHOP MANUAL" may not be identified.

Directions with  and  marks are very important, and must be followed.

	DANGER	Indicates a potentially hazardous situation which, if not avoided, could result in death or serious injury. You shall observe this instruction.
	WARNING	Indicates a potentially hazardous situation which, if not avoided, could result in death or serious injury. You shall observe this instruction.
	CAUTION	Indicates a potentially hazardous situation which, if not avoided, may result in minor or moderate injury. You shall observe this instruction.
	NOTE	Indicates suggestions, tips and hints related to the safety of a operator and maintain of truck.

1. Personnel this "WORKSHOP MANUAL" is aimed at:

This "WORKSHOP MANUAL" is directed at personnel who possess sufficient knowledge and technical expertise. If you do not understand any of the contents of this "WORKSHOP MANUAL", perform operation under the guidance of personnel who does.

2. Conditions of a facility

The work conditions described in the "WORKSHOP MANUAL" are written on the assumption that the work is performed at a shop where standard facilities and tools for the maintenance of NICHYU ELECTRIC LIFT TRUCKS are available.

For safe and reliable maintenance, the work should be performed at a shop where the facilities are equivalent to these described in the "WORKSHOP MANUAL" or better, and the instructions described should be strictly followed.

CONTENTS

See the "FB-75 WORKSHOP MANUAL" (03W-2205) for the chapters whose pages are not mentioned in the "Contents".

SAFETY WORK 1

- 1. Precautions for safe inspection and maintenance work 1
- 2. Safety labels 5
- 3. Model name and serial numbers 9
- 4. Cautions for maintenance 11
- 5. Tightening torque for bolts 14
- 6. Maintenance tools and inspection devices 15

1 .GENERAL 16

- 1-1. Appearance 16
- 1-2. Specifications 17

2 .FRONT AXLE (DRIVE)

- 2-1. Location and name
- 2-2. Disassembly and reassembly
 - 2-2-1. Front axle - removal and installation
 - 2-2-2. Front axle - disassembly and reassembly
- 2-3. Inspection and adjustment
 - 2-3-1. Gears - inspection and replacement
 - 2-3-2. Wheel hub and hub bolt - inspection
- 2-4. Troubleshooting
 - 2-4-1. Front axle - troubleshooting

3 .REAR AXLE (STEERING) 19

- 3-1. Structure and cautions for disassembly, reassembly 19
 - 3-1-1. Rear axle - disassembly and reassembly 19
 - 3-1-2. Rear axle assembly - methods and precautions 22
 - 3-1-3. Discharging air from the auto suspension cylinder 23
- 3-2. Inspection and adjustment 25
 - 3-2-1. Bushing - inspection 25
 - 3-2-2. Knuckle - inspection 25
 - 3-2-3. King pin - inspection 25
 - 3-2-4. Hub and hub bolt - inspection 26
 - 3-2-5. Rear axle comp. - inspection 26

- 3-4. Troubleshooting 27
 - 3-4-1. Rear axle - troubleshooting 27

4 .TYRE

- 4-1. Location, name and tyre size
 - 4-1-1. Tyre name
 - 4-1-2. Tyre size
- 4-2. Inspection and adjustment
 - 4-2-1. Hub nut - inspection
 - 4-2-2. Rim and rim bolt - inspection
 - 4-2-3. Air pressure - inspection
 - 4-2-4. Tyre - visual inspection and replacement
- 4-3. Troubleshooting
 - 4-3-1. Tyre - troubleshooting

5. STEERING 28

- 5-1. Structure and cautions for disassembly, reassembly 28
 - 5-1-1. Steering linkage - disassembly and reassembly 28
- 5-2. Inspection and adjustment 29
 - 5-2-1. Joint - inspection and replacement 29
 - 5-2-2. Knob - inspection and replacement 29
 - 5-2-3. Steering wheel - inspection and replacement 29
- 5-3. Troubleshooting 30
 - 5-3-1. Steering linkage - troubleshooting 30

6. BRAKE 31

- 6-1. Structure and cautions for disassembly, reassembly 31
 - 6-1-1. Foot brake linkage
 - disassembly and reassembly 31
 - 6-1-2. Parking brake linkage
 - disassembly and reassembly 32
- 6-2. Disassembly and reassembly
 - 6-2-1. Wheel brake - removal and installation
 - 6-2-2. Wheel brake - disassembly and reassembly

See the "FB-75 WORKSHOP MANUAL" (03W-2205) for the chapters whose pages are not mentioned in the "Contents".

6-3. Inspection and adjustment	
6-3-1. Brake drum - inspection, repair and replacement	
6-3-2. Shoe & lining - inspection and replacement	
6-3-3. Adjustor ass'y - inspection and replacement	
6-3-4. Wheel cylinder ass'y - inspection and replacement	
6-3-5. Master cylinder ass'y - inspection and replacement	33
6-3-6. Brake pedal - inspection	33
6-3-7. Parking lever - inspection and adjustment	34
6-3-8. Brake linkage - adjustment	34
6-3-9. Discharge air from the brakes	36
6-4. Troubleshooting	38
6-4-1. Brake - troubleshooting	38

7. HYDRAULIC SYSTEM 40

7-1. Oil piping circuit	40
7-1-1. Oil piping circuit - power steering	40

7a. HYDRAULIC PUMP 41

7a-1. Structure and cautions for disassembly, reassembly	41
7a-1-1. Hydraulic pump - removal and installation	41
7a-1-1. Hydraulic pump type	42
7a-2. Inspection and adjustment	42
7a-2-1. Hydraulic pump - inspection	42
7a-3. Troubleshooting	43
7a-4-1. Hydraulic pump - troubleshooting	43

7b. OIL TANK AND OIL PIPING 44

7b-1. Structure and cautions for disassembly, reassembly	44
7b-1-1. Oil tank - precautions	44
7b-1-2. Oil piping replacement - precautions	45
7b-2. Inspection and adjustment	46
7b-2-1. Oil - inspection	46
7b-2-2. Recommended oil and oil quantity	46
7b-2-3. Oil tank and filters - cleaning and check	47
7b-3. Troubleshooting	47
7b-3-1. Oil tank - troubleshooting	47

7c. CONTROL VALVE 48

7c-1. Structure and cautions for disassembly, reassembly	48
7c-1-1. Control valve - disassembly and reassembly	50
7c-2. Inspection and adjustment	52
7c-2-1. Relief pressure - measurement	52
7c-2-2. Microswitch - adjustment	52
7c-3. Troubleshooting	53
7c-3-1. Control valve - troubleshooting	53

7d. CYLINDER

7d-1. Location and name	
7d-1-1. Lift cylinder - main part names	
7d-1-2. Tilt cylinder - main part names	
7d-2. Disassembly and reassembly	
7d-2-1. Lift cylinder (STD mast) - removal	
7d-2-2. Lift cylinder 2nd (M/PFL mast) - removal	
7d-2-3. Tilt cylinder - removal	
7d-2-4. Lift cylinder (STD mast) - installation	
7d-2-5. Lift cylinder 2nd (M/PFL mast) - installation	
7d-2-6. Tilt cylinder - installation	
7d-2-7. Lift cylinder - disassembly and reassembly	
7d-2-8. Tilt cylinder - disassembly and reassembly	
7d-3. Inspection and adjustment	
7d-3-1. Cylinder comp. - inspection	
7d-3-2. Piston rod - inspection	
7d-3-3. Drift of lift lowering and tilt - inspection	
7d-4. Troubleshooting	
7d-4-1. Cylinder - troubleshooting	

7e. POWER STEERING PUMP AND POWER STEERING PIPING 54

7e-1. Structure and cautions for disassembly, reassembly	54
7e-1-1. Power steering pump - disassembly and reassembly	54
7e-1-2. Power steering piping - disassembly and reassembly	55
7e-1-3. Power steering piping replacement - precautions	56
7e-2. Inspection and adjustment	57
7e-2-1. Power steering pump - inspection	57

See the "FB-75 WORKSHOP MANUAL" (03W-2205) for the chapters whose pages are not mentioned in the "Contents".

- 7e-3. Troubleshooting
 - 7e-3-1. Power steering pump - troubleshooting

8. MAST

- 8-1. Location and name
- 8-2. Disassembly and reassembly
 - 8-2-1. Lift bracket ass'y - removal
 - 8-2-2. Mast ass'y - removal
 - 8-2-3. Mast - disassembly and reassembly
- 8-3. Inspection and adjustment
 - 8-3-1. Mast, lift bracket and roller shaft - inspection
 - 8-3-2. Back shoe - inspection
 - 8-3-3. Lift chain - inspection and replacement
 - 8-3-4. Chain bolt - inspection
 - 8-3-5. Chain wheel - inspection
 - 8-3-6. Hose pulley - inspection
 - 8-3-7. Roller - inspection
 - 8-3-8. Fork - inspection
 - 8-3-9. Lift chain - inspection and adjustment
 - 8-3-10. Mast inclination - inspection and adjustment
- 8-4. Troubleshooting
 - 8-4-1. Mast - troubleshooting

9. MOTOR

58

- 9-1. Structure and cautions for disassembly, reassembly 58
 - 9-1-1. Traction motor - disassembly and reassembly 58
 - 9-1-2. Hydraulic motor - disassembly and reassembly 59
 - 9-1-3. PS motor - disassembly and reassembly 59
 - 9-1-4. Motors - specifications 60
- 9-2. Inspection and adjustment..... 61
 - 9-2-1. Rotor comp. - inspection and replacement
(Traction and hydraulic motor) 61
 - 9-2-2. Armature comp. - inspection and replacement 62
 - 9-2-3. Brush, brush holder and spring
(PS motor) - inspection and replacement 62
 - 9-2-4. Motor ass'y - inspection
(Traction motor and Hydraulic motor) 64
 - 9-2-5. Motor ass'y (PS motor) - inspection 65
- 9-3. Troubleshooting 66
 - 9-3-1. Motor - troubleshooting 66

10. ELECTRIC PARTS

67

- 10-1. Location and name 67

10a. CONTROL UNIT

68

- 10a-1. Location and name 68
- 10a-2. Disassembly and reassembly 69
 - 10a-2-1. Control unit - removal and installation 69
 - 10a-2-2. Control unit - disassembly and reassembly 71
- 10a-3. Check and replacement..... 73
 - 10a-3-1. Module, IGBT - inspection and replacement 73
 - 10a-3-2. Capacitor - check and replacement 75
 - 10a-3-3. Capacitor - discharging procedure 75

10b. DISPLAY PANEL AND DIRECTIONAL SWITCH

76

- 10b-1. Disassembly and reassembly 76
 - 10b-1-1. Display panel - disassembly
and reassembly 76
 - 10b-1-2. Directional switch - disassembly
and reassembly 77

See the "FB-75 WORKSHOP MANUAL" (03W-2205) for the chapters whose pages are not mentioned in the "Contents".

10c. ACCELERATOR 79

10c-1. Disassembly and reassembly 79
 10c-1-1. Accelerator linkage - removal and installation 79

10d. MAIN CONTACTOR AND FUSE 80

10d-1. Disassembly and reassembly 80
 10d-1-1. Control unit - removal and installation 80
 10d-2. Inspection and replacement 82
 10d-2-1. Main contactor - inspection and replacement 82
 10d-2-2. Fuse - replacement 82

10e. CHARGER (BUILT-IN TYPE) 83

10e-1. Disassembly and reassembly 83
 10e-1-1. Charger ass'y - disassembly and reassembly 83
 10e-1-2. Transformer - disassembly and reassembly 84
 10e-1-3. Built-in charger - specifications 84
 10e-2. Inspection and replacement 85
 10e-2-1. Magnetic contactor - inspection 85
 10e-2-2. Plug comp. and receptacle - inspection and replacement 85
 10e-2-3. Link fuse and fuse base - inspection 85
 10e-2-4. Transformer - inspection 86
 10e-2-5. Diode - inspection 86
 10e-3. Inspection After Assembly 87
 10e-3-1. Timer - inspection 87
 10e-3-2. Reserve function - inspection 87
 10e-4. Charging procedure 87
 10e-4-1. Normal (Daily charge) 87
 10e-4-2. Reserve charge 87
 10e-4-3. Balancing charge 87
 10e-5. Voltage tap 88
 10e-5-1. Power voltage - check 88
 10e-5-2. Voltage tap - selection 88
 10e-5-3. Power tap - switching 89
 10e-5-4. Link fuse (three-phase voltage) - replacement 89

10f. BATTERY 90

10f-1. Disassembly and reassembly 90
 10f-1-1. Battery - removal and installation 90
 10f-2. Inspection and adjustment 91
 10f-2-1. Battery - inspection 91
 10f-2-2. Battery - Cleaning 92

10g. MPU BOARD

10g-1. Location and name 91
 10g-1-1. Travel/Hydraulic board 91
 10g-1-2. Display board 92

10h. POWER STEERING CONTROLLER 93

10h-1. Location and name 93
 10h-2. Disassembly and reassembly 94
 10h-2-1. Power steering controller - removal and installation 94
 10h-2-2. Power steering controller - disassembly and reassembly 95
 10h-3. Check and replacement 96
 10h-3-1. Diode - check and replacement 96
 10h-3-2. Capacitor - check and replacement 97
 10h-3-3. Capacitor - discharging procedure 97

11. LASER POINTER 98

11-1. Adjustment 98
 11-1-1. Fork level - adjustment 98
 11-1-2. Laser optical axis - adjustment 98

12. SERVICE DATA 99

12-1. Annual Inspection Service Data 99
 12-2. Standard work hours

SAFETY WORK

1. Precautions for safe inspection and maintenance work

Maintenance shops

▲ CAUTION

Facilities with adequate space and level surfaces:

- The floor area of the shop (location) where inspection and maintenance are performed must have adequate floor space, and have level surfaces without holes.
- ➔ If these conditions are not met, unexpected accidents, such as a roll-over of the forklift truck, may result.

▲ CAUTION

WELL-VENTILATED AREA

- Work such as welding painted components or sanding down coated parts should be carried out in well-ventilated areas.
- ➔ If this is not observed, harmful toxic gas or dust may be inhaled.

▲ CAUTION

LOCATION EQUIPPED WITH FIRE EXTINGUISHING EQUIPMENT

- Equipment such as first-aid boxes and fire extinguishers should be nearby when work is performed.

▲ CAUTION

SAFE AND WELL-LIGHTED AREA

- The work area should be safe and well lighted. When working inside the machine or underneath of it, always use a safety lamp with a shielded light bulb.
- ➔ If this is not observed, leaked oil may catch fire when a light bulb pops.

▲ CAUTION

PROPER ARRANGEMENT

- Arrange and clean always at a working place to work safety.
- Especially, arrange disassembled parts well.

Work clothing

CAUTION

- The worker should wear a hat, work clothes, and safety shoes that are suitable for safe work. The work clothes should be close-fitting.
- ➔ If this is not observed, loose clothing may become caught in a machine, resulting in serious injury.

Tools and gauges

CAUTION

- Always use tools that are suitable for the work being performed. Use proper size tools when tightening and loosening the parts of the forklift truck.
- ➔ Failure to observe the above could result in serious injury or damage to machines.

CAUTION

Prepare tools and gauges before starting to work.

Safety work

WARNING

- When hoisting a forklift truck or a heavy component, use ropes or cable with correct capacity.
- Do not use ropes or cables which are kinked.

WARNING

After lifting or jacking up a forklift truck, support it with safety blocks or rigid stands.

WARNING

Apply wheel chocks to tyres to prevent the truck from moving.

WARNING

When working under a forklift truck, use a pit or proper safety precautions.