

## INTRODUCTION

Following is a brief summary of the system used in compiling this Catalogue. It is to your advantage to carefully study this summary.

(1) GENERAL: This catalogue is divided into individual groups as indicated on the key page. The thumb tabs on this page directs the user of the catalogue to the index page for each particular group. This catalogue is also divided into four separate sections. Introductory pages, Indexes to Units, Illustrations and Parts Lists and Numerical Index.

(2) INDEXES: There are three type of Indexes in this catalogue: -

- A. Group Index in the front of the catalogue.
- B. Separate group Indexes to Units.
- C. Numerical Index at the back of the catalogue contains a listing of part numbers.

NOTE: It is important that you refer frequently to the Index to Units. Failure to do so will result in not being able to locate the proper unit.

(3) ILLUSTRATIONS: The "exploded views" of each unit show the individual parts clearly and in their proper relationship to each other. This method of illustrating makes it easy to locate parts, whether they are ordered by description or by part number. Reference numbers only are shown in each illustration. These numbers correspond to those in the reference number column in the list of parts which follows each "exploded view".

CAUTION: Reference numbers should not be used when ordering parts. ALWAYS use IH part numbers or description when ordering.

(4) METHOD OF LISTING: The Parts Catalogue is divided into groups or units. Parts are listed in order by reference number of illustration, followed by a full description based upon "noun first" method and quantity required per unit. Parts not shown in illustrations appear at the end of list in alphabetical sequence by noun name.

Throughout this catalogue the term "Front" indicates the radiator end and "Rear" indicates the drawbar end of the tractor. Whenever the terms "Right" and "Left" are used it should be understood to mean from a rear position looking towards the radiator end.

(5) PART NUMBERS: In cases where the part number suffix letters have been advanced the new part will replace the old unless otherwise indicated. When "R" suffix is used R2 will work for R1, R12 will work for R11, R21 will work for R11, and R92 will work for R91.

(6) ASSEMBLIES AND ATTACHMENTS: Wherever possible the components parts of assemblies or attachments are shown in the "exploded views" by use of brackets or arrows. Components parts of assemblies or attachments are listed by one of the following methods:

- (a) For simple assemblies or attachments the listing are fully covered by description.
- (b) When four or more parts are contained in the assemblies or attachments the listing of components follows the description with the wording -  
Comprising.
- (c) Assemblies or attachments consisting of many parts shows the assembly or attachment number at the beginning of the unit list, followed by the listing of the components.

In cases where individual parts of an assembly are not available for service, those parts are indicated.

(7) COMMON HARDWARE ITEMS (Attaching Parts): Appear in abbreviated nomenclature and are shown indented under the major items with which they are used. They should be ordered as listed, since they are not component parts of the pieces they attach. Hardware parts identified with part numbers have been designed for a specific usage. Standard hardware parts should not be substituted for them.

WARNING: Attaching parts especially made for their location should never be substituted with regular standard parts.

## INTRODUCTION - continued

The following rules are established to govern the listing of attaching parts:

per inch for various diameters as shown below:

All Carriage, Machine and Plough BOLTS; NUTS, and Cap, Machine and Set SCREWS will be considered furnished with National Coarse Thread unless otherwise specified. The number of threads per inch will be eliminated.

All NUTS will be considered "hex" unless otherwise specified.

All WASHERS will be considered "Plain" unless otherwise specified. The "ID", "OD" and "No." identity will be eliminated. The inside dimension will be listed first, followed by the outside diameter and the thickness.

All lock WASHERS will be considered "Medium" type unless specified as "Light" or "Heavy".

All cotter PINS will be considered "Extended Prong" type unless otherwise specified.

All groove PINS will be considered "Standard Groove" unless otherwise specified.

All common RIVETS will be considered "Annealed" unless otherwise specified.

All countersunk-head tubular RIVETS will be considered "Copper-Plated Steel" unless otherwise specified.

All oval-head tubular RIVETS will be considered "Brass".

Standard bolts used in International Harvester Products are manufactured under standards known as Unified National Coarse Thread (U.N.C.) and Unified National Fine Thread (U.N.F.) with the number of threads

Diameter of Bolt	No. of Threads per inch (U.N.C.)	No. of Threads per inch (U.N.F.)
1/4"	20	28
5/16"	18	24
3/8"	16	24
7/16"	14	20
1/2"	13	20
9/16"	12	18
5/8"	11	18
3/4"	10	16
7/8"	9	14
1"	8	14*
1-1/8"	7	12
1-1/4"	7	12
1-3/8"	6	12
1-1/2"	6	12

\* Not UNF but 1" STD. 1H Fine

(8) ABBREVIATIONS: The abbreviations used in this catalogue are explained in the list of abbreviations.

(9) SERIAL NUMBERS: Engine serial numbers are stamped on a pad on the right side of the engine crankcase.

CHASSIS serial numbers are stamped on the plate attached to the right of the dash panel.

LOADER serial numbers are stamped on the plate attached to right hand carrying frame.

4 in 1 BUCKET serial numbers are stamped on the plate attached on the rear of the bucket.

It is the policy of International Harvester Company to improve its products whenever it is possible and practical to do so.

We reserve the right to make changes or add improvements in the design or construction of parts at any time without incurring the obligation to install such changes on products previously delivered.



## D I E S E L   E N G I N E



## I N D E X   T O   U N I T S

Description	Page
CAMSHAFT    ...    ...    ...    ...    ...    ...	6
CRANKSHAFT    ...    ...    ...    ...    ...    ...	15
CRANKCASE    ...    ...    ...    ...    ...    ...	11
COVER, front    ...    ...    ...    ...    ...    ...	8
ELEMENT, air breather    ...    ...    ...    ...    ...    ...	10
ENGINE, service    ...    ...    ...    ...    ...    ...	2
FAN, blower    ...    ...    ...    ...    ...    ...	41
FILTERS, fuel, bowless    ...    ...    ...    ...    ...    ...	34
oil    ...    ...    ...    ...    ...    ...	36
FLYWHEEL w/Ring Gear    ...    ...    ...    ...    ...    ...	17
HEAD, cylinder    ...    ...    ...    ...    ...    ...	3
HOUSING, thermostat    ...    ...    ...    ...    ...    ...	38
INJECTION SYSTEM    ...    (Simms)    ...    ...    ...	21
LEVER, stop and control    ...    ...    ...    ...    ...    ...	25
MANIFOLD, intake    ...    ...    ...    ...    ...    ...	5
exhaust    ...    ...    ...    ...    ...    ...	3
NOZZLE, injection    ...    (Simms)    ...    ...    ...	23
PAN, crankcase, oil    ...    ...    ...    ...    ...    ...	14
PACKAGES    ...    ...    ...    ...    ...    ...	42
PISTONS    ...    ...    ...    ...    ...    ...	18
PIPES, fuel (Engine)    ...    (Simms)    ...    ...    ...	35
oil return    ...    ...    ...    ...    ...    ...	36
PLUG, glow    ...    ...    (Simms)    ...    ...    ...	23
PUMP, oil    ...    ...    ...    ...    ...    ...	36
water, assy.    ...    ...    ...    ...    ...    ...	39
fuel    ...    ...    (Simms Injection)    ...    ...    ...	32
fuel injection    ...    (Simms Injection)    ...    ...    ...	27
ROD, connecting    ...    ...    ...    ...    ...    ...	18
SUPPORTS, engine, front and rear    ...    ...    ...    ...    ...	20
THERMOSTAT    ...    ...    ...    ...    ...    ...	38
VALVE, mechanism    ...    ...    ...    ...    ...    ...	6



## SERVICE ENGINE

McCORMICK INTERNATIONAL B-100 LOADER

3068 832 R91 4" x 5-1/4", 4 Cylinder (BD 264) DIESEL

This is a standard production engine, less the following parts

BOLT, banjo, fuel feed pump  
BRACKET, fuel filter mounting  
CLAMP, injection pipe  
CONNECTOR, fuel filter  
FAN  
FILTER, fuel, Simm's Bowless, cpte.  
GASKET, injection pump  
LEVER, control, assy.  
LEVER, stop control assy.  
LOCKWIRE, power output screw  
PACKING, injection pipe  
PAD, injection pipe clamp  
PIGTAIL, injection pump drain, cpte.  
PIPE, fuel, feed pump to filter cpte.  
PIPE, fuel, filter to injection pump, cpte.  
PIPES, injection, Nos. 1, 2, 3 and 4, cpte.  
PUMP, fuel, injection, cpte.  
RING, clamping  
SHROUD, excess shaft  
SPACER  
WASHER, banjo bolt, fuel feed pump

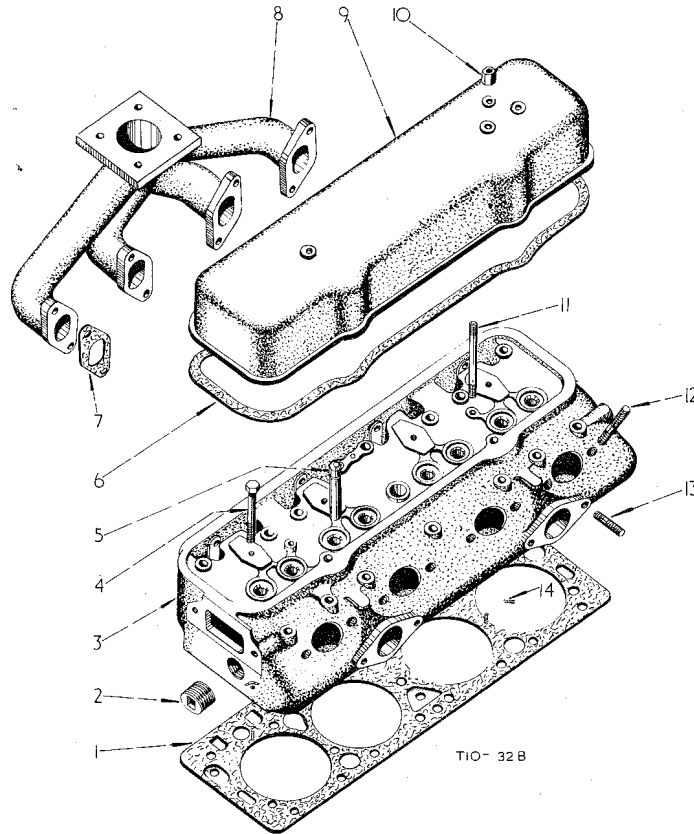

Part Number	Ref. No.	Description	Serial Number	No. Req'd.
CYLINDER HEAD AND EXHAUST MANIFOLD				
700 759 R2	1	GASKET cyl-hd.,		1
144 017	2	PLUG pipe, csk-hdls., 1-1/4" x 1/2" TPI		2
700 795 R95	3	HEAD cyl., assy., w/Valves (comprising		X
		1 HEAD 700 796 R41	8 SPRING 702 761 R2	
		16 KEY 41 339 D	4 VALVE 701 432 R1	
		8 RETAINER 41 349 D	4 VALVE 701 433 R1 )	
		8 SEAT 46 206 D		
46 227 D		NUT, cyl-hd., stud		18
700 796 R41	3	HEAD cyl., less valves, cpte. (comprising		1
		8 GUIDE 706 650 R1	12 STUD 840 575 R1	
		1 HEAD \$	8 STUD 700 797 R1	
		4 PLUG 103 883	2 STUD 700 798 R1 )	
		2 PLUG 144 017		



## DIESEL ENGINE

Part Number	Ref. No.	Description	Serial Number	No. Req'd.
CYLINDER HEAD AND EXHAUST MANIFOLD - contd.				
701 816 R1	4	BOLT, bracket, valve lever shaft		4
706 650 R1	5	GUIDE valve		8
700 799 R2	6	GASKET, valve housing		1
700 832 R2	7	GASKET, exhaust manifold		4
3041 501 R1	8	MANIFOLD, exhaust		1
840 608 R1		NUT, exhaust manifold stud		8
700 800 R2	9	HOUSING, valve		1
103 026	10	NUT, hex., 3/8" UNF		2
840 500 R1		WASHER, valve housing stud nut		2
700 798 R1	11	STUD, valve cover		2
700 797 R1	12	STUD, nozzle		8
840 575 R1	13	STUD, manifold (intake and exhaust)		12
103 883	14	PLUG, pipe, std., sltd., 1/8"		4
\$ Not supplied separately.				

DIESEL ENGINE

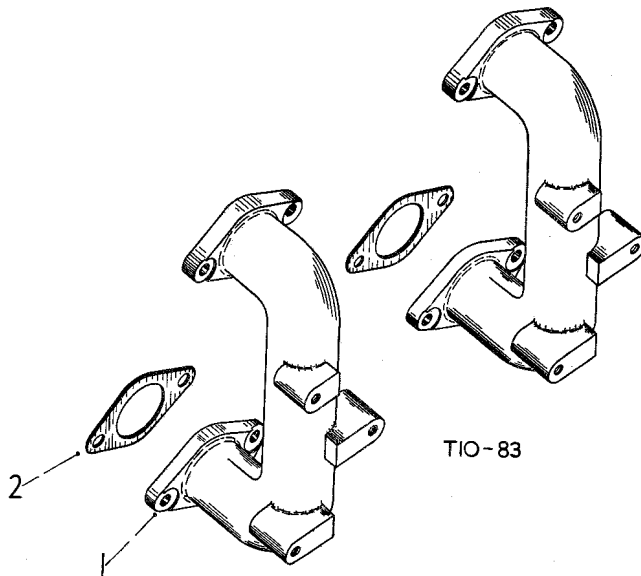

Part Number	Ref. No.	Description	Serial Number	No. Req'd.
INTAKE MANIFOLD				
3049 832 R1	1	MANIFOLD, intake		2
840 608 R1		NUT, intake manifold stud		4
615 063 R1		WASHER, plain, 15/32" x 7/8" x 16 ga.		2
700 830 R2	2	GASKET, intake manifold		2



DIESEL ENGINE

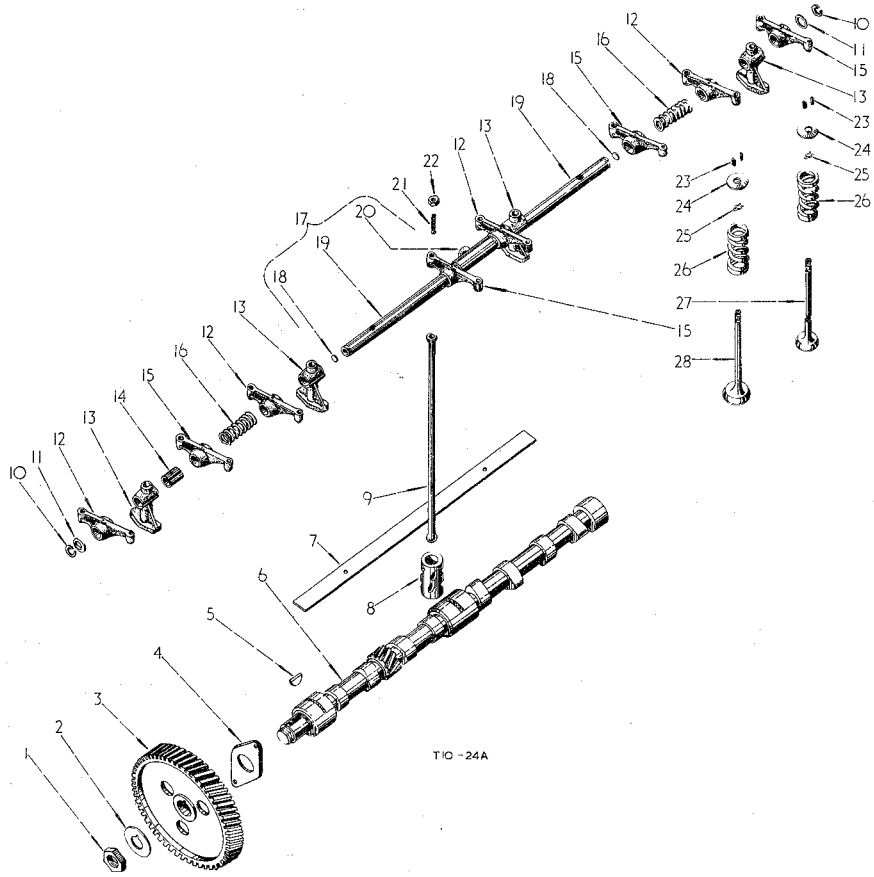

Part Number	Ref. No.	Description	Serial Number	No. Req'd.
<b>CAMSHAFT AND VALVE MECHANISM</b>				
3041 412 R1	1	NUT, camshaft gear		1
16 025 D	2	LOCK, camshaft gear nut		1
6 760 DB	3	GEAR, camshaft ( 58 teeth)		1
43 249 D	4	PLATE, camshaft thrust		1
179 837		BOLT, hex-hd., 3/8" x 3/4"		2
103 321		WASHER, lock, 3/8"		2
127 559	5	KEY, camshaft gear (Woodruff)		1
840 513 R1	6	CAMSHAFT		1
49 027 D	7	STOP, valve tappet		1
113 860		SCREW, mach., rd-hd., 5/16" x 5/8"		2
103 320		WASHER, lock, 5/16"		2
45 956 D	8	TAPPET, valve		8
708 349 R1	9	ROD, valve push		8





## DIESEL ENGINE

Part Number	Ref. No.	Description	Serial Number	No. Req'd.
CAMSHAFT AND VALVE MECHANISM - contd.				
43 375 D	10	SNAPRING, valve lever shaft		2
43 374 D	11	WASHER, valve lever shaft spring		2
43 916 DAX	12	LEVER, valve assy., R. H., cpte., w/BUSHING 24 564 DA		4
45 948 DB	13	BRACKET, valve lever shaft		4
114 606		WASHER, lock, external shakeproof, 3/8"		4
24 564 DA	14	BUSHING, valve lever		8
43 915 DAX	15	LEVER, valve, assy., L. H. cpte., w/BUSHING 24 564 DA		4
45 949 D	16	SPRING, valve lever		2
64 889 D	17	SHAFT, valve lever and oil sleeve, assy., w/two SHAFT 45 947 DBX and SLEEVE 45 950 DAX		1
172 528	18	PLUG, end, valve lever shaft		2
45 947 DBX	19	SHAFT, valve lever, assy., w/two PLUGS 172 528		2
45 950 DAX	20	SLEEVE, oil, valve lever shaft		1
16 067 DA	21	SCREW, adjusting, valve lever		8
133 093 R1	22	NUT, valve lever adjusting screw		8
41 339 D	23	KEY, valve spring seat		16
46 206 D	24	SEAT, valve spring, upper		8
41 349 D	25	RETAINER, valve stem		8
702 761 R2	26	SPRING, valve		8
701 432 R1	27	VALVE, intake		4
701 433 R1	28	VALVE, exhaust		4
43 915 DAYA		LEVER, valve, L. H. cpte., w/LEVER 43 915 DAX, SCREW 16 067 DA and NUT 133 093 R1		4
43 916 DAYA		LEVER, valve, R. H., cpte., w/LEVER 43 916 DAX, SCREW 16 067 DA and NUT 133 093 R1		4



**Mccormick International B 100 Spare Parts**

Full download: <http://manualplace.com/download/mccormick-international-b-100-spare-parts/>

DIESEL ENGINE

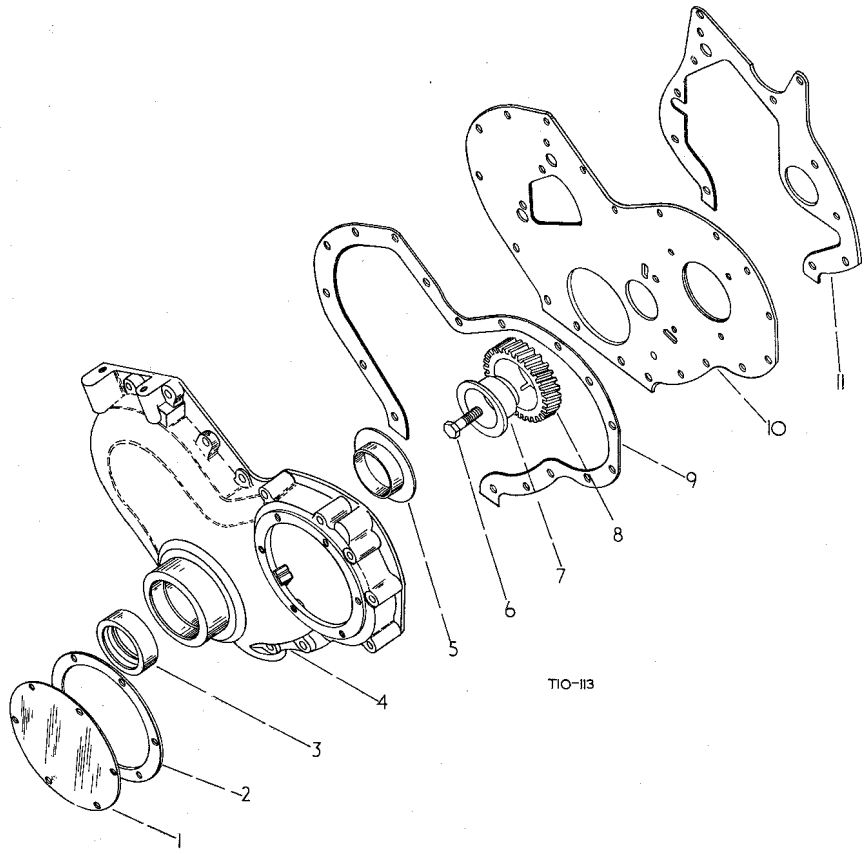

T10-113

Part Number	Ref. No.	Description	Serial Number	No. Req'd.
FRONT COVER				
3062 017 R1 179 816 103 320	1	COVER, injection pump gear BOLT, hex-hd., 5/16" x 3/4" WASHER, lock, 5/16"		1 6 6
3048 212 R1	2	GASKET, injection pump gear		1
258 511 R91	3	OIL SEAL, crankshaft, front		1
3062 971 R11  179 841 179 849 179 843 179 842 179 838 102 635 103 321	4	COVER, front, crankcase, cpte., w/OIL SEAL 258 511 R91 and DEFLECTOR 46 129 D  BOLT, hex-hd., 5/8" x 1-1/4" BOLT, hex-hd., 3/8" x 2-1/2" BOLT, hex-hd., 5/8" x 1-1/2" CAPSCREW, hex-hd., 3/8" x 1-3/8" CAPSCREW, hex-hd., 3/8" x 7/8" NUT, hex., 3/8" WASHER, lock, 3/8"		1  1 6 6 3 1 9 17
46 129 D	5	DEFLECTOR, oil, crankshaft, front		1
181 432	6	BOLT, hex-hd., 1/2" UNF x 1-5/8"		1