

Mazda Rx2 13 Electrical Manual Full download: <http://manualplace.com/download/mazda-rx2-13-electrical-manual/>

This is the cut pages sample. Download all 148 page(s) at: ManualPlace.com

HARNESS SYMBOL:  (F)  (E)  (R)

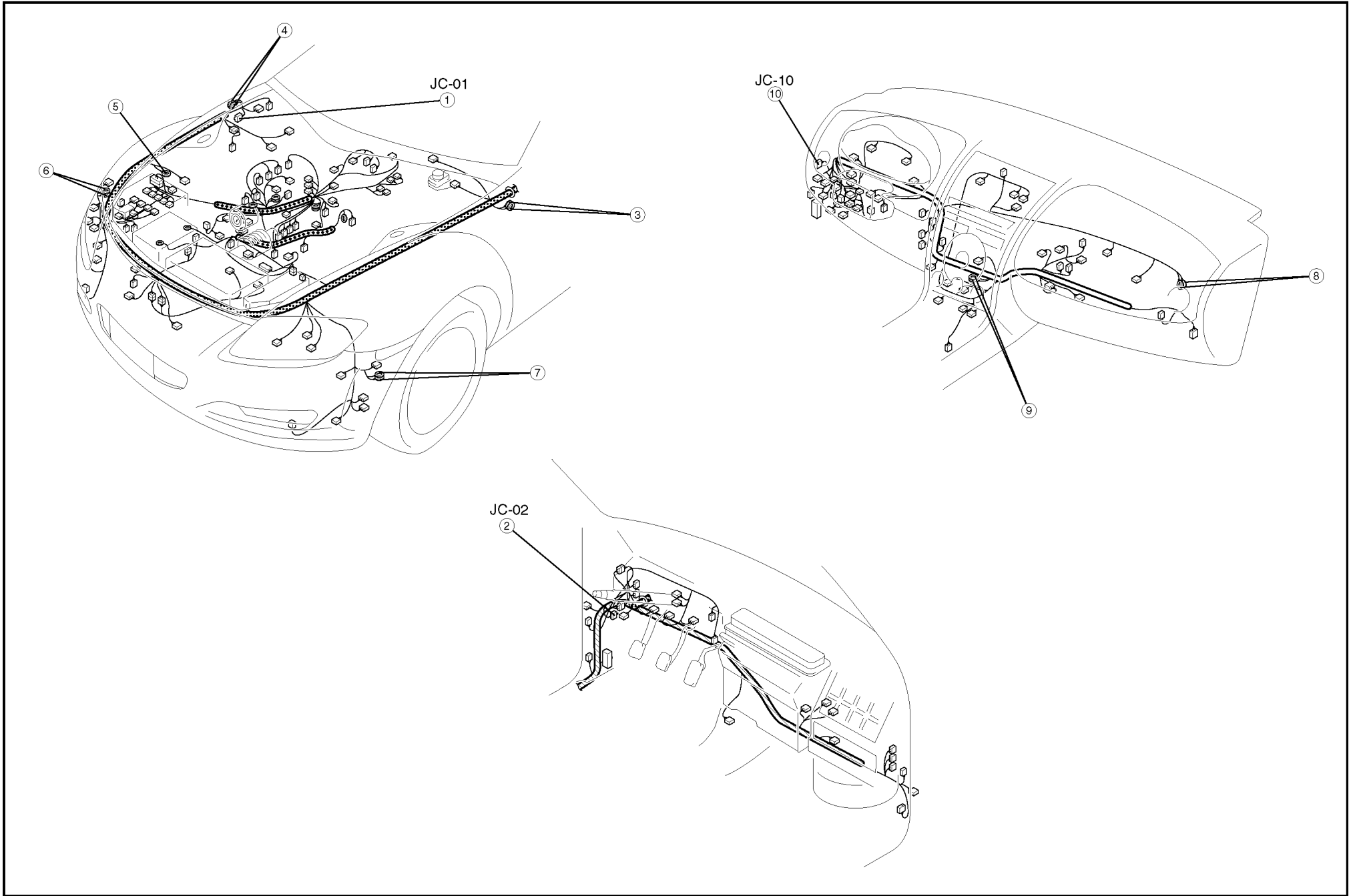



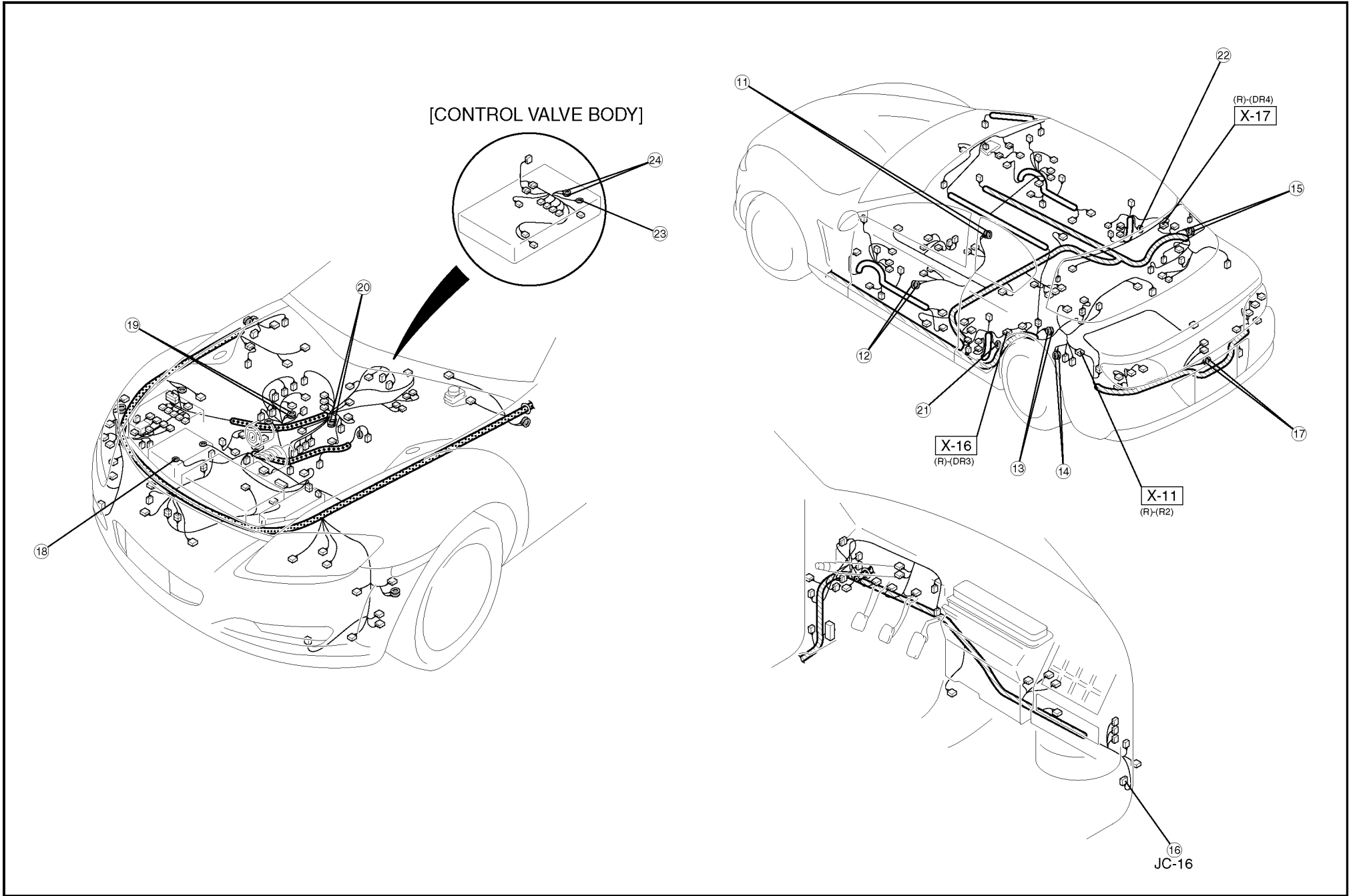

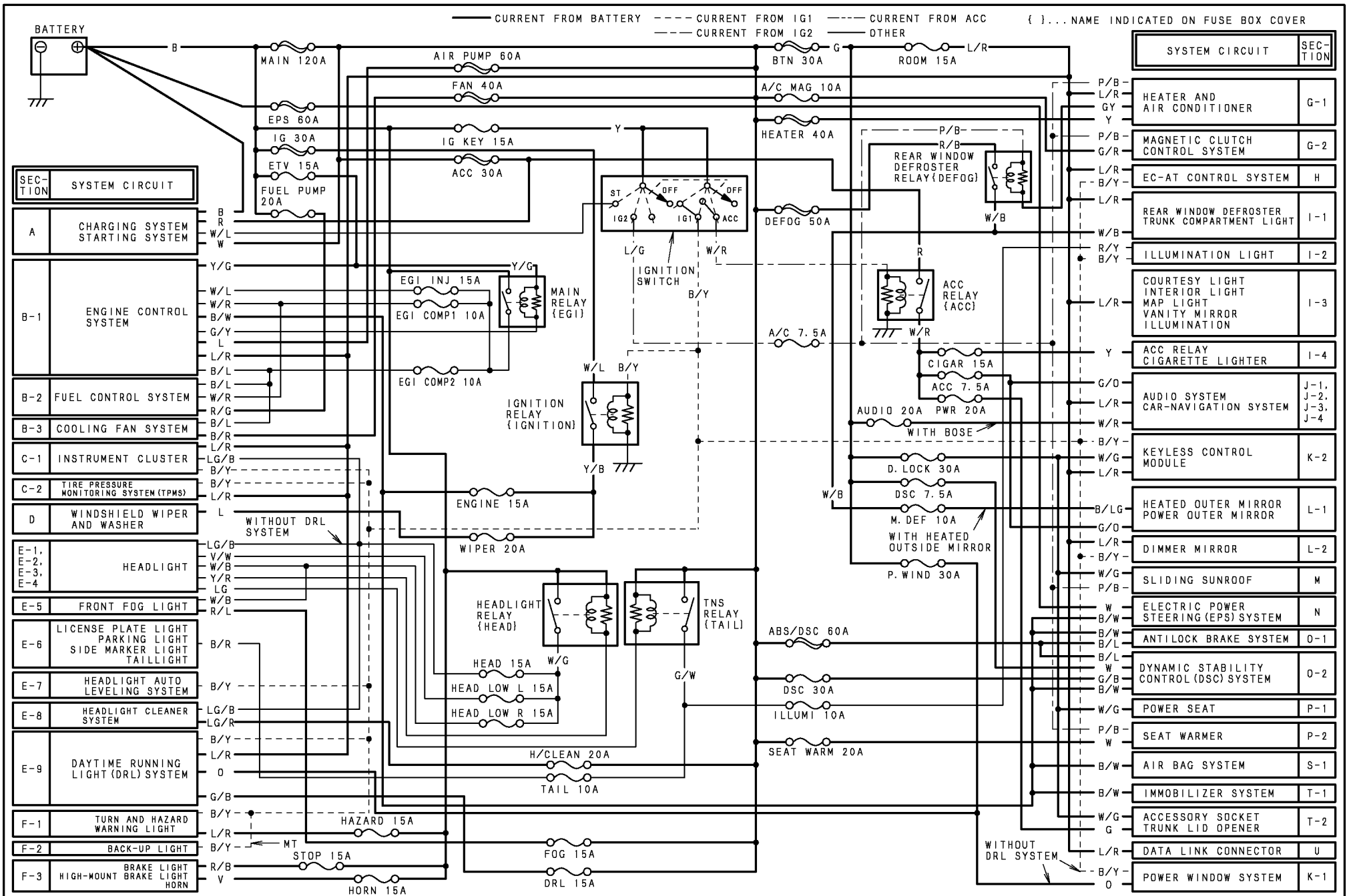
HARNESS SYMBOL:  (F)  (E)  (R)

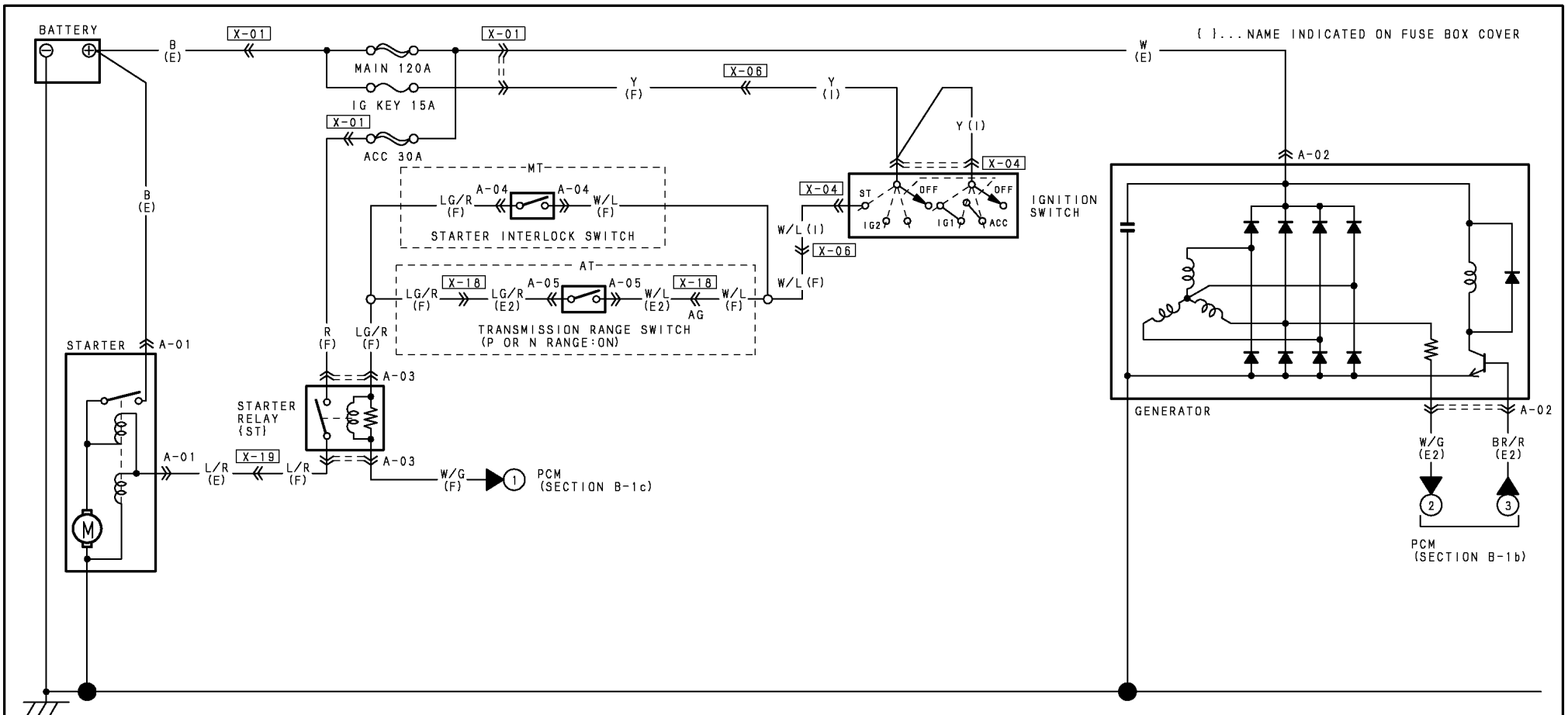



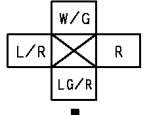
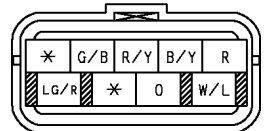

<p>A-01 STARTER (E)</p> 	<p>A-02 GENERATOR (E)</p> 	<p>A-03 STARTER RELAY (ST) (F)</p>  <p>FRONT NOTE: THIS IS THE CONNECTOR AS SEEN FROM THE TERMINAL SIDE.</p>	<p>A-05 TRANSMISSION RANGE SWITCH (E2)</p> 
<p>A-04 STARTER INTERLOCK SWITCH (F)</p> 			

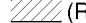
HARNESS SYMBOL:  (F)  (E)  (R)

GENERATOR
Generates power to keep battery fully charged and to operate vehicle's electrical system. Output is variable and depends on speed at which generator rotor spins, as well as amount of current passing through rotor winding.

TRANSMISSION RANGE SWITCH
Detects selector lever position.

IGNITION SWITCH

X-04

(F)-(1)

X-06

TRANSMISSION RANGE SWITCH
A-05

STARTER
A-01

[BLACK]
STARTER
A-01

[GRAY]
GENERATOR
A-02

(F)-(E2)

X-18

X-01

RELAY AND MAIN FUSE BLOCK

A-03
STARTER RELAY
{ST}

X-19

(F)-(E)

(F)-(1)

X-06

A-04
STARTER INTERLOCK SWITCH
[BLACK]

HARNESS SYMBOL:  (F)  (E)  (R)

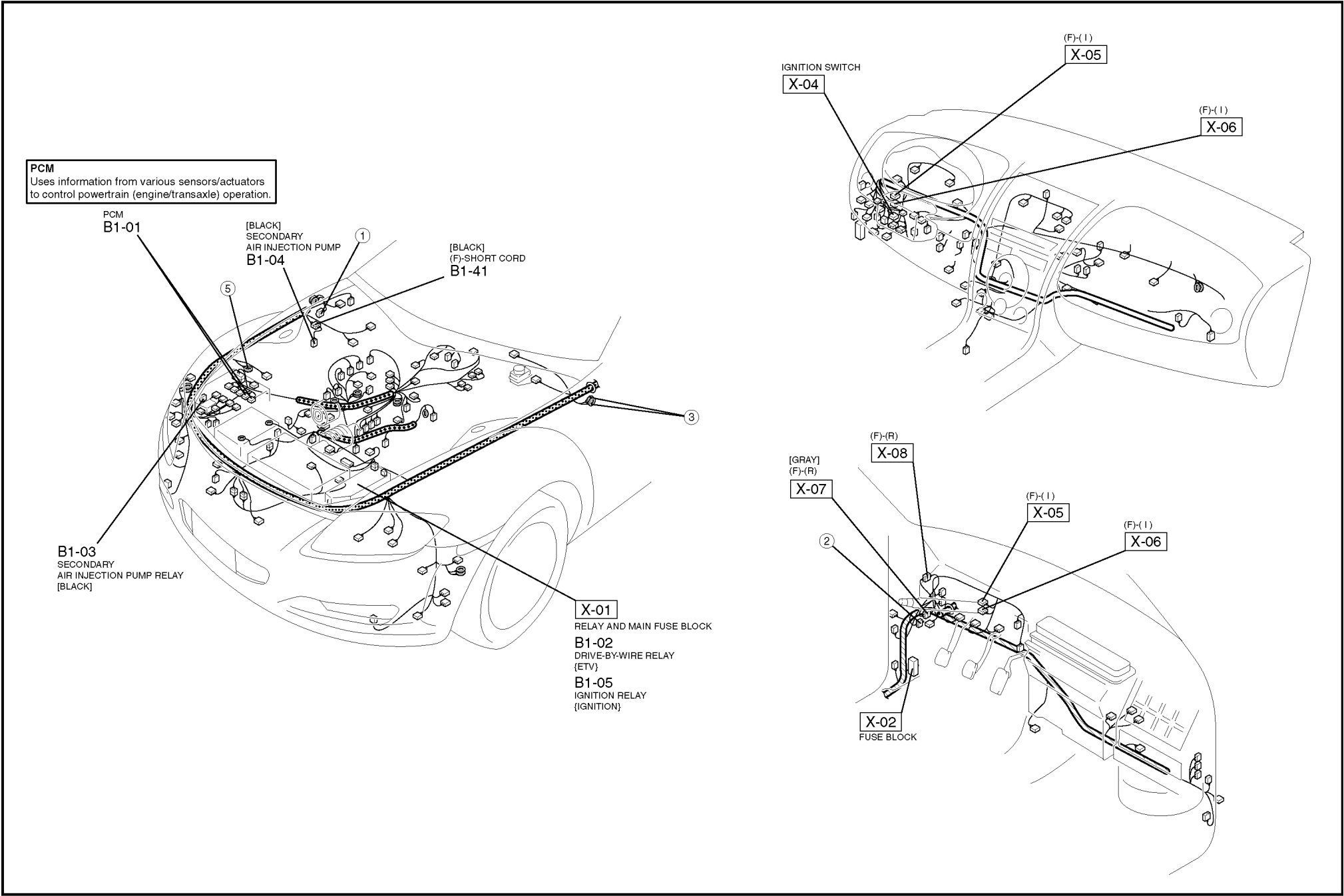

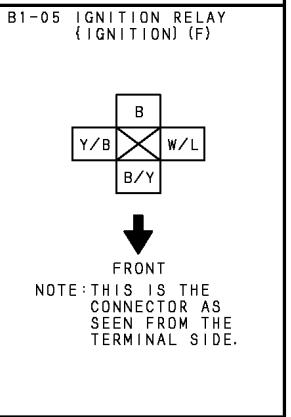
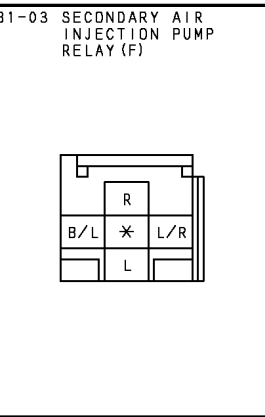
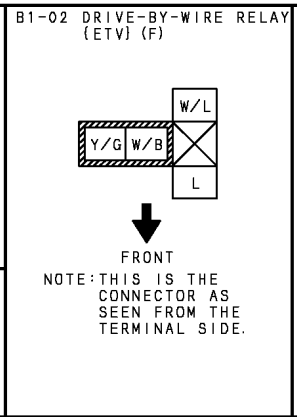
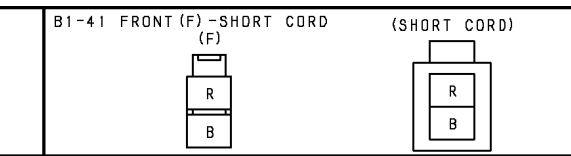
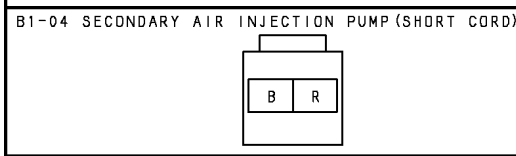
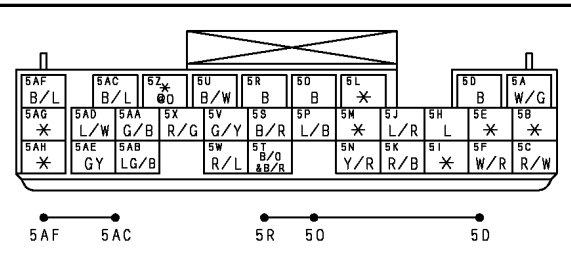
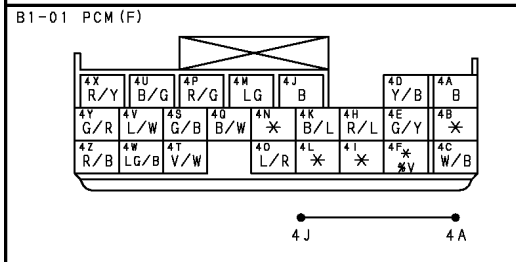
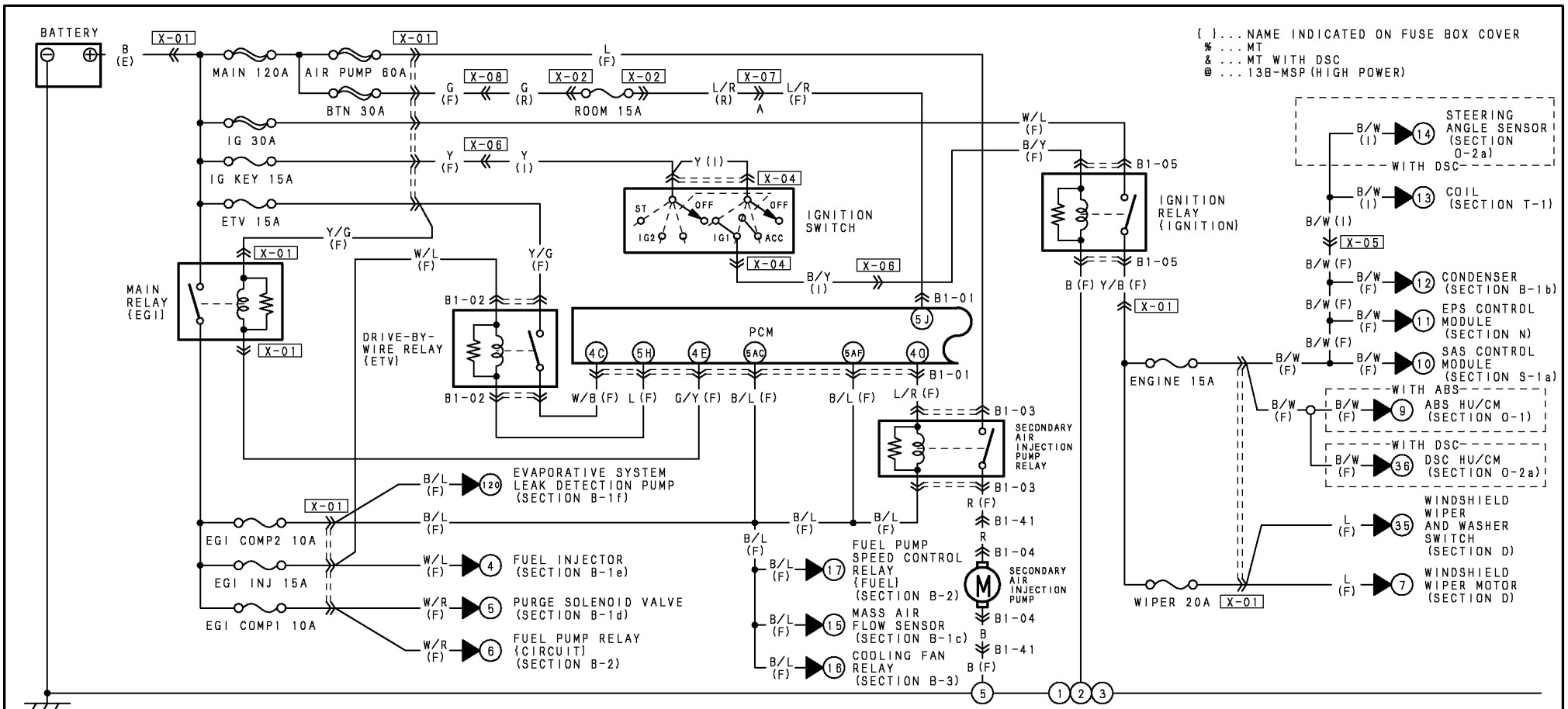

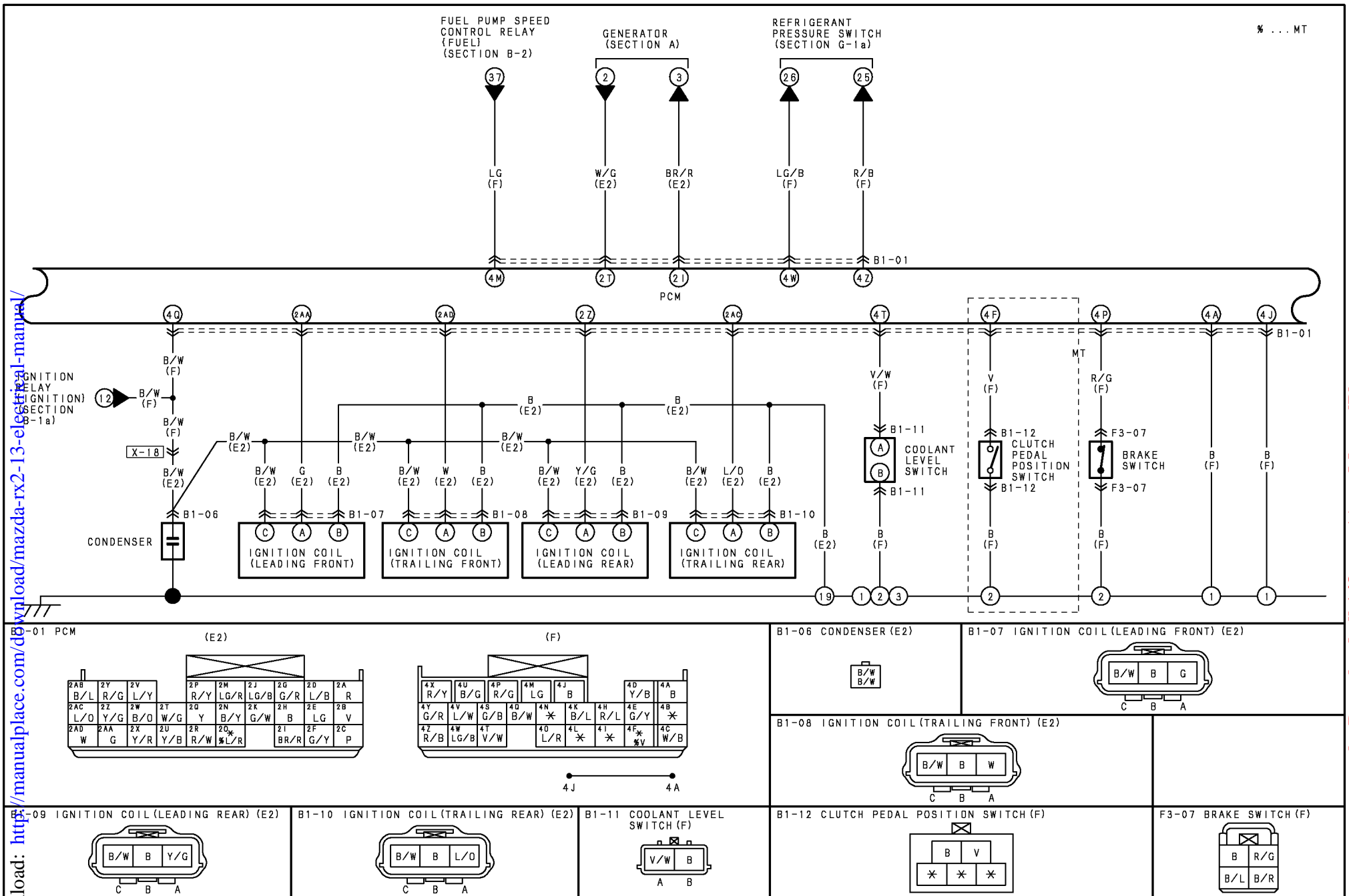

% ... MT

