

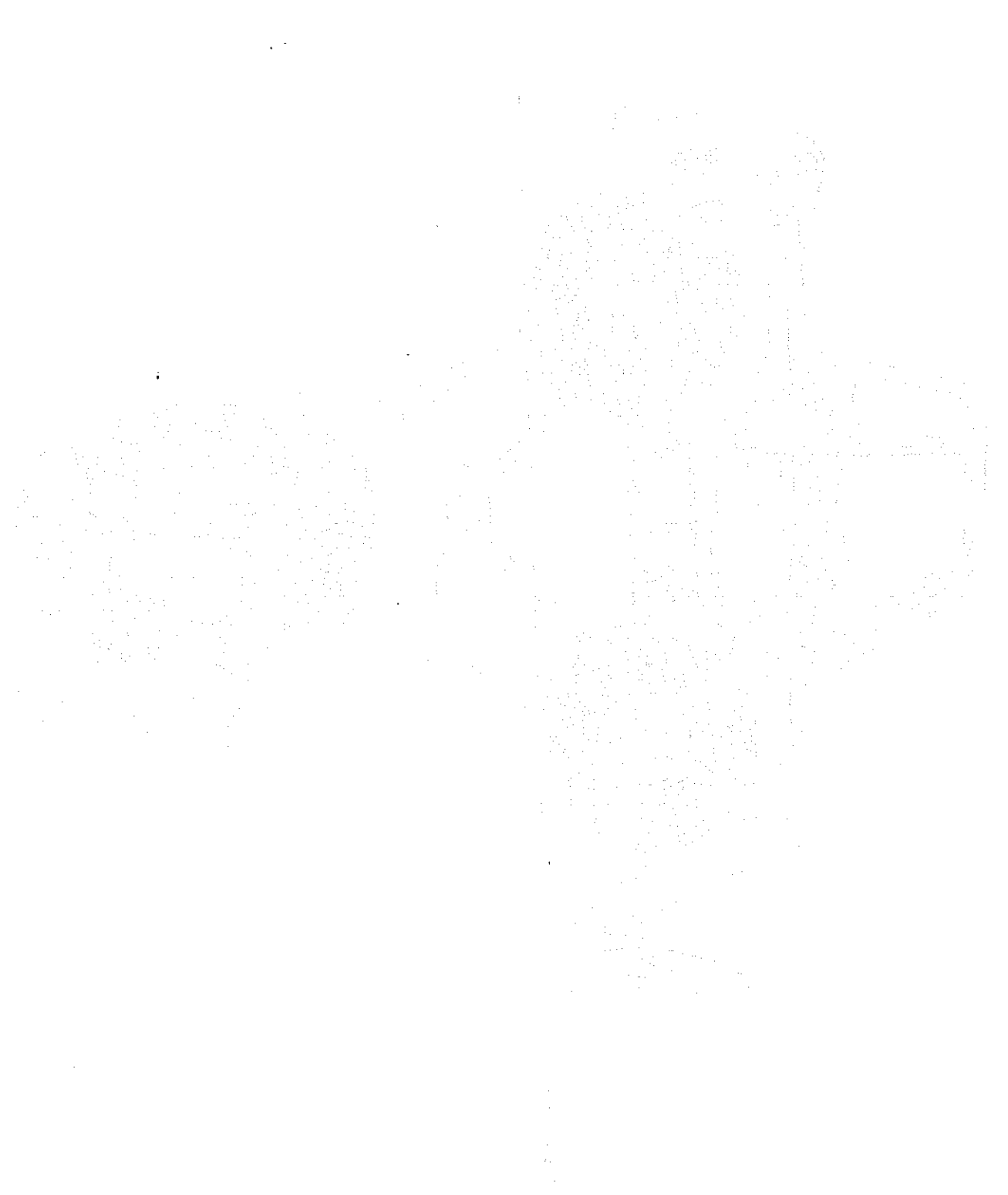

**REF. 47960**

**MVT 930  
T.U.V.  
PARTS CATALOGUE**





1

FINO ALLA MACCHINA  
JUSQU'A LA MACHINE  
UP TO MACHINE

MVT 930

→ N°4673 - 97640

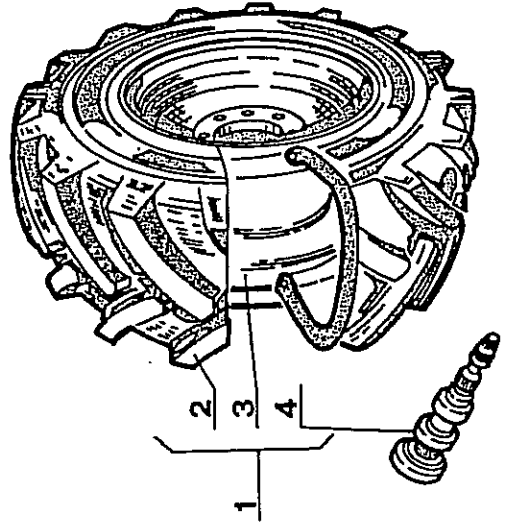
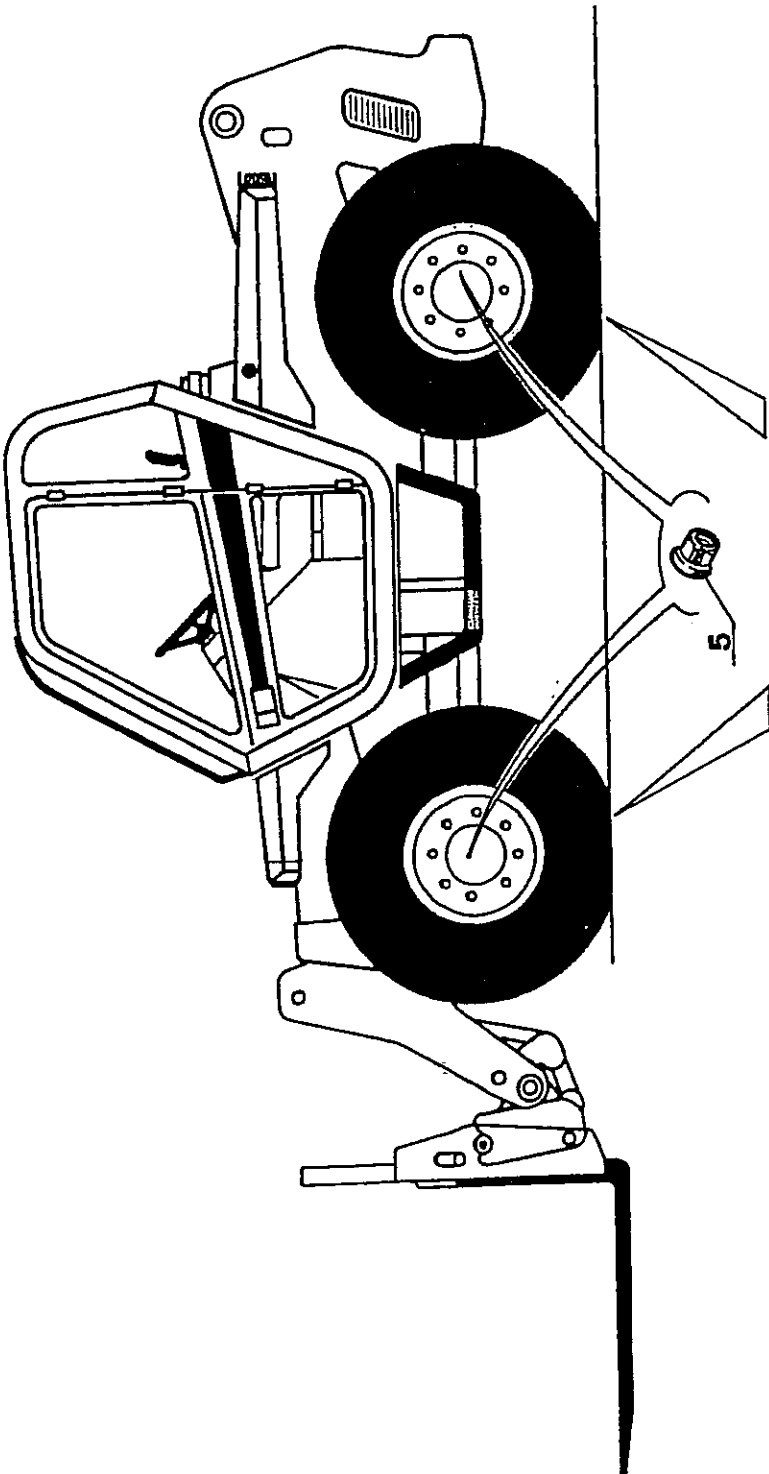

1/1	WHEEL RUOTE ROUES		1		
			Qty - Q.te Quantita		
Ref. Rif. Rep.	Part Number	Description Descrizione Designation	MVT 930		
1	487224	Rear and front complete right whell - Ruota completa anteriore e posteriore destra - Roue complete avant et arriere droit	2		
	487225	Rear and front complete left whell - Ruota completa anteriore e posteriore sinistra - Roue complete avant et arriere gauche	2		
2	482433	Wheel stripped - Pneumatico - Roue nue	4		
3	486835	Tyre - Cerchione - Enveloppe	4		
4	487222	Valve - Valvola camera aria - Valve	4		
5	486690	Nut - Dado - Ecrou	32		

1/A

A PARTIRE DALLA MACCHINA  
A PARTIR DE LA MACHINE  
FROM MACHINE

→ N°4674 - 97641

ECCEPPO PER - SAUF POUR  
EXCEPT FOR - NICHT FÜR  
N°4930 - 101578

FINO ALLA MACCHINA  
JUSQU'A LA MACHINE  
UP TO MACHINE

→ N°4942 - 101581

MVT 930

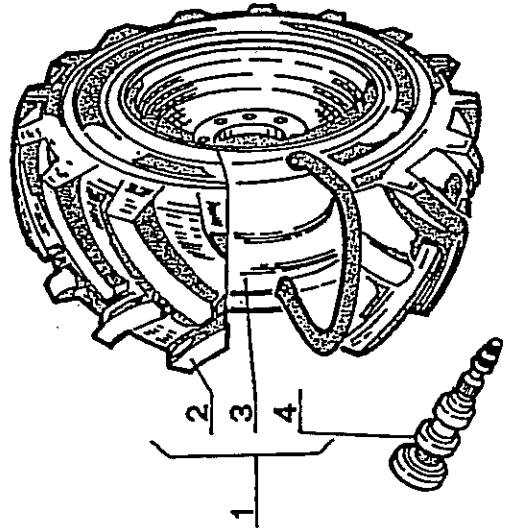
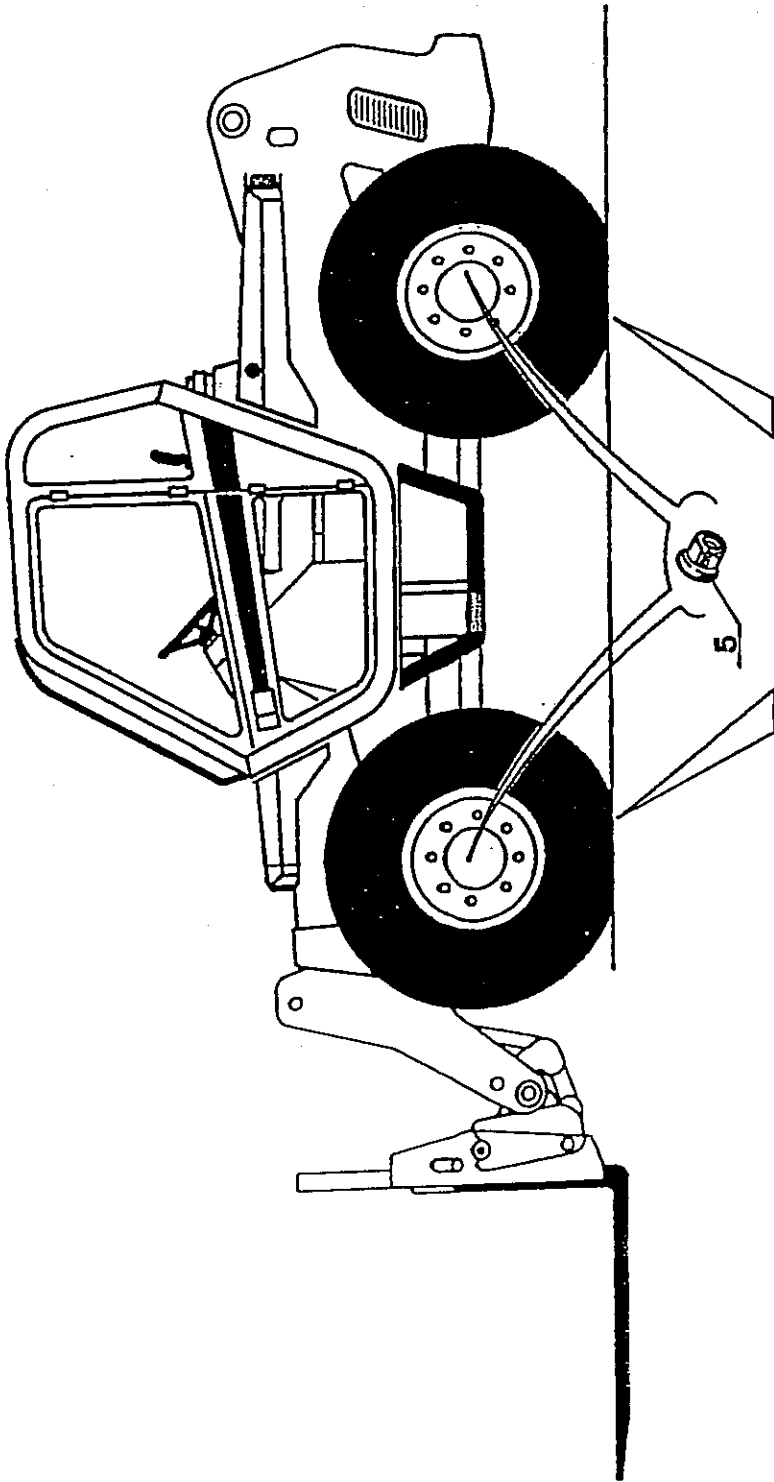

1/1	WHEEL RUOTE ROUES		1/A		
			Qty - Q.te Quantità		
Ref. Rif. Rep.	Part Number	Description Descrizione Designation	MVT 930		
1	487224	Rear and front complete right wheel - Ruota completa anteriore e posteriore destra - Roue complete avant et arriere droit	2		
	487225	Rear and front complete left wheel - Ruota completa anteriore e posteriore sinistra - Roue complete avant et arriere gauche	2		
2	482433	Wheel stripped - Pneumatico - Roue nue	4		
3	486835	Tyre - Cerchione - Enveloppe	4		
4	487222	Valve - Valvola camera aria - Valve	4		
5	501130	Nut - Dado - Ecrou	32		

1/B

A PARTIRE DALLA MACCHINA  
A PARTIR DE LA MACHINE  
FROM MACHINE

MVT 930

→ N° 5052- 103879 + 4930- 101578

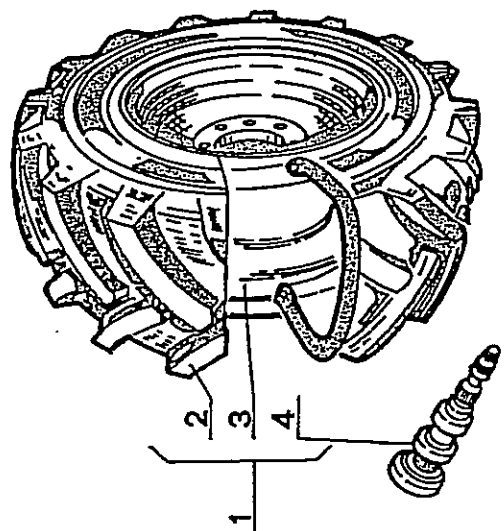
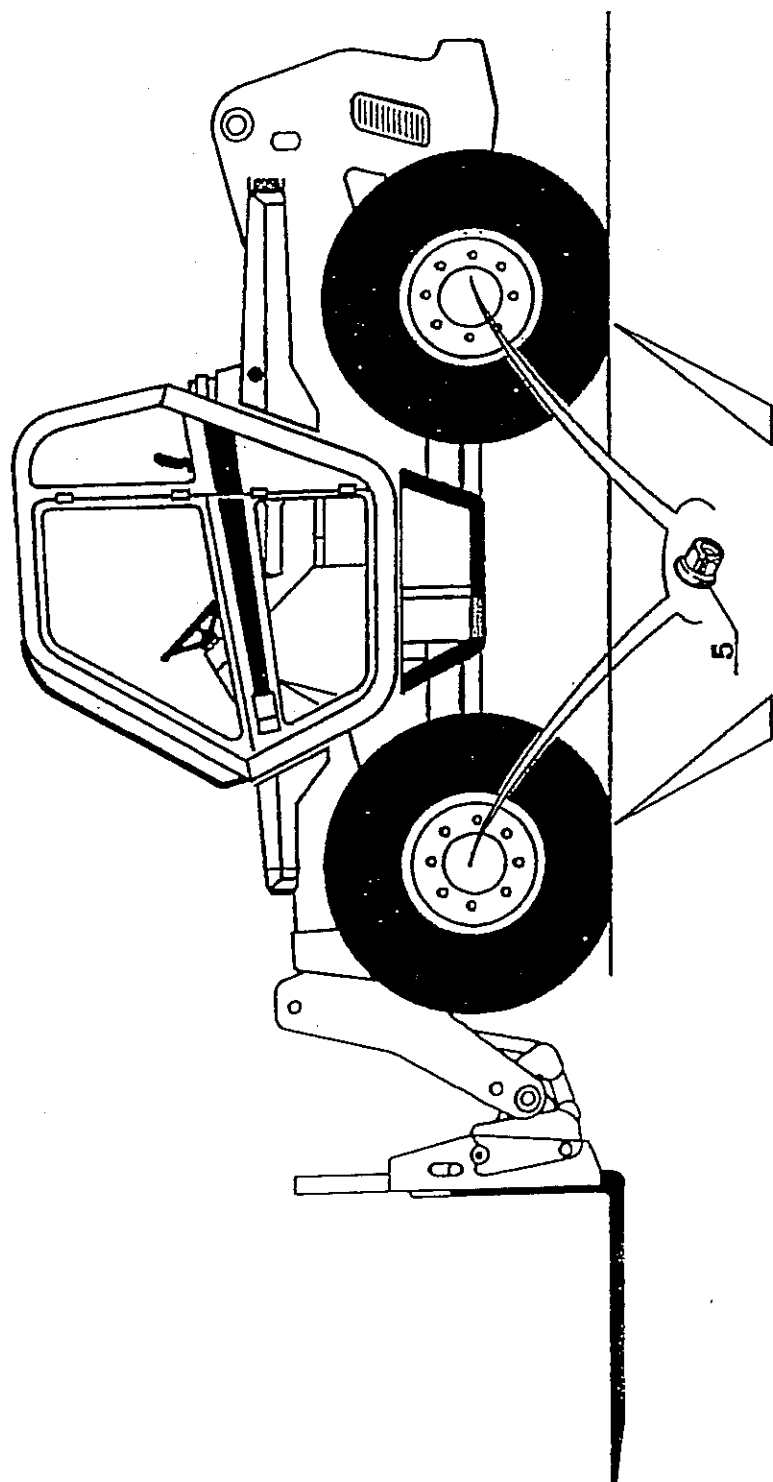



1/1	WHEEL RUOTE ROUES		1/B		
			Qty - Q.te Quantità		
Ref. Rif. Rep.	Part Number	Description Descrizione Designation	MVT 980		
1	487224	Rear and front complete right whell - Ruota completa anteriore e posteriore destra - Roue complete avant et arriere droit	2		
	487225	Rear and front complete left whell - Ruota completa anteriore e posteriore sinistra - Roue complete avant et arriere gauche	2		
2	482433	Wheel stripped - Pneumatico - Roue nue	4		
3	486835	Tyre - Cerchione - Enveloppe	4		
4	487222	Valve - Valvola camera aria - Valve	4		
5	486690	Nut - Dado - Ecrou	32		

FINO ALLA MACCHINA  
JUSQU'A LA MACHINE  
UP TO MACHINE

MVT 930

➔ N°4883 - 101249

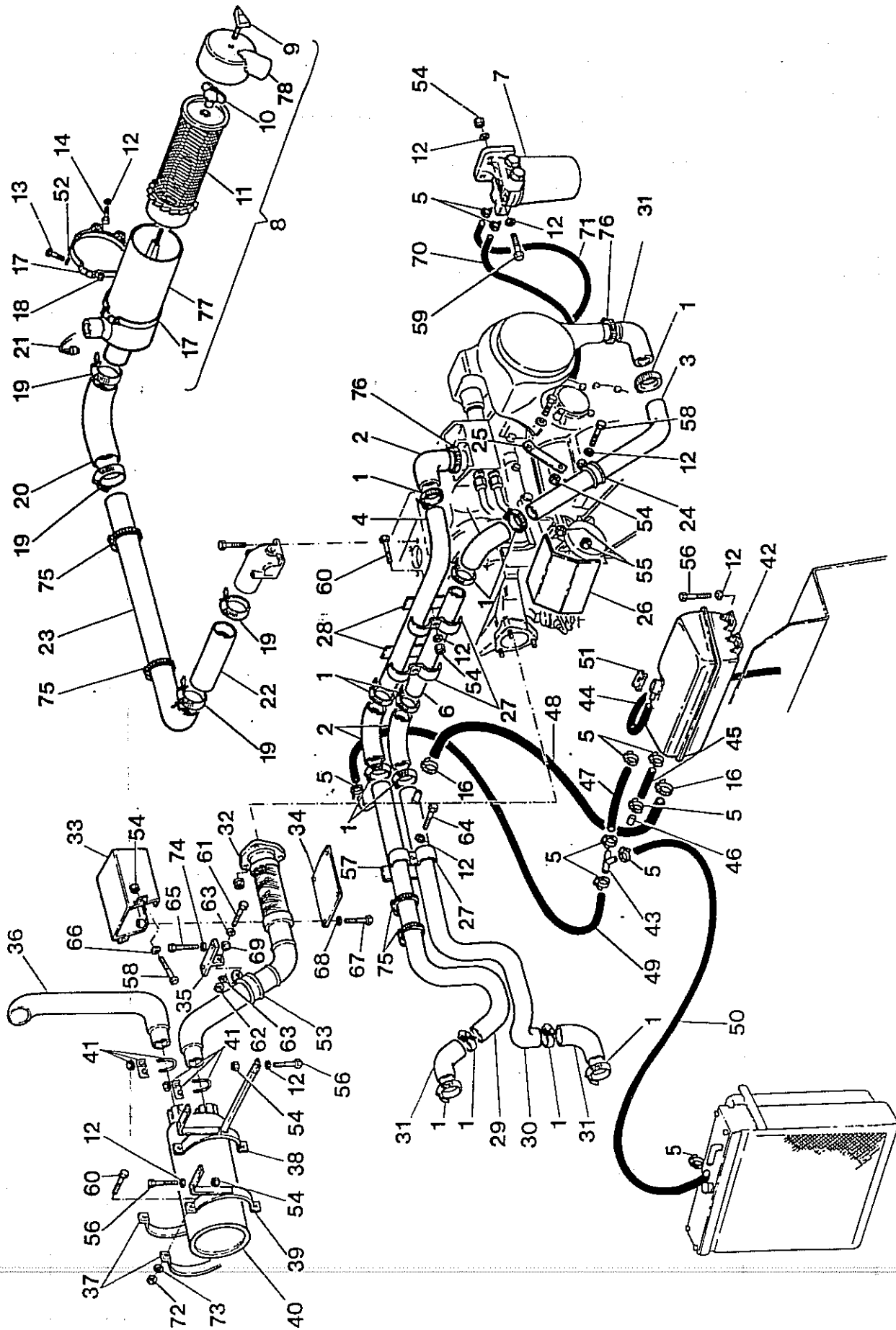

1/3	ENGINE AND POWER SHIFT COOLING SYSTEM, AIR FILTER AND EXHAUST RAFFREDDAMENTO MOTORE E CAMBIO, SCARICO FILTRO ARIA REFROIDISSEMENT DU MOTEUR ET POWER SHIFT, POT D'ECHAPPEMENT ET FILTRE AIR		2		
			Qty - Q.te Quantità		
Ref. Rif. Rep.	Part Number	Description Descrizione Designation	MVT 930		
1	479 159	Clamp - Fascetta - Collier	12		
2	488 359	Hose - Manicotto - Durite	4		
3	499254	Pipes - Tubo - Tuyaux	1		
4	499 256	Pipes - Tubi - Tuyaux	1		
5	487909	Clamp - Fascetta - Collier	12		
6	499 255	Pipes - Tubi - Tuyaux	1		
7	473559	Fuel prefilter - Prefiltro - Prefiltre	1		
8	499350	Complete air filter - Filtro aria completo - Filtre air complet	1		
9	499939	Screw - Vite - Vis	1		
10	499936	Wing nut - Dado ad alette - Erou à papillon	1		
11	499935	Filter cartridge - Cartuccia - Cartouche	1		
12	471360	Wascher - Rondella - Rondelle	20		
13	478639	Screw - Vite - Vis	2		
14	470388	Screw - Vite (TE M8X16) - Vis	4		
16	479093	Clamp - Fascetta - Collier	2		
17	499937	Clamp - Collare - Collier	2		
18	471 402	Nut - Dado - Erou	2		
19	448041	Clamp - Fascetta - Collier	4		
20	488009	Hose - Manicotto - Durit	1		
21	499 941	Indicator - Indicatore - Jauge	1		
22	499257	Pipes - Tubi - Tuyaux	1		
23	499258	Pipes - Tubi - Tuyaux	1		
24	488253	Clamp - Fascetta - Collier	1		
25	499259	Flask - Staffa - Bride	1		
26	487796	Casing - Carter - Carter	1		
27	486115	Flask - Staffa - Bride	3		
28	487823	Plate - Piatto - Plat	2		
29	499261	hose - Tubo - Tuyau	1		
30	499260	Hose - Tubo - Tuyau	1		
31	485627	Hose - Manicotto - Durit	3		

2/3	ENGINE AND POWER SHIFT COOLING SYSTEM,AIR FILTER AND EXHAUST RAFFREDDAMENTO MOTORE E CAMBIO,SCARICO FILTRO ARIA REFROIDISSEMENT DU MOTEUR ET POWER SHIFT,POT D'ECHAPPEMENT ET FILTRE AIR			2	
				Qty - Q.te Quantità	
Ref. Rif. Rep.	Part Number	Description Descrizione Designation	MVT 930		
32	488275	Pipe - Tubi - Tuyau	1		
33	488269	Casing - Carter - Carter	1		
34	488 262	Casing - lamiera - Tole	1		
35	488461	Flask - Staffa - Bride	1		
36	488282	Pipe - Tubo - Tuyau	1		
37	486109	Clamp - Collare - Collier	2		
38	488305	Clamp - Collare - Collier	1		
39	488300	Clamp - Collare - Collier	1		
40	79305	Muffler - Marmitta - Pot d'echappement	1		
41	485831	Clamp - Fascetta - Collier	2		
42	488334	Tank - Serbatoio - Reservoir	1		
43	499263	Connector - Raccordo - Raccord	1		
44	488361	Pipe - Tubi - Tuyau	1		
45	499252	Pipe - Tubo - Tuyau	1		
46	499253	Plug - Tappo - Bouchon	1		
47	488364	Pipe - Tubi - Tuyau	1		
48	488362	Pipe - Tubo - Tuyau	1		
49	488363	Pipe - Tubo - Tuyau	1		
50	488360	Pipe - Tubo - Tuyau	1		
51	499265	Plug - Tappo - Bouchon	1		
52	455018	Washer - Rondella - Rondelle	2		
53	470096	Clamp - Fascetta - Collier	1		
54	471320	Nut - Dado - Erou (M8)	15		
55	479803	Nut - Dado - Erou (M5)	2		
56	448677	Screw - Vite - Vis (TE M8X20)	6		
57	499264	Plate - Piatto - Plat	1		
58	455271	Screw - Vite - Vis (TE M8X25)	4		
59	471363	Screw - Vite - Vis (TE M8X30)	2		
60	482869	Screw - Vite - Vis (TE M8X60)	6		
61	484671	Screw - Vite - Vis (TE M10X50)	1		
62	471325	Nut - Dado - Erou (ES.M10)	1		

3/3		ENGINE AND POWER SHIFT COOLING SYSTEM,AIR FILTER AND EXHAUST RAFFREDDAMENTO MOTORE E CAMBIO, SCARICO FILTRO ARIA REFROIDISSEMENT DU MOTEUR ET POWER SHIFT, POT D'ECHAPPEMENT ET FILTRE AIR	2	
Ref. Rif. Rep.	Part Number	Description Descrizione Designation	MVT 930	Qty.- Q.té Quantità
63	448291	Washer - Rondella - Rondelle (EL 10)	1	
64	471358	Screw - Vite - Vis (TE M8X70)	1	
65	471336	Screw - Vite - Vis (TE M10X30)	2	
66	484100	Washer - Rondella - Rondelle	2	
67	455019	Screw - Vite - Vis (TE M6X15)	4	
68	455018	Washer - Rondella - Rondelle (P.Ø6)	4	
69	455820	Nut - Dado Autobloc - Erou (M10)	2	
70	499291	Pipe - Tubo - Tuyau	1	
71	485935	Pipe - Tubo - Tuyau	1	
72	455185	Nut - Dado - Erou (ES.M8)	4	
73	448285	Nut - Dado - Erou (EL.M8)	4	
74	471326	Washer - Rondella - Rondelle (P.10)	2	
75	448302	Clamp - Fascetta - Collier	10	
76	499 833	Clamp - Fascetta - Collier	2	
78	499 938	Cap - Coperchio - Couvercle	1	

A PARTIRE DALLA MACCHINA  
A PARTIR DE LA MACHINE  
FROM MACHINE

➔ N° 4928 - 101577

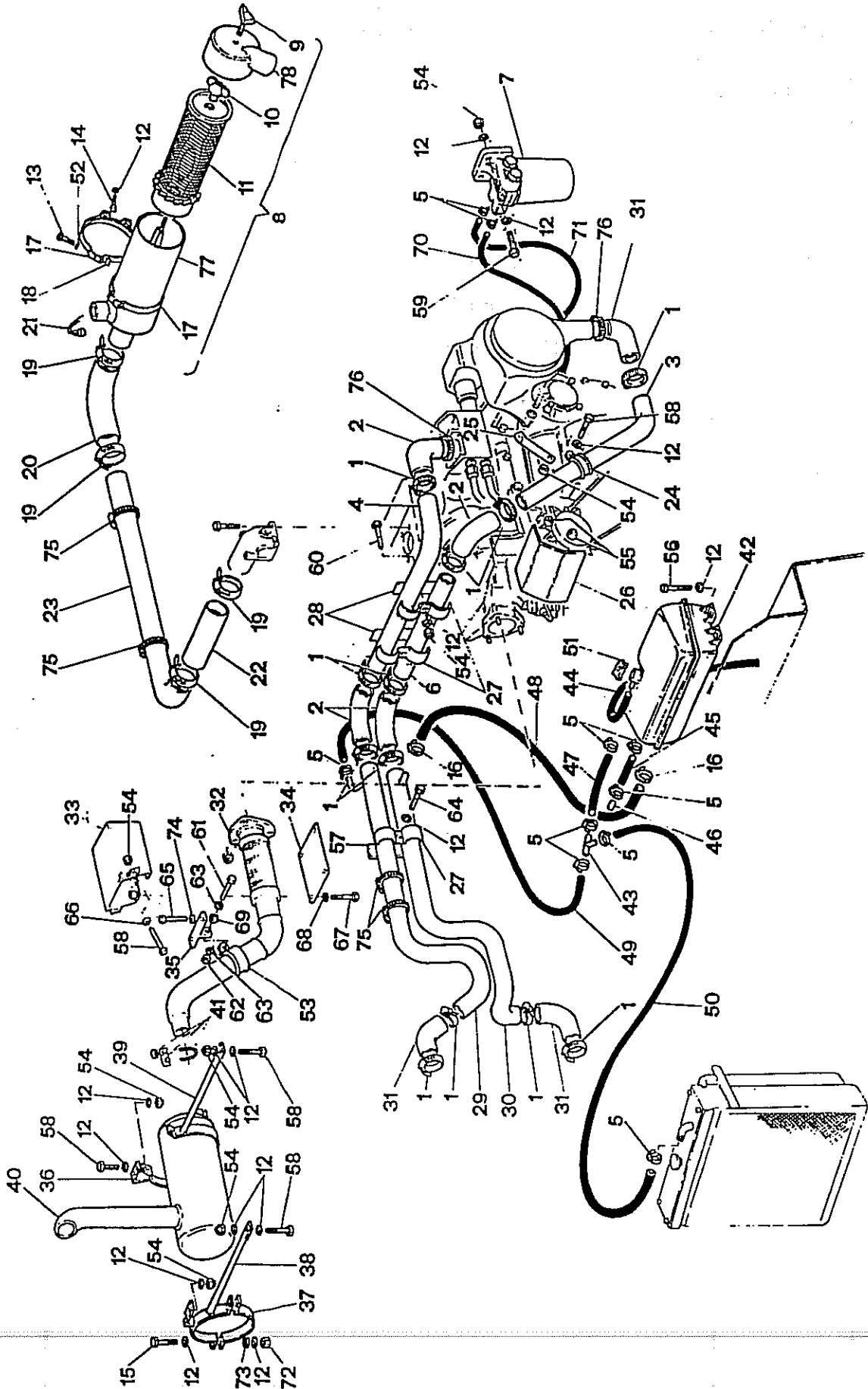

1/3	ENGINE AND POWER SHIFT COOLING SYSTEM, AIR FILTER AND EXHAUST RAFFREDDAMENTO MOTORE E CAMBIO, SCARICO FILTRO ARIA REFROIDISSEMENT DU MOTEUR ET POWER SHIFT, POT D'ECHAPPEMENT ET FILTRE AIR			2/A	
	Ref. Rif. Rep.	Part Number	Description Descrizione Designation	MVT:980	Qty - Q.te Quantità
1	479 159	Clamp - Fascetta - Collier	12		
2	488 359	Hose - Manicotto - Durite	4		
3	499254	Pipes - Tubo - Tuyaux	1		
4	499 256	Pipes - Tubi - Tuyaux	1		
5	487909	Clamp - Fascetta - Collier	12		
6	499 255	Pipes - Tubi - Tuyaux	1		
7	473559	Fuel prefilter - Prefiltro - Prefiltre	1		
8	499350	Complete air filter - Filtro aria completo - Filtre air complet	1		
9	499939	Screw - Vite - Vis	1		
10	499936	Wing nut - Dado ad alette - Ecrou à papillon	1		
11	499935	Filter cartridge - Cartuccia - Cartouche	1		
12	471360	Wascher - Rondella - Rondelle	20		
13	478639	Screw - Vite - Vis	2		
14	470388	Screw - Vite (TE M8X16) - Vis	4		
15	482869	Screw Vite (TE M8X60) Vis	4		
16	479093	Clamp - Fascetta - Collier	2		
17	499937	Clamp - Collare - Collier	2		
18	471 402	Nut - Dado - Ecrou	2		
19	448041	Clamp - Fascetta - Collier	4		
20	488009	Hose - Manicotto - Durit	1		
21	499 941	Indicator - Indicatore - Jauge	1		
22	499257	Pipes - Tubi - Tuyaux	1		
23	499258	Pipes - Tubi - Tuyaux	1		
24	488253	Clamp - Fascetta - Collier	1		
25	499259	Flask - Staffa - Bride	1		
26	487796	Casing - Carter - Carter	1		
27	486115	Flask - Staffa - Bride	3		
28	487823	Plate - Piatto - Plat	2		
29	499261	hose - Tubo - Tuyau	1		
30	499260	Hose - Tubo - Tuyau	1		
31	485627	Hose - Manicotto - Durit	3		

2/3		ENGINE AND POWER SHIFT COOLING SYSTEM, AIR FILTER AND EXHAUST RAFFREDDAMENTO MOTORE E CAMBIO, SCARICO FILTRO ARIA REFROIDISSEMENT DU MOTEUR ET POWER SHIFT, POT D'ECHAPPEMENT ET FILTRE AIR	2/A		
			Qty - Q.te Quantità		
Ref. Rif. Rep.	Part Number	Description Descrizione Designation	MVT 930		
32	488275	Pipe - Tubi - Tuyau	1		
33	488296	Casing - Carter - Carter	1		
34	499262	Casing - Lamiera - Tole	1		
35	488461	Flask - Staffa - Bride	1		
36	508789	Clamp Collare Collier	1		
37	508791	Clamp - Collare - Collier	2		
38	508792	Clamp - Collare - Collier	1		
39	508790	Clamp - Collare - Collier	1		
40	505112	Muffler - Marmitta - Pot d'echappement	1		
41	485831	Clamp - Fascetta - Collier	2		
42	488334	Tank - Serbatoio - Reservoir	1		
43	499263	Connector - Raccordo - Raccord	1		
44	488361	Pipe - Tubi - Tuyau	1		
45	499252	Pipe - Tubo - Tuyau	1		
46	499253	Plug - Tappo - Bouchon	1		
47	488364	Pipe - Tubi - Tuyau	1		
48	488362	Pipe - Tubo - Tuyau	1		
49	488363	Pipe - Tubo - Tuyau	1		
50	488360	Pipe - Tubo - Tuyau	1		
51	499265	Plug - Tappo - Bouchon	1		
52	455018	Washer - Rondella - Rondelle	2		
53	470096	Clamp - Fascetta - Collier	1		
54	471320	Nut - Dado - Ecrou (M8)	15		
55	479803	Nut - Dado - Ecrou (M5)	2		
56	448677	Screw - Vite - Vis (TE M8X20)	6		
57	499264	Plate - Piatto - Plat	1		
58	455271	Screw - Vite - Vis (TE M8X25)	4		
59	471363	Screw - Vite - Vis (TE M8X30)	2		
60	482869	Screw - Vite - Vis (TE M8X60)	6		
61	484671	Screw - Vite - Vis (TE M10X50)	1		
62	471325	Nut - Dado - Ecrou (ES.M10)	1		



3/3	ENGINE AND POWER SHIFT COOLING SYSTEM, AIR FILTER AND EXHAUST RAFFREDDAMENTO MOTORE E CAMBIO, SCARICO FILTRO ARIA REFROIDISSEMENT DU MOTEUR ET POWER SHIFT, POT D'ECHAPPEMENT ET FILTRE AIR			2/A	
	Ref. Rif. Rep.	Part Number	Description Descrizione Designation	Qty - Q.te Quantità	
				MVT 930	
63	448291	Washer - Rondella - Rondelle (EL 10)	1		
64	471358	Screw - Vite - Vis (TE M8X70)	1		
65	471336	Screw - Vite - Vis (TE M10X30)	2		
66	484100	Washer - Rondella - Rondelle	2		
67	455019	Screw - Vite - Vis (TE M6X15)	4		
68	455018	Washer - Rondella - Rondelle (P.ϕ6)	4		
69	455820	Nut - Dado Autobloc - Ecrou (M10)	2		
70	499291	Pipe - Tubo - Tuyau	1		
71	485935	Pipe - Tubo - Tuyau	1		
72	455185	Nut - Dado - Ecrou (ES.M8)	4		
73	448285	Nut - Dado - Ecrou (EL.M8)	4		
74	471326	Washer - Rondella - Rondelle (P.10)	2		
75	448302	Clamp - Fascetta - Collier	10		
76	499 833	Clamp - Fascetta - Collier	2		
78	499 938	Cap - Coperchio - Couvercle	1		

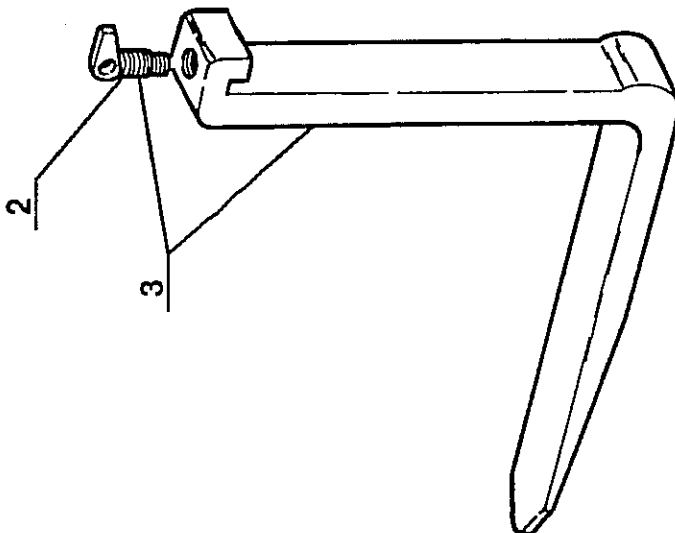
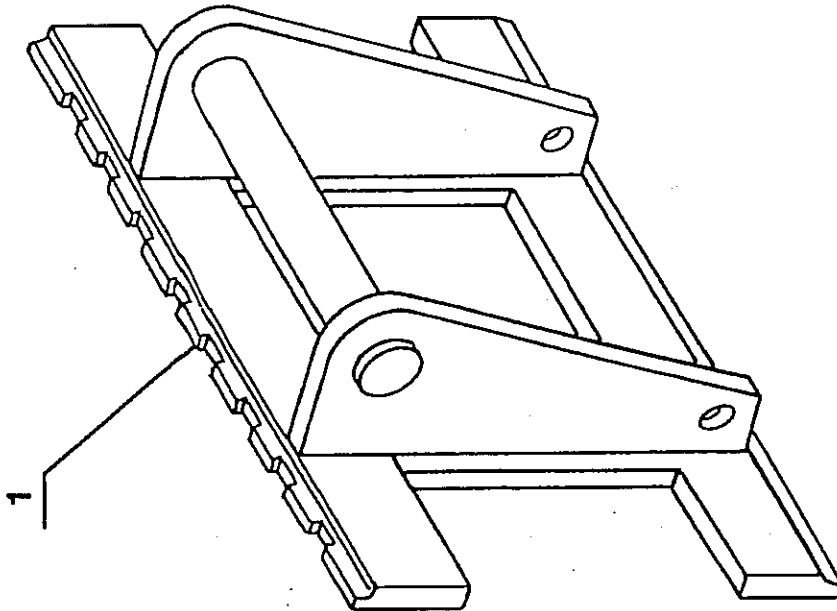

1/1	FORK CARRIAGE PORTAFORCHE TABLIER		3		
			Qty - Q.te Quantità		
Ref. Rif. Rep.	Part Number	Description Descrizione Designation	MVT-930		
1	487 753	Fork carriage - Portaforche - Tablier	1		
2	455 081	Fork pin - Blocco - Pivot de blocage	2		
3	487 486	Fork - Forca - Fourche	2		

4

FINO ALLA MACCHINA  
JUSQU'A LA MACHINE  
UP TO MACHINE

→ N° 4650 - 97635

MVT 930

