

LG956L轮式装载机 零部件图册

LG956L WHEEL LOADER PARTS CATALOG

山东临工工程机械有限公司

SHANDONG LINGONG CONSTRUCTION MACHINERY CO.,LTD.

配件与服务 Spare parts and services

对于山东临工机器的所有者来说,只有山东临工配件和服务才能够使您的机器更好地保持原有的特性。

For the owner of the machines of SDLG,only the space parts and services of SDLG can mark your machine to better maintain the original features.

只有山东临工才能够为您提供完美匹配且优质纯正的配件和对您的机器了如指掌的专业维修人员。这样才能保证及其可持续的高产能和更长的使用寿命。

Only SDLG is able to provide you with the perfect match of pure quality spare parts for your machine and knowledge of professional maintenance staff.Only in this way it can ensure sustainable high productivity and longer service life.

LG956L轮式装载机 零部件图册 LG956L WHEEL LOADER PARTS CATALOG

2009年12月 第1版 第1次印刷

2009-12 Version 1 Printed 1

山 东 临 工 程 机 械 有 限 公 司
SHANDONG LINGONG CONSTRUCTION MACHINERY CO.,LTD.

地址: 中国·临沂经济开发区临工工业园

Add: Lingong Industry Park,Linyi Economic Development Zone,Shandong,china

电话: 86-0539-8785668

Tel: 86-0539-8785624/86-0531-66590955

传真: 86-0539-8785698

Fax: 86-0539-8785618/86-0531-66590959

技术服务: 86-0539-8785800 400-6587999

Web: www.sdlg.cn

前言

LG956L轮式装载机零部件图册，是为了方便用户使用、维修和保养而绘制的，以供在使用过程中查阅及参考，也可帮助用户了解本机的结构和装配关系。发动机的零部件详见其随机资料，本图册不再绘出。

本图册按系统划分绘制出了各零部件的图形及相互装配关系。凡装机后不可拆卸的部件（如焊接件、铆合件），只标出部件代号，不另列其组成零件。本图册明细表采用中英文对照编排。

本图册主要根据标准型产品(订货号E5613115A39)编绘，其它非标准配置，可参照执行，详情请咨询山东临工、或当地经销商、或登录山东临工网站查询。随着科技的进步，产品将会不断改进，故本图册的内容可能会有部分与以后的产品不一致，恕不另行通知。敬请用户在订购配件时，指明所购整车的出厂日期和编号。

编者

2009年12月

FOREWORD

THIS PARTS LIST OF LG956L WHEEL LOADER IS MADE FOR THE CONVENIENCE OF USERS TO USE , REPAIR AND MAINTAIN THE MACHINE, AND IT CAN BE REFERED IN THE PROCESS OF USING. IT CAN ALSO HELP THE USERS TO BE FAMILIAR WITH THE CONSTRUCTION AND ASSEMBLY RELATION OF THE MACHINE. THE PART OF THE ENGINE IS SHOWED IN DETAIL IN ITS STRUCTION HANDBOOK. SO THIS CATALOG DOES NOT CONTAIN THE ENGING PART LIST.

THE CATALOG CONTAINS THE PART DRAWINGS OF DEFERENT ASSEMBLIES, SHOWING THE SHAPE OF THE PARTS AS WELL AS THE ASSEMBLING RELATION. THE COMPONENTS WHICH CAN NOT BE TAKEN APART (SUCH AS THE WELDMENT OR RIVETED ASSEMBLIES) ARE INDICATED ONLY BY THEIR COMPONET NUMBERS WITHOUT THE CONSISTING PART NUMBERS . THE LIST IN THE CATALOG IS ARRANGED BY CHINESE VERSUS ENGLISH.

THIS CATALOG IS MAINLY BASED ON THE STANDARD PRODUCT (ORDER NUMBER E5613115A39) THE OTHERS OF NONSTANDARD PRODUCT CAN REFER THE STANDARD PRODUCT, AND THE DETAILED INFORMATION CAN BE KNOWN FROM SHANDONG LINGONG, THE LOACAL DEALER OR LINGONG WEBSITE ALTERATIONS IN DESIGN ARE NECESSARILY WITH THE THECHNICAL DEVELOPMENT SO SOME CONTENT IN THE CATALOG PROBABLY IS NOT CONSISTANT WITH THE FUTURE PRODUCTS, AND THIS WILL NOT NOTICE USERS. THEREFORE WHEN ORDERING SPARE PARTS, USERS ARE KINDLY REQUSETED TO INFORM US THE MANUFACTURING DATE AND BATCHNUMBER OF THE WHEEL LOADER.

THE COMPILER

2009. 12

目录 CONTENTS

A. 发动机系统

A. DIESEL ENGINE SYSTEM

发动机总成	A1-2901001442
DIESEL ENGINE ASSEMBLY	A1-2901001442
燃油箱总成	A2-2902000845
FUEL TANK ASSEMBLY	A2-2902000845
散热器总成	A3-2903000966
RADIATOR ASSEMBLY	A3-2903000966
油门操纵机构	A4-2901000752
GOVERNOR CONTROL SYSTEM	A4-2901000752
发动机	A5-4110000186
DIESEL ENGINE	A5-4110000186

B. 变矩器系统

B. TORQUE CONVERTER SYSTEM

变矩器总成	B1-2904000777
TORQUE CONVERTER ASSEMBLY	B1-2904000777
液力变矩器YJSW315-6C(370804)	B2-4110000011
TORQUE CONVERTER YJSW315-6C(370804)	B2-4110000011
滤清器QF60M33G-1 (410708)	B4-4110000507
CLEANER QF60M33G-1 (410708)	B4-4110000507

C. 变速箱系统

C. TRANSMISSION SYSTEM

变速箱总成	C1-2905001263
TRANSMISSION ASSEMBLE	C1-2905001263
A305变速箱总成	C2-2905001219
A305 TRANSMISSION ASSEMBLE	C2-2905001219
三轴总成	C3-2030900027
3RD SHAFT ASS'Y	C3-2030900027
四轴总成（ I ）	C4-2030900026
4TH SHAFT ASS'Y（ I ）	C4-2030900026
四轴总成（ II ）	C6-2030900019
4TH SHAFT ASS'Y（ II ）	C6-2030900019
输出轴总成	C7-2905001219
OUTPUT SHAFT ASS'Y	C7-2905001219

D. 变速操纵系统

D. TRANSMISSION CONTROL SYSTEM

变速操纵系统	D1-2906000896
TRANSMISSION CONTROL SYSTEM	D1-2906000896
变速操纵机构LG956L	D2-4110000659
LG953 TRANSMISSION CONTROL SHAFT	D2-4110000659

变速操纵阀LG03-BSF(350802)	D3-4120000064
TRANSMISSION CONTROL LG03-BSF VALVE(350802)	D3-4120000064

E. 驱动桥系统

E. AXLE SYSTEM

前桥总成	E1-2907001203
FRONT AXLE ASSEMBLY	E1-2907001203
前主传动总成	E2-2907001108
FRONT MAIN DRIVE	E2-2907001108
轮边减速器(前桥)	E3-2907001091
FINAL DRIVE ASSEMBLY	E3-2907001091
传动轴总成	E4-2908000795
DRIVE SHAFT GROUP	E4-2908000795
后桥总成	E5-2909000809
REAR AXLE ASSEMBLY	E5-2909000809
后主传动总成	E6-2909000811
REAR AXLE MAIN DRIVE ASS'Y	E6-2909000811
轮边减速器(后桥)	E7-2907000108
FINAL DRIVE ASSEMBLY (REAR AXLE)	E7-2907000108
制动钳(371328)	E8-4120001739
DISK BRAKE(371328)	E8-4120001739

轮胎GB2980-23.5-25 (520101)	E11-4110000006
TIRE GB2980-23.5-25 (520101)	E11-4110000006
轮胎 23.5-25-18PR-L3 (371002)	E12-4110000582
TIRE 23.5-25-18PR-L3	E12-4110000582

F. 工作装置液压系统

F. IMPLEMENT HYDRAULIC SYSTEM

液压操纵总成	F1-2912001714
HYDRAULIC CONTROL ASSEMBLY	F1-2912001714
工作泵总成	F2-2911000881
WORKING PUMP ASSEMBLY	F2-2911000881
举升缸总成	F3-2913001205
LIFTING CYLINDER ASSEMBLY	F3-2913001205
转斗缸总成	F4-2914001017
DUMP CYLINDER ASSEMBLY	F4-2914001017
液压油箱总成	F5-2910001003
HYDRAULIC TANK ASSEMBLY	F5-2910001003
转斗油缸 (371368)	F7-4120002264
TILT CYLINDER	F7-4120002264
动臂油缸 (371368)	F9-4120002263
LIFT ARM CYLINDER	F9-4120002263

H. 工作装置

H. WORKING EQUIPMENT

工作装置	H1-2915001046
WORKING EQUIPMENT	H1-2915001046
铲斗总成	H2-2917003706
BUCKET ASSEMBLY	H2-2917003706

I. 转向系统

I. STEERING SYSTEM

转向泵总成	I1-2919000888
STEERING PUMP ASSEMBLY	I1-2919000888
转向器总成	I2-2920000831
STEERING GEAR ASSEMBLY	I2-2920000831
转向缸总成	I3-2921000862
STEERING CYLINDER ASSEMBLY	I3-2921000862
转向油缸(371368)	I5-4120000553
STEERING CYLINDER	I5-4120000553

J. 制动系统

J. BRAKE SYSTEM

行车制动系统	J1-2922000913
SERVICE BRAKE SYSTEM	J1-2922000913

储气罐	J2-2922000053
AIR RESERVOIR	J2-2922000053
加力泵(340201)	J3-4120000675
BRAKE BOOSTER	J3-4120000675
驻车制动总成	J4-2923000001
PARKING BRAKE SYSTEM	J4-2923000001
手制动器 (371322)	J8-4120000087
HAND BRAKE (371322)	J8-4120000087

K. 车架

K. FRAME

前车架及其附件	K1-2924001159
FRONT FRAME AND ACCESSORIES	K1-2924001159
铰接	K2-2925000001
ARTICULATION	K2-2925000001
灯架及挡泥瓦	K3-2925000850
LAMP FRAME AND FRONT FENDER	K3-2925000850
后车架及其附件	K4-2926001341
REAR FRAME AND ACCESSORIES	K4-2926001341
配重铁总成	K5-2928000819
COUNTER WEIGHT	K5-2928000819

L. 驾驶室

L. CAB GROUP

驾驶室总成	L1-2929000881
CAB ASSEMBLY	L1-2929000881
驾驶室	L2-2929000916
CAB	L2-2929000916
操作台架	L3-2931001426
OPERATE BENCH	L3-2931001426
座椅总成	L4-2930000772
SEAT ASSEMBLY	L4-2930000772
操纵箱	L5-2932000957
OPERATE BOX	L5-2932000957

M. 覆盖件系统

M. CONVER SYSTEM

发动机罩总成	M1-2933001510
HOOD OF DIESEL ENGINE ASSEMBLY	M1-2933001510
左台架总成	M2-2934001541
LEFT BENCH GROUP	M2-2934001541
右台架总成	M3-2934001556
RIGHT BENCH GROUP	M3-2934001556

后转向灯罩	M4-2934001568
REAR STEERING LAMP HOOD	M4-2934001568
标志与标识	M5-2936001200
SIGN AND LOGO	M5-2936001200
电瓶箱	M6-2934001572
BATTERY CASE	M6-2934001572
工具箱	M7-2934001581
TOOL CASE	M7-2934001581
N. 空调系统	
N. AIR CONDITIONER SYSTEM	
暖风机	N1-2935000888
WARMING MACHINE	N1-2935000888
空调系统	N2-2935000894
AIR CONDITIONER SYSTEM	N2-2935000894
暖风机	N3-4190000917
WARMING MACHING	N3-4190000917
O. 电气系统	
O. ELECTRIC SYSTEM	
电气系统	O1-2937001520
ELECTRIC SYSTEM	O1-2937001520

仪表盘总成	O2-2937001535
PANEL ASSEMBLY	O2-2937001535
仪表台总成	O3-2937001468
INSTRUMENT DESK	O3-2937001468





A 发动机系统
DIESEL ENGINE SYSTEM

山东临工工程机械有限公司
SHANDONG LINGONG CONSTRUCTION MACHINERY CO.,LTD.

发动机总成 DIESEL ENGINE ASSEMBLY

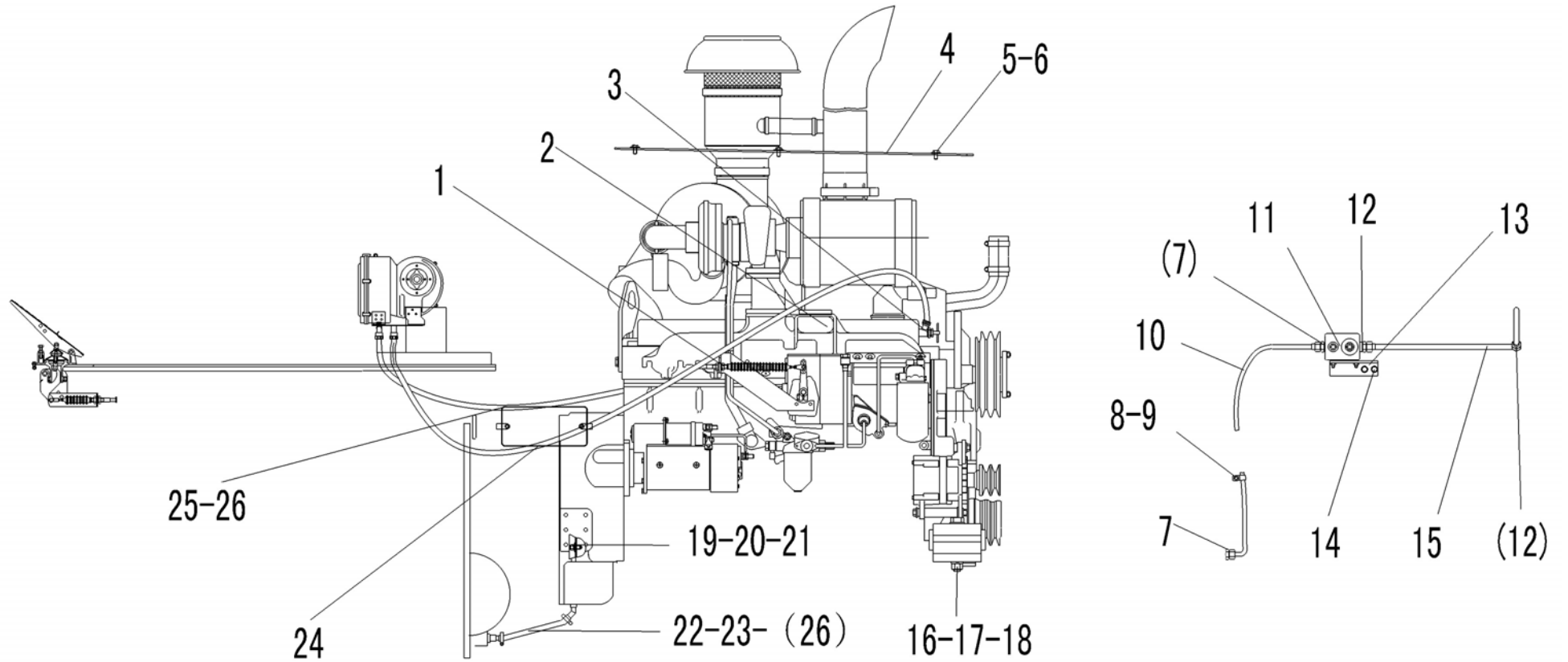

序号 Key	零件代号 Part No.	名称 Description	是否配件 Spare parts Y/N	数量 Qty	备注 Remarks
1	29010007521	油门操纵机构	N	1	
2	4110000186	发动机总成C6121ZG50(C6ZG50f)	Y	1	
3	4120000067	暖风机水阀LG12-NFJSF	Y	2	
4	29010014441	上盖板	Y	1	
5	4011000081	螺栓GB5783-M10*20EpZn-8.8	N	7	
6	4015000197	垫圈GB96.1-10EpZn-300HV	N	7	
7	29220001191	直接头	Y	2	
8	29010000031	管夹	Y	1	
9	4011000461	螺栓GB16674-M8*16EpZn-8.8	N	2	
10	4041001031	软管LGB145-205263	Y	1	
11	4120000084	油水分离器组合阀ST-50G	Y	1	
12	29010000051	垫圈	Y	2	
13	29010009241	支撑板	Y	1	
14	4011000488	螺栓GB16674-M10*16EpZn-8.8	N	2	
15	4120000750	金属软管	Y	1	
16	4011000387	螺栓GB5782-M24*130EpZn-8.8	N	2	
17	4013000021	螺母GB6170-M24EpZn-8	N	2	
18	4015000167	垫圈GB97.1-24EpZn-300HV	N	2	

发动机总成 DIESEL ENGINE ASSEMBLY

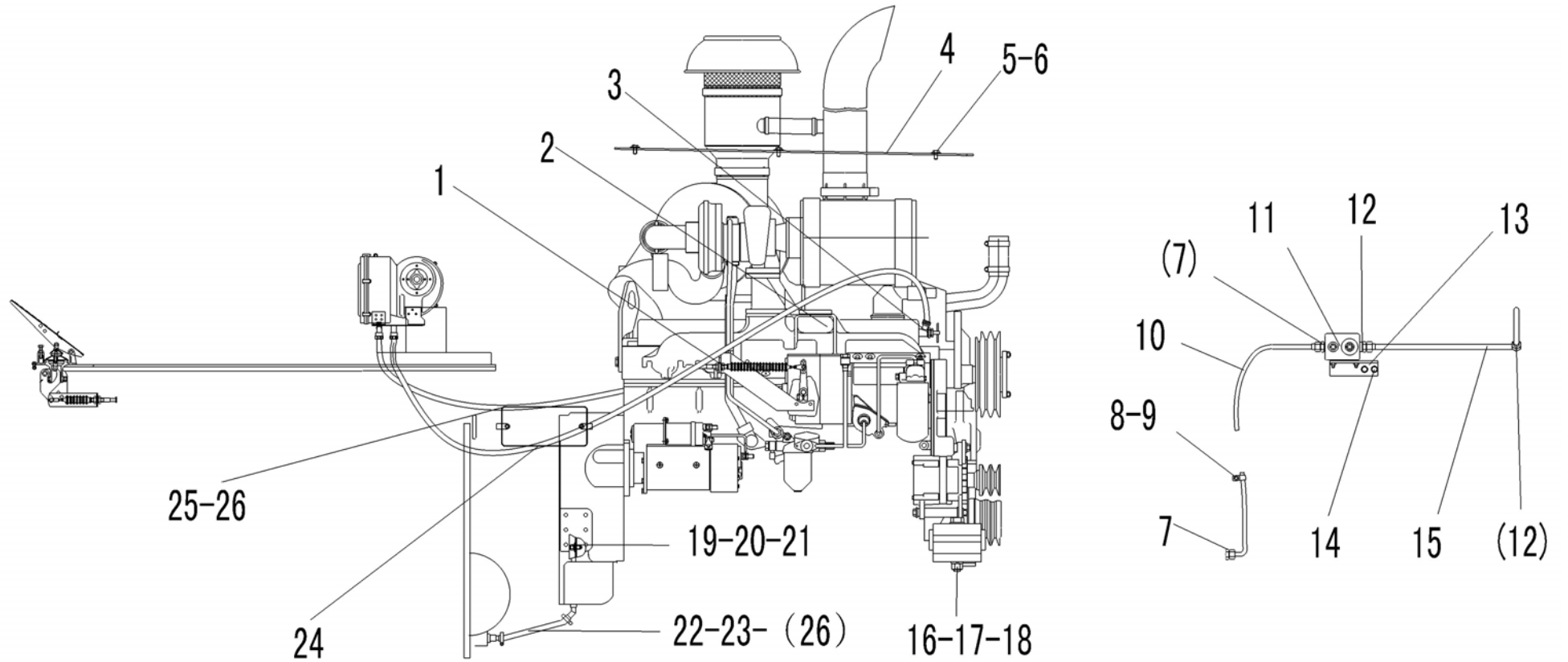

序号 Key	零件代号 Part No.	名称 Description	是否配件 Spare parts Y/N	数量 Qty	备注 Remarks
19	29010000111	双头螺柱	DOUBLE BOLT	Y	12
20	4013000007	螺母GB6170-M10EpZn-8	NUT GB6170-M10EpZn-8	N	12
21	4015000025	垫圈GB93-10-65Mn	WASHER GB93-10-65Mn	N	12
22	4030000581	胶管JB8406-B16*340	HOSE	Y	1
23	29010008691	回油接头	FITTING OIL RETURN	Y	1
24	4120000049	胶管JB8406-B16*2600	RUBBER TUBE JB8406-B16X2600	Y	1
25	4120000136	胶管JB8406-B16*2900	HOSE JB8406-B16*2900	Y	1
26	4017000024	环箍QC390-D26	CLAMP QC390-D26	N	6



燃油箱总成 FUEL TANK ASSEMBLY

