

Kubota

V3800DI-T

Engine

Form No.
917328

Revision A
05/08

(P/N 196110)

Gehl CTL85

Mustang MTL325

Track Loaders



ENGINE PARTS MANUAL

Introduction

This manual covers the Kubota V3800DI-T engine (P/N 196110), used in Gehl CTL85 - Mustang MTL325 track loaders.

When ordering service parts, specify the correct part number, full description, quantity required, and the engine model number and serial number.

Items shown that do not have a part number are shown for reference purposes only and are not available for purchase. Part numbers may change. Your Gehl or Mustang dealer will have the latest part number.

Gehl® Company and the Mustang® Manufacturing Co., Inc., reserve the right to make changes or improvements in the design or construction of any part of the unit without incurring the obligation to install such changes on any previously delivered units.

CAUTION

For maximum engine life, when shutting the engine down, allow the engine to idle, without load, for five minutes. This will allow engine components that operate at high temperatures to cool slightly before the engine itself is shut down.

GEHL is a registered trademark of the Gehl Company.

MUSTANG is a registered trademark of the Mustang Manufacturing Co., Inc.

TABLE OF CONTENTS

DESCRIPTION	PAGE
<u>ENGINE SERVICE PARTS</u>	
Crankcase and Oil Pan	1
Dipstick and Guide, Cylinder Head	3
Inlet Valve and Exhaust Valve and Rocker Arm Shaft.	5
Head Cover and Gear Case	7
Oil Filter and Main Bearing Case.	9
Piston and Crankshaft.	11
Camshaft and Idle Gear Shaft, Flywheel	13
Injection Pump Unit	15
Injection Pump Housing and Injection Pump.	17
Fuel Pump Cover and Fuel Camshaft.	19
Governor.	21
Fork Lever (Governor).	23
Restriction Adjusting Bolt	25
Fuel Filter and Separator	27
Nozzle Holder and Glow Plug, Overflow Pipe	29
Alternator and Pulley, Alternator (Component Parts)	31
Starter and Starter (Component Parts)	33
Stop Solenoid and Oil Switch/Thermometer and Plug.	35
Water Flange and Thermostat, Water Pump and Pipe	37
Reserve Tank and Fan	39
Inlet and Exhaust Manifolds.	41
EGR Valve and EGR Cooler	43
Boost Air Pipe and Turbocharger.	45
Oil Pipe (Turbocharger) and Oil Pipe (Mechanical Timer)	47
Oil Cooler and Hydraulic Pump.	49
Accessories and Service Parts	51
Numerical Index	54

CRANKCASE AND OIL PAN

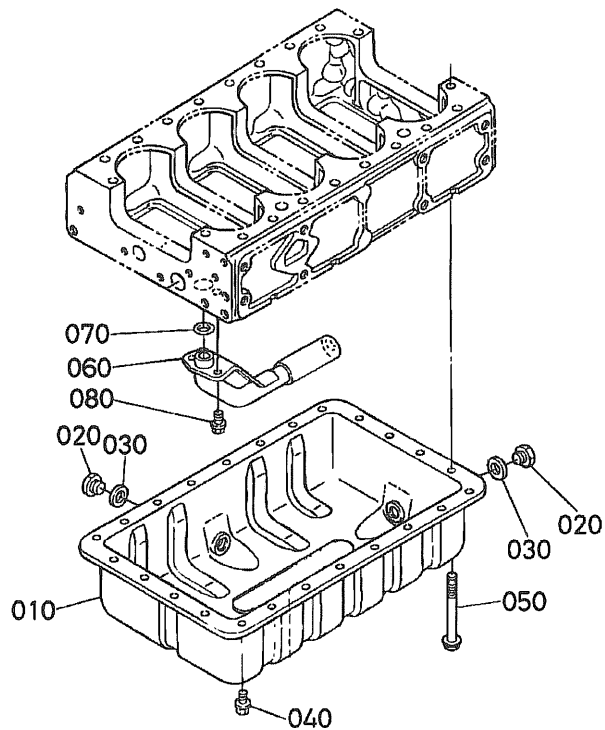
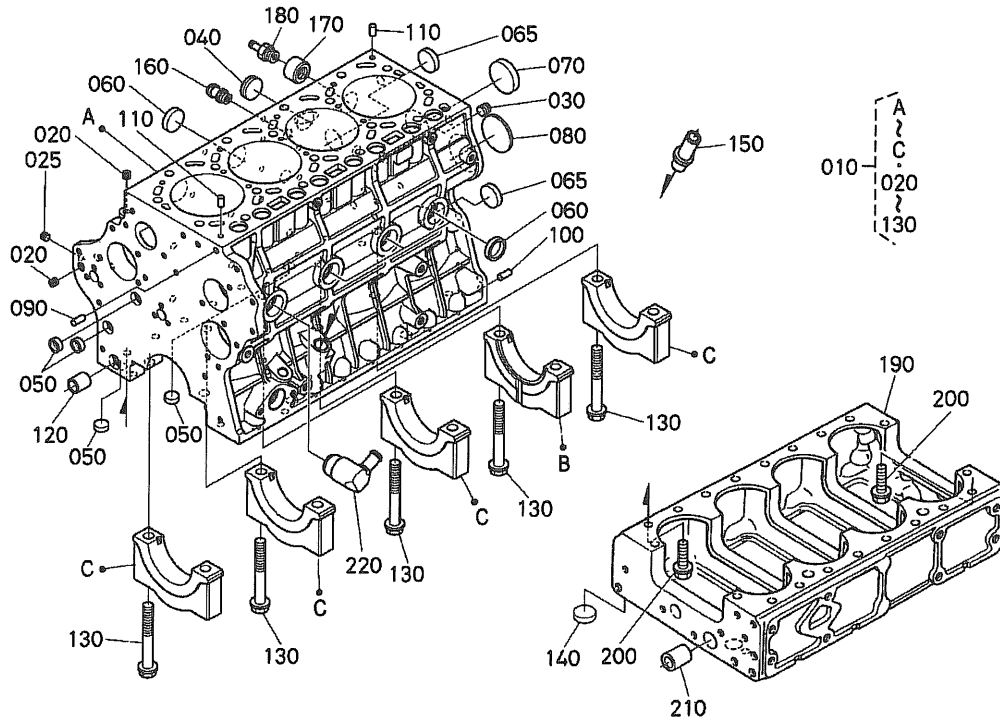

CRANKCASE AND OIL PAN

Ref. No.	Part No.	Description	Quantity V3800DI-T
10	K1J55001013	COMP.CRANKCASE	1
20	K1552196020	PLUG	2
25	K1584196020	PLUG	1
30	K1C01096010	PLUG	1
40	K1668396020	PLUG	1
50	K1526103370	CAP,SEALING	4
60	K1522103380	CAP,SEALING	5
65	K1522103380	CAP,SEALING	2
70	K1522103390	CAP,SEALING	1
80	K1C01096160	PLUG,EXPANSION	1
90	K0501200820	PIN,STRAIGHT	1
100	K0501201016	PIN,STRAIGHT	4
110	K1522133650	PIN,PIPE	2
120	K1C01033640	PIN,GEAR CASE	1
130	K1C01004560	BOLT,BEARING CASE	10
140	K1522103380	CAP,SEALING	1
150	K1C04033212	PIPE,OIL	1
160	K1C01037114	JOINT,WATER PIPE	1
170	K1J55071370	JOINT,PIPE	1
180	K1G37773170	PIPE JOINT,DRAIN	1
190	K1C01001126	CRANKCASE	1
200	K0177451030	BOLT,FLANGE	16
210	K1C01033650	PIN,GEAR CASE	1
220	K1J57471362	JOINT,PIPE	1

Ref. No.	Part No.	Description	Quantity V3800DI-T
10	K1C01001503	COMP.OIL_PAN	1
20	K1570733750	PLUG,DRAIN	2
30	K1626596670	GASKET	2
40	K1C01091100	BOLT,OIL_PAN	20
50	K0177451004	BOLT,FLANGE	4
60	K1C01032110	FILTER,OIL	1
70	K0481400220	O_RING	1
80	K0175450814	BOLT,FLANGE	2

DIPSTICK AND GUIDE, CYLINDER HEAD

