

PARTS BOOK



PC340LCD/ NLCD-7K

HYDRAULIC EXCAVATOR
HIGH REACH DEMOLITION MACHINE

MACHINE SERIAL NUMBER

K40575 and up

CONTENTS

PARTS LIST

ELECTRICAL SYSTEM

E0200-01A0 : TILT CAB MAIN HARNESS (HARNESS, CLIP)	6
E0200-02A0 : TILT CAB MAIN HARNESS (CLIP).....	8
E0200-03A0 : TILT CAB MAIN HARNESS (CLAMP)	10

MAIN/REVOLVING FRAME AND RELATED PARTS

J1110-01A0 : REVOLVING FRAME (TILT CAB)	14
J1110-02A0 : TILT FRAME (TILT CYLINDER AND PINS	16
J1110-03A0 : TILT FRAME (LUBRICATION PIPING)	18
J1110-04A0 : TILT FRAME (PIPING)	20
J1110-05A0 : PROXIMITY SWITCH	24

OPERATOR'S COMPARTMENT AND CONTROL SYSTEM

K0210-01A0 : OPERATOR'S CAB (FRONT WINDOW)	28
K0210-02A0 : OPERATOR'S CAB (ROOF WINDOW)	32
K0210-03A0 : OPERATOR'S CAB (DOOR LOCK)	34
K0210-04A0 : OPERATOR'S CAB (OPEN LOCK)	36
K0210-05A0 : OPERATOR'S CAB (ACCESSORIES)	38
K0210-06A0 : OPERATOR'S CAB (BLIND BOLT)	40
K0210-07A0 : OPERATOR'S CAB (ROOF WIPER)	42
K0210-08A0 : OPERATOR'S CAB (ROOF WIPER HOSE).....	44
K0210-09A0 : OPERATOR'S CAB (CONTROL PANEL)	46
K0220-01A0 : OPG GUARD.....	48
K0350-01A0 : WINDOW WASHER TANK G.	50
K1110-01A0 : FLOOR (FLOOR FRAME)(TILT CAB)	52

K1110-02A0 : FLOOR (CONTROL GROUP)(TILT CAB)	54
K1110-03A0 : FLOOR (A/C HOSE)(TILT CAB)	56
K1110-04A0 : FLOOR (HEATER HOSE)(TILT CAB)	58
K1110-05A0 : FLOOR (PPC)(TILT CAB)(1/2)	60
K1110-06A0 : FLOOR (PPC)(TILT CAB)(2/2)	62
K1110-07A0 : SAFETY VALVE LINE	64
K1110-08A0 : TILT CAB HYDRAULICS (A)	66
K1110-09A0 : TILT CAB HYDRAULICS (B)	70
K1110-10A0 : TILT CAB HYDRAULICS (C)	74

GUARD

M1120-01A0 : FRAME (MACHINE CAB)	78
M1210-01A0 : COVER (UPPER)(MACHINE CAB)	80
M1510-01A0 : COUNTER WEIGHT	82
M1810-01A0 : DEMO CAB UNDERCOVERS (L.H.)	84
M1810-02A0 : DEMO CAB UNDERCOVERS (R.H.)	86
M1810-03A0 : DEMO CAB SIDE GUARDS	88
M1810-04A0 : TILT CAB UNDERCOVERS (R.H.)	90
M1810-05A0 : TILT CAB UNDERCOVERS (L.H.)	92
M1810-06A0 : TILT CAB SIDE GUARDS	94
M1810-07A0 : TILT CAB COVERS (CAB)	96

UNDERCARRIAGE

R1000-01A0 : HYDRAULIC TRACK FRAME	100
R1000-02A0 : HYD. TRACK FRAME CONTROL PIPING	102

WORK EQUIPMENT

T1110-01A0 : 1ST, 2ND, 3RD BOOM PINS AND BUSHINGS	106
T1110-02A0 : 1ST BOOM LUBE PIPING	108
T1110-03A0 : 1ST BOOM PIPING	110

T1110-04A0 : 1ST BOOM PIPING CLAMPS	112
T1110-05A0 : 1ST BOOM QUICK CHANGE UNIT	116
T1110-06A0 : 1ST BOOM WORKLAMP	118
T1110-07A0 : 1ST BOOM ANGLE INDICATOR	120
T1110-08A0 : 2ND BOOM PIPING	122
T1110-09A0 : 3RD BOOM PIPING	124
T1110-10A0 : 1ST, 2ND, 3RD BOOM FASTER PIPING	128
T1110-11A0 : 1ST, 2ND, 3RD BOOM FASTER PIPE CLAMPS	132
T1110-12A0 : MID LINK PINS AND BUSHINGS	137
T1110-13A0 : DIG BOOM PIPING	139
T1120-01A0 : MID LINK CYLINDER DETAIL	143
T1140-01A0 : ARM CYLINDER DETAIL	147
T1210-01A0 : ARM PINS AND BUSHINGS	151
T1210-02A0 : MID LINK AND ARM PIPING	153
T1210-03A0 : MID LINK AND ARM PIPING CLAMPS	157
T1210-04A0 : MID LINK AND ARM CYLINDER S/V PIPING	159
T1210-05A0 : ARM 3.2M (DIG BOOM)	163
T1210-05A0 : ARM 2.5M (DIG BOOM)	165
T1220-01A0 : ATTACHMENT CYLINDER DETAIL	167
T1230-01A0 : LINK PINS AND BUSHINGS	169
X1000-01A0 : TRANSPORT PIN	171
X1000-02A0 : HIGH REACH WORK EQUIPMENT STANDS	173
X1000-03A0 : DIG BOOM STAND	175

**PC340LCD/NLCD-7K
HIGH REACH DEMOLITION
MACHINE PARTS LIST**

ELECTRICAL SYSTEM

E0200-01A0 : TILT CAB MAIN HARNESS (HARNESS, CLIP)

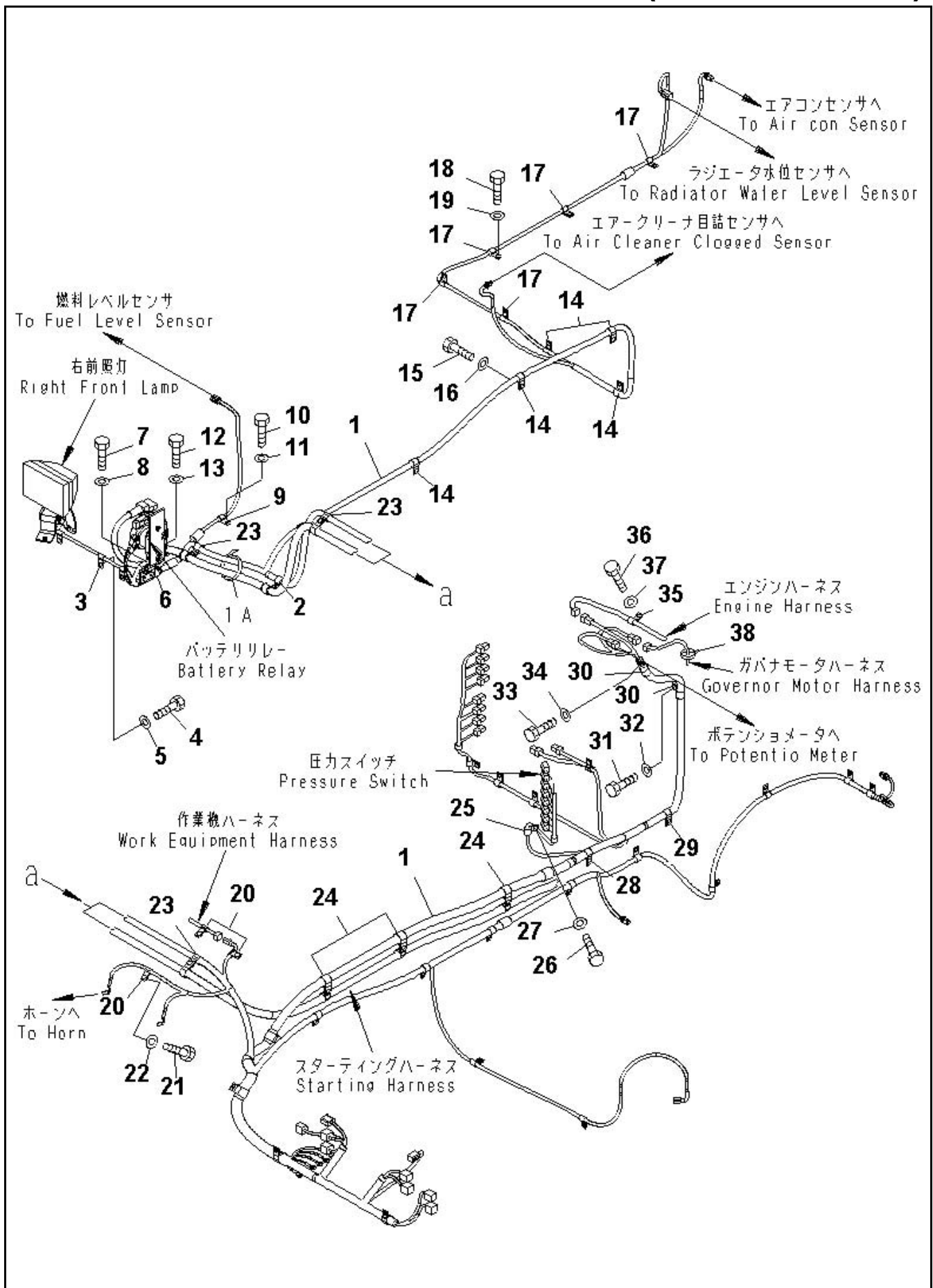

E0200-01A0 : TILT CAB MAIN HARNESS (HARNESS, CLIP)

Item	Part No.	Description	Qty	Options
1	207-06-KA460	WIRING HARNESS	1	
	22U-06-11270	• FUSIBLE LINK(65A)	1	
	20Y-06-31660	• FUSIBLE LINK (30A)	2	
2	04434-51912	CLIP	1	
3	04434-51012	CLIP	1	
4	01010-81225	BOLT	1	
5	01643-31232	WASHER	1	
6	04434-51912	CLIP	1	
7	01010-81225	BOLT	1	
8	01643-31232	WASHER	1	
9	04434-51012	CLIP	1	
10	01010-81225	BOLT	1	
11	01643-31232	WASHER	1	
12	01010-81025	BOLT	1	
13	01643-31032	WASHER	1	
14	04434-51712	CLIP	6	
15	01010-81225	BOLT	6	
16	01643-31232	WASHER	6	
17	04434-51012	CLIP	5	
18	01010-81225	BOLT	5	
19	01643-31232	WASHER	5	
20	04434-51012	CLIP	3	
21	01010-81225	BOLT	3	
22	01643-31232	WASHER	3	
23	04434-51912	CLIP	3	
24	04434-52712	CLIP	1	
25	04434-51712	CLIP	1	
26	01010-81225	BOLT	1	
27	01643-31232	WASHER	1	
28	04434-52312	CLIP	1	
29	04434-51712	CLIP	1	
30	04434-52112	CLIP	2	
31	01010-81220	BOLT	1	
32	01643-31232	WASHER	1	
33	01010-81225	BOLT	1	
34	01643-31232	WASHER	1	
35	04434-51512	CLIP	1	
36	01010-81225	BOLT	1	
37	01643-31232	WASHER	1	
38	08034-20519	BAND	1	

E0200-02A0 : TILT CAB MAIN HARNESS (CLIP)

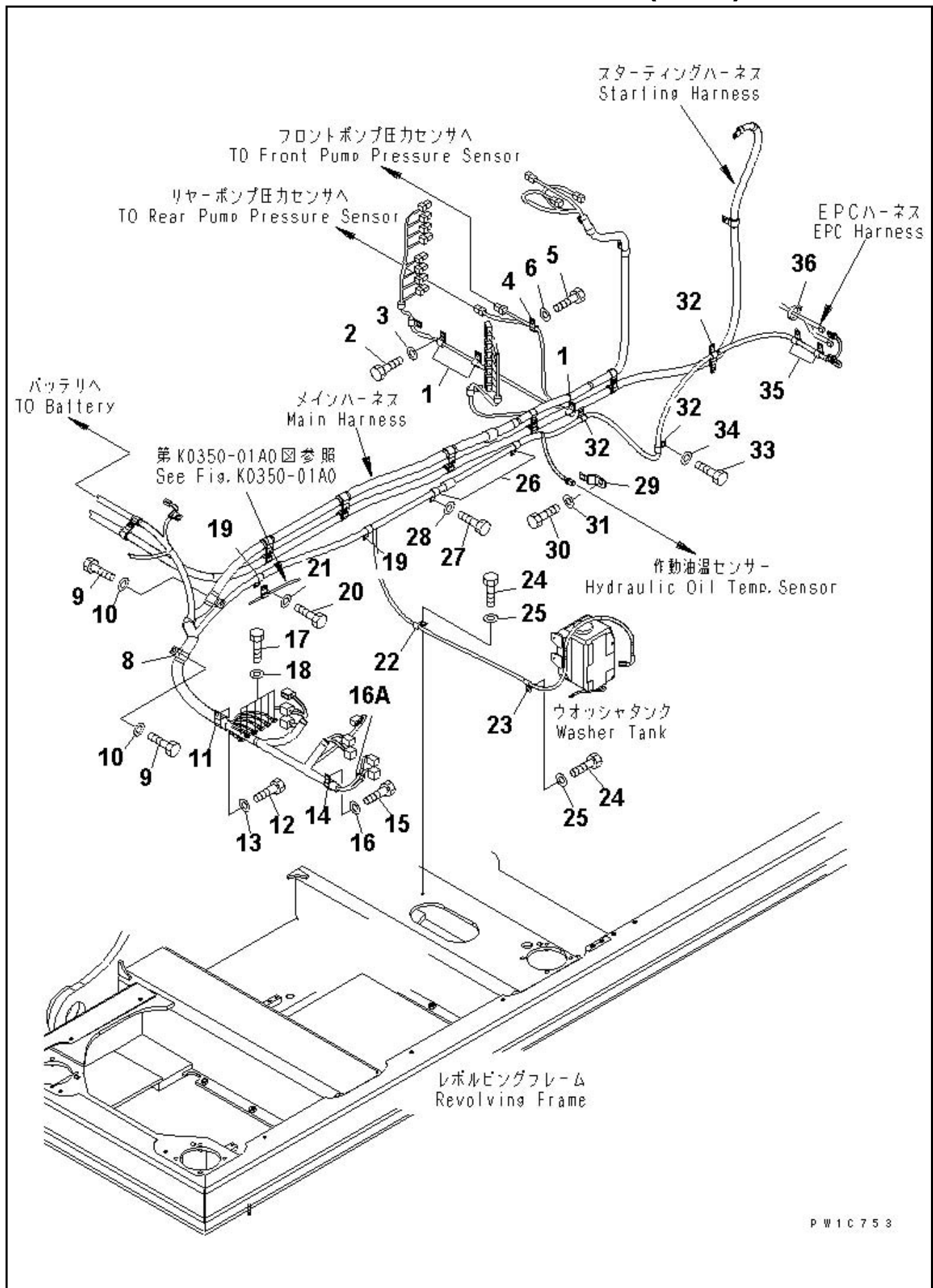

PW1C753