

SHOP

MANUAL

KOMATSU

PC340LC, 340NLC-7K

MACHINE MODEL

PC340LC-7K

PC340NLC-7K

SERIAL NUMBER

K40001 AND UP

K40001 AND UP

- This shop manual may contain attachments and optional equipment that are not available in your area. Please consult your local Komatsu distributor for those items you may require. Materials and specifications are subject to change without notice.
- PC340LC/NLC-7K mount the SAA6D114E engine.
For details of the engine, see the 114 Series Engine Shop Manual.

CONTENTS

	No. of page
01 GENERAL	01-1
10 STRUCTURE, FUNCTION AND MAINTENANCE STANDARD	10-1
20 TESTING AND ADJUSTING	20-1
30 DISASSEMBLY AND ASSEMBLY	30-1
90 OTHERS	90-1

LIST OF REVISED PAGES

The affected pages are indicated by the use of the following marks. It is requested that necessary actions be taken to these pages according to the table below.

Mark	Indication	Action required
○	Page to be newly added	Add
●	Page to be replaced	Replace
()	Page to be deleted	Discard

Pages having no marks are those previously revised or made additions.

LIST OF REVISED PAGES

Mark	Page	Time of revision	Mark	Page	Time of revision	Mark	Page	Time of revision	Mark	Page	Time of revision	Mark	Page	Time of revision
●	00-1	①		10-13			10-42			10-70			10-100	
●	00-2	①		10-14			10-43			10-71			10-101	
○	00-2-1	①		10-15			10-44			10-72			10-102	
○	00-2-2	①		10-16			10-45			10-74			10-103	
○	00-2-3	①		10-17			10-46			10-75			10-104	
○	00-2-4	①		10-18			10-47			10-76			10-105	
				10-19			10-48			10-77			10-106	
				10-20			10-50			10-78			10-107	
				10-21			10-51			10-79			10-108	
	01-1			10-22			10-52			10-80			10-109	
	01-2			10-23			10-53			10-81			10-110	
	01-3			10-24			10-54			10-82			10-111	
	01-4			10-26			10-55			10-83			10-112	
	01-5			10-27			10-56			10-84			10-113	
	01-6			10-28			10-57			10-85			10-114	
	01-7			10-29			10-58			10-86			10-115	
	01-8			10-30			10-59			10-87			10-116	
				10-31			10-60			10-88			10-117	
	10-1			10-32			10-61			10-89			10-118	
	10-2			10-33			10-62			10-90			10-120	
	10-3			10-34			10-62			10-91			10-121	
	10-4			10-35			10-63			10-92			10-122	
	10-6			10-36			10-64			10-94			10-123	
	10-7			10-37			10-65			10-95			10-124	
	10-8			10-38			10-66			10-96			10-125	
	10-9			10-39			10-67			10-97			10-126	
	10-10			10-40			10-68			10-98			10-127	
	10-12			10-41			10-69			10-99			10-128	

LIST OF REVISED PAGES

Mark	Page	Time of revision	Mark	Page	Time of revision	Mark	Page	Time of revision	Mark	Page	Time of revision	Mark	Page	Time of revision
	10-129			10-171			20-101			20-141			20-181	
	10-130			10-172			20-102			20-142			20-182	
	10-132			10-173			20-103			20-143				
	10-133			10-174			20-104			20-144				
	10-134			10-175			20-105			20-145				
	10-135			10-176			20-106			20-146			20-201	
	10-136			10-177			20-107			20-147			20-202	
●	10-137	①		10-178			20-108			20-148			20-203	
	10-138			10-179			20-109			20-149			20-204	
	10-139			10-180			20-110			20-150			20-205	
	10-140			10-181			20-111			20-151			20-206	
	10-141			10-182			20-112			20-152			20-207	
	10-142			10-183			20-113			20-153			20-208	
	10-143			10-184			20-114			20-154			20-209	
	10-144			10-185			20-115			20-155			20-210	
	10-146			10-186			20-116			20-156			20-211	
	10-147			10-187			20-117			20-157			20-212	
	10-148			10-188			20-118			20-158			20-213	
	10-149			10-189			20-119			20-159			20-214	
	10-150			10-190			20-120			20-160			20-215	
	10-151			10-191			20-121			20-161			20-216	
	10-152			10-192			20-122			20-162			20-218	
	10-153			10-193			20-123			20-163			20-219	
	10-154			10-194			20-124			20-164			20-220	
	10-155			10-195			20-125			20-165			20-221	
	10-156			10-196			20-126			20-166			20-222	
	10-157			10-197			20-127			20-167			20-224	
	10-158			10-198			20-128			20-168			20-225	
	10-159						20-129			20-169			20-226	
	10-160			20-1			20-130			20-170			20-227	
	10-161			20-2			20-131			20-171			20-228	
	10-162			20-3			20-132			20-172			20-230	
	10-163			20-4			20-133			20-173			20-231	
	10-164			20-5			20-134			20-174			20-232	
	10-165		●	20-6	①		20-135			20-175			20-233	
	10-166		●	20-7	①		20-136			20-176			20-234	
	10-167			20-8			20-137			20-177			20-235	
	10-168			20-9			20-138			20-178			20-236	
	10-169			20-10			20-139			20-179			20-237	
	10-170						20-140			20-180			20-238	

LIST OF REVISED PAGES

Mark	Page	Time of revision	Mark	Page	Time of revision	Mark	Page	Time of revision	Mark	Page	Time of revision	Mark	Page	Time of revision
	20-239			20-320			20-360			20-514		○	20-601	①
	20-240			20-321			20-362			20-515		○	20-602	①
	20-241			20-322			20-363			20-516		○	20-603	①
	20-242			20-323			20-364			20-517		○	20-604	①
	20-243			20-324			20-365			20-518		○	20-605	①
	20-244			20-325			20-366			20-519		○	20-606	①
	20-245			20-326			20-367			20-520		○	20-607	①
	20-246			20-327			20-368			20-521		○	20-608	①
	20-247			20-328			20-369			20-522		○	20-609	①
	20-248			20-329			20-370			20-523		○	20-610	①
	20-249			20-330			20-371			20-524		○	20-611	①
	20-250			20-331			20-372			20-525		○	20-612	①
	20-251			20-332			20-374			20-526		○	20-613	①
	20-252			20-333			20-375			20-527		○	20-614	①
	20-253			20-334			20-376			20-528		○	20-615	①
	20-254			20-335			20-377			20-530		○	20-616	①
	20-255			20-336			20-378			20-531		○	20-617	①
	20-256			20-337			20-379			20-532		○	20-618	①
	20-257			20-338			20-380			20-533		○	20-619	①
				20-339			20-381			20-534		○	20-620	①
				20-340			20-382			20-535		○	20-621	①
				20-341			20-383			20-536		○	20-622	①
				20-342			20-384			20-537		○	20-623	①
	20-301			20-343			20-385			20-538				
	20-302			20-344			20-386			20-540				
	20-304			20-345						20-541				
	20-305			20-346						20-542				
	20-306			20-347						20-543				
	20-307			20-348			20-501			20-544			30-1	
	20-308			20-349			20-502			20-545			30-2	
	20-309			20-350			20-503			20-546			30-3	
	20-310			20-351			20-504			20-547			30-4	
	20-311			20-352			20-505			20-548			30-5	
	20-312			20-353			20-506			20-549			30-6	
	20-313			20-354			20-507						30-7	
	20-314			20-355			20-508						30-8	
	20-315			20-356			20-510						30-9	
	20-316			20-357			20-511						30-10	
	20-317			20-358			20-512						30-11	
	20-318			20-359			20-513						30-12	

LIST OF REVISED PAGES

Mark	Page	Time of revision	Mark	Page	Time of revision	Mark	Page	Time of revision	Mark	Page	Time of revision	Mark	Page	Time of revision
	30-13			30-53			20-93							
	30-14			30-54			30-94							
	30-15			30-55			30-95							
	30-16			30-56			30-96							
	30-17			30-57										
	30-18			30-58										
	30-19			30-59										
	30-20			30-60			90-1							
	30-21			30-61			90-3							
	30-22			30-62			90-5							
	30-23			30-63			90-7							
	30-24			30-64			90-9							
	30-25			30-65										
	30-26			30-66										
	30-27			30-67										
	30-28			30-68										
	30-29			30-69										
	30-30			30-70										
	30-31			30-71										
	30-32			30-72										
	30-33			30-73										
	30-34			30-74										
	30-35			30-75										
	30-36			30-76										
	30-37			30-77										
	30-38			30-78										
	30-39			30-79										
	30-40			30-80										
	30-41			30-81										
	30-42			30-82										
	30-43			30-83										
	30-44			30-84										
	30-45			30-85										
	30-46			30-86										
	30-47			30-87										
	30-48			30-88										
	30-49			30-89										
	30-50			30-90										
	30-51			30-91										
	30-52			30-92										

01 GENERAL

Specification Dimension Drawings	01-2
Specifications	
PC340LC-7, PC340NLC-7	01-4
Weight Table	
PC340LC-7, PC340NLC-7	01-6
Fuel, Coolant, And Lubricants	01-8

SPECIFICATION DIMENSION DRAWINGS

DIMENSIONS

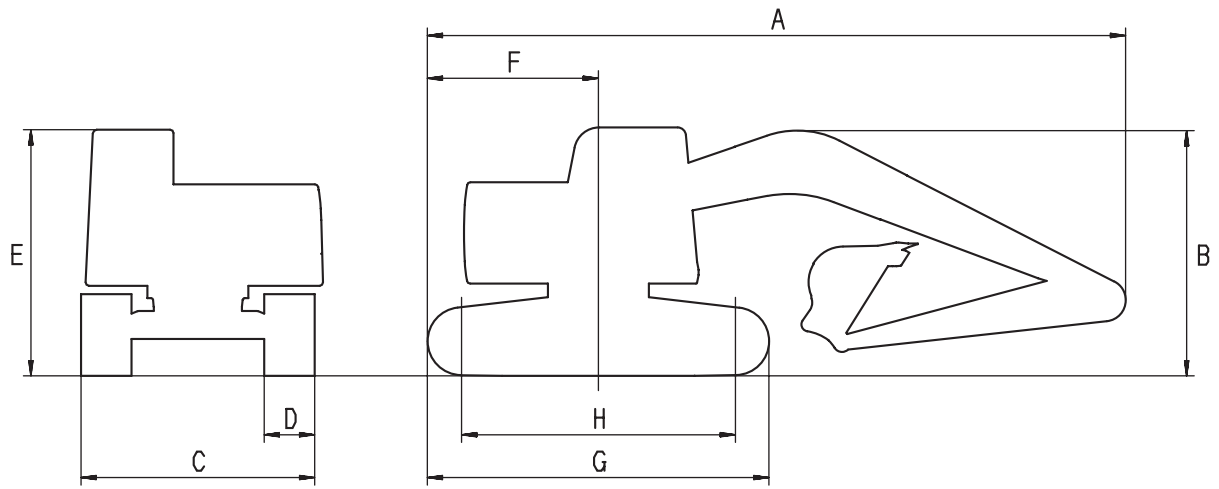

9JM01330

WORKING RANGES

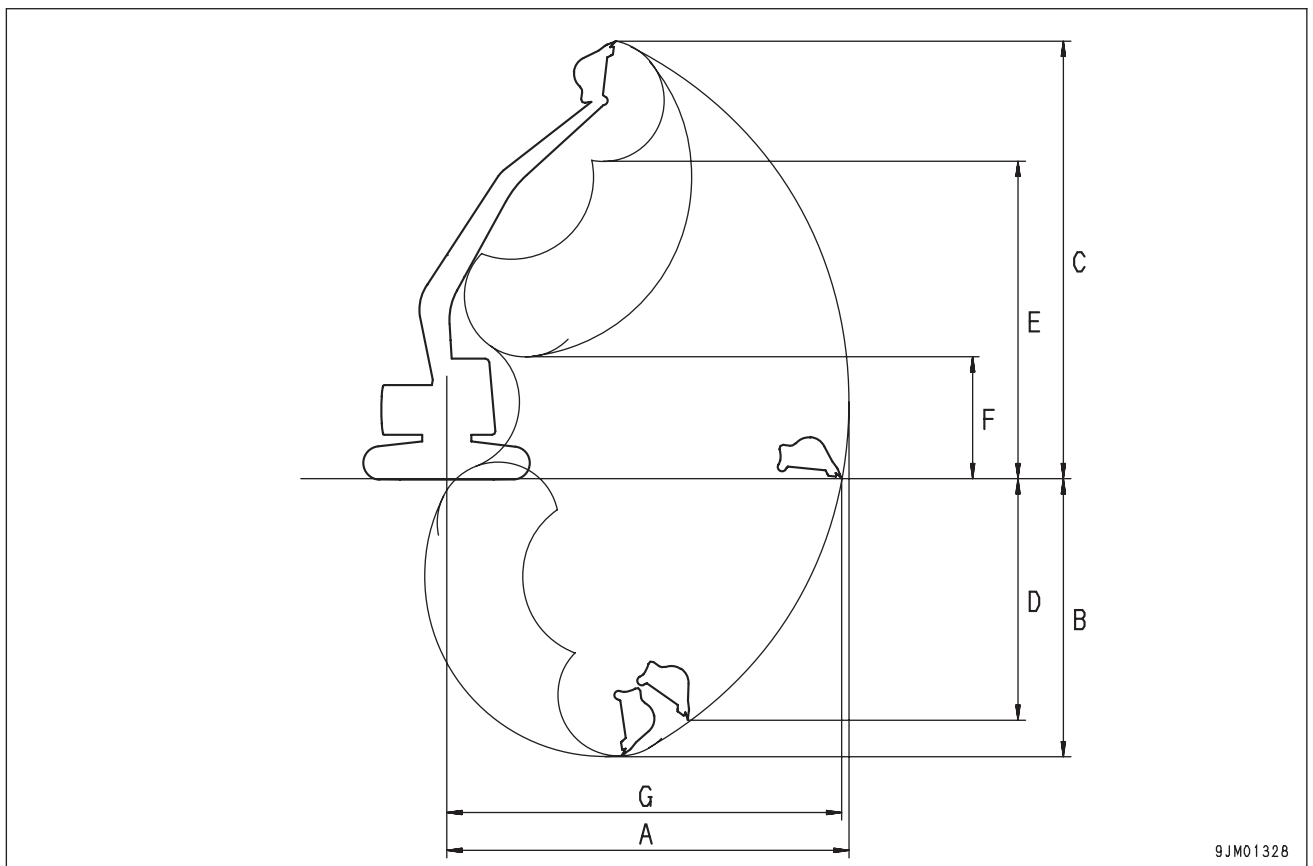

9JM01328

DIMENSIONS

	Item	Unit	PC340LC-7	PC340NLC-7
A	Overall length	mm	11,140	11,140
B	Overall height	mm	3,290	3,280
C	Overall width	mm	3,190	2,990
D	Track shoe width	mm	700	600
E	Height of cab	mm	3,130	3,130
F	Tail swing radius	mm	3,450	3,450
G	Track overall length	mm	4,955	4,955
H	Length of track on ground	mm	4,030	4,030
	Min. ground clearance	mm	498	498

WORKING RANGES

	Item	Unit	PC340LC-7	PC340NLC-7
A	Max. digging reach	mm	11,100	11,100
B	Max. digging depth	mm	7,380	7,380
C	Max. digging height	mm	10,210	10,210
D	Max. vertical wall depth	mm	6,480	6,480
E	Max. dumping height	mm	7,110	7,110
F	Min. dumping height	mm	2,640	2,640
G	Max. reach at ground level	mm	10,920	10,920

SPECIFICATIONS

PC340LC-7, PC340NLC-7

Machine model		PC340LC-7	PC340NLC-7	
Serial Number		40001 and up		
Bucket capacity		m ³	1.4	1.4
Operating weight		kg	33,530	33,230
Working ranges	Max. digging depth	mm	7,380	7,380
	Max. vertical wall depth	mm	6,480	6,480
	Max. digging reach	mm	11,100	11,100
	Max. reach at ground level	mm	10,920	10,920
	Max. digging height	mm	10,210	10,210
	Max. dumping height	mm	7,110	7,110
Performance	Max. digging force	kN {kg}	211.8 {21,600} (226.5	211.8 {21,600} (226.5
	(using power max. function)	kN {kg}	{23,100})	{23,100})
	Swing speed	rpm	9.5	9.5
	Swing max. slope angle	deg.	21	21
	Travel speed	km/h	Lo: 3.2 (※ Mi: 4.5)	Lo: 3.2 (※ Mi: 4.5)
			Hi: 5.5	Hi: 5.5
	Gradeability	deg.	35	35
Ground pressure	kPa {kg/cm ² }	53.0 {0.54}	61.8 {0.63}	
[standard shoe width]	[mm]	[700]	[600]	
Dimensions	Overall length (for transport)	mm	11,140	11,140
	Overall width	mm	3,190	3,190
	Overall width of track	mm	3,290	2,990
	Overall height (for transport)	mm	3,280	3,280
	Overall height to chassis	mm	3,130	3,130
	Ground clearance to bottom of upper structure	mm	1,186	1,186
	Min. ground clearance	mm	498	498
	Tail swing radius	mm	3,450	3,450
	Min. swing radius of work equipment	mm	4,310	4,310
	Height of work equipment at min. swing radius	mm	8,520	8,520
	Length of track on ground	mm	4,030	4,030
	Track gauge	mm	2,590	2,590
	Height of machine cab	mm	3,130	3,130

※ : The "Mi" mode is on the multi-monitor specification machine only.

Machine model		PC340LC-7	PC340NLC-7			
Serial Number		40001 and up				
Engine	Model	SAA6D114E				
	Type	4-cycle, water-cooled, in-line, vertical, direct injection, with turbo charger and aftercooler				
	No. of cylinders - bore x stroke	mm	6 - 114 x 135			
	Piston displacement	l {cc}	8.27 {8,270}			
	Performance					
	Flywheel horsepower	kW/rpm {HP/rpm}	180.3/1,900 {242/1,900}			
	Max. torque	Nm/rpm {kgm/rpm}	1,079/1,400 {110/1,400}			
	Max. speed at no load	rpm	2,160			
	Min. speed at no load	rpm	900			
	Min. fuel consumption	g/kWh {g/HPh}	205 {153}			
	Starting motor		24V, 7.5 kW			
	Alternator		24V, 35 A			
	Battery		12V, 126 Ah x 2			
	Radiator core type		CF19-4			
Under-carriage	Carrier roller		2 on each side			
	Track roller		7 on each side	8 on each side		
	Track shoe		Assembly-type triple grouser, 45 on each side	Assembly-type triple grouser, 48 on each side		
Hydraulic system	Hydraulic pump	Type x No. Delivery Set pressure	l/min MPa (kg/cm ²)	HPV125+125, variable displacement, Piston type x2 267.5 x 2 37.8 {380}		
	Control valve	Type x No. Control method		6-spool type + 1-spool type x 1 Hydraulic		
	Hydraulic motor	Travel motor Swing motor		H MV160ADT-2, Piston type (with brake valve, parking brake): x 2 KMF230ABE-5, Piston type (with safety valve, holding brake): x 1 reverse rotation check valve		
	Hydraulic cylinder	Type		Boom	Arm	Bucket
				Double acting piston	Double acting piston	Double acting piston
		Inside diameter of cylinder	mm	140	160	140
		Diameter of piston rod	mm	100	110	100
		Stroke	mm	1,480	1,825	1,285
Max. distance between pins	mm	3,525	4,255	3,155		
Min. distance between pins	mm	2,045	2,430	1,870		
	Hydraulic tank		Closed box type			
	Hydraulic filter		Tank return side			
	Hydraulic cooler		CFT-1 (Air cooled)			

WEIGHT TABLE



This weight table is for use when handling components or when transporting the machine.

PC340LC-7, PC340NLC-7

Unit: kg

Machine model	PC340LC-7	PC340NLC-7
Serial Number	40001 and up	
Engine assembly	1,148	1,148
• Engine	860	860
• Damper	14.3	14.3
• Hydraulic pump	178	178
Radiator oil cooler assembly	153	153
Hydraulic tank, filter assembly (excluding hydraulic oil)	176	176
Fuel tank (excluding fuel)	238	238
Revolving frame	2,723	2,723
Operator's cab	292	292
Operator's seat	35	35
Counterweight	5,470	5,470
Swing machinery	442	442
Control valve	242	242
Swing motor	88	88
Travel motor	164 x 2	164 x 2
Center swivel joint	29.9	29.9
Track frame assembly	7,979	7,979
• Track frame	4,441	4096.79
• Swing circle	487	169 x 2
• Idler	169 x 2	287.5 x 2
• Idler cushion	287.5 x 2	31.3 x 4
• Carrier roller	31.3 x 4	52.9 x 16
• Track roller	52.9 x 14	583 x 2
• Final drive (including travel motor)	583 x 2	

Unit: kg

Machine model	PC340LC-7	PC340NLC-7
Serial Number	40001 and up	
Track shoe assembly		
• Standard triple grouser shoe (600 mm)	3,700	3,700
• Standard triple grouser shoe (700 mm)	4,300	4,300
• Wide triple grouser shoe (800 mm)	4,680	4,680
• Road liner (rubber pad type) (600 mm)	—	—
Boom assembly	2,290	2,290
Arm assembly	1,105	1,105
Bucket assembly	1,015	1,015
Boom cylinder assembly	254 x 2	254 x 2
Arm cylinder assembly	382	382
Bucket cylinder assembly	228	228
Link assembly (large)	316	316
Link assembly (small)	—	—
Boom pin	76 + 15 x 2 + 56 + 17 + 42	76 + 15 x 2 + 56 + 17 + 42
Arm pin	13 + 17	13 + 17
Bucket pin	30 x 2	30 x 2
Link pin	27 x 2	27 x 2

FUEL, COOLANT, AND LUBRICANTS

RESERVOIR	KIND OF FLUID	AMBIENT TEMPERATURE								CAPACITY (l)	
		-22 -30	-4 -20	14 -10	32 0	50 10	68 20	86 30	104°F 40°C	Specified	Refill
Engine oil pan	Engine oil								SAE 30	38	35
									SAE 10W		
									SAE 10W-30		
									SAE 15W-40		
Damper case										1.3	—
Swing machinery case										13.4	13.4
Final drive case (each side)									SAE 30	8.5	8.5
Idler (1 each)									0.22 ~ 0.24	0.22 ~ 0.24	
Track roller (1 each)									0.25 ~ 0.28	0.25 ~ 0.28	
Carrier roller (1 each)									0.145 ~ 0.155	0.145 ~ 0.155	
Hydraulic system	Hydraulic oil								SAE 10W	365	188
									SAE 10W-30		
								SAE 15W-40			
								H046-HM (★)			
Fuel tank	Diesel fuel								ASTM D975 No. 2	605	—
									ASTM D975A No.1		
Cooling system	Coolant								Add antifreeze	32	—

★ For the H-046-HM, use the oil recommended by Komatsu.

10 STRUCTURE, FUNCTION AND MAINTENANCE STANDARD

Engine Related Parts	10-2	Sensor	10-195
Radiator • Oil Cooler • Aftercooler	10-3		
Power Train	10-4		
Final Drive	10-6		
Swing Machinery	10-8		
Swing Circle	10-10		
Track Frame • Recoil Spring	10-12		
Idler	10-14		
Carrier roller	10-16		
Track roller	10-17		
Track Shoe	10-18		
Hydraulic Equipment Layout Drawing	10-22		
Hydraulic tank	10-24		
Hydraulic Pump	10-26		
Variable Volume Valve	10-47		
Control Valve	10-50		
CLSS	10-66		
Self Pressure Reducing Valve	10-69		
Swing Motor	10-72		
Reverse Prevention Valve	10-78		
Center Swivel Joint	10-80		
Travel Motor	10-81		
Travel Junction Valve	10-91		
Travel PPC Shuttle Valve	10-94		
Valve Control	10-98		
Work Equipment • Swing PPC Valve	10-99		
Travel PPC Valve	10-103		
Service PPC Valve	10-112		
Solenoid Valve	10-115		
PPC Accumulator	10-117		
Return Oil Filter	10-118		
Boom Hydraulic Drift Prevention Valve	10-120		
Quick Return Valve	10-126		
Lift Check Valve	10-128		
Attachment Circuit Selector Valve	10-129		
Hydraulic Cylinder	10-132		
Work Equipment	10-134		
Air Conditioner	10-140		
Engine Control	10-141		
Electronic Control System	10-149		
Multi Monitor System	10-173		

ENGINE RELATED PARTS

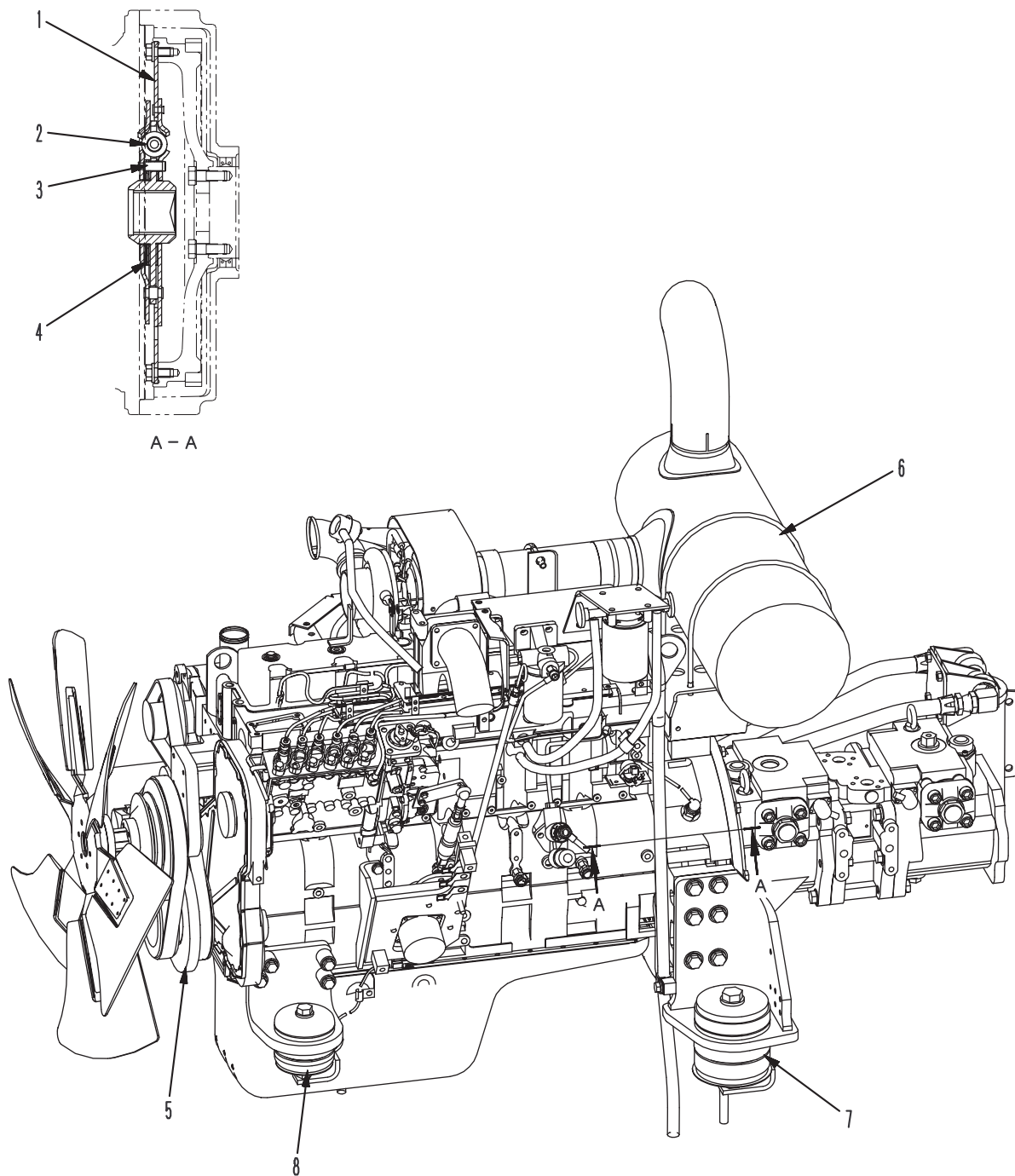

SWP08988

- | | |
|-------------------|-----------------------|
| 1. Drive plate | 5. Damper assembly |
| 2. Torsion spring | 6. Muffler |
| 3. Stopper pin | 7. Rear engine mount |
| 4. Friction plate | 8. Front engine mount |

OUTLINE

- The damper assembly is a wet type.
Oil capacity: 1.3 l

RADIATOR • OIL COOLER • AFTERCOOLER

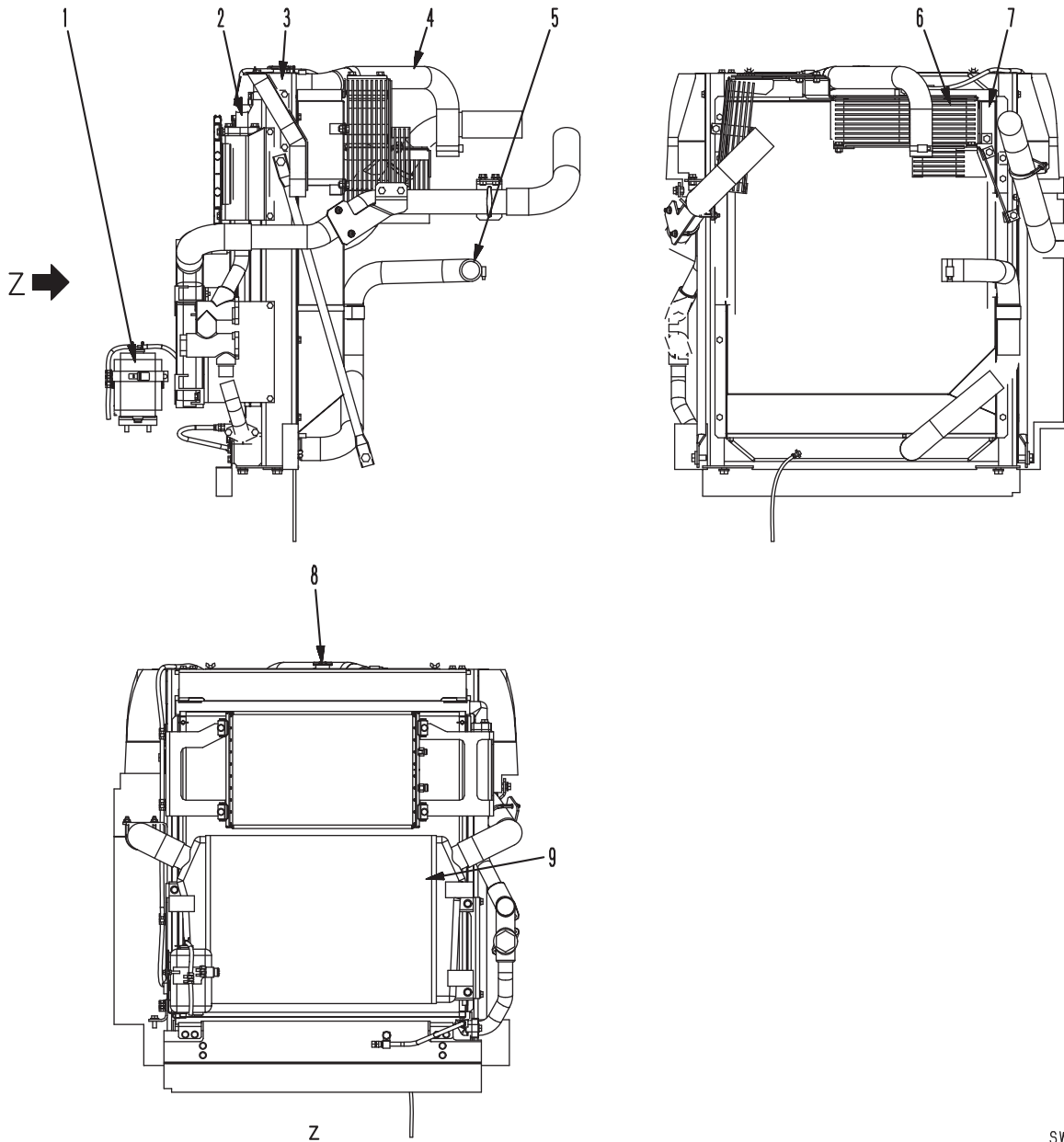

SWP08990

1. Reservoir tank
2. Oil cooler
3. Radiator
4. Radiator inlet hose
5. Radiator outlet hose
6. Net
7. Shroud
8. Radiator cap
9. Aftercooler

SPECIFICATIONS

Radiator : CF19-4
 Oil cooler : CF40-1

POWER TRAIN

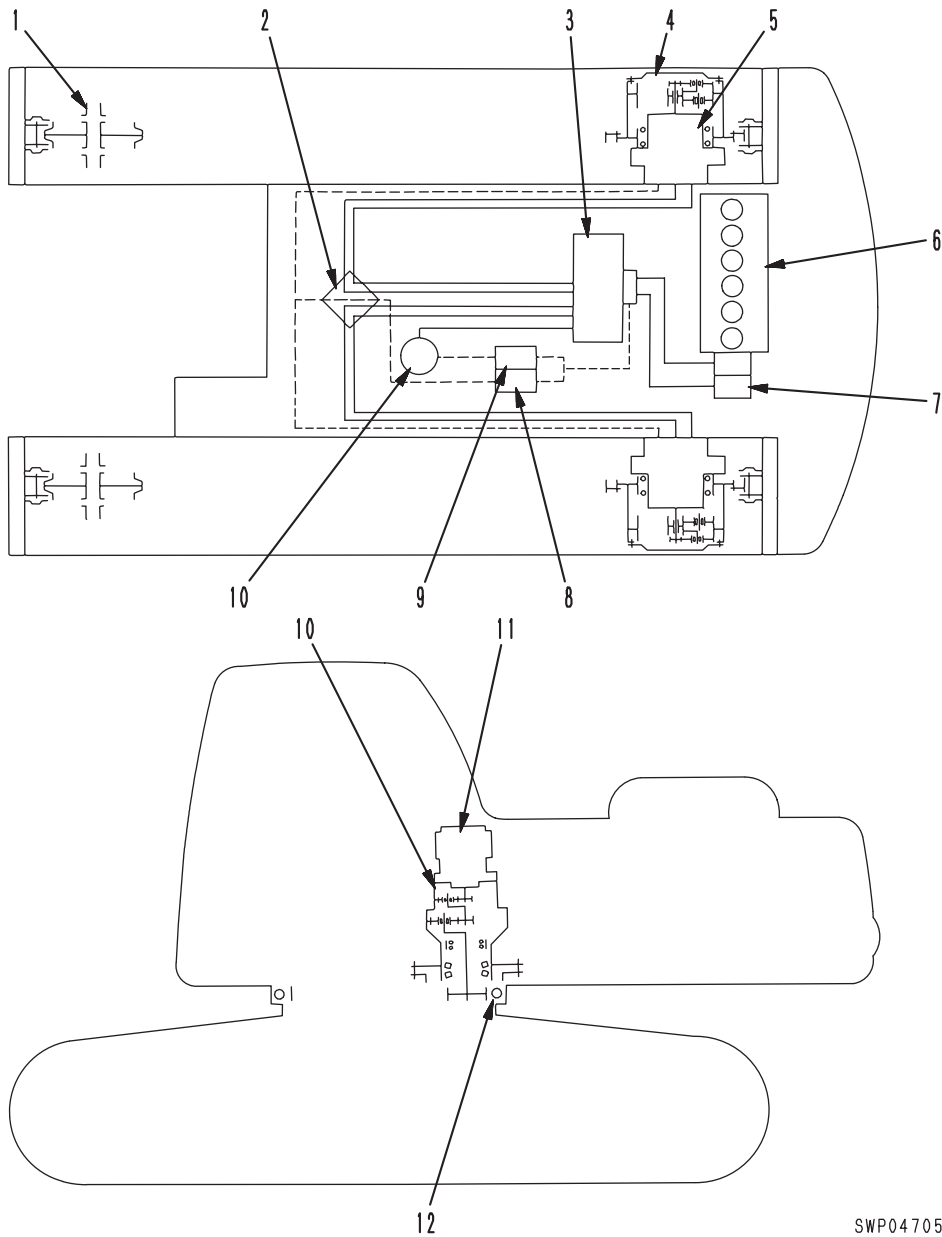

SWP04705

- | | |
|--------------------------------|--------------------------------|
| 1. Idler | 7. Hydraulic pump (HPV125+125) |
| 2. Center swivel joint | 8. Travel speed solenoid valve |
| 3. Control valve | 9. Swing brake solenoid valve |
| 4. Final drive | 10. Swing machinery |
| 5. Travel motor (HMV 160ADT-2) | 11. Swing motor (KMF230ABE-5) |
| 6. Engine (SAA6D114E) | 12. Swing circle |

FINAL DRIVE

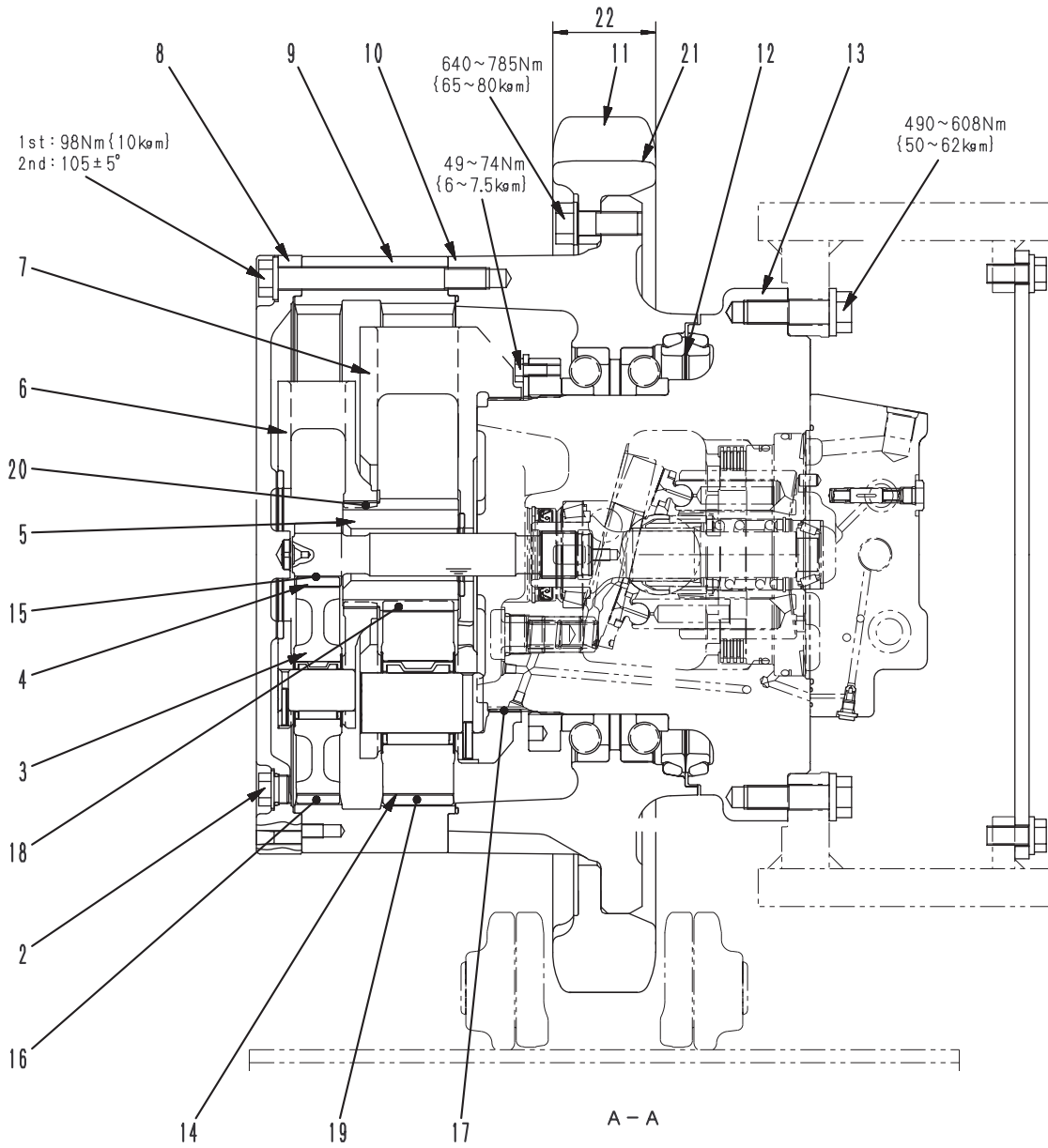

SJP08991