

# SHOP

# MANUAL

# KOMATSU

## PC210, 210LC, 210NLC PC240LC, 240NLC-7K

MACHINE MODEL

SERIAL NUMBER

**PC210-7K**

**K40001 AND UP**

**PC210LC-7K**

**K40001 AND UP**

**PC210-NLC-7K**

**K40001 AND UP**

**PC240LC-7K**

**K40001 AND UP**

**PC240NLC-7K**

**K40001 AND UP**

- This shop manual may contain attachments and optional equipment that are not available in your area. Please consult your local Komatsu distributor for those items you may require. Materials and specifications are subject to change without notice.

# CONTENTS

	No. of page
<b>01 GENERAL</b> .....	01-1
<b>10 STRUCTURE, FUNCTION AND MAINTENANCE STANDARD</b> .....	10-1
<b>20 TESTING AND ADJUSTING</b> .....	20-1
<b>30 DISASSEMBLY AND ASSEMBLY</b> .....	30-1
<b>90 OTHERS</b> .....	90-1

The affected pages are indicated by the use of the following marks. It is requested that necessary actions be taken to these pages according to the table below.

Mark	Indication	Action required
○	Page to be newly added	Add
●	Page to be replaced	Replace
( )	Page to be deleted	Discard

Pages having no marks are those previously revised or made additions.

**LIST OF REVISED PAGES**

Mark	Page	Time of revision	Mark	Page	Time of revision	Mark	Page	Time of revision	Mark	Page	Time of revision	Mark	Page	Time of revision
●	00-1	①		10-1			10-29			10-57			10-85	
●	00-2	①		10-2			10-30			10-58			10-86	
○	00-2-1	①		10-3			10-31			10-59			10-87	
○	00-2-2	①		10-4			10-32			10-60			10-88	
○	00-2-3	①		10-5			10-33			10-61			10-89	
○	00-2-4	①		10-6			10-34			10-62			10-90	
				10-7			10-35			10-63			10-91	
				10-8			10-36			10-64			10-92	
	01-1			10-9			10-37			10-65			10-93	
	01-2			10-10			10-38			10-66			10-94	
	01-3			10-11			10-39			10-67			10-95	
	01-4			10-12			10-40			10-68			10-96	
	01-5			10-13			10-41			10-69			10-97	
	01-6			10-14			10-42			10-70			10-98	
	01-7			10-15			10-43			10-71			10-99	
	01-8			10-16			10-44			10-72			10-100	
	01-9			10-17			10-45			10-73			10-101	
	01-10			10-18			10-46			10-74			10-102	
	01-11			10-19			10-47			10-75			10-103	
	01-12			10-20			10-48			10-76			10-104	
	01-13			10-21			10-49			10-77			10-105	
	01-14			10-22			10-50			10-78			10-106	
				10-23			10-51			10-79			10-107	
				10-24			10-52			10-80			10-108	
				10-25			10-53			10-81			10-109	
				10-26			10-54			10-82			10-110	
				10-27			10-55			10-83			10-111	
				10-28			10-56			10-84			10-112	

**LIST OF REVISED PAGES**

Mark	Page	Time of revision	Mark	Page	Time of revision	Mark	Page	Time of revision	Mark	Page	Time of revision	Mark	Page	Time of revision
	10-113			10-154			10-194			20-11			20-131	
	10-114		●	10-155	①		10-195			20-12			20-132	
	10-115		●	10-156	①		10-196			20-13			20-133	
	10-116		●	10-157	①		10-197			20-14			20-134	
	10-117		●	10-158	①		10-198			20-15			20-135	
	10-118			10-159			10-199			20-16			20-136	
	10-119			10-160			10-200						20-137	
	10-120			10-161			10-201						20-138	
	10-121			10-162			10-202						20-139	
	10-122			10-163			10-203						20-140	
	10-123			10-164			10-204			20-101			20-141	
	10-124			10-165			10-205			20-102			20-142	
	10-125			10-166			10-206			20-103			20-143	
	10-126			10-167			10-207			20-104			20-144	
●	10-127	①		10-168			10-208			20-105			20-145	
●	10-128	①		10-169			10-209			20-106			20-146	
	10-129			10-170			10-210			20-107			20-147	
	10-130			10-171			10-211			20-108			20-148	
	10-131			10-172			10-212			20-109			20-149	
	10-132			10-173			10-213			20-110			20-150	
	10-133			10-174			10-214			20-111			20-151	
	10-134			10-175			10-215			20-112			20-152	
	10-135			10-176			10-216			20-113			20-153	
	10-136			10-177			10-217			20-114			20-154	
	10-138			10-178			10-218			20-115			20-155	
	10-139			10-179			10-219			20-116			20-156	
	10-140			10-180						20-117			20-157	
	10-141			10-181						20-118			20-158	
	10-142			10-182						20-119			20-159	
	10-143			10-183						20-120			20-160	
	10-144			10-184						20-121			20-161	
	10-145			10-185			20-1			20-122			20-162	
	10-146			10-186			20-2			20-123			20-163	
	10-147			10-187			20-3			20-124			20-164	
	10-148			10-188			20-4			20-125		●	20-165	①
	10-149			10-189			20-5			20-126			20-166	
	10-150			10-190			20-6			20-127		●	20-167	①
	10-151			10-191			20-7			20-128			20-168	
	10-152			10-192			20-8			20-129			20-169	
	10-153			10-193			20-9			20-130			20-170	

**LIST OF REVISED PAGES**

Mark	Page	Time of revision	Mark	Page	Time of revision	Mark	Page	Time of revision	Mark	Page	Time of revision	Mark	Page	Time of revision
●	20-171	①		20-225			20-301			20-342			20-386	
	20-172			20-226			20-302			20-343				
	20-173			20-227			20-304			20-344				
	20-174			20-228			20-305			20-345				
	20-175			20-229			20-306			20-346				
	20-176			20-230			20-307			20-347				
	20-177			20-231			20-308			20-348			20-501	
●	20-178	①		20-232			20-309			20-349			20-502	
	20-179			20-233			20-310			20-350			20-503	
●	20-180	①		20-234			20-311			20-351			20-504	
	20-181			20-235			20-312			20-352			20-505	
	20-182			20-236			20-313			20-353			20-506	
				20-237			20-314			20-354			20-507	
				20-238			20-315			20-355			20-508	
				20-239			20-316			20-356			20-510	
				20-240			20-317			20-357			20-511	
	20-201			20-241			20-318			20-358			20-512	
	20-202			20-242			20-319			20-359			20-513	
	20-203			20-243			20-320			20-360			20-514	
	20-204			20-244			20-321			20-362			20-515	
	20-205			20-245			20-322			20-364			20-516	
	20-206			20-246			20-323			20-365			20-517	
	20-207			20-247			20-324			20-366			20-518	
	20-208			20-248			20-325			20-367			20-519	
	20-209			20-249			20-326			20-368			20-520	
	20-210			20-250			20-327			20-369			20-521	
	20-211			20-251			20-328			20-370			20-522	
	20-212			20-252			20-329			20-372			20-523	
	20-213			20-253			20-330			20-374			20-524	
	20-214			20-254			20-331			20-375			20-525	
	20-215			20-255			20-332			20-376			20-526	
	20-216			20-256			20-333			20-377			20-527	
	20-217			20-257			20-334			20-378			20-528	
	20-218						20-335			20-379			20-530	
	20-219						20-336			20-380			20-531	
	20-220						20-337			20-381			20-532	
	20-221						20-338			20-382			20-533	
	20-222						20-339			20-383			20-534	
	20-223						20-340			20-384			20-535	
	20-224						20-341			20-385			20-536	

**LIST OF REVISED PAGES**

Mark	Page	Time of revision	Mark	Page	Time of revision	Mark	Page	Time of revision	Mark	Page	Time of revision	Mark	Page	Time of revision
	20-537					○	30-43	①	○	30-83	①			
	20-538					○	30-44	①	○	30-84	①			
	20-540					○	30-45	①	○	30-85	①			
	20-541		○	30-1	①	○	30-46	①	○	30-86	①			
	20-542		○	30-2	①	○	30-47	①	○	30-87	①			
	20-543		○	30-3	①	○	30-48	①	○	30-88	①			
	20-544		○	30-4	①	○	30-49	①	○	30-89	①			
	20-545		○	30-5	①	○	30-50	①	○	30-90	①			
	20-546		○	30-6	①	○	30-51	①	○	30-91	①			
			○	30-7	①	○	30-52	①	○	30-92	①			
			○	30-8	①	○	30-53	①	○	30-93	①			
			○	30-9	①	○	30-54	①	○	30-94	①			
			○	30-10	①	○	30-55	①	○	30-95	①			
			○	30-11	①	○	30-56	①	○	30-96	①			
	20-601		○	30-12	①	○	30-57	①	○	30-97	①			
	20-602		○	30-13	①	○	30-58	①						
	20-603		○	30-14	①	○	30-59	①						
	20-604		○	30-15	①	○	30-60	①						
	20-605		○	30-16	①	○	30-61	①						
	20-606		○	30-17	①	○	30-62	①						
	20-607		○	30-18	①	○	30-63	①		90-1				
	20-608		○	30-20	①	○	30-64	①		90-3				
	20-609		○	30-21	①	○	30-65	①		90-5				
	20-610		○	30-22	①	○	30-66	①		90-7				
	20-611		○	30-23	①	○	30-67	①		90-9				
	20-612		○	30-24	①	○	30-68	①		90-11				
	20-613		○	30-25	①	○	30-69	①						
	20-614		○	30-26	①	○	30-70	①						
	20-615		○	30-27	①	○	30-71	①						
	20-616		○	30-28	①	○	30-72	①						
	20-617		○	30-29	①	○	30-73	①						
	20-618		○	30-30	①	○	30-74	①						
	20-619		○	30-31	①	○	30-75	①						
	20-620		○	30-32	①	○	30-76	①						
	20-621		○	30-33	①	○	30-77	①						
	20-622		○	30-34	①	○	30-78	①						
	20-623		○	30-35	①	○	30-79	①						
	20-624		○	30-36	①	○	30-80	①						
			○	30-37	①	○	30-81	①						
			○	30-38	①	○	30-82	①						

---

# 01 GENERAL

---

Specification Dimension Drawings	
PC210, PC210LC, PC210NLC-7K . . .	01-2
PC240LC, PC240NLC-7K . . . . .	01-4
Specifications	
PC210, PC210LC, PC210NLC-7K . . .	01-6
PC240LC, PC240NLC-7K . . . . .	01-8
Weight Table	
PC210, PC210LC, PC210NLC-7K . .	01-10
PC240LC, PC240NLC-7K . . . . .	01-12
Fuel, Coolant, And Lubricants . . . . .	01-14

# SPECIFICATION DIMENSION DRAWINGS

PC210-7K, PC210LC-7K, PC210NLC-7K

## DIMENSIONS

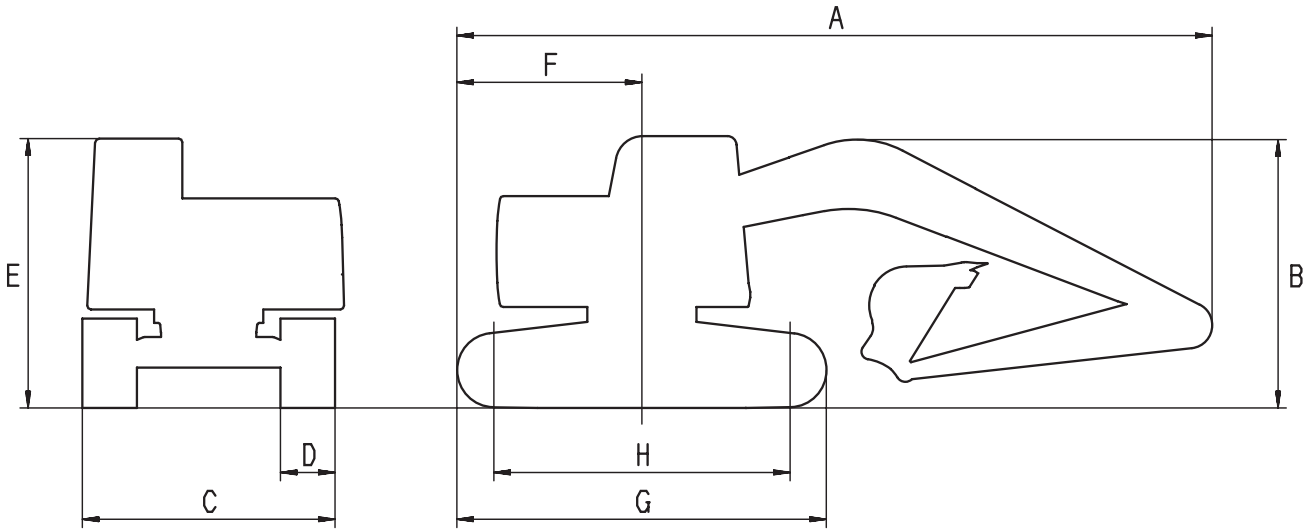

9JM01330

## WORKING RANGES

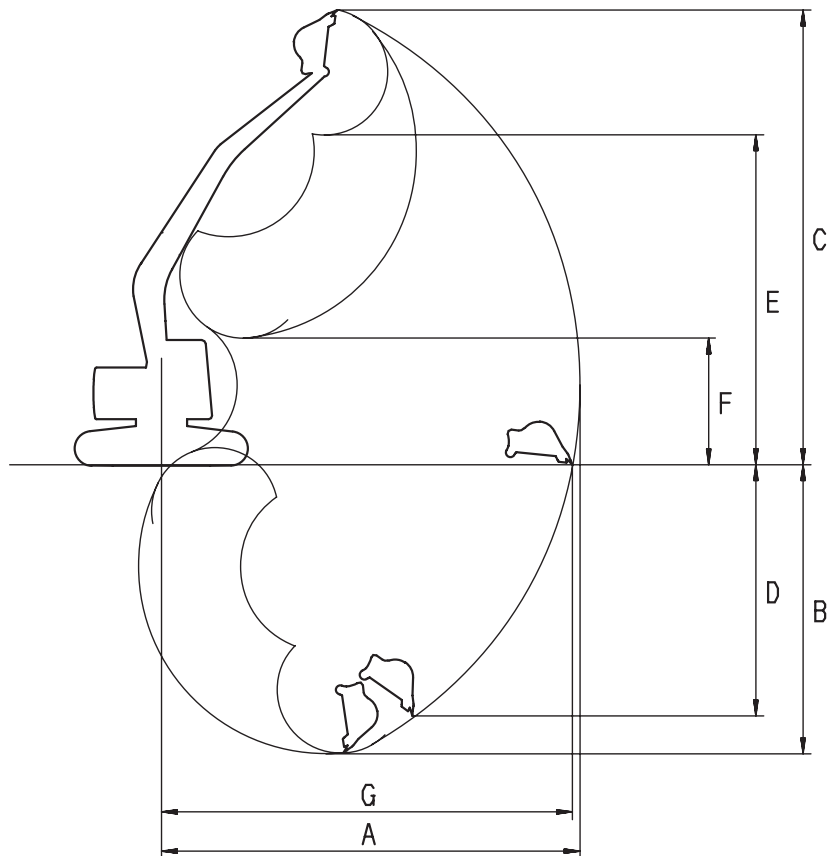

9JM01328



**DIMENSIONS**

	Item	Unit	PC210-7K	PC210LC-7K	PC210NLC-7K
A	Overall length	mm	9,425		
B	Overall height	mm	3,000		
C	Overall width	mm	2,800	3,080	2,540
D	Track shoe width	mm	600	700	500
E	Height of cab	mm	3,000		
F	Tail swing radius	mm	2,750		
G	Track overall length	mm	4,080	4,450	4,450
H	Length of track on ground	mm	3,270	3,640	3,655
	Min. ground clearance	mm	440		

**WORKING RANGES**

	Item	Unit	PC210-7K	PC210LC-7K	PC210NLC-7K
A	Max. digging reach	mm	9,875		
B	Max. digging depth	mm	6,620		
C	Max. digging height	mm	10,000		
D	Max. vertical wall depth	mm	5,980		
E	Max. dumping height	mm	7,110		
F	Min. dumping height	mm	2,645		
G	Max. reach at ground level	mm	2,645		

PC240LC-7K, PC240NLC-7K

DIMENSIONS

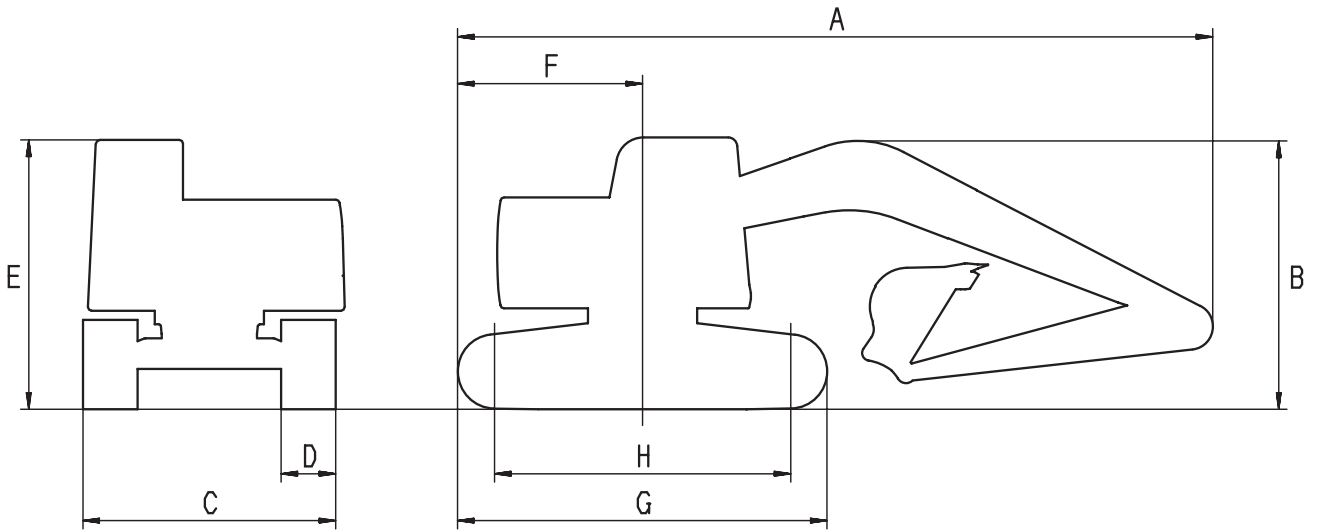

9JM01330

WORKING RANGES

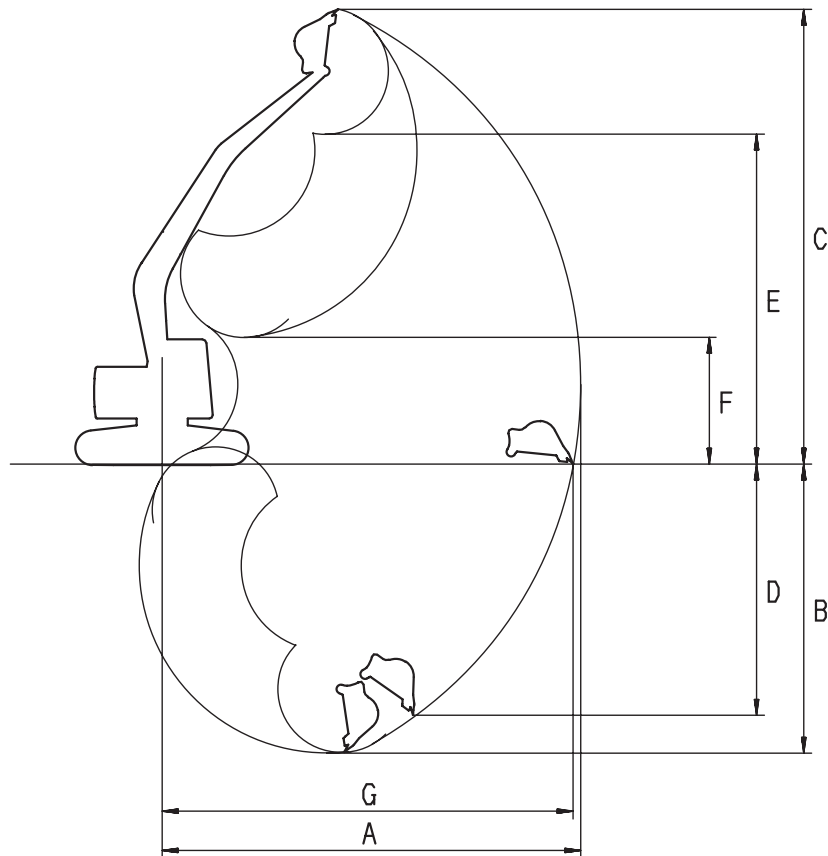

9JM01328

**DIMENSIONS**

	Item	Unit	PC240LC-7K	PC240NLC-7K
A	Overall length	mm	9,885	9,885
B	Overall height	mm	3,160	3,160
C	Overall width	mm	2,980	3,280
D	Track shoe width	mm	600	700
E	Height of cab	mm	3,015	3,015
F	Tail swing radius	mm	2,940	2,940
G	Track overall length	mm	4,250	4,640
H	Length of track on ground	mm	3,460	3,845
	Min. ground clearance	mm	440	400

**WORKING RANGES**

	Item	Unit	PC240LC-7K	PC240NLC-7K
A	Max. digging reach	mm	10,180	10,180
B	Max. digging depth	mm	6,920	6,920
C	Max. digging height	mm	10,000	10,000
D	Max. vertical wall depth	mm	6,010	6,010
E	Max. dumping height	mm	7,035	7,035
F	Min. dumping height	mm	2,530	2,530
G	Max. reach at ground level	mm	10,020	10,020

## SPECIFICATIONS

## PC210-7K, PC210LC-7K, PC210NLC-7K

Machine model			PC210-7K	PC210LC-7K	PC210NLC-7K
Serial Number			K40001 and up		
Bucket capacity		m <sup>3</sup>	0.8		
Operating weight		kg	19,300	20,700	
Working ranges	Max. digging depth	mm	6,620		
	Max. vertical wall depth	mm	5,980		
	Max. digging reach	mm	9,875		
	Max. reach at ground level	mm	9,700		
	Max. digging height	mm	10,000		
	Max. dumping height	mm	7,110		
Performance	Max. digging force (using power max. function)	kN {kg}	138.3 {14,100} (149.1 {15,200})		
	Swing speed	rpm	12.4		
	Swing max. slope angle	deg.	20		
	Travel speed	km/h	Lo: 3.0 (※ Mi: 4.1) Hi: 5.5		
	Gradeability	deg.	35		
	Ground pressure [standard shoe width]	kPa {kg/cm <sup>2</sup> } [mm]	36.3 {0.37} [700]		
	Dimensions	Overall length (for transport)	mm	9,425	9,425
Overall width		mm	2,800	3,080	2,540
Overall width of track		mm	2,800	3,080	2,540
Overall height (for transport)		mm	3,000	3,000	3,000
Overall height to chassis		mm	3,000	3,000	3,000
Ground clearance to bottom of upper structure		mm	1,085	1,085	1,085
Min. ground clearance		mm	440	440	440
Tail swing radius		mm	2,750	2,750	2,750
Min. swing radius of work equipment		mm	3,040	3,040	3,040
Height of work equipment at min. swing radius		mm	8,005	8,005	8,005
Length of track on ground		mm	3,270	3,655	3,655
Track gauge		mm	2,200	2,380	2,040
Height of machine cab		mm	2,335	2,335	2,335

※ : The "Mi" mode is on the multi-monitor specification machine only.

Machine model		PC210-7K	PC210LC-7K	PC210NLC-7K		
Serial Number		K40001 and up				
Engine	Model Type	SAA6D102E-2-A 4-cycle, water-cooled, in-line, vertical, direct injection, with turbo charger				
	No. of cylinders - bore x stroke Piston displacement	mm l {cc}	6 - 102 x 120 5.883 {5,883}			
	Performance	Flywheel horsepower	kW/rpm {HP/ rpm}	106.7/1,950 {143/1,950}		
		Max. torque	Nm/rpm {kgm/ rpm}	610.0/1,500 {62.2/1,500}		
		Max. speed at no load	rpm	2,150		
Min. speed at no load		rpm	1,030			
Min. fuel consumption	rpm g/kWh {g/HPh}	215 {160}				
Starting motor		24V, 4.5 kW				
Alternator		24V, 35 A				
Battery		12V, 110 Ah x 2				
Radiator core type		Corrugated CWX-4				
Under- carriage	Carrier roller	2 on each side				
	Track roller	7 on each side	9 on each side			
	Track shoe	Assembly-type triple grouser, 45 on each side	Assembly-type triple grouser, 49 on each side			
Hydraulic system	Hydraulic pump	Type x No. Delivery Set pressure	HPV95+95, variable displacement  Piston type: 214 x 2 Piston type: 37.2 {380}			
		Control valve	Type x No. Control method	6-spool type x 1 Hydraulic		
	Hydraulic motor		Travel motor	HMV110ADT-2, Piston type (with brake valve, parking brake): x 2		
		Swing motor	KMF125ABE-5, Piston type (with safety valve, holding brake): x 1			
	Hydraulic cylinder	Type	Boom	Arm	Bucket	
			Double acting piston	Double acting piston	Double acting piston	
		Inside diameter of cylinder	120	135	115	
		Diameter of piston rod	85	95	80	
Stroke		1,334.5	1,490	1,120		
Max. distance between pins	3,204.5	3,565	2,800			
Min. distance between pins	1,870	2,075	1,680			
Hydraulic tank		Closed box type				
Hydraulic filter		Tank return side				
Hydraulic cooler		CF40-1 (Air cooled)				

## PC240LC-7K, PC240NLC-7K

Machine model			PC240LC-7K	PC240NLC-7K
Serial Number			K40001 and up	
Bucket capacity		m <sup>3</sup>	1.0	1.0
Operating weight		kg	22,700	24,130
Working ranges	Max. digging depth	mm	6,920	6,920
	Max. vertical wall depth	mm	6,010	6,010
	Max. digging reach	mm	10,180	10,180
	Max. reach at ground level	mm	10,020	10,020
	Max. digging height	mm	10,000	10,000
	Max. dumping height	mm	7,035	7,035
Performance	Max. digging force (using power max. function)	kN {kg}	158.9 {16,200} (171.6 {17,500})	158.9 {16,200} (171.6 {17,500})
	Swing speed	rpm	11.7	11.7
	Swing max. slope angle	deg.	25	25
	Travel speed	km/h	Lo: 3.1 (※ Mi: 4.2) Hi: 5.5	Lo: 3.1 (※ Mi: 4.2) Hi: 5.5
	Gradeability	deg.	35	35
	Ground pressure [standard shoe width]	kPa {kg/cm <sup>2</sup> } [mm]	50.0 {0.51} [600]	41.2 {0.42} [700]
	Overall length (for transport)	mm	9,885	9,885
Overall width	mm	2,980	3,280	
Overall width of track	mm	2,980	3,280	
Overall height (for transport)	mm	3,160	3,160	
Overall height to chassis	mm	3,015	3,015	
Ground clearance to bottom of upper structure	mm	1,110	1,110	
Min. ground clearance	mm	440	440	
Tail swing radius	mm	2,940	2,940	
Min. swing radius of work equipment	mm	3,450	3,450	
Height of work equipment at min. swing radius	mm	8,110	8,110	
Length of track on ground	mm	3,460	3,845	
Track gauge	mm	2,380	2,580	
Height of machine cab	mm	2,390	2,390	

※ : The "Mi" mode is on the multi-monitor specification machine only.

Machine model		PC240LC-7K	PC240NLC-7K			
Serial Number		K40001 and up				
Engine	Model		SAA6D102E-2-C			
	Type		4-cycle, water-cooled, in-line, vertical, direct injection, with turbo charger			
	No. of cylinders - bore x stroke	mm	6 - 102 x 120			
	Piston displacement	l {cc}	5.883 {5,883}			
	Performance					
	Flywheel horsepower	kW/rpm {HP/rpm}	125/2,000 {167/2,000}			
	Max. torque	Nm/rpm {kgm/rpm}	686/1,500 {70/1,500}			
	Max. speed at no load	rpm	2,260			
	Min. speed at no load	rpm	1,060			
	Min. fuel consumption	g/kWh {g/HP}	212 {153}			
	Starting motor		24V, 4.5 kW			
	Alternator		24V, 35 A			
	Battery		12V, 110 Ah x 2			
	Radiator core type		Corrugated CF19-5			
Under-carriage	Carrier roller		2 on each side			
	Track roller		8 on each side	10 on each side		
	Track shoe		Assembly-type triple grouser, 47 on each side	Assembly-type triple grouser, 51 on each side		
Hydraulic system	Hydraulic pump	Type x No. Delivery Set pressure	HPV95+95, variable displacement			
		l/min MPa (kg/cm <sup>2</sup> )	Piston type: 214 x 2 Piston type: 37.2 {380}			
	Control valve	Type x No. Control method	6-spool type x 1 Hydraulic			
	Hydraulic motor	Travel motor Swing motor	HMV110ADT-2, Piston type (with brake valve, parking brake): x 2 KMF125ABE-5, Piston type (with safety valve, holding brake): x 1			
	Hydraulic cylinder	Type		Boom	Arm	Bucket
				Double acting piston	Double acting piston	Double acting piston
		Inside diameter of cylinder	mm	130	140	130
Diameter of piston rod		mm	90	100	90	
Stroke		mm	1,335	1,635	1,020	
Max. distance between pins	mm	3,205	2,235	2,625		
Min. distance between pins	mm	1,870	3,870	1,605		
	Hydraulic tank		Closed box type			
	Hydraulic filter		Tank return side			
	Hydraulic cooler		CF40-1 (Air cooled)			

**WEIGHT TABLE****PC210-7K, PC210LC-7K, PC210NLC-7K**

This weight table is for use when handling components or when transporting the machine.

Unit: kg

Machine model	PC210-7K	PC210LC-7K	PC210NLC-7K
Serial Number	K40001 and up		
Engine assembly	749		
• Engine	598		
• Damper	6		
• Hydraulic pump	145		
Radiator oil cooler assembly	110		
Hydraulic tank, filter assembly (excluding hydraulic oil)	123		
Fuel tank (excluding fuel)	121		
Revolving frame	1,729		
Operator's cab	278		
Operator's seat	35		
Counterweight	3,735		
Swing machinery	160		
Control valve	263		
Swing motor	60		
Travel motor	98 x 2		
Center swivel joint	36		
Track frame assembly	4,712		
• Track frame	2,534		
• Swing circle	273		
• Idler	99 x 2		
• Idler cushion	135 x 2		
• Carrier roller	16 x 4		
• Track roller	36 x 18		
• Final drive (including travel motor)	343 x 2		



Unit: kg

Machine model	PC210-7K	PC210LC-7K	PC210NLC-7K
Serial Number	K40001 and up		
Track shoe assembly			
• Standard triple grouser shoe (600 mm)	1,215x2	1,325 x 2	1,325 x 2
• Standard triple grouser shoe (700 mm)	1,405x5	1,530 x 2	1,530 x 2
• Wide triple grouser shoe (800 mm)	1,530x2	1,670 x 2	-
• Road liner (rubber pad type) (600 mm)	1,470x2	1,600 x	-
Boom assembly	1,408		
Arm assembly	653		
Bucket assembly	628		
Boom cylinder assembly	172 x 2		
Arm cylinder assembly	226		
Bucket cylinder assembly	136		
Link assembly (large)	81		
Link assembly (small)	22 x 2		
Boom pin	48 + 8 x 2 + 31 + 10 + 26		
Arm pin	11 + 8		
Bucket pin	20 x 2		
Link pin	13 x 2		

**PC240LC-7K, PC240NLC-7K**

Unit: kg

Machine model	PC240LC-7K	PC240NLC-7K
Serial Number	K40001 and up	K40001 and up
Engine assembly	749	749
• Engine	598	598
• Damper	6	6
• Hydraulic pump	145	145
Radiator oil cooler assembly	119	119
Hydraulic tank, filter assembly (excluding hydraulic oil)	123	123
Fuel tank (excluding fuel)	121	121
Revolving frame	2,048	2,048
Operator's cab	278	278
Operator's seat	35	35
Counterweight	5,056	5,056
Swing machinery	237	237
Control valve	263	263
Swing motor	60	60
Travel motor	98 x 2	98 x 2
Center swivel joint	36	36
Track frame assembly	4,828	5,460
• Track frame	2,558	3,046
• Swing circle	293	293
• Idler	99 x 2	99 x 2
• Idler cushion	135 x 2	135 x 2
• Carrier roller	16 x 4	16 x 4
• Track roller	36 x 16	36 x 20
• Final drive (including travel motor)	362 x 2	362 x 2

Unit: kg

Machine model	PC240LC-7K	PC240NLC-7K
Serial Number	K40001 and up	K40001 and up
Track shoe assembly		
• Standard triple grouser shoe (600 mm)	1,340 x 2	1,455 x 2
• Standard triple grouser shoe (700 mm)	1,470 x 2	1,595 x 2
• Wide triple grouser shoe (800 mm)	1,600 x 2	1,735 x 2
• Road liner (rubber pad type) (600 mm)	1,535 x 2	1,665 x 2
Boom assembly	1,825	1,825
Arm assembly	1,213	1,213
Bucket assembly	722	722
Boom cylinder assembly	195 x 2	195 x 2
Arm cylinder assembly	262	262
Bucket cylinder assembly	161	161
Link assembly (large)	82	82
Link assembly (small)	22 x 2	22 x 2
Boom pin	50 + 10 x 2 + 31 + 10 + 26	50 + 10 x 2 + 31 + 10 + 26
Arm pin	11 + 10	11 + 10
Bucket pin	20 x 2	20 x 2
Link pin	17 x 2	17 x 2

# FUEL, COOLANT, AND LUBRICANTS

RESERVOIR	KIND OF FLUID	AMBIENT TEMPERATURE								CAPACITY (l)	
		-22 -30	-4 -20	14 -10	32 0	50 10	68 20	86 30	104°F 40°C	Specified	Refill
Engine oil pan	Engine oil								SAE 30	26.3	24
									SAE 10W		
									SAE 10W-30		
									SAE 15W-40		
Damper case										0.75	—
Swing machinery case										6.6	6.6
Final drive case (each side)									SAE 30	4.7	4.5
Idler (1 each)									0.07-0.08	0.07-0.08	
Track roller (1 each)									0.19-0.20	0.19-0.20	
Carrier roller (1 each)									0.075-0.085	0.075-0.085	
Hydraulic system	Engine oil								SAE 10W	240	143
									SAE 10W-30		
									SAE 15W-40		
	Hydraulic oil								H046-HM (★)		
Fuel tank	Diesel fuel								ASTM D975 No. 2	400	—
									ASTM D975A No.1		
Cooling system	Coolant	Add antifreeze								PC210, PC210LC, PC210NLC-7	PC210, PC210LC, PC210NLC-7
											22.4
										PC240LC, PC240NLC-7	PC240LC, PC240NLC-7
										30.9	30.9

★ For the H-046-HM, use the oil recommended by Komatsu.