

Shop Manual

HYDRAULIC
EXCAVATOR

PC1250 -8

PC1250SP-8

PC1250LC -8

SERIAL NUMBERS PC1250- 30001
 PC1250SP- 30001 and up
 PC1250LC- 30001

ecot3

KOMATSU

HYDRAULIC EXCAVATOR

PC1250-8
PC1250SP-8
PC1250LC-8

Machine model Serial number

PC1250-8	30001 and up
PC1250SP-8	30001 and up
PC1250LC-8	30001 and up

00 Index and foreword

Index

Composition of shop manual	2
Table of contents	4

Composition of shop manual

The contents of this shop manual are shown together with Form No. in a list.

Note 1: Always keep the latest version of this manual in accordance with this list and utilize accordingly.

The marks shown to the right of Form No. denote the following:

○: New issue (to be filed additionally) ●: Revision (to be replaced for each Form No.)

Note 2: This shop manual can be supplied for each Form No.

Note 3: To file this shop manual in the special binder for management, handle it as follows:

- Place a divider on the top of each section in the file after matching the Tab No. with No. indicated next to each Section Name shown in the table below:
- File overview and other materials in sections in the order shown below and utilize them accordingly.

Section Title	Form Number
Shop Manual, contents binder, binder label and tabs	SEN00889-17
00 Index and foreword	SEN00890-17
Index	SEN00891-17 ●
Foreword and general information	SEN00892-04 ●
01 Specification.....	SEN00893-01
Specification and technical data.....	SEN00894-01
10 Structure, function and maintenance standard	SEN00895-07
Engine and cooling system.....	SEN00896-01
Power train.....	SEN00897-01
Undercarriage and frame	SEN00898-01
Air system	SEN00899-00
Hydraulic system, Part 1	SEN00900-01
Hydraulic system, Part 2	SEN00901-02
Work equipment.....	SEN00902-00
Cab and its attachments	SEN00903-00
Electrical system	SEN00904-05
20 Standard value table	SEN00905-04
Standard service value table.....	SEN01631-04
30 Testing and adjusting	SEN00906-06
Testing and adjusting, Part 1.....	SEN01632-04
Testing and adjusting, Part 2.....	SEN01633-02
Testing and adjusting, Part 3.....	SEN01634-02
Testing and adjusting, Part 4.....	SEN01635-05
Testing and adjusting, Part 5.....	SEN01636-01
Testing and adjusting, Part 6.....	SEN01674-02

40 Troubleshooting	SEN00907-04
Failure code table and fuse locations	SEN01638-01
General information on troubleshooting.....	SEN01637-04
Troubleshooting by failure code (Display of code), Part 1	SEN01639-01
Troubleshooting by failure code (Display of code), Part 2	SEN01640-02
Troubleshooting by failure code (Display of code), Part 3	SEN01641-00
Troubleshooting by failure code (Display of code), Part 4	SEN01642-00
Troubleshooting of electrical system (E-mode).....	SEN01643-01
Troubleshooting of hydraulic and mechanical system (H-mode)	SEN01644-00
Troubleshooting of engine (S-mode)	SEN01645-02
50 Disassembly and assembly	SEN00908-05
General information on disassembly and assembly	SEN01195-03
Engine and cooling system, Part 1	SEN01197-03
Engine and cooling system, Part 2	SEN01196-02
Power train.....	SEN01198-03
Undercarriage and frame	SEN01199-04
Hydraulic system	SEN01200-03
Work equipment.....	SEN01201-02
Cab and its attachments	SEN01202-01
Electrical system.....	SEN01203-02
90 Diagrams and drawings	SEN00909-06
Hydraulic circuit diagrams.....	SEN00910-02
Electrical diagrams and drawings	SEN00911-04

Table of contents

00 Index and foreword	
Index	SEN00891-17
Composition of shop manual	2
Table of contents.....	4
Foreword and general information	SEN00892-04
Safety notice	2
How to read the shop manual.....	7
Explanation of terms for maintenance standard	9
Handling of electric equipment and hydraulic component	11
Handling of connectors newly used for engines	20
How to read electric wire code.....	23
Precautions when carrying out operation	26
Method of disassembling and connecting push-pull type coupler	29
Standard tightening torque table.....	32
Conversion table.....	36
01 Specification	
Specification and technical data	SEN00894-01
Backhoe specification	2
Loading shovel specification.....	4
Specifications.....	6
Weight table	22
Table of fuel, coolant and lubricants	30
10 Structure, function and maintenance standard	
Engine and cooling system	SEN00896-01
PTO	2
PTO lubrication system.....	4
Radiator and oil cooler.....	6
Power train	SEN00897-01
Power train.....	2
Swing machinery	4
Swing circle.....	8
Final drive	9
Sprocket.....	12
Undercarriage and frame	SEN00898-01
Track frame, recoil spring	2
Idler.....	4
Carrier roller.....	6
Track roller	7
Track shoe	8
Air system	SEN00899-00
Air piping drawing	2
Air circuit diagram	3
Air governor	4
Air tank.....	5
Safety valve	6
Horn valve.....	7
Grease pump.....	8

Hydraulic system, Part 1	SEN00900-01
Hydraulic piping drawing	2
Hydraulic tank	5
Hydraulic pump	7
Line oil filter	48
Pilot oil filter	49
Return oil filter	50
Drain oil filter	51
Cooling fan pump	52
Cooling fan motor	66
Aftercooler fan motor	72
Hydraulic system, Part 2	SEN00901-02
Control valve	2
Swing motor	17
Center swivel joint	26
Travel motor	27
PPC control relief valve	37
Accumulator	38
Valve control	39
PPC valve	40
Solenoid valve	50
Hydraulic cylinder	58
Work equipment	SEN00902-00
Work equipment	2
Dimensions of work equipment	6
Cab and its attachments	SEN00903-00
Air conditioner	2
Electrical system	SEN00904-05
Engine control	2
Electric control system	9
Monitor system	45
Sensor	68
20 Standard value table	
Standard service value table	SEN01631-04
Standard value table for engine related parts	2
Standard value table for chassis related parts	3
30 Testing and adjusting	
Testing and adjusting, Part 1	SEN01632-04
Tools for testing, adjusting, and troubleshooting	3
Sketch of special tool	8
Testing engine speed	9
Testing air supply pressure (Boost pressure)	10
Testing exhaust temperature	11
Testing exhaust color	12
Testing and adjusting valve clearance	14
Testing compression pressure	16
Testing blow-by pressure	19
Testing engine oil pressure	20
Testing EGR valve and bypass valve drive oil pressure	21
Adjusting engine speed sensor	23
Handling fuel system parts	24
Releasing residual pressure in fuel system	24
Testing fuel pressure	25
Testing fuel return rate and fuel leakage	26
Bleeding air from fuel circuit	29

Testing fuel system for leakage	31
Procedure for checking alternator and replacing belt	32
Testing and adjusting, Part 2	SEN01633-02
Testing swing circle bearing clearance	2
Testing wear of sprocket	3
Testing and adjusting track shoe tension	4
Testing and adjusting hydraulic pressure in work equipment, swing, travel circuit	5
Testing and adjusting control circuit oil pressure	19
Testing and adjusting piston pump control pressure	21
Testing servo piston stroke	28
Testing and adjusting, Part 3	SEN01634-02
Measuring PPC valve output pressure and testing swing PPC shuttle valve	2
Measuring solenoid valve output pressure	6
Adjusting work equipment, swing PPC valve	8
Testing travel deviation	9
Testing locations causing hydraulic drift of work equipment	10
Measuring oil leakage	11
Measurement of fan speed	19
Measurement of fan circuit oil pressure	20
Measuring fan pump EPC solenoid valve output pressure	22
Bleeding air	23
Releasing remaining pressure in hydraulic circuit	25
Testing procedures for diode	26
Testing and adjusting, Part 4	SEN01635-05
Special function of machine monitor	2
Handling controller voltage circuit	42
Testing and adjusting, Part 5	SEN01636-01
VHMS controller initial setting procedure	2
Precautions for replacing VHMS controller	17
Testing and adjusting, Part 6	SEN01674-02
Pm-clinic service	2
40 Troubleshooting	
Failure code table and fuse locations	SEN01638-01
Failure code table	2
Fuse locations	7
General information on troubleshooting	SEN01637-04
Points to remember when troubleshooting	2
Sequence of events in troubleshooting	3
Checks before troubleshooting	4
Classification and troubleshooting steps	5
Information in troubleshooting table	9
Connection table for connector pin numbers	11
T- branch box and T- branch adapter table	47
Troubleshooting by failure code (Display of code), Part 1	SEN01639-01
Failure code [A000N1] Eng. Hi Out of Std	3
Failure code [AA10NX] Aircleaner Clogging	4
Failure code [AB00KE] Charge Voltage Low	6
Failure code [B@BAZG] Eng. Oil Press. Low	8
Failure code [B@BAZK] Eng. Oil Level Low	10
Failure code [B@BCNS] Eng. Water Overheat	12
Failure code [B@BCZK] Eng. Water Lvl Low	14
Failure code [B@CBNS] High PTO temperature	16
Failure code [B@HANS] Hydr. Oil Overheat	18
Failure code [CA111] ECM Critical Internal Failure	19
Failure code [CA115] Eng Ne and Bkup Speed Sens Error	21
Failure code [CA122] Chg Air Press Sensor High Error	22

Failure code [CA123] Chg Air Press Sensor Low Error.....	24
Failure code [CA131] Throttle Sensor High Error.....	25
Failure code [CA132] Throttle Sensor Low Error.....	27
Failure code [CA135] Eng Oil Press Sensor High Error.....	28
Failure code [CA141] Eng Oil Press Sensor Low Error.....	30
Failure code [CA144] Coolant Temp Sens High Error.....	31
Failure code [CA145] Coolant Temp Sens Low Error.....	33
Failure code [CA153] Chg Air Temp Sensor High Error.....	34
Failure code [CA154] Chg Air Temp Sensor Low Error.....	36
Failure code [CA187] Sens Supply 2 Volt Low Error.....	37
Failure code [CA212] Oil Temp. Sensor High Error.....	38
Failure code [CA213] Oil Temp. Sensor Low Error.....	40
Failure code [CA221] Ambient Press Sens High Error.....	41
Failure code [CA222] Ambient Press Sens Low Error.....	43
Failure code [CA227] Sens Supply 2 Volt High Error.....	44
Failure code [CA234] Eng Overspeed.....	46
Failure code [CA238] Ne Speed Sens Supply Volt Error.....	48
Failure code [CA263] Fuel Temp Sensor High Error.....	50
Failure code [CA265] Fuel Temp Sensor Low Error.....	52
Failure code [CA271] IMV/PCV1 Short Error.....	53
Failure code [CA272] IMV/PCV1 Open Error.....	54
Failure code [CA273] PCV2 Short Error.....	56
Failure code [CA274] PCV2 Open Error.....	57
Failure code [CA322] Inj #1 (L#1) Open/Short Error.....	58
Failure code [CA323] Inj #5 (L#5) Open/Short Error.....	60
Failure code [CA324] Inj #3 (L#3) Open/Short Error.....	62
Failure code [CA325] Inj #6 (L#6) Open/Short Error.....	64
Failure code [CA331] Inj #2 (L#2) Open/Short Error.....	66
Failure code [CA332] Inj #4 (L#4) Open/Short Error.....	68
Failure code [CA342] Calibration Code Incompatibility.....	70
Failure code [CA351] Injectors Drive Circuit Error.....	72
Troubleshooting by failure code (Display of code), Part 2	SEN01640-02
Failure code [CA352] Sens Supply 1 Volt Low Error.....	3
Failure code [CA386] Sensor Sup. 1 Volt. High Error.....	4
Failure code [CA441] Battery Voltage Low Error.....	6
Failure code [CA442] Battery Voltage High Error.....	6
Failure code [CA449] Rail Press Very High Error.....	7
Failure code [CA451] Rail Press Sensor High Error.....	8
Failure code [CA452] Rail Press Sensor Low Error.....	10
Failure code [CA553] Rail Press High Error.....	10
Failure code [CA554] Rail Press Sensor In Range Error.....	11
Failure code [CA559] Rail Press Low Error.....	12
Failure code [CA689] Eng Ne Speed Sensor Error.....	16
Failure code [CA731] Eng Bkup Speed Sens Phase Error.....	18
Failure code [CA757] All Persistent Data Lost Error.....	19
Failure code [CA778] Eng Bkup Speed Sensor Error.....	20
Failure code [CA1228] EGR Valve Servo Error 1.....	22
Failure code [CA1625] EGR Valve Servo Error 2.....	23
Failure code [CA1626] BP Valve Sol Current High Error.....	24
Failure code [CA1627] BP Valve Sol Current Low Error.....	26
Failure code [CA1628] Bypass Valve Servo Error 1.....	27
Failure code [CA1629] Bypass Valve Servo Error 2.....	28
Failure code [CA1631] BP Valve Pos Sens High Error.....	29
Failure code [CA1632] BP Valve Pos Sens Low Error.....	31
Failure code [CA1633] KOMNET Datalink Timeout Error.....	32
Failure code [CA2185] Throt Sens Sup Volt High Error.....	34
Failure code [CA2186] Throt Sens Sup Volt Low Error.....	36
Failure code [CA2249] Rail Press Very Low Error.....	37

Failure code [CA2271] EGR Valve Pos Sens High Error.....	38
Failure code [CA2272] EGR Valve Pos Sens Low Error	40
Failure code [CA2351] EGR Valve Sol Current High Error	42
Failure code [CA2352] EGR Valve Sol Current Low Error.....	44
Failure code [CA2555] Grid Htr Relay Volt Low Error.....	45
Failure code [CA2556] Grid Htr Relay Volt High Error.....	46
Failure code [D110KB] Battery Relay Drive S/C.....	48
Failure code [D163KB] Flash Light Relay S/C.....	50
Failure code [D195KB] Step Light Relay S/C	52
Failure code [DA22KK] Solenoid: Source voltage reduction	54
Failure code [DA25KP] Press. Sensor Power Abnormality	56
Failure code [DA2SKQ] Model selection Abnormality	58
Failure code [DA80MA] Auto. Lub. Abnormal.....	60
Failure code [DA2RMC] Pump Comm. Abnormality.....	62
Failure code [DAFRMC] Monitor Comm. Abnormality.....	64
Troubleshooting by failure code (Display of code), Part 3	SEN01641-00
Failure code [DBB0KK] VHMS source voltage Error (or change of VHMS-LED display from n9 to 01)	4
Failure code [DBB0KQ] VHMS Connector Mismatch (or change of VHMS-LED display from nf to 11).....	6
Failure code [DBB3KK] Abnormality in VBAT voltage (or change of VHMS-LED display from n9 to 05)	8
Failure code [DBB5KP] VHMS 5V source sys Error (or change of VHMS-LED display from n9 to 04)	10
Failure code [DBB6KP] VHMS 24V source sys Error (or change of VHMS-LED display from n9 to 02)	12
Failure code [DBBQKR] KOM-NET/c error (or change of VHMS-LED display from n8 to 02)	14
Failure code [DGE5KB] Ambi. Temp. Sensor S/C.....	16
Failure code [DGH2KB] Hydr. Oil Temp. Sensor S/C	17
Failure code [DGT3KZ] PTO Temp Sensor Failure (or change of VHMS-LED display from n5 to 01)	18
Failure code [DGT4KA] F Exhaust Temp. Sensor Failure (or change of VHMS-LED display from n3 to 12)	20
Failure code [DGT4KB] F Exhaust Temp. Sensor Failure (or change of VHMS-LED display from n3 to 11).....	22
Failure code [DGT5KA] R Exhaust Temp. Sensor Failure (or change of VHMS-LED display from n3 to 22)	24
Failure code [DGT5KB] R Exhaust Temp. Sensor Failure (or change of VHMS-LED display from n3 to 21)	26
Failure code [DHE5KB] Blowby Pres. Sensor Failure (or change of VHMS-LED display from n3 to 32)	28
Failure code [DHE5KY] Blowby Pres. Sensor Failure) (or change of VHMS-LED display from n3 to 31)	30
Failure code [DHPAMA] F Pump P. Sensor Abnormality.....	32
Failure code [DHPAZL] F Pump Relief Pressure Abnormality	34
Failure code [DHPBMA] R Pump P. Sensor Abnormality	36
Failure code [DHPBZL] R Pump Relief Pressure Abnormality	38
Failure code [DHPTKA] Fan Pump Pre. Sens Failure (or change of VHMS-LED display from n5 to 23)	40
Failure code [DHPTKB] Fan Pump Pre. Sens Failure (or change of VHMS-LED display from n5 to 24)	42
Failure code [DV20KB] Travel Alarm S/C.....	44
Failure code [DW41KA] Swing Priority Sol. Disc.....	46
Failure code [DW41KB] Swing Priority Sol. S/C.....	48
Failure code [DW43KA] Travel Speed Sol. Disc.....	50
Failure code [DW43KB] Travel Speed Sol. S/C.....	52
Failure code [DW45KA] Swing Brake Sol. Disc.....	54
Failure code [DW45KB] Swing Brake Sol. S/C.....	56

Failure code [DW48KA] CO Cancel Sol. Disc.	58
Failure code [DW48KB] CO Cancel Sol. S/C	60
Troubleshooting by failure code (Display of code), Part 4	SEN01642-00
Failure code [DW7BKA] Fan Reverse Sol. Disc.	4
Failure code [DW7BKB] Fan Reverse Sol. S/C	6
Failure code [DW91KA] Travel Junction Sol. Disc.	8
Failure code [DW91KB] Travel Junction Sol. S/C	10
Failure code [DWK0KA] 2-stage Relief Sol. Disc.	12
Failure code [DWK0KB] 2-stage Relief Sol. S/C	14
Failure code [DX16KA] Fan Pump EPC Sol. Disc.	16
Failure code [DX16KB] Fan Pump EPC Sol. S/C	18
Failure code [DXA0KA] TVC Sol. Disc.	20
Failure code [DXA0KB] TVC Sol. S/C	22
Failure code [DY20KA] Wiper Working Abnormality	24
Failure code [DY20MA] Wiper Parking Abnormality	26
Failure code [DY2CKB] Washer Drive S/C	30
Failure code [DY2DKB] Wiper Drive (For) S/C	32
Failure code [DY2EKB] Wiper Drive (Rev) S/C	36
Failure code [F@BBZL] High Blowby Pressure (or change of VHMS-LED display from n3 to 38)	38
Failure code [F@BYNR] High F cyl. Exhaust Temp. 2 (or change of VHMS-LED display from n3 to 62)	40
Failure code [F@BYNS] High F cyl. Exhaust Temp. 1 (or change of VHMS-LED display from n3 to 61)	42
Failure code [F@BZNR] High R cyl. Exhaust Temp. 2 (or change of VHMS-LED display from n3 to 72)	44
Failure code [F@BZNS] High R cyl. Exhaust Temp. 1 (or change of VHMS-LED display from n3 to 71)	46
Failure code [F@HCMA] Swing Pump Pres. Sen. Abnormality	48
Failure code [F@HCZL] Swing Pump Relief Pres. Abnormality	50
Failure code [J100KA] Cnt. Pump Pre. Sens Failure (or change of VHMS-LED display from n5 to 11)	52
Failure code [j100KA] Fan Pump Pre. Sens Failure (or change of VHMS-LED display from n5 to 21)	54
Failure code [J100KB] Cnt. Pump Pre. Sens Failure (or change of VHMS-LED display from n5 to 12)	56
Failure code [j100KB] Fan Pump Pre. Sens Failure (or change of VHMS-LED display from n5 to 22)	58
Failure code [J100L6] Abnormal Cnt. gear pump press (or change of VHMS-LED display from n5 to 71)	60
Failure code [j100L6] Abnormal Fan gear pump press (or change of VHMS-LED display from n5 to 81)	62
Failure code [LA10ZL] Fan Pump Relief Press Abnormality (or change of VHMS-LED display from n5 to 25)	64
Troubleshooting of electrical system (E-mode)	SEN01643-01
Before carrying out troubleshooting of electrical system	3
Information contained in troubleshooting table	5
E-1 Engine does not start (Engine does not rotate)	6
E-2 Auto-decelerator does not work	10
E-3 Auto engine warm-up device does not work	12
E-4 Preheater does not work	14
E-5 All work equipment, swing and travel do not move	16
E-6 Machine push-up circuit does not work	18
E-7 Boom shockless circuit cannot be reset	20
E-8 No display in machine monitor at all	22
E-9 Part of display on machine monitor is missing	24
E-10 Machine monitor displays contents irrelevant to the model	24
E-11 Fuel level monitor red lamp lights up while engine is running	25

E-12 Hydraulic oil temperature gauge does not display correctly.....	26
E-13 Fuel gauge does not display correctly.....	27
E-14 Swing lock monitor does not display correctly	28
E-15 When the monitor switch is operated, no display appears.....	30
E-16 Windshield wiper does not work.....	32
E-17 "Boom RAISE" is not correctly displayed in monitor function.....	34
E-18 "Boom LOWER" is not correctly displayed in monitor function	35
E-19 "Arm DIGGING" is not correctly displayed in monitor function.....	36
E-20 "Arm DUMPING" is not correctly displayed in monitor function	37
E-21 "Bucket CURL" is not correctly displayed in monitor function	38
E-22 "Bucket DUMPING" is not correctly displayed in monitor function	39
E-23 "SWING" is not correctly displayed in monitor function.....	40
E-24 "TRAVEL" is not correctly displayed in monitor function	42
E-25 Air conditioner does not work.....	44
E-26 Travel alarm does not sound.....	46
E-27 Any of panel lamp, head lamp, working lamp (including additional lamp) does not light up.....	47
E-28 Step light does not light up or go off.....	51
E-29 Electric priming pump does not operate or does not stop automatically	54
Troubleshooting of hydraulic and mechanical system (H-mode)	SEN01644-00
Before troubleshooting for hydraulic and mechanical systems.....	3
H-1 Speed or power of all work equipment, travel, and swing is low	9
H-2 Engine speed lowers remarkably or engine stalls.....	11
H-3 All work equipment, travel, and swing systems do not work.....	12
H-4 Abnormal sound is heard from around pump.....	14
H-5 Speed or power of boom is low.....	15
H-6 Speed or power of arm is low.....	17
H-7 Speed or power of bucket is low	18
H-8 Boom does not move	19
H-9 Arm does not move.....	20
H-10 Bucket does not move	21
H-11 Hydraulic drift of work equipment is large	22
H-12 Time lag of work equipment is large	23
H-13 Boom shockless function cannot be turned ON or OFF	24
H-14 Machine deviates in one direction.....	24
H-15 Machine deviates largely at start	26
H-16 Machine deviates largely during compound operation.....	27
H-17 Travel speed or power is low	27
H-18 Machine does not travel (only one track).....	28
H-19 Travel speed does not change.....	29
H-20 Machine does not swing	30
H-21 Swing speed or acceleration is low.....	31
H-22 Swing speed or power is low in compound operation of travel and bucket	32
H-23 Swing speed or power is low in compound operation of travel and boom in swing priority mode.....	32
H-24 Upper structure overruns largely.....	33
H-25 Large shocks are made when upper structure stops swinging	34
H-26 Large abnormal sounds are made when upper structure stops swinging.....	35
H-27 Hydraulic drift of swing is large	36
H-28 Fan revolution is abnormal (Sound and vibration of the fan is abnormally large, and the fan is overheated).....	37
Troubleshooting of engine (S-mode)	SEN01645-02
Method of using troubleshooting chart.....	3
S-1 Starting performance is poor	6
S-2 Engine does not start	8
S-3 Engine does not pick up smoothly	12
S-4 Engine stops during operations.....	13
S-5 Engine does not rotate smoothly.....	14

S-6 Engine lacks output (or lacks power)	15
S-7 Exhaust smoke is black (incomplete combustion)	16
S-8 Oil consumption is excessive (or exhaust smoke is blue).....	17
S-9 Oil becomes contaminated quickly	18
S-10 Fuel consumption is excessive	19
S-11 Oil is in coolant (or coolant spurts back or coolant level goes down).....	20
S-12 Oil pressure drops.....	21
S-13 Oil level rises (Entry of coolant or fuel)	22
S-14 Coolant temperature becomes too high (overheating).....	24
S-15 Abnormal noise is made	25
S-16 Vibration is excessive	26
S-17 Air cannot be bled from fuel circuit.....	28
50 Disassembly and assembly	
General information on disassembly and assembly	SEN01195-03
How to read this manual	2
Coating materials list	4
Special tools list	7
Sketches of special tools	15
Engine and cooling system, Part 1	SEN01197-03
Removal and installation of fuel supply pump assembly	2
Removal and installation of cylinder head assembly	8
Removal and installation of fuel injector assembly	26
Removal and installation of engine front seal	31
Removal and installation of engine rear seal.....	33
Engine and cooling system, Part 2	SEN01196-02
Removal and installation of engine, PTO and hydraulic pump assembly	2
Removal and installation of radiator and hydraulic oil cooler assembly	11
Removal of air aftercooler assembly	15
Removal and installation of fuel cooler and air conditioner condenser assembly	17
Removal and installation of fan motor assembly	19
Removal and installation of fuel tank assembly.....	24
Power train	SEN01198-03
Removal and installation of PTO assembly	2
Disassembly and assembly of PTO assembly.....	4
Removal and installation of swing machinery assembly	8
Removal and installation of swing motor and swing machinery assembly	10
Disassembly and assembly of swing machinery assembly	13
Disassembly and assembly of swing motor and swing machinery assembly.....	20
Removal and installation of swing circle assembly	27
Disassembly and assembly of final drive assembly	28
Undercarriage and frame	SEN01199-04
Removal and installation of track shoe assembly.....	2
Disassembly and assembly of one link in field	4
Removal and installation of idler assembly	8
Disassembly and assembly of idler assembly	9
Disassembly and assembly of idler adjustment cylinder assembly	12
Removal and installation of recoil spring assembly	13
Disassembly and assembly of recoil spring assembly	15
Removal and installation of track roller assembly	17
Disassembly and assembly of track roller assembly	18
Removal and installation of carrier roller assembly	21
Disassembly and assembly of carrier roller assembly.....	22
Removal and installation of revolving frame assembly.....	24
Removal and installation of counterweight assembly	25

Hydraulic system	SEN01200-03
Removal and installation of hydraulic tank assembly	2
Removal and installation of hydraulic pump assembly	4
Removal and installation of main pump input shaft oil seal	10
Removal and installation of 5-spool control valve assembly (No. 1)	11
Removal and installation of 4-spool control valve assembly (No. 2)	13
Removal and installation of 4-spool control valve assembly (No. 3)	15
Disassembly and assembly of control valve assembly (No. 1)	17
Disassembly and assembly of control valve assembly (No. 2)	20
Disassembly and assembly of control valve assembly (No. 3)	24
Removal and installation of swing motor assembly	28
Removal and installation of center swivel joint assembly	32
Disassembly and assembly of center swivel joint assembly	33
Removal and installation of travel motor assembly	35
Disassembly and assembly of work equipment PPC valve assembly	36
Disassembly and assembly of travel PPC valve assembly	38
Disassembly and assembly of hydraulic cylinder assembly	41
Work equipment	SEN01201-02
Removal and installation of bucket cylinder assembly	2
Removal and installation of bottom dump cylinder assembly	6
Removal and installation of arm cylinder assembly	8
Removal and installation of boom cylinder assembly	12
Removal and installation of bucket assembly	16
Removal and installation of arm assembly	20
Removal and installation of boom assembly	23
Cab and its attachments	SEN01202-01
Removal and installation of operator cab assembly	2
Removal and installation of operator's cab glass (Stuck glass)	5
Removal and installation of front window assembly	15
Electrical system	SEN01203-02
Removal and installation of air conditioner unit assembly	2
Removal and installation of monitor assembly	5
Removal and installation of pump controller assembly	6
Removal and installation of Orbcomm terminal assembly for VHMS	7
Removal and installation of VHMS controller assembly	8
Removal and installation of engine controller assembly	9
90 Diagrams and drawings	
Hydraulic circuit diagrams	SEN00910-02
Hydraulic circuit diagram (1/2) Serial number 30001 – 30051	3
Hydraulic circuit diagram (2/2) Serial number 30001 – 30051	5
Hydraulic circuit diagram (1/3) Serial number 30052 and up	7
Hydraulic circuit diagram (2/3) Serial number 30052 and up	9
Hydraulic circuit diagram (3/3) Serial number 30052 and up	11
Electrical diagrams and drawings	SEN00911-04
Electrical circuit diagram (1/7)	3
Electrical circuit diagram (2/7)	5
Electrical circuit diagram (3/7)	7
Electrical circuit diagram (4/7)	9
Electrical circuit diagram (5/7)	11
Electrical circuit diagram (6/7)	13
Electrical circuit diagram (7/7)	15
Connector arrangement diagram	17

PC1250-8, PC1250SP-8, PC1250LC-8 Hydraulic excavator

Form No. SEN00891-17

© 2012 KOMATSU
All Rights Reserved
Printed in Japan 02-12

HYDRAULIC EXCAVATOR

PC1250-8 PC1250SP-8 PC1250LC-8

Machine model Serial number

PC1250-8	30001 and up
PC1250SP-8	30001 and up
PC1250LC-8	30001 and up

00 Index and foreword

Foreword and general information

Safety notice	2
How to read the shop manual	7
Explanation of terms for maintenance standard	9
Handling of electric equipment and hydraulic component	11
Handling of connectors newly used for engines	20
How to read electric wire code	23
Precautions when carrying out operation.....	26
Method of disassembling and connecting push-pull type coupler.....	29
Standard tightening torque table	32
Conversion table	36

Safety notice

Important safety notice

Proper service and repair are extremely important for safe machine operation. The service and repair techniques recommended by Komatsu and described in this manual are both effective and safe. Some of these techniques require the use of tools specially designed by Komatsu for the specific purpose.

To prevent injury to workers, the symbol  is used to mark safety precautions in this manual. The cautions accompanying these symbols should always be followed carefully. If any dangerous situation arises or may possibly arise, first consider safety, and take the necessary actions to deal with the situation.

1. General precautions

 **Mistakes in operation are extremely dangerous. Read the Operation and Maintenance Manual carefully before operating the machine. In addition, read this manual and understand its contents before starting the work.**

- 1) Before carrying out any greasing or repairs, read all the safety labels stuck to the machine. For the locations of the safety labels and detailed explanation of precautions, see the Operation and Maintenance Manual.
- 2) Decide a place in the repair workshop to keep tools and removed parts. Always keep the tools and parts in their correct places. Always keep the work area clean and make sure that there is no dirt, water, or oil on the floor. Smoke only in the areas provided for smoking. Never smoke while working.
- 3) When carrying out any operation, always wear safety shoes and helmet. Do not wear loose work clothes, or clothes with buttons missing.
 - Always wear safety glasses when hitting parts with a hammer.
 - Always wear safety glasses when grinding parts with a grinder, etc.
- 4) When carrying out any operation with 2 or more workers, always agree on the operating procedure before starting. Always inform your fellow workers before starting any step of the operation. Before starting work, hang UNDER REPAIR warning signs in the operator's compartment.
- 5) Only qualified workers must carry out work and operation which require license or qualification.
- 6) Keep all tools in good condition, learn the correct way to use them, and use the proper ones of them. Before starting work, thoroughly check the tools, machine, fork-lift, service car, etc.
- 7) If welding repairs are needed, always have a trained and experienced welder carry out the work. When carrying out welding work, always wear welding gloves, apron, shielding goggles, cap and other clothes suited for welding work.
- 8) Before starting work, warm up your body thoroughly to start work under good condition.
- 9) Avoid continuing work for long hours and take rests at proper intervals to keep your body in good condition. Take rests in specified safe places.

Safety points

1	Good arrangement
2	Correct work clothes
3	Following work standard
4	Making and checking signs
5	Prohibition of operation and handling by unlicensed workers
6	Safety check before starting work
7	Wearing protective goggles (for cleaning or grinding work)
8	Wearing shielding goggles and protectors (for welding work)
9	Good physical condition and preparation
10	Precautions against work which you are not used to or you are used to too much

2. Preparations for work

- 1) Before adding oil or making any repairs, park the machine on a hard and level ground, and apply the parking brake and block the wheels or tracks to prevent the machine from moving.
- 2) Before starting work, lower the work equipment (blade, ripper, bucket, etc.) to the ground. If this is not possible, insert the lock pin or use blocks to prevent the work equipment from falling. In addition, be sure to lock all the control levers and hang warning signs on them.
- 3) When disassembling or assembling, support the machine with blocks, jacks, or stands before starting work.
- 4) Remove all mud and oil from the steps or other places used to get on and off the machine. Always use the handrails, ladders or steps when getting on or off the machine. Never jump on or off the machine. If it is impossible to use the handrails, ladders or steps, use a stand to provide safe footing.

3. Precautions during work

- 1) Before disconnecting or removing components of the oil, water, or air circuits, first release the pressure completely from the circuit. When removing the oil filler cap, a drain plug, or an oil pressure pickup plug, loosen it slowly to prevent the oil from spurting out.
- 2) The coolant and oil in the circuits are hot when the engine is stopped, so be careful not to get scalded. Wait for the oil and coolant to cool before carrying out any work on the oil or water circuits.
- 3) Before starting work, stop the engine. When working on or around a rotating part, in particular, stop the engine. When checking the machine without stopping the engine (measuring oil pressure, revolving speed, temperature, etc.), take extreme care not to get rolled or caught in rotating parts or moving parts.
- 4) **For the machine equipped with a battery disconnect switch, turn the battery disconnect switch to the OFF (O) position and pull the switch key out, before starting the work.** For machines without a battery disconnect switch, remove the cable from the battery, before starting the work. Always remove the cable from the negative (-) terminal first.

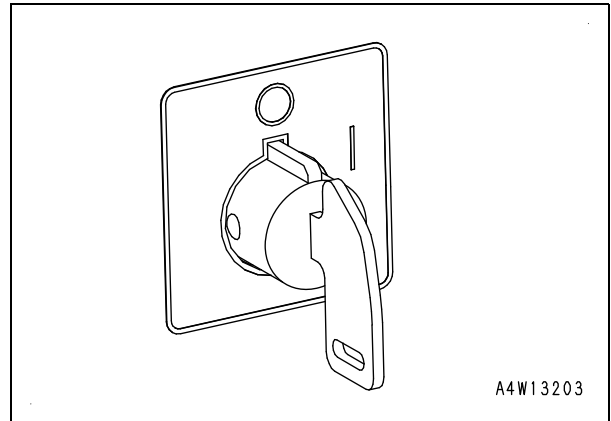

- 5) When raising a heavy component (heavier than 25 kg), use a hoist or crane. Before starting work, check that the slings (wire ropes, chains, and hooks) are free from damage. Always use slings which have ample capacity and install them to proper places. Operate the hoist or crane slowly to prevent the component from hitting any other part. Do not work with any part still raised by the hoist or crane.
- 6) When removing a cover which is under internal pressure or under pressure from a spring, always leave 2 bolts in diagonal positions. Loosen those bolts gradually and alternately to release the pressure, and then remove the cover.
- 7) When removing components, be careful not to break or damage the electrical wiring. Damaged wiring may cause electrical fires.
- 8) When removing piping, stop the fuel or oil from spilling out. If any fuel or oil drips onto the floor, wipe it up immediately. Fuel or oil on the floor can cause you to slip and can even start fires.
- 9) As a general rule, do not use gasoline to wash parts. Do not use it to clean electrical parts, in particular.
- 10) Be sure to assemble all parts again in their original places. Replace any damaged parts and parts which must not be reused with new parts. When installing hoses and wires, be sure that they will not be damaged by contact with other parts when the machine is operated.
- 11) When installing high pressure hoses, make sure that they are not twisted. Damaged tubes are dangerous, so be extremely careful when installing tubes for high pressure circuits. In addition, check that connecting parts are correctly installed.

- 12) When assembling or installing parts, always tighten them to the specified torques. When installing protective parts such as guards, or parts which vibrate violently or rotate at high speed, be particularly careful to check that they are installed correctly.
- 13) When aligning 2 holes, never insert your fingers or hand. Be careful not to get your fingers caught in a hole.
- 14) When measuring hydraulic pressure, check that the measuring tools are correctly assembled.
- 15) Take care when removing or installing the tracks of track-type machines. When removing the track, the track separates suddenly, so never let anyone stand at either end of the track.
- 16) If the engine is operated for a long time in a place which is not ventilated well, you may suffer from gas poisoning. Accordingly, open the windows and doors to ventilate well.

4. Precautions for sling work and making signs

- 1) Only one appointed worker must make signs and co-workers must communicate with each other frequently. The appointed sign maker must make specified signs clearly at a place where he is well seen from the operator's seat and where he can see the working condition easily. The sign maker must always stand in front of the load and guide the operator safely.
 - Do not stand under the load.
 - Do not step on the load.
- 2) Check the slings before starting sling work.
- 3) Keep putting on gloves during sling work. (Put on leather gloves, if available.)
- 4) Measure the weight of the load by the eye and check its center of gravity.
- 5) Use proper sling according to the weight of the load and method of slinging. If too thick wire ropes are used to sling a light load, the load may slip and fall.
- 6) Do not sling a load with 1 wire rope alone. If it is slung so, it may rotate and may slip out of the rope. Install 2 or more wire ropes symmetrically.

⚠ Slinging with 1 rope may cause turning of the load during hoisting, untwisting of the rope, or slipping of the rope from its original winding position on the load, which can result in a dangerous accident.

- 7) Limit the hanging angle to 60°, as a rule. Do not sling a heavy load with ropes forming a wide hanging angle from the hook. When hoisting a load with 2 or more ropes, the force subjected to each rope will increase with the hanging angle. The table below shows the variation of allowable load in kN {kg} when hoisting is made with 2 ropes, each of which is allowed to sling up to 9.8 kN {1,000 kg} vertically, at various hanging angles. When the 2 ropes sling a load vertically, up to 19.6 kN {2,000 kg} of total weight can be suspended. This weight is reduced to 9.8 kN {1,000 kg} when the 2 ropes make a hanging angle of 120°. If the 2 ropes sling a 19.6 kN {2,000 kg} load at a lifting angle of 150°, each of them is subjected to a force as large as 39.2 kN {4,000 kg}.

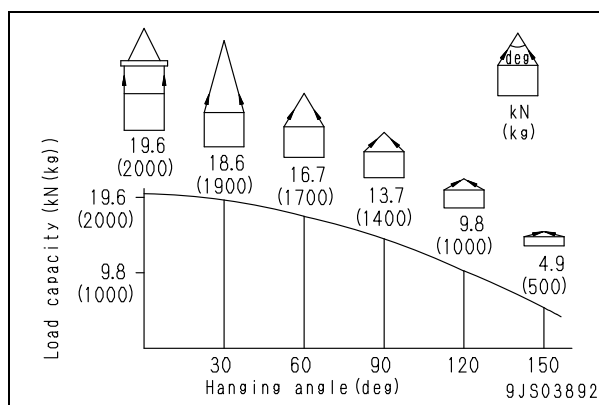

- 8) When installing wire ropes to an angular load, apply pads to protect the wire ropes. If the load is slippery, apply proper material to prevent the wire rope from slipping.
- 9) Use the specified eyebolts and fix wire ropes, chains, etc. to them with shackles, etc.
- 10) Apply wire ropes to the middle portion of the hook.
 - Slinging near the tip of the hook may cause the rope to slip off the hook during hoisting. The hook has the maximum strength at the middle portion.