

ContMaster

SPARE PART LIST

Model	DRS4527-S5
Serial no.	45436, 45454, 45455, 45463, 45464, 45465, 45466, 45468
Year	2000

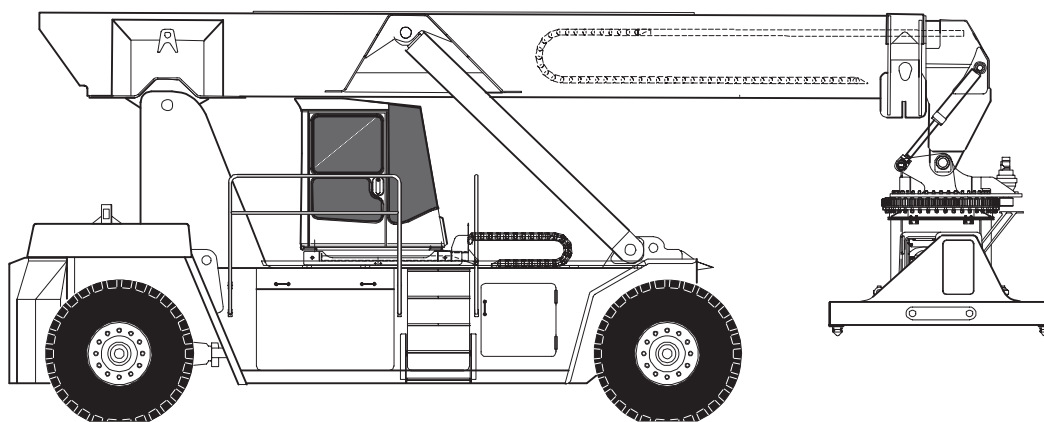

It is forbidden to copy this document or reproduce it or surrender it to a third party. It must not be used for any other purposes than those approved by us.

Kalmar Industries Oy Ab

Kalmar Industries Oy Ab
Container Handling
PO Box 387
FIN-33101 Tampere Finland
Tel. +358 3 265 8111
Fax.+358 3 265 8220

A Partek Company

REFERENCE INDEX

00 Instructions

01 Power Unit

02 Transmission

03 Hydraulic System

04 Electrical System

05 Cab

06 Working Devices

07 Frame and Shields

08 Equipment

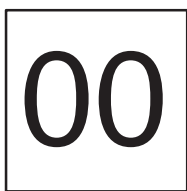

INSTRUCTIONS
BEDIENANWEISUNG

Instructions on Spare Parts Lists and How to Order

These spare parts lists are made for **ordering spare parts from the dealers authorized by Kalmar Industries Oy Ab**. By using these spare parts lists and giving detailed information of the parts to the dealer, your order and delivery will be handled faster.

The spare parts lists consist of pages where the information on the parts of the machine is given (machine number and model are on the front page).

Drawings of the spare parts are shown on an illustration page in exploded views or plane views, and detailed information is given on the opposing text page. Each illustration page has an drawing with reference numbers, and a heading box with information referring to the corresponding text page. A text page contains a heading box and detailed information on each part: part number, name, order number, quantity, and standard.

The spare parts lists are divided into sections given in the main index. Each section consists of modules presented on the front page of the section.

The spare parts lists are delivered in the language ordered by the customer. Either one or two languages can be used.

The following information must be given in the spare part order:

1. Complete information on the machine, including machine number, and possibly model, engine number, and gearbox number.
2. The group, page, and part numbers of the ordered parts, and their exact quantities.
3. Information on delivery and how the dealer is able to contact the customer.

Module Front Page

	Revision VOK01/98-06-09	Date 98-06-09	Module NV03-0100	Page 1/3
-------------------------------------------------------------------------------------	-----------------------------------	-------------------------	----------------------------	--------------------

Completion date of module.

Version and the date when the changes were made.

NV03-0100
Hydr. pump for brake ——— Module name

Illustration Page

An illustration page contains drawings either as exploded views or plane views with the reference numbers of the parts.

Page 2	Module NV03-0100	Date 98-06-09	Description Pump mounting	
------------------	----------------------------	-------------------------	-------------------------------------	-------------------------------------------------------------------------------------

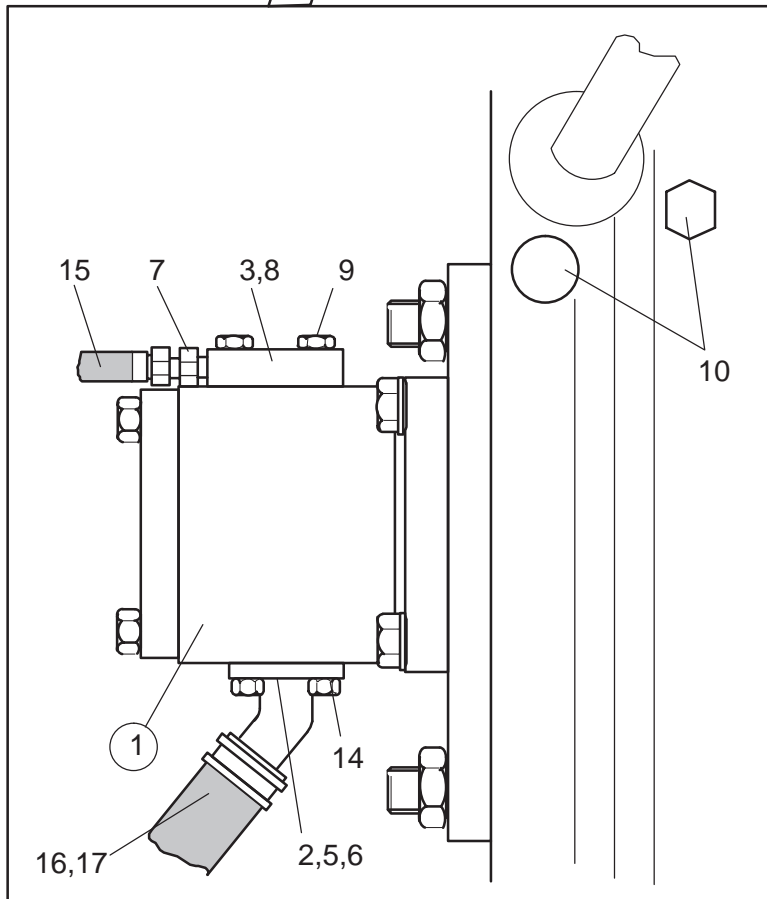
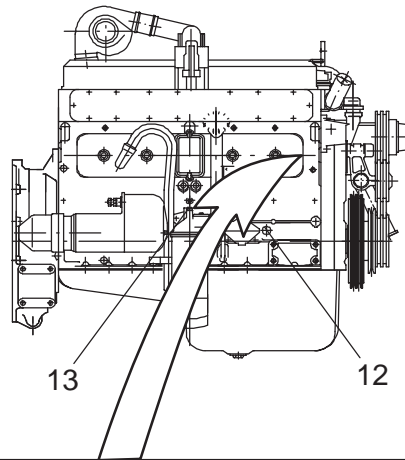

N5502850A

Text Page

A text page contains the following information:

1. Drawing number refers to the corresponding illustration page. The letter after the number indicates the version.
2. Date indicates when the page was made.
3. Name is the name of the unit dealt with on the pair of pages.
4. Module is a manufacturing reference.
6. Running page numbering within each group.
7. Reference numbers refer to the corresponding drawing.
8. Name is the name of the part.
9. Order number defines the spare part.
10. Quantity indicates the number of the parts in this unit.
11. Spare part recommendation gives information on the wear of parts. (Not used)
12. Notes include the standards and the dimensions of the parts.

Ref.	Description	Order no.	Qty	S	Notes
1	Pump Se sida 7	K0301071H	1		
2	Joint	N5413000	1		
3	Joint	N5336220	1		
5	Ring	N5242160	1		
6	Gasket	61440222	1		
7	Joint	643445162	1		
8	Gasket	61450167	1		
9	Screw	53160113	4		ISO4014 M6x40
10	Plug	N5396520	2		
12	Plug	64305904	1		
13	Plug	64305902	1		
14	Screw	53060108	4		ISO4017 M6x20
15	Hose	VL5402929	1		
16	Hose	68512532	x		
17	Clamp	60282743	2		

x) Order as required (min. delivery length 1m).

N5502850A

01 POWER UNIT

KV01–0100

Engine and Transmission Mounting
Montagem do motor e da transmissão

KV01–0101

Engine
Motor

KV01–0102

Cooling system
Sistema de arrefecimento

KV01–0103

Hydraulic Transmission
Transmissão hidráulica

KV01–0110

Dipstick/ Gearbox
Vareta de óleo/caixa de câmbio

KV01–0105

Fuel System
Sistema de combustível

KV01–0106

Fuel System
Sistema de combustível

KV01–0107

Control equipment for power unit
Equipamento de controle da unidade de
potência

KV01–0108

Exhaust Manifold
Tubulação de escape

KV01–0109

Air Filter
Filtro de ar



KV01-0100

Engine and Transmission Mounting

Montagem do motor e da transmissão

Page Página 2	Module Módulo KV01-0100	Date Data 93-01-12	Description Descrição Power unit, mount.	
----------------------------	--------------------------------------	---------------------------------	-------------------------------------------------------	------------------------------------------------------------------------------------

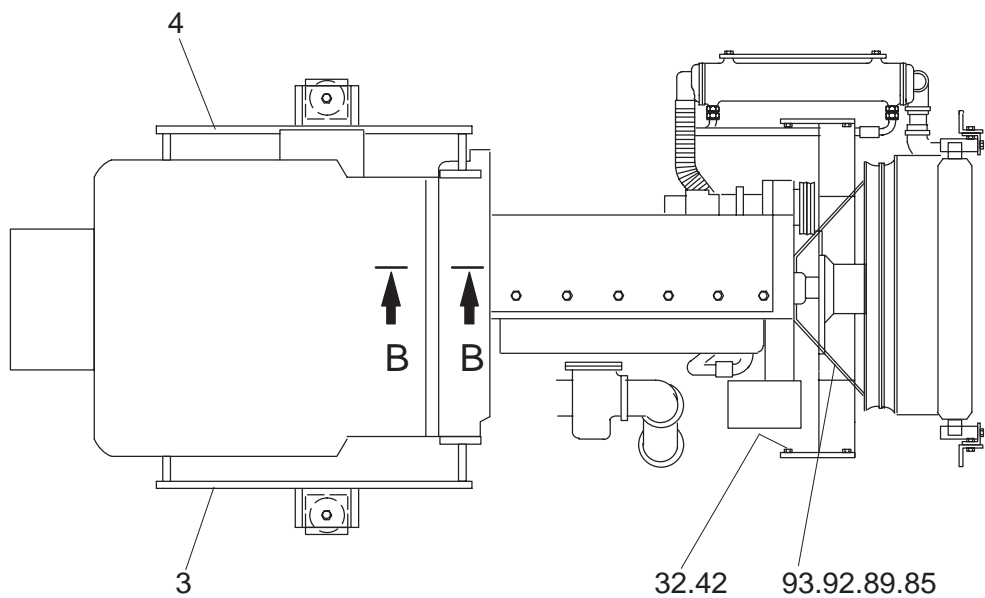
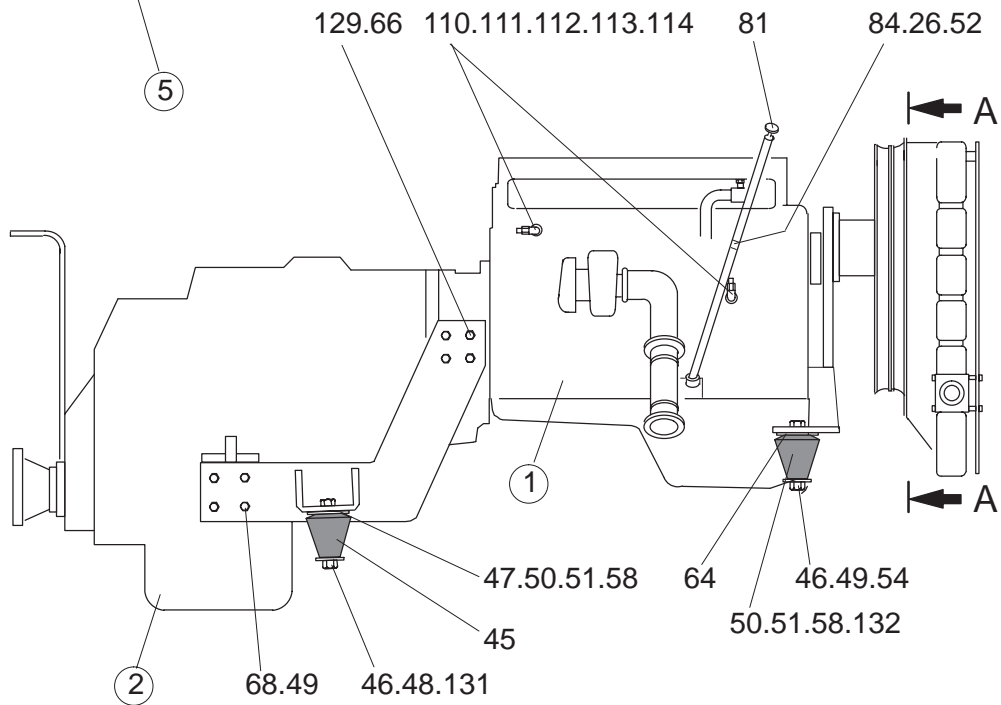
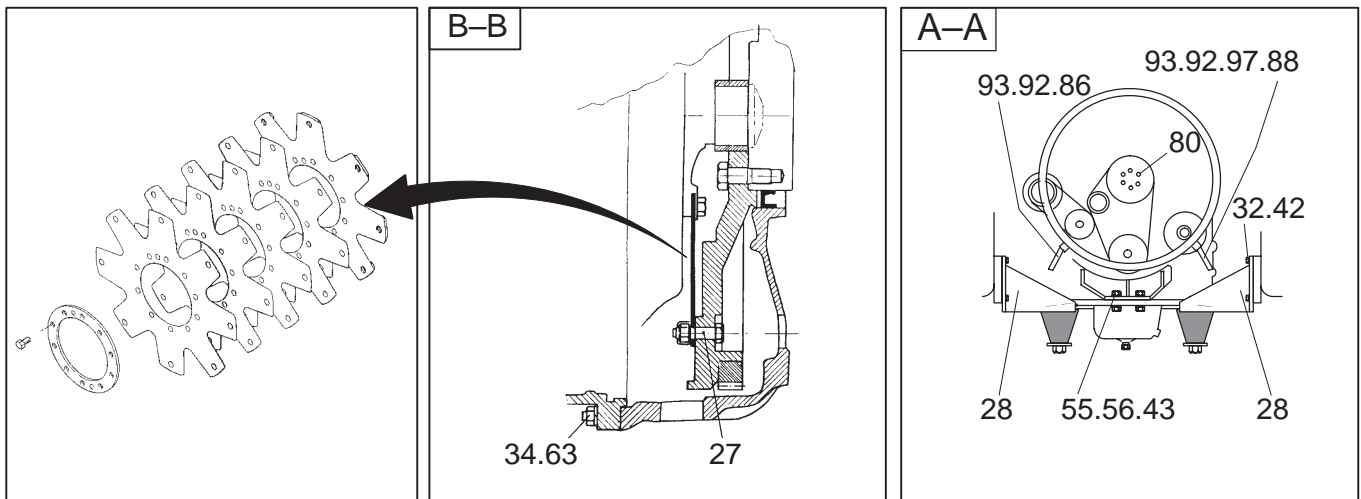



Description
Descrição
Power unit, mount.



Date
Data
93-01-12

Module
Módulo
KV01-0100

Page
Página
3

Item.	Description	Order no.	Qty	S	Notes
*1	Engine Motor	T5614260	1		Cummi MTA11-C330
**2	Gearbox Caixa de velocidades	K0201082H	1		Clark 15.5HR36431-3
3	Support Suporte	T5516910	1		
4	Support Suporte	T5516920	1		
**5	Disc set Jogo de discos	T0209036H	1		Clark 802558 16"
26	Tube Tubo	K5680630	1		
27	Screw Parafuso	53061183	8		ISO4017 M10X1.25X40
28	Support Suporte	T5518300	2		
32	Screw Parafuso	53060222	8		ISO4017 M12x35
34	Screw Parafuso	53060185	12		ISO4017 M10x50
42	Washer Anilha	50062012	8		DIN6796 12
43	Washer Anilha	50012200	4		DIN125 21
45	Rubber mounting Suporte de borracha	770172246	2		METAL 17-0146-60
46	Limitador Limitador	770152470	4		Metal 15/247
47	Limitador Limitador	T5517930	2		Metal 15/247
48	Screw Parafuso	53160485	2		ISO4014 M24X200
49	Screw Parafuso	53065384	8		SMS1943 UNC3/4x45
50	Screw Parafuso	53060143	16		ISO4017 M8X40
52	Fitting União	64308009	1		VL054100/6-3/4-16UNF
51	Nut Porca	51010080	16		DIN985 M8
54	Screw Parafuso	53060487	2		ISO4014 M24X220
55	Screw Parafuso	53060389	2		ISO4017 M20X70
56	Nut Porca	51010200	2		DIN985 M20
58	Washer Anilha	50012080	16		DIN125 8.4
63	Washer Anilha	50082100	22		DIN137 10
64	Limitador Limitador	T5516430	2		
66	Screw Parafuso	53060307	8		ISO4017 M16x60
68	Washer Anilha	50082200	8		DIN137 20
80	Screw Parafuso	T5515880	6		
81	Dipstick Vareta	K5680602	1		
84	Support Suporte	T5515920	1		
85	Fastener Ligador	T5515820	1		
86	Fastener Ligador	T5515810	1		
88	Fastener Ligador	T5515840	1		
89	Screw Parafuso	53060218	2		ISO4017 M12x20
92	Screw Parafuso	53060136	4		ISO4017 M8x16
93	Washer Anilha	50012080	4		DIN125 8.4
97	Screw Parafuso	53060178	1		ISO4017 M10x20
110	Fitting União	64306010	2		VLO54110/16 7/8-14UNF
111	Fitting União	64345716	2		VLS620.33 16JIC/7/8-14
112	Nut Porca	64163910	2		VLS620.50 16JIC
113	Sleeve Casquilho	64160916	2		VLS620.51 16JIC
114	Tube Tubo	24162033	x		DIN2391 16x2.0
129	Screw Parafuso	53060305	8		ISO4017 M16x50
131	Nut Porca	51010240	2		DIN985 M24
132	Rubber mounting Suporte de borracha	770172245	2		METAL 17-0146-45

*) See engine module

***) See gearbox module



Revision
Revisão
VOK71/00-12-11



Date
Data
98-10-06

Module
Módulo
KV01-0101

Page
Página
1/125

KV01-0101

Engine

Motor

Page Página	Module Módulo	Date Data	Description Descrição	
2	KV01-0101	93-01-12	Cylinderblock	

1A

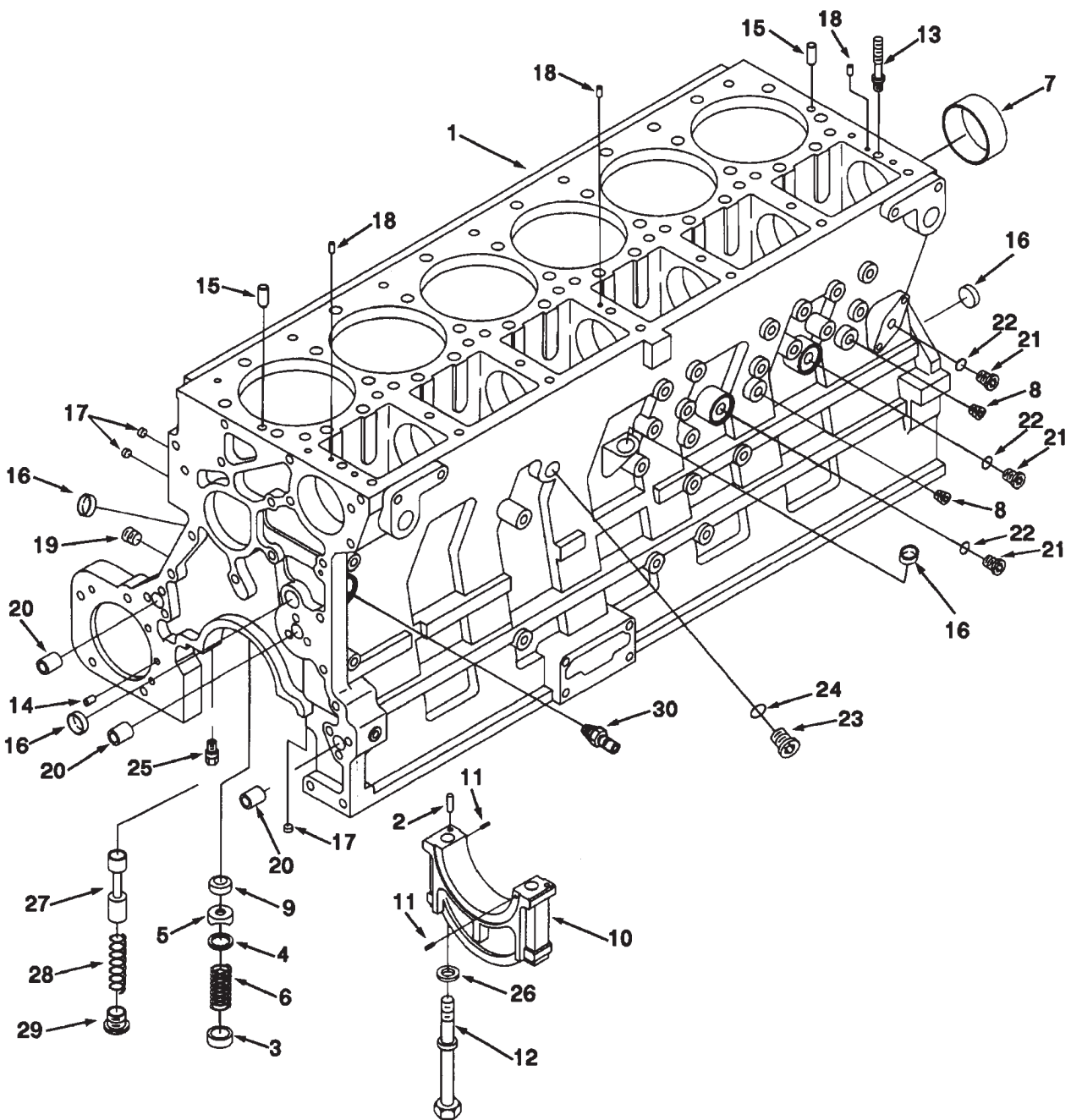



Description
Descrição
Cylinderblock



Date
Data
93-01-12

Module
Módulo
KV01-0101

Page
Página
3

Item.	Description	Order no.	Qty	S	Notes
-	Engine see page 3-125	Motor T5614260	1		Cummi MTA11-C330
1A	Cylinderblock	Bloco de motor 800040993	1		Cummi 3803717
2	Dowel pin	Perne-guia 800038860	2		Cummi 148555 no. 4
3	Plug	Ficha 800038861	1		Cummi 179063
4	Washer	Anilha 800038862	1		Cummi 3014754
5	Disc	Disco 800038863	1		Cummi 3014755
6	Spring	Mola 800038864	1		Cummi 3014756
7	Bushing	Casquilho 800038865	7		Cummi 3820566
8	Plug	Ficha 800038866	2		Cummi 3008466
9	Valve seat	Sede de valvula 800038867	1		Cummi 3026758
10	Bearing cap	Tampa rolamento 800038868	1		Cummi 3027490no.4
11	Pin	Pin 800040926	2		Cummi 3028252
10a	Bearing cap	Tampa rolamento 800038870	6		Cummi 3026961no.1.2.3.5.6.7
12	Screw	Parafuso 800038871	14		Cummi 3027493
13	Stud bolt	Perne-parafuso 800040927	7		Cummi 3895832
14	Dowel pin	Perne-guia 800038873	1		Cummi 70550
15	Dowel pin	Perne-guia 800038874	2		Cummi 142207
16	Plug	Ficha 800038875	4		Cummi 3007635
17	Plug	Ficha 800038876	8		Cummi 3007632
18	Dowel pin	Perne-guia 800038877	3		Cummi 3008446
19	Plug	Ficha 800038878	4		Cummi 3008468
20	Guide bushing	Casquilho guia 800038879	1		Cummi 3026231
21	Plug	Ficha 800038880	1		Cummi 3037536
22	O-ring	O'ring 800038125	1		Cummi 3037537
23	Plug	Ficha 800038881	1		Cummi 3046202
24	O-ring	O'ring 800039212	1		Cummi 3046201
25	Sensor	Sensor 800039225	1		Cummi 3069728
26	Washer	Anilha 800039202	14		Cummi 3019631
27	Piston	Pistão 800039223	1		Cummi 3068979
28	Spring	Mola 800034046	1		Cummi 3010146
29	Plug	Ficha 800038820	1		Cummi 3821725
30	Fitting	União 800034006	1		Cummi 3042619

Page Página	Module Módulo	Date Data	Description Descrição	<input type="checkbox"/>	
4	KV01-0101	97-01-30	Nozzle		

