



**WVNAVY**

**[HTTP://WWW.WVNAVY.COM](http://www.wvnavy.com)**

**Click on the web address above to go to our website.**

**TECHNICAL MANUAL**

**DIRECT SUPPORT AND GENERAL SUPPORT  
MAINTENANCE REPAIR PARTS AND  
SPECIAL TOOLS LISTS**

**TRACTOR, WHEELED, DED, LOADER BACKHOE:  
WITH HYDRAULIC IMPACT TOOL  
AND WITH HYDRAULIC EARTH  
AUGER ATTACHMENT**

**JOHN DEERE MODEL JD410 (CCE)**

**WITH BUCKET, IMPACTOR,  
AND EARTH DRILL  
NSN 2420-00-567-0135**

**This manual superseded TM 5-2420-222-34P, 30 December 1985.**

**Approved for public release; distribution is unlimited.**

CHANGE  
NO. 1

HEADQUARTERS  
DEPARTMENT OF THE ARMY  
Washington D.C., 29 September 1993

**DIRECT SUPPORT AND GENERAL SUPPORT MAINTENANCE  
REPAIR PARTS AND SPECIAL TOOLS LISTS**

**TRACTOR, WHEELED, DED, LOADER BACKHOE:  
WITH HYDRAULIC IMPACT TOOL  
AND WITH HYDRAULIC EARTH  
AUGER ATTACHMENT**

JOHN DEERE MODEL JD410 (CCE)

**WITH BUCKET, IMPACTOR,  
AND EARTH DRILL**

**NSN 2420-00-567-0135**

Current as of 18 June 1993

TM 5-2420-222-34P, dated 25 February 1992, is changed as follows:

1. Remove old pages and insert new pages.
2. New or changed material is indicated by an asterisk or by a vertical bar in the margin of the page.

**Remove Pages**

*ix/(x Blank)*

*2-1 through Figure 6  
7-1 through Figure 9  
10-1 through Figure 18  
19-1 through Figure 21  
22-1 through Figure 37  
38-1 through Figure 41  
43-1 through Figure 45  
47-1 and Figure 48  
49-1 and Figure 50  
51-1 through Figure 54  
55-1 through Figure 57  
70-1 and Figure 71  
79-1 and Figure 80  
83-1 and Figure 87  
88-1 and Figure 89  
93-1 and Figure 94  
95-1 and Figure 96  
97-1 through Figure 100  
101-1 and Figure 102  
104-1 and Figure 105  
106-1 through Figure 108  
110- and Figure 111  
112-1 and Figure 113  
114-1 through Figure 117  
118-1 through Figure 120*

**Insert Pages**

*ix/(x Blank)*

*2-1 through Figure 6  
7-1 through Figure 9  
10-1 through Figure 18  
19-1 through Figure 21  
22-1 through Figure 37  
38-1 through Figure 41  
43-1 through Figure 45  
47-1 and Figure 48  
49-1 and Figure 50  
51-1 through Figure 54  
55-1 through Figure 57  
70-1 and Figure 71  
79-1 and Figure 80  
83-1 and Figure 87  
88-1 and Figure 89  
93-1 and Figure 94  
95-1 and Figure 96  
97-1 through Figure 100  
101-1 and Figure 102  
104-1 and Figure 105  
106-1 through Figure 108  
110-1 and Figure 111  
112-1 and Figure 113  
114-1 through Figure 117  
118-1 through Figure 120*

Approved for public release; distribution is unlimited.

**Remove Pages (Con't)**

121-1 and Figure 122  
124-1 and Figure 125  
126-1 through Figure 128  
131-1 through 132-2  
133-1 through 134-2  
139-1 through Figure 142  
146-1 and Figure 147  
148-1 and Figure 149  
155-1 through Figure 157  
158-1 and Figure 159  
163-1 through 164-2  
166-1 through 167-2  
170-1 and Figure 171  
172-1 through 175-2  
176-1 through Figure 182  
183-1 and 183-2  
184-1 and 185-2  
187-1 and Figure 188  
190-1 through Figure 193  
196-1 and 196-2  
197-1 and Figure 198  
200-1 and Figure 201  
204-1 and Figure 205  
210-1 through Figure 216  
219-1 through Figure 223  
224-1 and Figure 225  
227-1 through Figure 229  
230-1  
Kit-1 through Figure 231  
235-1 and Figure 236  
238-1 through 241-1  
1-1 through 1-176

**Insert Pages (Con't)**

121-1 and Figure 122  
124-1 and Figure 125  
126-1 through Figure 128  
131-1 through 132-2  
133-1 through 134-2  
139-1 through Figure 142  
146-1 and Figure 147  
148-1 and Figure 149  
155-1 through Figure 157  
158-1 and Figure 159  
163-1 through 164-2  
166-1 through 167-2  
170-1 and Figure 171  
172-1 through 175-2  
176-1 through Figure 182  
183-1 and 183-2  
184-1 and 185-2  
187-1 and Figure 188  
190-1 through Figure 193  
196-1 and 196-2  
197-1 and Figure 198  
200-1 and Figure 201  
204-1 and Figure 205  
210-1 through Figure 216  
219-1 through Figure 223  
224-1 and Figure 225  
227-1 through Figure 229  
230-1  
Kit-1 through Figure 231  
235-1 and Figure 236  
238-1 through 241-1  
I-1 through I-177

3. File this change sheet in front of the publication for reference purposes.

By Order of the Secretary of the Army:

GORDON R. SULLIVAN  
*General, United States Army*  
*Chief of Staff*

Official:



MILTON H. HAMILTON  
Administrative Assistant to the  
Secretary of the Army  
05177

Distribution:

To be distributed in accordance with DA Form 12-25E (Block 1938)  
requirements for TM5-2420-222-34P.

**DIRECT SUPPORT AND GENERAL SUPPORT MAINTENANCE  
REPAIR PARTS AND SPECIAL TOOLS LISTS**

**TRACTOR, WHEELED, DED, LOADER BACKHOE:  
WITH HYDRAULIC IMPACT TOOL  
AND WITH HYDRAULIC EARTH  
AUGER ATTACHMENT  
JOHN DEERE MODEL JD410 (CCE)**

**WITH BUCKET, IMPACTOR,  
AND EARTH DRILL**

**NSN 2420-00-567-0135**

Current as of 18 June 1991

**REPORTING ERRORS AND RECOMMENDING IMPROVEMENTS**

You can help improve this manual. If you find any mistakes or if you know of a way to improve the procedures, please let us know. Mail your letter, DA Form 2028 (Recommended Changes to Publications and Blank Forms), or DA Form 2028-2, located in the back of this manual, direct to: Commander, U.S. Army Tank-Automotive Command, ATTN: AMSTA-MB, Warren, MI 48397-5000. A reply will be furnished to you.

Approved for public release; distribution is unlimited.

TABLE OF CONTENTS

			Page	Illus Fig
SECTION I.	INTRODUCTION		1	
SECTION II.	REPAIR PARTS LIST		1-1	
GROUP	01 ENGINE			
	0100 - ENGINE ASSEMBLY.....		1-1	
	ENGINE ASSEMBLY.....		1-1	1
	0101 - CRANKCASE, BLOCK, CYLINDER HEAD.....		2-1	
	CYLINDER BLOCK AND LINERS.....		2-1	2
	CYLINDER HEAD AND GASKET.....		3-1	3
	ENGINE FRONT PLATE.....		4-1	4
	0102 - CRANKSHAFT.....		5-1	
	CRANKSHAFT AND BEARING CAPS.....		5-1	5
	0103 - FLYWHEEL ASSEMBLY.....		6-1	
	FLYWHEEL.....		6-1	6
	FLYWHEEL HOUSING.....		7-1	7
	0104 - PISTONS AND CONNECTING RODS.....		8-1	
	PISTONS AND CONNECTING RODS.....		8-1	8

\* This manual supersedes TM 5-2420-222-34P, 30 December 1985.

TABLE OF CONTENTS (Con't)

	Page	Illus Fig
0105 - VALVES, CAMSHAFTS, AND TIMING SYSTEM.....	9-1	
ROCKER ARMS AND VALVES.....	9-1	9
IDLER GEARS.....	10-1	10
CAMSHAFT.....	11-1	11
TIMING GEAR COVER.....	12-1	12
ROCKER ARM COVER.....	13-1	13
BALANCER SHAFT.....	14-1	14
0106 - ENGINE LUBRICATION SYSTEM.....	15-1	
ENGINE OIL COOLER.....	15-1	15
OIL FILLER INLET.....	16-1	16
LUBRICATING OIL PUMP.....	17-1	17
ENGINE OIL FILTER, DIPSTICK, AND VENTILATOR TUBE.....	18-1	18
OIL PAN AND GASKET.....	19-1	19
0108 - MANIFOLDS.....	20-1	
EXHAUST MANIFOLD.....	20-1	20
 GROUP 02		
CLUTCH		
0200 - CLUTCH ASSEMBLY.....	21-1	
CLUTCH DISCONNECT, USE ON SERIAL NUMBERS 235786 THRU 235999.....	21-1	21
CLUTCH DISCONNECT, USE ON SERIAL NUMBERS 319995 THRU 342573.....	22-1	22
0202 - CLUTCH RELEASE MECHANISM.....	23-1	
CLUTCH PEDAL SHAFT.....	23-1	23
 GROUP 03		
FUEL SYSTEM		
0301 - CARBURETOR, FUEL INJECTOR.....	24-1	
FUEL INJECTION NOZZLE ASSEMBLY.....	24-1	24
0302 - FUEL PUMPS.....	25-1	
FUEL INJECTION SYSTEM.....	25-1	25
FUEL PUMP HELICAL GEAR.....	26-1	26
FUEL INJECTION PUMP HOUSING AND DRIVE.....	27-1	27
FUEL INJECTION PUMP HEAD AND ROTOR.....	28-1	28
FUEL INJECTION PUMP TRANSFER.....	29-1	29
FUEL INJECTION PUMP AUTOMATIC ADVANCE.....	30-1	30
FUEL INJECTION PUMP DRIVE, EXPLODED VIEW.....	31-1	31
FUEL INJECTION PUMP LINKAGE.....	32-1	32
FUEL PUMP ASSEMBLY.....	33-1	33
0304 - AIR CLEANER.....	34-1	
AIR INTAKE.....	34-1	34
AIR CLEANER.....	35-1	35
0306 - TANKS, LINES, FITTINGS, HEADERS.....	36-1	
FUEL INJECTION PUMP, ELECTRIC SHUT-OFF.....	36-1	36
FUEL TANK.....	37-1	37
0308 - ENGINE SPEED GOVERNOR AND CONTROLS.....	38-1	
FUEL INJECTION PUMP GOVERNOR.....	38-1	38
0309 - FUEL FILTERS.....	39-1	
DUAL STAGE FUEL FILTER ASSEMBLY.....	39-1	39
0311 - ENGINE STARTING AIDS.....	40-1	
COLD WEATHER STARTING AID.....	40-1	40
0312 - ACCELERATOR, THROTTLE, OR CHOKE CONTROLS.....	41-1	
SPEED CONTROL LEVER AND CABLE.....	41-1	41
ACCELERATOR PEDAL AND SPEED CONTROL ROD.....	42-1	42

## TABLE OF CONTENTS (Con't)

	Page	Illus Fig	
GROUP 04	EXHAUST SYSTEM		
0401 -	MUFFLER AND PIPES.....	43-1	
	MUFFLER.....	43-1	43
GROUP 05	COOLING SYSTEM		
0501 -	RADIATOR, EVAPORATIVE COOLER, OR HEAT EXCHANGER	44-1	
	ENGINE COOLANT HEATER AND HOSES.....	44-1	44
	RADIATOR AND RELATED PARTS.....	45-1	45
0502 -	COWLING, DEFLECTORS, AIR DUCTS, SHROUDS, ETC ..	46-1	
	FAN SHROUD.....	46-1	46
0503 -	WATER MANIFOLD, HEADERS, THERMOSTATS, AND		
	HOUSING GASKET.....	47-1	
	THERMOSTAT HOUSING ASSEMBLY.....	47-1	47
	RADIATOR HOSES AND CLAMPS.....	48-1	48
0504 -	WATER PUMP.....	49-1	
	WATER PUMP ASSEMBLY.....	49-1	49
0505 -	FAN ASSEMBLY.....	50-1	
	FAN, BELT, AND RELATED PARTS.....	50-1	50
GROUP 06	ELECTRICAL SYSTEM		
0601 -	GENERATOR, ALTERNATOR.....	51-1	
	GENERATOR ATTACHING PARTS.....	51-1	51
	GENERATOR ASSEMBLY, EXPLODED VIEW.....	52-1	52
	GENERATOR AND RELATED PARTS.....	53-1	53
0602 -	GENERATOR REGULATOR.....	54-1	
	VOLTAGE REGULATOR.....	54-1	54
0603 -	STARTING MOTOR.....	55-1	
	STARTING MOTOR, DRIVE, AND SWITCH ASSEMBLY.....	55-1	55
	STARTING MOTOR COIL ASSEMBLY HOUSING AND	56-1	56
0606 -	ENGINE SAFETY CONTROLS.....	57-1	
	PRESSURE AND STARTER SAFETY SWITCH.....	57-1	57
0607 -	INSTRUMENT OR ENGINE CONTROL PANEL.....	58-1	
	PARKING BRAKE WARNING SWITCH AND WIRING.....	58-1	58
	ENGINE ELECTRIC HOURMETER.....	59-1	59
	GAGES, INDICATOR LIGHTS, AND WIRING HARNESS.....	60-1	60
	IGNITION SWITCH.....	61-1	61
	INSTRUMENT PANEL COVER AND DASH.....	62-1	62
	LIGHT SWITCH AND TURN SIGNAL SWITCH.....	63-1	63
	FLUID STARTING AID WIRING.....	64-1	64
0608 -	MISCELLANEOUS ITEMS.....	65-1	
	CIGAR LIGHTER.....	65-1	65
0609 -	LIGHTS.....	66-1	
	TURNING LIGHT AND WARNING LIGHT.....	66-1	66
	COMBINATION REAR LIGHT ASSEMBLY.....	67-1	67
	COMBINATION REAR LIGHT AND RELATED PARTS.....	68-1	68
	FRONT LIGHT.....	69-1	69
	WARNING LIGHT FLASHER.....	70-1	70



TABLE OF CONTENTS (Con't)

	Page	Illus Fig
0610 - SENDING UNITS AND WARNING SWITCHES .....	71-1	
FUEL GAGE SENDING UNIT .....	71-1	71
0611 - HORN, SIREN .....	72-1	
ELECTRIC HORN .....	72-1	72
REVERSE WARNING ALARM.....	73-1	73
0612 - BATTERIES, STORAGE .....	74-1	
BATTERIES AND CABLES .....	74-1	74
BATTERY TRAY AND CLAMP.....	75-1	75
0613 - HULL OR CHASSIS WIRING HARNESS .....	76-1	
REVERSE WARNING ALARM AND HORN HARNESS .....	76-1	76
FRONT AND REAR LIGHT WARNING SYSTEM.....	77-1	77
ELECTRICAL WIRING SYSTEM .....	78-1	78
 GROUP 07		
TRANSMISSION		
0700 - TRANSMISSION ASSEMBLY .....	79-1	
TRANSMISSION AND CASE .....	79-1	79
TRANSMISSION CASE PLUGS .....	80-1	80
TRANSMISSION SUMP COVER .....	81-1	81
TRANSMISSION REAR COVER.....	82-1	82
0701 - TRANSMISSION SHAFTS .....	83-1	
COUNTERSHAFT AND BEARING SUPPORT .....	83-1	83
TRANSMISSION DRIVE SHAFT ASSEMBLY1 .....	84-1	84
0702 - OPPOSED OUTPUT .....	85-1	
DIFFERENTIAL DRIVE SHAFT ASSEMBLY .....	85-1	85
DIFFERENTIAL ASSEMBLY .....	86-1	86
DIFFERENTIAL LOCK MECHANISM .....	87-1	87
0704 - TRANSMISSION TOP COVER ASSEMBLY.....	88-1	
GEARSHIFTERS AND SHIFTER SHAFTS .....	88-1	88
REVERSER SPEED, TOP COVER.....	89-1	89
TRANSMISSION TOP COVER, USE ON SERIAL NUMBERS 235786 THRU 235999 .....	90-1	90
TRANSMISSION TOP COVER, USE ON SERIAL NUMBERS 319995 THRU 342573 .....	91-1	91
0705 - TRANSMISSION SHIFTING COMPONENTS.....	92-1	
REVERSER SHIFTER LEVER.....	92-1	92
REVERSER CONTROL LEVER LINKAGE .....	93-1	93
REVERSER CONTROL LEVER.....	94-1	94
0710 - TRANSMISSION ASSEMBLY AND ASSOCIATED PARTS ...	95-1	
REVERSER BRAKE HOUSING .....	95-1	95
REVERSER BRAKE CARRIER AND SHAFT .....	96-1	96
REVERSER BRAKE PLATES AND DISKS.....	97-1	97
REVERSER CLUTCH DRUM AND DISKS .....	98-1	98
REVERSER CLUTCH HOUSING.....	99-1	99
0721 - COOLERS, PUMPS, MOTORS.....	100-1	
REVERSER POWER SHAFT DRIVE AND BODY1.....	100-1	100
REVERSER CLUTCH CONTROL VALVE ASSEMBLY.....	101-1	101
REVERSER CLUTCH CONTROL VALVE, SHAFT, AND ARM ASSEMBLY .....	102-1	102
REVERSER CLUTCH CONTROL VALVE AND PISTON	103-1	103
REVERSER OIL LINES.....	104-1	104
TRANSMISSION RELIEF VALVE .....	105-1	105
TRANSMISSION LUBRICATING OIL LINES .....	106-1	106
TRANSMISSION OIL FILTER .....	107-1	107
TRANSMISSION OIL COOLER .....	108-1	108
TRANSMISSION FILTER SCREEN .....	109-1	109

## TABLE OF CONTENTS (Con't)

		Page	Illus Fig
GROUP 10	FRONT AXLE		
	1000 - FRONT AXLE ASSEMBLY.....	110-1	
	FRONT AXLE ASSEMBLY.....	110-1	110
	1004 - STEERING AND LEANING WHEEL MECHANISM.....	111-1	
	FRONT AXLE, SPINDLE, AND KNUCKLE ASSEMBLY.....	111-1	111
GROUP 11	REAR AXLE		
	1103 - PLANETARY OR FINAL DRIVE.....	112-1	
	REAR AXLE HOUSING.....	112-1	112
	REAR AXLE SHAFT.....	113-1	113
	PLANETARY PINION CARRIER.....	114-1	114
GROUP 12	BRAKES		
	1201 - HANDBRAKES.....	115-1	
	BRAKE BAND, LINING, AND LINKAGE.....	115-1	115
	PARKING BRAKE LEVER AND LINKAGE.....	116-1	116
	1202 - SERVICE BRAKES.....	117-1	
	BRAKE DISK ASSEMBLY.....	117-1	117
	1204 - HYDRAULIC BRAKE SYSTEM.....	118-1	
	BRAKE VALVE AND OIL LINES.....	118-1	118
	BRAKE VALVE HOUSING RELATED PARTS.....	119-1	119
	1206 - MECHANICAL BRAKE SYSTEM.....	120-1	
	BRAKE PEDALS.....	120-1	120
GROUP 13	WHEELS AND TRACKS		
	1311 - WHEEL ASSEMBLY.....	121-1	
	FRONT WHEEL ASSEMBLY.....	121-1	121
	REAR WHEEL STEEL DISK.....	122-1	122
	1313 - TIRES, TUBES, TIRE CHAINS.....	123-1	
	TIRES, REAR AND FRONT.....	123-1	123
GROUP 14	STEERING		
	1401 - MECHANICAL STEERING GEAR ASSEMBLY.....	124-1	
	TIE-ROD ASSEMBLY.....	124-1	124
	STEERING COLUMN AND RELATED PARTS.....	125-1	125
	1411 - HOSES, LINES, FITTINGS.....	126-1	
	POWER STEERING CYLINDER HYDRAULIC HOSES, USE ON SERIAL NUMBERS 235786 THRU 235999.....	126-1	126
	POWER STEERING CYLINDER HYDRAULICS, USE ON SERIAL NUMBERS 319995 THRU 342573.....	127-1	127
	POWER STEERING CYLINDER OIL LINES, USE ON SERIAL NUMBERS 235786 THRU 235999.....	128-1	128
	POWER STEERING VALVE HYDRAULICS, USE ON SERIAL NUMBERS 319995 THRU 342573.....	129-1	129
	POWER STEERING VALVE RETURN LINE AND ACCUMULATOR HOSE, USE ON SERIAL NUMBERS 235786 THRU 235999.....	130-1	130

TABLE OF CONTENTS (Con't)

	Page	Illus Fig
1412 - HYDRAULIC OR AIR CYLINDERS .....	131-1	
POWER STEERING CYLINDER AND PINS, USE ON SERIAL NUMBERS 235786 THRU 235999 .....	131-1	131
POWER STEERING CYLINDER AND PINS, USE ON SERIAL NUMBERS 319995 THRU 342573 .....	132-1	132
1414 - STEERING SYSTEM VALVES.....	133-1	
POWER STEERING VALVE, USE ON SERIAL NUMBERS 235786 THRU 235999 .....	133-1	133
POWER STEERING VALVE, USE ON SERIAL NUMBERS 319995 THRU 342573 .....	134-1	134
 GROUP 15		
FRAME, TOWING ATTACHMENTS, DRAWBARS, AND ARTICULATION SYSTEMS		
1501 - FRAME ASSEMBLY .....	135-1	
FRONT SUPPORT .....	135-1	135
1502 - COUNTERWEIGHTS .....	136-1	
SINGLE COUNTERWEIGHT .....	136-1	136
 GROUP 18		
BODY, CAB, HOOD, AND HULL		
1801 - BODY, CAB, HOOD, AND HULL ASSEMBLIES.....	137-1	
CANOPY REAR CUSHION MOUNT SUPPORT1 .....	137-1	137
BACKHOE CONTROL GUARDS .....	138-1	138
CANOPY .....	139-1	139
CANOPY ROOF AND RELATED PARTS, USE ON SERIAL NUMBERS 319995 THRU 342573 .....	140-1	140
CANOPY ROOF AND RELATED PARTS, USE ON SERIAL NUMBERS 235786 THRU 235999 .....	141-1	141
COWL SUPPORT .....	142-1	142
COWL .....	143-1	143
HOOD AND RELATED PARTS .....	144-1	144
CANOPY FRONT CUSHION MOUNT SOCKET AND BRACKET	145-1	145
GRILLE HOUSING AND RELATED PARTS .....	146-1	146
1802 - FENDERS, RUNNING BOARDS WITH MOUNTING AND ATTACHING PARTS, OUTRIGGERS, WINDSHIELD, GLASS, ETC .....	147-1	
STEP .....	147-1	147
FENDERS.....	148-1	148
STABILIZER .....	149-1	149
1805 - FLOORS, SUBFLOORS, AND RELATED COMPONENTS....	150-1	
LEFT PLATFORM AND SUPPORT .....	150-1	150
RIGHT PLATFORM AND RELATED PARTS.....	151-1	151
CENTER PLATFORM, REAR PLATFORMS, AND BATTERY	152-1	152
1806 - UPHOLSTERY, SEATS, AND CARPETS .....	153-1	
SEAT LOWER SUPPORT AND SWIVEL .....	153-1	153
DELUXE SEAT SUPPORT.....	154-1	154
SEAT AND SEATBELT .....	155-1	155
1808 - STOWAGE RACKS, BOXES, STRAPS, CARRYING CASES, CABLE REELS, HOSE REELS, ETC .....	156-1	
BACKHOE VALVE BOX AND COVER.....	156-1	156
TOOLBOX AND TRAY .....	157-1	157
CONTROL BOX.....	158-1	158
 GROUP 22		
BODY, CHASSIS, AND HULL ACCESSORY ITEMS		
2202 - ACCESSORY ITEMS .....	159-1	
REFLECTORS, USE ON SERIAL NUMBERS 319995 THR	159-1	159

TABLE OF CONTENTS (Con't)

	Page	Illus Fig
2210 - DATA PLATES AND INSTRUCTION HOLDERS.....	160-1	
LOADER AND BACKHOE DECALS .....	160-1	160
TRACTOR DECALS .....	161-1	161
TRACTOR LABELS.....	162-1	162
GROUP 24 HYDRAULIC AND FLUID SYSTEMS		
2401 - PUMP AND MOTOR .....	163-1	
HYDRAULIC ACCUMULATOR AND BRACKET.....	163-1	163
HYDRAULIC PUMP.....	164-1	164
HYDRAULIC PUMP DRIVE AND RELATED PARTS, USE ON SERIAL NUMBERS 235786 THRU 235999.....	165-1	165
HYDRAULIC PUMP DRIVE, EXPLODED VIEW, USE ON SERIAL NUMBERS 319995 THRU 342573 .....	166-1	166
2402 - MANIFOLD AND/OR CONTROL VALVES.....	167-1	
HYDRAULIC PUMP STROKE CONTROL VALVE.....	167-1	167
PRESSURE CONTROL VALVE.....	168-1	168
HYDRAULIC RELIEF VALVE.....	169-1	169
HYDRAULIC IMPACTOR VALVE AND MANIFOLD .....	170-1	170
JAW CONTROL VALVE .....	171-1	171
BACKHOE CONTROL VALVE ASSEMBLY.....	172-1	172
BACKHOE STABILIZER AND BUCKET VALVE.....	173-1	173
BACKHOE CROWD VALVE .....	174-1	174
BACKHOE BOOM AND SWING VALVE.....	175-1	175
BACKHOE CIRCUIT RELIEF VALVE CARTRIDGES.....	176-1	176
LOADER VALVE MOUNTING BRACKET AND MANIFOLD BLOCK	177-1	177
LOADER CONTROL VALVE .....	178-1	178
BUCKET SECTION OF LOADER VALVE.....	179-1	179
LOADER AND BUCKET RELIEF VALVE.....	180-1	180
BOOM SECTION OF LOADER CONTROL VALVE.....	181-1	181
2403 - HYDRAULIC CONTROLS AND/OR MANUAL CONTROLS182-1		
JAW VALVE LINKAGE .....	182-1	182
BACKHOE CONTROL LEVERS AND LINKAGE, USE ON SERIAL NUMBERS 235786 THRU 235999.....	183-1	183
BACKHOE CONTROL LEVERS AND LINKAGE, USE ON SERIAL NUMBERS 319995 THRU 342573 .....	184-1	184
LOADER CONTROL VALVE LINKAGE .....	185-1	185
2406 - STRAINERS, FILTERS, LINES, AND FITTINGS, ETC.....	186-1	
HYDRAULIC OIL LINE, PUMP TO COOLER.....	186-1	186
HYDRAULIC OIL LINES TO PUMP, CLUTCH CONTROL VALVE, FILTER RELIEF VALVES, AND RETURN .....	187-1	187
LOADER LEFT- AND RIGHT-HAND BOOM CYLINDER HOSES	188-1	188
AUGER HYDRAULIC LINES AND FITTINGS, USE ON SERIAL NUMBERS 319995 THRU 342573 .....	189-1	189
JAW BUCKET HYDRAULIC HOSES, USE ON SERIAL NUMBERS 319995 THRU 342573 .....	190-1	190
CROWD AND BUCKET CYLINDER HYDRAULICS, USE ON SERIAL NUMBERS 319995 THRU 342573 .....	191-1	191
CROWD CYLINDER LINES AND FITTINGS .....	192-1	192
HYDRAULIC HOSES, USE ON SERIAL NUMBERS 235786. THRU 235999	193-1	193
BACKHOE CONTROL TO MANIFOLD BLOCK OIL LINE AND FITTINGS\ .....	194-1	194
BACKHOE BOOM, CROWD AND BUCKET OIL LINES AND FITTINGS, USE ON SERIAL NUMBERS 319995 THRU 342573.....	195-1	195
BACKHOE BOOM, CROWD AND BUCKET OIL LINES, USE ON SERIAL NUMBERS 235786 THRU 235999 .....	196-1	196

TABLE OF CONTENTS (Con't)

	Page	Illus Fig
2406 - STRAINERS, FILTERS, LINES, AND FITTINGS, ETC (Con't)		
BACKHOE STABILIZER AND SWING CIRCUIT OIL LINES AND FITTINGS .....	197-1	197
BACKHOE PRESSURE AND RETURN CIRCUIT OIL LINES AND FITTINGS, USE ON SERIAL NUMBERS 319995 THRU 342573	198-1	198
BACKHOE PRESSURE AND RETURN CIRCUIT OIL LINES AND FITTINGS, USE ON SERIAL NUMBERS 235786 THRU 235999	199-1	199
BACKHOE OIL LINES AND FITTINGS, USE ON SERIAL NUMBERS 319995 THRU 342573 .....	200-1	200
LOADER LEFT AND RIGHT BUCKET CYLINDER CIRCUITS	201-1	201
LOADER PRESSURE AND RETURN CIRCUITS.....	202-1	202
HYDRAULIC PUMP OIL PRESSURE LINES.....	203-1	203
HYDRAULIC OIL FILTER.....	204-1	204
JAW CYLINDER HOSES .....	205-1	205
HYDRAULIC IMPACTOR HOSE.....	206-1	206
VALVE LINES AND FITTINGS.....	207-1	207
2407 - HYDRAULIC CYLINDERS.....	208-1	
LOADER BOOM CYLINDER.....	208-1	208
JAW BUCKET CYLINDER .....	209-1	209
BACKHOE BOOM CYLINDER .....	210-1	210
BACKHOE SWING CYLINDER.....	211-1	211
BACKHOE BUCKET CYLINDER, USE ON SERIAL NUMBERS 235786 THRU 235999 .....	212-1	212
BACKHOE CROWD CYLINDER.....	213-1	213
BACKHOE STABILIZER CYLINDER .....	214-1	214
LOADER BUCKET CYLINDER .....	215-1	215
GROUP 47 GAGES (NONELECTRICAL), WEIGHING AND MEASURING DEVICES		
4701 - INSTRUMENTS.....	216-1	
TACHOMETER.....	216-1	216
4702 - GAGES, MOUNTINGS, LINES, AND FITTINGS .....	217-1	
AIR CLEANER RESTRICTION INDICATOR .....	217-1	217
GROUP 74 CRANES, SHOVELS, AND EARTHMOVING EQUIPMENT COMPONENTS		
7412 - BACKHOE ATTACHMENTS .....	218-1	
JAW BUCKET .....	218-1	218
BACKHOE DIPPERSTICK .....	219-1	219
BACKHOE BOOM, USE ON SERIAL NUMBERS 319995..... THRU 342573	220-1	220
BACKHOE BOOM, USE ON SERIAL NUMBERS 235786..... THRU 235999	221-1	221
BACKHOE SWING FRAME, USE ON SERIAL NUMBERS 319995 THRU 342573	222-1	222
BACKHOE SWING FRAME, USE ON SERIAL NUMBERS 235786 THRU 235999	223-1	223
BACKHOE MAIN FRAME AND TIE BARS, USE ON SERIAL NUMBER 319995 THRU 342573-1	224	
BACKHOE MAIN FRAME AND TIE BARS, USE ON..... SERIAL NUMBERS 0235786 THRU 235999	225-1	225
7437 - LOADER BUCKET ASSEMBLY OR FORKLIFT .....	226-1	
LOADER .....	226-1	226
BUCKET .....	227-1	227
LOADER SIDE FRAMES.....	228-1	228
BUCKET LEVEL INDICATOR .....	229-1	229
LOADER BUCKET LINKAGE.....	230-1	230

TABLE OF CONTENTS (Con't)

	Page	Illus Fig
GROUP 94	REPAIR KITS	
9401 -	REPAIR KITS .....	KIT-1
	REPAIR KITS .....	KIT-1      KIT
GROUP 95	GENERAL USE STANDARDIZED PARTS	
9501 -	BULK MATERIEL .....	BULK-1
	BULK MATERIEL .....	BULK-1      BULK
GROUP 99	PARTS PECULIAR	
9901 -	MULTILISTED PARTS .....	231-1
	HYDRAULIC MOTOR.....	231-1      231
	AUGER HYDRAULIC HOSES AND RELATED PARTS .....	232-1      232
	IMPACTOR LINES AND FITTINGS .....	233-1      233
	HYDRAULIC EARTH DRILL.....	234-1      234
	HYDRAULIC BACKHOE IMPACTOR .....	235-1      235
	BACKHOE IMPACTOR WORKING TOOLS .....	236-1      236
	HYDRAULIC BORING HEAD.....	237-1      237
	HYDRAULIC BORING HEAD AND RELATED PARTS.....	238-1      238
	HYDRAULIC BORING HEAD MOTOR AND RELATED PARTS .....	239-1      239
	IMPACTOR ADAPTER.....	240-1      240
	EARTH DRILL MOTOR .....	241-1      241
SECTION III.	SPECIAL TOOLS LIST (NOT APPLICABLE)	
SECTION IV.	CROSS-REFERENCE INDEXES	
	NATIONAL STOCK NUMBER INDEX.....	I-1
	PART NUMBER INDEX.....	I-34
	FIGURE AND ITEM NUMBER INDEX .....	I-106

Change 1 ix/(x Blank)

**DIRECT SUPPORT AND GENERAL SUPPORT  
MAINTENANCE REPAIR PARTS AND  
SPECIAL TOOLS LISTS**

**SECTION I. INTRODUCTION**

**1. Scope.**

This RPSTL lists and authorizes spares and repair parts; special tools; special test, measurement, and diagnostic equipment (CTMDE); and other special support equipment required for performance of Direct Support and General Support Maintenance of the Loader Backhoe Wheeled Tractor. It authorizes the requisitioning, issue, and disposition of spares, repair parts and special tools as indicated by the source, maintenance and recoverability (SMR) codes.

**2. General.**

In addition to Section I. Introduction, this Repair Parts and Special Tools List is divided into the following sections:

*a. Section II. Repair Parts List.* A list of spares and repair parts authorized by this RPSTL for use in the performance of maintenance. The list also includes parts which must be removed for replacement of the authorized parts. Parts lists are composed of functional groups in ascending alphanumeric sequence, with the parts in each group listed in ascending figure and item number sequence. Bulk materials are listed in item name sequence. Repair kits are listed separately in their own functional group within Section II. Repair parts for reparable special tools are also listed in the section. Items listed are shown on the associated illustration(s)/figure(s).

*b. Section III. Special Tools List* A list of special tools, special TMDE, and other special support equipment authorized by this RPSTL (as indicated by Basis of Issue (BOI) information in DESCRIPTION AND USABLE ON CODE column) for the performance of maintenance.

*c. Section IV Cross-reference Indexes.* A list, in National Item Identification Number (NIIN) sequence, of all National stock numbered items appearing in the listing, followed by a list in alphanumeric sequence of all part numbers appearing; in the listings. National stock numbers and part numbers are cross-referenced to each illustration/figure and item number appearance.

The figure and item number index lists figure and item numbers in alphanumeric sequence and cross-references NSN, CAGE, and part numbers.

**3. Explanation of Columns (Sections II and III).**

*a. ITEM NO.* (Column (1)). Indicates the number used to identify items called out in the illustration.

*b. SMR CODE* (Column (2)). The Source, Maintenance, and Recoverability (SMR) code is a 5-position code containing supply/requisitioning information, maintenance category authorization criteria, and disposition instructions, as shown in the following breakout:

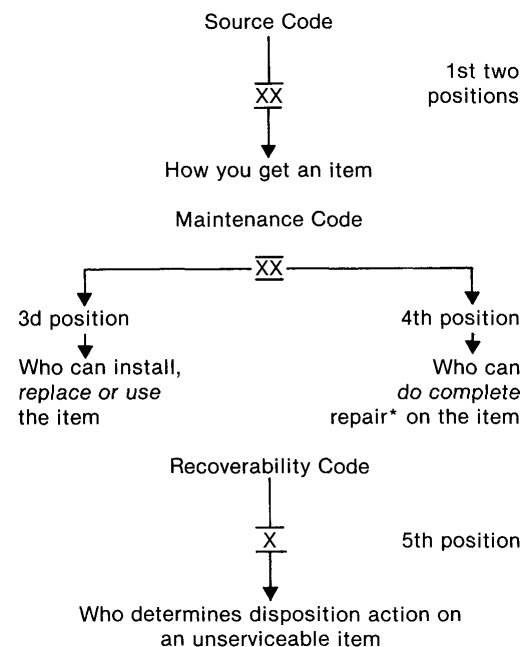

*\*Complete Repair:* Maintenance capacity, capability, and authority to perform all corrective maintenance tasks of the "Repair" function in a use/user environment in order to restore serviceability to a failed item.

(1) *Source Code.* The source code tells you how to get an item needed for maintenance, repair, or overhaul of an end item/equipment. Explanations of source codes follows:

Code    Application/Explanation

PA    Stocked items; use the applicable NSN to request/requisition items with these source codes. They are authorized to the category indicated by the code entered in the 3d position of the SMR code.  
 PB  
 PC\*\*  
 PD  
 PE  
 PF    \*\* Items coded PC are subject to deterioration.  
 PG

\*\*Items with these codes are not to be re-requisitioned individually. They are part of a kit which is authorized to the maintenance category indicated in the 3d position of the SMR code. The complete kit must be requisitioned and applied.

MO-(Made at UMI AVUM Level)  
 MF-(Made at DS/ AVUM Level)  
 MH-(Made at GS Level)  
 ML-(Made at Specialized Repair Activity (SRA))  
 MD-(Made at Depot) to you by the 3d position code of the SMR code, but the source code indicates it is made at a higher level, order the item from the higher level of maintenance. Items with these codes are not to be requested/requisitioned individually. The parts that make up the assembled item must be requisitioned or fabricated and assembled at the level of maintenance indicated by the source code. If the 3d position code of the SMR code authorizes you to replace the item, but the source code indicates the item is assembled at a higher level, order the item from the higher level of maintenance.

AO-(Assembled by UM/AVUM Level)  
 AF-(Assembled by DS/AVIM Level)  
 AH-(Assembled by GS Category)  
 AL-(Assembled by SRA)  
 AD-(Assembled by Depot)

XA -    Do not requisition an "XA"-coded item. Order its next higher assembly. (Also refer to the NOTE following.)

XB -    If an "XB" item is not available from salvage, order it using the CAGE and part number given.

XC -    Installation drawing, diagram, instruction sheet, field service drawing, that is identified by the manufacturer's part number.

XD -    Item is not stocked. Order an "XD"-coded item through normal supply channels using the CAGE and part number given, if no NSN is available.

NOTE: Cannibalization or controlled exchange, when authorized, may be used as a source of supply for items with the above source codes, except for those source coded "XA' or those aircraft support items restricted by requirements of AR 700-42.

(2) *Maintenance Code.* Maintenance codes tell you the level(s) of maintenance authorized to USE and REPAIR support items. The maintenance codes are entered in the third and fourth positions of the SMR code as follows:

(a) The maintenance code entered in the third position tells you the lowest maintenance level authorized to remove, replace, and use an item. The maintenance code entered in the third position will indicate authorization to one of the following levels of maintenance.

Code    Application/Explanation

- C -    Crew or operator maintenance done within unit maintenance or aviation unit maintenance.
- O -    Unit maintenance or aviation unit category can remove, replace, and use the item.
- F -    Direct support or aviation intermediate level can remove, replace, and use the item.
- H -    General support level can remove, replace, and use the item.
- L -    Specialized repair activity can remove, replace, and use the item.
- D -    Depot level can remove, replace, and use the item.

(b) The maintenance code entered in the fourth position tells whether or not the item is to be repaired and identifies the lowest maintenance level with the capability to do complete repair (i.e., perform all authorized repair functions). (NOTE: Some limited repair may be done on the item at a lower level of maintenance, if authorized by the Maintenance Allocation Chart (MAC) and SMR codes.) This position will contain one of the following maintenance codes:

Code    Application/Explanation

- 0 -    Unit maintenance or aviation unit is the lowest level that can do complete repair of the item.
- F -    Direct support or aviation intermediate is the lowest level than can do complete repair of the item.



- H - General support is the lowest level that can do complete repair of the item.
- L - Specialized repair activity is the lowest level that can do complete repair of the item.
- D - Depot is the lowest level that can do complete repair of the item.
- Z - Nonreparable No repair is authorized.
- B - No repair is authorized (No parts or special tools are authorized for the maintenance of a "B"-coded item.) However, the item may be reconditioned by adjusting, lubricating, etc., at the user level.

(3) Recoverability Code. Recoverability codes are assigned to items to indicate the disposition action on unserviceable items. The recoverability code is entered in the fifth position of the SMR code as follows:

Code	Application/Explanation
Z -	Nonreparable item. When unserviceable, condemn and dispose of the item at the level of maintenance shown in the 3d position of the SMR code.
O -	Reparable item. When uneconomically repairable, condemn and dispose of the item at unit maintenance or aviation unit level.
F -	Reparable item. When uneconomically repairable, condemn and dispose of the item at the direct support or aviation intermediate level.
H -	Reparable item. When uneconomically repairable, condemn and dispose of the item at the general support level.
D -	Reparable item. When beyond lower level repair capability, return to depot. Condemnation and disposal of item not authorized below depot level.
L -	Reparable item. Condemnation and disposal of item not authorized below specialized repair activity (SRA).
A -	Item requires special handling or condemnation procedures because of specific reasons (e.g., precious metal content, high dollar value, critical material, or hazardous material). Refer to appropriate manuals/directives for specific instructions.

c. *CAGEC (Column (3))*. The Commercial and Government Entity (CAGE) Code (C) is a 5-digit numeric code which is used to identify the manufacturer, distributor, or Government agency, etc., that supplies the item.

d. *PART NUMBER (Column (4))*. Indicates the primary number used by the manufacturer (individual, company, firm, corporation, or Government activity), which controls the design and characteristics of the item by means of its engineering drawings, specifications standards, and inspection requirements to identify an item or range of items.

NOTE: When you use an NSN to requisition an item, the item you receive may have a different part number from the part ordered.

e. *DESCRIPTION AND USABLE ON CODE (UOC) (Column (5))*. This column includes the following information:

(1) The Federal item name and, when required, a minimum description to identify the item.

(2) Physical security classification. Not Applicable.

(3) Items that are included in kits and sets are listed below the name of the kit or set on Figure KIT.

(4) Spare/repair parts that make up an assembled item are listed immediately following the assembled item line entry.

(5) Part numbers for bulk materials are referenced in this column in the line item entry for the item to be manufactured/fabricated.

(6) When the item is not used with all serial numbers of the same model, the effective serial numbers are shown on the last line(s) of the description (before UOC).

(7) The usable on code, when applicable (see paragraph 5, Special Information).

(8) In the Special Tools List section, the basis of issue (BOI) appears as the last line(s) in the entry for each special tool, special TMDE, and other special support equipment. When density of equipments supported exceeds density spread indicated in the basis of issue, the total authorization is increased proportionately.

(9) The statement "END OF FIGURE" appears just below the last item description in Column 5 for a given figure in both Section II and Section III.

f. *QTY (Column (6))*. The QTY (quantity per figure column) indicates the quantity of the item used in the breakout shown on the illustration/figure, which is prepared for a functional group, subfunctional group, or an assembly. A "V" appearing in this column in lieu of a quantity indicates that the quantity is variable and the quantity may vary from application to application.

4. **Explanation of Columns** (Section IV).

a. **NATIONAL STOCK NUMBER (NSN) INDEX.**

(1) **STOCK NUMBER** column. This column lists the NSN by National Item Identification Number (NIIN) sequence. The NIIN consists of the last nine

digits of the NSN (i.e.,  $\frac{\text{NSN}}{5305-01-674-1467}$ ). When  
|  
NIIN

using this column to locate an item, ignore the first 4 digits of the NSN. However, the complete NSN should be used when ordering items by stock number.

(2) **FIG.** column. This column lists the number of the figure where the item is identified/located. The figures are in numerical order in Section II and Section II.

(3) **ITEM** column. The item number identifies the item associated with the figure listed in the adjacent FIG. column. This item is also identified by the NSN listed on the same line.

b. **PARTNUMBER INDEX.** Part numbers in this index are listed by part number in ascending alphanumeric sequence (i.e., vertical arrangement of letter and number combination which places the first letter or digit of each group in order A through Z, followed by the numbers 0 through 9 and each following letter or digit in like order).

(1) **CAGEC** column. The Commercial and Government Entity (CAGE) Code (C) is a 5-digit numeric code used to identify the manufacturer, distributor, or Government agency, etc., that supplies the item.

(2) **PART NUMBER** column. Indicates the primary number used by the manufacturer (individual, firm, corporation, or Government activity), which controls the design and characteristics of the item by means of its engineering drawings, specifications standards, and inspection requirements to identify an item or range of items.

(3) **STOCK NUMBER** column. This column lists the NSN for the associated part number and manufacturer identified in the PART NUMBER and CAGE columns to the left.

(4) **FIG.** column. This column lists the number of the figure where the item is identified/located in Sections 11 and III.

(5) **ITEM** column. The item number is that number assigned to the item as it appears in the figure referenced in the adjacent figure number column.

c. **FIGURE AND ITEM NUMBER INDEX.**

(1) **FIG.** column. This column lists the number of the figure where the item is identified/located in Sections II and III.

(2) **ITEM** column. The item number is that number assigned to the item as it appears in the figure referenced in the adjacent figure number column.

(3) **STOCK NUMBER** column. This column lists the NSN for the item.

(4) **CAGE** column. The Commercial and Government Entity (CAGE) is a 5-digit numeric code used to identify the manufacturer, distributor, or Government agency, etc., that supplies the item.

(5) **PART NUMBER** column. Indicates the primary number used by the manufacturer (individual, firm, corporation, or Government activity), which controls the design and characteristics of the item by means of its engineering drawings, specifications standards and inspection requirements to identify an item or range of items.

**5. Special Information.**

a. This manual covers end items purchased under two contracts. One contract covers serial numbers 235786 through 235999; the other contract covers serial numbers 319995 through 342573. Although the model number remains the same, there are minor design changes in the end items. Check the maintenance manuals for the location of the serial numbers.

**WARNING:** Installation of wrong part numbers may result in injury to personnel or damage to equipment.

b. **USABLE ON CODE.** The usable on code appears in the lower left corner of the description column heading. Not Applicable.

c. **FABRICATION INSTRUCTIONS.** Bulk materials required to manufacture items are listed in the Bulk Material Functional Group of this RPSTL. Part numbers for bulk materials are also referenced in the Description column of the line item entry for the item to be manufactured/fabricated. Detailed fabrication instructions for items source coded to be manufactured or fabricated are found in TM 5-2420-222-20 or TM 5-2420-222-34.

d. **ASSEMBLY INSTRUCTIONS.** Detailed assembly instructions for items source coded to be assembled from component spare/repair parts are found in TM 5-2420-222-20 or TM 5-2420-222-34. Items that make up the assembly are listed immediately following the assembly item entry or reference is made to an applicable figure.

e. **KITS.** Line item entries for repair parts kits appear in group 9401 in Section II.

f. **INDEX NUMBERS.** Items which have the word BULK in the figure column will have an index number shown in the item number column. This index number is a cross-reference between the National Stock Number/Part Number Index and the bulk material list in Section II.

g. **ASSOCIATED PUBLICATIONS.** The publications listed below pertain to the Loader Backhoe Wheeled Tractor and its components:

<u>Publication</u>	<u>Short Title</u>
LO 5-2420-222-12	Tractor, Wheeled, Loader Backhoe
TM 5-2420-222-10	Tractor, Wheeled, Loader Backhoe
TM 5-2420-222-20-1	Tractor, Wheeled, Loader Backhoe
TM 5-2420-222-20-2	Tractor, Wheeled, Loader Backhoe
TM 5-2420-222-20-3	Tractor, Wheeled, Loader Backhoe
TM 5-2420-222-20P	Tractor, Wheeled, Loader Backhoe
TM 5-2420-222-34	Tractor, Wheeled, Loader Backhoe

**6. How to Locate Repair Parts.**

a. *When National Stock Number or Part Number is Not Known:*

(1) *First.* Using the table of contents, determine the assembly group or subassembly group to which the item belongs. This is necessary since figures are

prepared for assembly groups and subassembly groups, and listings are divided into the same groups.

(2) *Second.* Find the figure covering the assembly group or subassembly group to which the item belongs.

(3) *Third.* Identify the item on the figure and use the Figure and Item Number Index to find the NSN.

b. *When National Stock Number or Part Number is Known:*

(1) *First.* Using the National Stock Number or Part Number Index, find the pertinent National Stock Number or Part Number. The NSN index is in National Item Identification Number (NIIN) sequence (see paragraph 4.a.(1)). The part numbers in the Part Number index are listed in ascending alphanumeric sequence (see paragraph 4.b). Both indexes cross-reference you to the illustration/figure and item number of the item you are looking for.

(2) *Second.* Turn to the figure and item number, verify that the item is the one you're looking for, then locate the item number in the repair parts list for the figure.

**7. Abbreviations.**

For standard abbreviations see MIL-STD-12D, *Military Standard Abbreviations for Use on Drawings, Specifications, Standards, and in Technical Documents.*

<u>Abbreviations</u>	<u>Explanation</u>
NIIN.....	National Item Identification Number (consists of the last 9 digits of the NSN)
RPSTL.....	Repair Parts and Special Tools List

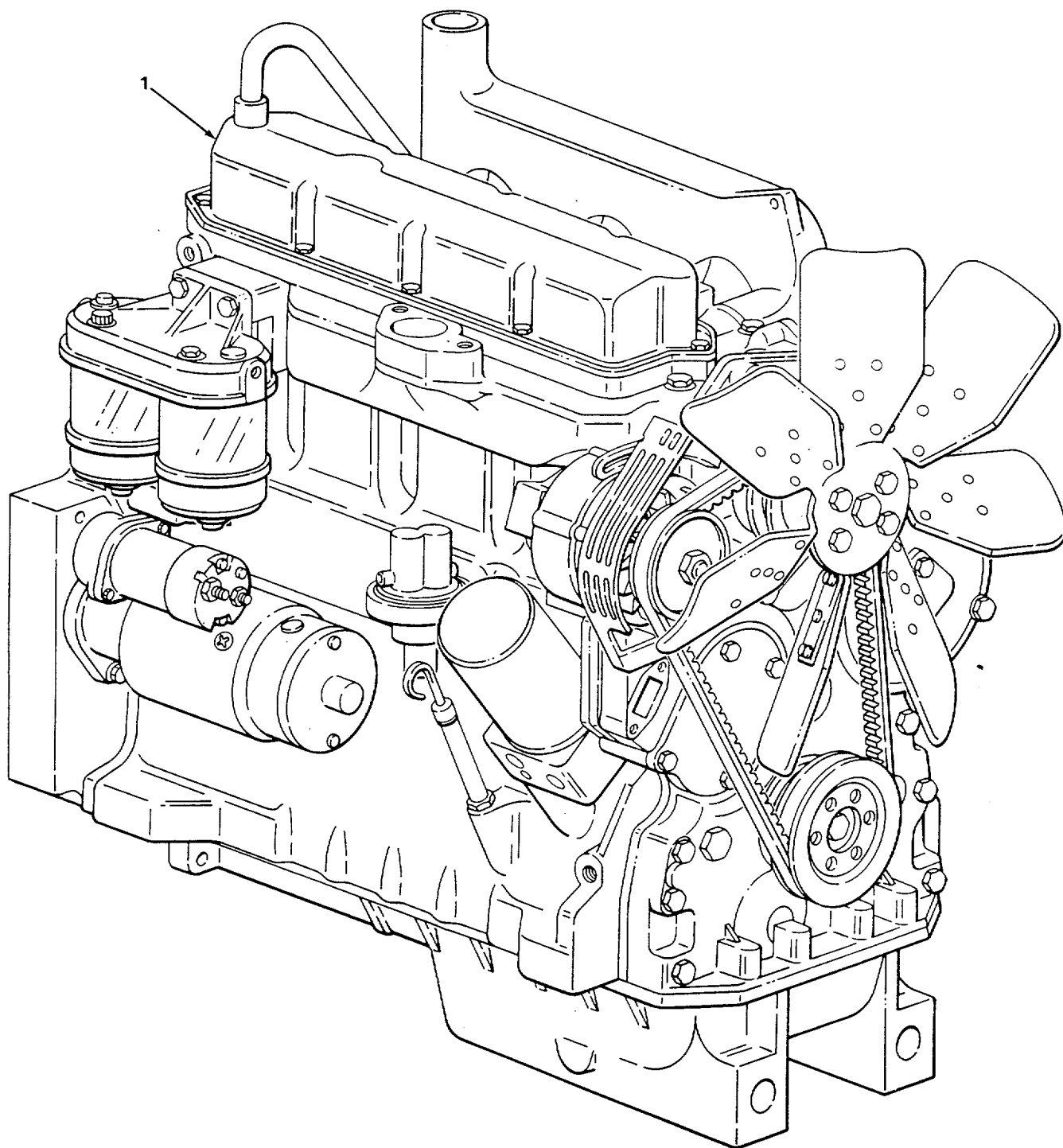

TA506362

FIGURE 1. ENGINE ASSEMBLY.