

HP1967 -UN-01JAN94

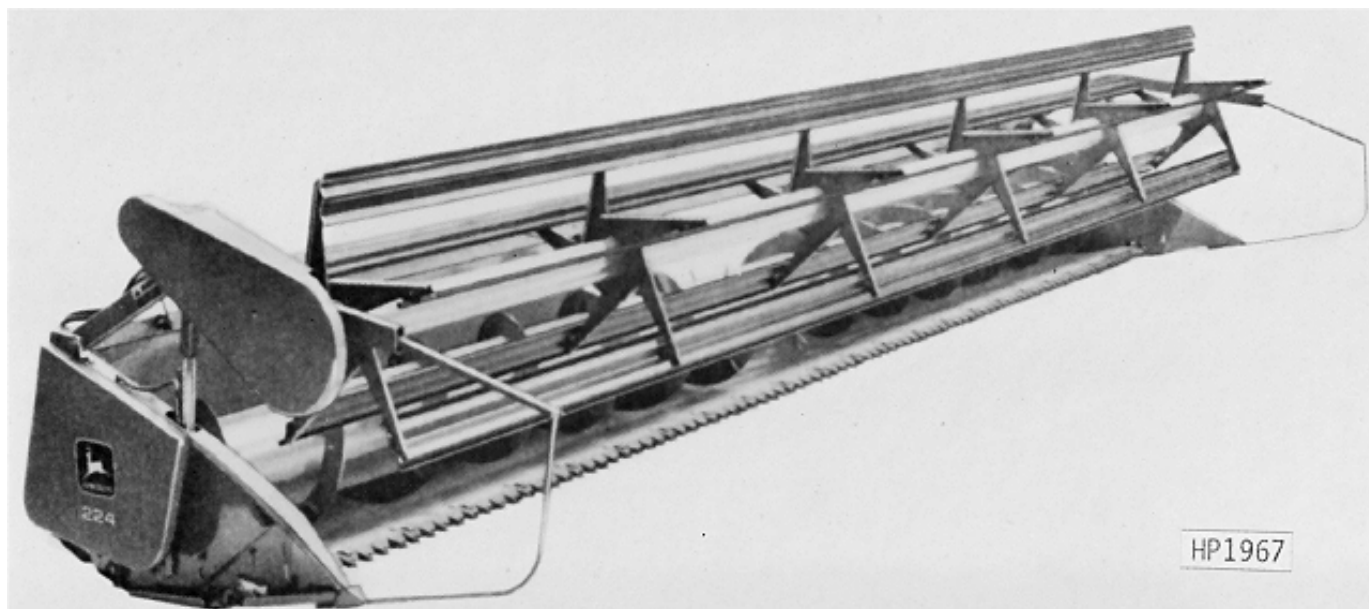

JOHN DEERE 224 RIGID CUTTERBAR PLATFORM WITH BAT REEL

(SPECIFICATIONS AND DESIGN SUBJECT TO CHANGE WITHOUT NOTICE)

**DATE OF MANUFACTURE**

MODEL NO.	TYPE	DATE
213	RIGID, FLEX	(1976-1987)
215	RIGID, FLEX	(1976-1987)
216	RIGID, FLEX	(1976-1987)
218	RIGID, FLEX	(1976-1987)
220	RIGID, FLEX	(1976-1987)
222	RIGID, FLEX	(1976-1987)
224	RIGID, FLEX	(1976-1987)
230	RIGID	(1979-1987)

## SERIAL NUMBER PLATE

USE ALL NUMBERS, LETTERS, AND SPACES ON THE SERIAL NUMBER PLATE IN WARRANTY CORRESPONDENCE.

200 SERIAL PLATFORMS ( -579900)

ON THESE PLATFORMS, THE SERIAL NUMBER PLATE IS LOCATED ON THE LEFT-HAND SIDE OF THE FRAME.

*EXAMPLE: E0216579900H*  
E - EQUIPMENT  
0216 - PLATFORM MODEL  
579900 - PLATFORM SERIAL NUMBER  
H - FACTORY (HARVESTER WORKS)

200 SERIES PLATFORM (579901- )

ON THESE PLATFORMS, THE SERIAL NUMBER PLATE IS LOCATED ON THE LEFT-SIDE OF THE FRAME.

*EXAMPLE: H00216R579901*  
216 PLATFORM

(FIRST LINE) H0 - FACTORY (HARVESTER WORKS)  
0216 - PLATFORM MODEL  
R - CONFIGURATION/MODEL SUFFIX  
579901 - PLATFORM SEQUENCE NUMBER (SERIAL NUMBER)  
(SECOND LINE) PLATFORM - PRODUCT TYPE

## SERIAL NUMBER LISTING INFORMATION

SERIAL NUMBER INFORMATION IS LISTED TO SHOW ON WHICH MACHINES A PART CAN BE USED; FOR EXAMPLE:

- THE PART CAN BE USED ON ALL MACHINES.
- 000000- THE PART CAN BE USED ON ALL MACHINES BEGINNING WITH THE SERIAL NUMBER LISTED.
- 000000 THE PART CAN BE USED ON ALL MACHINES UP TO AND INCLUDING THE SERIAL NUMBER LISTED.
- 000000-000000 THE PART CAN BE USED ON ALL MACHINES BETWEEN AND INCLUDING THE SERIAL NUMBERS LISTED.

WHEN XXXXXX'S ARE LISTED IN PLACE OF A SERIAL NUMBER, A SERIAL NUMBER CHANGE WAS MADE BUT THE EXACT SERIAL NUMBER WAS NOT AVAILABLE WHEN THE CATALOG WAS PRODUCED.

*COPYRIGHT (C) 2000. DEERE & COMPANY. MOLINE, ILLINOIS  
ALL RIGHTS RESERVED*

## IMPORTANT

THIS PARTS CATALOG CONTAINS COMPLETE PARTS INFORMATION ON THE 200 SERIES CUTTING PLATFORM. VINTAGE IS DETERMINED BY SERIAL NUMBERS UNDER WHICH PLATFORMS WERE MANUFACTURED. IT IS IMPORTANT THAT THE CORRECT SERIAL NUMBER BE USED WHEN ORDERING PARTS.

## DIRECTION ARROW

ARROWS ARE USED WITH ILLUSTRATIONS TO INDICATE THE FRONT OF THE UNIT. "RIGHT-HAND" AND "LEFT-HAND" SIDES ARE DETERMINED BY FACING IN THE DIRECTION OF MACHINE FORWARD TRAVEL.

## BOX-ENCLOSED ILLUSTRATIONS

A KEY NUMBER, SHOWN IN THE PARTS LIST, IS ASSIGNED TO A BOX ENCLOSING ALL PARTS SOLD AS A SERVICE ASSEMBLY. A BOX NOT KEYED INCLUDES NON-CURRENT PARTS.

## KITS

KIT INFORMATION WILL BE FOUND IMMEDIATELY FOLLOWING THE STORY IN WHICH IT IS USED. THE ILLUSTRATION IS REPEATED WITH ONLY THE KIT PARTS CALLED OUT AND WITH ALL OTHER PARTS SHOWN IN PHANTOM FOR RELATIONSHIP.

## JDM REMANUFACTURED COMPONENTS

THE SERVICE PARTS LISTED IN THIS CATALOG ARE INTENDED FOR THE REPAIR OF ORIGINAL EQUIPMENT COMPONENTS. ALTHOUGH MOST SERVICE PARTS MAY BE USED TO REPAIR REMANUFACTURED COMPONENTS, THE REMANUFACTURED DESIGN MAY CHANGE PARTS SUFFICIENTLY SO THAT SERVICE PARTS ARE INADEQUATE OR NOT USABLE.

## BOLT AND CAP SCREW STRENGTH IDENTIFICATION

BOLTS AND CAP SCREWS REQUIRED TO HAVE HIGH-STRENGTH QUALITIES EQUIVALENT TO SAE GRADE 8 ARE IDENTIFIED THROUGHOUT THIS CATALOG BY THE DESCRIPTION HS SAE 8. ALL STANDARD BOLTS AND CAP SCREWS ARE SAE GRADE 5 OR LOWER.

## SI UNITS OF MEASURE

METRIC DIMENSIONS ARE GIVEN, WHERE APPLICABLE, THROUGHOUT THIS PARTS CATALOG.

## TRADEMARKS

THROUGHOUT THIS PARTS CATALOG, YOU WILL FIND THE FOLLOWING DEERE & COMPANY TRADEMARKS:

DIAL-A-MATIC™

## CHANGE INDICATOR LINE (MICROFICHE CATALOGS ONLY)

CHANGES AFFECTING THE ORDERING OF PARTS ARE IDENTIFIED BY VERTICAL LINES MARKED IN THE LEFT-HAND MARGIN OF REVISED PARTS LISTING IMAGES. A LINE IS ALSO AT THE LEFT-HAND EDGE OF THE SAME PART NUMBER IN THE NUMERICAL INDEX TO SHOW THE LOCATION OF REVISED INFORMATION.

## SECTION INDEX

SECTION 05 - GENERAL INFORMATION

SECTION 10 - REEL

SECTION 15 - FRAME, SHEETS, DIVIDERS, SKID PLATES AND HEADER HEIGHT CONTROL

SECTION 20 - KNIFE, CUTTERBAR AND DRIVES

SECTION 25 - AUGER AND DRIVE

SECTION 30 - HYDRAULICS

SECTION 35 - IDLERS, TIGHTENERS, AND SHIELDS

SECTION 40 - BELTS, CHAINS, SHEAVES, SPROCKETS AND DECALS

SECTION 45 - NUMERICAL INDEX

## ALPHABETICAL INDEX

GRID		PAGE	GRID		PAGE
<b>A</b>					
F11	ARM, BAT REEL .....	10 - 10	I8	CROSS AUGER SPROCKET .....	25 - 7
F13	ARM, BAT REEL .....	10 - 12	I8	CROSS AUGER SUPPORT .....	25 - 7
F4	ARM, PICKUP REEL .....	10 - 2	H16	CUTTERBAR DRIVE .....	20 - 16
F17	ARM, REEL .....	10 - 16	H18	CUTTERBAR DRIVE (SH).....	20 - 18
F19	ARM, REEL .....	10 - 18	H22	CUTTERBAR DRIVE SUPPORT SPRING .....	20 - 22
F18	ARM, REEL (RIGID AND FLEXIBLE) .....	10 - 17	H9	CUTTERBAR KNIFE GUARDS (NON-CLOG) .....	20 - 9
G16	ARM, STOP .....	15 - 23	F19	CYLINDER ROD EXTENSION .....	10 - 18
I4	AUGER AND SHAFT, CROSS .....	25 - 3	I19	CYLINDER, HYDRAULIC, LIFT REEL, MASTER.....	30 - 3
G17	AUTOMATIC HEADER HEIGHT CONTROL .....	15 - 24	I18	CYLINDER, HYDRAULIC, LIFT REEL, SLAVE .....	30 - 1
<b>B</b>					
G19	BALL, INDICATOR, AUTO. HEIGHT CONTROL .....	15 - 26	<b>D</b>		
F11	BAT REEL ARM.....	10 - 10	H18	DECAL, DRIVE SHAFT(SH) .....	20 - 18
F13	BAT REEL ARM.....	10 - 12	I13	DECAL, DRIVESHAFT .....	25 - 12
F11	BAT REEL DRIVE SHAFT.....	10 - 10	I15	DECAL, DRIVESHAFT .....	25 - 14
F13	BAT REEL DRIVE SHAFT.....	10 - 12	G19	DECAL, RANGE INDICATOR .....	15 - 26
F15	BAT REEL DRIVE SHAFT,SPRKTS,AND MTGS. ....	10 - 14	G22	DECAL,RANGE IND.,DIAL-A-MATIC HDR. HGT. CONT. ....	15 - 29
F11	BAT REEL MOUNTING .....	10 - 10	J17	DECALS .....	40 - 3
F13	BAT REEL MOUNTING .....	10 - 12	J19	DECALS, RIGHT-HAND AND LEFT-HAND .....	40 - 5
F11	BAT REEL SHIELD .....	10 - 10	G24	DIAL-A-MATIC HDR HGT CONT,WIRING HARNESS (FLEX) .....	15 - 31
F13	BAT REEL SHIELD .....	10 - 12	G18	DIAL-A-MATIC HDR.HGT.CONT.SENSING BOX.....	15 - 25
F11	BAT REEL SLAT .....	10 - 10	G18	DIAL-A-MATIC HEADER HEIGHT CONTROL MTG. ....	15 - 25
F13	BAT REEL SLAT .....	10 - 12	G10	DIVIDER POINTS (RIGID).....	15 - 17
F11	BAT REEL SPROCKETS.....	10 - 10	G10	DIVIDER, LOOP .....	15 - 17
F13	BAT REEL SPROCKETS.....	10 - 12	G11	DIVIDERS, LONG, ROW CROP .....	15 - 18
F4	BAT, PICKUP REEL .....	10 - 2	J15	DRIVE BELT, L.H. SIDE .....	40 - 1
F4	BATSHAFT, PICKUP REEL.....	10 - 2	J16	DRIVE CHAINS AND SPROCKETS, R.H. SIDE .....	40 - 2
I6	BEARINGS, CROSS AUGER .....	25 - 5	H18	DRIVE SHAFT DECAL (SH) .....	20 - 18
H12	BEARINGS, KNIFE DRIVE CASE.....	20 - 12	F11	DRIVE SHAFT, BAT REEL .....	10 - 10
J15	BELT, DRIVE, L.H. SIDE .....	40 - 1	F13	DRIVE SHAFT, BAT REEL .....	10 - 12
H3	BLOCK, GUARD AND KNIFE REPAIR.....	20 - 2	I13	DRIVE SHAFT, DECAL .....	25 - 12
H6	BOLTED KNIFE AND MOUNTINGS .....	20 - 6	I15	DRIVE SHAFT, DECAL .....	25 - 14
I8	BRACKETS, CROSS AUGER .....	25 - 7	H20	DRIVE SHAFT, HEADER - SIDEHILL .....	20 - 20
<b>C</b>					
H10	CASE, KNIFE DRIVE.....	20 - 10	J15	DRIVE SHEAVES, L.H. SIDE .....	40 - 1
F19	CHAIN, CYL. ROD EXTENSION.....	10 - 18	J15	DRIVE TIGHTENERS, L.H. SIDE .....	40 - 1
J16	CHAINS, DRIVE, R.H. SIDE .....	40 - 2	J16	DRIVE TIGHTENERS, R.H. SIDE.....	40 - 2
G18	CIRCUIT BOARD,DIAL-A-MATIC HDR.HGT.CONT. ....	15 - 25	H16	DRIVE, CUTTERBAR.....	20 - 16
I13	CLUTCH, CROSS AUGER DRIVE (SH).....	25 - 12	H22	DRIVE, CUTTERBAR.....	20 - 22
I15	CLUTCH, CROSS AUGER DRIVE (SH).....	25 - 14	H18	DRIVE, CUTTERBAR (SH) .....	20 - 18
I9	CLUTCH, SLIP, CROSS AUGER DRIVE .....	25 - 8	<b>E</b>		
I11	CLUTCH, SLIP, CROSS AUGER DRIVE .....	25 - 10	F19	EXTENSION CYL. ROD .....	10 - 18
I22	CONNECTORS, REEL DRIVE .....	30 - 6	F18	EXTENSION, RAM.....	10 - 17
I22	CONNECTORS, REEL LIFT .....	30 - 6	I2	EXTENSIONS, FLIGHT, CROSS AUGER .....	25 - 1
I4	COVER, CROSS AUGER .....	25 - 3	<b>F</b>		
I6	CRANK, CROSS AUGER .....	25 - 5	G1	FEED PLATES, MAIN SILL, AND SUPPORTS .....	15 - 8
I4	CROSS AUGER AND SHAFT.....	25 - 3	F4	FINGER, PICKUP REEL .....	10 - 2
I6	CROSS AUGER BEARINGS.....	25 - 5	I6	FINGERS, CROSS AUGER.....	25 - 5
I8	CROSS AUGER BRACKETS .....	25 - 7	F22	FLEXIBLE FRAME .....	15 - 3
I4	CROSS AUGER COVER.....	25 - 3	F24	FLEXIBLE FRAME .....	15 - 5
I6	CROSS AUGER CRANK.....	25 - 5	G15	FLEXIBLE STABILIZER .....	15 - 22
I9	CROSS AUGER DRIVE.....	25 - 8	I2	FLIGHT EXTENSIONS.....	25 - 1
I11	CROSS AUGER DRIVE.....	25 - 10	F25	FLOOR STRIPPER .....	15 - 7
I13	CROSS AUGER DRIVE (SH) .....	25 - 12	F21	FRAME .....	15 - 2
I15	CROSS AUGER DRIVE (SH) .....	25 - 14	F23	FRAME .....	15 - 4
I6	CROSS AUGER FINGERS .....	25 - 5	F22	FRAME (FLEXIBLE).....	15 - 3
I2	CROSS AUGER FLIGHT EXTENSIONS .....	25 - 1	F24	FRAME (FLEXIBLE).....	15 - 5
I4	CROSS AUGER HUB .....	25 - 3	F21	FRAME (RIGID AND FLEXIBLE) .....	15 - 2
I6	CROSS AUGER SHAFTS .....	25 - 5	F23	FRAME (RIGID AND FLEXIBLE) .....	15 - 4
I8	CROSS AUGER SHIELDS .....	25 - 7			

## ALPHABETICAL INDEX - CONTINUED

<i>GRID</i>		<i>PAGE</i>	<i>GRID</i>		<i>PAGE</i>
F22	FRAME (RIGID) .....	15-3	G16	LINK, PUSH, STOP ARM .....	15-23
F24	FRAME (RIGID) .....	15-5	G19	LINKAGE, HEIGHT SENSING .....	15-26
<b>G</b>			<b>M</b>		
H3	GUARD AND KNIFE REPAIR BLOCK .....	20-2	G1	MAIN SILL, FEED PLATES, AND SUPPORTS .....	15-8
F7	GUARD, PICKUP REEL .....	10-6	J10	MOTOR, HYD., HYDROSTATIC DRIVE REEL .....	30-17
F9	GUARD, PICKUP REEL .....	10-8	J11	MOTOR, REEL .....	30-18
H8	GUARDS AND WEAR PLATES .....	20-8	G17	MOUNTING, AUTO. HEADER HEIGHT CONTROL .....	15-24
H9	GUARDS, CUTTERBAR KNIFE (NON-CLOG) .....	20-9	F11	MOUNTING, BAT REEL .....	10-10
H2	GUARDS, LIFTING .....	20-1	F13	MOUNTING, BAT REEL .....	10-12
<b>H</b>			H22	MOUNTING, CUTTERBAR DRIVE .....	20-22
G23	HARNES, WIRING, AUTO. HEIGHT CONTROL .....	15-30	G11	MOUNTING, ROW CROP DIVIDERS .....	15-18
H20	HEADER DRIVE SHAFT - SIDEHILL .....	20-20	F15	MOUNTINGS, BAT REEL DRIVE .....	10-14
G18	HEADER HEIGHT CONTROL, DIAL-A-MATIC .....	15-25	<b>N</b>		
J8	HOSE, HYDRAULIC DRIVE REEL .....	30-15	G10	NOSE, LOOP DIVIDER .....	15-17
J9	HOSES, HYDRAULIC, PICKUP REEL .....	30-16	<b>O</b>		
I22	HOSES, REEL DRIVE .....	30-6	J1	OIL LINES, HYDRAULIC LIFT REEL .....	30-8
I22	HOSES, REEL LIFT .....	30-6	J3	OIL LINES, HYDRAULIC LIFT REEL .....	30-10
J5	HOSES, REEL LIFT .....	30-12	J5	OIL LINES, REEL LIFT .....	30-12
I4	HUB, CROSS AUGER .....	25-3	<b>P</b>		
I19	HYDRAULIC CYLINDER, LIFT REEL, MASTER .....	30-3	F3	PICKUP REEL .....	10-1
I18	HYDRAULIC CYLINDER, LIFT REEL, SLAVE .....	30-1	F4	PICKUP REEL .....	10-2
J8	HYDRAULIC DRIVE REEL HOSE .....	30-15	F3	PICKUP REEL ARM .....	10-1
J9	HYDRAULIC DRIVE REEL HOSES, PICKUP REEL .....	30-16	F4	PICKUP REEL ARM .....	10-2
I20	HYDRAULIC DRIVE REEL LINES .....	30-4	F5	PICKUP REEL ARM .....	10-3
I23	HYDRAULIC DRIVE REEL LINES .....	30-7	F3	PICKUP REEL BAT .....	10-1
J7	HYDRAULIC DRIVE REEL LINES, BAT REEL .....	30-14	F4	PICKUP REEL BAT .....	10-2
J7	HYDRAULIC HOSES, BAT REEL .....	30-14	F3	PICKUP REEL BATSHAFT .....	10-1
I19	HYDRAULIC LIFT REEL MASTER CYLINDER .....	30-3	F4	PICKUP REEL BATSHAFT .....	10-2
J1	HYDRAULIC LIFT REEL OIL LINES .....	30-8	F7	PICKUP REEL DRIVE SHAFT .....	10-6
J3	HYDRAULIC LIFT REEL OIL LINES .....	30-10	F9	PICKUP REEL DRIVE SHAFT .....	10-8
I18	HYDRAULIC LIFT REEL SLAVE CYLINDER .....	30-1	F6	PICKUP REEL ECCENTRIC SPIDER .....	10-5
J10	HYDRAULIC MOTOR, HYDROSTATIC DRIVE REEL .....	30-17	F3	PICKUP REEL FINGER .....	10-1
J10	HYDROSTATIC DRIVE REEL HYDRAULIC MOTOR .....	30-17	F4	PICKUP REEL FINGER .....	10-2
<b>I</b>			F5	PICKUP REEL FINGER .....	10-3
H21	IDLER, KNIFE DRIVE .....	20-21	F7	PICKUP REEL GUARD .....	10-6
G22	IND., RANGE, DIAL-A-MATIC HDR. HGT. CONT. .....	15-29	F9	PICKUP REEL GUARD .....	10-8
G19	INDICATOR, RANGE, AUTO. HEIGHT CONTROL .....	15-26	F7	PICKUP REEL MOUNTINGS .....	10-6
<b>K</b>			F9	PICKUP REEL MOUNTINGS .....	10-8
H3	KNIFE AND GUARD REPAIR BLOCK .....	20-2	F5	PICKUP REEL SPIDER .....	10-3
H6	KNIFE AND MOUNTINGS, BOLTED .....	20-6	F3	PICKUP REEL SPIDER PLATE .....	10-1
H4	KNIFE AND MOUNTINGS, RIVETED .....	20-4	F4	PICKUP REEL SPIDER PLATE .....	10-2
H10	KNIFE DRIVE CASE .....	20-10	F7	PICKUP REEL SPROCKETS .....	10-6
H12	KNIFE DRIVE CASE BEARINGS AND SUPPORTS .....	20-12	F9	PICKUP REEL SPROCKETS .....	10-8
H21	KNIFE DRIVE IDLER AND TIGHTENER .....	20-21	F19	PIN, REEL ARM .....	10-18
H9	KNIFE GUARDS, CUTTERBAR (NON-CLOG) .....	20-9	G10	PLATE, DIVIDER POINT SKID .....	15-17
<b>L</b>			F4	PLATE, PICKUP REEL SPIDER .....	10-2
H2	LIFTING GUARDS .....	20-1	G5	PLATES, PROTECTION (RIGID) .....	15-12
I23	LINES, HYDRAULIC DRIVE REEL .....	30-7	G5	PLATES, SKID (RIGID) .....	15-12
J7	LINES, HYDRAULIC, BAT REEL .....	30-14	G10	POINTS, DIVIDER (RIGID) .....	15-17
J1	LINES, OIL, HYDRAULIC LIFT REEL .....	30-8	G5	PROTECTION PLATES (RIGID) .....	15-12
J3	LINES, OIL, HYDRAULIC LIFT REEL .....	30-10	<b>R</b>		
I20	LINES, REEL, HYDRAULIC DRIVE .....	30-4	F17	REEL ARM .....	10-16

## ALPHABETICAL INDEX - CONTINUED

<i>GRID</i>		<i>PAGE</i>	<i>GRID</i>		<i>PAGE</i>
F18	REEL ARM (RIGID AND FLEXIBLE) .....	10 - 17	F25	STRIPPER, FLOOR .....	15 - 7
F19	REEL ARM (RIGID AND FLEXIBLE) .....	10 - 18	I8	SUPPORT, CROSS AUGER .....	25 - 7
J5	REEL LIFT OIL LINES.....	30 - 12	H12	SUPPORTS, KNIFE DRIVE CASE .....	20 - 12
I20	REEL LINES, HYDRAULIC DRIVE .....	30 - 4	G1	SUPPORTS, MAIN SILL, AND FEED PLATES .....	15 - 8
J11	REEL MOTOR .....	30 - 18	G17	SWITCHES, MOUNTING, AUTO. HEIGHT CONTROL ..	15 - 24
F4	REEL, PICKUP.....	10 - 2	G17	SWITCHES, SENSING, AUTO. HEIGHT CONTROL.....	15 - 24
G16	REINFORCEMENT, STOP ARM.....	15 - 23			
F22	RIGID FRAME .....	15 - 3		T	
F24	RIGID FRAME .....	15 - 5	H21	TIGHTENER, KNIFE DRIVE .....	20 - 21
H4	RIVETED KNIFE AND MOUNTINGS .....	20 - 4	J15	TIGHTENERS AND SHEAVE ON L.H. SIDE .....	40 - 1
G11	ROW CROP LONG DIVIDERS .....	15 - 18	J16	TIGHTENERS AND SPROCKETS, R.H. SIDE.....	40 - 2
	S			W	
G3	SEALS .....	15 - 10	H8	WEAR PLATES .....	20 - 8
G17	SENSING SWITCHES, AUTO. HDR. HGT. CONT. ....	15 - 24	G23	WIRING HARNESS-AUTO. HDR. HEIGHT CONTROL ..	15 - 30
I4	SHAFT AND AUGER, CROSS .....	25 - 3	G24	WIRING HARNESS,DIAL-A-MATIC HDR HGT CONT....	15 - 31
F15	SHAFT, BAT REEL DRIVE .....	10 - 14			
I9	SHAFT, CROSS AUGER DRIVE .....	25 - 8			
I11	SHAFT, CROSS AUGER DRIVE .....	25 - 10			
I13	SHAFT, CROSS AUGER DRIVE (SH) .....	25 - 12			
I15	SHAFT, CROSS AUGER DRIVE (SH) .....	25 - 14			
H16	SHAFT, CUTTERBAR DRIVE .....	20 - 16			
H20	SHAFT, HEADER DRIVE - SIDEHILL .....	20 - 20			
I6	SHAFTS, CROSS AUGER .....	25 - 5			
H18	SHEAVE, CUTTERBAR DRIVE (SH) .....	20 - 18			
H21	SHEAVE, IDLER, KNIFE DRIVE .....	20 - 21			
J13	SHIELD.....	35 - 1			
F11	SHIELD, BAT REEL.....	10 - 10			
F13	SHIELD, BAT REEL.....	10 - 12			
I9	SHIELD, CROSS AUGER DRIVE .....	25 - 8			
I11	SHIELD, CROSS AUGER DRIVE .....	25 - 10			
I13	SHIELD, CROSS AUGER DRIVE (SH) .....	25 - 12			
I15	SHIELD, CROSS AUGER DRIVE (SH) .....	25 - 14			
H16	SHIELD, CUTTERBAR DRIVE .....	20 - 16			
H18	SHIELD, CUTTERBAR DRIVE (SH) .....	20 - 18			
I8	SHIELDS, CROSS AUGER .....	25 - 7			
J13	SHIELDS, DRIVE .....	35 - 1			
G10	SHOE, DIVIDER.....	15 - 17			
G8	SHOES, SKID (FLEXIBLE) .....	15 - 15			
H20	SIDEHILL - HEADER DRIVE SHAFT .....	20 - 20			
G5	SKID PLATES (RIGID).....	15 - 12			
G8	SKID SHOES (FLEXIBLE).....	15 - 15			
F11	SLAT, BAT REEL.....	10 - 10			
F13	SLAT, BAT REEL.....	10 - 12			
F6	SPIDER, ECCENTRIC, PICKUP REEL.....	10 - 5			
H22	SPRING, CUTTERBAR DRIVE .....	20 - 22			
H23	SPRING, STABILIZER .....	20 - 23			
H24	SPRING, STABILIZER .....	20 - 24			
I8	SPROCKET, CROSS AUGER.....	25 - 7			
I9	SPROCKET, CROSS AUGER DRIVE .....	25 - 8			
I11	SPROCKET, CROSS AUGER DRIVE .....	25 - 10			
I13	SPROCKET, CROSS AUGER DRIVE (SH) .....	25 - 12			
I15	SPROCKET, CROSS AUGER DRIVE (SH) .....	25 - 14			
H16	SPROCKET, CUTTERBAR DRIVE .....	20 - 16			
F11	SPROCKETS, BAT REEL .....	10 - 10			
F13	SPROCKETS, BAT REEL .....	10 - 12			
F15	SPROCKETS, BAT REEL DRIVE .....	10 - 14			
F7	SPROCKETS, PICKUP REEL .....	10 - 6			
F9	SPROCKETS, PICKUP REEL .....	10 - 8			
G15	STABILIZER (FLEXIBLE).....	15 - 22			
G15	STABILIZER ARM .....	15 - 22			
H23	STABILIZER SPRING .....	20 - 23			
H24	STABILIZER SPRING .....	20 - 24			
G16	STOP ARM, PUSH LINK, AND REINFORCEMENT .....	15 - 23			
F19	STOP, CYL. ROD EXTENSION .....	10 - 18			

---

MEMORANDA



# F3

REEL

PICKUP REEL-YELLOW (RIGID AND FLEXIBLE)  
(SERIAL NO. -365600)

H26615 -UN-01JAN94

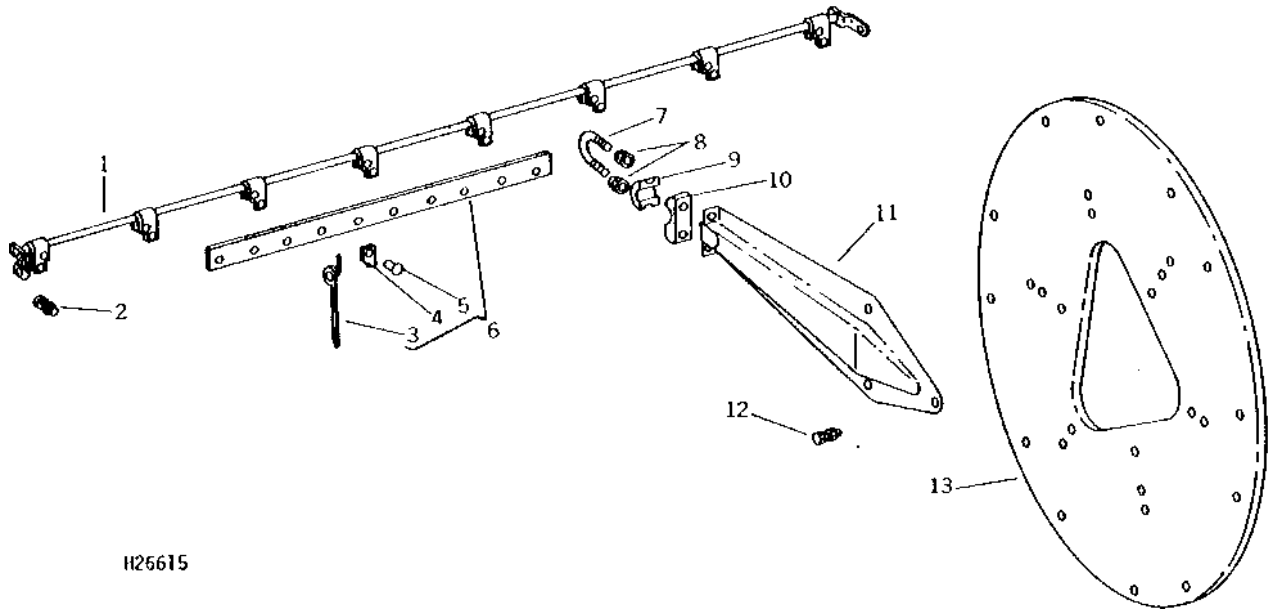

H26615

KEY	PART NO.	PART NAME	QTY	SERIAL NO.	REMARKS
1	AH19680	SHAFT	6	(SUB AH97182) (213)	
	AH63039	SHAFT	6	(215) (SUB AH97183)	
	AH19695	SHAFT	6	(SUB AH97184) (216)	
	AH19698	SHAFT	6	(218) (SUB AH97185)	
	AH63604	SHAFT	6	(SUB AH97186) (220)	
	AH80100	SHAFT	6	(222) (SUB AH97187)	
2	AH81254	SHAFT	6	(224) (SUB AH87188)	
	03H1810	BOLT	AR	1/4" X 1-1/2"	
3	E45229	LOCK NUT	AR		
	H33316	FINGER	AR	(213-186 USED; 215-216 USED; 216-234 USED; 218-258 USED; 220-294 USED; 222-324 USED; AND 224-360 USED)	
4	H33317	CLIP	AR	(213-186 USED; 215-216 USED; 216-234 USED; 218-258 USED; 220-294 USED; 222-324 USED; AND 224-360 USED)	
5	H33318	RIVET	AR	(213-186 USED; 215-216 USED; 216-234 USED; 218-258 USED; 220-294 USED; 222-324 USED; AND 224-360 USED)	
6	AH19681	SLAT	12	(R.H. AND L.H.)(213) (SUB AH97190)	
	AH19682	SLAT	6	(CENTER)(213) (SUB AH97191)	
	AH63038	SLAT	18	(215) (SUB AH97193)	
	AH19696	SLAT	AR	(216-18 USED; 218-6 USED) (SUB AH97194)	
	AH19699	SLAT	AR	(218, R.H. AND L.H.-2 USED; 220, CENTER- 6 USED) (SUB AH97195)	
	AH65216	SLAT	12	(220) (SUB AH97196)	
7	AH80098	SLAT	18	(222) (SUB AH97197)	
	AH81256	SLAT	18	(224) (SUB AH97200)	
	E40203	U-BOLT	24		
8	E40202	LOCK NUT	48	-365600 (SUB E45229)	
	E45229	LOCK NUT	48		
9	E40205	CAP	24		
10	E40206	BASE	24		
11	AE24410	ARM	24		
12	19H2020	CAP SCREW	72	5/16" X 1/2"	
	12H303	LOCK WASHER	72	5/16"	
	14H785	NUT	72	5/16"	
13	H84031	PLATE	4	(213, 215, 216, 218)	
	H84031	PLATE	4	(220)	
	H88454	PLATE	4	-267450 (SUB H98689) (220)	
	H88454	PLATE	4	267451- (SUB H98689) (222 AND 224)	

H26615 -UN-01JAN94

PICKUP REEL-BLACK (RIGID AND FLEXIBLE)  
(SERIAL NO. 365601- )

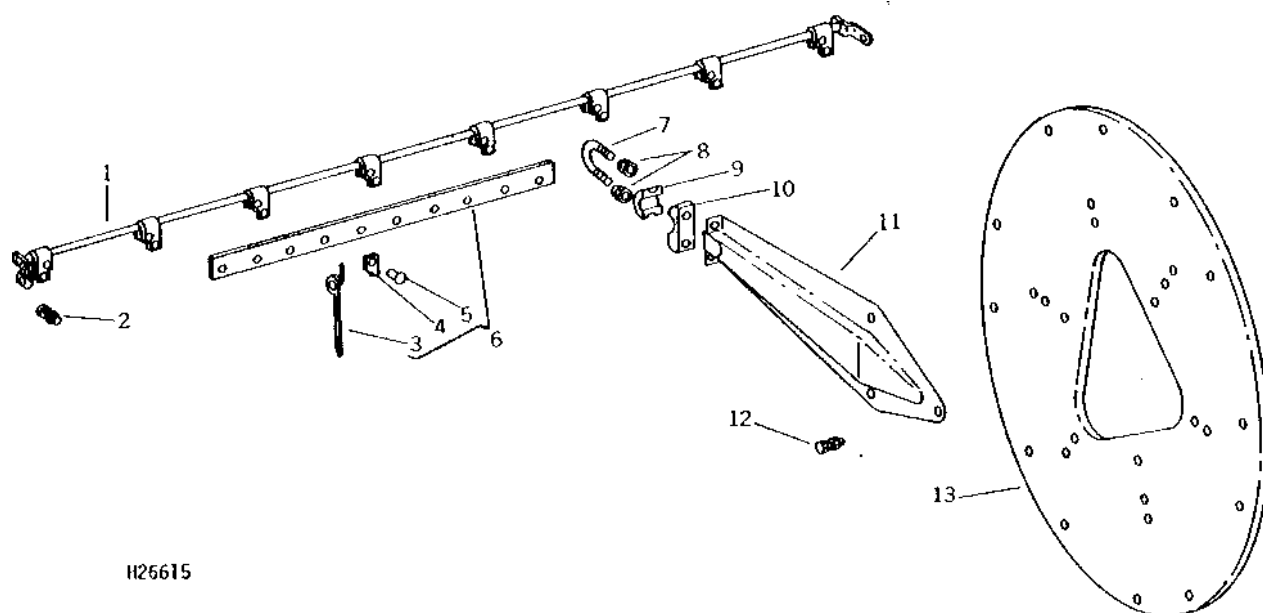

H26615

KEY	PART NO.	PART NAME	QTY	SERIAL NO.	REMARKS
1	AH97182	SHAFT	6	(213)	
	AH97183	SHAFT	6	(215)	
	AH97184	SHAFT	6	(216)	
	AH97185	SHAFT	6	(218)	
	AH97186	SHAFT	6	(220)	
	AH97187	SHAFT	6	(222)	
	AH97188	SHAFT	6	(224)	
2	AH97189	SHAFT	6	433738-	(230)
	03H1810	BOLT	AR		1/4" X 1-1/2"
3	E45229	LOCK NUT	AR		
	H33316	FINGER	AR		(213-186 USED; 215-216 USED; 216-234 USED; 218-258 USED; 220-294 USED; 222-324 USED; 224-360 USED; AND 230-456 USED)
4	H33317	CLIP	AR		(213-186 USED; 215-216 USED; 216-234 USED; 218-258 USED; 220-294 USED; 222-324 USED; 224-360 USED; AND 230-456 USED)
5	H33318	RIVET	AR		(213-186 USED; 215-216 USED; 216-234 USED; 218-258 USED; 220-294 USED; 222-324 USED; 224-360 USED; AND 230-456 USED)
6	AH97190	SLAT	12		R.H AND L.H. (213)
	AH97191	SLAT	6		CENTER (213)
	AH97193	SLAT	18		(215)
	AH97194	SLAT	AR		(216-18 USED AND 218 CENTER-6 USED)
	AH97195	SLAT	AR		(218, R.H. AND L.H.-12 USED; 220, CENTER-6 USED)
	AH97196	SLAT	12		(220)
	AH97197	SLAT	18		(222)
	AH97200	SLAT	18		(224)
7	AH97198	SHAFT	12	433738-	R.H. AND L.H. (230)
	AH97199	SHAFT	12	433738-	CENTER (230)
8	E40203	U-BOLT	AR		(213, 215, 216, 218, 220, 222, 224-36 USED; AND 230-42 USED)
9	E40202	LOCK NUT	AR	-585895	(SUB E45229)
	E45229	LOCK NUT	AR		(213, 215, 216, 218, 220, 222, 224-72 USED; AND 230-42 USED)
10	E40205	CAP	AR		(213, 215, 216, 218, 220, 222, 224-36 USED; AND 230-42 USED)
11	E40206	BASE	AR		(213, 215, 216, 218, 220, 222, 224-36 USED; AND 230-42 USED)
12	AH97207	ARM	AR		(213, 215, 218, 220, 222, 224-36 USED; AND 230-42 USED)
13	19H2020	CAP SCREW	72		5/16" X 1/2"
	12H303	LOCK WASHER	72		5/16"
	14H785	NUT	72		5/16"
13	H98688	PLATE	4		(213, 215, 216, AND 218)
	H98689	PLATE	AR		(220, 222, 224-4 USED; AND 230-5 USED)