

Directions for use of Parts Catalogue

1. Applicable model of machines

All component and option parts used for TM3200, TM3240 tractors are listed in this parts catalogue.

1) MODEL TYPE

- F..... FOUR WHEEL DRIVE
- H..... HST
- S..... POWER STEERING & INDEPENDENT PTO
- M..... MID PTO.
- U..... POWER STEERING
- R..... FRONT/REAR HITCH & ROPS

2) AREA CODE

- E4..... EUROPE

2. Explanation for head paragraph

KEY	PART CODE	DESCRIPTION	S P C	TYPE OF MODEL						I T C	C O L	G R P	REMARKS
				SSM48M	SSM48F	SSM48G	SRM48M	SRM48F	SRM48G				
1	8595-211-001-20	CASE/UPPER	*	1									
1A	8657-201-081-00	CASE/UPPER	*	1			1						
2	8595-211-002-10	CASE/LOWER	*	1			1						
3	V523-100-801-80	PIN	*	5			2						
4	V211-260-803-00	BOLT, SEWS	*	6			1						
			*	2			2						
			*	2			2						
			*	2			2						
			*	1			1						

- ① KEY shows the location of parts diagramed in the illustration.
- ② Parts numbers begin with `V` and `W` are standard parts of the market.
- ③ `LH` and `RH` on the parts name are described against the moving direction of the machine or are described on the condition how to install parts on the machines.

- ④ SPC : The following symbol classifies parts to be used for machines.
- `*` means standard parts.
 - `T` shows that the parts can be installed as optional parts.
 - `R` shows that the parts can be used as applicable parts to replace originally equipped parts.
- ⑤ Upper column : QTY shows the number of parts to be used for one unit of machine.
- `M` is indicated for parts supplied by a meter long.
 - `l` is indicated for parts supplied by liter.
 - `AR` is indicated for parts need to be adjusted or regulated.
- Lower column : serial number
- 229 means serial number up to 229.
 - 230— means serial number 230 and after.
- ⑥ ITC : Interchangeability
- `1`...OLD ← NEW
New parts can be used in place of the old parts.
 - `2`...OLD → NEW
Old parts can be used in place of the new parts.
 - `3`...OLD →← NEW
Old parts and new parts can not be replaced each other.
- ⑦ COL : Color code
- Color is signified with color code number for colored parts.
Please see the color list shown in the next page.
- ⑧ GRP : Parts shown in this column can be replaced by SET parts.
- Example : Parts marked ① can be replaced by parts marked ②, and ③ for ④, so the rest follow in the same alphabetical order.
- ⑨ Remarks
- * Other maker's part code number is shown in this column.
 - * When Fig. No. is shown in the Remark column of SET parts or ASSY parts, each of their component parts are listed in said Fig. No.

3. Color :

The following colors are used color parts.

COLOR CODE	COLOR	SPRAY TYPE CODE NUMBER	PAINTS 4K DRUM	PAINTS 16K DRUM
4 L	NEO BLUE	1300-985-001-10	1300-985-003-00	—————
5 I	SUNSET GRAY	1300-959-001-10	1300-959-003-00	1300-959-004-00
6 G	SUMMER WHITE	1300-958-001-10	1300-958-003-00	1300-958-004-00
7 F	MIRROR BLACK	1300-954-001-10	1300-954-003-00	1300-954-004-00

NOTE : Color code is signified only for the parts assigned by the maker as color parts.

4. Serial Numbers :

1) For engines serial number is stamped on CYLINDER BLOCK ASSY.

Please see Fig. No. 5-1.

2) For chassies serial number is shown on the LABEL.

Please see



5. Parts Order

1) Parts numbers listed in the parts catalogue are all registered in “ISEKI on-line computer”.

2) When you order parts, please make sure of correct numbers.

3) When substitute parts is available, the part number ordered will be automatically turned to a new part number.

4) Please be sure to use “ISEKI GENUINE PARTS”.

Any other similar parts other than ISEKI parts when used may cause a trouble that makes us unable to repair or guarantee the warrant.

*** Structure Table of Model ***

M O D E L FIG.	T M 3 2 0 0 4 4 4	T M 3 2 0 0 4 4 4	T M 3 2 4 4 4	T M 3 2 4 4 4								
1	***		**	*								
2			**									
3	***	***	**	**	*							
4	***	***	**	**	*							
5	***	***	**	**	*							
6	***	***	**	**	*							
7	***	***	**	**	*							
8	***	***	**	**	*							
9	***	***	**	**	*							
10			**		*							
11	***			**	*							
12	***			**	*							
13			**		*							
14			**		*							
15	***			**	*							
16			**		*							
17	***			**	*							
18	***			**	*							
19	***			**	*							
20			**		*							
21	***			**	*							
22	***			**	*							
23			**		*							
24	***			**	*							
25			**		*							
26			**		*							
27	***			**	*							
28				**	*							
29	***											
30			**		*							
31	***	***	**	**	*							
32	***	***	**	**	*							
33			**		*							
34	***	***	**	**	*							
35			**		*							
36	**			**								
37	*				*							
38			**		*							
39			**		*							
40			**		*							
41					*							
42			**		*							
43			**		*							
44	***	***	**	**	*							
45	***	***	**	**	*							

*** Structure Table of Model ***

M O D E L	T	T	T	T									
	M	M	M	M									
	3	F	F	F	3	F	F	3	F	F	F	3	F
	2	M	M	U	2	H	H	2	M	M	U	2	H
	0	U	U	R	0	S	S	4	U	U	R	4	S
	0	E	R	0	M	M	0	E	R	0	M	M	
	4	E	4	H	E	R	4	E	4	H	E	R	
		4		4	E		4		4	E		4	
				4					4				
FIG.													
46	*	*	*	*	*	*	*	*	*	*	*		
47	*	*	*	*			*	*	*				
48					*	*				*	*		
49	*	*	*	*	*	*	*	*	*	*	*		
50	*	*	*	*			*	*	*				
51					*	*				*	*		
52	*	*	*	*	*	*	*	*	*	*	*		
53	*	*	*	*	*	*	*	*	*	*	*		
54	*	*	*	*	*	*	*	*	*	*	*		
55	*	*	*	*			*	*	*				
56					*	*				*	*		
57	*	*	*	*	*	*	*	*	*	*	*		
58	*	*	*	*			*	*	*				
59					*	*				*	*		
60	*	*	*	*	*	*	*	*	*	*	*		
61	*	*	*	*	*	*	*	*	*	*	*		
62	*	*	*	*	*	*	*	*	*	*	*		
63	*	*	*	*	*	*	*	*	*	*	*		
64	*	*	*	*	*	*	*	*	*	*	*		
65	*	*	*	*	*	*	*	*	*	*	*		
66	*	*	*	*	*	*	*	*	*	*	*		
67	*	*	*	*	*	*	*	*	*	*	*		
68	*	*	*	*			*	*	*				
69					*	*				*	*		
70	*	*	*	*	*	*	*	*	*	*	*		
71	*	*	*	*	*	*	*	*	*	*	*		
72	*	*	*	*	*	*	*	*	*	*	*		
73	*	*	*	*	*	*	*	*	*	*	*		
74	*	*	*	*	*	*	*	*	*	*	*		
75					*	*				*	*		
76	*	*	*	*	*	*	*	*	*				
77										*	*		
78	*	*	*	*			*	*	*				
79					*	*				*	*		
80	*	*	*	*	*	*	*	*	*	*	*		
81	*	*	*	*			*	*	*				
82					*	*				*	*		
83	*	*	*	*	*	*	*	*	*	*	*		
84	*	*	*	*	*	*	*	*	*	*	*		
85	*	*	*	*			*	*	*				
86					*	*				*	*		
87	*	*	*	*			*	*	*				
88					*	*				*	*		
89	*	*	*	*	*	*	*	*	*	*	*		
90	*	*	*	*	*	*	*	*	*	*	*		

*** Structure Table of Model ***

M O D E L FIG.	T M 3 2 0 0 4 4 4	T M 3 2 0 0 4 4 4	T M 3 2 0 0 4 4 4	T M 3 2 0 0 4 4 4							
91	***		**	**							
92			**	**							
93	***	**	**	**							
94	***	**	**	**							
95	T			T							
96				TTT	TT						
97	TTT	TT									
98				TTT	TT						
99	TTT	TT									
100	T	T	T	T							
101	TTT	TT	TTT	TT							
102	TTT	TT									
103				TTT	TT						
104	TTT	TT	TTT	TT							
105	T	T	T	T							
106	T	T	T	T							
107	TTT	TT	TTT	TT							
108		**		**							
109	***	**	**	**							
110		**		**							
111		**		**							

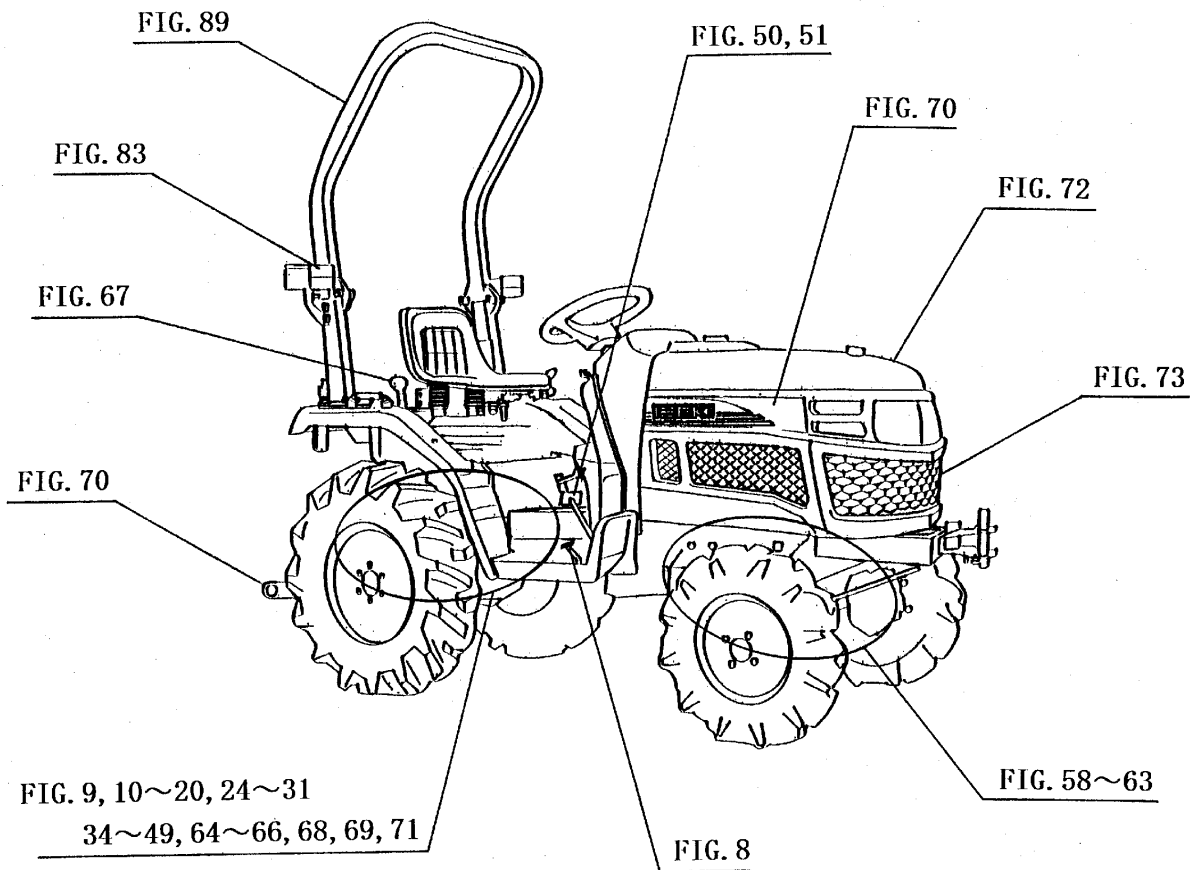
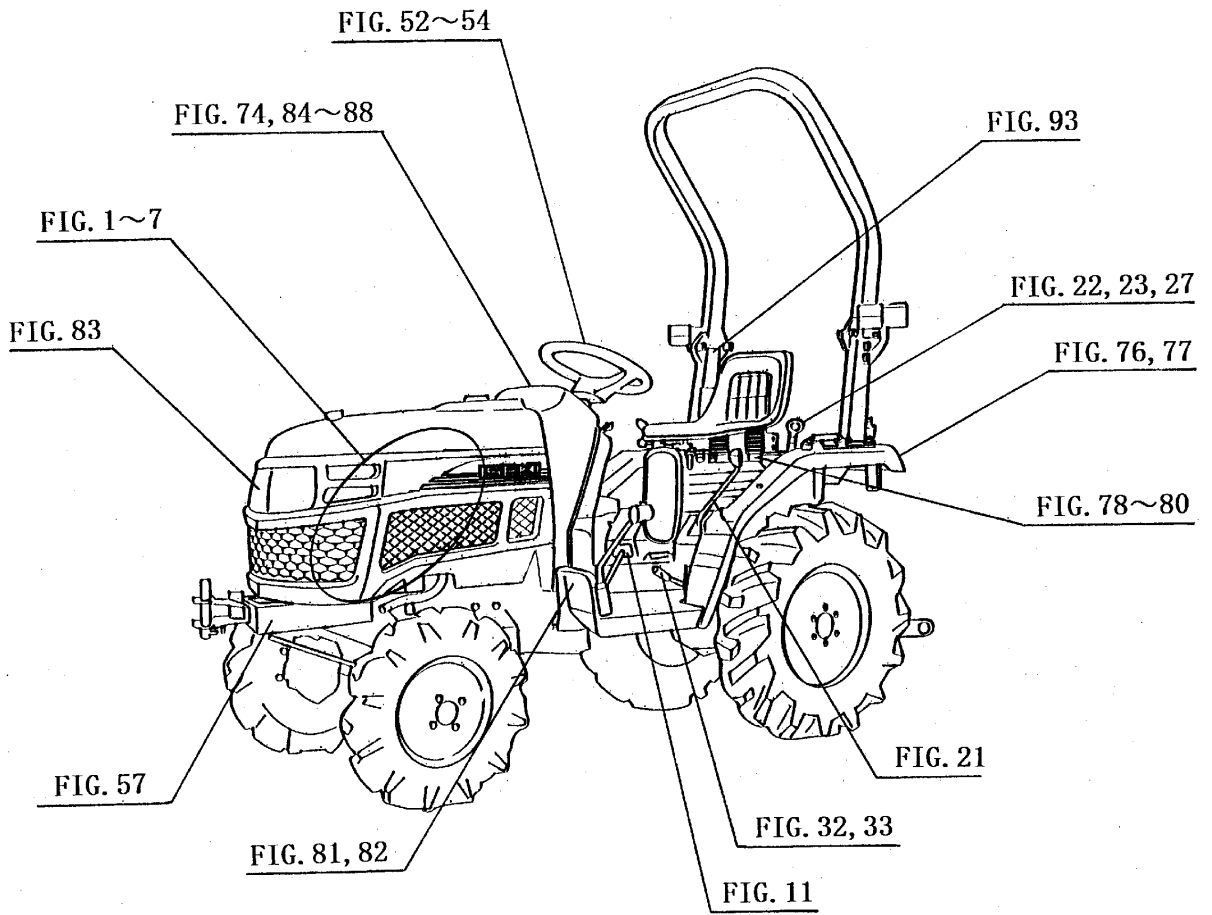

Contents

TM3200H

ENGINE(E3112-B13)

CYLINDER HEAD	Fig. 1
CYLINDER HEAD COVER	Fig. 2
INLET MANIFOLD	Fig. 3
EXHAUST MANIFOLD	Fig. 4
CYLINDER BLOCK	Fig. 5
BEARING/UNDER SIZE (OPTION)	Fig. 6
OIL PAN	Fig. 7
REAR PLATE	Fig. 8
TIMING GEAR CASE	Fig. 9
HANGER	Fig. 10
VALVE	Fig. 11
CAM SHAFT	Fig. 12
PISTON	Fig. 13
PISTON/OVER SIZE (OPTION)	Fig. 14
CRANK SHAFT	Fig. 15
OIL PUMP	Fig. 16
WATER PUMP	Fig. 17
COOLING FAN	Fig. 18
INJECTION NOZZLE	Fig. 19
INJECTION PUMP	Fig. 20
FUEL PIPE	Fig. 21
ADAPTER	Fig. 22
ELECTRIC (1)	Fig. 23
ELECTRIC (2)	Fig. 24

REPAIR PARTS (OPTION).....	Fig. 25
COMPONENT PARTS	
FOR 6215-300-036-00 ON Fig.19.....	Fig. 26
COMPONENT PARTS	
FOR 6215-600-103-10 ON Fig.20.....	Fig. 27
COMPONENT PARTS	
FOR 6281-100-014-00 ON Fig.23.....	Fig. 28
COMPONENT PARTS	
FOR 6281-200-005-00 ON Fig.23.....	Fig. 29

Contents

TM3200

ENGINE(E3112-B14)

CYLINDER HEAD	Fig. 1
CYLINDER HEAD COVER	Fig. 2
INLET MANIFOLD	Fig. 3
EXHAUST MANIFOLD	Fig. 4
CYLINDER BLOCK	Fig. 5
BEARING/UNDER SIZE (OPTION)	Fig. 6
OIL PAN	Fig. 7
REAR PLATE	Fig. 8
TIMING GEAR CASE	Fig. 9
HANGER	Fig. 10
VALVE	Fig. 11
CAM SHAFT	Fig. 12
PISTON	Fig. 13
PISTON/OVER SIZE (OPTION)	Fig. 14
CRANK SHAFT	Fig. 15
OIL PUMP	Fig. 16
WATER PUMP	Fig. 17
COOLING FAN	Fig. 18
INJECTION NOZZLE	Fig. 19
INJECTION PUMP	Fig. 20
FUEL PIPE	Fig. 21
ADAPTER	Fig. 22
ELECTRIC (1)	Fig. 23
ELECTRIC (2)	Fig. 24

REPAIR PARTS (OPTION)..... Fig. 25

COMPONENT PARTS

 FOR 6215-300-036-00 ON Fig.19..... Fig. 26

COMPONENT PARTS

 FOR 6215-600-103-10 ON Fig.20..... Fig. 27

COMPONENT PARTS

 FOR 6281-100-014-00 ON Fig.23..... Fig. 28

COMPONENT PARTS

 FOR 6281-200-005-00 ON Fig.23..... Fig. 29

Contents

TM3240H

ENGINE(E3112-B15)

CYLINDER HEAD.....	Fig. 1
CYLINDER HEAD COVER.....	Fig. 2
INLET MANIFOLD.....	Fig. 3
EXHAUST MANIFOLD.....	Fig. 4
CYLINDER BLOCK.....	Fig. 5
BEARING/UNDER SIZE (OPTION).....	Fig. 6
OIL PAN.....	Fig. 7
REAR PLATE.....	Fig. 8
TIMING GEAR CASE.....	Fig. 9
HANGER.....	Fig. 10
VALVE.....	Fig. 11
CAM SHAFT.....	Fig. 12
PISTON.....	Fig. 13
PISTON/OVER SIZE (OPTION).....	Fig. 14
CRANK SHAFT.....	Fig. 15
OIL PUMP.....	Fig. 16
WATER PUMP.....	Fig. 17
COOLING FAN.....	Fig. 18
INJECTION NOZZLE.....	Fig. 19
INJECTION PUMP.....	Fig. 20
FUEL PIPE.....	Fig. 21
ADAPTER.....	Fig. 22
ELECTRIC (1).....	Fig. 23
ELECTRIC (2).....	Fig. 24

REPAIR PARTS (OPTION).....	Fig. 25
COMPONENT PARTS	
FOR 6215-300-036-00 ON Fig.19.....	Fig. 26
COMPONENT PARTS	
FOR 6215-600-103-10 ON Fig.20.....	Fig. 27
COMPONENT PARTS	
FOR 6281-100-014-00 ON Fig.23.....	Fig. 28
COMPONENT PARTS	
FOR 6281-200-005-00 ON Fig.23.....	Fig. 29

Contents

TM3240

ENGINE(E3112-B16)

CYLINDER HEAD.....	Fig. 1
CYLINDER HEAD COVER.....	Fig. 2
INLET MANIFOLD.....	Fig. 3
EXHAUST MANIFOLD.....	Fig. 4
CYLINDER BLOCK.....	Fig. 5
BEARING/UNDER SIZE (OPTION).....	Fig. 6
OIL PAN.....	Fig. 7
REAR PLATE.....	Fig. 8
TIMING GEAR CASE.....	Fig. 9
HANGER.....	Fig. 10
VALVE.....	Fig. 11
CAM SHAFT.....	Fig. 12
PISTON.....	Fig. 13
PISTON/OVER SIZE (OPTION).....	Fig. 14
CRANK SHAFT.....	Fig. 15
OIL PUMP.....	Fig. 16
WATER PUMP.....	Fig. 17
COOLING FAN.....	Fig. 18
INJECTION NOZZLE.....	Fig. 19
INJECTION PUMP.....	Fig. 20
FUEL PIPE.....	Fig. 21
ADAPTER.....	Fig. 22
ELECTRIC (1).....	Fig. 23
ELECTRIC (2).....	Fig. 24

REPAIR PARTS (OPTION).....	Fig. 25
COMPONENT PARTS	
FOR 6215-300-036-00 ON Fig.19.....	Fig. 26
COMPONENT PARTS	
FOR 6215-600-103-10 ON Fig.20.....	Fig. 27
COMPONENT PARTS	
FOR 6281-100-014-00 ON Fig.23.....	Fig. 28
COMPONENT PARTS	
FOR 6281-200-005-00 ON Fig.23.....	Fig. 29

Contents

CHASSIS

RADIATOR SYSTEM (EXCEPT H TYPE).....	Fig. 1
RADIATOR SYSTEM (H TYPE).....	Fig. 2
MUFFLER SYSTEM.....	Fig. 3
AIR CLEANER SYSTEM.....	Fig. 4
FILTER SYSTEM.....	Fig. 5
FUEL TANK SYSTEM.....	Fig. 6
BATTERY SYSTEM.....	Fig. 7
ACCELERATOR PEDAL (EXCEPT H TYPE), ACCELERATOR SYSTEM.....	Fig. 8
MAIN CLUTCH,INPUT SHAFT SYSTEM (EXCEPT H TYPE).....	Fig. 9
CLUTCH HOUSING,INPUT SHAFT SYSTEM (H TYPE).....	Fig. 10
PEDAL (CLUTCH) SYSTEM (EXCEPT H TYPE).....	Fig. 11
CASE (TRANSMISSION) SYSTEM (EXCEPT H TYPE).....	Fig. 12
CASE (TRANSMISSION) SYSTEM (H TYPE).....	Fig. 13
HST SYSTEM (H TYPE).....	Fig. 14
GEAR (INPUT) SYSTEM (EXCEPT H TYPE).....	Fig. 15
GEAR (DRIVE) SYSTEM (H TYPE).....	Fig. 16
PINION (DRIVE) SYSYTEM (EXCEPT H TYPE).....	Fig. 17
GEAR (REVERSE) SYSTEM (EXCEPT H TYPE).....	Fig. 18
GEAR (4WD) SYSTEM (EXCEPT H TYPE).....	Fig. 19
GEAR (4WD) SYSTEM (H TYPE).....	Fig. 20
LEVER (MAIN) SYSTEM (EXCEPT H TYPE).....	Fig. 21
LEVER (SUB) SYSTEM (EXCEPT H TYPE).....	Fig. 22
LEVER (SUB) SYSTEM (H TYPE).....	Fig. 23

CHANGE (4WD) SYSTEM (EXCEPT H TYPE).....	Fig. 24
CHANGE (4WD) SYSTEM (H TYPE).....	Fig. 25
CHANGE (SUB) SYSTEM (H TYPE).....	Fig. 26
CHANGE (MAIN/SUB) SYSTEM (EXCEPT H TYPE).....	Fig. 27
GEAR (PTO) SYSTEM (TM3240-EXCEPT H TYPE).....	Fig. 28
GEAR (PTO) SYSTEM (TM3200-EXCEPT H TYPE).....	Fig. 29
GEAR (PTO) SYSTEM (H TYPE).....	Fig. 30
SHAFT (PTO) SYSTEM.....	Fig. 31
LEVER (PTO) SYSTEM (EXCEPT H TYPE).....	Fig. 32
LEVER (PTO) SYSTEM (H TYPE).....	Fig. 33
SHIELD COVER SYSTEM.....	Fig. 34
MID PTO SYSTEM (H TYPE).....	Fig. 35
MID PTO SYSTEM (M TYPE EXCEPT H)(1/2)(2/2).....	Fig. 36
MID PTO SYSTEM (EXCEPT M,H TYPE).....	Fig. 37
LEVER (MID PTO) SYSTEM (H TYPE).....	Fig. 38
LINK (HST) SYSTEM (H TYPE).....	Fig. 39
PEDAL (HST) SYSTEM (H TYPE).....	Fig. 40
CRUISE SYSTEM (TM3240-H TYPE).....	Fig. 41
SHAFT COVER SYSTEM (TM3200-H TYPE).....	Fig. 42
PIPING SYSTEM (H TYPE).....	Fig. 43
DIFF CASE SYSTEM.....	Fig. 44
REAR AXLE HOUSING SYSTEM.....	Fig. 45
SHAFT (WHEEL) SYSTEM.....	Fig. 46
PEDAL (DIFF-LOCK) SYSTEM (EXCEPT H TYPE).....	Fig. 47
LEVER (DIFF-LOCK) SYSTEM (H TYPE).....	Fig. 48
BRAKE SYSTEM.....	Fig. 49
PEDAL (BRAKE) SYSTEM (EXCEPT H TYPE)(1/2)(2/2).....	Fig. 50
PEDAL (BRAKE) SYSTEM (H TYPE)(1/2)(2/2).....	Fig. 51

WHEEL (STEERING) SYSTEM.....	Fig. 52
STEERING SYSTEM (1).....	Fig. 53
STEERING SYSTEM (2).....	Fig. 54
PIPING SYSTEM (EXCEPT H TYPE).....	Fig. 55
PIPING SYSTEM (H TYPE).....	Fig. 56
BRACKET (AXLE),	
HITCH (FRONT/R TYPE) SYSTEM.....	Fig. 57
SHAFT (DRIVE) SYSTEM (EXCEPT H TYPE).....	Fig. 58
SHAFT (DRIVE) SYSTEM (H TYPE).....	Fig. 59
PINION (DRIVE) SYSTEM.....	Fig. 60
HOUSING (AXLE) SYSTEM.....	Fig. 61
GEAR (FINAL) SYSTEM.....	Fig. 62
ROD (TIE) SYSTEM.....	Fig. 63
CYLINDER CASE SYSTEM.....	Fig. 64
ARM (LIFT) SYSTEM.....	Fig. 65
CYLINDER SYSTEM.....	Fig. 66
CONTROL SYSTEM.....	Fig. 67
PIPING (MAIN) SYSTEM (EXCEPT H TYPE).....	Fig. 68
PIPING SYSTEM (H TYPE).....	Fig. 69
LINK (3P) SYSTEM.....	Fig. 70
HITCH (DRAW BAR) SYSTEM (R TYPE).....	Fig. 71
HOOD SYSTEM(1/2)(2/2).....	Fig. 72
GRILLE SYSTEM.....	Fig. 73
STEERING COVER SYSTEM.....	Fig. 74
SEAL (NOISE) SYSTEM (H TYPE).....	Fig. 75
FENDER SYSTEM	
(TM3200/TM3240-EXCEPT H TYPE).....	Fig. 76
FENDER SYSTEM (TM3240-H TYPE).....	Fig. 77
SEAT BASE SYSTEM (EXCEPT H TYPE).....	Fig. 78
SEAT BASE SYSTEM (H TYPE).....	Fig. 79
FRAME SYSTEM.....	Fig. 80
STEP SYSTEM (EXCEPT H TYPE).....	Fig. 81
STEP SYSTEM (H TYPE).....	Fig. 82

LAMP SYSTEM.....	Fig. 83
PANEL SYSTEM.....	Fig. 84
SWITCH SYSTEM (EXCEPT H TYPE).....	Fig. 85
SWITCH SYSTEM (H TYPE).....	Fig. 86
HARNESS SYSTEM (EXCEPT H TYPE).....	Fig. 87
HARNESS SYSTEM (H TYPE).....	Fig. 88
ROPS SYSTEM (R TYPE).....	Fig. 89
ORNAMENT.....	Fig. 90
LABEL (CONTROL) (EXCEPT H TYPE).....	Fig. 91
LABEL (CONTROL) (H TYPE).....	Fig. 92
LABEL (CAUTION).....	Fig. 93
TOOLS.....	Fig. 94

OPTIONAL PARTS

MID PTO SET (EXCEPT M TYPE)	
(OPTION)(1/2)(2/2).....	Fig. 95
REAR WHEEL SYSTEM (TM3240) (OPTION).....	Fig. 96
REAR WHEEL SYSTEM (TM3200) (OPTION).....	Fig. 97
REAR WHEEL (TURF) SYSTEM (TM3240)	
(OPTION).....	Fig. 98
REAR WHEEL (TURF) SYSTEM (TM3200)	
(OPTION).....	Fig. 99
HITCH (FRONT) SET (EXCEPT R TYPE)	
(OPTION).....	Fig. 100
FRONT WHEEL SYSTEM (OPTION).....	Fig. 101
FRONT WHEEL (TURF) SYSTEM (TM3200)	
(OPTION).....	Fig. 102
FRONT WHEEL (TURF) SYSTEM (TM3240)	
(OPTION).....	Fig. 103
HITCH (CREVICE) SET (R TYPE) (OPTION).....	Fig. 104
HITCH (DRAW BAR) SET (EXCEPT R TYPE)	
(OPTION).....	Fig. 105

ROPS SET (EXCEPT R TYPE) (OPTION)..... Fig.106
WEIGHT (BUMPER) SYSTEM (OPTION)..... Fig.107

COMPONENT PARTS

COMPONENT PARTS

FOR K200-053-000-00 ON Fig.56..... Fig.108

COMPONENT PARTS

FOR K211-001-000-00 ON Fig.66..... Fig.109

COMPONENT PARTS

FOR K510-008-000-00 ON Fig.14..... Fig.110

COMPONENT PARTS

FOR 1685-211-500-10 ON Fig.30..... Fig.111

WIRING DIAGRAM

WIRING DIAGRAM (HST)