

# OPERATION MANUAL

*Robex* 75-7

SER. NO. HY7570001~





# INTRODUCTION

## **⚠ WARNING**

Read this manual carefully before operating the machine to ensure safe and optimum running conditions. If you do not understand any of the points in the manual, or the machine breaks down, contact your dealer. In particular, attention needs to be paid to the following points.

- Read this operation manual if you have any questions or doubts on any point to ensure proper and safety excavator operation.
- Keep this operation manual in the excavator at any time to ensure readily access to it in case a need for it arises.
- Be sure to hand over this operation manual to the new owner if the ownership of the excavator is to be transferred.
- Make every possible effort to ensure proper and safety operation of the excavator.

- Note that a portion of the contents of this instruction manual may differ from the excavator you have purchased, which is mainly due to the improvements adopted for it.
- Consult our marketing staff if you have any questions or comments on this operation manual.

# CONTENTS

## OPERATION

Safety Decals .....	1
Basic Precautions on Safety .....	3
Safety Precautionary Notes before Start .....	4
Safety Precautions during Operation .....	6
Safety Precautions during Inspection and Maintenance .....	15
Safety Post Operational Caution .....	18
Part Names .....	19
Explanation of Each Device .....	21
Operation .....	28
Operational Precautions .....	32
Transporting by Truck .....	39
Machine Traction .....	41
How to Hoist a Machine .....	42
Cold Weather or During-Winter Operations .....	44
Long-Period Storage .....	46

## INSPECTION AND MAINTENANCE

Ordering Parts and Servicing Guidelines .....	47
Inspections .....	48
Maintenance after the First 50 Service Hours (New Machine) .....	53
Maintenance after the First 100 Service Hours (New Machine) .....	54
Maintenance Every 50 Service Hours .....	55
Maintenance Every 100 Service Hours .....	57
Maintenance Every 250 Service Hours .....	58
Maintenance Every 500 Service Hours .....	59
Maintenance Every 1000 Service Hours .....	61
To Pressurize .....	62
Inspection and Maintenance Procedures .....	64
Periodical Inspections and Maintenance List .....	70
Lubricants .....	72

## OTHERS

Dimensions and Specifications .....	76
PTO Flow .....	78
Lifting Capacities .....	79
Hydraulic Circuit .....	82
Electric Circuit .....	83

# OPERATION

# SAFETY DECALS

## Explanations

### Caution:

Read the Operation and Service Manual *before* operating the machine to avoid risk of injury.

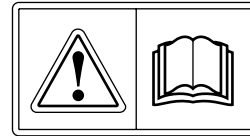

### Danger:

Make sure the engine is stopped before working of any part of the engine compartment to avoid risk of injury.

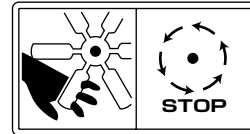

### Caution:Hot surfaces

Keep hands and arms away from hot surfaces.

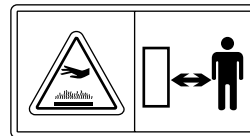

### Danger:Stay clear of the rear of the machine

Keep a safe distance from turning radius of the machine to avoid risk of injury.

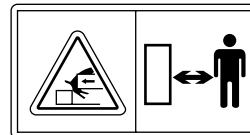

### Danger:Stay clear of the working equipment

Keep a safe distance from turning radius of the boom, arm, bucket and any other lifted equipment to avoid risk of injury.



# LOCATION OF SAFETY DECALS

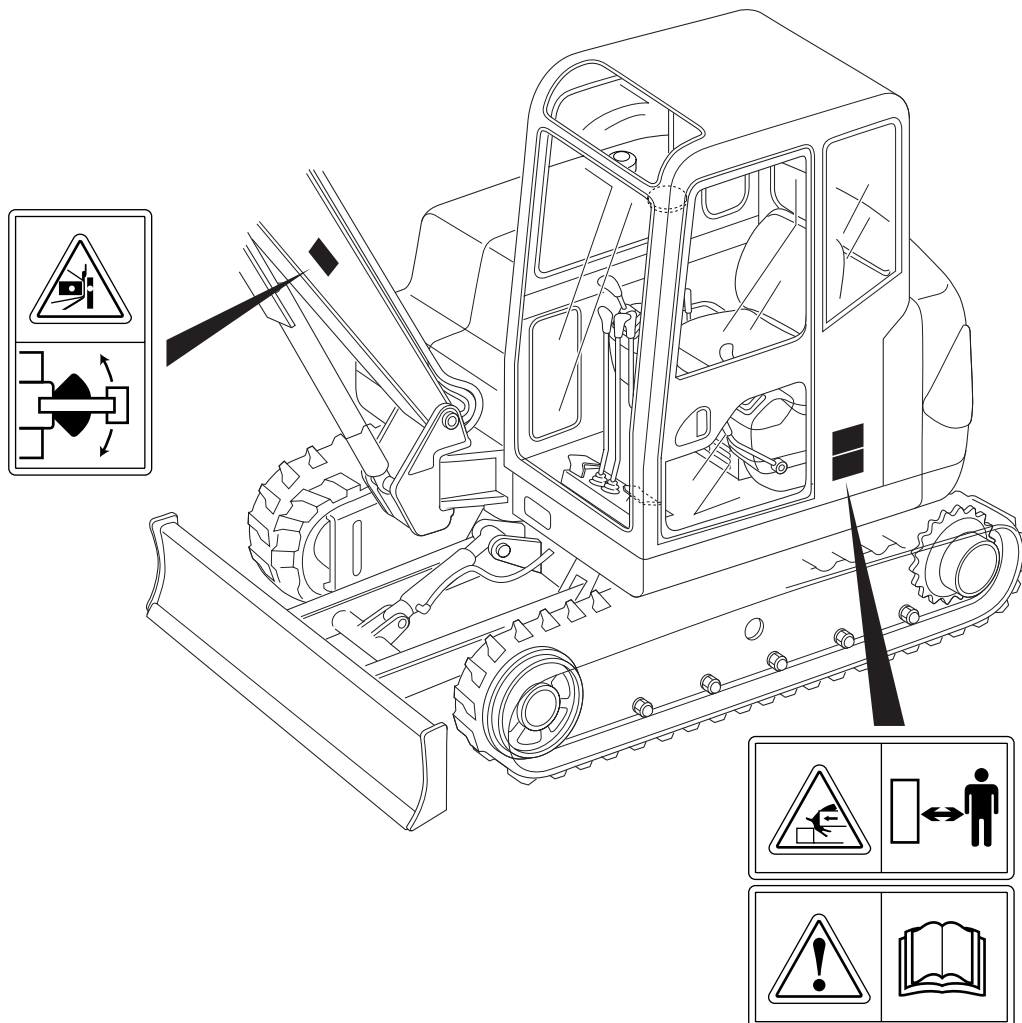
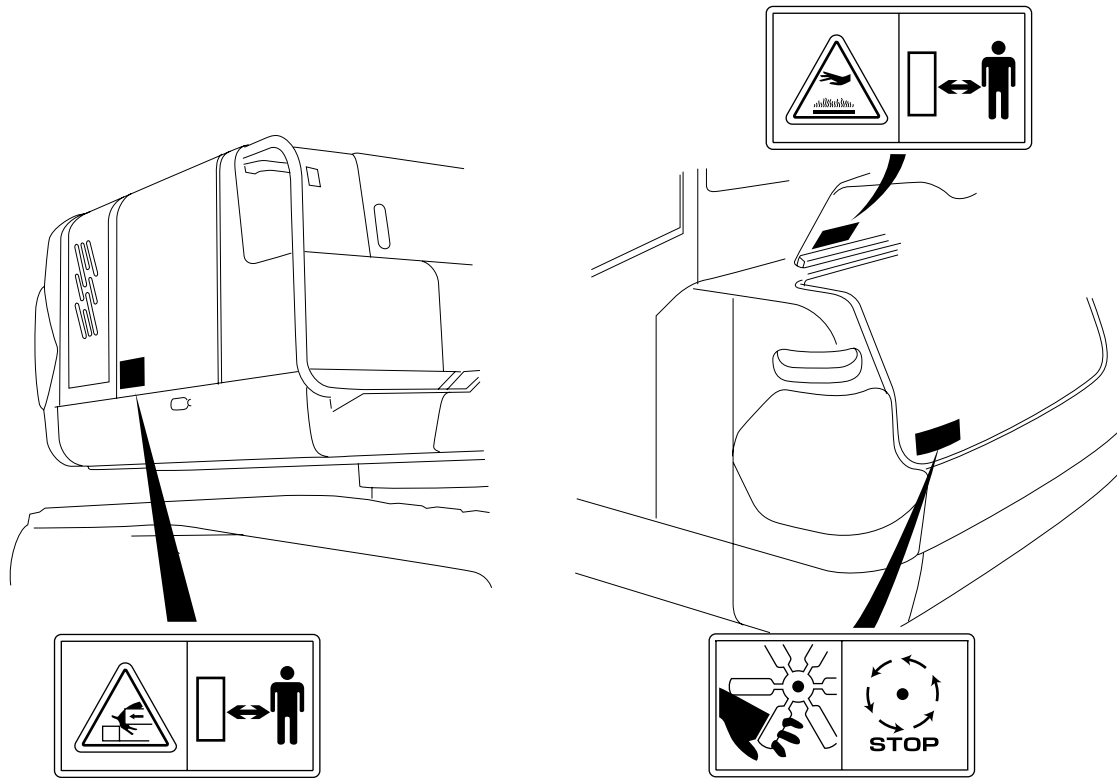

## BASIC PRECAUTIONS ON SAFETY

### ▲ WARNING

#### Remodeling a machine is prohibited

- The machine must not be remodeled without a permission of our company or our sales agent.  
Remodeling without the permission will lead to lower safety, inviting danger. Remodeling will not only deteriorate the functions of the machine but also shorten its life.
- We do not assume the responsibility for any accident or failure due to remodeling without our permission.
- For remodeling, make an inquiry about it at our office or our sales agent.

### ▲ WARNING

#### Precautions on options and attachments

- Do not mount any part or attachment that has not been approved by us or our sales agent, on this machine.
- Using parts or attachments not approved by us will lower the safety, inviting danger.
- We do not assume the responsibility for any injury, accident, or machine failure due to using parts or attachments not approved by us.

### ▲ WARNING

It is necessary for administrator, operator and maintenance staff to study this manual carefully before carrying out the operation or inspection, etc. of the machine.

The work should be performed appropriately with accurate skill and tools by those who received required education and understand the proper operation.

### ▲ WARNING

It is prohibited to use the machine under the particular environment as below.

- Areas where atmosphere and soil are contaminated.
- Areas where explosive substances or dangerous objects exist.

### ▲ WARNING

The temperature obi that this machine can maintain expected performance is written in the following.

40°C~–10°C (Working and storage)



## SAFETY PRECAUTIONARY NOTES BEFORE START

### ▲ WARNING

#### Secure safety in the work site.

- Before starting the work, investigate and record the topography and geological features of the work site completely to take proper measures for prevention against a machine turnover and earth/sand collapse.
- Do not start the work until the safety can be confirmed.

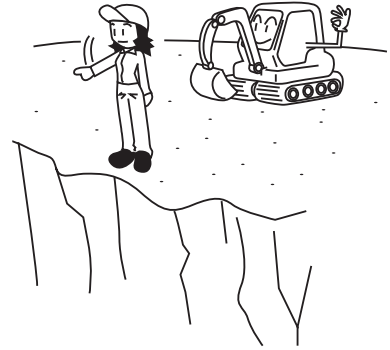

### ▲ WARNING

#### Always wear a hard hat and safety shoes.

Be sure to wear a hard hat and safety shoes when running the machine. Goggles and ear protectors may be necessary depending on the type of work. To prevent being caught in the machine, do not wear loose clothing.



### ▲ DANGER

#### Check the surroundings before start.

Look around you to check the safety of the surroundings before start. Before starting engine, fasten the seat belt surely. Do not carry out any maintenance work whilst the machine is suspended, using the dozer or arm.

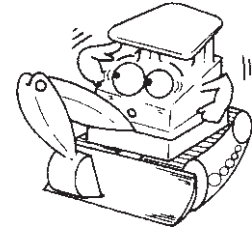

### ▲ DANGER

Before engine start, signal other workers with horn.

