

SECTION 4 ELECTRICAL SYSTEM

GROUP 1 COMPONENT LOCATION

1. LOCATION 1

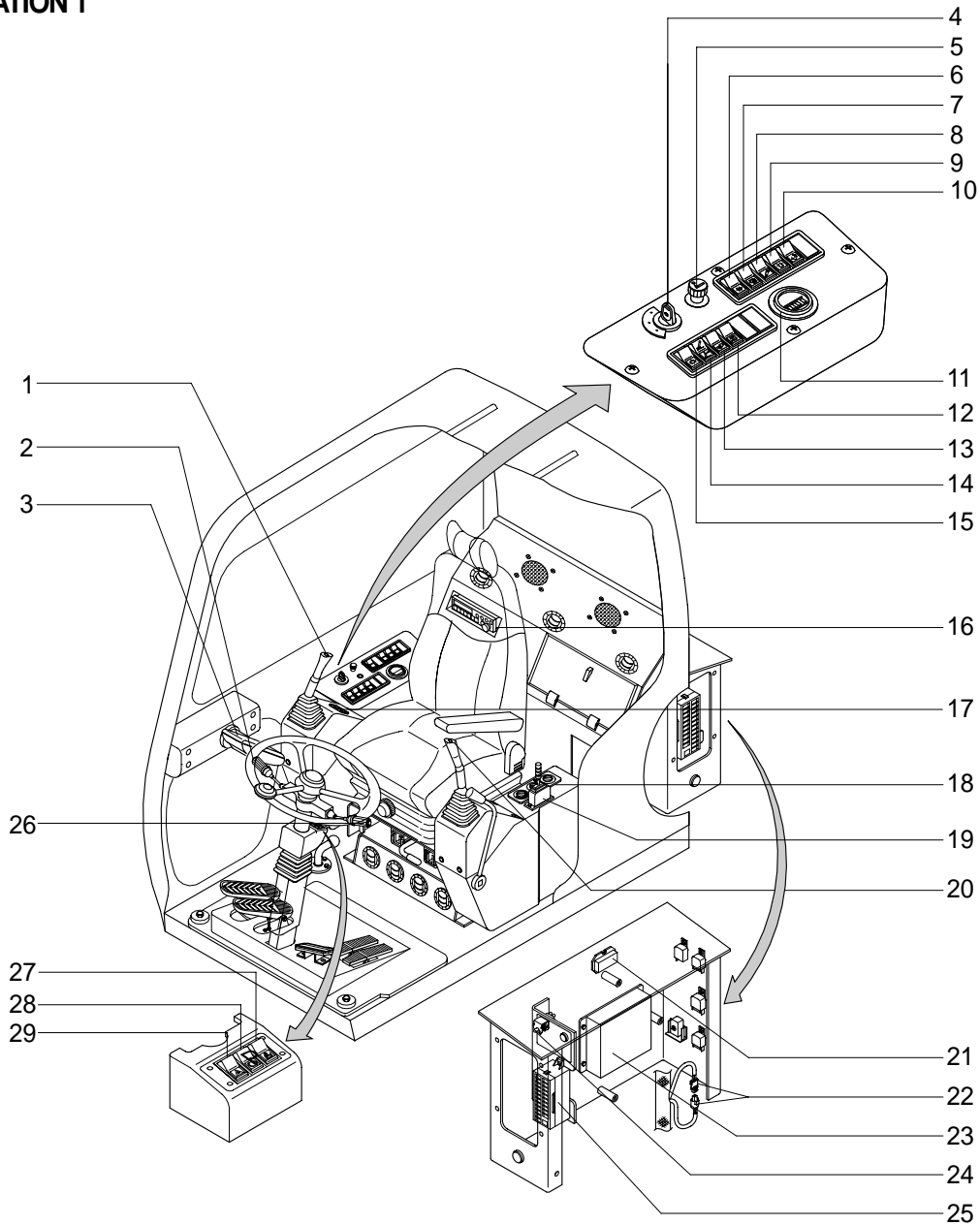

1	Horn switch	11	Service meter	21	Resistor
2	RH multifunction switch	12	Arm half switch	22	Emergency engine starting connector
3	Cluster	13	Work light switch	23	CPU controller
4	Starting switch	14	Outrigger & dozer selector switch	24	Prolix switch
5	Cigar lighter	15	Main light switch	25	Fuse box
6	Aircon switch	16	Cassette & radio	26	LH multifunction switch
7	Cold start switch(Optional)	17	Warning indicator	27	RAM lock switch
8	Breaker switch(Optional)	18	Aircon heater switch	28	Parking braker switch
9	Beacon switch(Optional)	19	Dozer & outrigger lever	29	Hazard switch
10	Quick coupling switch	20	Power boost switch		

2. LOCATION 2

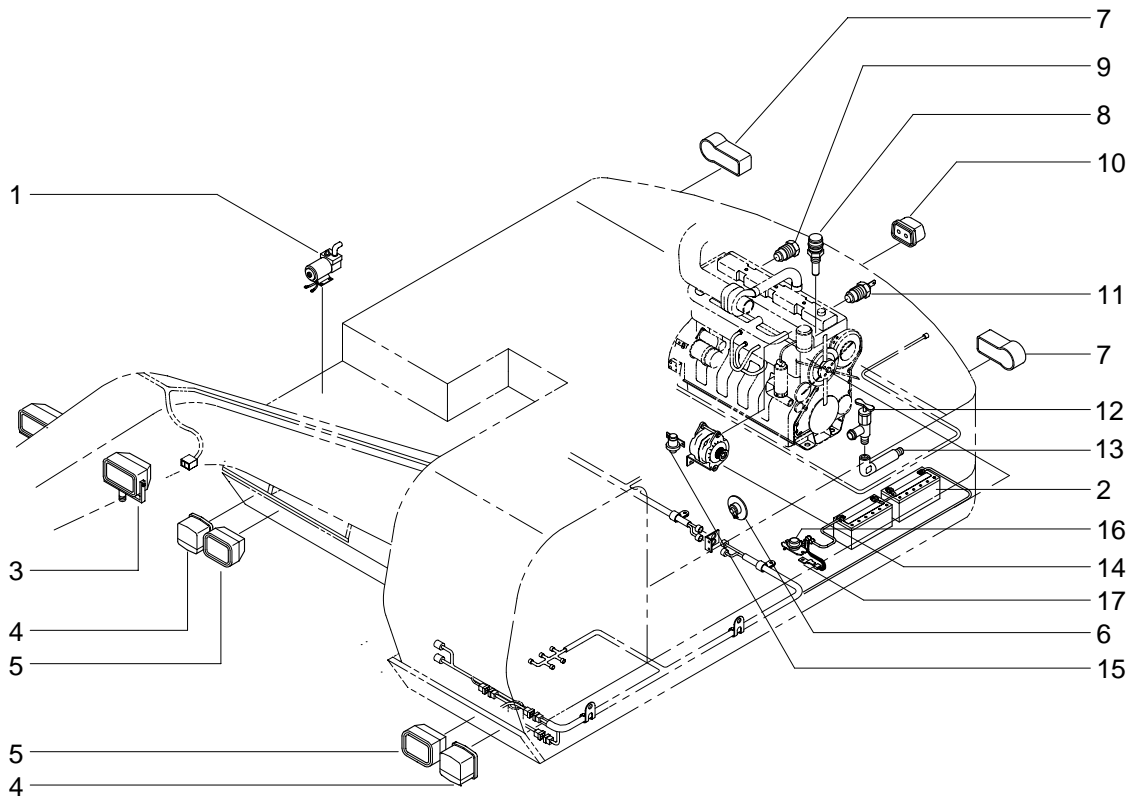

- | | | |
|--------------------------|-------------------------------|--------------------|
| 1 Fuel filter pump | 7 Rear combination lamp | 13 Heater adapter |
| 2 Battery | 8 Temperature sensor | 14 Alternator |
| 3 Work light | 9 Engine speed sensor | 15 Start relay |
| 4 Front combination lamp | 10 Number plate lamp | 16 Battery relay |
| 5 Head lamp | 11 Engine oil pressure switch | 17 Connector plate |
| 6 Master switch | 12 Heater valve | |

GROUP 2 ELECTRICAL CIRCUIT

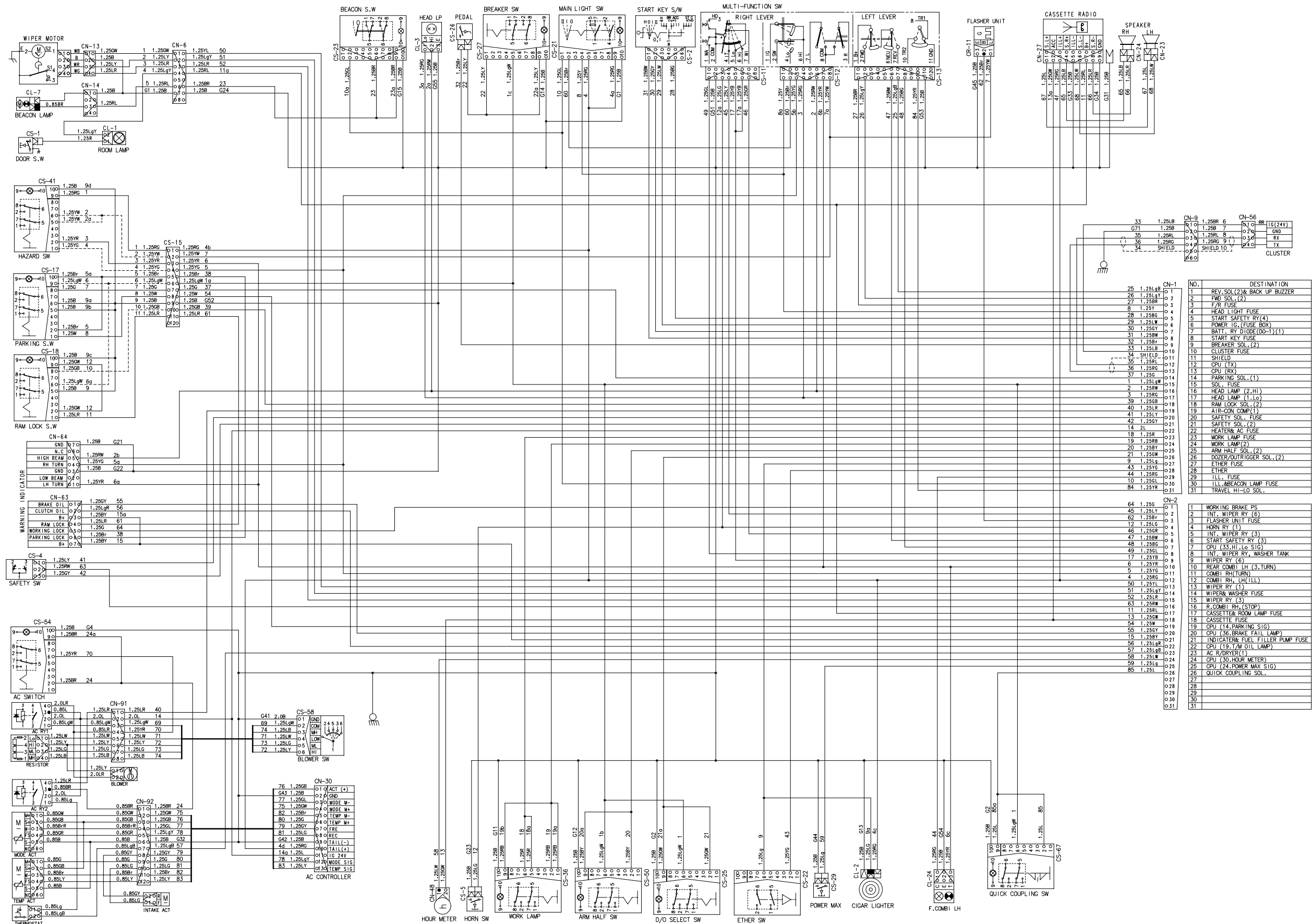

NO.	DESTINATION
1	REV. SOL(2)& BACK UP BUZZER
2	FWD SOL.(2)
3	F/R FUSE
4	HEAD LIGHT FUSE
5	START SAFETY RY(4)
6	POWER IG.(FUSE BOX)
7	BATT. RY DIODE(DO-1)(1)
8	START KEY FUSE
9	BREAKER SOL.(2)
10	CLUSTER FUSE
11	SHIELD
12	GPU (TX)
13	GPU (RX)
14	PARKING SOL.(1)
15	SOL. FUSE
16	HEAD LAMP (2,HI)
17	HEAD LAMP (1,Lo)
18	RAM LOCK SOL.(2)
19	AIR-CON COMP(1)
20	SAFETY SOL. FUSE
21	SAFETY SOL.(2)
22	HEATER& AC FUSE
23	WORK LAMP FUSE
24	WORK LAMP(2)
25	ARM HALF SOL.(2)
26	DOZER/OUTRIGGER SOL.(2)
27	ETHER FUSE
28	ETHER
29	ILL. FUSE
30	ILL. BEACON LAMP FUSE
31	TRAVEL HI-LO SOL.
64	WORKING BRAKE PS
45	INT. WIPER RY (6)
24	INT. WIPER RY (3)
12	FLASHER UNIT FUSE
4	HORN RY (1)
5	INT. WIPER RY (3)
6	START SAFETY RY (3)
48	INT. WIPER RY, WASHER TANK
49	INT. WIPER RY, WASHER TANK
17	WIPER RY (6)
6	REAR COMBI LH (3,TURN)
5	INT. WIPER RY (3)
4	COMBI RH (TURN)
12	COMBI RH, LH (ILL)
50	WIPER RY (1)
14	WIPER& WASHER FUSE
51	WIPER RY (3)
52	R.COMBI RH (STOP)
63	WIPER RY (3)
11	CASSETTE& ROOM LAMP FUSE
13	CASSETTE FUSE
54	GPU (14,PARKING SIG)
55	GPU (36,BRAKE FAIL LAMP)
20	INDICATOR& FUEL FILLER PUMP FUSE
21	GPU (19,T/M OIL LAMP)
56	GPU (19,T/M OIL LAMP)
57	GPU (30,HOUR METER)
58	GPU (24,POWER MAX SIG)
59	GPU (30,HOUR METER)
85	QUICK COUPLING SOL.
027	
28	
29	
30	
31	

NO.	SOURCE
1	MULTI-FUNCTION SW(CS-13.7 REV)
2	MULTI-FUNCTION SW(CS-13.2 FMD)
3	MULTI-FUNC SW(CS-13.1 REV, FMD SOL 24V)
4	MULTI-FUNC SW(CS-12.1), HEAD LAMP SW(4)
5	START KEY SW(5 R2)
6	START KEY SW(3 G)
7	START KEY SW(2 BR)
8	START KEY SW(1 24V)
9	BREAKER PADAL SW
10	CLUSTER (IG POWER, 1)
11	SHIELD
12	CLUSTER (RX, 3)
13	CLUSTER (TX, 4)
14	PARKING SW(8)
15	SOL_SW(CS-25, 50, 27, 17, 18)
16	MULTI-FUNCTION SW(CS-12.6 HEAD HI)
17	MULTI-FUNCTION SW(CS-12.4 HEAD LO)
18	RAM LOCK SW(8)
19	A.C-RY(CN-13.1)
20	SAFETY SW(1 COM)
21	SAFETY SW(3 NO)
22	AC SYS(CN-13.2 CN-30, 11)
23	WORK LAMP SW(5, 6)
24	WORK LAMP SW(1, 2)
25	ARM HALF SW(2)
26	DOZER/OUTRIGGER SW(2)
27	ETHER SW, CIGAR LIGHTER
28	ETHER SW(2)
29	F.COMBI LH
30	HEAD LAMP SW(1) BEACON LAMP SW(2)
31	MULTI-FUNCTION SW(CS-13, 10)

1	WARNING INDICATOR
2	MULTI-FUNCTION SW(CS-11, 4)
3	FLASHER UNIT
4	HORN SW(CS-11, 3, CS-5)
5	MULTI-FUNCTION SW(CS-11, 7)
6	MULTI-FUNCTION SW(CS-13, 6 NEU)
7	MULTI-FUNCTION SW(CS-13, 10 TR2)
8	MULTI-FUNCTION SW(CS-11, 1 WA)
9	MULTI-FUNCTION SW(CS-11, 5, 6 WI)
10	MULTI-FUNCTION SW(CS-12, 7 TURN LH)
11	MULTI-FUNCTION SW(CS-13, 10 TR2)
12	HEAD LAMP SW(5 LIL)
13	WIPER MOTOR(S2)
14	WIPER MOTOR(B)
15	WIPER MOTOR(S1)
16	SAFETY SW
17	CASSETTE (B+), ROOM LAMP
18	CASSETTE (ACC), HOUR METER(2)
19	PARKING SW(1 S1)
20	WARNING INDICATOR(BRAKE FAIL LP)
21	WARNING INDICATOR(24V)
22	WARNING INDICATOR(T/M OIL LP)
23	AC SYS(CN-12, 7)
24	HOUR METER(1)
25	POWER MAX SW
26	
27	
28	
29	
30	
31	

