

Honda Cbr1100xx 97 02 Parts Manual

Full download: <http://manualplace.com/download/honda-cbr1100xx-97-02-parts-manual/>



PARTS CATALOG

CBR1100XX'97•'98•'99•'00•'01•'02

This is the cut pages sample. Download all 82 page(s) at: ManualPlace.com

HOW TO USE THIS CATALOG

This parts catalog is to be used when ordering replacement parts for the model (s) specified on the microfiche strip.

CATALOG PAGE BREAKDOWN (Generic layout-sample data only)

4= MODEL	5= MODEL	6= MODEL	7= MODEL	④	E-1	Engine Serial Number								
Ref.	Description	MODEL-ID	From	To	AREA	ORG	QTY	Part Number	H/C					
1	COVER SET, CYLINDER HEAD	4	15240057	-----	AC	JPN	1	12310-PE2-020	2031797					
	COVER SET, CYLINDER HEAD		-----	12234811	A	USA	1	12310-PE2-030	2210888					

KEY TO CATALOG PAGE BREAKDOWN

1. **Ref.** - Reference numbers correspond to the reference numbers on the illustrations. All illustrations are representative only and do not necessarily correspond exactly to the actual part. "NI" signifies the part is not illustrated.

2. **Description*** - Describes the part for the related part number.

Abbreviations

ASSY. - Assembly	V - Volt
COMP - Complete	W - Watt
L(100L) - Link/100Links	A.C. - Alternating Current
R - Right	D.C. - Direct Current
L - Left	KPH - Kilometers Per Hour
IN. - Inlet	MPH - Miles Per Hour
EX - Exhaust	A.M. - Attaching Mark
FR. - Front	T.M. - Transcript Mark
RR - Rear	A - Ampere
HEX. - Hexagonal	WL - With Labeling
STD. - Standard	WOL - Without Labeling
MM - Millimeter	T (22") - Tooth
G - Gram	C.D.I. - Capacitive Discharge Ignition

3. **MODEL-ID*** - Model indicator code is unique per catalog (not consistent with other catalogs).

4. Each catalog will be represented with applicable model indicators and models.

5. **Serial Number** - Applies to Engine or Frame serial numbers depending on the section. The serial numbers of the vehicle (frame, engine, carburetor) should be checked prior to ordering parts for a specific unit. In cases where a part has been modified, the serial number of the vehicle bearing the modification is listed in the 'SERIAL NUMBER' column. The modification parts are controlled by each pertinent serial number below.

Engine serial number - Engine group parts (Block numbers beginning with 'E')

Carburetor identification number - Carburetor component parts

Frame serial number - Frame group parts (Block numbers beginning with 'F')

A serial number chart and serial number locations are provided.

Note - Some models may be controlled by one serial number only.

6. **AREA*** - Applicable area code type is defined in the serial number chart.

7. **ORG*** - Manufacturing origin of the unit.

8. **QTY** - Quantity required per unit as specified.

A. "AR" in place of the quantity indicates AS REQUIRED.

B. "()" Parentheses in the quantity required indicate "optional".

9. **Part Number** - Part number corresponds to the reference number and application. Several part numbers may be listed under one (1) reference number. For your convenience the current supersede chain, as of print date, has been listed. Supersede chains are subject to change without notice.

10. **H/C** - The Honda Code and Part Number share a 1 to 1 relationship.

MAKE-UP OF PART NUMBERS

All parts are classified into two groups consisting of "GENERAL PARTS" and "STANDARD PARTS". All parts are numbered in accordance with the system described below:

General Parts

Example: Driver Seat Assembly Part No. 77400-634-671ZA
 Function No. 77
 Component No. 400
 Model Code No. -634-
 Modification Process Design 671
 Color Code** ZA

A. Additional Information - The section index located at the bottom of each microfiche grid lists section titles. The Engine and Frame sections have separate section indexes.

Note

1. Rear view mirrors are standard equipment on all street legal models.

*When columns become full, additional data is displayed on a second line.

**The color code at the end of a part number indicates a color. Color codes such as ZA, ZB, ZC, ... except ZZ, do not indicate the actual color. Actual colors are represented in code, between asterisks in the part description.

LOCATION OF SERIAL NUMBER

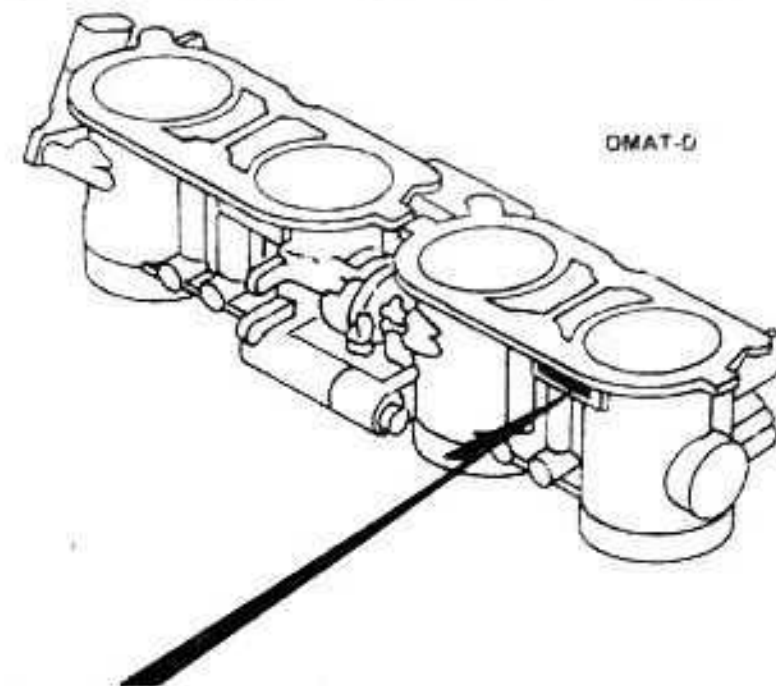

THROTTLE BODY IDENTIFICATION NUMBER

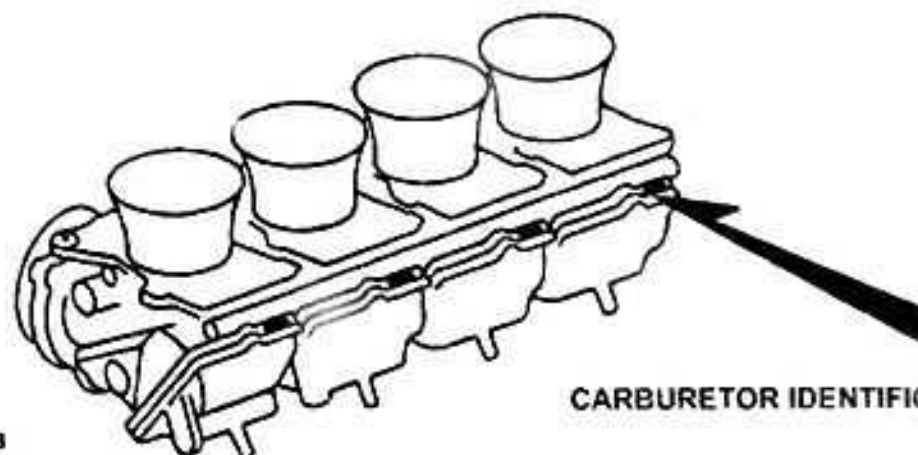

CARBURETOR IDENTIFICATION NUMBER

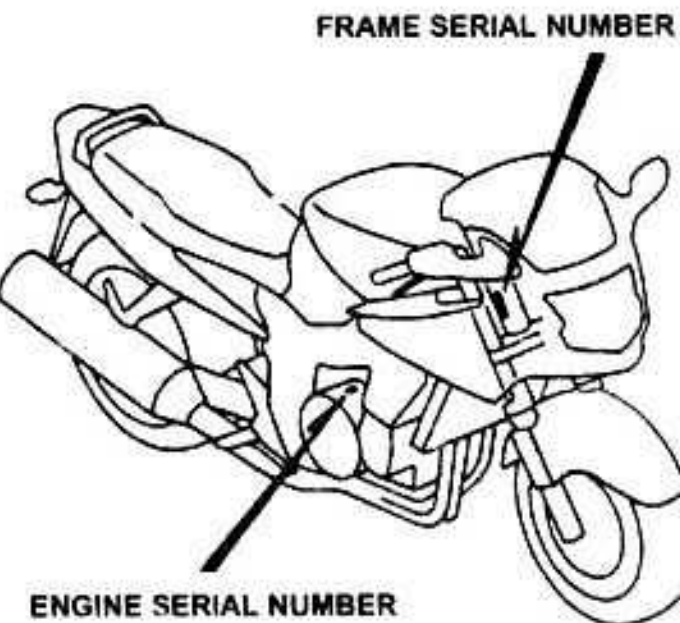

ENGINE SERIAL NUMBER

DMAT-A

LOCATION OF SERIAL NUMBER

INSTRUCTION OF COLOR LABEL

Color label

When ordering parts, check the model name, main color and by code observing the color label on the vehicle.

When ordering a colored part, use the Color Chart in the INSTRUCTION FOR USE OF PARTS CATALOG.

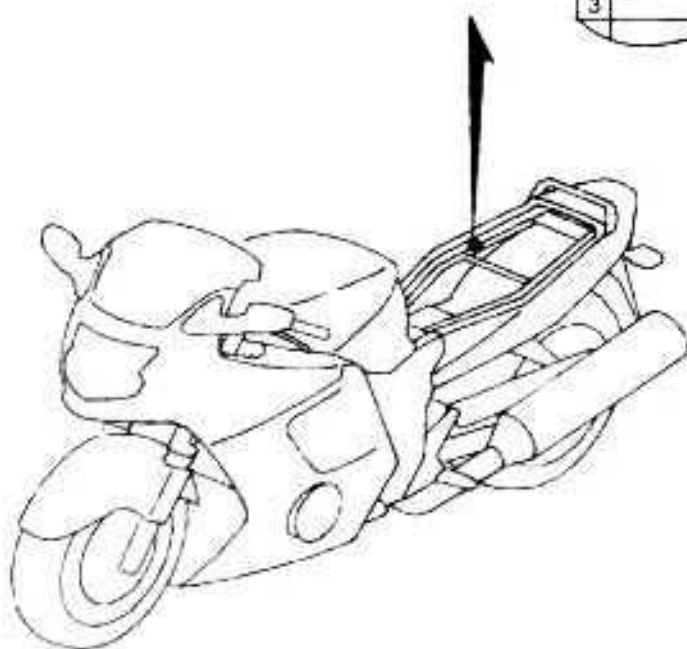
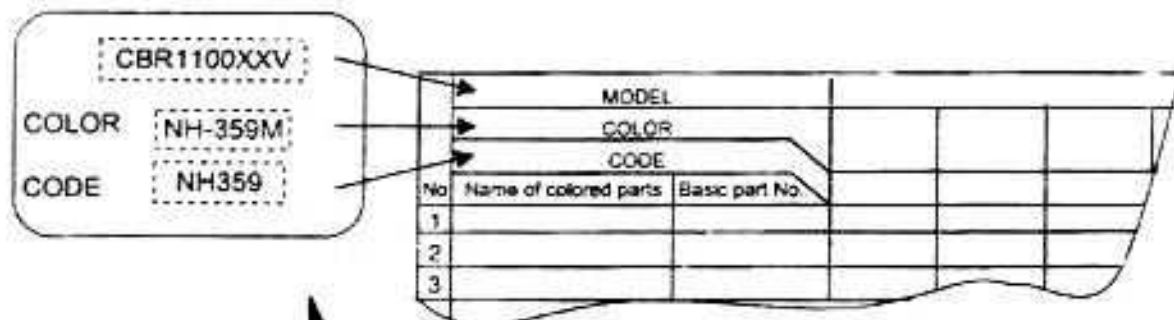

SERIAL NUMBERS

Models and applicable serial numbers

Models and applicable serial numbers given in this parts catalog can be identified as follows

Model	Area Code	Engine Serial No.	Frame Serial No.	Carburetor Serial No.
CBR1100XX'97	A	SC35E-2000001 TO 2015366	JH2SC350*VM000001 TO VM002696	VPS2A (A)
CBR1100XX'97	AC	SC35E-2000001 TO 2015430	JH2SC351*VM000001 TO VM000422	VPS1A (A)
CBR1100XX'98	A	SC35E-3000001 TO 3002745	JH2SC350*WM100001 TO WM101089	VPS2A (A)
CBR1100XX'98	AC	SC35E-3000001 TO 3002906	JH2SC351*WM100001 TO WM100160	VPS1A (A)
CBR1100XX'99	A	SC35E-3100001 TO 3105095	JH2SC350*XM200001 TO XM201515	GQ40D (A)
CBR1100XX'99	AC	SC35E-3100001 TO 3104681	JH2SC351*XM200001 TO XM200165	GQ40B (A)
CBR1100XX'00	A	SC35E-3300001 TO 3308644	JH2SC350*YM300001 TO YM300771	GQ40D (A)
CBR1100XX'00	AC	SC35E-3300001 TO 3305641	JH2SC351*YM300001 TO YM300096	GQ40B (A)
CBR1100XX'01	A	SC35E-3400001~	JH2SC350*1M400001~	GQ40H (A)
CBR1100XX'01	AC	SC35E-3400001~	JH2SC351*1M400001~	GQ40F (A)
CBR1100XX'02	A	SC35E-3500001~	JH2SC350*2M500001~	GQ40H (A)
CBR1100XX'02	AC	SC35E-3500001~	JH2SC351*2M500001~	GQ40F (A)

CONSTRUCTION OF VEHICLE IDENTIFICATION NUMBER

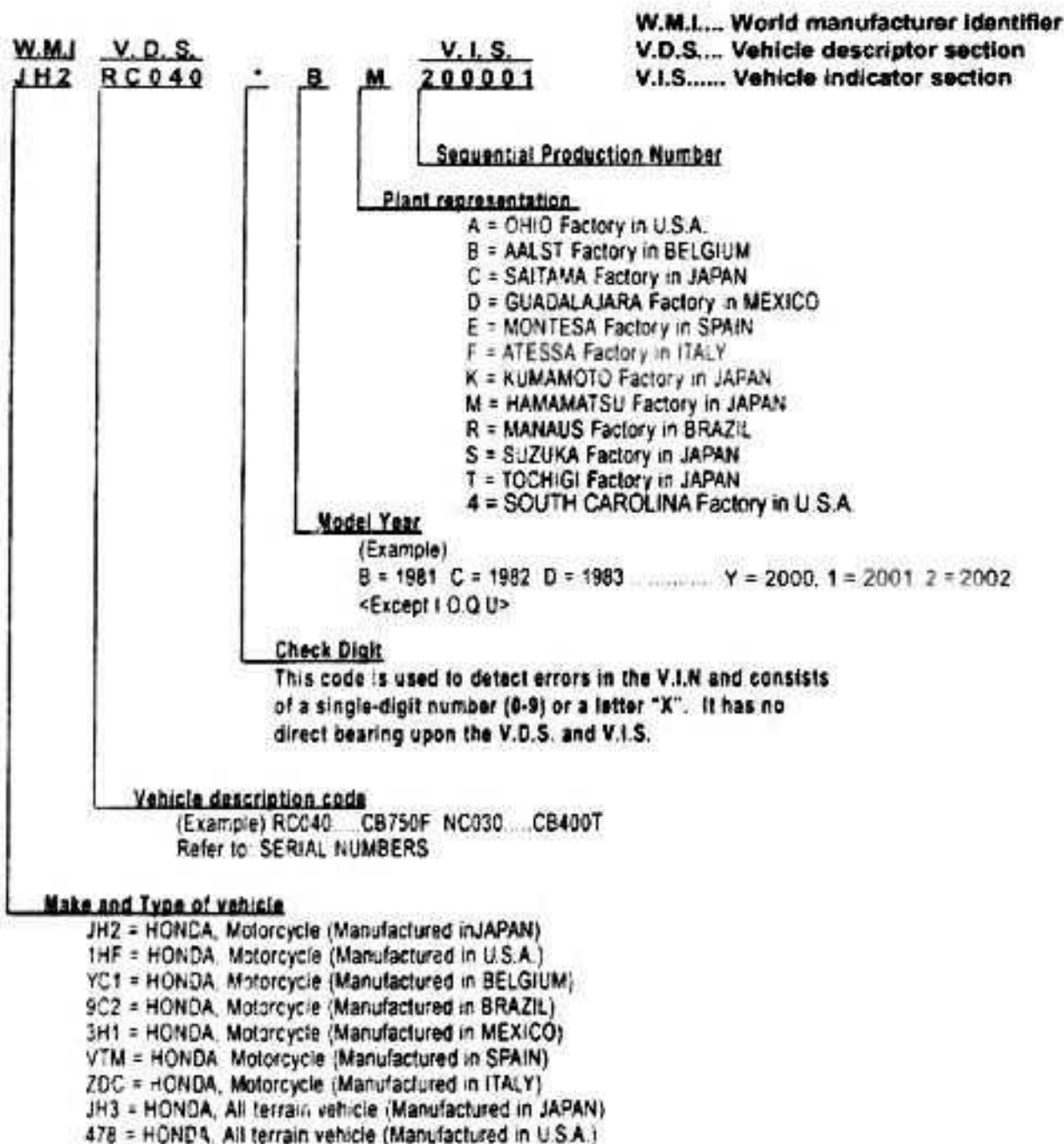

Any change or modification of parts is directly related to the V.D.S. and V.I.S.
 A V.I.S. number will appear in the "Serial No." column of the Parts Catalog if a part is changed or modified.

COMMENT:

This example is generic and applies to 1981 and newer vehicles. 1980 models and prior are referred to as "FRAME NUMBERS" and the construction is designed by using the model designation or code followed by a sequential number.

BULK HOSE PART NUMBER PATTERN

Construction of Fuel and Vacuum Hose Part Number

Example: 9 5 0 0 1 - 7 5 0 0 1 - 4 0 M

Roll Hose

All roll hose part numbers have an "M" in this position

Appearance Code

Fuel Hose:

- 2 = Red, braided exterior
- 3 = Red
- 4 = Ash Gray with red stripe
- 5 = Black, braided interior
- 6 = Black

Vinyl Hose:

- 1 = Ash Gray
- 2 = Black
- 3 = Light Red
- 6 = Light Red
- 7 = Pale Black

Vacuum Hose:

- 1 = Ash Gray
- 2 = Ash Gray
- 3 = Black
- 5 = Black

Length

Cut Hose length is in Millimeters (mm)

Bulk Hose length is in Meters (M)

Inside Diameter

Fuel and Vacuum Hose

35 = 3.5 mm	11 = 11 mm
45 = 4.5 mm	61 = 12 (outside dia. 15) mm
50 = 5.0 mm	62 = 12 (outside dia. 16) mm
55 = 5.3 mm or 5.5 mm	12 = 12 (outside dia. 17) mm
65 = 6.5 mm	14 = 14 mm
70 = 7.0 mm	17 = 17 mm
75 = 7.3 mm or 7.5 mm	
80 = 8.0 mm	

ID/OD Code: Vinyl Hose

01 = ID 2.9, OD 6.8 mm	14 = ID 8.0, OD 9.0 mm	37 = ID 11.0, OD 15.0 mm
03 = ID 3.0, OD 6.0 mm	17 = ID 7.0, OD 9.0 mm	38 = ID 12.0, OD 13.0 mm
05 = ID 3.5, OD 6.5 mm	19 = ID 7.0, OD 11.0 mm	39 = ID 12.0, OD 14.0 mm
07 = ID 4.0, OD 7.0 mm	21 = ID 8.0, OD 9.0 mm	40 = ID 12.0, OD 16.0 mm
09 = ID 4.5, OD 6.5 mm	23 = ID 8.0, OD 12.0 mm	43 = ID 13.0, OD 15.0 mm
09 = ID 4.5, OD 8.0 mm	25 = ID 9.0, OD 11.0 mm	45 = ID 14.0, OD 18.0 mm
12 = ID 5.0, OD 7.0 mm	27 = ID 9.0, OD 13.0 mm	50 = ID 16.0, OD 19.0 mm
10 = ID 5.0, OD 8.0 mm	33 = ID 10.0, OD 14.0 mm	55 = ID 17.5, OD 20.5 mm
11 = ID 5.0, OD 9.0 mm	36 = ID 11.0, OD 13.0 mm	60 = ID 22.0, OD 27.0 mm

Hose Type:

- 1 = Fuel Hose
- 3 = Vinyl Hose
- 5 = Vacuum Hose

CAUTION: Never use vacuum / or vinyl hose in place of fuel hose or vice versa

CYLINDER HEAD COVER

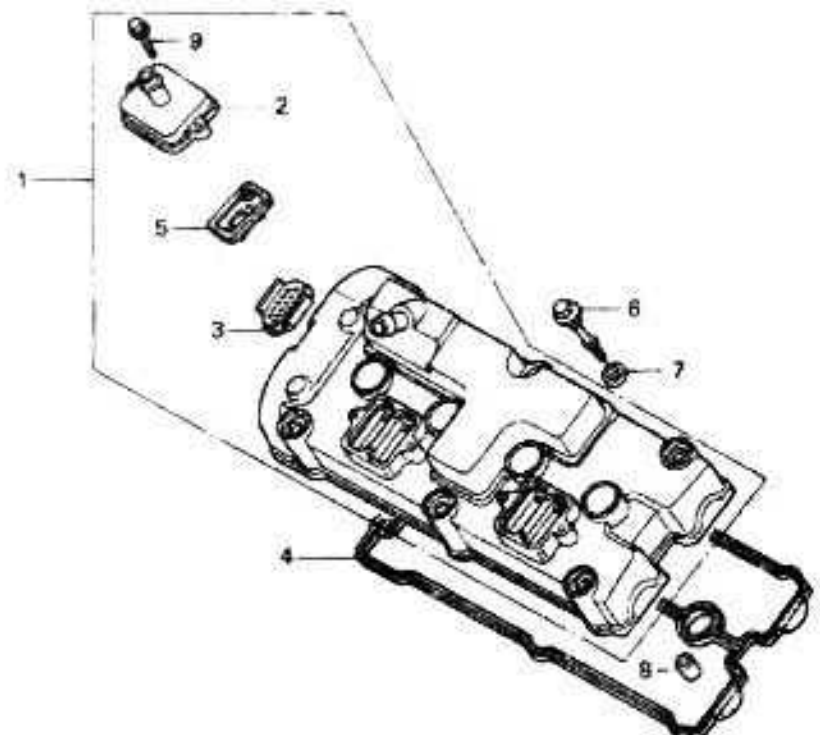

MAT4-E0100

MAT4E0100

7 = CBR1100XX'97
8 = CBR1100XX'98
9 = CBR1100XX'99
0 = CBR1100XX'00

1 = CBR1100XX'01
2 = CBR1100XX'02

Engine Serial Number		A ^o EA		QTY	Part Number	H/C
From	To					
7	8			1	12310-MAT-750	5212378
9	0 1 2			1	12310-MAT-E00	6112122
7	8 9 0 1 2			2	12331-MAT-750	5212386
7	8 9 0 1 2			4	12341-MAT-750	5212394
7	8 9 0 1 2			1	12391-MAT-000	5232020
7	8			4	18601-MJ1-790	2489995
9	0 1 2			4	18601-MBW-003	6082036
7	8			6	90002-MAT-000	5215975
9	0 1 2			6	90002-MY5-850	5033683
7	8 9 0 1 2			6	90543-MV9-570	3699139
7	8 9 0 1 2			4	94301-10150	0059206
7	8			4	95001-05020-00	2529154
9	0 1 2			4	90020-ZC3-000	2734820

Ref	Description	Model	From	To	AREA	QTY	Part Number	H/C
1	COVER ASSY. CYLINDER HEAD (AI)	7 8				1	12310-MAT-750	5212378
	COVER ASSY. CYLINDER HEAD	9 0 1 2				1	12310-MAT-E00	6112122
2	COVER REED VALVE	7 8 9 0 1 2				2	12331-MAT-750	5212386
3	PLATE PORT (AI)	7 8 9 0 1 2				4	12341-MAT-750	5212394
4	GASKET HEAD COVER	7 8 9 0 1 2				1	12391-MAT-000	5232020
5	VALVE REED	7 8				4	18601-MJ1-790	2489995
	VALVE REED	9 0 1 2				4	18601-MBW-003	6082036
6	BOLT HEAD COVER	7 8				6	90002-MAT-000	5215975
	BOLT HEAD COVER	9 0 1 2				6	90002-MY5-850	5033683
7	RUBBER SETTING	7 8 9 0 1 2				6	90543-MV9-570	3699139
8	PIN A DOWEL (10X16)	7 8 9 0 1 2				4	94301-10150	0059206
9	BOLT FLANGE (6X20)	7 8				4	95001-05020-00	2529154
	BOLT FLANGE (6X20)	9 0 1 2				4	90020-ZC3-000	2734820

CYLINDER HEAD

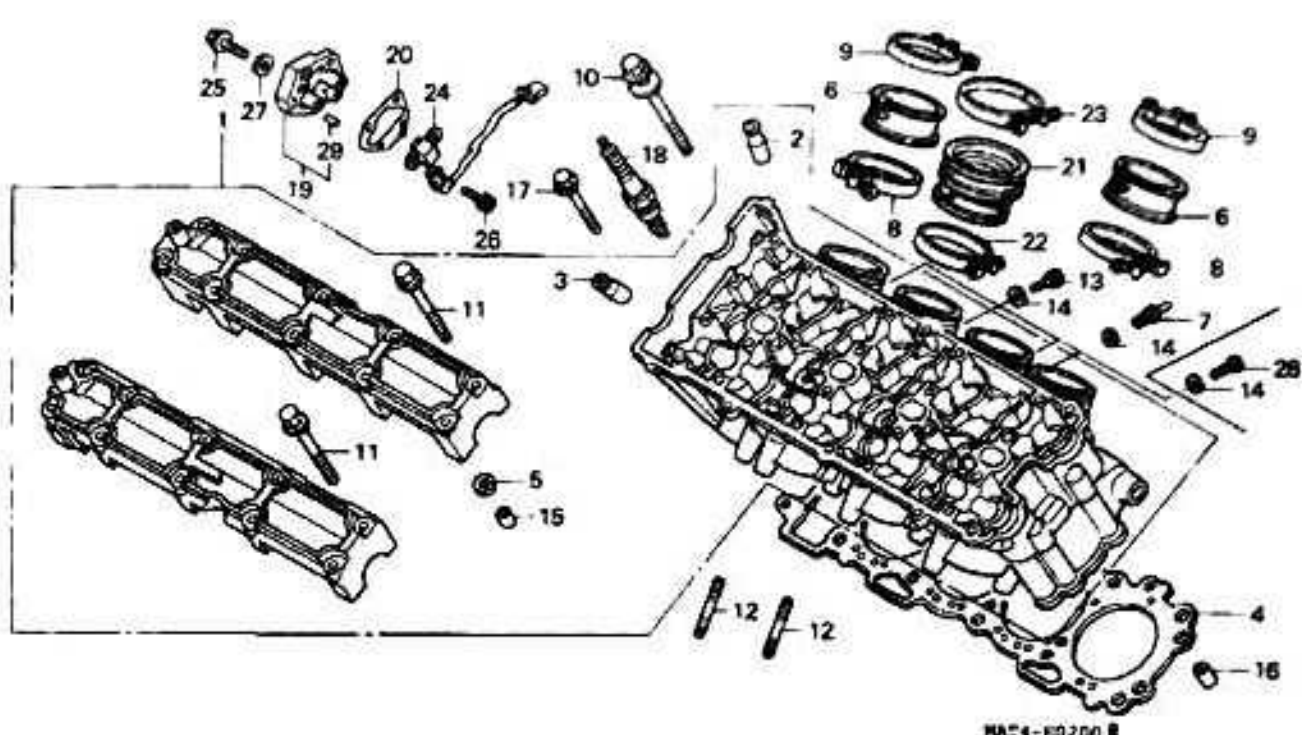

MAT4-E0200 B

MAT4E0200B

7 = CBR1100XX'97
8 = CBR1100XX'98
9 = CBR1100XX'99
0 = CBR1100XX'00

1 = CBR1100XX'01
2 = CBR1100XX'02

Engine Serial Number		A ^o EA		QTY	Part Number	H/C
From	To					
7	8			1	12010-MAT-750	5212337
9	0 1 2			1	12010-MAT-E00	6112106
7	8 9 0 1 2			6	12204-MAT-305	5212345
7	8 9 0 1 2			8	12205-MAT-305	5212352
7	8			1	12251-MAT-003	5212360
9	0 1 2			1	12251-MAT-E01	6112114
7	8 9 0 1 2			4	12395-MAT-750	5212402
7	8			4	16211-MAT-000	5232582
7	8			1	16214-MB0-000	1244193
7	8			4	16217-MAT-000	5232590
7	8			4	16218-MAT-000	5232608
7	8 9 0 1 2			10	90007-MAT-000	5215983
7	8 9 0 1 2			20	90018-425-000	0717256
7	8 9 0 1 2			8	90035-MM5-000	2551794
7	8			3	90089-MNB-000	2919983
7	8 9 0 1 2			4	90452-323-000	0255224
7	8 9 0 1			4	94301-08200	1417369
2				6	94301-08200	1417369

Ref	Description	Model	From	To	AREA	QTY	Part Number	H/C
1	CYLINDER HEAD ASSY. (AI)	7 8				1	12010-MAT-750	5212337
	CYLINDER HEAD ASSY.	9 0 1 2				1	12010-MAT-E00	6112106
2	GUIDE VALVE (OS)	7 8 9 0 1 2				6	12204-MAT-305	5212345
3	GUIDE EX VALVE (OS)	7 8 9 0 1 2				8	12205-MAT-305	5212352
4	GASKET CYLINDER HEAD	7 8				1	12251-MAT-003	5212360
	GASKET CYLINDER HEAD	9 0 1 2				1	12251-MAT-E01	6112114
5	GASKET B. CYLINDER HEAD COVER	7 8 9 0 1 2				4	12395-MAT-750	5212402
6	INSULATOR CARBURETOR	7 8				4	16211-MAT-000	5232582
7	JOINT BOOSTER	7 8				1	16214-MB0-000	1244193
8	BAND A INSULATOR	7 8				4	16217-MAT-000	5232590
9	BAND B INSULATOR	7 8				4	16218-MAT-000	5232608
10	BOLT-WASHER (10X105)	7 8 9 0 1 2				10	90007-MAT-000	5215983
11	BOLT FLANGE (6X48)	7 8 9 0 1 2				20	90018-425-000	0717256
12	BOLT STUD (8X24)	7 8 9 0 1 2				8	90035-MM5-000	2551794
13	BOLT SOCKET (5X8)	7 8				3	90089-MNB-000	2919983
14	WASHER SEALING (5MM)	7 8 9 0 1 2				4	90452-323-000	0255224
15	PIN DOWEL (8X20)	7 8 9 0 1				4	94301-08200	1417369
		2				6	94301-08200	1417369

CYLINDER HEAD

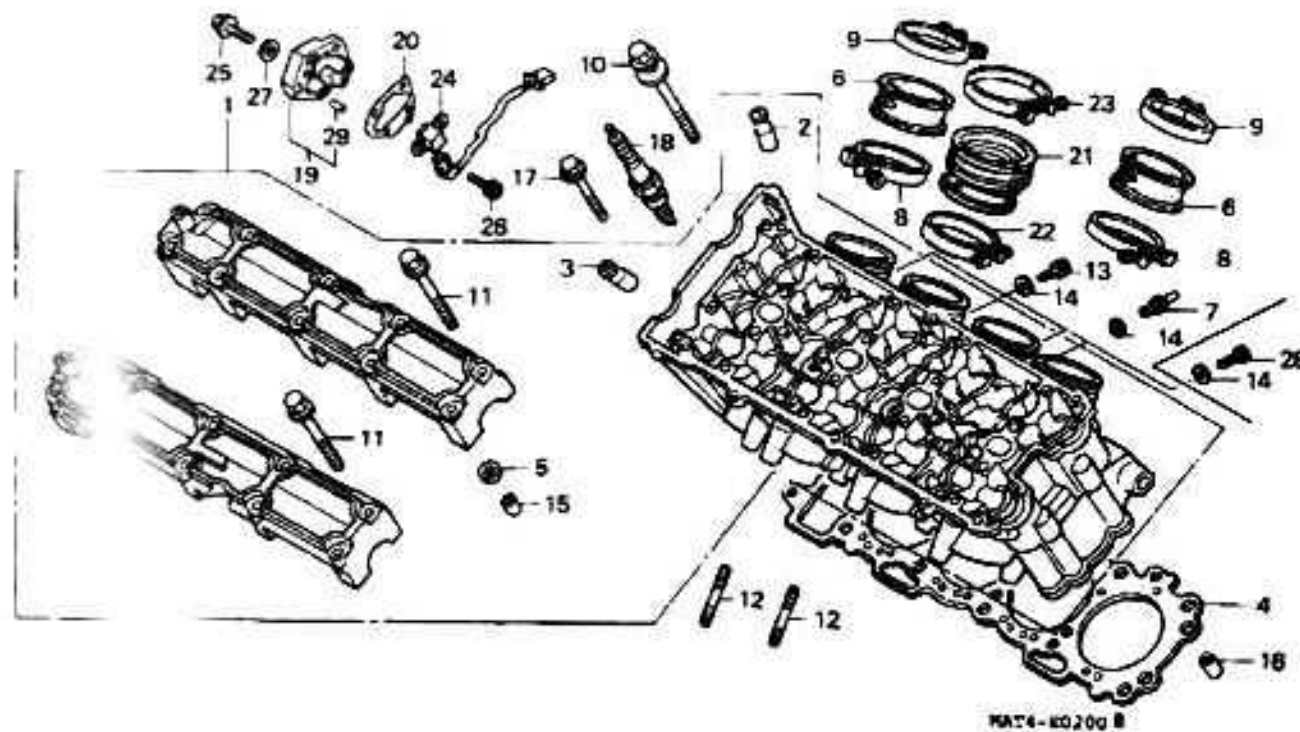

MAT4-E0200 B

MAT4E0200B

7 = CBR1100XX'97
8 = CBR1100XX'98
9 = CBR1100XX'99
0 = CBR1100XX'00

1 = CBR1100XX'01
2 = CBR1100XX'02

E-2

Engine
Serial Number

Ref	Description	Model	From	To	AREA	QTY	Part Number	H/C
15	PIN A DOWEL (10X16)	7 8 9 0 1 2				2	94301-10160	0058206
17	BOLT FLANGE (6X45)	7 8 9 0 1 2				2	96001-06045-07	2479640
18	SPARK PLUG (CR9EHVX-9) (NGK)	7 8 9 0				4	98059-5991F	4485892
	SPARK PLUG (MR9A-9H) (NGK)	1				4	98059-5991U	6658140
	SPARK PLUG (MR9C-9H)	2				4	31912-MBW-E11	6846034
19	COVER CAM PULSER	9 0 1 2				1	12320-MAT-E00	6112130
20	GASKET CAM PULSER	9 0 1 2				1	12322-MAT-E01	6112148
21	INSULATOR	9 0				4	16211-MAT-E00	6112437
	INSULATOR	1 2				4	16211-MCC-600	6696744
22	BAND INSULATOR	9 0 1 2				4	16217-MAT-E00	6112445
23	BAND INSULATOR	9 0 1 2				4	16219-MAT-E00	6112452
24	GENERATOR ASSY CAM PULSE	9 0 1 2				1	30330-MAT-E00	6113195
25	BOLT FLANGE (6X25) (NSHF)	9 0				3	90005-GHB-670	4890315
	BOLT FLANGE (6X25) (NSHF)	1 2				3	90004-GHB-670	4774170
26	BOLT SOCKET (5X12)	9 0 1 2				2	90049-KT7-000	2544526
27	WASHER SEALING (6.5MM)	9 0 1 2				3	90463-ML7-000	2408680
28	BOLT SLOT (5X8)	9 0 1 2				4	92301-05008-0A	2519650
29	ROLLER (4X10)	9 0 1 2				2	96220-40100	0216051

CAMSHAFT

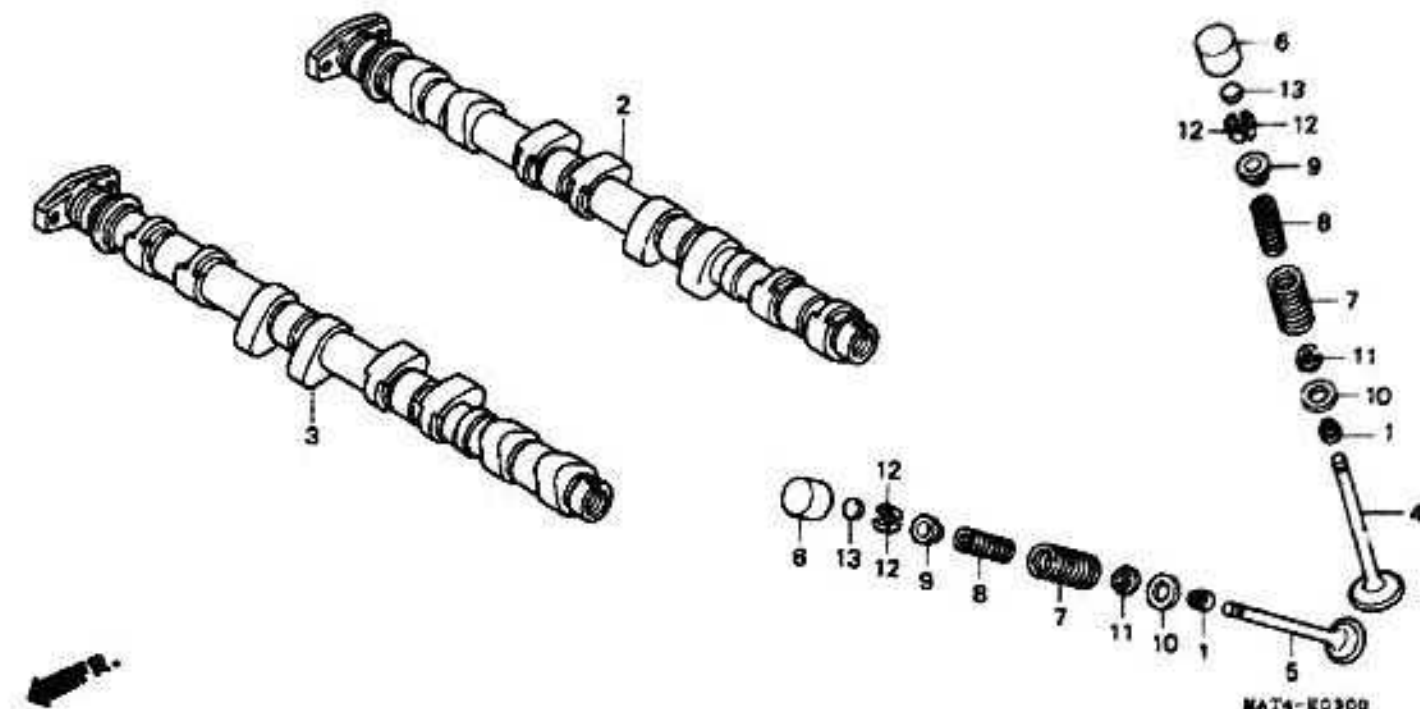

MAT4-E0300

MAT4E0300

7 = CBR1100XX'97
8 = CBR1100XX'98
9 = CBR1100XX'99
0 = CBR1100XX'00

1 = CBR1100XX'01
2 = CBR1100XX'02

E-3

Engine
Serial Number

Ref	Description	Model	From	To	AREA	QTY	Part Number	H/C
1	SEAL VALVE STEM (NOK)	7 8 9 0 1 2				16	12209-MA5-005	1445543
2	CAMSHAFT IN	7 8				1	14110-MAT-000	5212683
	CAMSHAFT IN	9 0 1 2				1	14110-MAT-E00	6112213
3	CAMSHAFT EX	7 8				1	14210-MAT-000	5212691
	CAMSHAFT EX	9 0 1 2				1	14210-MAT-E00	6112221
4	VALVE IN	7 8 9 0 1 2				8	14711-MAT-000	5212774
5	VALVE EX	7 8 9 0 1 2				8	14721-MAT-000	5212782
6	LIFTER VALVE	7 8 9 0 1 2				16	14731-MT4-000	3465705
7	SPRING VALVE (OUTER)	7 8 9 0 1 2				16	14751-MAT-003	5212790
	SPRING VALVE (OUTER)	7 8 9 0 1 2				16	14751-MAT-004	5212808
8	SPRING VALVE (INNER)	7 8 9 0 1 2				16	14761-MAT-003	5212816
	SPRING VALVE (INNER)	7 8 9 0 1 2				16	14761-MAT-004	5212824
9	RETAINER VALVE SPRING	7 8 9 0 1 2				16	14771-MAT-000	5212832
10	SEAT VALVE SPRING (OUTER)	7 8 9 0 1 2				16	14775-MR7-000	3444783
11	SEAT VALVE SPRING (INNER)	7 8 9 0 1 2				16	14777-MT4-000	3465770
12	COTTER VALVE	7 8 9 0 1 2				32	14781-MAT-000	5212840
13	SHIM TAPPET (1.200)	7 8 9 0 1 2				16	14901-KT7-013	4064283
	SHIM TAPPET (1.225)	7 8 9 0 1 2				16	14902-KT7-013	4105565

CAMSHAFT

Full download: <http://manualplace.com/download/honda-cbr1100xx-97-02-parts-manual/>

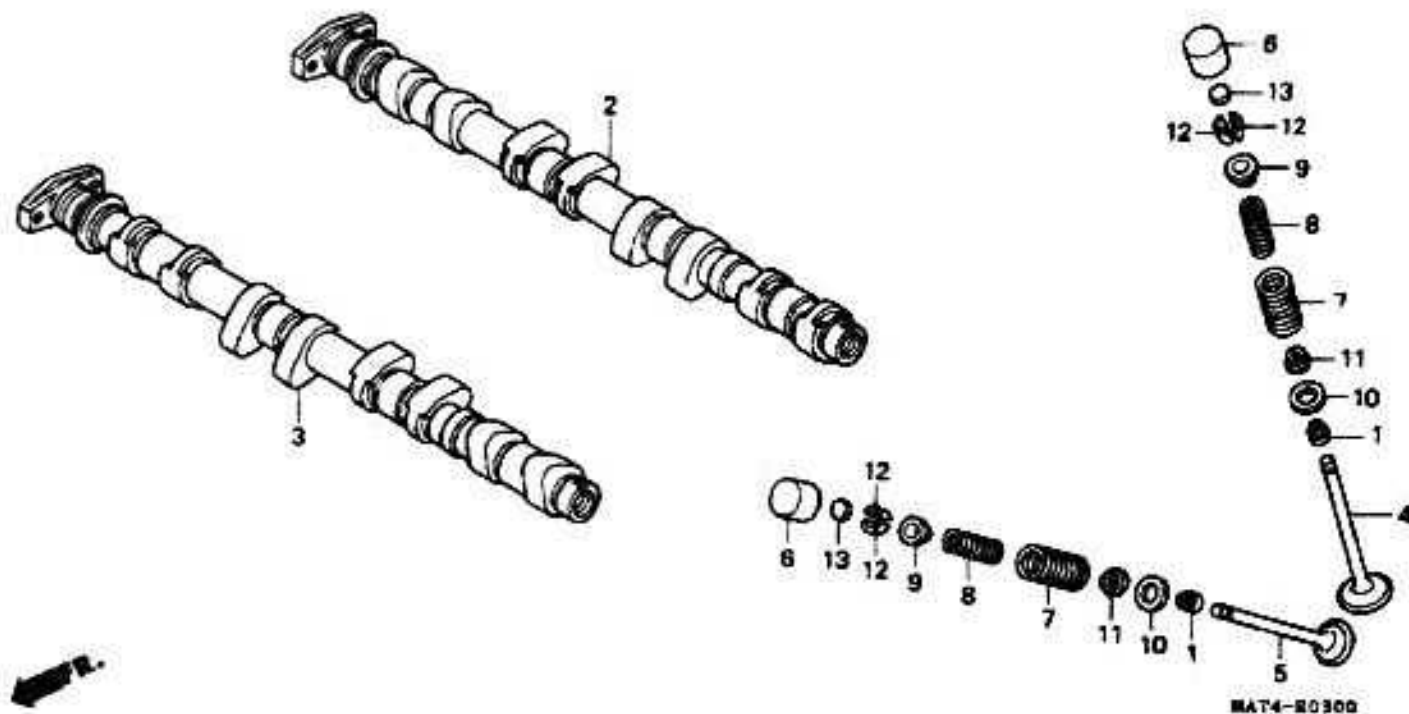

MAT4E0300

7 = CBR1100XX'97
8 = CBR1100XX'98
9 = CBR1100XX'99
0 = CBR1100XX'00

1 = CBR1100XX'01
2 = CBR1100XX'02

Engine Serial Number		E-3	
From	To	AREA	QTY

Ref	Description	Model	From	To	AREA	QTY	Part Number	H/C
13	SHIM TAPPET (1.250)	7 8 9 0 1 2				16	14903-KT7-013	4105573
	SHIM TAPPET (1.275)	7 8 9 0 1 2				16	14904-KT7-013	4105581
	SHIM TAPPET (1.300)	7 8 9 0 1 2				16	14905-KT7-013	4105599
	SHIM TAPPET (1.325)	7 8 9 0 1 2				16	14906-KT7-013	4105607
	SHIM TAPPET (1.350)	7 8 9 0 1 2				16	14907-KT7-013	4105615
	SHIM TAPPET (1.375)	7 8 9 0 1 2				16	14908-KT7-013	4105623
	SHIM TAPPET (1.400)	7 8 9 0 1 2				16	14909-KT7-013	4105631
	SHIM TAPPET (1.425)	7 8 9 0 1 2				16	14910-KT7-013	4105649
	SHIM TAPPET (1.450)	7 8 9 0 1 2				16	14911-KT7-013	4105656
	SHIM TAPPET (1.475)	7 8 9 0 1 2				16	14912-KT7-013	4105664
	SHIM TAPPET (1.500)	7 8 9 0 1 2				16	14913-KT7-013	4105672
	SHIM TAPPET (1.525)	7 8 9 0 1 2				16	14914-KT7-013	4105680
	SHIM TAPPET (1.550)	7 8 9 0 1 2				16	14915-KT7-013	4105698
	SHIM TAPPET (1.575)	7 8 9 0 1 2				16	14916-KT7-013	4105706
	SHIM TAPPET (1.600)	7 8 9 0 1 2				16	14917-KT7-013	4105714
	SHIM TAPPET (1.625)	7 8 9 0 1 2				16	14918-KT7-013	4105722
	SHIM TAPPET (1.650)	7 8 9 0 1 2				16	14919-KT7-013	4105730
	SHIM TAPPET (1.675)	7 8 9 0 1 2				16	14920-KT7-013	4105748

CAMSHAFT

7 = CBR1100XX'97
8 = CBR1100XX'98
9 = CBR1100XX'99
0 = CBR1100XX'00

1 = CBR1100XX'01
2 = CBR1100XX'02

Engine Serial Number		E-3	
From	To	AREA	QTY

Ref	Description	Model	From	To	AREA	QTY	Part Number	H/C
13	SHIM TAPPET (1.700)	7 8 9 0 1 2				16	14921-KT7-013	4105755
	SHIM TAPPET (1.725)	7 8 9 0 1 2				16	14922-KT7-013	4105763
	SHIM TAPPET (1.750)	7 8 9 0 1 2				16	14923-KT7-013	4105771
	SHIM TAPPET (1.775)	7 8 9 0 1 2				16	14924-KT7-013	4105789
	SHIM TAPPET (1.800)	7 8 9 0 1 2				16	14925-KT7-013	4105797
	SHIM TAPPET (1.825)	7 8 9 0 1 2				16	14926-KT7-013	4105805
	SHIM TAPPET (1.850)	7 8 9 0 1 2				16	14927-KT7-013	4105813
	SHIM TAPPET (1.875)	7 8 9 0 1 2				16	14928-KT7-013	4105821
	SHIM TAPPET (1.900)	7 8 9 0 1 2				16	14929-KT7-013	4105839
	SHIM TAPPET (1.925)	7 8 9 0 1 2				16	14930-KT7-013	4105847
	SHIM TAPPET (1.950)	7 8 9 0 1 2				16	14931-KT7-013	4105854
	SHIM TAPPET (1.975)	7 8 9 0 1 2				16	14932-KT7-013	4105862
	SHIM TAPPET (2.000)	7 8 9 0 1 2				16	14933-KT7-013	4105870
	SHIM TAPPET (2.025)	7 8 9 0 1 2				16	14934-KT7-013	4105888
	SHIM TAPPET (2.050)	7 8 9 0 1 2				16	14935-KT7-013	4105896
	SHIM TAPPET (2.075)	7 8 9 0 1 2				16	14936-KT7-013	4105904
	SHIM TAPPET (2.100)	7 8 9 0 1 2				16	14937-KT7-013	4105912
	SHIM TAPPET (2.125)	7 8 9 0 1 2				16	14938-KT7-013	4105920
	SHIM TAPPET (2.150)	7 8 9 0 1 2				16	14939-KT7-013	4105938
	SHIM TAPPET (2.175)	7 8 9 0 1 2				16	14940-KT7-013	4105946
	SHIM TAPPET (2.200)	7 8 9 0 1 2				16	14941-KT7-013	4105953
	SHIM TAPPET (2.225)	7 8 9 0 1 2				16	14942-KT7-013	4105961
	SHIM TAPPET (2.250)	7 8 9 0 1 2				16	14943-KT7-013	4105979
	SHIM TAPPET (2.275)	7 8 9 0 1 2				16	14944-KT7-013	4105987
	SHIM TAPPET (2.300)	7 8 9 0 1 2				16	14945-KT7-013	4105995
	SHIM TAPPET (2.325)	7 8 9 0 1 2				16	14946-KT7-013	4106001
	SHIM TAPPET (2.350)	7 8 9 0 1 2				16	14947-KT7-013	4106019
	SHIM TAPPET (2.375)	7 8 9 0 1 2				16	14948-KT7-013	4106027
	SHIM TAPPET (2.400)	7 8 9 0 1 2				16	14949-KT7-013	4106035
	SHIM TAPPET (2.425)	7 8 9 0 1 2				16	14950-KT7-013	4106043
	SHIM TAPPET (2.450)	7 8 9 0 1 2				16	14951-KT7-013	4106050
	SHIM TAPPET (2.475)	7 8 9 0 1 2				16	14952-KT7-013	4106058
	SHIM TAPPET (2.500)	7 8 9 0 1 2				16	14953-KT7-013	4106075
	SHIM TAPPET (2.525)	7 8 9 0 1 2				16	14954-KT7-013	4106084