



MODEL	
RB145 KA	
ENGINE	W04C-T
CAT.NO.	RB-1013-E
DATE ISSUED	1991 MAY

PARTS CATALOG

HINO MOTORS, LTD.

Hino

MODEL

RB145 KA

ENGINE

W04C-T

CAT. NO.

RB-1013-E

DATE ISSUED

1991

MAY

SUBJECT INDEX

LOCATION NO.

1. APPLICABLE MODELS

CHASSIS

CHASSIS NOS.

RB145KA (FROM RB145K-40013)

ENGINE

ENGINE NOS.

W04C-T (FROM W04C-TA10860)

2. SPEC. OUTLINE OF HINO PRODUCT
RANGE AND OPTIONAL EQUIPMENTA16

3. VERY IMPORTANT INFORMATIONB16

4. GROUP INDEX
ENGINE GROUPF16

CHASSIS GROUPG16

5. REVISION REF. CODE INDEXA15

6. NUMERICAL INDEX3-A1

7. ALPHABETICAL INDEX3-A3

A16

SPEC. OUTLINE OF HINO PRODUCT RANGE

MODEL		RB145KA						
PRODUCTION SERIES CODE		AHA	AKA	ANA	AEA	AGN	AGK	AGA
WHEEL BASE (MM)	3,780	X	X	X	X	X	X	X
ENGINE MODEL	W04C-T	X	X	X	X	X	X	X
TRANSMISSION SERIES	LE05S	X	X	X	X	X	X	X
REAR AXLE SERIES (RATIO)	SS12-2 (4.100)	X	X	X	X	X	X	X
SERVICE BRAKE CONTROL	VACUUM SERVO HYDRAULIC, TWO INDEPENDENT CIRCUITS	X	X	X	X	X	X	X
PARKING BRAKE	ACTING ON TRANSMISSION OUTPUT SHAFT	X	X	X	X	X	X	X
AIR CONDITIONER	WIDTH	X	X	X	—	—	—	—
	WITHOUT	—	—	—	X	X	X	X
RIM SIZE (FRONT & REAR)	5.50R-16-115	X	X	X	X	—	X	X
	6.00-17.5-127	—	—	—	—	X	—	—
BODY TYPE	COMPLETE BODY UNIT	X	X	X	X	—	X	X
	COWL	—	—	—	—	X	—	—
DESTINATION		AUSTRALIA				NEW- ZEALAND	CYPRUS	

OPTIONAL EQUIPMENT

OPTIONAL EQUIPMENT	LOCATION	GROUP NO.	OPTION NO.	SPECIFICATION	RB145KA							
					AHA	AKA	ANA	AEA	AGN	AGK	AGA	
TIRE SIZE (FRONT & REAR)	2-D8	5901	C65-A005	700R-16-10PR	X	X	X	—	—	—	X	
			C65-A328	7.00R16-12PR (RADIAL TIRE)	X	X	X	X	—	—	—	X
			C65-H141	700-16-12PR	—	—	—	—	—	—	X	—
			C65-H142	7.00R16-12PR	—	—	—	—	—	—	X	—
SLIDING DOOR KEY	1-H4	2701	F04-M025	WITH KEY	X	—	—	—	X	X	X	
			F04-M026	WITHOUT KEY	—	X	X	—	—	—	—	—
GENERATOR	1-K8 1-H14	1811 2701	F23-M011	24V-70A	—	—	—	X	—	—	X	
MUFFLER	1-H12	2401	F52-A001	STACK TAIL TYPE	X	X	X	X	—	—	X	
RADIATOR CURTAIN	1-A12	2201	F59-M001	—	X	X	X	X	X	X	X	
PACKAGE PARTS	1-B	6001	H11-C125	BLOCK EMBLEM	—	—	—	—	X	X	—	



VERY IMPORTANT INFORMATION

1. This PARTS CATALOG comprises SERVICE PARTS and TOOLS for EXPORT BUSES regarding the CHASSIS and ENGINE NUMBERS listed in the following.

Model		
Chassis	RB145KA	Chassis Nos. RB145K-40013
Engine	WO4C-T	Engine Nos. WO4C-TA10860

2. Please read the PRECAUTIONS FOR USING PARTS CATALOG in the succeeding pages carefully before referring to this PARTS CATALOG.
3. Please notice that the SERVICE PARTS or TOOLS will be supplied according to the DISTRIBUTION SYSTEM of HINO MOTORS, LTD.
4. Please observe the RULES printed in the next page in placing orders for spare parts or tools.

This Parts Catalog is a REVISED EDITION of the Parts Catalog No. RB-1012-E for the TRUCKS regarding the CHASSIS and ENGINE NUMBERS listed in the above.

RULES TO BE OBSERVED IN PLACING ORDERS FOR SPARE PARTS OR TOOLS

1. Please make use of the Parts Order Form of which sample is printed on the next page, whenever an order for spare parts or tools is prepared.
2. The said Parts Order Forms are available free of charge at Hino Motors, Ltd. for use of the Distributors, Agencies and Authorized Organizations of Hino Motors, Ltd.
3. Please be sure to give the following information correctly in the Parts Order Form.
 1. Model
 2. Chassis Number (For Chassis Part)
Cab Number (For Cab Part)
Engine Number (For Engine Part)
 3. Part Number
 4. Quantity Required
 5. Parts Catalog Number

Note: The chassis number and the cab number are both inscribed on the respective identification plates in the driver's compartment, while the engine number is inscribed on the crankcase.



**CAUTIONS
NOT TO USE IMITATION**

1. The illustrations inserted in this parts catalog are intended to give a rough idea about the shape of parts. So, there may be instances where some items or their dimensions, their direction order of fitting, etc. are not found in the illustrations. Consequently, if repair and maintenance of vehicles are made only by reference to these illustrations, some trouble may occur. Therefore, please do not refer to the illustrations but always use relevant shop manual for the purpose of repair and maintenance.
2. Always use Genuine Hino Parts for the maintenance and repairs of Hino vehicles. Please refrain from the use of any imitation parts as they are no doubt inferior in material quality, manufacturing process and in all other aspects as compared with Hino Genuine Parts.

Many kinds of Genuine Hino Parts are available in the sales agent or parts agent of Hino, and are ready for delivery at any time. Either of the following marks is put on Genuine Hino Parts for the assurance of their superlative quality.

PRECAUTIONS FOR USING PARTS CATALOG

1. GENERAL INFORMATION

This parts catalog is so compiled that all equipment is classified as described in the Group Index. Each equipment is divided further into several subgroups which are followed by illustrations and pertinent text for each subgroup. For the details of subgroups, refer to the Group Index.

2. ILLUSTRATIONS

Each illustration is described at the beginning of subgroup. Key No. is attached to each illustration for the convenience of indexing the parts included in the illustration. The key No. coincides with the Key No. given in the left column of each page in the text.

3. ILLUSTRATION OF PARTS CONTAINED

Relationship between assembled parts for service and its relative parts contained (assembly, sub-assembly and component) is to be illustrated as in right hand. But the relative parts contained are limited to serviceable parts.

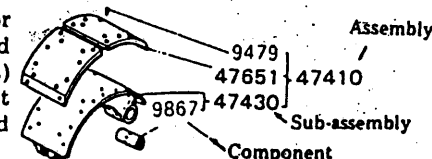

4. COMPONENTS OF A COMPLETE PART

(e.g. Electrical Part, Valves, Cylinders, etc.)

A complete part as assembly is shown in the illustration and text of the group to which it belongs, while its components are illustrated separately at the end of the pages showing the group.

5. STANDARD PARTS OR SEMI-STANDARD PARTS AND PARTS IN GENERAL

Standard parts, semi-standard parts (bolt, nut, washer, rivet, key, etc.) and parts in general are distinguished from each other as shown in the following example.

Part Number

STANDARD OR SEMI-STANDARD PARTS NUMBER ⑨○○○-○○○○

STANDARD BEARING PARTS NUMBER ⑨⑨○-○○○○

Excluding ⑨⑨⑨○-○○○○

Beginning from 9



6. QUANTITY COLUMN

In case different parts are used according to model of chassis or equipment, a discriminative list is given at the initiation of each subgroup, and the quantity required for each category is mentioned in the "Q'ty" column. All parts listed in undistinguished subgroups are those which may be used commonly. The figure given in the "Quantity" column basically denotes the quantity of the part required per unit of the vehicle, but there are the following exceptions.

- (A) When the same part is used for different purposes or on different items of equipment, the figure in the "Quantity" column denotes the quantity required as of the item of equipment or the purpose per unit of vehicle.
- (B) When the components of the structural part are given in separate subgroups, the quantity of the component is understood to denote the requirements there of per unit of the structural part.

Parts marked with "AR" in the "Quantity" column are those which may be used at your convenience as spare or replacement parts.

7. HOW CHANGE OF A PART IS INDICATED :

The new part number is listed below the old part number, and interchangeability of the old and new parts is indicated by the symbols described below.

01.....Where both the old and new parts have interchangeability:
 (Old part number) }
 V 01 The old and new parts are completely
 New part number } interchangeably with each other.

02.....Where only the new part has interchangeability:
 (Old part number) }
 V 02 The new part can be used for the ve-
 New part number } hicle fitted with the old part, but the
 old part cannot be used for the vehicle
 fitted with the new part.

□.....Where the new part combined with an additional part(s) is interchangeable with the old part:
 (Old part number) }
 V □ Substituted with following number(s)
 New part number } New part number, Description, Key
 number. The new part can be
 used for the vehicle
 fitted with the old
 part if additional
 part is provided.

X.....Where neither old nor new part has interchangeability:
 (Old part number) }
 V X The old and new parts are not inter-
 New part number } changeable with each other.

04.....Where the old part becomes unnecessary:
 (Old part number)

V 04
 xxxxxxxxxxx

05.....Where a new part is added:
 (xxxxxxxxxxx)

V 05
 New part number

06.....Where a new part is added in combination with other part(s):
 (xxxxxxxxxxx)

V 06 Substituted with following number(s)
 New part number New part number, Description, Key
 number.

8. HOW TO LOOK UP APPLICABILITY OF A MODIFIED PART

In this edition, the "Table of Applicabilities" describes the serial number of vehicle (Engine No., Chassis No. or Cab No.) from which modification of a part is applicable.

For a modified part, the code number is given on each page in the extreme right column titled "revision ref. code", and the code numbers are listed with corresponding serial numbers. Therefore, when looking up the applicability of a modified part,

- (1) Note the code number in the "revision ref. code" column corresponding to the modified part;
- (2) Find the serial number corresponding to the code number in the aforementioned table.

The confirmation of the applicable serial number is a must especially for a modified part which is interchangeable only when used together with other new part(s) or is not interchangeable with the old part.

(Example)

TABLE										1-C1		B13		
Part Number	A	B	C	D	E	F	G	H	I	Revision Ref. Code	Serial No.	Serial No.	Serial No.	Serial No.
40015														
40016														
40017														
40018														
40019														
40020														
40021														
40022														
40023														
40024														
40025														
40026														
40027														
40028														
40029														
40030														
40031														
40032														
40033														
40034														
40035														
40036														
40037														
40038														
40039														
40040														
40041														
40042														
40043														
40044														
40045														
40046														
40047														
40048														
40049														
40050														
40051														
40052														
40053														
40054														
40055														
40056														
40057														
40058														
40059														
40060														
40061														
40062														
40063														
40064														
40065														
40066														
40067														
40068														
40069														
40070														
40071														
40072														
40073														
40074														
40075														
40076														
40077														
40078														
40079														
40080														
40081														
40082														
40083														
40084														
40085														
40086														
40087														
40088														
40089														
40090														
40091														
40092														
40093														
40094														
40095														
40096														
40097														
40098														
40099														
40100														



9. APPLICABLE SERIAL NUMBER OF BUS CHASSIS FROM WHICH MODIFICATION OF A PART IS APPLICABLE

In the applicable serial number of bus chassis, respective body manufacturers are distinguished from each other by the following symbols.

- T Made of Hino Body Mfg. Co., Ltd. (Yokohama Factory)
- N Made of Nishi-Nippon Body Mfg. Co., Ltd.
- W Made of Kawasaki Heavy Industries, Ltd.
- K Made of Hino Body Mfg. Co., Ltd. (Kanazawa Factory)
- F Made of Fuji Heavy Industries, Ltd.

10. NOMINATION OF "LEFT OR RIGHT", "FRONT OR REAR" AND "UPPER OR LOWER"

"Left or Right" of Chassis, Cab or Rear Body is nominated by seeing the vehicle from the back of it. For engine, we nominate "Back" against the side of Flywheel. "Left or Right" is to be described by seeing from the side of Flywheel. (Consequently, in case of Rear-Engined Bus, "Front or Rear" or "Left or Right" of the Engine is quite vise versa against those of Vehicle.)

11. NUMERICAL INDEX AND ALPHABETICAL INDEX

Numerical index and alphabetical index are given at the end of this catalog, which please use for locating a part by either the part number or part name. (Excluding the part numbers issued by the part manufacturer)

12. DIMENSIONS

All parts are manufactured in métric measure.

13. PART NEWS

Part numbers, the quantity of each part required and the shape of each part are subject to change without notice.



GROUP INDEX

F16

GROUP INDEX

(CONT.)

GROUP NO	GROUP TITLE	PAGE
	ENGINE GROUP	
	** PARTIAL ENGINE **	
0100	PARTIAL ENGINE.....	1-A1
	** SHORT BLOCK **	
0500	SHORT BLOCK.....	1-C1
	** CYLINDER HEAD **	
1000	CYLINDER HEAD.....	1-E1
	** CRANK CASE **	
1100	CYLINDER BLOCK.....	1-I1
1110	TIMING GEAR COVER AND FLYWHEEL HOUSIN	1-A2
1111(OPTION)	TIMING GEAR COVER AND FLYWHEEL HOUSIN	1-D2
	** MAIN MOVING PARTS	
1200	MAIN MOVING PARTS.....	1-E2
1201	MAIN MOVING PARTS(OPTION).....	1-J2
	** VALVE, INTAKE AND EXHAUST SYSTEM *	
1300	CAMSHAFT AND IDLER GEAR.....	1-K2
1310	VALVE SYSTEM.....	1-A3
1320	AIR INTAKE AND EXHAUST SYSTEM.....	1-C3

GROUP NO	GROUP TITLE	PAGE
	** LUBRICATING SYSTEM **	
1400	LUBRICATING SYSTEM.....	1-I3
1490-1420E	COOLER, OIL.....	1-K3
	** FUEL SYSTEM **	
1500	FUEL SYSTEM.....	1-A4
1590-1518X	FILTER, FUEL.....	1-G4
1590-1523D	GOVERNOR, MECHANICAL.....	1-H4
1590-1523E	GOVERNOR, MECHANICAL.....	1-C5
1590-1530V	HOLDER, NOZZLE.....	1-A6
1590-1556F	PUMP BODY, FUEL INJECTION.....	1-E6
1590-1563D	PUMP, FUEL FEED.....	1-J6
1590-1575Y	TIMER, AUTOMATIC.....	1-A7
	** COOLING SYSTEM **	
1600	COOLING SYSTEM.....	1-D7
1601	COOLING SYSTEM(OPTION).....	1-H7
1690-1659N	PUMP, COOLANT.....	1-J7
1690-1810A	PUMP, VACUUM.....	1-K7
	** ACCESSORY PARTS **	
1800	AIR COMPRESSOR AND STEERING OIL PUMP.	1-A8
1810	ELECTRICAL PARTS.....	1-E8
1811	ELECTRICAL PARTS(OPTION).....	1-K8
1830	TURBOCHARGER.....	1-A9



GROUP NO	GROUP TITLE	PAGE
1831	TURBOCHARGER (OPTION).....	1-C9
1890-1823Z	ALTERNATOR.....	1-E9
1890-1824D	ALTERNATOR.....	1-H9
1890-1846Z	MOTOR, STARTING.....	1-K9
1890-1847F	STARTER.....	1-A10
1890-1881L	TURBOCHARGER.....	1-D10
1890-6406Z	PUMP, OIL, POWER STEERING.....	1-G10
C H A S S I S G R O U P		
** FUEL TANK **		
2000	FUEL TANK.....	1-A11
2090-1518F	FILTER, FUEL.....	1-G11
2090-1571B	SEDIMENTER.....	1-H11
** COOLING SYSTEM **		
2200	COOLING SYSTEM.....	1-I11
2201	RADIATOR CURTAIN (OPTION).....	1-A12
** EXHAUST **		
2400	EXHAUST.....	1-C12
2401	EXHAUST (OPTION).....	1-H12
** AIR INTAKE **		
2500	AIR INTAKE (CHASSIS).....	1-A13
2590-2505G	CLEANER, AIR.....	1-C13

GROUP NO	GROUP TITLE	PAGE
** BATTERY **		
2600	BATTERY AND BATTERY SETTING.....	1-D13
** ELECTRICAL **		
2700	ELECTRIC SYSTEM (CHASSIS).....	1-E13
2701	ELECTRIC SYSTEM (CHASSIS) (OPTION).....	1-H14
2790-2705A	BLOCK, FUSE AND JUNCTION.....	2-A1
2790-2705Z	BLOCK, FUSE AND JUNCTION.....	2-B1
2790-2746G	LAMP, BACK-UP.....	2-C1
2790-2770E	LAMP, DIRECTION SIGNAL.....	2-D1
2790-2771A	LAMP, TURN SIGNAL.....	2-E1
2790-2775D	LAMP, SIDE TURN SIGNAL.....	2-F1
2790-2786G	LAMP, FOG.....	2-G1
2790-2786N	LAMP, FOG.....	2-H1
2790-2789G	HEAD LAMP.....	2-I1
2790-2795D	LAMP, LICENSE.....	2-J1
2790-2795E	LAMP, LICENSE.....	2-K1
2790-2819G	LAMP, TAIL AND STOP.....	2-L1
2790-2819R	LAMP, TAIL AND STOP.....	2-A2
2790-2819V	LAMP, TAIL AND STOP.....	2-C2
2790-6430C	SWITCH, COMBINATION.....	2-D2
** CLUTCH **		
3000	CLUTCH.....	2-E2
3005	CLUTCH HOUSING.....	2-G2



GROUP INDEX

(CONT.)

GROUP INDEX

(CONT.)

GROUP NO	GROUP TITLE	PAGE
3007	ENGINE SETTING PARTS.....	2-I2
3010	CLUTCH PEDAL CONTROL.....	2-J2
3090-3006X	CYLINDER, CLUTCH MAIN.....	2-A3
3090-3011K	CYLINDER, CLUTCH SLAVE.....	2-B3
	** TRANSMISSION **	
3200	TRANSMISSION ASSY.....	2-C3
3210	CASE AND MAIN UNIT.....	2-D3
3220	SPEEDOMETER GEAR.....	2-J3
3230	GEAR SHIFT HOUSING.....	2-A4
3240	TRANSMISSION CONTROL.....	2-D4
	** PROPELLER SHAFT **	
3400	PROPELLER SHAFT.....	2-H4
	** SERVICE BRAKE PIPING **	
3500	SERVICE BRAKE PIPING.....	2-A5
3590-3016X	RESERVOIR, OIL.....	2-I5
3590-3516T	CYLINDER, BRAKE MAIN.....	2-J5
3590-3536G	HYDROMASTER.....	2-A6
	** PARKING BRAKE **	
3800	PARKING BRAKE.....	2-D6
3810	PARKING BRAKE CONTROL.....	2-F6

GROUP NO	GROUP TITLE	PAGE
	** FRAME AND BUMPER **	
4400	FRAME.....	2-J6
	** FRONT SPRING **	
5500	FRONT SPRING.....	2-A7
5590-5516B	SHOCK-ABSORBER.....	2-F7
	** REAR SPRING **	
5800	REAR SPRING.....	2-G7
5890-5516H	SHOCK-ABSORBER.....	2-L7
	** WHEEL AND TIRE	
5900	WHEEL AND TIRE.....	2-A8
5901	WHEEL AND TIRE (OPTION).....	2-D8
	** METER AND GAUGE **	
6000	METER AND FINAL PARTS.....	2-F8
6001	METER AND FINAL PARTS (OPTION).....	2-I8
6090-6003B	INSTRUMENT CLUSTER.....	2-J8
6090-6006J	SPEEDOMETER.....	2-K8
	** ENGINE CONTROL **	
6100	ENGINE CONTROL.....	2-A9
	** STEERING **	

**

2-G1
2-L7

A8
P

NO	GROUP TITLE	PAGE
	STEERING GEAR AND LINKAGE.....	2-E9
	INTEGRAL POWER STEERING GEAR.....	2-I9
	POWER STEERING OIL PIPING.....	2-A10
0-6411W	RESERVOIR, OIL, POWER STEERING.....	2-D10
0-6440B	WHEEL, STEERING.....	2-E10
	** FRONT AXLE AND WHEEL BRAKE **	
6600	FRONT AXLE.....	2-G10
6610	FRONT WHEEL BRAKE.....	2-J10
6690-6612B	CYLINDER, WHEEL BRAKE.....	2-A11
	** REAR AXLE AND WHEEL BRAKE **	
6800	REAR AXLE (FRONT).....	2-B11
6810	REAR WHEEL BRAKE (FRONT).....	2-D11
6820	REAR AXLE DIFFERENTIAL CARRIER (FRON	2-F11
6890-6612C	CYLINDER, WHEEL BRAKE.....	2-I11
	** POWER TAKE-OFF **	
7000	POWER TAKE-OFF.....	2-J11
	** TOOL **	
9000	ACCESSORY.....	2-K11
9015	SPECIAL TOOL (FOR ENGINE).....	2-A12
9020	SPECIAL TOOL (FOR FUEL TANK).....	2-F12
9027	SPECIAL TOOL (FOR ELECTRICAL SYSTEM	2-G12

GROUP NO	GROUP TITLE	PAGE
9030	SPECIAL TOOL (FOR CLUTCH).....	2-H12
9032	SPECIAL TOOL (FOR TRANSMISSION)....	2-I12
9035	SPECIAL TOOL (FOR SERVICE BRAKE)...	2-J12
9059	SPECIAL TOOL (FOR WHEEL).....	2-K12
9064	SPECIAL TOOL (FOR STEERING).....	2-L12
9066	SPECIAL TOOL (FOR FRONT AXLE).....	2-M12
9068	SPECIAL TOOL (FOR REAR AXLE).....	2-A13
	C A B G R O U P	
	** HEATER **	
B9000	HEATER.....	2-B13
B9090-2774A	LAMP, HEATER CONTROL.....	2-F13
	** AIR CONDITIONER, COOLER **	
K9100	COOLER.....	2-G13

1-A1

0100

PARTIAL ENGINE

11090

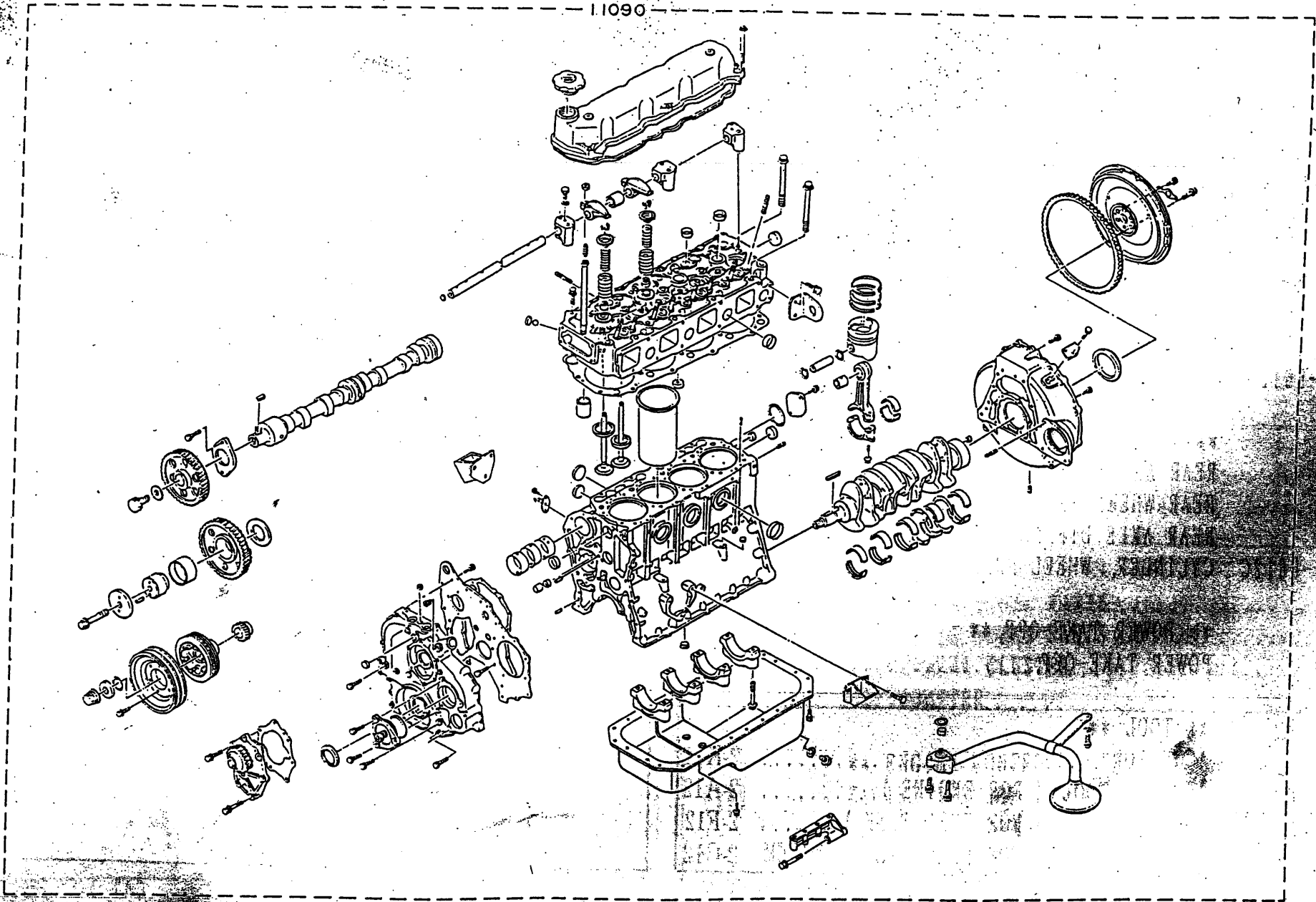

0100-A



ME11-038-00X00~12
(0100)

0100

PARTIAL ENGINE

PART NUMBER	Q U A N T I T Y														REVISION	
	A	B	C	D	E	F	G	H	I	J	K	L	M	N	O	REF. CODE
A RB145KA (AEA, AGA) B RB145KA-AGN C RB145KA (AHA, AKA, ANA) D RB145KA-AGK																
----- : 11090 : ENGINE ASSY, PARTIAL *-----*																
11090-5930	1	1	1	1												

1-C1

0500

SHORT BLOCK

11400

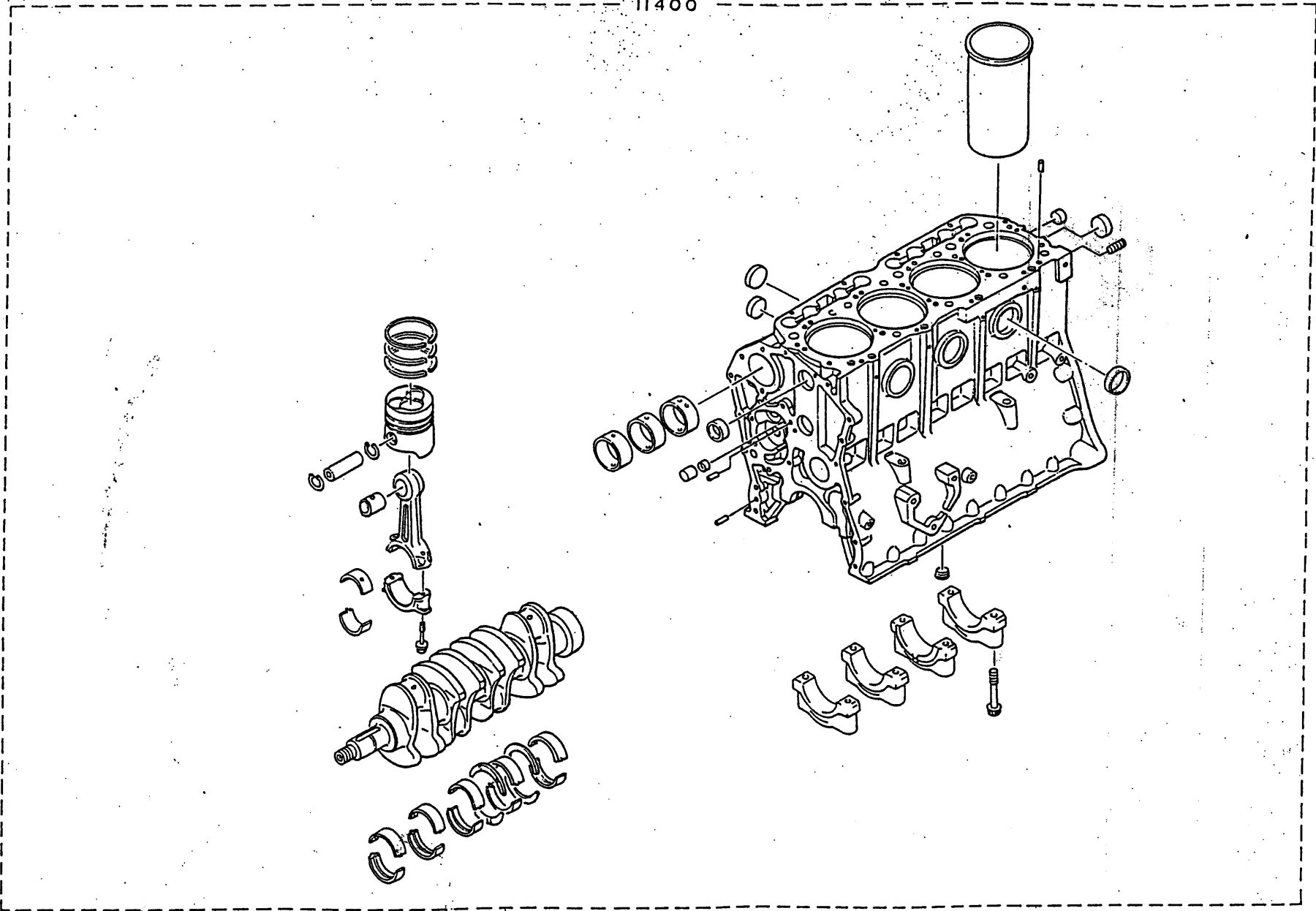

ME11-038-00X00~12
(500)

0500-A



0500

SHORT BLOCK

PART NUMBER	Q U A N T I T Y										REVISION					
	A	B	C	D	E	F	G	H	I	J	K	L	M	N	O	REF. CODE
A. RB145KA (AEA, AGA)																
B. RB145KA-AGN																
C. RB145KA (AHA, AKA, ANA)																
D. RB145KA-AGK																

: 11400 : BLOCK ASSY, SHORT																

11400-3110	1	1	1	1												

1-E1

1000

CYLINDER HEAD (1/2)

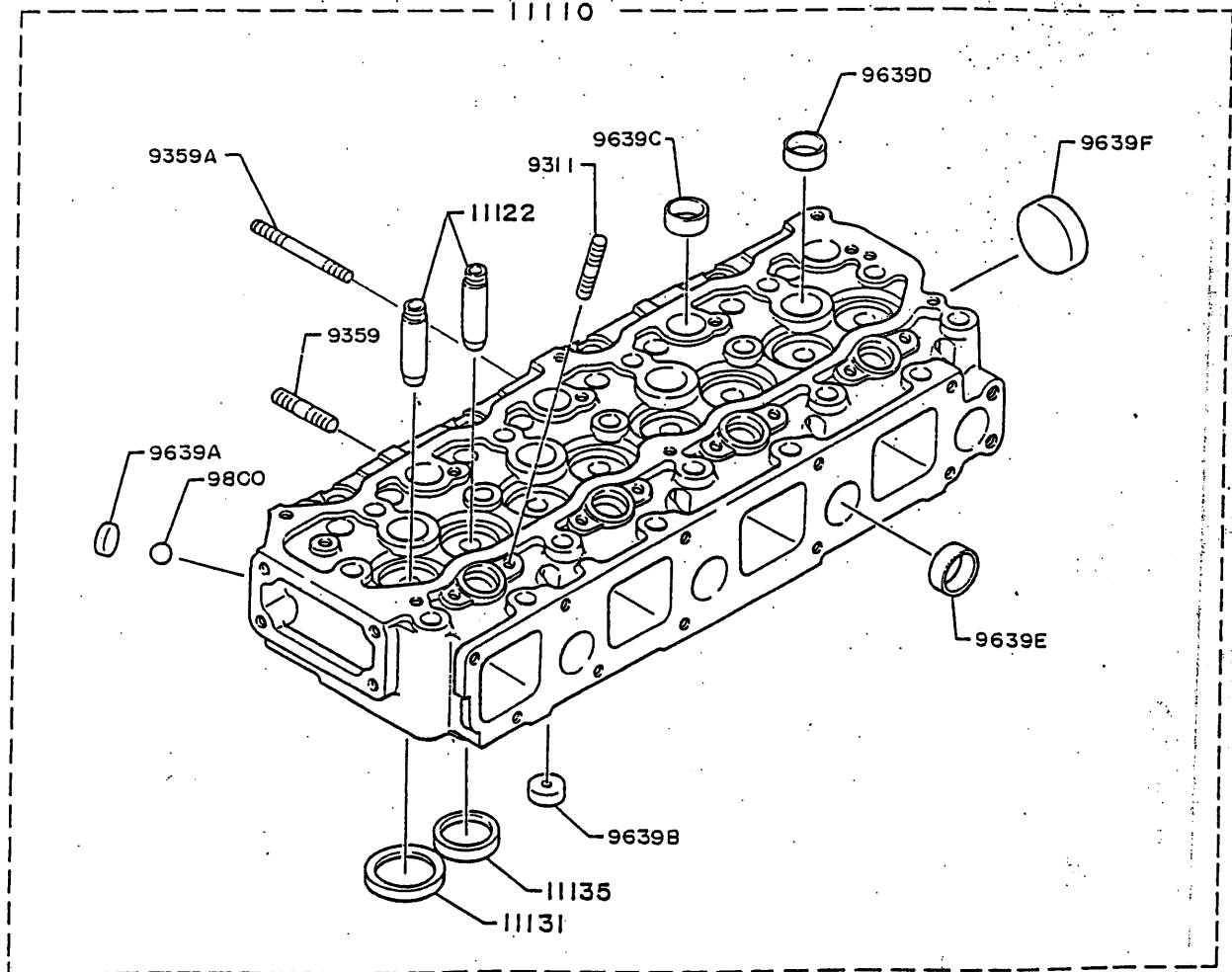

ME11-038-00X00~12
(1000)(1/2)

1000-A



1000

CYLINDER HEAD (2/2)

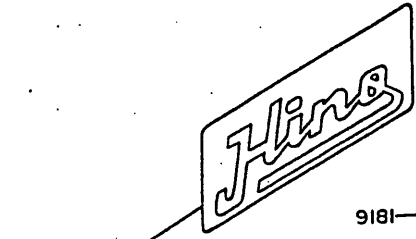

76579B

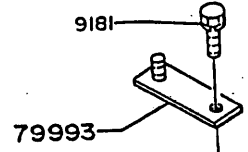

9181

79993

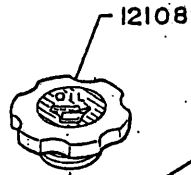

12108

11211

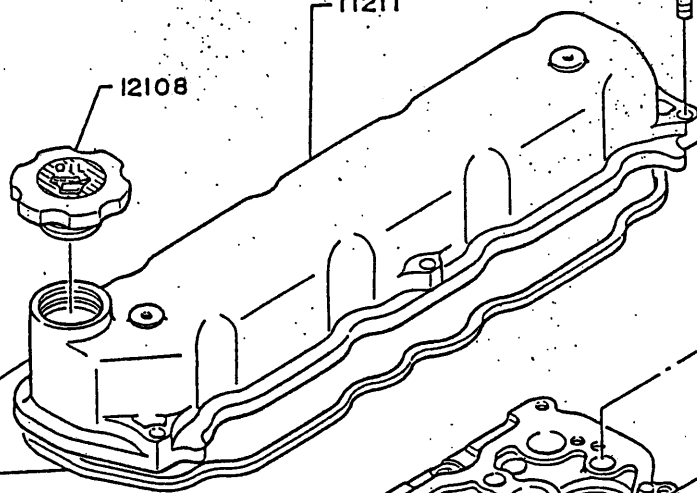

11213

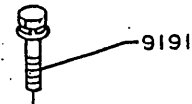

9191

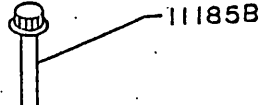

11185B

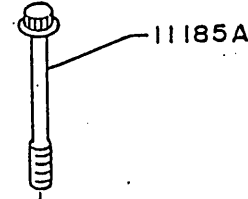

11185A

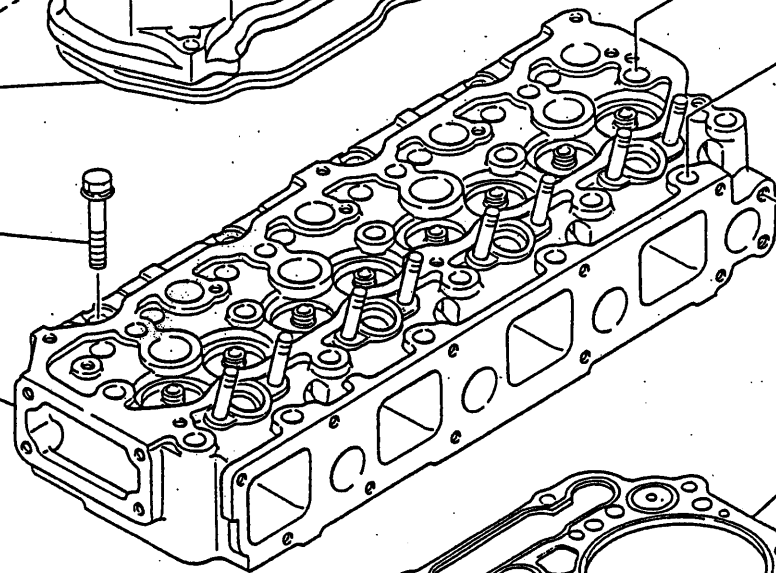

9411

11110

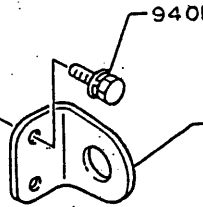

9401

12281

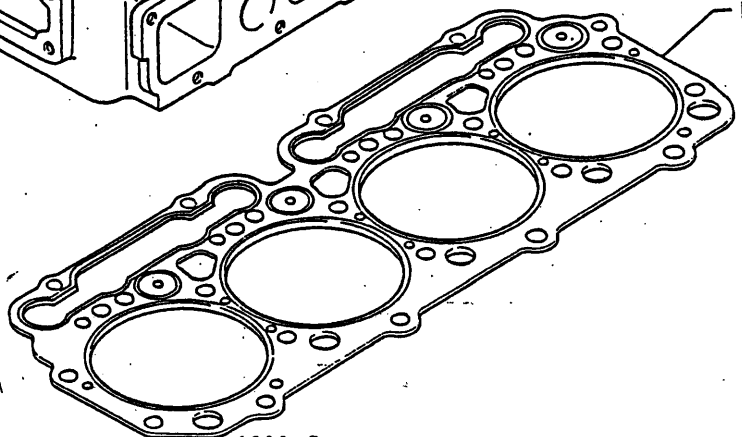

11115

1000-B.



1000

CYLINDER HEAD

PART NUMBER	QUANTITY										REVISION					
	A	B	C	D	E	F	G	H	I	J	K	L	M	N	O	REF.CODE
A RB145KA(AEA,AGA)																
B RB145KA-AGN																
C RB145KA(AHA,AKA,ANA)																
D RB145KA-AGK																

: 11110 : HEAD ASSY, CYL.																

(11110-3400)	1	1	1	-												
V X																
(11110-3930)	1	1	1	-												
V 02																
11110-3931	1	1	1	1												

: 11115 : GASKET, CYL HEAD																

(11115-1821)	1	1	1	-												
V 01																
11115-1821	1	1	1	1												

: 11122 : BUSHING, VALVE GUIDE INTAKE, REPAIR STD																

11122-1140	8	8	8	8												

: 11131 : SEAT, VALVE INTAKE																

11131-1210	4	4	4	4												

: 11135 : SEAT, VALVE EXH																

11135-1320	4	4	4	4												

: 11185 A : BOLT, CYL HEAD																

(11185-1440)	13	13	13	-												
V 01																
11185-1440	13	13	13	13												

: 11185 B : BOLT, CYL HEAD																

(11185-1450)	5	5	5	-												
V 01																
11185-1450	5	5	5	5												

: 11211 : COVER, CYL HEAD																

11211-1940	1	1	1	1												

: 11213 : GASKET, CYL HEAD COVER																

11213-1550	1	1	1	1												

: 12108 : CAP SUB ASSY, OIL FILLER																

(12108-1130)	1	1	1	-												
V 01																
12108-1100	1	1	1	1												



1000

CYLINDER HEAD

PART NUMBER	QUANTITY										REVISION					
	A	B	C	D	E	F	G	H	I	J	K	L	M	N	O	REF.CODE

: 12281 : HANGER, ENG																

12281-1320	1	1	1	1												

: 76579 B : PLATE, CAUTION ENG																

76579-5260	1	1	1	1												

: 79993 : HOLDER, CLIP																

79993-2990	1	1	1	1												

: 9181 : BOLT																

9181-08350	1	1	1	1												

: 9191 : BOLT																

(9191-08352)	5	5	5	-												
V 01																
9191-08351	5	5	5	5												

: 9311 : STUD																

9311-08750	8	8	8	8												

: 9359 : STUD																

(9351-10380)	8	8	8	-												
V 01																
(9351-10380)	5	5	5	5												
V 01																
9359-10114	5	5	5	5												

: 9359 A : STUD																

(9351-10800)	3	3	3	-												
V 02																
(9369-10129)	3	3	3	3												
V 01																
9359-10115	3	3	3	3												

: 9401 : BOLT																

9401-10200	2	2	2	2												

: 9411 : BOLT																

9411-10401	4	4	4	4												

: 9639 A : PLUG, EXPANSION																

9639-14101	4	4	4	4												

: 9639 B : PLUG, EXPANSION																

9639-22107	4	4	4	4												

W04CT361

W04CT323
W04CT361

1000

CYLINDER HEAD

PART NUMBER	QUANTITY															REVISION	
	A	B	C	D	E	F	G	H	I	J	K	L	M	N	O	REF. CODE	
A RB145KA (AEA, AGA)																	
B RB145KA-AGN																	
C RB145KA (AHA, AKA, ANA)																	
D RB145KA-AGK																	

: 9639 C :																	
PLUG, EXPANSION																	

9639-24103	4	4	4	4													

: 9639 D :																	
PLUG, EXPANSION																	

9639-26102	4	4	4	4													

: 9639 E :																	
PLUG, EXPANSION																	

9639-30105	4	4	4	4													

: 9639 F :																	
PLUG, EXPANSION																	

9639-50103	1	1	1	1													

: 9800 :																	
BALL, STEEL																	

9800-05080	4	4	4	4													