

MASTER PARTS CATALOG

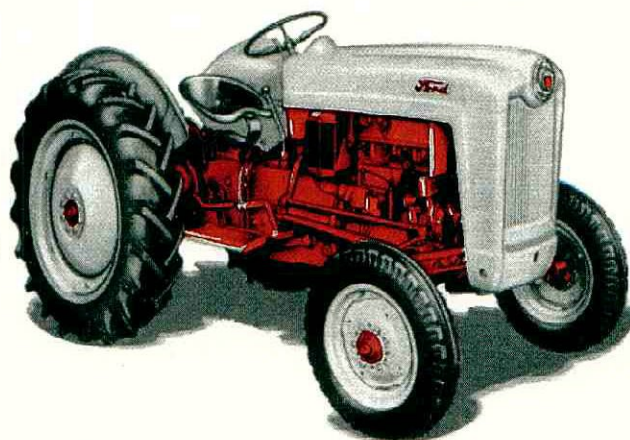

This catalog, PA-8058, contains the following information:

1. Exploded drawings for correct assembly and identification.
2. Part Numbers
3. Part Name, including description and dimensions necessary for proper identification of parts.
4. Quantity used per Vehicle
5. Model Application
6. Year Part is used

**Models NAA, 501, 600, 700,
800, 900 and 1801**

1953 thru 1959
Ford Motor Company

CM082702

1953 thru 1959

Clayton

Tractor Parts Catalog

**FORD
TRACTOR**



PARTS **TRACTOR** CATALOG

GENERAL INFORMATION

This completely new Ford Tractor Parts Catalog, compiled in Loose-Leaf Form, has been prepared for ease in identifying and ordering parts for tractors built from 1953 thru current production (Models NAA, 501, 600, 700, 800, 900, 1801.)

Tractor Parts Catalog PA-6604 and Supplements PA-6604-1, 2, 3, are replaced and superseded by this Tractor Parts Catalog PA-8058.

PARTS INFORMATION

The information contained in this Tractor Parts Catalog includes the following -

1. Part Numbers
2. Part Name, including description and dimensions necessary for proper identification of parts.
3. Quantity used per Vehicle
4. Model Application
5. Year Part is used

NUMERICAL INDEX

Reference to any part by part number. This index contains a numerical listing of all tractor parts indicating a hyphenated number, the major section, and the page in that section where each part is located.

ILLUSTRATIONS

Illustrations show the "make-up" of assemblies and individual parts but in all cases may not show the exact shape or detail of parts required. However, the purpose for the illustrations is to identify parts performing like functions. Whenever possible, illustrations are located at the beginning of each section or immediately adjacent to the applicable text. If possible, parts are identified on each illustration by basic numbers, otherwise the sequential numbers are shown.

HOW TO LOCATE PARTS

This tractor parts catalog is divided into major sections corresponding to specific areas of the tractor showing the tractor series to which each section applies. The sections include one or more illustrations with component parts, related to each illustration, arranged numerically. Basic numbers shown in the parts column with an asterick are for reference only and the true part number for the required part is shown in brackets opposite the reference number. Illustrations show basic part numbers wherever possible. When a part number is unknown, use the major section index and the pertinent illustration to identify the required part.

SYMBOLS IN YEAR COLUMN

- | | |
|-------|---|
| 53/54 | Parts used for a period of years and then discontinued are indicated in the year column by a commencing and finishing year. |
| 55 | Parts used in one year only and then discontinued are indicated by the year. |
| 53/ | Parts still used in current production are indicated by the commencing year followed by a slant (/). |



PARTS TRACTOR CATALOG



ABBREVIATIONS

Adj.	-	Adjusting	Hi-Clr.	-	Hi-Clearance
Assy.	-	Assembly	Hsg.	-	Housing
Bal.	-	Balance	Incl.	-	Includes
Batt.	-	Battery	Ins.	-	Instrument
Brg.	-	Bearing	Inv.	-	Inverted
Brkt.	-	Bracket	Lub.	-	Lubrication
Brk.	-	Brake	L/W	-	Lockwasher
Carb.	-	Carburetor	L. H.	-	Left Hand
Carr.	-	Carriage	Impl.	-	Implement
Col.	-	Column	Mach.	-	Machine
Conn.	-	Connecting, Connection	Manfld.	-	Manifold
Clp.	-	Clamp	Mtg.	-	Mounting
Comp.	-	Components	N. S.	-	Not Serviced
Cyl.	-	Cylinder	Opt.	-	Optional
Dia.	-	Diameter	Press.	-	Pressure
Drld.	-	Drilled	Quad.	-	Quadrant
Diff.	-	Differential	R. C.	-	Row Crop
Eng.	-	Engine	Reg.	-	Regulator
Ext.	-	Extension	Ret.	-	Retainer
Frnt.	-	Front	Retg.	-	Retaining
Fil.	-	Filler	Rd.	-	Round
Fill.	-	Fillister	R. H.	-	Right Hand
Fltr.	-	Filter	R. A.	-	Rear Axle
Flrd.	-	Flared	Std.	-	Standard
Ftng.	-	Fitting	Sq.	-	Square
Gr.	-	Gear	Ser.	-	Serial
Gov.	-	Governor	Spdl.	-	Spindle
H. D.	-	Heavy Duty	Strg.	-	Steering
Hd.	-	Head	Spd.	-	Speed
Supp.	-	Support	Trans.	-	Transmission
Sprg.	-	Spring	Thrd.	-	Thread
Term.	-	Terminal	Univ.	-	Universal

PARTS **TRACTOR** CATALOGMODEL IDENTIFICATION

MODEL	TYPE ENGINE AVAILABLE				ENGINE DISP. CU. IN.	TRANS. SPEEDS	P. T. O.	CLUTCH	PROOF METER	POWER STRG.	YEAR
	GAS	KEROSENE	LPG	DIESEL							
NAA	X				134	4	Std.	9"S	No	Acc.	1953/54
NAB		X			134	4	Std.	9"S	No	Acc.	1953/54
541	X			X	134/144	4	Std.	10"S	Yes	No	1959/
611	X		X	X	134/D 144	10	Opt.	No	No	Opt.	1959/
620	X	X	X		134	4	Opt.	9"S	No	Acc.	1955/57
621	X	X	X	X	134/144	4	Opt.	10"S	No	Opt.	1958/
630	X	X	X		134	4	Opt.	9"S	No	Acc.	1955/57
631	X	X	X	X	134/144	4	Opt.	10"S	No	Opt.	1958/
640	X	X	X		134	4	Std.	9"S	Yes	Acc.	1955/57
641	X	X	X	X	134/D 144	4	Std.	10"S	Yes	Opt.	1958/
650	X	X	X		134	5	Std.	10"S	Yes	Acc.	1955/57
651	X	X	X		134	5	Std.	10"S	Yes	Opt.	1958/
660	X	X	X		134	5	Live	9"D	Yes	Acc.	1955/57
661	X	X	X		134	5	Live	9"D	Yes	Opt.	1958/
671	X		X	X	134/D 144	10	Single Spd	No	Yes	Opt.	1959/
681	X		X	X	134/D 144	10	2 Spd.	No	Yes	Opt.	1959/
740	X	X	X		134	4	Std.	9"S	Yes	Std.	1955/57
741	X	X	X	X	134/D 144	4	Std.	10"S	Yes	Std.	1958/
771	X		X	X	134/D 144	10	S. Speed	No	Yes	Std.	1959/
811	X		X	X	172	10	Opt.	No	No	Opt.	1959/
820	X	X	X		172	5	Opt.	10"S	No	Acc.	1955/57
821	X	X	X	X	172	5	Opt.	10"S	No	Opt.	1958/
840	X	X	X		172	4	Std.	10"S	Yes	Acc.	1955/57
841	X	X	X	X	172	4	Std.	10"S	Yes	Opt.	1958/
850	X	X	X		172	5	Std.	10"S	Yes	Acc.	1955/57
851	X	X	X	X	172	5	Std.	10"S	Yes	Opt.	1958/
860	X	X	X		172	5	Live	9"D	Yes	Acc.	1955/57
861	X	X	X	X	172	5	Live	9"D	Yes	Opt.	1958/
871	X		X	X	172	10	S. Speed	No	Yes	Opt.	1959/
881	X		X	X	172	10	2 Speed	No	Yes	Opt.	1959/
941	X	X	X	X	172	5	Std.	10"S	Yes	Std.	1958/
950	X	X	X		172	5	Std.	10"S	Yes	Std.	1955/57
951	X	X	X	X	172	5	Std.	10"S	Yes	Std.	1958/
960	X	X	X		172	5	Live	9"D	Yes	Std.	1955/57
961	X	X	X	X	172	5	Live	9"D	Yes	Std.	1958/
971	X		X	X	172	10	S. Speed	No	Yes	Std.	1959/
981	X		X	X	172	10	2 Speed	No	Yes	Std.	1959/
1811	X		X	X	172	10	Opt.	No	No	Std.	1959/
1821	X		X	X	172	4	Opt.	10"S	No	Std.	1958/
1841	X		X	X	172	4	Std.	10"S	Yes	Std.	1958/
1871	X		X	X	172	10	S. Speed	No	Yes	Std.	1959/
1881	X		X	X	172	10	2 Speed	No	Yes	Std.	1959/

MODEL USAGE IS INDICATED AS FOLLOWS

Model Application of individual parts is shown in the "Model or Series" column as follows:

1. Gasoline models only are shown for parts common to gasoline, Kerosene, L. P. G. and Diesel Tractors.
2. Kerosene models, identified by the letter "K", are shown for parts peculiar to kerosene tractors.
3. L. P. G. Models, identified by the letter "L", are shown for parts peculiar to L. P. G. Tractors.
4. Diesel Models, identified by the letter "D", are shown for parts peculiar to diesel tractors.
5. Use of series number (600, 700, 800, 900) indicates part used on all tractors within the series shown, including models 601, 701, 801, 901.

SECTION NO. 1

WHEELS

<u>DESCRIPTION</u>	<u>PAGE NO.</u>
Front Wheel Assy. (NAA, 600, 700, 800, 900)	1-2
Front Wheel Assy. (600, 800, 1801)	1-3
Rowcrop Single Wheel (700, 900)	1-4
Rear Wheel	1-5
Power Adjustable Rear Wheel (600, 700, 800, 900)	1-6
Wheel Charts	1-7



PARTS TRACTOR CATALOG

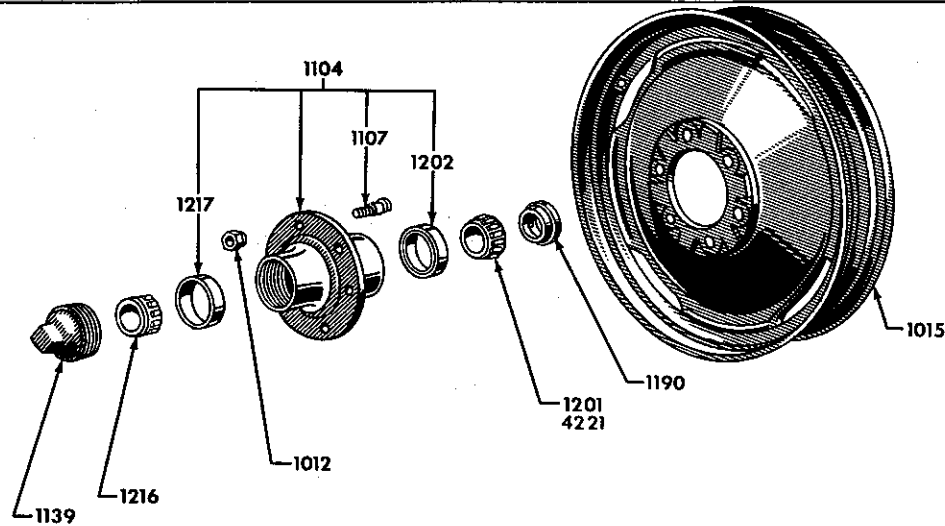

FIG. 1A1 - FRONT WHEEL ASSEMBLY

Basic numbers only shown on illustration. Order by Part Numbers shown in list of parts.

FIG.	PART NO.	PART NAME	NO. REQ.	REMARKS	YEAR
		NAA, 501, 600, 700, 800, 900			
1A1	2N-1012	Nut - Front Wheel Bolt	12		53/
		w/R. C. Single Wheel - Hi-Clr.	6		57/
1A1	8N-1015-A	Wheel Assy. - w/4 x 19 tires	2	NAA only	53/54
1A1	8N-1015-C	Wheel Assy. - w/5.50 x 16 tires	2	not used w/frt. end equip.	53/
1A1	8N-1015-D	Wheel Assy. - w/6.00 - 6.50 x 16 tires	2		53/
		w/R. C. Single Wheel - Hi-Clr.	1		57/
1A1	NCA-1104-B	Hub & Bolt Assy. - Front Wheel	2	after Ser. #137818	57/
		w/R. C. Single Wheel Hi-Clr.	1	after Ser. #137818	57/
1A1	NCA-1104-C	Hub & Bolt Assy. - Front Wheel	2	Prior to Ser. #137818	53/56
		w/R. C. Single Wheel - Hi-Clr.	1	Prior to Ser. #137818	55/56
1A1	78-1107	Bolt - Front Wheel	12		53/
		w/R. C. Single Wheel Hi-Clr.	6		57/
1A1	2N-1139-B	Cap - Front Hub	2		53/
		w/R. C. Single Wheel - Hi-Clr.	1		57/
1A1	*1190	(202784) Retainer Assy. - Frt. Hub	2		53/
		w/R. C. Single Wheel Hi-Clr.	1		57/
1A1	B-1201	Cone & Roller Assy. - Front Wheel	2	NAA only Inner w/8N-1104-A	53/54
1A1	8A-1201-B	Cone & Roller Assy. - Front Wheel	2	Inner w/NCA-1104-A	53/57
		w/R. C. Single Wheel Hi-Clr.	1	Inner w/NCA-1104-A	57/
1A1	8A-1201-C	Cone & Roller Assy. - Front Wheel	2	Inner w/NCA-1104-B	53/
		w/R. C. Single Wheel Hi-Clr.	1	Inner w/NCA-1104-B	57/
1A1	B-1202	Cup - Frt. Wheel Brg.	2	NAA only-Inner w/8N-1104-A	53/54
1A1	8A-1202-A	Cup - Frt. Wheel Brg.	2	Inner w/NCA-1104-A	53/
		w/R. C. Single Wheel - Hi-Clr.	1	Inner w/NCA-1104-A	57/
1A1	8A-1202-B	Cup - Frt. Wheel Brg.	2	Inner - w/NCA-1104-B	53/
		w/R. C. Single Wheel - Hi-Clr.	1	Inner-w/NCA-1104-B	57/
1A1	B-1216	Cone & Roller Assy. - Front Wheel	2	NAA only Outer w/8N-1104-A	53/54
1A1	8A-1216-A	Cone & Roller Assy. - Front Wheel	2	Outer w/NCA-1104-A	53/57
		w/R. C. Single Wheel - Hi-Clr.	1	Outer w/NCA-1104-A	57/
1A1	8A-1216-B	Cone & Roller Assy. - Front Wheel	2	Outer w/NCA-1104-B	53/
		w/R. C. Single Wheel - Hi-Clr.	1	Outer w/NCA-1104-B	53/
1A1	B-1217	Cup - Frt. Wheel Brg.	2	NAA only-Outer w/8N-1104-A	53/54
1A1	8A-1217-A	Cup - Frt. Wheel Brg.	2	Outer w/NCA-1104-A	53/57
		w/R. C. Single Wheel - Hi-Clr.	1	Outer w/NCA-1104-A	57/
1A1	8A-1217-B	Cup - Frt. Wheel Brg.	2	Outer - w/NCA-1104-B	53/
		w/R. C. Single Wheel - Hi-Clr.	1	Outer - w/NCA-1104-B	57/
	202784	Refer to 1190			

*Note - Reference No. only. When ordering parts use part No. shown in brackets opposite reference number.

PARTS TRACTOR CATALOG

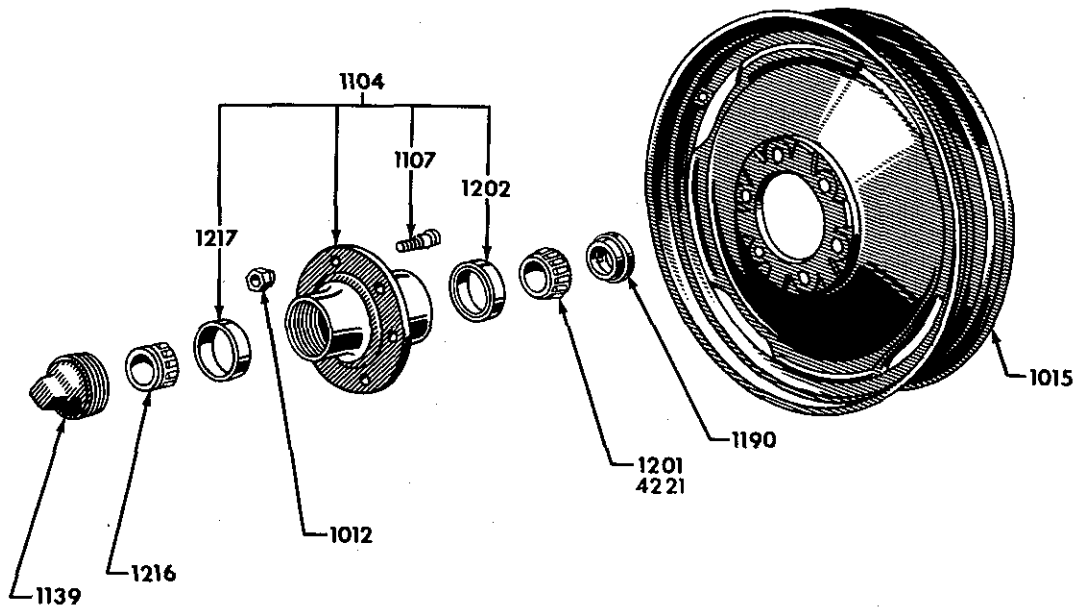

FIG. 1A2 - FRONT WHEEL ASSEMBLY

Basic numbers only shown on illustration. Order by Part Numbers shown in list of parts.

FIG.	PART NO.	PART NAME	NO. REQ.	REMARKS	YEAR
		600, 800, 1801			
1A2	2N-1012	Nut - Frt. Wheel Bolt	12		58/
1A2	* 1015	(312743) Wheel Assy. - W/7.50 x 16 Tires	2	900 - R. C. Wide Axle	58/
1A2	* 1104	(312640) Hub & Bolt Assy. - Frt. Wheel	2	Except Ind.	58/
1A2	* 1104	(313020) Hub & Bolt Assy. - Frt. Wheel	2	Ind. only	58/
1A2	* 1107	(313022) Bolt - Frt. Wheel	12	Ind. only	58/
1A2	78-1107	Bolt - Frt. Wheel	12	Except Ind.	58/
1A2	* 1139	(313023) Cap - Front Hub	2	Ind. only	58/
1A2	2N-1139-B	Cap - Front Hub	2	Except Ind.	58/
1A2	* 1190	(310195) Retainer Assy. - Frt. Hub	2	Except Ind.	58/
1A2	* 1190	(312523) Retainer Assy. - Frt. Hub.	2	Ind. only	58/
1A2	* 1201	(310115) Cone & Roller Assy. - Frt. Wheel	2	Except Ind. - Inner w/312640	58/
1A2	* 1202	(310116) Cup - Frt. Wheel Brg.	2	Except Ind. - Inner w/312640	58/
1A2	* 1202	(312518) Cup - Frt. Wheel Brg.	2	Ind. only - Inner w/313020	58/
1A2	* 1216	(312520) Cone & Roller Assy. - Frt. Wheel	2	Ind. only - Outer w/313020	58/
1A2	8A-1216-B	Cone & Roller Assy. - Frt. Wheel	2	Except Ind. - Outer w/312640	58/
1A2	* 1217	(312548) Cup - Frt. Wheel Brg.	2	Ind. only - Outer w/313020	58/
1A2	8A-1217-B	Cup - Frt. Wheel Brg.	2	Except Ind. - Outer w/312640	58/
1A2	8L-4221	Cone & Roller Assy. - Frt. Wheel	2	Ind. only - Inner w/313020	58/
	310115	Refer to 1201			
	310116	Refer to 1202			
	310195	Refer to 1190			
	312518	Refer to 1202			
	312520	Refer to 1216			
	312523	Refer to 1190			
	312548	Refer to 1217			
	312640	Refer to 1104			
	312743	Refer to 1015			
	313020	Refer to 1104			
	313022	Refer to 1107			
	313023	Refer to 1139			

*Note - Reference No. only. When ordering parts use part No. shown in brackets opposite reference number.



PARTS TRACTOR CATALOG

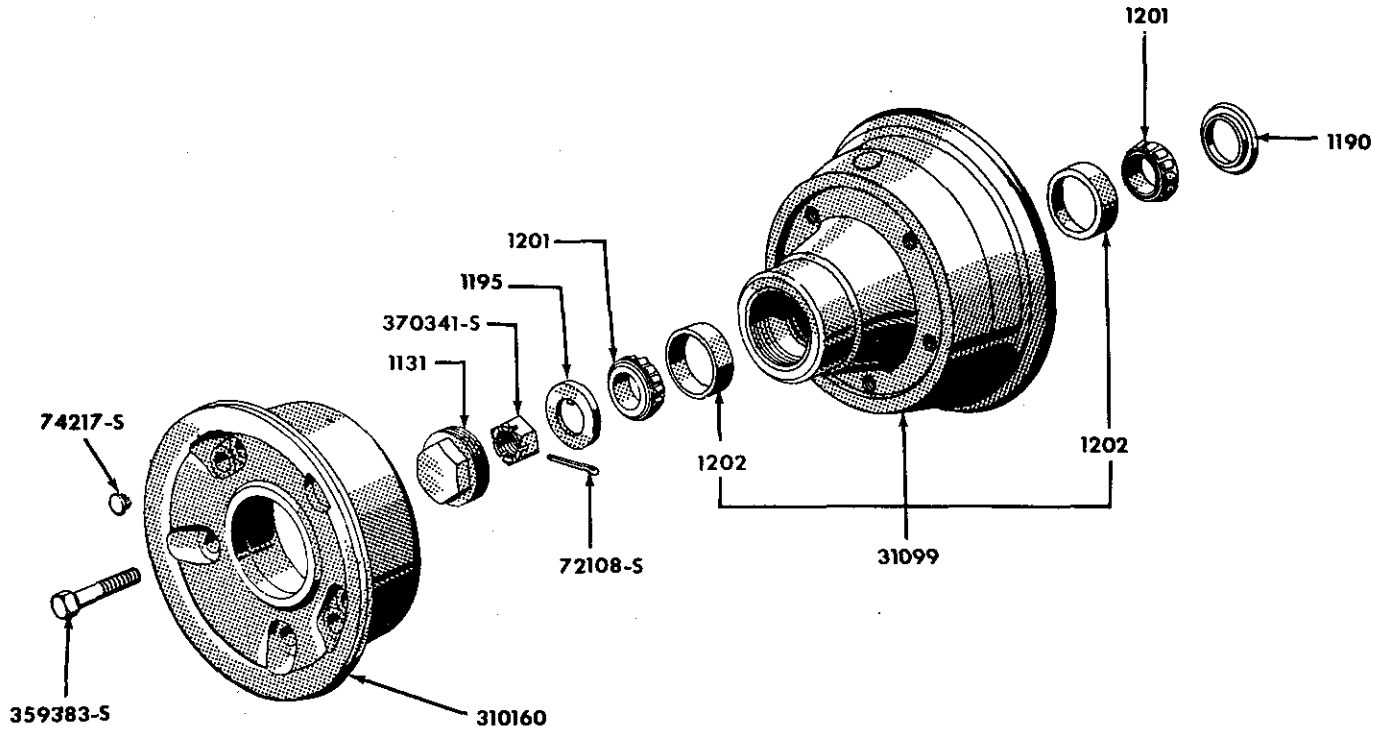

FIG. 1A3 - ROWCROP SINGLE WHEEL 1957/

Basic numbers only shown on illustration. Order by Part Numbers shown in list of parts.

FIG.	PART NO.	PART NAME	NO. REQ.	REMARKS	YEAR
		700, 900			
1A3	* 1201	(310115) Cone & Roller Assy. Frt. Wheel	2		57/
1A3	* 1202	(310116) Cup - Frt. Wheel Brg.	2		57/
1A3	* 1190	(310195) Retainer Assy. - Frt. Hub	1		57/
1A3	NCB-1131-A	Cap - Front Hub	1		57/
1A3	* 1195	(310192) Washer - Frt. Hub Brg. Ret.	1	W/Spindles not having Keyway	57/
1A3	* 1195	(310874) Washer - Frt. Hub Brg. Ret.	1	W/Spindles having Keyway	57/
	310115	Refer to 1201			
	310116	Refer to 1202			
1A3	310160	Flange - Front Wheel	1		57/
		359383-S8B Bolt, 1/2 - 13 x 3.25 (Flange to Disc.) Hex Hd.	5		57/
		74217-S7 Plug, 9/16 Button	2		57/
	310192	Refer to 1195			
	310195	Refer to 1190			
1A3	310199	Disc. Assy. - Front Wheel	1		57/
		72108-S8 Pin 5/32 x 2 Cotter			
		370341-S8 Nut 1-14 (Disc to Spindle) Hex Slotted	1		57/
	310874	Refer to 1195			

*Note - Reference No. only. When ordering parts use part No. shown in brackets opposite reference number.

PARTS TRACTOR CATALOG

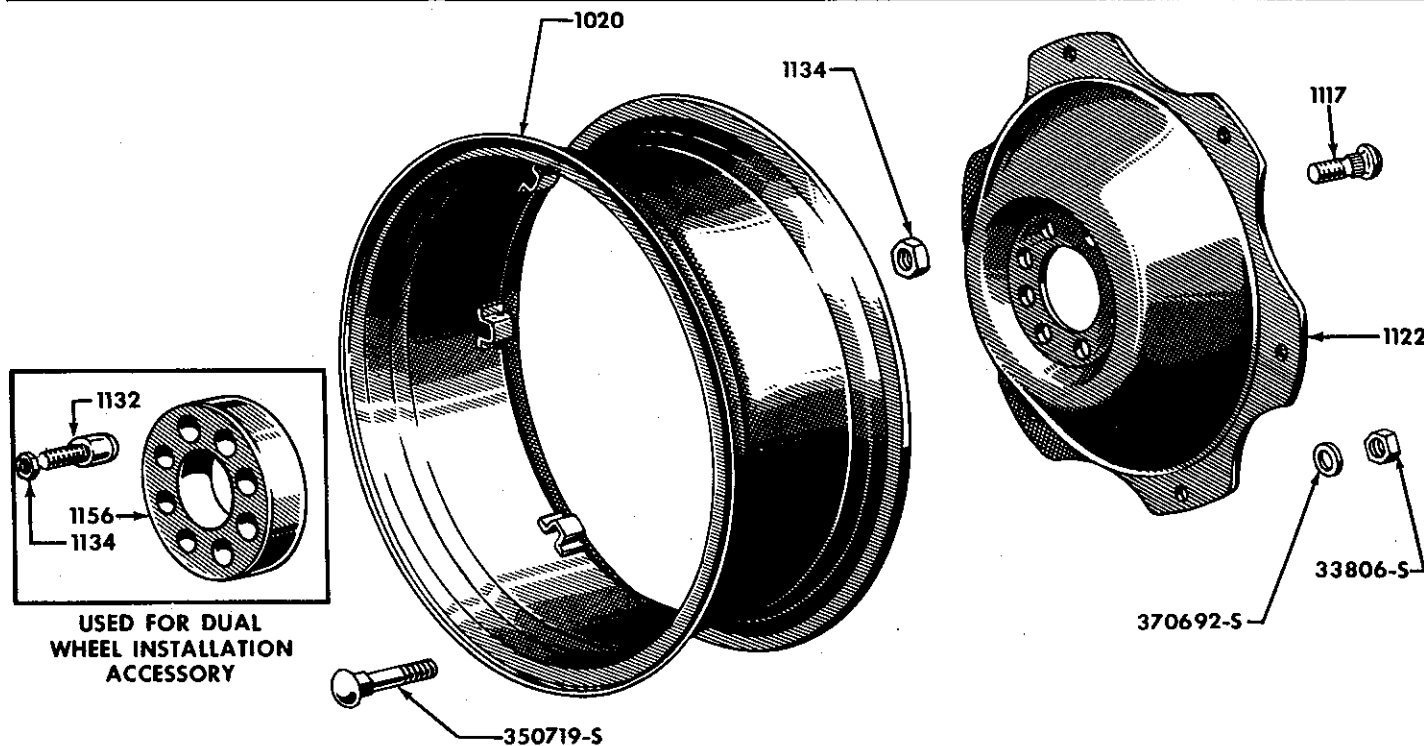

FIG. 1B1 - STANDARD REAR WHEEL

Basic numbers only shown on illustration. Order by Part Numbers shown in list of parts.

FIG.	PART NO.	PART NAME	NO. REQ.	REMARKS	YEAR
		NAA, 501, 600, 700, 800, 900, 1801			
1B1	NCA-1020-B	Rim-Rear Wheel (10" x 28")	2	600, 700, 800, 1801	55/
1B1	NCA-1020-C	Rim-Rear Wheel (9" x 28")	2	NAA, 600, 800, 501	53/
1B1	* 1020	(313197) Rim-Rear Wheel (12" x 28" opt.)	2	1801	58/
1B1	* 1020	(313559) Rim-Rear Wheel (9" x 38")	2	501	59/
		33806-S34 Nut 5/8-18 Hex			
		370692-S34 Washer 5/8 Flat			
		350719-S8 Bolt 5/8-18 x 2.82 (Rim to Disc.) Rd. Hd.	12		53/
		350789-S8 Bolt 5/8-18 x 3.40 (Rim to Disc.) (used w/312223 Disc) Hex Hd.	12	801	58/
	B8NN-1046-A	Bolt - Rear Wheel Weight (used W/312223)	12	801, 1801	59/
1B1	* 1117	(312696) Bolt-Rear Wheel	16		53/
1B1	NCA-1122-A	Disc. Assy.-Rear Wheel	2		
	* 1122	(312223) Disc. Assy.-Rear Wheel (600#) N.S.	2	(801-Order w/Tractor)	58/
1B1	* 1122	(313555) Disc. Assy.-Rear Wheel	2	501	59/
1B1	8N-1134	Nut-Rear Wheel Bolt	16		53/
	* 1134	(312227) Nut-Wheel (used w/350789-S8 Bolt)	12	801	59/
	312223	Refer to 1122			
	312227	Refer to 1134			
	312696	Refer to 1117			
	313197	Refer to 1020			
	313555	Refer to 1122			
	313559	Refer to 1020			

*Note - Reference No. only. When ordering parts use part No. shown in brackets opposite reference number.



PARTS TRACTOR CATALOG

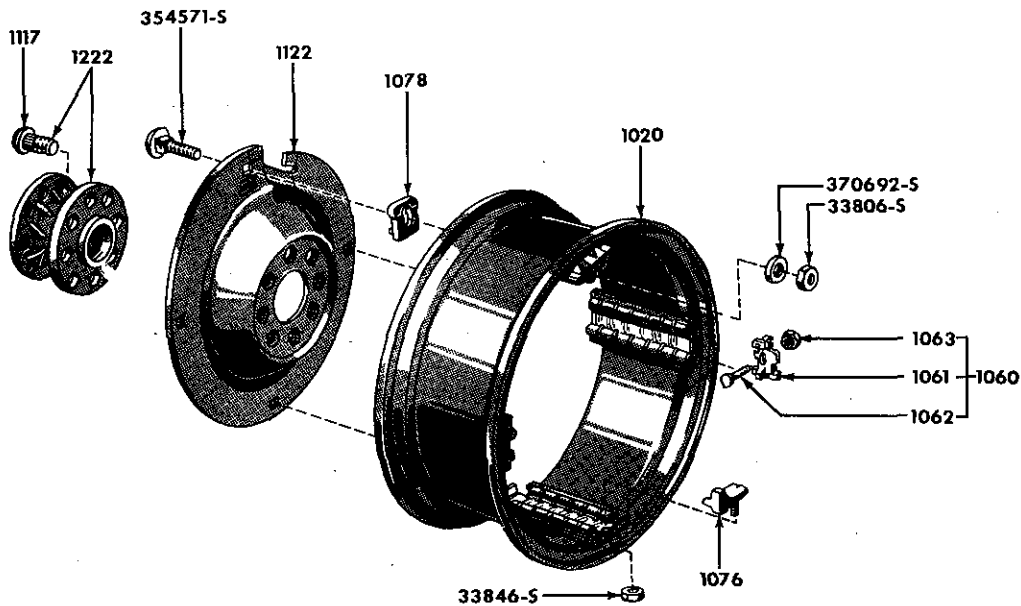

FIG. 1B2 - POWER ADJUSTABLE REAR WHEEL

Basic numbers only shown on illustration. Order by Part Numbers shown in list of parts.

FIG.	PART NO.	PART NAME	NO. REQ.	REMARKS	YEAR
		600, 700, 800, 900			
1B2	NDB-1020-B	Rim-Rear Wheel (11 x 28")	2	except R. C. Hi-Clear	55/
1B2	* 1020	(310715) Rim-Rear Wheel (8" x 42")	2	R. C. Hi-Clear	57/
		33806-S34 Nut 5/8-18 Hex			
		370692-S34 Washer 5/8 Flat			
		354571-S8 Bolt 5/8-18 x 1.75 (Rim & Clamps to Disc.) Carriage	8		55/
1B2	* 1020	(311724) Rim-Rear Wheel (12" x 24")	2	601, 801	58/
		33806-S34 Nut 5/8-18 Hex			
		371619-S8 Bolt 5/8-18 x 2.12 (Rim & Clamps to Disc.) Button Hd.	12	601, 801	58/
1B2	NDB-1060-B	Clamp Assy.-Power Adj. Wheel Rim Adj.	2	except R. C. Hi-Clear	55/
1B2	NDB-1061-A	Clamp-Power Adj. Wheel Rim Adj.	2	except R. C. Hi-Clear	55/
1B2	NDB-1062-A	Bolt-Power Adj. Wheel Rim Adj. Clamp	2	except R. C. Hi-Clear	55/
1B2	NDB-1063-A	Nut-Power Adj. Wheel Rim Adj. Clamp	2	except R. C. Hi-Clear	55/
1B2	NDB-1076-A	Stop-Power Adj. Wheel Rim Outer	2	900, except R. C. Hi-Clear	55/56
1B2	NDB-1076-B	Stop-Power Adj. Wheel Rim Outer	2	except R. C. Hi-Clear	55/
		33846-S8 Nut 1/2-20 (Stop to Guide) Hex	2	except R. C. Hi-Clear	55/
1B2	NDB-1078-A	Clamp-Power Adj. Wheel Rim (Std.)	6	900, except R. C. Hi-Clear	55/56
1B2	NDB-1078-B	Clamp-Power Adj. Wheel Rim (o/s)	AR	900, except R. C. Hi-Clear	55/56
1B2	NDB-1078-C	Clamp-Power Adj. Wheel Rim	6	except R. C. Hi-Clear	55/
1B2	* 1078	(311702) Clamp-Power Adj. Wheel Rim	12	601, 801	58/
1B2	* 1117	(312696) Bolt-Rear Wheel	16	600, 800	55/
1B2	NCA-1122-A	Disc. Assy.-Rear Wheel	2	R. C. Hi-Clear	57/
1B2	NDB-1122-B	Disc Assy.-Rear Wheel	2	except R. C. Hi-Clear	55/
	* 1122	(311701) Disc. Assy.-Rear Wheel	2	601, 801	58/
	8N-1134	Nut-Rear Wheel Bolt	16	600, 800	55/
1B2	* 1222	(312932) Extension Assy.-Rear Axle Shaft	2	600, 800	55/
	310715	Refer to 1020			
	311701	Refer to 1122			
	311702	Refer to 1078			
	311724	Refer to 1020			
	312696	Refer to 1117			
	312932	Refer to 1222			

*Note - Reference No. only. When ordering parts use part No. shown in brackets opposite reference number.

PARTS **TRACTOR** CATALOG

FRONT WHEEL HUBS & BEARINGS
FOR
FORD, FORDSON MAJOR & DEXIA TRACTORS

FRONT WHEEL HUB ASSYS.	INCLUDES BEARING CUPS		MODEL APPLICATION	YEAR RANGE	USES CONE & ROLLER ASSY.	
	INNER	OUTER			INNER	OUTER
9N-1104-A3	B-1202	B-1217	9N, 2N	39/47	B-1201	B-1216
*8N-1104	B-1202	B-1217	8N, NAA	48/54	B-1201	B-1216
*NCA-1104-A	8A-1202-A	8A-1217-A	8N, NAA (To replace 8N-1104) 600, 700, 800, 900 prior to Ser. #137818	48/54 55/57	B-1201 8A-1201-B	B-1216 8A-1216-A
NCA-1104-B	8A-1202-B	8A-1217-B	501, 600, 700, 800, 900 Aft. Ser. #137818	57/	8A-1201-C	8A-1216-B
NCA-1104-C	8A-1202-A	8A-1217-A	8N, NAA (To replace 8N-1104 or NCA-1104A) 600, 700, 800, 900 prior to Serial #137817	48/54 55/57	B-1201 8A-1201-B	B-1216 8A-1216-A
312640	310116	8A-1217-B	601, 801, (Heavy Duty Front End)	58/	310115	8A-1216-B
313020	312518	312548	1801	58/	8L-4221	312520
NONE	310116 (2)		700, 900 (Rowcrop Single Wheel-Except H1-Clearance)	57/	310115 (2)	
E1ADKN-1105	N-1202-A	N-1217	FMD (Except Rowcrop)	52/	E27N-1201	N-1216
19897	N-1202-A	N-1217	FMD Rowcrop	55/	E27N-1201	N-1216
957E-1110	957E-1202-B	204E-1217	Dexia	57/	957E-1201-B	204E-1216

* Hub Assys. 8N-1104 & NCA-1104-A No Longer Supplied - Replaced by NCA-1104-C.
NOTE - Hub Assys. 8N-1104 & NCA-1104-A-B-C- are completely interchangeable Provided Cone & Roller Assys.
are used as specified.



PARTS TRACTOR CATALOG



REAR WHEELS CHART

<u>RIM</u>	<u>ASSEMBLY</u>	<u>DISC</u>	<u>*</u>	<u>REMARKS</u>
8 x 42	310715	NCA-1122-A	C	700, 900, High Clearance
9 x 28	NCA-1020-C	NCA-1122-A	A	9N, 2N, 8N, NAA, 501, 600, 700, 800
9 x 38	313599	313555	C	501, High Clearance
10 x 28	NCA-1020-B	NCA-1122-A	A	9N, 2N, 8N, NAA, 501, 600, 700, 800, 900, 1801
10 x 28	NCA-1020-B	312223	B	801, 1801, 600# Disc - Not Serviced - Available Only As Production Option.
11 x 28	NDB-1020-B	NDB-1122-B	E F	Power Adjusted Wheels. Standard on 900 Series R. P. O. or Accessory for NAA, 600, 700, 800
11 x 38	313953	313555	A	501, High Clearance
12 x 24	311724	311701	D	NAA, 600, 800, 1801
12 x 28	313197	NCA-1122-A	A	800, 1801

* Required Related Parts

	<u>A</u>	<u>B</u>	<u>C</u>	<u>D</u>	<u>E</u>	<u>F</u>	
B8NN-1046-A Bolt, Rim to Disc		12		-			
NDB-1060-B Clamp Assy.					2	2	
NDB-1076-B Stop					2	2	
NDB-1078-C Clamp					6	6	
8N-1134 Nut, Rear Wheel Bolt	16	16	16	16	16	32%	
NCA-1222-A Extension Assy.						2%	% Required Only on NAA, 600, 800
311702 Clamp				12			
33806-S34 Nut, Rim to Disc	12	12	12	12	8	8	
33846-S8 Nut, Stop to Rim					2	2	
45811-S8 Nut, Rim to Disc			12				
350719-S8 Bolt, Rim to Disc	12						
370692-S34 Washer, Rim to Disc					8	8	
371619-S8 Bolt, Rim to Disc				12			

SECTION NO. 2

BRAKES

<u>DESCRIPTION</u>	<u>PAGE NO.</u>
Brakes and Related Parts (NAA)	2-2
Brakes and Related Parts (501, 600, 700, 800, 900, 1801)	2-3
Brake and Clutch Controls (NAA, 600, 700, 800, 900, 1801)	2-5
Brake and Clutch Controls (501)	2-9



PARTS TRACTOR CATALOG

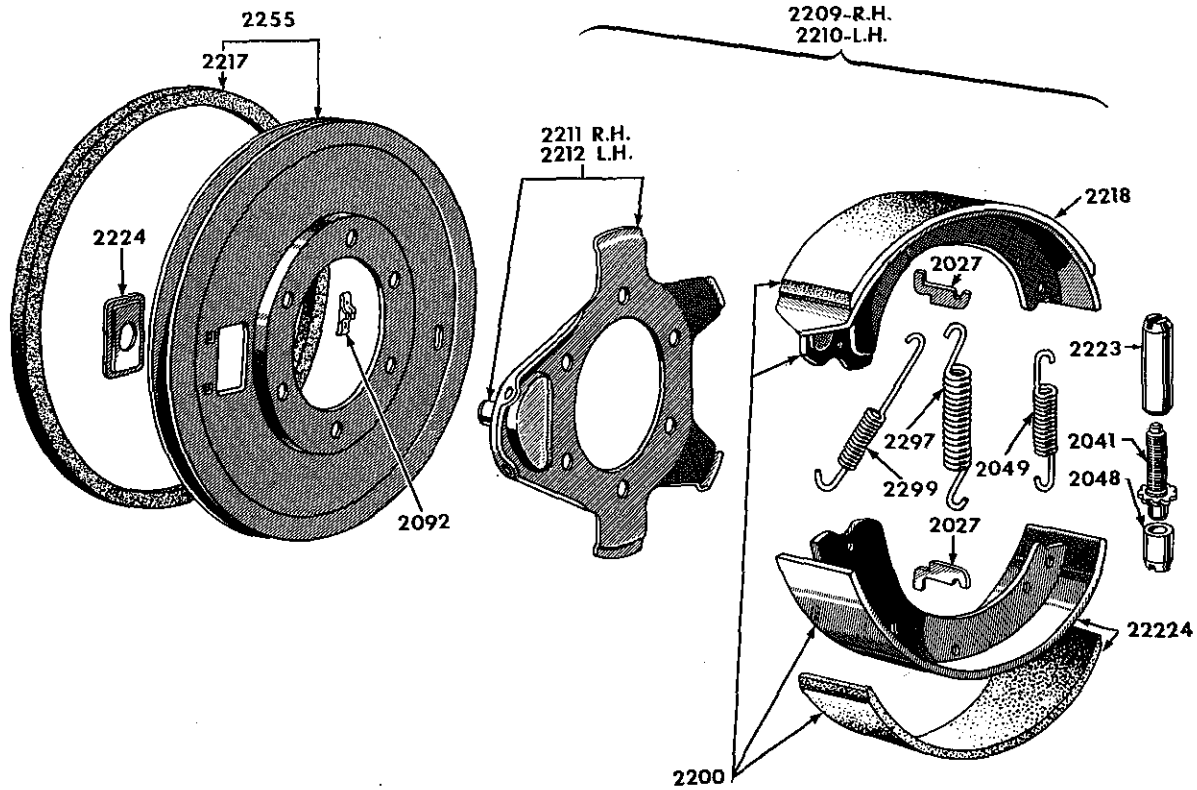

FIG. 2A1 - BRAKES & RELATED PARTS 1953/54

Basic numbers only shown on illustration. Order by Part Numbers shown in list of parts.

FIG.	PART NO.	PART NAME	NO. REQ.	REMARKS	YEAR
		NAA			
2A1	8N-2027-B	Anchor-Brake Shoe Return Spring	4		53/54
2A1	H-2041	Screw-Brake Adjusting	2		53/54
2A1	8N-2048	Socket-Brake Adjusting Screw	2		53/54
2A1	8M-2049	Spring-Brake Shoe Adjusting Screw	2		53/54
2A1	H-2092	Cover-Brake Adjusting Hole	2		53/54
2A1	8N-2200-B	Kit-Brake Shoe & Lining	2		53/54
		Consists of the following-			
		(1) 8N-2218-B Shoe & Lining			
		(1) 8N-2224-B Shoe & Lining			
2A1	8N-2212-B	Plate Assy. -Brake Backing	2		53/54
2A1	8N-2217	Seal-Brake Dust	2		53/54
2A1	8N-2218-B	Shoe & Lining Assy.-Brake (R. H. Upper & L. H. Lower)	2		53/54
2A1	8N-2223	Nut-Brake Adjusting Screw	2		53/54
2A1	8N-2224	Cover-Brake Camshaft Hole	2		53/54
2A1	8N-2255	Shield Assy. -Brake Dust	2		53/54
2A1	8N-2297-B	Spring-Brake Shoe Retracting	2		53/54
2A1	8N-2299	Spring-Brake Shoe Secondary (L. H. Brake Only)	1		53/54
2A1	8N-2224-B	Shoe & Lining Assy. -Brake (L. H. Upper & R. H. Lower)	2		53/54

PARTS TRACTOR CATALOG

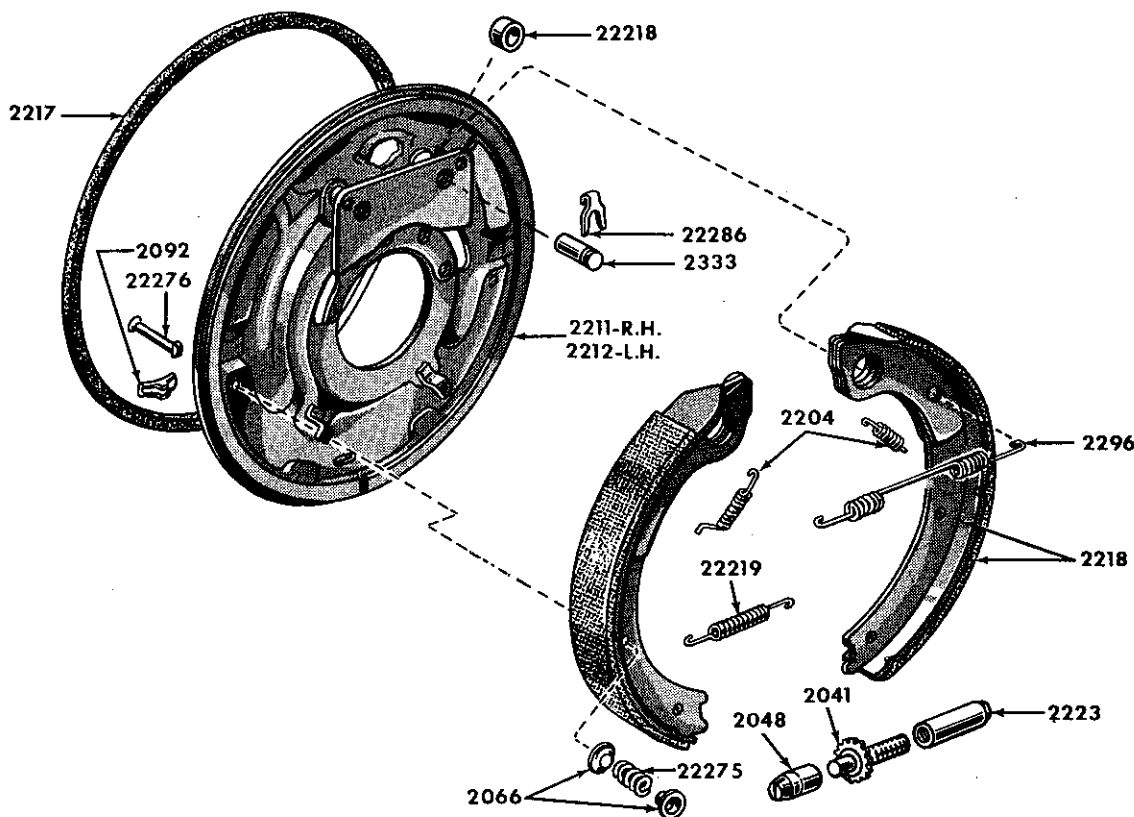

FIG. 2A2 - BRAKES & RELATED PARTS 1955/

Basic numbers only shown on illustration. Order by Part Numbers shown in list of parts.

FIG.	PART NO.	PART NAME	NO. REQ.	REMARKS	YEAR
		501, 600, 700, 800, 900, 1801			
2A2	H-2041	Screw-Brake Adjusting	2		55/
2A2	8N-2048	Socket-Brake Adjusting Screw	2		55/
2A2	6H-2066	Cup-Brake Shoe Hold Down Spring	8		55/
2A2	H-2092	Cover-Brake Adjusting Hole	2		55/
2A2	NCA-2204-A	Spring-Brake Shoe Return (R. H. Brake)	2		55/
2A2		Spring-Brake Shoe Return (L. H. Brake)	1		55/
2A2	* 2211	(312380) Plate Assy. -Brake Backing R. H.	1		55/
2A2	* 2212	(312381) Plate Assy. -Brake Backing L. H.	1		55/
2A2	NCA-2217-A	Seal-Brake Dust	2		55/
2A2	NCA-2218-A	Shoe & Lining Assy. -Brake	4		55/
2A2	8N-2223	Nut-Brake Adjusting Screw	2		55/
2A2	NCA-2296-B	Spring-Brake Shoe Retracting	2		55/
2A2	NCA-2333-A	Pin-Brake Shoe Anchor	4		55/
2A2	NCA-22218-A	Collar-Brake Shoe Anchor Pin	4		55/
2A2	NCA-22219-A	Spring-Brake Shoe Adjusting Screw	2		55/
2A2	NCA-22275-A	Spring-Brake Shoe Hold Down	4		55/
2A2	NCA-22276-A	Pin-Brake Shoe Hold Down Spring	4		55/
2A2	NCA-22286-A	Retainer-Brake Anchor Pin	4		55/
	312380	Refer to 2211			
	312381	Refer to 2212			

*Note - Reference No. only. When ordering parts use part No. shown in brackets opposite reference number.

PARTS **TRACTOR** CATALOG

FIG.	PART NO.	PART NAME	NO. REQ.	REMARKS	YEAR
BRAKE & CLUTCH CONTROLS					
		NAA, 600, 700, 800, 900, 1801			
2B1	8N-2224	Cover - Brake Camshaft Hole	2	NAA	53/54
2B1	NCA-2224-A	Cover - Brake Camshaft Hole	2	Except NAA	55/
2B1	8N-2246	Camshaft - Brake Actuating R. H.	1	NAA	53/54
2B1	NCA-2246-A	Camshaft - Brake Actuating R. H.	1	600, 800, 1801	55/
2B1	NCB-2246-A	Camshaft - Brake Actuating R. H.	1	700, 900	55/
2B1	8N-2247	Camshaft - Brake Actuating L. H.	1	NAA	53/54
2B1	NCA-2247-A	Camshaft - Brake Actuating L. H.	1	600, 800, 1801	55/
2B1	NCB-2247-A	Camshaft - Brake Actuating L. H.	1	700, 900	55/
2B1	NAA-2315-A	Lever - Brake Camshaft L. H.	1	NAA	53/54
2B1	NCA-2315-A	Lever - Brake Camshaft L. H.	1	Except NAA	55/
		74156-S Key 1/4 x 1-1/8 (Lever to Camshaft) Woodruff	1	NAA	53/54
		74181-S Key 1/4 x 7/8 (Lever to Camshaft) Woodruff	1	Except NAA	55/
		34808-S7 Washer 7/16 Lock			
		20894-S8 Bolt 7/16-20 x 1.68 (Camshaft to Lever) Hex Hd.	1		53/
		72035-S8 Pin 1/8 x 1 Cotter			
		73951-S8 Pin 1/2 x 1-3/8 (Lever to Pawl) Clevis	1		53/
2B1	8N-2322	Spring - Brake Camshaft Hole Cover	2		53/
2B1	8N-2324	Arm - Brake Pawl	1	NAA	53/54
2B1	NCA-2324-A	Arm - Brake Pawl	1	Except NAA	55/
		34808-S7 Washer 7/16 Lock			
		20894-S8 Bolt 7/16-20 x 1.68 (Pawl Arm) Hex Hd.	1		53/
		74156-S Key 1/4 x 1-1/8 (Arm to Camshaft) Woodruff	1	NAA	53/54
		74181-S Key 1/4 x 7/8 (Arm to Camshaft) Woodruff	1	Except NAA	55/
		72035-S8 Pin 1/8 x 1 Cotter			
		73951-S8 Pin 1/2 x 1-3/8 (Arm to Pawl) Clevis	1		53/
2B1	NCA-2453-A	Pedal - Brake R. H.	1	600, 800	55/
2B1	NCB-2453-A	Pedal - Brake R. H.	1	700, 900	55/
2B1	* 2453	(313554) Pedal - Brake R. H.	1	1801	58/
2B1	8N-2455	Pedal - Brake R. H.	1	NAA	53/54
		34808-S7 Washer 7/16 Lock			
		20894-S8 Bolt 7/16-20 x 1.68 (R. H. Pedal to Brake Camshaft) Hex Hd.	1		53/
		74156-S Key 1/4 x 1-1/8 (R. H. Pedal to Camshaft) Woodruff	1	NAA	53/54
		74181-S Key 1/4 x 7/8 (R. H. Pedal to Camshaft) Woodruff	1	Except NAA	55/
2B1	8N-2456-A	Pedal - Brake L. H.	1	NAA	53/54
2B1	NCA-2456-B	Pedal - Brake L. H. (Prior to Ser. #14257)	1	Except NAA	55/58
2B1	* 2456	(310535) Pedal - Brake L. H. (After Ser. #14256)	1	Except NAA	58/
		34808-S7 Washer 7/16 Lock			
		20894-S8 Bolt 7/16-20 x 1.68 (L. H. Pedal to Brake Cross Shaft) Hex Hd.	1		53/58
		359453-S8B Bolt 7/16-20 x 2.00 (L. H. Pedal to Pedal Shaft Assy.) sq. Hd. Shoulder	1	Except NAA	58/
		74156-S Key 1/4 x 1-1/8 (L. H. Pedal to Cross Shaft) Woodruff	1	NAA, 620, 630, 640, 740	53/
		74181-S Key 1/4 x 7/8 (L. H. Pedal to Cross Shaft) Woodruff	1	650, 660, 800, 900, 1801	55/
		34671-S8 Nut 7/16-20 Hex	1		53/

*Note - Reference No. only. When ordering parts use part No. shown
in brackets opposite reference number.



PARTS TRACTOR CATALOG



FIG.	PART NO.	PART NAME	NO. REQ.	REMARKS	YEAR
BRAKE & CLUTCH CONTROLS					
2B1	NCA-2458-A	Shaft - Brake Pedal Cross - Except Diesel	1	4 Speed Trans. Prior to Ser. #14257	53/58
2B1	NDA-2458-A	Shaft - Brake Pedal Cross - Except Diesel	1	5 Speed Trans. Prior to Ser. #14257	55/58
2B1	* 2458	(310820) Shaft - Brake Pedal Cross	1	After Ser. #14256	58/
2B1	8N-2465	Rod Assy. - Brake Control	1	NAA	53/54
2B1	NCA-2465-A	Rod Assy. - Brake Control - Except Diesel	1	600, 800 Prior to Ser. #14257	55/58
2B1	NCB-2465-A	Rod Assy. - Brake Control - Except Diesel	1	700, 900 Prior to Ser. #14257	55/58
2B1	* 2465	(310537) Rod Assy. - Brake Control	1	601, 801, 1801 After Ser. #14256	58/
2B1	* 2465	(310539) Rod Assy. - Brake Control	1	701, 901 After Ser. #14256	58/
		33925-S8 Nut 3/8-24 Hex	1		53/
		97013-S Clevis 3/8 x 2-1/2 Adj.	1		53/
		72010-S8 Pin 1/8 x 5/8 Cotter	2		53/
		73919-S8 Pin 3/8 x 1-1/8 (Brake Rod Assy.) Clevis	2		53/
	78-2477	Bushing - Brake Camshaft	2		53/
2B1	NCA-2634-A	Spring - Parking Brake Pawl Control Rod	2	Except NAA, 1801	57/
	* 2634	(312821) Spring - Parking Brake Pawl Control Rod Upper	2	1801	58/
	* 2634	(312822) Spring - Parking Brake Pawl Control Rod Lower	2	1801	58/
		44719-S8 Washer 1/4 (Spring Seat) Flat	4	Except NAA, 1801	57/
		44719-S8 Washer 1/4 (Spring Seat) Flat	8	1801	58/
2B1	NAA-2782-A	Lever - Parking Brake	2	Except 1801	53/56
2B1	8N-2796	Sector - Brake Pawl L. H.	1	NAA	53/54
2B1	NAA-2796-A	Sector - Brake Pawl R. H.	1	NAA	53/54
2B1	NCA-2796-B	Sector - Brake Pawl - used w/NCA-22785-B	2	600	57/
2B1	NCB-2796-A	Sector - Brake Pawl - used w/NCA-22785-A	2	700, 900	55/56
2B1	NCB-2796-B	Sector - Brake Pawl - used w/NCA-22785-B	2	700, 900	57/
2B1	NDA-2796-B	Sector - Brake Pawl - used w/NCA-22785-B	2	800, 1801	57/
2B1	8N-7508-B	Bushing - Clutch Pedal - 4 Speed Trans.	1	Except 1801	53/58
2B1	B-7510-A2	Shaft - Clutch Release - 4 Speed Trans.	1	Prior to Ser. #14257	53/58
2B1	NDA-7510-B	Shaft - Clutch Release - 5 Speed Trans.	1	Prior to Ser. #14257	55/58
2B1	* 7510	(311246) Shaft - Clutch Release - 5 Speed Trans.	1	After Ser. #14256	58/
2B1	* 7510	(311332) Shaft - Clutch Release - 4 Speed Trans.	1	After Ser. #14256	58/
		33924-S8 Nut 3/8-16 Hex Jam			
		91229-S8 Screw 3/8-16 x 1-1/4 (used w/NDA-7510-A & 311246) Sq. Hd. Set.	1	Except NAA	55/
		91249-S8 Screw 3/8-16 x 1-1/2 (used w/NDA-7510-B) Sq. Hd. Set.	1	5 Speed Trans.	55/58
2B1	8N-7511-B	Arm - Clutch Release Shaft	1	4 Speed Trans.	53/
		352581-S8 Pin 5/16 x 1-1/2 (Clutch Release Arm to Shaft) Flat Hd.	1		53/
2B1	48-7515	Fork - Clutch Release Shaft - 4 Speed Trans.	1		53/
2B1	NDA-7515-B	Fork - Clutch Release Shaft - 5 Speed Trans.	1	Prior to Ser. #14257	55/58
2B1	* 7515	(311649) Fork - Clutch Release Shaft - 5 Speed Trans.	1	After Ser. #14256	58/
		352581-S8 Pin 5/16 x 1-1/2 (Fork to Clutch Release Shaft) Flat Hd.	1	4 Speed Trans.	53/
		352611-S Pin 3/8 x 1-7/8 (Fork to Clutch Release Shaft) Flat Hd.	1	5 Speed Trans.	55/58
		34420-S8 Nut 3/8-24 Hex			
		304846-S8 Bolt 3/8-24 x 2.12 (Fork to Shaft) Hex Hd.	1	5 Speed Trans.	58/

*Note - Reference No. only. When ordering parts use part No. shown in brackets opposite reference number.

PARTS **TRACTOR** CATALOG

FIG.	PART NO.	PART NAME	NO. REQ.	REMARKS	YEAR
BRAKE & CLUTCH CONTROLS					
2B1	NAA-7519-B	Pedal Assy. - Clutch - 4 Speed Trans.	1		53/58
2B1	NDA-7519-B	Pedal Assy. - Clutch - 5 Speed Trans.	1		55/
		4 Speed Trans.	1		58/
		33792-S8 Nut 7/16-20 Hex			
		355584-S8 Eye Bolt 7/16-20 x 2.68 (Pedal Assy. to Clutch Release Shaft)	1		53/58
		72035-S7 Pin 1/8 x 1.00 Cotter			
		73941-S8 Pin 3/8 x 1-5/16 (Pedal Assy. to Eye Bolt) Clevis	1		53/58
		87916-S8 Fitting 1/8-35° Angle (Clutch Pedal Assy.) Lubrication	1		53/
		352619-S8 Washer .880/.890 I.D. x 1.50 O.D. (Clutch Pedal to Shaft) 5 Speed	1		55/
		4 Speed	1		58/
2B1	NDA-7526-A	Bushing - Clutch Pedal - 5 Speed Trans.	1		55/
		4 Speed Trans.	1		58/
2B1	8N-7533	Pin - Clutch Release Shaft Arm	1	4 Speed Trans.	53/
2B1	8M-9825	Clip - Parking Brake Pawl Control Rod	2	Except NAA	57/
2B1	NCA-22071-A	Lever - Parking Brake - R. H.	1	Except NAA	57/
2B1	NCA-22072-A	Lever - Parking Brake - L. H.	1	Except NAA	57/
2B1	NCA-22073-A	Guide - Parking Brake Control Rod	2	Except NAA, 1801	57/
2B1	* 22073	(312817) Guide - Parking Brake Control Rod	2	1801	58/
2B1	NCB-22079-A	Rod - Parking Brake Pawl Control - R. H.	1	Utility Except NAA, 1801	57/
2B1	NCB-22079-B	Rod - Parking Brake Pawl Control - R. H.	1	600, 800 except utility	57/
2B1	* 22079	(312819) Rod - Parking Brake Pawl Control - R. H.	1	1801	58/
2B1	NCB-22080-A	Rod - Parking Brake Pawl Control - L. H.	1	Utility except NAA, 1801	57/
2B1	NCB-22080-B	Rod - Parking Brake Pawl Control - L. H.	1	600, 800 except utility	57/
2B1	* 22080	(312818) Rod - Parking Brake Pawl Control - L. H.	1	1801	58/
2B1	NAA-22785-B	Pawl - Brake	2	NAA	53/54
2B1	NCA-22785-A	Pawl - Brake	2	Except NAA, 1801	55/56
2B1	NCA-22785-B	Pawl - Brake	2	Except NAA	57/
		72255-S8 Pin 3/16 x 1.00 (Pawl & Parking Brake Lever to Camshaft Lever & Pawl Arm) Groove	2		53/
	310535	Refer to 2456			
	310537	Refer to 2465			
	310539	Refer to 2465			
	310820	Refer to 2458			
	311246	Refer to 7510			
	311332	Refer to 7510			
	311649	Refer to 7515			
	312817	Refer to 22073			
	312818	Refer to 22080			
	312819	Refer to 22079			
	312820	Handle - Parking Brake Pawl Control Rod L. H.	1	1801	58/
	312821	Refer to 2634			
	312822	Refer to 2634			
	312886	Handle - Parking Brake Pawl Control Rod - R. H.	1	1801	58/
	313554	Refer to 2453			

*Note - Reference No. only. When ordering parts use part No. shown in brackets opposite reference number.



PARTS TRACTOR CATALOG

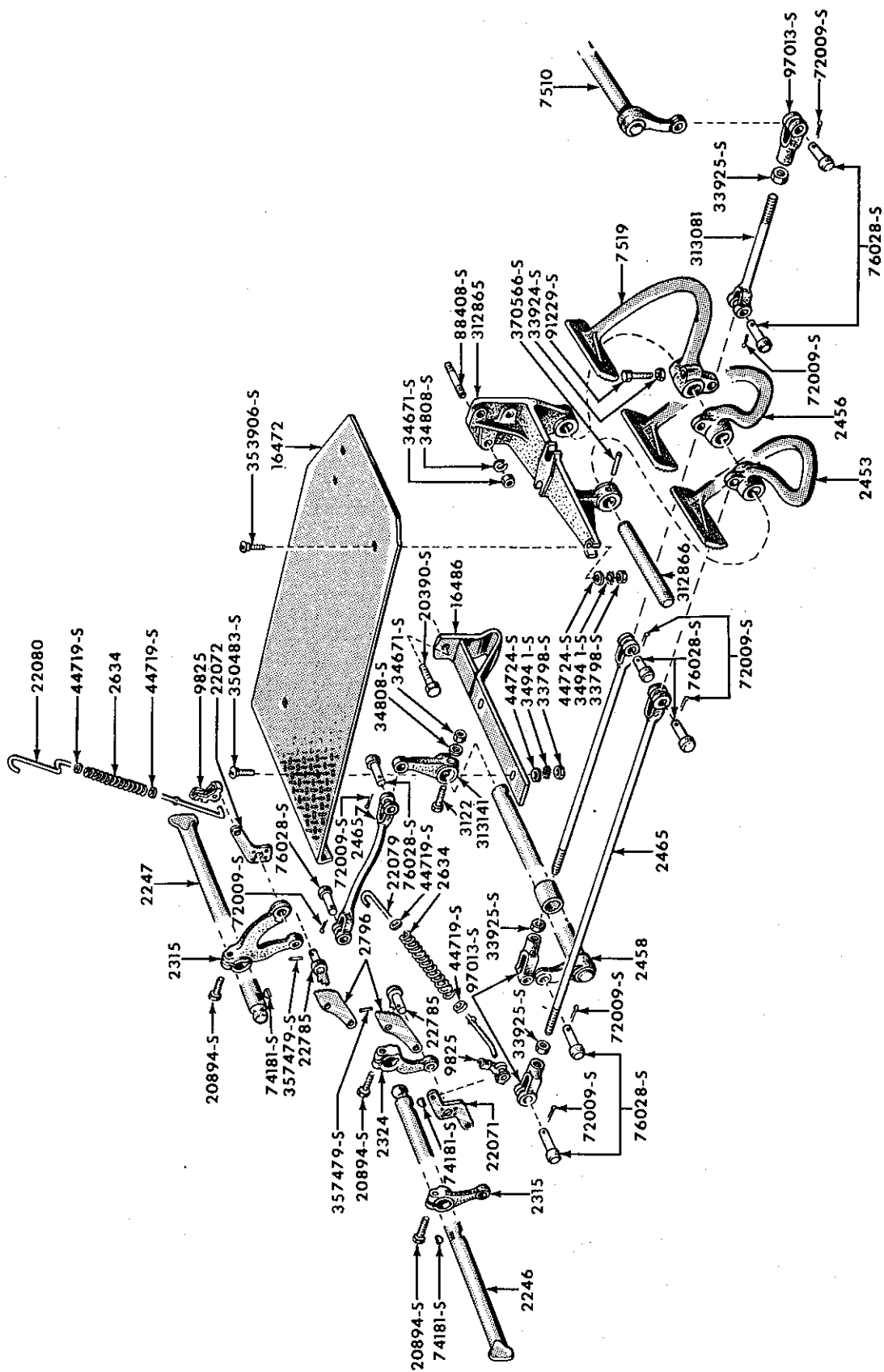

FIG. 2B2 - BRAKE & CLUTCH CONTROLS
Basic numbers only shown on illustration. Order by Part Numbers shown in list of parts.