

# Fiat Connect Newbravo Blue Me Guide

Full download: <http://manualplace.com/download/fiat-connect-newbravo-blue-me-guide/>

V O



C O N N E C T N a v +

This is the cut pages sample. Download all 166 page(s) at: [ManualPlace.com](http://ManualPlace.com)

**T**he car is fitted with the infotelematic CONNECT system designed in accordance with the specific features of the passenger compartment and with a personalised design that blends with the styling of the dashboard.

**T**he system is installed in a user-friendly position for the driver and the graphics on the front panel make it easy to quickly locate the controls which facilitates the use of them.

**T**o increase safety against theft, the set is fitted with a protection system that allows the use of it only on the car on which it was fitted originally.

**T**he pages that follow contain the instructions for use, which we advise you to read carefully and always keep within reach (e.g. in the glove compartment).

**S**o, enjoy your reading and have a good journey.

**IMPORTANT** For the navigation system only use the original CD provided with the car or in any case other CDs of the same brand.



# CONNECT Nav+

<b>ADVICE, CONTROLS AND GENERAL INFORMATION ...</b>	5	Compression function .....	39
ADVICE .....	5	CD setup function .....	39
<b>CONTROLS</b> .....	10	Audio setup function .....	42
Front panel controls .....	10	CD-CHANGER MODE .....	42
Steering wheel controls .....	14	Shuffle function .....	44
<b>GENERAL INFORMATION</b> .....	15	Prog function .....	45
System power on .....	16	Scan function .....	45
System power off .....	17	Compression function .....	45
Main mode .....	18	CDC setup function .....	45
Protection against theft .....	19	Audio setup function .....	47
<b>AUDIO</b> .....	21	MP3 MODE .....	47
<b>SCREEN OPTIONS AND FUNCTIONS</b> .....	21	Main screen options and functions.....	49
<b>RADIO MODE</b> .....	22	Audio setup function .....	50
Traffic information .....	24	Direct selection function .....	50
Seeking alternative frequencies .....	26	Define Playlist function .....	50
“Frequency” function .....	26	Playlist function .....	50
Autostore function .....	27	Compression function .....	51
Band Scan function .....	28	Scan function .....	51
Preset Scan function .....	28	Shuffle function .....	51
Radio setup function .....	29	Playing the Playlist .....	52
LOC/DX function .....	29	Playing MP3 CD .....	53
Mono/Stereo function .....	29	Define Playlist function .....	54
PTY-Prog. Type function .....	30	<b>CELLULAR TELEPHONE WITH VOICE COMMANDS</b> ...	60
RDS function .....	31	<b>GENERAL INFORMATION</b> .....	60
Regional function .....	31	<b>PRELIMINARY OPERATIONS</b> .....	61
Audio setup function .....	32	Entering and exiting the telephone mode .....	61
Bass .....	33	Inserting the telephone card .....	63
Treble .....	33	Entering the PIN code .....	64
Balance/Fader function .....	33	<b>INCOMING CALLS</b> .....	65
Loudness .....	33	<b>OUTGOING CALLS</b> .....	65
Equalizer .....	34	<b>DIALLING A SERVICE NUMBER</b> .....	66
Auto Vol. Cont. function .....	35	Frequent Numbers function .....	67
<b>CD MODE</b> .....	37	Ph/Book function .....	68
Shuffle function .....	38	Message function.....	75
Scan function .....	39	<b>LAST CALL</b> function .....	79

Incoming calls function .....	79	Trip time .....	118
Outgoing calls function .....	80	Distance traveled .....	118
Memo function .....	81	Average speed .....	118
WAP function .....	82	Average consumption .....	118
Settings function .....	87	Trip: speed .....	118
Options function .....	88	Trip: MY CAR .....	119
		Trip: info .....	121
		Trip: reset .....	123
<b>NAVIGATOR</b> .....	92	<b>VOICE RECOGNITION</b> .....	124
GENERAL INFORMATION .....	92	GENERAL INFORMATION .....	124
SCREEN OPTIONS AND FUNCTIONS .....	93	VOICE COMMANDS .....	125
GRAPHIC INSTRUCTIONS .....	94	Keywords .....	125
VOICE INSTRUCTIONS .....	94	Examples (voice commands) .....	132
NAVIGATION CD-ROM PLAYER .....	95		
MAIN SCREEN .....	96	<b>INFORMATION AND ASSISTANCE SERVICES (SOS)</b> .....	141
OTHER MENUS .....	99	Medical advice function .....	141
SELECT ADDRESS .....	99	Roadside assist. function .....	142
Address .....	100	Personal number function .....	142
Points of interest .....	103	Emergency 112 function .....	142
Last destinations .....	105	Phone settings function .....	143
Bookmarks.....	105	Calls for medical advice or roadside assistance .....	144
RDS-TMC .....	106	bCONNECT Infomobility services .....	145
Dest 1 – Dest 2 .....	108		
VISUALIZATION .....	109	<b>MY CAR</b> .....	148
DELETE DESTINATION .....	109	LANGUAGE .....	149
VOICE BOOKMARKS .....	111	DATE & TIME .....	150
MAP PREFERENCES .....	113	VEHICLE .....	152
ROUTE OPTIONS .....	115	SYSTEM (programming) .....	156
		Instrument panel .....	156
<b>ON-BOARD COMPUTER (TRIP)</b> .....	116	Video .....	157
GENERAL INFORMATION .....	116	Power OFF .....	157
GENERAL TRIP and TRIP B function .....	116		
ETA (Estimated Time of Arrival) .....	117	<b>FAULTS</b> .....	159
Distance to destination .....	117	Internal faults .....	159
Speed limit .....	117	Overtemperature faults .....	159
Km/miles to empty .....	117		
Instant consumption .....	118		

# ADVICE, CONTROLS AND GENERAL INFORMATION

## ADVICE

### ROAD SAFETY

You are recommended to learn how to use the different functions of the CONNECT Nav+ and in particular of the radio (e.g. storing stations) before starting to drive.



#### WARNING

*Too high a volume when driving can put the driver's life at risk and that of other people. Therefore the volume should always be adjusted in such a way that it is always possible to hear the noises of the surrounding environment (e.g. horns, ambulance, police sirens, etc.).*

### RECEPTION CONDITIONS

Reception conditions change constantly when driving. Reception can be disturbed by the presence of mountains, buildings, bridges particularly when far away from the broadcaster received.

**IMPORTANT** When receiving traffic information the volume might be higher than normal.

### CARE AND MAINTENANCE

The structure of the CONNECT Nav+ ensures long years of operation with no need for particular maintenance. In the event of a fault, contact **Fiat Dealership**.

Some care must however be taken to ensure the complete efficiency of the CONNECT Nav+:

- the monitor is sensitive to scratching, liquid detergents and UV rays;
- liquids that penetrate inside may damage the device irreparably.

Clean the front panel and display only using a soft, dry antistatic cloth. Cleaning and polishing products may damage the surface.



***Be careful not to knock the display with pointed or hard objects and avoid touching with the hands. Do not press on the display when cleaning.***

## IMPORTANT NOTES

- In the event of a fault the CONNECT Nav+ should be checked and repaired only at **Fiat Dealership**.
- In case of particularly low temperatures the display might take a certain time to reach the optimum brightness.
- In the case of prolonged parking with high outside temperature, the automatic thermal protection of the system may come into action suspending operation until the passenger compartment temperature falls to acceptable levels.

## COMPACT DISC

If a Compact Disc is used on the sound system, remember that the presence of dirt or marks on Compact Discs may cause skipping when playing and poor sound quality. The same happens if Compact Discs are bent by accident.

**IMPORTANT** Never use 8 cm audio or MP3 CDs, even with the special adapter, since this format damages the system.

To obtain optimum playing conditions we give the following advice:

- Only use Audio Compact Discs with the brand:



- Carefully clean all Compact Discs of any fingerprints and dust using a soft cloth. Support Compact Discs on the edges and clean from the centre outwards.

– Never use chemical products for cleaning (e.g. spray cans, antistatics or thinners) as they might damage the surface of Compact Discs.

– After listening to them put Compact Discs back in their boxes to avoid marking or scoring which could cause skipping when playing.

– Do not expose Compact Discs to direct sunlight, high temperatures or damp for prolonged lengths of time to prevent them from bending.

– Do not stick labels or write on the recorded surface of Compact Discs.

To remove a Compact Disc from its container, press on the centre and raise the disc holding carefully from the edges.

Always hold a Compact Disc by the edge. Never touch the surface.

To remove fingerprints and dust, use a soft cloth starting from the centre of the Compact Disc towards the circumference.

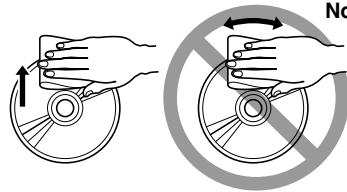

New discs may be rough around the edges. When using these discs the player might not work or the sound might skip. To remove roughness from the edge of a disc use a ball-point pen, etc.

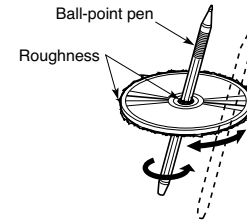

Removing the disc

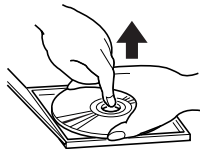

Proper way to hold the compact disc



**IMPORTANT** Do not use the protective sheets for CDs in commerce or discs with stabilisers, etc. as they might get stuck in the internal mechanism and damage the disc.



**IMPORTANT** Should copy-protected CDs be used, then, few seconds may be required before the system starts to play them. Moreover, due to the proliferation of always new and different protection methods, it is not guaranteed that the CD player can play whatever protected disc. Copy protection is often indicated on the CD cover in small letters or hard to read characters. Usually it is indicated by writings like: “COPY CONTROL”, “COPY PROTECTED”, “THIS CD CANNOT BE PLAYED ON A PC/MAC”, or it is identified by symbols like:



Protected discs (and their cover) very often are not marked with the audio CD identification symbol:

COMPACT  
**disc**  
DIGITAL AUDIO

## Notes about Compact Discs

Do not stick labels on the surfaces of a Compact Disc or write on the surface with pens or pencils.

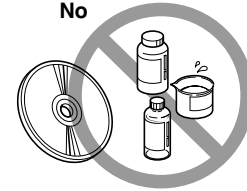
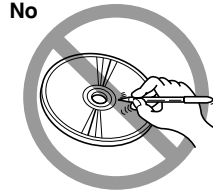

Do not use solvents such as stain removers, antistatic sprays or thinners in commerce for cleaning Compact Discs.

Do not use highly scratched, cracked or distorted Compact Discs. This could damage the player or prevent it from working properly.

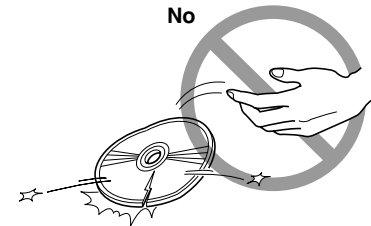

Do not expose Compact Discs to direct sunlight or any other source of heat.

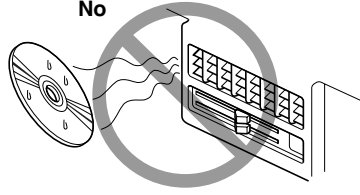

## GENERAL INFORMATION

The CONNECT Nav+ controls and provides information for the following systems and functions:

- GPS (Global Positioning System) based navigation;
- Sound system with RDS (Radio Data System) radio, MP3, CD and CD Changer;
- GSM (Global System for Mobile Communication) based telephone with WAP and SOS-call (emergency call) functions;
- Voice recognition (VR module) with voice synthesis and voice memo.

The CONNECT Nav+ system mainly consists of the following:

- a keypad consisting of 28 push-buttons and 2 knobs;
- controls on steering wheel (8 push-buttons + 1 encoder)
- electronics boxed in a properly housing located inside the dashboard.

The interface is the multifunction information display for all the integrated components.

## Multifunction information display

The system uses a graphic 6,5" 16/9 LCD 256-colour TFT display with a resolution of 400 x 240 pixels.

The display brightness can be changed depending on the environment conditions and the driver's requirements, storing two settings, day and night, which are automatically set to correspond with the turning on/off of the external lights, if this has been set in MY CAR menu.