

545, 545H

(DIESEL)

WHEEL LOADER

Parts Catalog

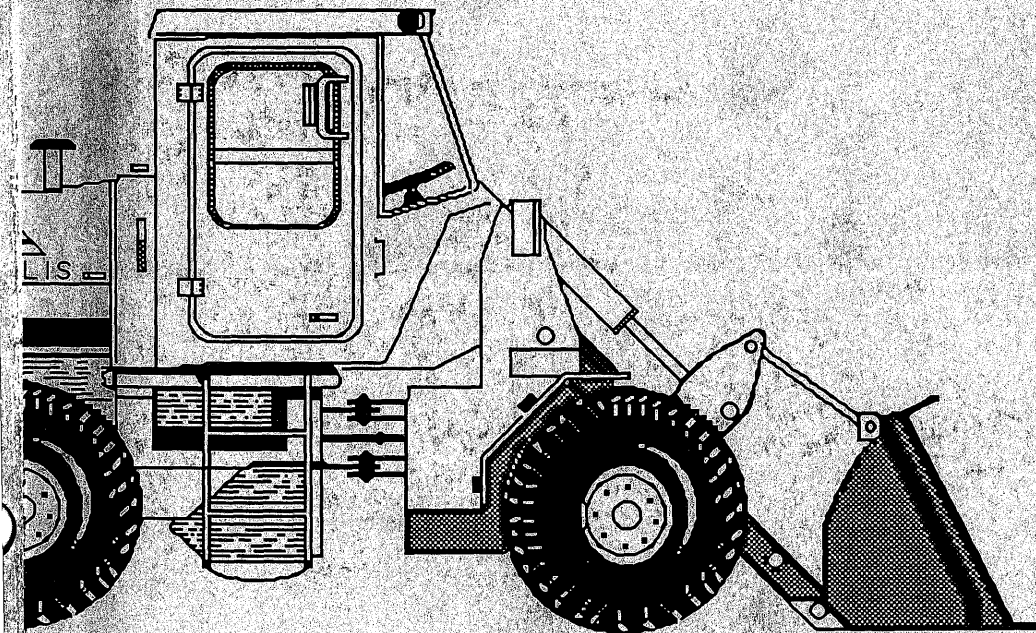

FORM 73063928
Reprint 3-89

AVOID ACCIDENTS

Most accidents, whether they occur in industry, on the farm, at home or on the highway, are caused by the failure of some individual to follow simple and fundamental safety rules or precautions. For this reason MOST ACCIDENTS CAN BE PREVENTED by recognizing the real cause and doing something about it before the accident occurs.

Regardless of the care used in the design and construction of any type of equipment there are conditions that cannot be completely safeguarded against without interfering with reasonable accessibility and efficient operation.

**A careful operator is the best insurance against an accident.
The complete observance of one simple rule would prevent many
thousand serious injuries each year.
That rule is:**

Never attempt to clean, oil or adjust a machine while it is in motion.

WARNING

On machines having hydraulically, mechanically, and/or cable controlled equipment (such as shovels, loaders, dozers, scrapers, etc.) be certain the equipment is lowered to the ground before servicing, adjusting and/or repairing. If it is necessary to have the hydraulically, mechanically, and/or cable controlled equipment partially or fully raised to gain access to certain items, be sure the equipment is suitably supported by means other than the hydraulic lift cylinders, cable and/or mechanical devices used for controlling the equipment.

COPYRIGHT BY FIATALLIS



**All rights reserved. Reproduction of text and illustrations
in whole or in part, is strictly prohibited.**

545, 545H

(DIESEL)
wheel loaders

parts catalog

S/N 990-3000

S/N 21U03001-UP

S/N 34M03001-UP





S/N 48U03001-UP

S/N 78A03001-UP

Form 73063928 English

WARNING

STUDY THE OPERATION AND MAINTENANCE INSTRUCTION MANUAL THROUGH BEFORE STARTING, OPERATING, MAINTAINING, FUELING OR SERVICING THIS MACHINE.

-  The Operation and Maintenance Instruction Manual provides the instructions and procedures for starting, operating, maintaining, fueling, shutdown and servicing that are necessary for properly conducting the procedures for overhaul of the related components outlined in this Service Manual.
-  This symbol is your safety alert sign. It means **ATTENTION! BECOME ALERT! YOUR SAFETY IS INVOLVED!**
-  Read and heed all safety instructions carrying the signal words **WARNING** and **DANGER**.
-  Machine mounted safety signs have been color coded yellow with black borders and lettering for **WARNING** and red with white borders and lettering for **DANGER** points.

(

(

(

ADDITIONAL PUBLICATIONS

Additional publications pertaining to this model and to all other Fiat-Allis products are available through Fiat-Allis dealers. Publications are generally available in several languages. Refer to Service Publications Index Form 70658800 for all such publications; the index is available free from Fiat-Allis.

IMPORTANT

Attaching parts such as bolts, nuts, rivets, screws, washers, etc., are indented immediately following the parts which they attach.

Parts indicated with a square (□) are also available in packaged sets. Refer to section titled "PACKAGED PARTS".

The terms "right" and "left" used throughout this parts catalog are determined by facing the direction of forward travel.

The engine is mounted unconventionally with the flywheel toward the front of the machine, but all engine parts are designated in respect to the engine as it would be installed in a conventional machine with the flywheel to the rear.

INSTRUCTIONS FOR ORDERING PARTS

Order parts from the dealer covering the local territory.

ALWAYS GIVE THE MODEL AND SERIAL NUMBER OF MACHINE. IF PARTS ARE FOR AN ASSEMBLY WHICH HAS A MODEL AND/OR SERIAL NUMBER (SUCH AS ENGINE ASSEMBLY, PUMP ASSEMBLY), ALSO INCLUDE THIS INFORMATION.

To obtain parts promptly, give part name and part number.

Give post office address, town, county and state where parts are to be shipped. Also specify whether material is to be shipped by freight, express or parcel post.

Confirm all telephone or telegraph orders in writing.

Parts for standard motor accessories such as generators and starting motors should be ordered from authorized Service Stations maintained by manufacturers of these units throughout the country.

No credit will be allowed on parts unless they are returned to the dealer from whom they were purchased; from there they will be returned, at the customer's expense, to the factory for inspection.

Unless claims for shortages or errors are made immediately upon receipt of goods, they will not be considered.

When broken goods are received, a full description of the damage should be made by the carrier agent on the freight bill. If this description is insisted upon, full damage can always be collected from the transportation company.

No responsibility is assumed for delay or damage to merchandise while in transit. Our responsibility ceases upon delivery of shipment to the transportation company from whom a receipt is received showing that shipment was in good condition when delivered to them; therefore, claims (if any) should be filed with the transportation company and not with Fiat-Allis.

The right is reserved to change the construction or material of any parts where it seems desirable to do so without incurring the obligation of installing such changes on units already delivered.

The information contained herein is general in nature and is not intended for specific application purposes. Fiat-Allis reserves the right to make changes in specifications shown herein or add improvements, at any time without notice or obligation.

MODEL IDENTIFICATION

The symbol listed below is stamped in front of the model serial number on each unit.

MODEL SYMBOL	ENGINE SYMBOL	DESCRIPTION
545	2900	Turbocharged Diesel powered engine, articulated four wheel drive loader unit of "modular" design, equipped with: power shift transmission, torque converter, planetary axles, power steering and power brakes.

SERIAL NUMBER LOCATIONS

LOADER SERIAL NO: On plate attached to the transmission control lever pedestal to the left of the operator's seat. (See page 12).

ENGINE SERIAL NO: On plate attached to the right hand side of the engine block.

TRANSMISSION SERIAL NO: On plate attached to the right side of the engine block.

AXLE SERIAL NO: On plate attached to the axle housing.

RECORD YOUR SERIAL NUMBERS BELOW

WHEEL LOADER SERIAL NO. _____

ENGINE SERIAL NO. _____

TRANSMISSION SERIAL NO. _____

AXLE SERIAL NO. _____

MODEL SERIAL NUMBER

* SERIAL NUMBER, consisting of all 8 characters must always be submitted for positive identification of your machine.

LOADER MODEL	*SERIAL NUMBER	
	PRODUCT CODE	UNIT NO.
545	78 A	03501
	21 U	03501
545H	48 U	03501
	34 M	03501

NOTICE

Allis-Chalmers Corporation and FIAT S.p.A. entered into a joint venture agreement to combine their manufacture, sale and service of construction machinery products throughout the world after January 1, 1974.

In view of the new enterprise, wherever in this publication reference is made to Allis-Chalmers or your Allis-Chalmers dealer, such reference is intended to identify FIAT-ALLIS Construction Machinery Inc. or your FIAT-ALLIS dealer.

ALPHABETICAL INDEX

A

Air Cleaner	68, 70
Air Heater	52
Air Heater Box	53
Air Heater Kit	13
Alternator	339
Automatic Boom Kick-Out	284
Automatic Bucket Leveler	282
Auxiliary Battery	323
Axle and Supports	148
Axle Housing	166, 167

B

Battery and Cables	325
Battery Cover	324
Brake Assembly	172, 174
Brake Warning Light	341
Bucket	316, 317, 317a
Bucket Hydraulics	320
Bucket Level Indicator	266
Bucket Position Indicator	321

C

Cab	354, 358
Cab and Wiper Assembly, ROPS	380
Cab Heater, ROPS	390
Canopy Assembly, ROPS	382
Clutch Cut-Off Valve	177
Cold Weather Starting Aid	78
Cowl, Floor Plate and Platform	300, 302
Crankshaft	18
Cylinders:	
Bucket	322
Dump	254, 256, 258
Lift	260, 262, 264
Steering	206, 208
Cylinder Block	14
Cylinder Head	22

D

Demand Valve and Piping	230
Demand Valve Assembly	228, 232
Differential Carrier Assembly	150, 154
Door Assembly	364
Door Assembly, Left	362
Door Assembly, Right	261
Door Assembly, ROPS	384
Drawbar	298
Drive Shaft Assembly	143, 145, 146
Drive Shaft Group	142
Dump Cylinder Assembly	254, 256, 258

E

Electrical System	326, 328, 330
Engine Air Heater	52
Engine and Mounting	13
Engine Controls	72
Exhaust Manifold	45

F

Fan	80
Filters:	
Engine Oil	38, 40
Fuel	46
Transmission	138, 139, 140, 141
Water	83
Flex Disk and Converter Drive	86
Flywheel	26

(Continued)

F

Flywheel Housing	27
Forward Clutch and Planetary	98, 100
Frame	304
Front Piping	286, 288
Front Plate and Gear Cover	28, 30
Fuel Filter	46
Fuel Injection Pump	47
Fuel Tank & Lines	54

H

Heater and Defroster	372
High Range Clutch	106
High Range Clutch and Transfer Drive Gear	102, 104
Hose Parts	6
Hour Meter	17
Hour Meter Kit	13
Hydraulic and Power Steering Pump and Piping	210, 212
Hydraulic Brake Lines	178, 181
Hydraulic Controls	290, 292
Hydraulic Piping and Cylinders - Front	234, 238
Hydraulic Piping - Rear Section	242, 244, 246
Hydraulic Piping - Three Spool Valve - Rear Section	248, 250, 252
Hydraulic Pump and Piping	214
Hydraulic Pump Assembly Parts	226
Hydraulic Tank and Valve	268, 270, 272

I

Idler Gear Assembly	21
Injection Nozzles and Lines	48
Injection Pump	47
Instrument Panel and Gauges	342, 344, 346, 350
Gauges	342, 344, 346, 350
Instrument Panel and Wires	352
Intake Manifold	44

L

Ladder, Hand Rails and Fenders	296, 297
Lift Cylinder Assembly	260, 262, 264
Lights and Wiring	336, 338
Light Assembly Parts	334
Linkage Group	312, 314
Low Range Clutch and Transfer Drive Group	108

M

Manifolds:	
Exhaust	45
Intake	44
Master Cylinder Assembly	182
Mechanical Fuel Shut-Off	74, 76
Multi-Purpose Bucket	318

N

Nozzle Holder Assembly	50, 51
------------------------	--------

O

Oil Cooler	42
Oil Pan	31
Oil Pump	32, 34, 36
Oil Pump Drive	37

(Continued)

(Revised April 1978)

ALPHABETICAL INDEX (Continued)

P			
Packaged Parts -----	8	Transmission: -----	85
Painting and Marking -----	375, 376	Charging Oil Pump -----	114
Pantograph Wiper -----	370	Control Group -----	120, 122, 124
Parking Brake Assembly Parts -----	168	Control Valve -----	116, 119, 119b
Parking Brake Control -----	169, 171	Cooling Lines and Dipstick ---	134, 135, 136
Piston and Connecting Rod -----	20	Cooling Lines, Filter and	
Power Steering Pump -----	222, 223, 224	Mounting -----	128, 132
Power Take-Off -----	115	Housing and Covers -----	92
Primer Pump and Lines -----	56, 58	Oil Filter -----	138, 139, 140, 141
Pumps:		Oil Thermostat -----	137
Engine Oil -----	32, 34, 36	Rear Housing -----	113
Hydraulic -----	226	Turbine Driven Gears and Freewheel	
Injection -----	47	Unit -----	87
Primer -----	56, 58	Turbocharger -----	60, 64
Steering -----	222, 223, 224	Turbocharger Assembly Parts -----	62, 66
Vacuum -----	190	Turn Signal -----	371
Water -----	80		
R		U	
Radiator -----	82	Universal Joint Cartridge and	
Radiator Support, Hood, & Fenders --	306	Support -----	144
Rear Axle Disconnect -----	112	V	
Rear Axle Disconnect Control -----	127	Vacuum Brake System -----	184
Rear Output Group -----	111	Vacuum Pump and Piping -----	188
Rear Panel Assembly -----	383	Vacuum Pump Parts -----	190
Rear Window Assembly -----	366	Valves:	
Rear Wiper Group -----	369	Clutch Cut-Off -----	177
Relief Valve Assembly -----	221	Demand -----	228, 232
Reverse Clutch and Planetary -----	95, 97	Hydraulic Control -----	274, 278
Right Door Assembly -----	361	Relief -----	221
ROPS Cab		Steering Gear -----	202
Cab and Wiper Assembly -----	380	Transmission -----	116
Canopy Assembly -----	382	Valve Operating Mechanism -----	24
Door Assembly -----	384		
Instrument Panel and Wiring -----	388	W	
Rear Panel Assembly -----	383	Water Filter -----	83
Turn Signals -----	391	Water Filter Assembly -----	84
Wiper Groups -----	386	Water Pump -----	80
		Wheel Cylinder Assembly -----	176
		Wheel Group -----	294
		Window Assy, rear -----	383
		Wiper Group -----	367, 368
		Wiper Groups, ROPS -----	386
S			
Seat and Mounting -----	308, 309		
Seat Belt -----	310		
Shaft and Hub -----	158, 162		
Side Panels -----	311		
Starting Motor -----	340		
Steering Cylinder -----	206, 208		
Steering Cylinder and Piping -----	200		
Steering Gear and Linkage -----	199		
Steering Gear, Cylinder and Piping --	192, 196		
Steering Pump, Demand Valve			
and Lines -----	216, 218		
T			
Tail Light -----	333		
Thermostat and Housing -----	79		
Tie Rod Assembly -----	209		
Tires -----	295		
Tools -----	378		
Torque Converter -----	89		
Torque Converter Housing -----	90		

(Continued)

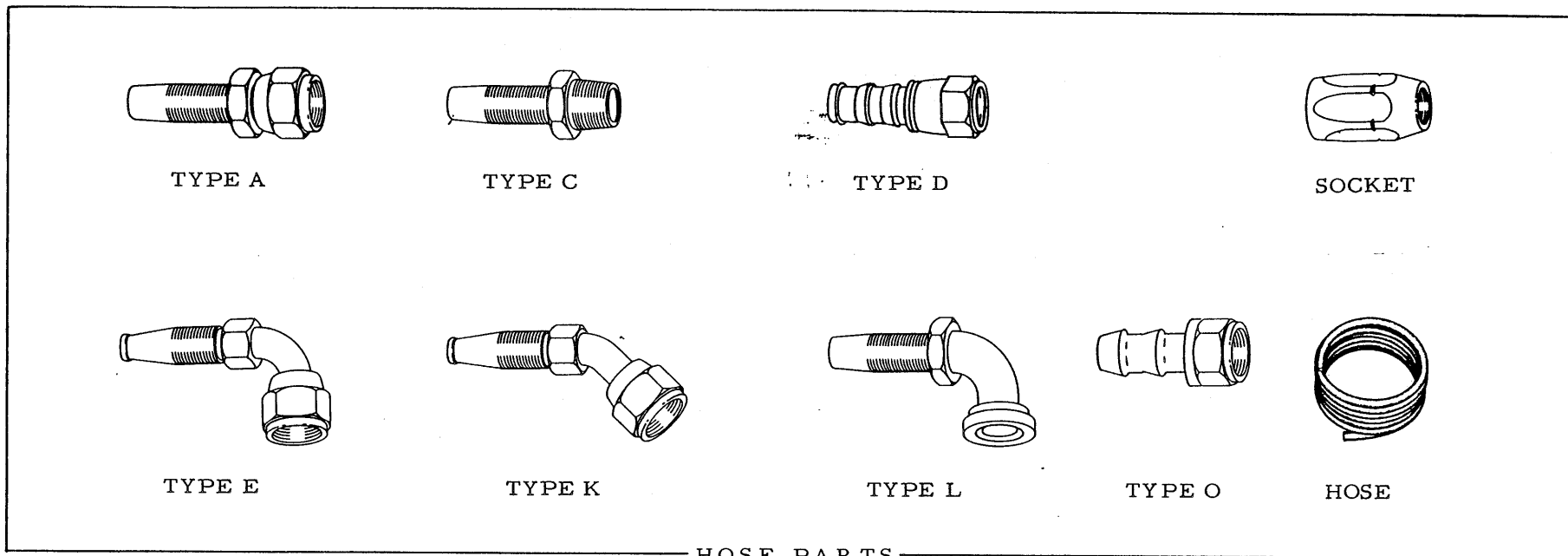

HOSE PARTS

NOTE: Refer to right hand column for identity of interchangeable crimped-type hose (fittings not re-usable). Assembly number shown in left hand column indicates available replacement hose assembly with re-usable components; where no assembly number is listed, hose assembly is not available from factory but may be constructed in the field from data indicated.

USAGE: I-used prior to loader s/n 2501, II-effective with loader s/n 2501

HOSE ASSEMBLY NO. (See NOTE)	BULK HOSE (25' roll)	HOSE LENGTH (inches)	NIPPLE (#1 end)			NIPPLE (#2 end)			SOCKET (both ends)	CRIMPED-TYPE HOSE (See NOTE) Part No.	USAGE	
			Including SOCKET	NIPPLE only	Type	Including SOCKET	NIPPLE only	Type			I	II
	70920388	26-3/4	70920389		C	70920806		A		73043323	*	*
	70920793	40-3/8	70920942	70921562	A	79020942	70921562	A	70920971	73043353	*	*
	70920794	32	70923506	70922894	L	70923506	70922894	L	70920972	73044144	*	*
	70920794	32	70923506	70922894	L	70923506	70922894	L	70920972	73044145	*	*
	70920795	22-1/4	70920945	70922831	A	70920945	70922831	A	70920973	73044146	*	*
	70920794	32	70923506	70922894	L	70923506	70922894	L	70920972	73044164	*	*
	70920794	32	70923506	70922894	L	70923506	70922894	L	70920972	73044165	*	*
	70920793	77-1/4	70920951	70921563	E	70920961	70921302	K	70920971	73044172	*	*
	70920388	10-1/2	70920806		D	70920806		D		73044541	*	*

	70920727	24-3/4	70920852	70920344	A	70920852	70920344	A	70919281	73044802	*	*
	70920795	39	70921855	70923263	L	70920945	70922831	A	70920973	73044971	*	*
	70920221	73-3/4	70920874	70921042	E	70920867	70919277	E	70919281	73044991	*	*
	70920795	25-11/64	70924408		L	70920953		E	70920973	73046656	*	*
	70920720	38	70920805		O					73050508		*
	70920794	36-1/8	70920944	70920978	A	70920944	70920978	A	70920972	73052363		*
	70920982	49-1/4	70921020	70922830	A	70921020	70922830	A	70920972	73052396		*
	70920794	22-3/4	70920944	70920978	A	70926039		L	70920972	73053207	*	*
	70924031	18-3/4	70924041							73053208	*	*
	70920794	30-1/4	70921020		A	70926039		L	70920972	73053209	*	*
	70920794	25	70924177	70921513	L	70926039	70924978	L	70920972	73053210	*	*
	70920221	53-5/8	70920852	70920344	A	70920882	70919278	K	70919281	73053979		*
	70920221	65-7/8	70920852	70920344	A	70920882	70919278	K	70919281	73053980		*
	70920221	32	70920852	70920344	A	70920867	70919277	E	70919281	73054019		*
74022871	70922363	18-3/8		70922183	A		70922183	A	70920508			*
74022887	70922363	15-1/2		70922183	A		70922183	A	70920508			*
	70924031	38-7/8	70928340		A	70928340		A		73056768		*
	70924031	37-3/8	70928340		A	70928340		A		73057445		*
	70920794	29-3/4	70923506	70922894	L	70921020	70922830	A	70920972	73044149	*	
	70920945	71	70920945	70922831	A	70920945	70922831	A	70920973	73044291	*	
	70920720	36-1/2	70920828		Comp	70920805		D		73044778	*	
	70920727	15-3/4	70920852	70920344	A	70920852	70920344	A	70919281	73044793	*	
	70919156	25-1/2	70920902	70921226	A	70920902	70921226	A	70919820	73044967	*	
	70920794	21-3/4	70924177	70921513	L	70923506	70922894	L	70920972	73044969	*	
	70924031	16-1/4	70924041		A	70924042		E		73044978	*	
	70920982	31-1/4	70921020	70922830	A	70921020	70922830	A	70920972	73047171	*	
	70920982	44-1/4	70921020	70922830	A	70921020	70922830	A	70920972	73047172	*	

PACKAGED PARTS

USAGE: *Used prior to loader serial no. 2501
 **Effective with loader serial no. 2501

PACKAGE NO.	*	**	DESCRIPTION
-----	1	1	DECAL KIT (See PAINTING AND MARKING)
-----	1	1	LINING KIT (See BRAKE ASSEMBLY)
-----	1	1	LINING KIT, parking brake (See PARKING BRAKE)
-----	-	1	REPAIR KIT, cap (See CONTROL VALVE ASSEMBLY)
-----	1	1	REPAIR KIT, cylinder (See DUMP CYLINDER)
-----	1	1	REPAIR KIT, cylinder (See LIFT CYLINDER)
-----	-	1	REPAIR KIT, master cylinder (See MASTER CYLINDER)
-----	1	1	REPAIR KIT, cylinder (See POWER STEERING CYLINDER)
-----	-	1	REPAIR KIT, element (See TRANSMISSION FILTER ASSEMBLY)
-----	1	1	REPAIR KIT, wheel cylinder (See WHEEL CYLINDER ASSEMBLY)
-----	1	1	REPAIR KIT, pump (See WATER PUMP)
-----	-	1	REPAIR KIT, solenoid (See AUTOMATIC BUCKET LEVELER)
-----	-	1	REPAIR KIT, solenoid (see AUTOMATIC BOOM KICK-OUT)
-----	1	1	RING SET, piston (See PISTON AND CONNECTING ROD)
-----	1	1	SHIM KIT, bearing cage (See DIFFERENTIAL ASSEMBLY, Front Axle)
-----	1	1	SHIM KIT, bearing cage (See DIFFERENTIAL ASSEMBLY, Rear Axle)
-----	1	1	SHIM KIT, pinion bearing cage (See DIFFERENTIAL ASSEMBLY, Front Axle)
-----	1	1	SHIM KIT, steering gear (See STEERING GEAR ASSEMBLY)
-----	1	1	SPACER KIT, bearing cage (See DIFFERENTIAL ASSEMBLY, Front Axle)
-----	1	1	SPACER KIT, bearing cage (See DIFFERENTIAL ASSEMBLY, Rear Axle)

PACKAGED PARTS

PACKAGE NO.	DESCRIPTION	
73046168	SEAL AND GASKET KIT, transmission (2-speeds forward, 1-reverse)	
24	73021041	NUT
1	73021053	SEAL, oil, shifter shaft
2	73067517	GASKET, strainer and core cover
1	73021058	RING, seal
1	73026156	SEAL, oil pump body
1	73027012	RING, seal, cover
1	73031847	CUP, cut-off plug
1	73035714	RING, seal, hi-clutch
1	73035745	RING, seal (Not used - discard)
2	73063316	SEAL, oil, valve
2	73042138	SEAL KIT (Includes expander)
2	73042146	SEAL KIT (Includes expander)
1	73042151	SEAL KIT (Includes expander)
6	73044377	STRIP, locking, pump retainer
1	73044382	RING, seal
1	73044386	GASKET, oil pump
1	73044390	GASKET, housing, transmission
1	73044400	RING, seal, suction tube nut
1	73044402	GASKET, cover, oil pump
1	73044409	SEAL, oil (For "A" spline shaft only)
1	73044410	GASKET, rear cover
1	73044411	RING, seal, rear cover
3	73044414	NUT
2	73044422	RING, seal, 2nd turbine
6	73044460	TAB, lock, piston housing
2	73044462	SEAL, oil, output shaft
2	73044474	GASKET
1	73044485	GASKET, trimmer valve
2	73044489	GASKET, cut-off plug
6	73046029	STRIP, locking
1	73048782	GASKET, control valve
1	73051197	DIAPHRAGM AND SEAL ASSEMBLY
1	73054475	GASKET, pump, torque converter
1	73055857	SEAL, oil (For "B" spline shaft only)
1	-----	INSTRUCTION SHEET
2	73058791	RING
2	73058792	RING
2	73058793	RING
73046957	SEAL AND GASKET KIT, transmission (2-speeds forward, 2-reverse)	
24	73021041	NUT, coverter cover
1	73021053	SEAL, oil, shaft
2	73067517	GASKET, strainer assembly
1	73021058	RING, seal cut-off, valve plug
1	73021121	RING, seal, low piston
1	73026156	SEAL, oil, pump body
1	73027012	RING, seal, cover
1	73027016	RING, seal coverter drive
1	73031847	CUP, plug, control valve
1	73063376	SEAL, range selector valve
2	73042138	SEAL KIT (Includes expander)
2	73042146	SEAL KIT (Includes expander)
1	73042147	SEAL KIT (Includes expander)
6	73044377	STRIP, locking, pump retainer
1	73044382	RING, seal, input gear
1	73044386	GASKET, oil pump
1	73044390	GASKET, transmission housing

(Continued)

(Revised October 1977)

PACKAGED PARTS

PACKAGE NO.	DESCRIPTION	
73046957	SEAL AND GASKET KIT, transmission (2-speeds forward, 2-reverse Con't.)	
	1	73044400 RING, seal, nut, suction tube
	1	73044402 GASKET, pump cover
	1	73044409 SEAL, accessory drive (For "A" spline shaft only)
	1	73044411 RING, seal, rear housing
	2	73044414 NUT, drive flange
	2	73044422 RING, seal, ground sleeve
	2	73044462 SEAL, oil
	2	73044474 GASKET, plug
	1	73044485 GASKET, trimmer valve
	2	73044489 GASKET, cut-off, valve plug
	1	73045285 GASKET, adapter
	2	73045289 RING, seal
	1	73045313 SEAL KIT (Includes expander)
	1	73045320 GASKET, rear housing
	1	73045327 SEAL, oil
	1	73048782 GASKET, control valve
	1	73051197 DIAPHRAGM AND SEAL ASSEMBLY
	1	73054475 GASKET, pump, torque converter
	1	73055857 SEAL, oil (For "B" spline shaft only)
	2	73058791 RING
	2	73058792 RING
	2	73058793 RING
74023788	GASKET KIT, intermediate	
	1	70226012 GASKET, drain plug (Not used - discard)
	1	70923684 O-RING, water pump volute
	1	70923817 O-RING, hydraulic pump drive (Not used - discard)
	1	70923822 O-RING, water pump mounting
	1	74020016 O-RING, rear plate (Not used - discard)
	1	74020098 GASKET, front plate
	1	74023567 GASKET, front cover
	1	74020104 GASKET, inspection cover
	1	74020879 O-RING, rear plate
	1	74025019 GASKET, fuel pump cover
	1	74025021 GASKET, filler elbow
	1	74025106 GASKET, water inlet pipe
	1	74025120 GASKET, filter base
	2	74026549 GASKET, hydraulic pump cover
	1	74026887 GASKET, water pump
	1	74021913 GASKET, front cover
	1	74023859 GASKET, air compressor
	1	74023138 GASKET, lube oil filter
	1	74040305 GASKET, air compressor
74061522	SLEEVE KIT (For one cylinder)	
	1	74020032 O-RING
	1	74023811 SLEEVE
	1	74023827 O-RING
	1	----- INSTRUCTION SHEET
74061535	PISTON KIT (for one cylinder) (For original equipment)	
	1	----- PISTON
	2	70927693 RETAINER
	1	74021796 RING SET
	1	74023970 PIN
	1	----- INSTRUCTION SHEET

(continued)

(Revised October 1977)

PACKAGED PARTS

PACKAGED NO.	DESCRIPTION	
74023824	GASKET KIT, cylinder head	
	1	70242095 GASKET, air heater base
	1	74008074 GASKET, cylinder head cover
	3	74020090 GASKET, exhaust manifold
	1	74021332 GASKET, intake manifold
	1	74022911 GASKET, cylinder head
	2	74025101 GASKET, thermostat housing and water outlet flange
	6	74025150 GASKET, injection nozzle
	12	74025385 SHIELD, dust, injection nozzle
	1	74339532 GASKET, turbo drain tube
74061794	PISTON KIT (For one cylinder) (Service replacement - MK II)	
	1	----- PISTON
	2	70927693 RETAINER
	1	74021796 RING SET
	1	74023970 PIN
	1	----- INSTRUCTION SHEET

(Revised August 1978)

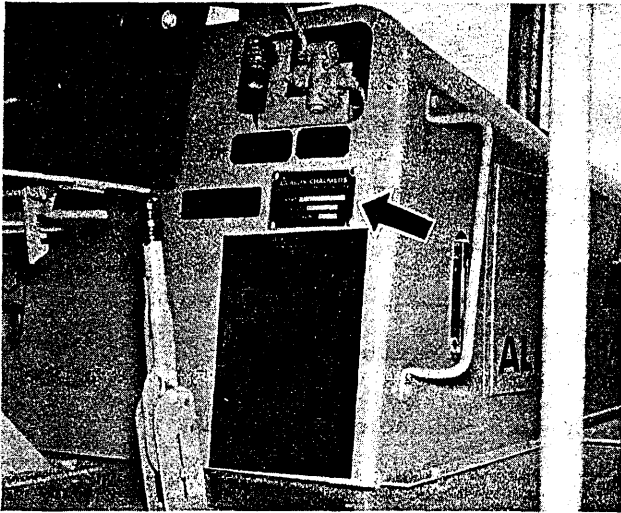

T-74409
LOADER SERIAL NUMBER

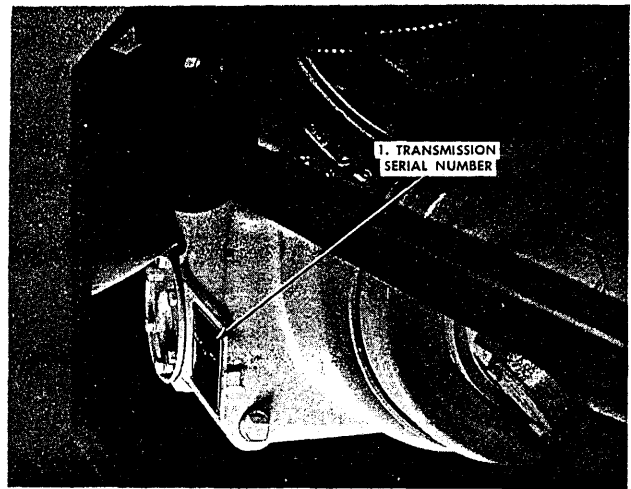

T-71046
TRANSMISSION SERIAL NUMBER



T-74332
ENGINE SERIAL NUMBER

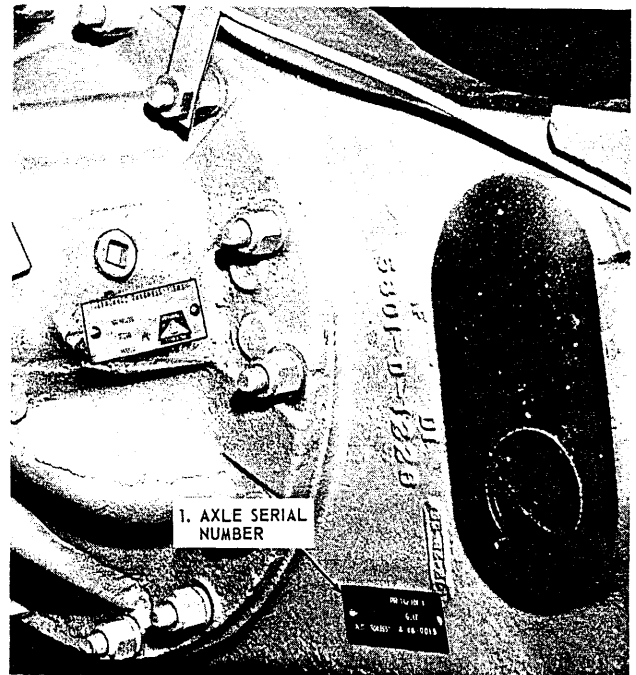

T-72567
AXLE SERIAL NUMBER

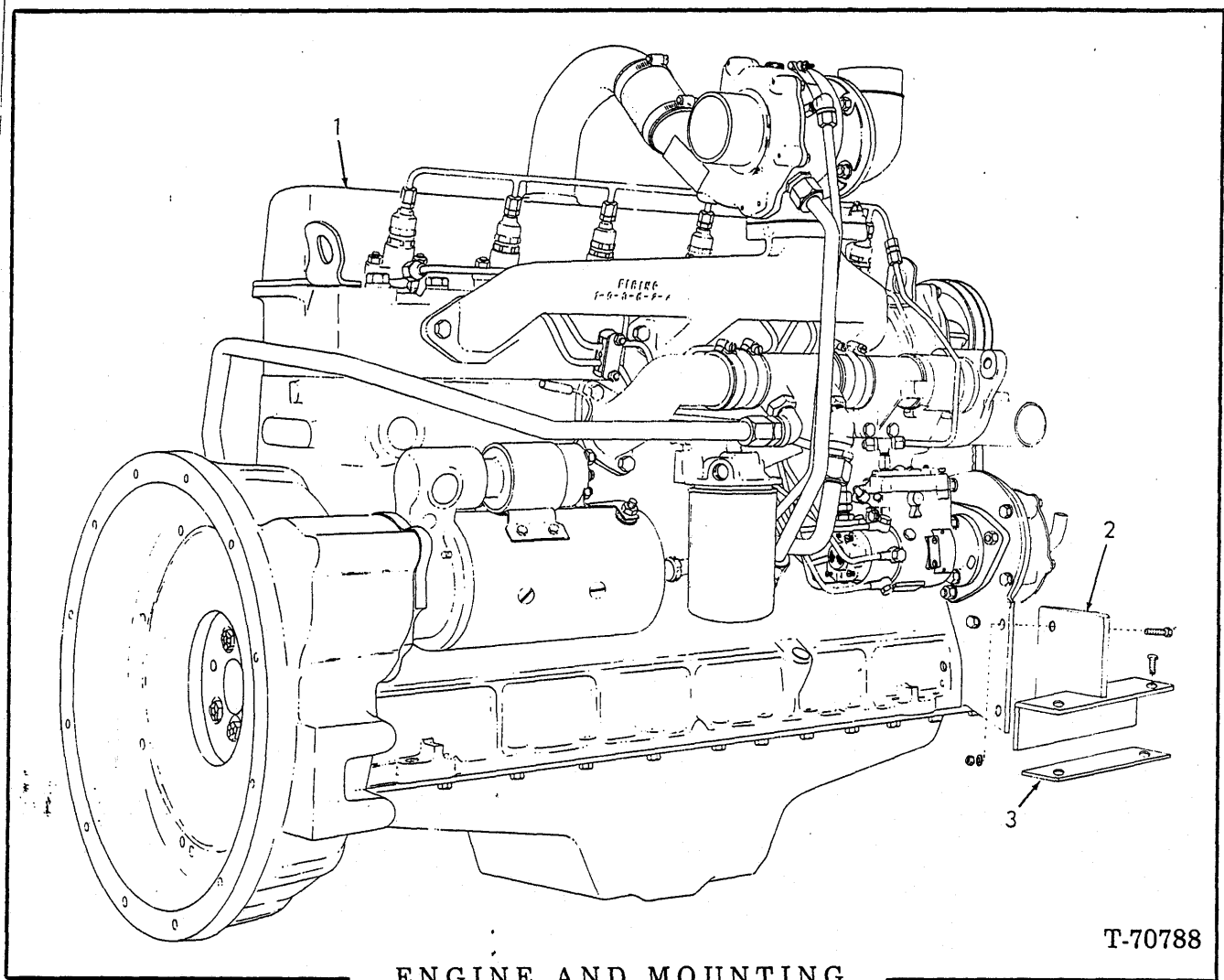

ENGINE AND MOUNTING

T-70788

ITEM	PART NO.	QTY.	DESCRIPTION
1	74024577	1	ENGINE ASSY. (Less air cleaner, fan, starter, generator but includes oil and fuel filters) (For installation of service replacement engine also order items 4, 5 and 6)
	70916028	4	CAPSCREW, 1/2" NF x 1-3/4"
	70914487	2	NUT, safety, 1/2" NF
2	73045595	2	BRACKET
	70916408	4	CAPSCREW, 5/8" NF x 2-3/4"
	73026289	4	WASHER
	70921139	4	LOCKNUT, 5/8" NF
3	73045917	1	SHIM (1/16" thick. Use as required)
4	73061139	1	KIT, installation, 2900 MK II repower
5	73067417	1	KIT, electric hour meter
6	73067436	1	KIT, manifold air heater

(Revised October 1977)

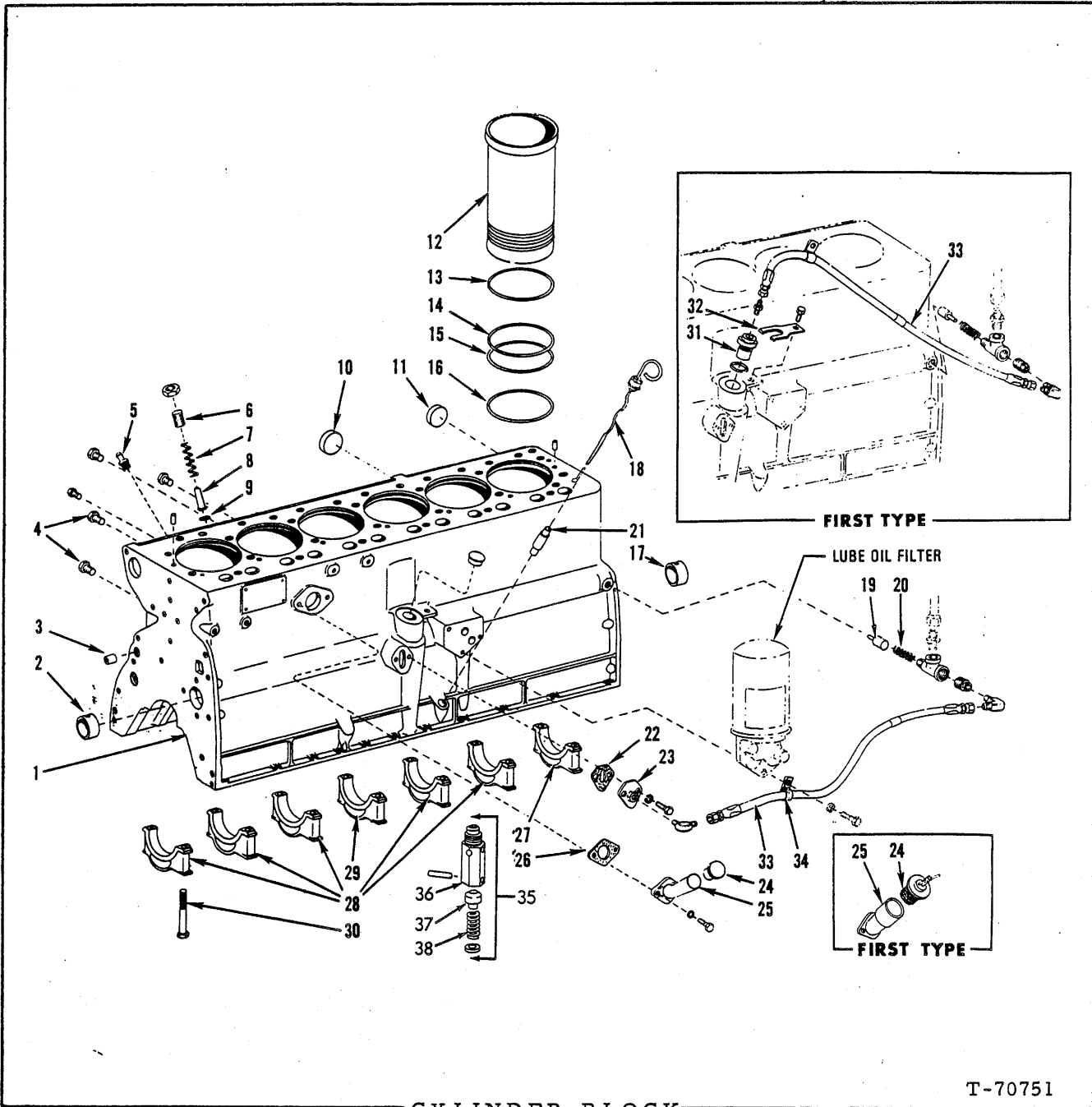

CYLINDER BLOCK

T-70751

USAGE: * Used prior to engine serial no. 2D-39240
 ** Effective with engine serial no. 2D-39240

ITEM	PART NO.	QTY.		DESCRIPTION
		*	**	
1	74023709	1	1	BLOCK ASSY., cylinder (Includes items 2, 3, 9 thru 11, 17, 19, 20 and 27 thru 30 and hardware indented below)
	70912415	1	1	COCK, drain, 1/4" NPT
	70917547	2	2	PIN, dowel, 3/8" x 3/4"
	70919840	1	1	PLUG, pipe, hex-hd., 1/4" NPT
	70919134	2	2	PLUG, pipe, hex-hd., 1/8" NPT
	70918850	1	1	PLUG, pipe, ctsk., 1/8" NPT
	70917970	1	1	PLUG, pipe, hex-hd., 1/2" NPT

(Continued)

(Revised August 1978)

CYLINDER BLOCK (Continued)

ITEM	PART NO.	QTY.	DESCRIPTION
		* **	
2	74025025	1 1	BEARING, camshaft, front (Std.)
	74025259	1 1	BEARING, camshaft, front (.010" undersize)
3	74025392	1 1	PLUG, pipe, restrictor, 1/2"
4	74255492	2 2	PLUG
5	74020955	1 1	ADAPTER
6	74022129	1 1	SCREW
	70910847	1 -	NUT, jam, 3/4" NF
7	74500231	1 1	SPRING
8	74507374	1 1	PISTON
9	74507673	1 1	INSERT
10	74255110	1 -	PLUG
11	74255107	2 2	PLUG
12	74023811	6 6	□ SLEEVE
13	74020537	* -	SHIM, cylinder sleeve (.005" thick)
	74020538	* -	SHIM, cylinder sleeve (.010" thick)
	74020539	* -	SHIM, cylinder sleeve (.015" thick)
	74020540	* -	SHIM, cylinder sleeve (.020" thick)
			* Use as required when remachining block
14	74020672	6 -	□ O-RING, cylinder sleeve (top)
15	74020031	6 -	□ O-RING, cylinder sleeve (center)
16	74023827	6 12	□ O-RING, cylinder sleeve (lower)
17	74025238	3 3	BEARING, camshaft, intermediate and rear (Std.)
	74025258	3 3	BEARING, camshaft, intermediate and rear (.010" undersize)
18	74021610	1 -	GAUGE, oil level (Used prior to engine serial no. 2D-36795)
	74022914	1 -	GAUGE, oil level (Used engine serial no. 2D-36795 thru 39239)
	74021611	- 1	GAUGE, oil level (Use engine serial no. 2D-39240 thru 40947)
	74023810	- 1	GAUGE, oil level (Effective with engine serial no. 2D-40948)
	74023934	- 1	GAUGE, oil level (Service replacement - MK II)
19	74020861	1 1	PLUG
20	74020862	1 1	SPRING
21	74021615	1 1	ADAPTER, oil level gauge (Long type)(Used with oil level gauge 74021610 and 74021611)
	74022685	1 1	ADAPTER, oil level gauge (Short type)(Used with oil level gauge 74022913 and 74022914)
	74023877	- 1	ADAPTER, oil level gauge (Service replacement - MK II)
22	74025019	1 1	□ GASKET
23	74026383	1 -	PLATE, cover, fuel pump pad (First type)
	74022882	1 -	NOZZLE ASSY., cover, fuel pump pad (Second type)
	74023198	- 1	PLATE
	70915809	2 2	CAPSCREW, 5/16" NC x 3/4"
	70904205	2 2	LOCKWASHER, 5/16"

(Continued)

CYLINDER BLOCK (Continued)

ITEM	PART NO.	QTY. * **	DESCRIPTION
24	74385253	1 1	PLUG, oil filler (Used prior to engine serial no. 2D-42891)
	74021711	- 1	CAP, oil filler (Effective with engine serial no. 2D-42891)
	74024097	- 1	CLOSURE ASSY., oil filler (Includes chain)(Service replacement - MK II)
25	74021498	1 1	ELBOW, oil filler (Prior to engine serial no. 2D-42891 also order 1 CAP 74021711 and 1 PLUG 70922464)
	70916272	2 2	CAPSCREW, 3/8" NC x 1-1/4"
	70904206	2 2	LOCKWASHER, 3/8"
25a	74023455	- 1	ELBOW, oil filler (Service replacement - MK II)
	70916281	- 2	CAPSCREW, 5/16" NC x 2-3/4"
	70904205	- 2	LOCKWASHER, 5/16"
	70912369	- 2	WASHER, plain, 21/64"
	70919840	- 1	PLUG, pipe, hex-hd., 1/4" NPT
26	74025021	1 1	□ GASKET
	74025019	- 1	GASKET (Service replacement - MK II)
27	74020382	1 1	CAP, rear main bearing (See NOTE)
28	74020380	5 5	CAP, intermediate and front main bearing (See NOTE)
29	74020381	1 1	CAP, center main bearing (See NOTE)
30	74020135	14 14	CAPSCREW
31	74254452	1 -	PLUG, tachometer drive hole (without tapped hole)
	-----	1 -	PLUG, tachometer drive hole (with tapped hole)(Order 1 NOZZLE ASSY. 74022882, 1 ELBOW 70919173 and 1 PLUG 74254452)
	70923566	1 -	O-RING, sealing
32	74020814	1 -	CLAMP, tachometer plug (First type)
	74255060	1 -	CAPSCREW, 3/8" NC x 1"
33	74022871	1 -	HOSE ASSY., oil pump gear lube (See HOSE PARTS)(First type)
	70919171	1 -	CONNECTOR, 1/4" tube, 7/16" straight thread
	70918941	1 -	CLIP, hose supporting
	74022887	1 -	HOSE ASSY., oil pump gear lube (See HOSE PARTS)(Second type)
	70904269	1 -	REDUCER, pipe, 1/8" x 1/2" NPT
	70914087	1 -	TEE, pipe, 1/2" NPT
	70919173	2 -	ELBOW, 1/4" tube, 7/16" straight thread (Nozzle end)
34	74250269	1 -	CLAMP, hose supporting (Second type)
35	74023127	1 1	VALVE ASSY., relief valve (Includes items 36 thru 38)
36	74023148	1 1	BODY
	70916001	1 1	PIN, roll, 3/16" x 1"
37	74354571	1 1	PISTON
38	74026942	1 1	SPRING
	70913168	1 1	WASHER, plain

NOTE: Replacement bearing cap are semi-finished and must be line bored after installing.

□ (Also see PACKAGED PARTS)