

G ELECTRICAL WIRING ROUTING

Position of Parts in Engine Compartment

[2GR-FE]

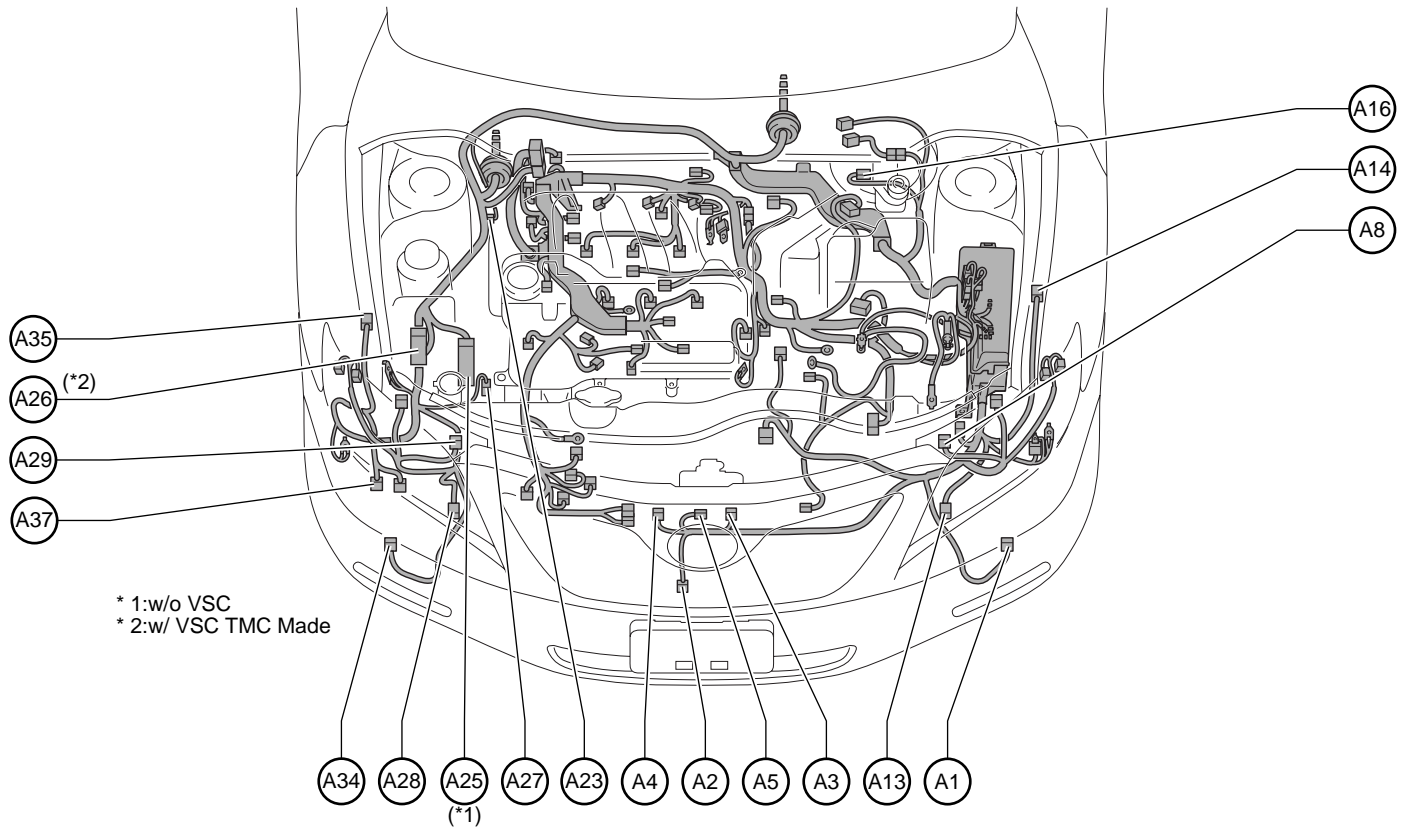

* 1:w/o VSC
* 2:w/ VSC TMC Made

- A 1 Fog Lamp (Front LH)
- A 2 Ambient Temp. Sensor
- A 3 Horn (High)
- A 4 Horn (Low)
- A 5 Engine Hood Courtesy SW
- A 8 Headlamp (LH High)
- A 13 Airbag Sensor (Front LH)
- A 14 Speed Sensor (Front LH)
- A 16 Brake Fluid Level Warning SW

- A 23 Security Horn
- A 25 Skid Control ECU with Actuator
- A 26 Skid Control ECU with Actuator
- A 27 A/C Pressure Sensor
- A 28 Airbag Sensor (Front RH)
- A 29 Headlamp (RH High)
- A 34 Fog Lamp (Front RH)
- A 35 Speed Sensor (Front RH)
- A 37 Windshield Washer Motor

Position of Parts in Engine Compartment

[2GR-FE]

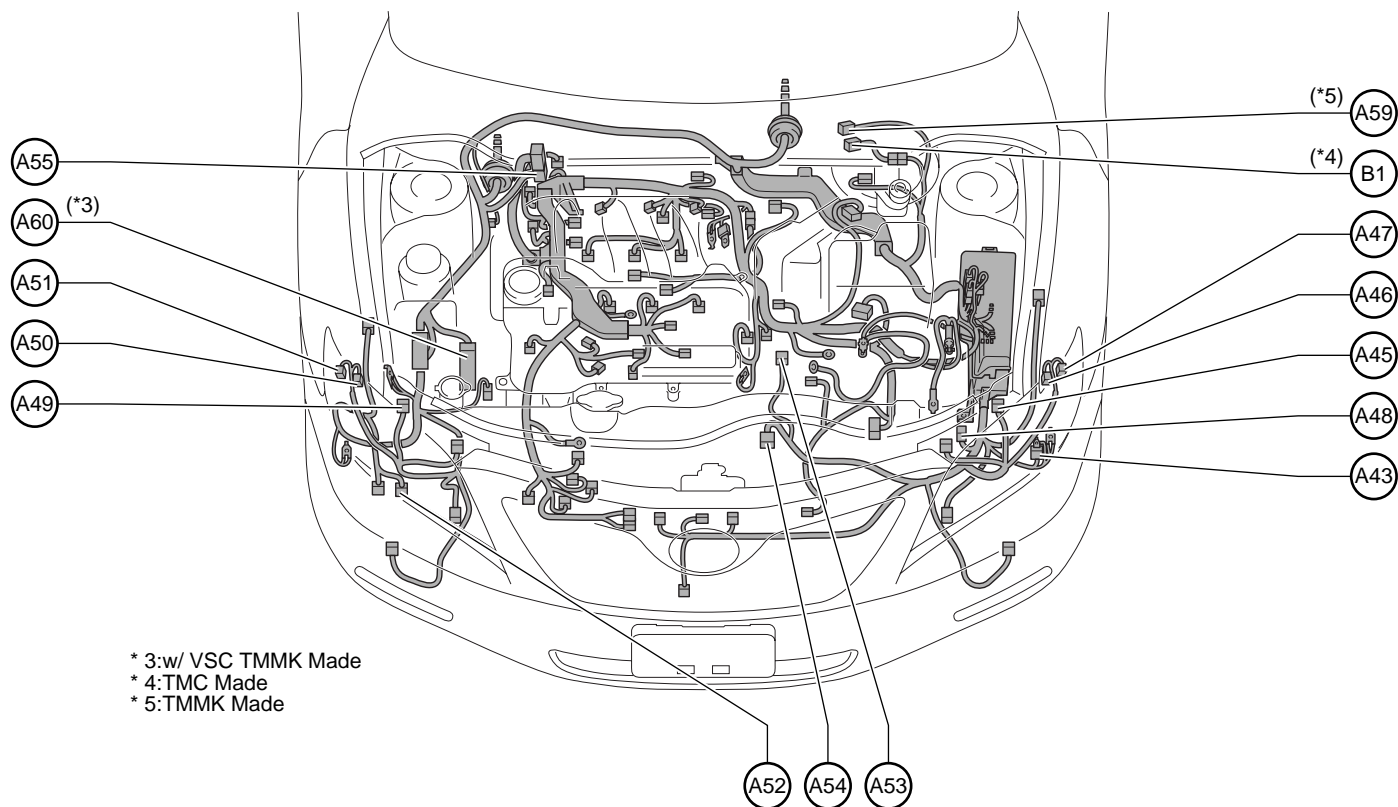

- A 43 Junction Connector
- A 45 Headlamp (LH Low)
- A 46 Turn Signal and Parking Lamp (Front LH)
- A 47 Side Marker Lamp (Front LH)
- A 48 Wireless Door Lock Buzzer
- A 49 Headlamp (RH Low)
- A 50 Turn Signal and Parking Lamp (Front RH)
- A 51 Side Marker Lamp (Front RH)
- A 52 Washer Level Warning SW
- A 53 VSV (Air Intake Control)
- A 54 Cooling Fan ECU
- A 55 Engine Control Module
- A 59 Windshield Wiper Motor
- A 60 Skid Control ECU with Actuator

B 1 Windshield Wiper Motor