

OPERATION & MAINTENANCE



Paver

F1000W T4F

4812247169(Full size)

4812247170 (A5)

12JAN2015

Keep for later use in document compartment

Valid for:

_____ - _____
_____ - _____

Sustainable Productivity

Atlas Copco



www.atlascopco.com

1.2	Engine Error messages	18
D3.0	Operation	1
1	Operating elements on the paver	1
	Operator's platform	1
	Seat console	1
	Operating panel	1
	Driver's seat	2
	Batteries	2
	Battery main switch	3
	Transport safeguards for the hopper	4
	Mechanical screed transport safeguard (to the left and the right beneath the driver's seat)	4
	Paving thickness indicator	5
	Release Agent System	6
	On/Off switch of working lights (1)	7
	On/Off switch hazard flasher (2):	7
	Warning Beacon	7
	Conveyor limit sensors	8
	Ultrasonic auger limit sensors (left and right)	8
	Sockets 24V	8
D4.0	Operation	1
1	Preparation of operation	1
	Required equipment and tools	1
	Before starting work (in the morning or when starting paving)	2
	Checklist for the machine operator	2
1.1	Starting the paver	5
	Before starting the paver	5
	"Normal" starting	5
	Jump starting	7
	After starting	9
1.2	Transport Operation	11
	Lifting and securing the screed	11
	Driving and stopping the paver	11
	Switching off and securing the paver	11
1.3	Preparations for paving	12
	Releasing agent	12
	Screed heater	12
	Direction marks	12
	Loading/distributing material	14
1.4	Starting for paving	16
1.5	Check during paving	17
	Paver function	17
	Quality of the layer	17
1.6	Interrupting/terminating operation	19
	During breaks (i.e. the material supply truck is late)	19
	During extended interruptions (i.e. lunch break)	19

	When work is finished	21
2	Malfunctions	22
2.1	Problems during paving	22
2.2	Malfunctions on the paver or screed	24
E1.0	Set-up and modification	1
1	Special notes on safety	1
2	Auger	2
2.1	Height adjustment	2
2.2	Auger crossbeam - hydraulic height adjustment	2
2.3	Auger extension	3
2.4	Mounting extension parts	4
2.5	Mounting support tube extensions	5
2.6	Installing tunnel plates	6
2.7	Installing additional braces	7
3	Screed	8
4	Electrical connections	8
4.1	Remotes from screed to paver	8
4.2	Right hand conveyor sensor control	8
4.3	Right hand auger sensor control	8
4.4	Left hand conveyor sensor control	9
4.5	Left hand auger sensor control	9
4.6	Auger Chart	10
F1.0	Maintenance	1
1	Notes regarding safety	1
F2.1	Maintenance Overview	1
1	Maintenance overview	1
F3.0	Maintenance - Conveyor	1
1	Maintenance - Conveyor	1
1.1	Maintenance intervals	2
1.2	Points of maintenance	3
	Chain tension of the conveyor (1)	3
	Conveyor tensioning sprocket bearings (2)	5
	Conveyor bearing (3)	5
	Conveyor drive - (5) drive chains	6
	Conveyor drive - (6) planetary drive (left/right)	7
	Conveyor chain guards / conveyor plates (7)	8
F4.0	Maintenance - Auger	1
1	Maintenance - Auger sub-unit I	1
1.1	Maintenance intervals	2
1.2	Points of maintenance	3
	Auger - outer bearing (1)	3
	Auger middle bearing (2)	3
	Auger - drive gear neck bearing (3)	4

	Auger bevel gear (on the RH and LH sides) (4)	5
	Auger blade (5)	6
F5.0	Maintenance - Engine	1
1	Maintenance - engine sub-unit	1
1.1	Maintenance intervals	2
1.2	Points of maintenance	4
	Engine fuel tank (1)	4
	Engine lube-oil system (2)	5
	Engine fuel system (3)	7
	Engine air cleaner (4)	9
	Engine Coolant system (5)	11
	Engine drive belt (6)	13
F6.0	Maintenance - Hydraulic System	1
1	Maintenance - hydraulic system	1
1.1	Maintenance intervals	2
1.2	Hydraulic System	3
1.3	Points of maintenance	4
	Hydraulic oil tank (1)	4
	Suction/return flow hydraulic filter (2)	6
	Venting the filter:	7
	High pressure filter (3)	8
	Pump distribution gear (4)	9
	Hydraulic hoses (5)	11
F7.1	Maintenance - Travel Drive, Steering	1
1	Maintenance - travel drive, steering	1
1.1	Maintenance intervals	2
1.2	Points of maintenance	3
	Wheel mounting nuts (1)	3
	Rear wheels	3
	Front wheels (with front wheel drive)	3
	Planetary gear (2)	4
	Air pressure (driving wheels) (3)	6
	Places of lubrication (4)	7
F8.1	Maintenance - Electronic System	1
1	Maintenance - Electronic system	1
1.1	Maintenance intervals	2
1.2	Points of maintenance	3
	Batteries (1)	3
	Electric fuses / relays (3)	4
	Fuses in terminal box (B)	5
	Relays in terminal box (C)	7
F9.0	Maintenance - Lubricating Points	1
1	Maintenance - Lubricating points	1

1.1	Maintenance intervals	2
1.2	Points of maintenance	3
	Bearing points (1)	3
F10.0	Checks, Decommissioning	1
1	Tests, check-up, cleaning, stopping	1
1.1	Maintenance intervals	2
2	General observation	3
3	Check performed by a specialist	3
4	Cleaning	4
5	Preservation for storage of paver	5
5.1	Downtime up to 6 months	5
5.2	Downtime between 6 months and 1 year.	5
5.3	Re-commissioning:	5
F11.0	Lubricants and Operating Substances	1
1	Lubricants and operating substances	1
1.1	Capacities	2

V Preface

Safe operation of the machine requires specific knowledge that is in these operating instructions. The information is provided in a concise, clearly structured form. The individual chapters are arranged in alphabetical order and every chapter starts with page 1. The individual pages are identified by the chapter letter and the page number.

Example: Page B 2 is the second page of chapter B.

These operating instructions cover various machine options. Make sure that during operation and maintenance work the description appropriate to the machine option is used.

Safety instructions and important notes are identified by the following:

DANGER

Danger is used to indicate the presence of a hazard which will cause severe personal injury, death, or substantial property damage if the warning is ignored.

WARNING

Warning is used to indicate the presence of a hazard which can cause severe personal injury, death, or extensive property damage if the warning is ignored.

CAUTION

Caution is used to indicate the presence of a hazard which will or can cause minor personal injury or property damage if the warning is ignored.

NOTICE

Notifies people of installation, operation or maintenance information which is important but not hazard-related. Hazard warnings should never be included under the Notice indicator.

NOTE:

Note is used for supplementary information not directly effecting safety or damage to the equipment. Note can also refer to special information on the efficient use of the equipment.

In the interest of continued development, the manufacturer reserves the right to make changes to the machine (which will not, however, change the essential features of the type of machine described) without updating the present operating instructions at the same time.

Dynapac (China) Compaction & Paving Equipment Co., Ltd.

Atlas Copco Construction Technique Product Company China
No. 38, QuanWang Road, WuQing High Tech Industrial Park,
Commerce City, CO 80022
301700, Tianjin, China

www.dynapac.com

1 General safety instructions

1.1 Acts, directives, accident prevention regulations

NOTICE

The locally applicable acts, directives and accident prevention regulations shall be observed, even if the attention is not specifically directed to these.

The operator himself shall be responsible for the observation and performance of the related regulations and actions!

NOTICE

The following alerts, prohibitions and instructions refer to the risks to which people, machinery and environment are exposed.

NOTICE

Ignoring these instructions, bans and commands may lead to fatal injuries!

NOTICE

Furthermore, the Dynapac publication "Directives for the correct and specified application of pavers" shall also be observed.

1.2 Warning instructions

A paving machine has many components and implements that are controlled by a hydraulic system, either directly or indirectly. Before working on or inspecting any part of a paving machine, it is important that the individual knows how the components move and are controlled by the hydraulic system components including the respective control circuits.

Before working on or inspecting any component, it must be physically constrained from any movement that could cause injury to the worker. The worker must be alert to not placing any part of his/her body where movement of a component could cause injury, unless that component is physically constrained from movement, if the hydraulic system fails, is disconnected, or is signaled to cause movement.

It must also be recognized that there are occasions where component and or vehicle movement may react to the release of potential energy. Where applicable it must be confirmed that all measures are employed to ensure that any and all sources of potential energy are released and/ or physically restrained.

It is also the responsibility of those involved to insure that all local, state and federal safety regulations are followed, prior to, and during any work or inspection.

⚠ WARNING

Warning: areas of hazard or danger!
Not observing the warning instructions may lead to injuries or death!



⚠ WARNING

Warning: rotating parts!

Rotating parts or transport parts can cause severe injury or death!
Perform each operation only with equipment switched off!



⚠ CAUTION

Attention: electric voltage!

All maintenance and repair work on the screed's electrical system must always be carried out by an electrician!



⚠ CAUTION

Attention: suspended load!

Never stand under suspended loads!



⚠ WARNING

Warning: risk of crushing!

Operation of certain parts or functions and moving the machine can produce a risk of crushing.
Always make sure that no one is in the areas exposed to risk!



⚠ CAUTION

Caution: risk of hand injury!



⚠ CAUTION

Caution: hot surfaces or hot liquids!



⚠ WARNING

Warning, risk of falling off!

Falling can cause severe injury or death!



⚠ CAUTION

Caution: hazardous batteries!

Combustible gas can cause severe burns, blindness or death!

Keep sparks and open flame away from batteries.



⚠ CAUTION

Caution: materials harmful to health and irritating substances!



⚠ CAUTION

Caution: flammable materials!



⚠ CAUTION

Caution: gas bottles!



1.3 Prohibitive signs

It is prohibited to open / step on / reach into / perform / adjust during operation or when the paver engine is running!



Do not start the engine/drive!

Maintenance and repair can be carried out only with the Diesel engine turned off!



Do not spray with water!



Do not extinguish with water!



Unskilled maintenance is prohibited!

Maintenance can be performed by skilled professionals only!



NOTICE

Contact the Dynapac service for maintenance assistance!

Danger of fire: do not use open flame and no smoking!



Do not turn on!



1.4 Protective gear

NOTICE

The applicable local regulations may define the use of different protective gear!
Observe these specifications!

Protect your eyes with goggles!



Wear appropriate head protection!



Protect your hearing with appropriate ear muffs!



Protect your feet with safety footwear!



Always wear tight, conforming working coveralls!
Wear visibility vest for good visibility!



In case of polluted air, wear respiratory mask!



1.5 Environmental protection

NOTICE

The locally applicable acts, directives and waste disposal regulations shall be observed, even if the attention is not specifically directed to these.

During cleaning, maintenance and repair operations, pollutants such as:

- lubricants (oils, grease)
- hydraulic oil
- gas oil
- coolant
- detergents

may not enter the soil or the sewer system!

These materials shall be collected, stored, transported in the correct containers until professional disposal!



Material harmful for the environment!

1.6 Fire prevention

NOTICE

The applicable local regulations may specify that appropriate fire extinguishers be mounted!

Observe these specifications!

Fire fighting device
(optional equipment)



1.7 Further instructions

NOTICE

Observe the manufacturer's and other instructions!

(i.e. the maintenance instructions from the engine manufacturer)

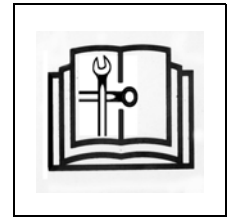

⚠ WARNING

Indicates a bottled gas heated design!

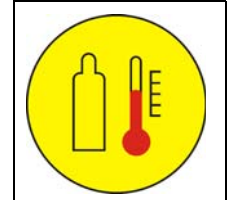

⚠ WARNING

indicates an electrically heated design!

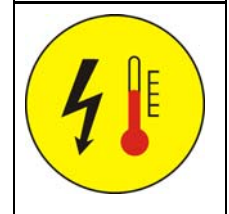

A Correct use and application

NOTICE

The “Guidelines for the Correct Use and Application of Paver” compiled by Dynapac are included in the scope of delivery for the present machine. The guidelines are part of the present operating instructions and must always be followed. Federal, state and local regulations are fully applicable.

The road construction machine described in these operating instructions is a paver that is suited for laying mixed materials, roll-down concrete or lean-mixed concrete, track-laying ballast and unbound mineral aggregates for paving foundations.

This machine shall be used, operated and maintained for the purpose of the intended work as included in the operation manual. Any other use is regarded as improper use and can cause injury to persons or damage to the paver or other equipment or property.

Any use going beyond the range of applications described above is regarded as improper use and is expressly forbidden! Especially in those cases where the paver is to be operated on inclines or where it is to be used for special purposes (i.e. construction of dumps, dams), it is absolutely necessary to contact the manufacturer.

Duties of the user: A “user” within the meaning of the present operating instructions is defined as any natural or legal person who either uses the paver himself, or on whose behalf it is used. In special cases (i.e. leasing or renting), the user is considered the person who, in accordance with existing contractual agreements between the owner and the user of the paver, is charged with the observation of the operating duties.

The user must ensure that the paver is only used in the stipulated manner and that all danger to life and limb of the operator, or third parties, is avoided. In addition to this, it must be ensured that the relevant accident prevention regulations and other safety-related provisions as well as the operating, servicing and maintenance guidelines are observed. The user must also ensure that all persons operating the equipment have read and understood the present operating instructions.

Mounting attachments: The paver must only be operated in conjunction with screeds that have been approved by the manufacturer. Mounting or installation of any attachments that will interfere with or supplement the functions of the paver is permitted only after written approval by the manufacturer has been obtained. If necessary, the approval of local authorities has to be obtained.

Any approval obtained from local authorities does not, however, make the approval by the manufacturer unnecessary.

B Vehicle description

1 Application

The Dynapac F1000W is a rubber tire fitted paver finisher that is used for laying bituminous mixed material, roll-down or lean-mixed concrete, track-laying ballast and unbound mineral aggregates for paving foundations.

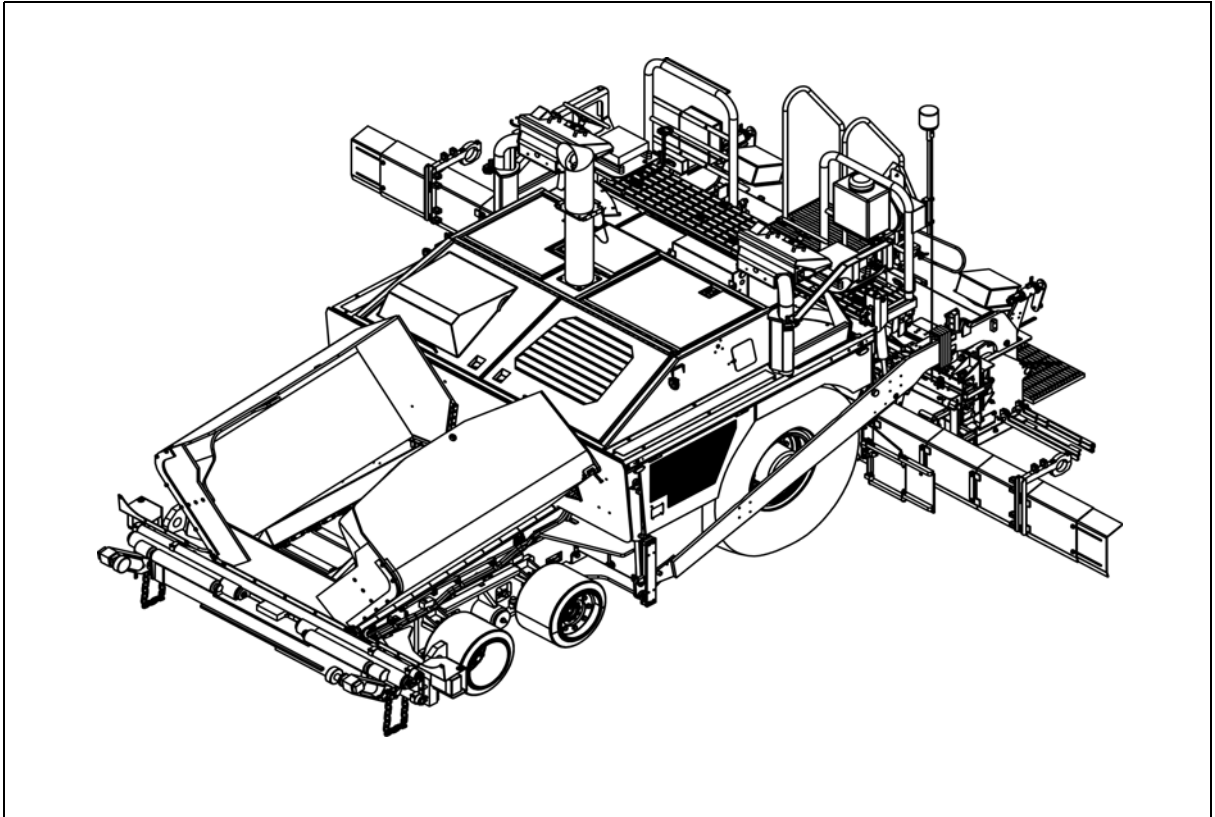

2 Description of assemblies and functions

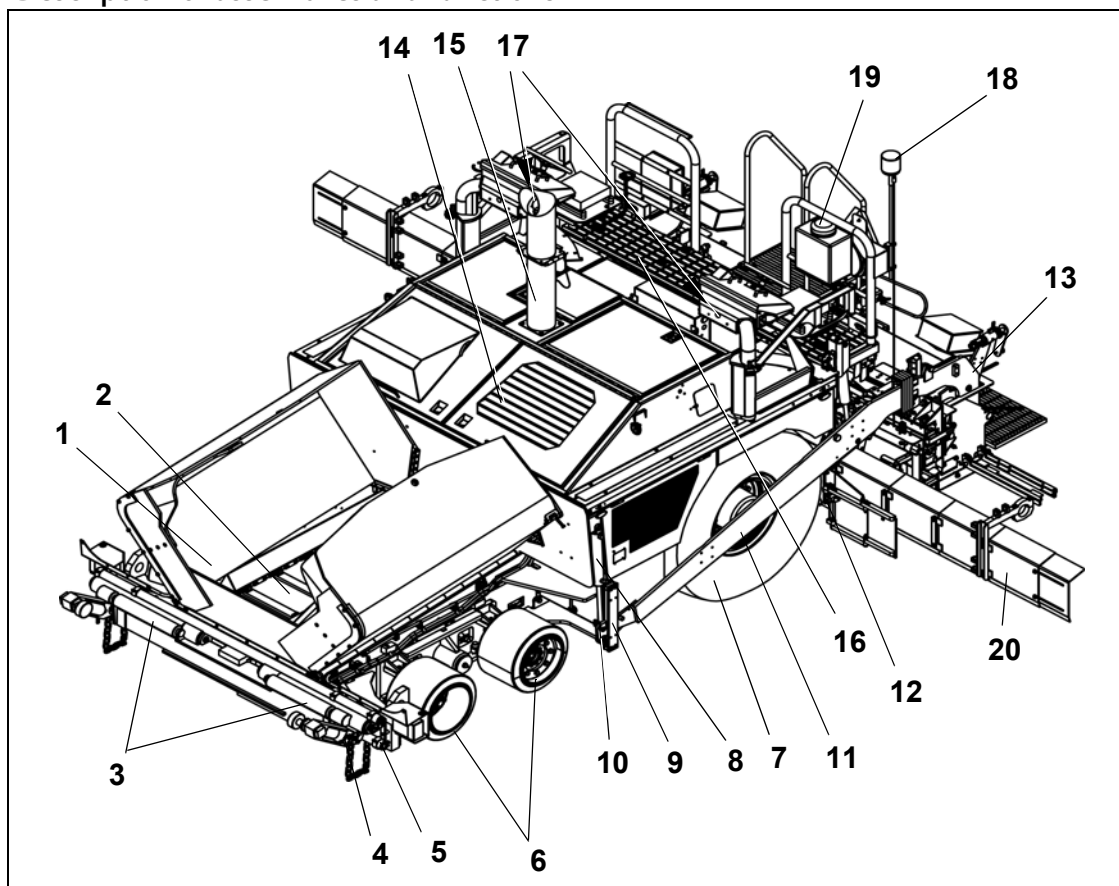

Item	Standard or Optional	Designation
1	Standard	Material hopper
2	Standard	Conveyor
3	Standard	Truck push rollers
4	Option	Truck hitch
5	Standard	Mounting tube for alignment indicator
6	Standard	Front tandem axle
7	Standard	Rear wheels
8	Standard	Levelling cylinder (for paving thickness)
9	Standard	Traction arm guide
10	Standard	Traction roller
11	Standard	Screed lifing arm
12	Standard	Auger
13	Standard	Screed
14	Standard	Power pack enclosure
15	Standard	Engine exhaust
16	Standard	Operator's platform
17	Standard	Operator's panels
18	Standard	Warning beacon
19	Standard	Washer/sprayer
20	Optional	Tunnel Extensions
21	Standard	FWA