

VIN PLATE DECODING INFORMATION

1	2	3	4	5	6	7	8	9	10	11	12 thru 17
Country	Make	Vehicle Type	GVWR & Pass. Safety	Line	Series	Body Style	Engine	Check Digit	Model Year	Assy. Plant	Sequence No.

The following table interprets the VIN Plate position shown above.

Position	Interpretation	Codes = Description
1	Country of Origin	1 = U.S.
2	Assembler	B = Dodge
3	Vehicle Type	7 = Truck
4	GVWR & Pass. Safety	D = 0-3000 lbs (0-1360 kg) E = 3001-4000 lbs (1361-1814 kg) F = 4001-5000 lbs (1815-2267 kg) G = 5001-6000 lbs (2268-2721 kg) H = 6001-7000 lbs (2722-3175 kg) J = 7001-8000 lbs (3176-3628 kg) K = 8001-9000 lbs (3629-4082 kg) L = 9001-10000 lbs (4083-4535 kg) M = 10001-14000 lbs (4536-6350 kg) W = Buses & Incomplete Vehicles With Hydraulic Brakes
5	Vehicle Line	G = Dakota, Dakota/Sport, Dakota 4x4 L = Dakota, Dakota/Sport, Dakota 4x2
6	Series	2 = Dakota/Sport/SLT
7	Body Style	2 = Club Cab (2 Door) 3 = Club Cab (4WD) 6 = Regular Cab (2WD)
8	Engine	N = 4.7L 8 Cyl Gasoline (MPI) (EVA) P = 2.5L 4 Cyl. (EPE) X = 3.9L 6 Cyl. (EHC) Y = 5.2L 8 Cyl. (ELF) Z = 5.9L 8 Cyl. (EML)
9	Check Digit	0 = Check Digit 0 = Check Digit 0 = Check Digit 0 = Check Digit
10	Model Year	Y = 2000
11	Assembly Plant	S = Dodge City
12 thru 17	Vehicle Build Sequence	Model Year Assembly Sequence

Group - 1

Component Parts for Mopar Accessories

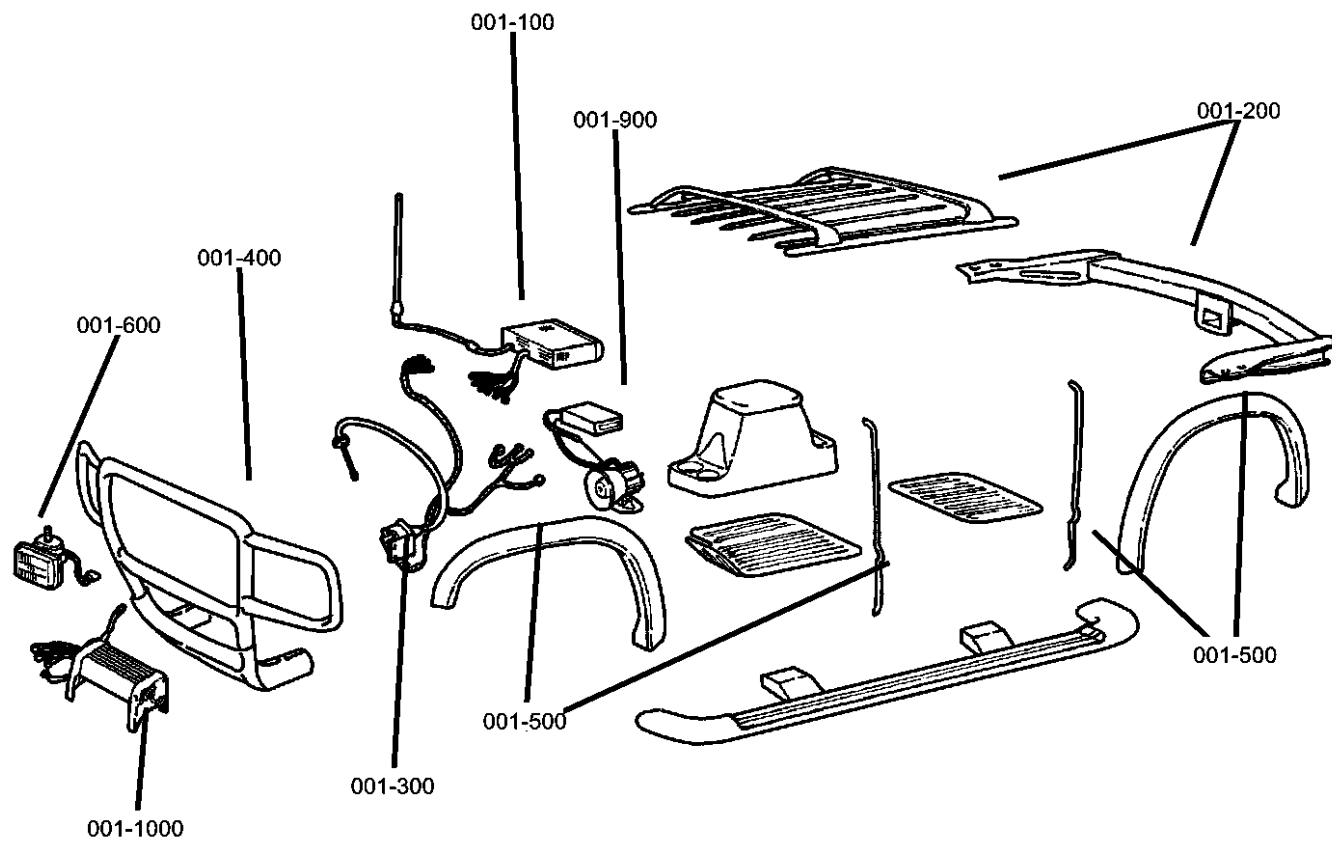

Group - 1 Component Parts for Mopar Accessories

Group-Fig. No.

Illustration Title

Audio & Electronics

Player Kit - CD Changer - 6 Disc..... Fig. 1 - 110
 Install Kit - CD Changer - Trunk..... Fig. 1 - 130

Carriers & Cargo Hauling

Bike Carrier - Fork Mount..... Fig. 1 - 210
 Ski Carrier - Two Pair..... Fig. 1 - 220
 Receiver Kit - Trailer Tow..... Fig. 1 - 230
 Wiring Kit - Trailer Tow - 7 Way..... Fig. 1 - 240
 Cooler Kit - Transmission Oil..... Fig. 1 - 250
 Cover Kit - Tonneau..... Fig. 1 - 260
 Cover Kit - Folding..... Fig. 1 - 270
 Cover Kit - Tonneau..... Fig. 1 - 280

Driving Convenience

Speed Control Kit..... Fig. 1 - 310
 Mounting Kit - Cellular Phone..... Fig. 1 - 320

Exterior Appearance

Wheel Lip Mouldings..... Fig. 1 - 410
 Grille and Brush Guards..... Fig. 1 - 420
 Running Board..... Fig. 1 - 430
 Side Steps, Molded and Tubular..... Fig. 1 - 440

Exterior Protection

Bedliner, Trays and Mats..... Fig. 1 - 510
 Divider Kit - Cargo..... Fig. 1 - 520
 Shield Kit - Air Front..... Fig. 1 - 530

Fog Lights & Electrical





Heater Kit - Engine Block..... Fig. 1 - 610
 Light Kit - Off Road..... Fig. 1 - 620
 Light Kit - Fog..... Fig. 1 - 630
 Install Package - Off Road..... Fig. 1 - 632
 Install Package - Fog..... Fig. 1 - 634

Security

Alarm, EVS II Security Plus..... Fig. 1 - 910

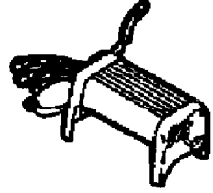
4 - Wheeling & Off Road

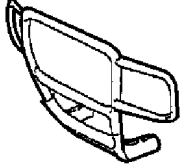
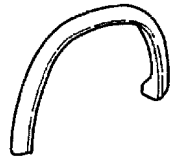
Winch Kit - Power..... Fig. 1 - 1010

<p>001-100 Audio & Electronics</p> 	<p>001-1000 4 - Wheeling & Off Road</p> 	<p>001-200 Carriers & Cargo Hauling</p> 	<p>001-300 Driving Convenience</p> 
<p>001-400 Exterior Appearance</p> 	<p>001-500 Exterior Protection</p> 	<p>001-600 Fog Lights & Electrical</p> 	<p>001-900 Security</p> 

Player Kit - CD Changer - 6 Disc
Figure 1-110

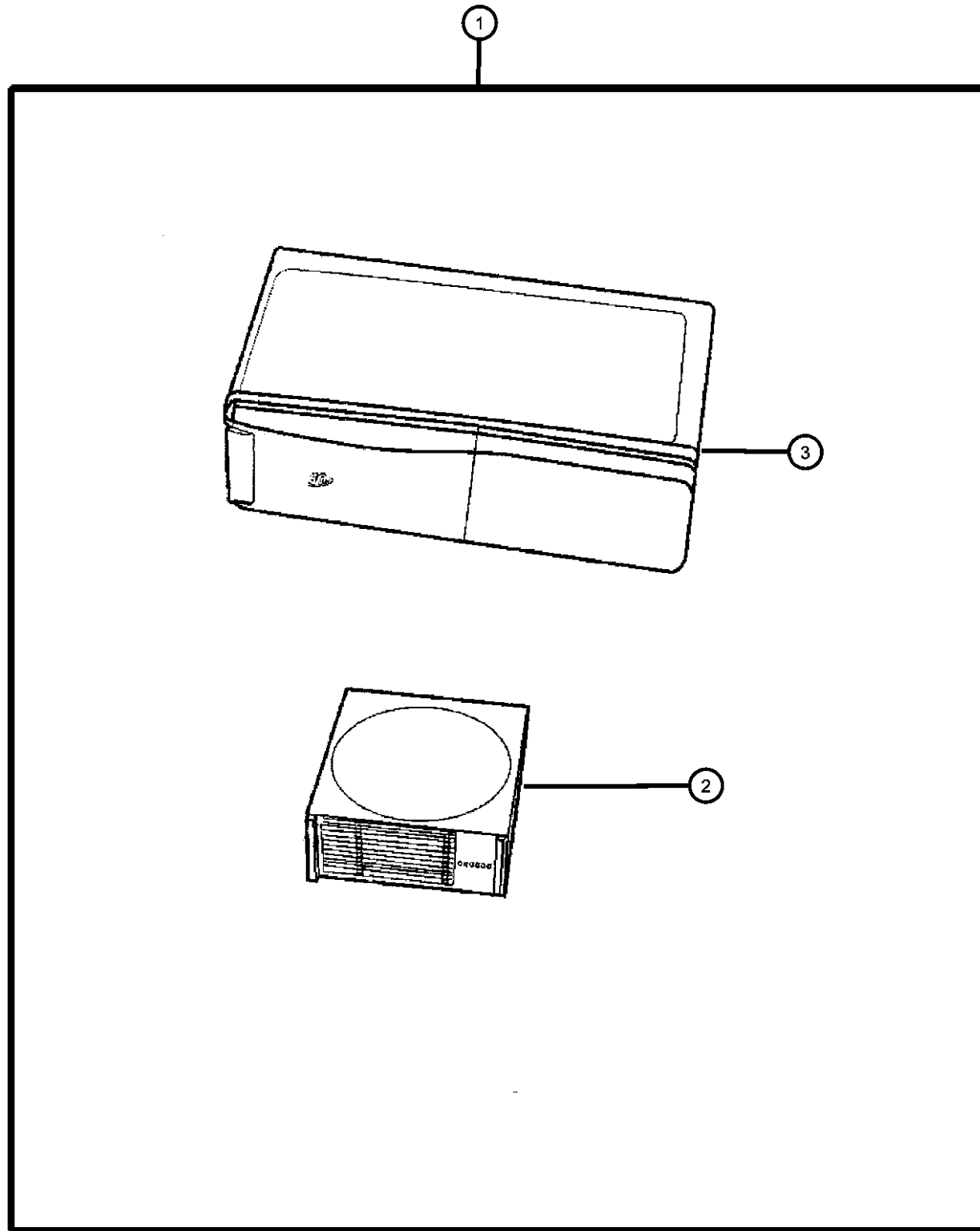

ITEM	PART NUMBER	QTY	LINE	SERIES	BODY	ENGINE	TRANS	TRIM	DESCRIPTION
1	82202700	1							PLAYER KIT, CD Changer - 6 Disc
2	04797433	1							MAGAZINE, CD Changer
3	04797433	1							CHANGER, CD, Serviced in Kit, (NOT SERVICED)

DAKOTA (AN)

SERIES LINE
L = Quad Cab 1 = Dakota 2WD
L = Regular Cab 5 = Dakota 4WD
L = Club Cab

BODY
31 = CLUB CAB 2-DR 6.5 FT BOX
61 = REG CAB 6.5 FT BOX
84 = CREW CAB 4-DR W.B.1

ENGINE
EPO = 2.5L 4 Cyl.
EHO = 3.9L 6 Cyl.
EMO = 5.9L 8 Cyl.
EVO = 4.7L Magnum
EHC = 3.9L SMPI V6
EML = 5.9L V8 MPI Engine
EPE = 2.5L POWER TECH I-4 Cyl.
EVA = 4.7L V8 MPI

TRANSMISSION
DDC = TRANSMISSION - 5-SPEED HD MANUAL
DG4 = TRANSMISSION-MULTI-SPEED AUTO, 45RFE
DGK = TRANSMISSION - 4-SPD. AUTOMATIC,42RE
DGT = TRANSMISSION - 4-SPD. AUTOMATIC,46RE
DGO = AUTO. TRANS.

AR = use ase required - = Non illustrated part

2000 AN

Install Kit - CD Changer - Trunk
Figure 1-130

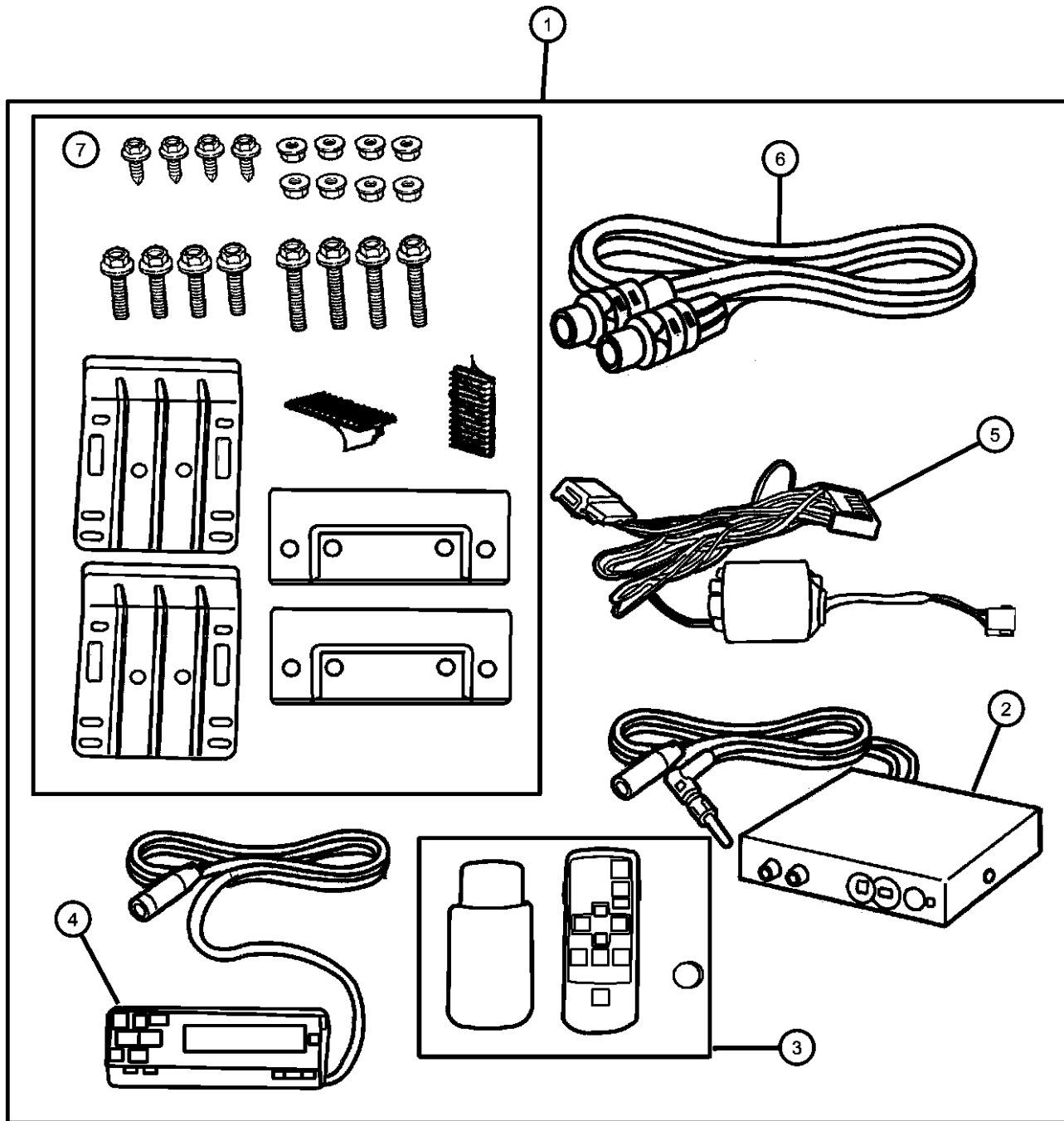

ITEM	PART NUMBER	QTY	LINE	SERIES	BODY	ENGINE	TRANS	TRIM	DESCRIPTION
1	82202292	1							INSTALL KIT, CD Changer - Trunk
2	82202292	1							MODULATOR, FM Changer, Serviced in package, (NOT SERVICED)
3	05017217AA	1							CONTROLLER, CD Wireless
4	05017217AA	1							CONTROLLER, CD Wired, Serviced in package, (NOT SERVICED)
5	04465117	1							ADAPTOR, A/C
6	04465113	1							CABLE, Din
7	04465113	1							HARDWARE KIT, Mounting, Serviced in package, (NOT SERVICED)

DAKOTA (AN)

SERIES	LINE
L = Quad Cab	1 = Dakota 2WD
L = Regular Cab	5 = Dakota 4WD
L = Club Cab	

BODY
31 = CLUB CAB 2-DR 6.5 FT BOX
61 = REG CAB 6.5 FT BOX
84 = CREW CAB 4-DR W.B.1

ENGINE
EPO = 2.5L 4 Cyl.
EHO = 3.9L 6 Cyl.
EMO = 5.9L 8 Cyl.
EVO = 4.7L Magnum
EHC = 3.9L SMPI V6
EML = 5.9L V8 MPI Engine
EPE = 2.5L POWER TECH I-4 Cyl.
EVA = 4.7L V8 MPI

TRANSMISSION
DDC = TRANSMISSION - 5-SPEED HD MANUAL
DG4 = TRANSMISSION-MULTI-SPEED AUTO, 45RFE
DGK = TRANSMISSION - 4-SPD. AUTOMATIC,42RE
DGT = TRANSMISSION - 4-SPD. AUTOMATIC,46RE
DGO = AUTO. TRANS.

AR = use ase required - = Non illustrated part

Bike Carrier - Fork Mount
Figure 1-210

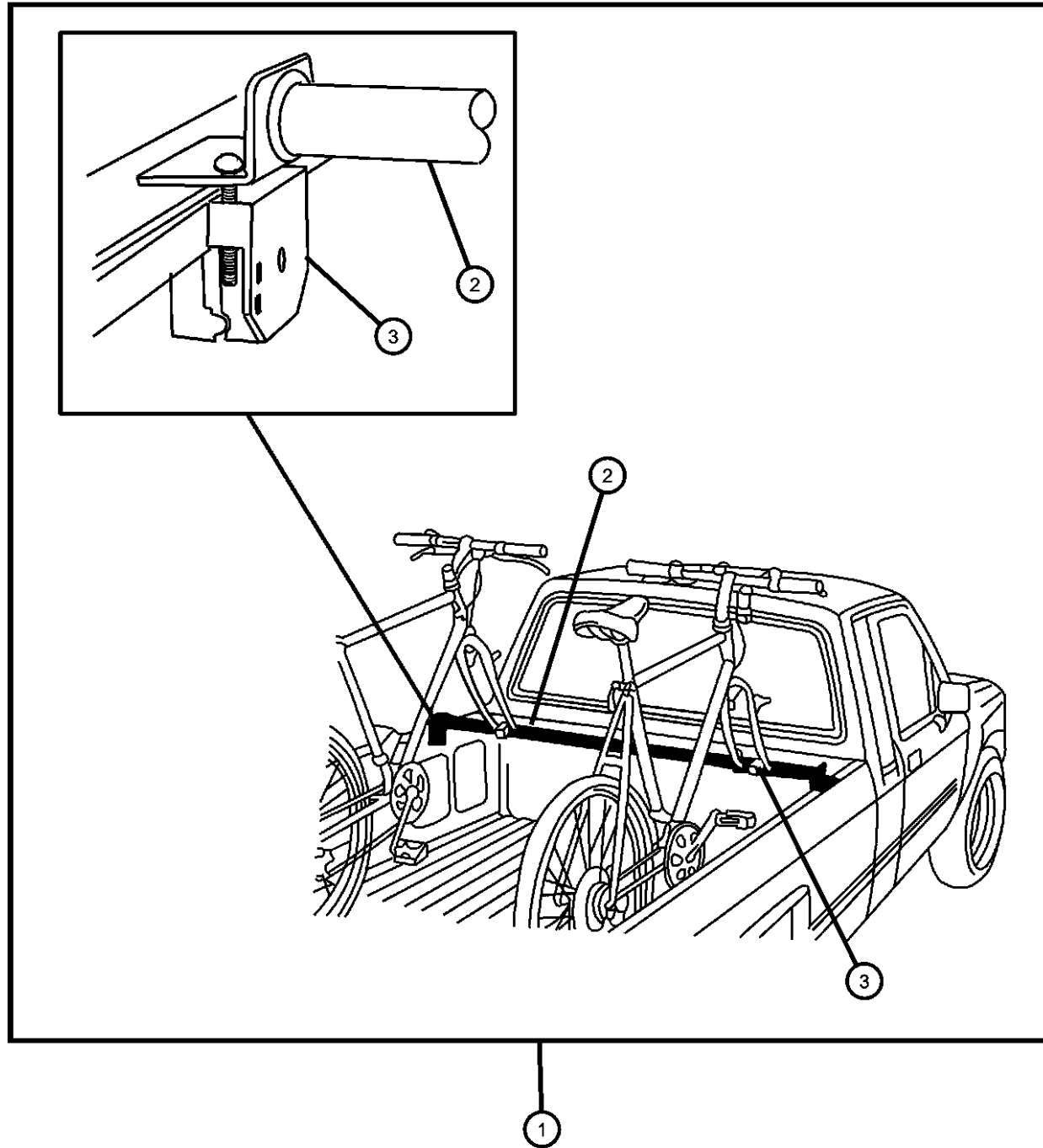

ITEM	PART NUMBER	QTY	LINE	SERIES	BODY	ENGINE	TRANS	TRIM	DESCRIPTION
1	82203189	1	1, 5		31, 61, 84				CARRIER KIT, Bike
2	05018178AA	1	1, 5		31, 61, 84				HARDWARE KIT, Bike Carrier, Telescoping Bar
3	05018184AA	1	1, 5		31, 61, 84				HARDWARE KIT, Bike Carrier, Rail Clamps and Fork Mounts
-4	82203193	1	1, 5		31, 61, 84				ADAPTER KIT, Bike, 4 Bike Conversion
-5	82203191	1	1, 5		31, 61, 84				CARRIER KIT, Bike Wheel
-6	82203192	1	1, 5		31, 61, 84				LOCK KIT, Carrier

DAKOTA (AN)

SERIES LINE
L = Quad Cab 1 = Dakota 2WD
L = Regular Cab 5 = Dakota 4WD
L = Club Cab

BODY
31 = CLUB CAB 2-DR 6.5 FT BOX
61 = REG CAB 6.5 FT BOX
84 = CREW CAB 4-DR W.B.1

ENGINE
EPO = 2.5L 4 Cyl.
EHO = 3.9L 6 Cyl.
EMO = 5.9L 8 Cyl.
EVO = 4.7L Magnum
EHC = 3.9L SMPI V6
EML = 5.9L V8 MPI Engine
EPE = 2.5L POWER TECH I-4 Cyl.
EVA = 4.7L V8 MPI

TRANSMISSION
DDC = TRANSMISSION - 5-SPEED HD MANUAL
DG4 = TRANSMISSION-MULTI-SPEED AUTO, 45RFE
DGK = TRANSMISSION - 4-SPD. AUTOMATIC,42RE
DGT = TRANSMISSION - 4-SPD. AUTOMATIC,46RE
DGO = AUTO. TRANS.

AR = use ase required - = Non illustrated part

Ski Carrier - Two Pair
Figure 1-220

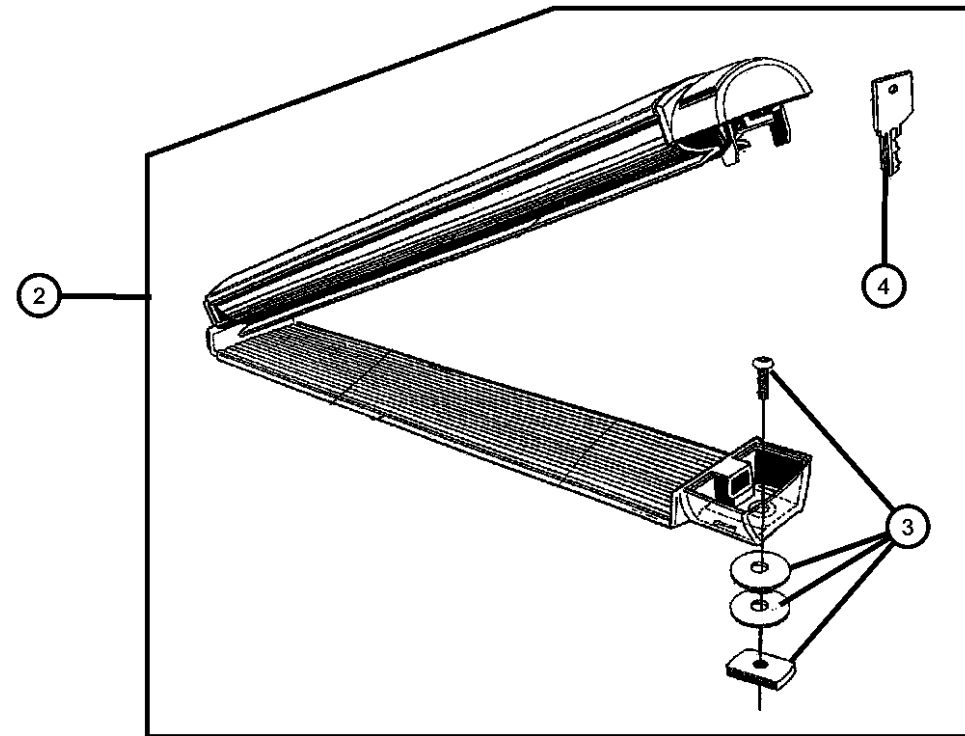
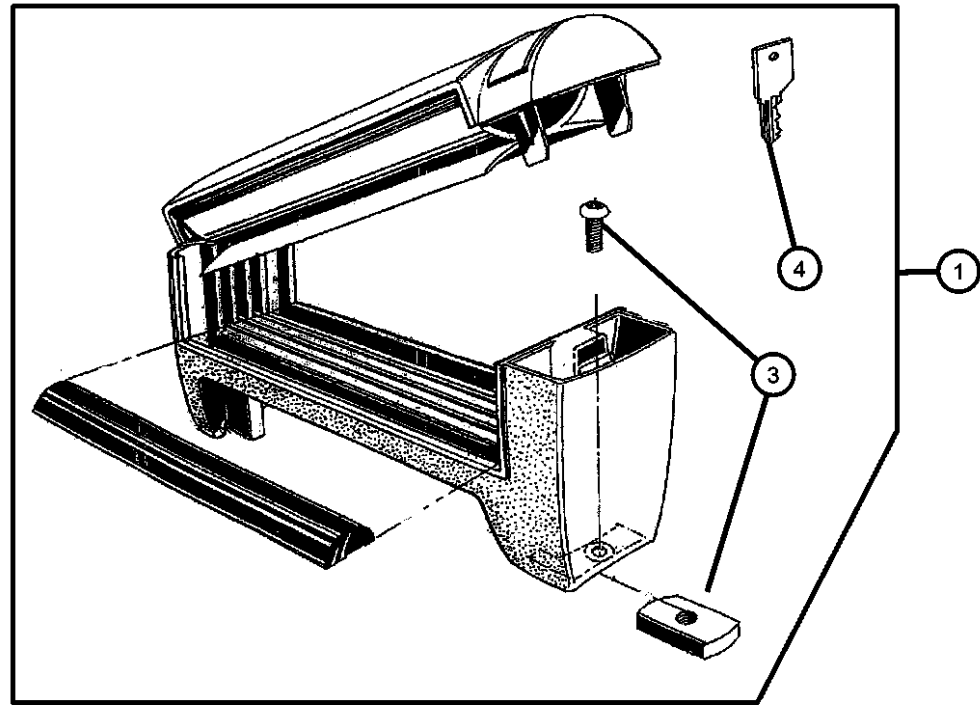

ITEM	PART NUMBER	QTY	LINE	SERIES	BODY	ENGINE	TRANS	TRIM	DESCRIPTION
------	-------------	-----	------	--------	------	--------	-------	------	-------------

NOTE: New keys are Vendor Ship Direct.

1	82203474	1	1, 5		84				CARRIER KIT, Ski - 2 Pair, High Mount
2	82203472	1	1, 5		84				CARRIER KIT, Ski
3	05018389AA	1	1, 5		84				HARDWARE KIT, Mounting High Mount
	05019077AA	1	1, 5		84				
4	05019077AA	1							KEY, Master, (NOT SERVICED)

DAKOTA (AN)

SERIES	LINE
L = Quad Cab	1 = Dakota 2WD
L = Regular Cab	5 = Dakota 4WD
L = Club Cab	

BODY
31 = CLUB CAB 2-DR 6.5 FT BOX
61 = REG CAB 6.5 FT BOX
84 = CREW CAB 4-DR W.B.1

ENGINE
EPO = 2.5L 4 Cyl.
EHO = 3.9L 6 Cyl.
EMO = 5.9L 8 Cyl.
EVO = 4.7L Magnum
EHC = 3.9L SMPI V6
EML = 5.9L V8 MPI Engine
EPE = 2.5L POWER TECH I-4 Cyl.
EVA = 4.7L V8 MPI

TRANSMISSION
DDC = TRANSMISSION - 5-SPEED HD MANUAL
DG4 = TRANSMISSION-MULTI-SPEED AUTO, 45RFE
DGK = TRANSMISSION - 4-SPD. AUTOMATIC,42RE
DGT = TRANSMISSION - 4-SPD. AUTOMATIC,46RE
DGO = AUTO. TRANS.

AR = use ase required - = Non illustrated part

2000 AN

Receiver Kit - Trailer Tow
Figure 1-230

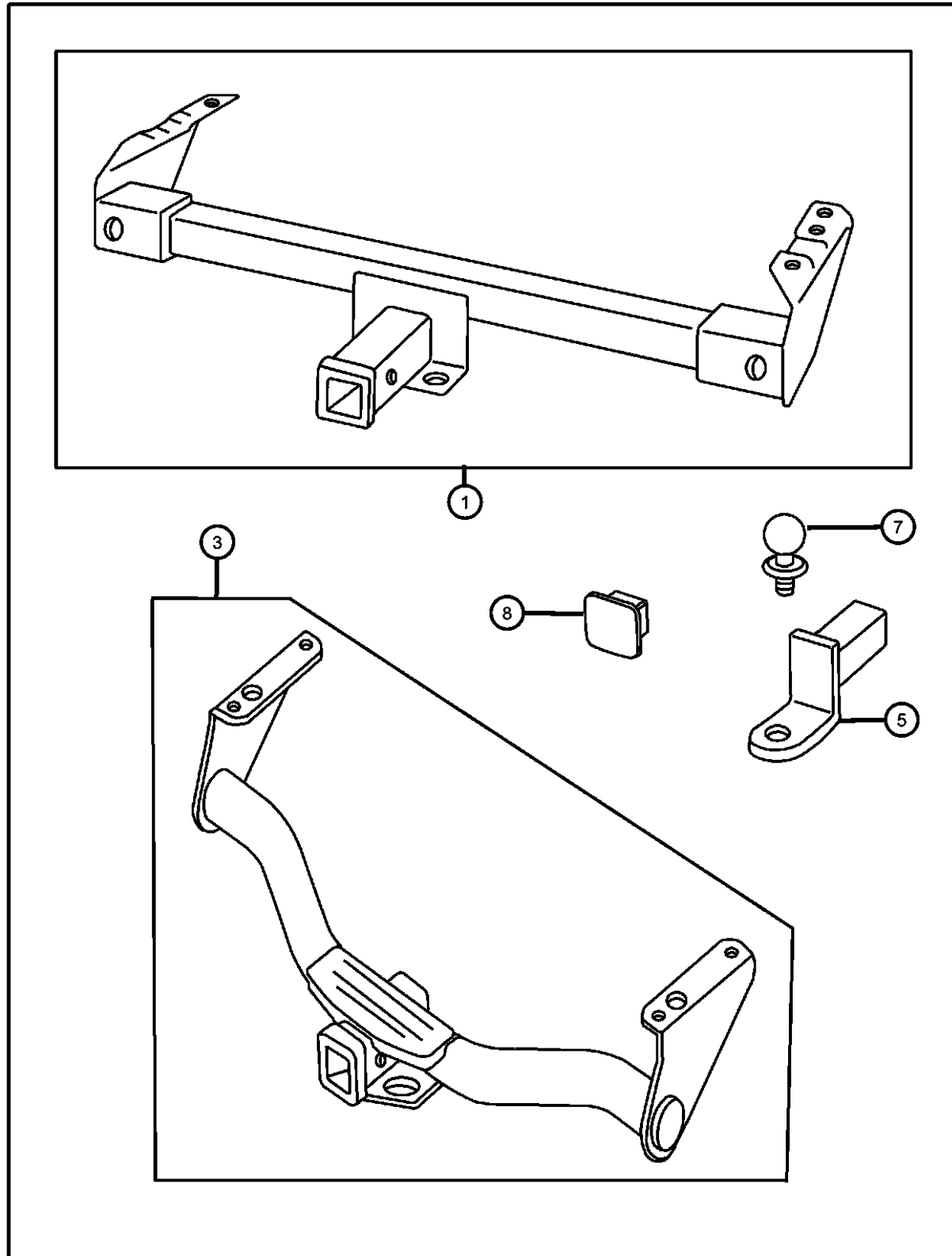

ITEM	PART NUMBER	QTY	LINE	SERIES	BODY	ENGINE	TRANS	TRIM	DESCRIPTION
1	82204712	1	1, 5		31, 61, 84				RECEIVER KIT, Trailer Tow, w/Standard Bumper, Standard Bumper
-2	05018009AA	1	1, 5		31, 61, 84				HARDWARE KIT, Hitch, Used w/82204712
3	82204713	1	1, 5		31, 61, 84				RECEIVER KIT, Trailer Tow, w/Rear Valance Panel
-4	05017945AA	1	1, 5		31, 61, 84				HARDWARE KIT, Hitch
5	82200248	1	1, 5		31, 61, 84				ADAPTER KIT, Ball Mount 3.5' Rise and 2.75' Drop for .75' Shank Ball
	82201148	1	1, 5		31, 61, 84				1.75' Rise and 1.0' Drop for 1.0' Shank Ball
	82201149	1	1, 5		31, 61, 84				3.0' Rise and 2.25' Drop for 1.0' Shank Ball
-6	05016666AA	1	1, 5		31, 61, 84				PIN, Hitch
7	82401102	1	1, 5		31, 61, 84				BALL KIT, Trailer Tow Chrome, 1 7/8' Ball, 1.0' x 2.5' Shank, w/Wrench Flats
	82401103	1	1, 5		31, 61, 84				Chrome, 2.0' Ball, 1.0' x 2.125' Shank, w/Wrench Flats
	82401104	1	1, 5		31, 61, 84				Chrome, 1 7/8' Ball, .75' x 1.75' Shank, w/Wrench Flats
	82401197	1	1, 5		31, 61, 84				Chrome, 1 7/8' Ball, .75' x 2.312' Shank, w/Wrench Flats
	82401218	1	1, 5		31, 61, 84				Chrome, 2.312' Ball, 1.0' x 2.125' Shank, w/Wrench Flats
8	82203601	1	1, 5		31, 61, 84				COVER KIT, Trailer Tow w/Ram Logo
	82203602	1	1, 5		31, 61, 84				w/Mpoar Logo
-9	82401217	1	1, 5		31, 61, 84				ADAPTER KIT, Trailer Tow, 7 Way to 6 Way
-10	56019823	1	1, 5		31, 61, 84				ADAPTER, Trailer Tow, 7 Way to 4 Way

DAKOTA (AN)

SERIES LINE
L = Quad Cab 1 = Dakota 2WD
L = Regular Cab 5 = Dakota 4WD
L = Club Cab

BODY
31 = CLUB CAB 2-DR 6.5 FT BOX
61 = REG CAB 6.5 FT BOX
84 = CREW CAB 4-DR W.B.1

ENGINE
EPO = 2.5L 4 Cyl.
EHO = 3.9L 6 Cyl.
EMO = 5.9L 8 Cyl.
EVO = 4.7L Magnum
EHC = 3.9L SMPI V6
EML = 5.9L V8 MPI Engine
EPE = 2.5L POWER TECH I-4 Cyl.
EVA = 4.7L V8 MPI

TRANSMISSION
DDC = TRANSMISSION - 5-SPEED HD MANUAL
DG4 = TRANSMISSION-MULTI-SPEED AUTO, 45RFE
DGK = TRANSMISSION - 4-SPD. AUTOMATIC, 42RE
DGT = TRANSMISSION - 4-SPD. AUTOMATIC, 46RE
DGO = AUTO. TRANS.

AR = use ase required - = Non illustrated part

2000 AN

Wiring Kit - Trailer Tow - 7 Way
Figure 1-240

ITEM	PART NUMBER	QTY	LINE	SERIES	BODY	ENGINE	TRANS	TRIM	DESCRIPTION
------	-------------	-----	------	--------	------	--------	-------	------	-------------

NOTE:

Will not fit Chassis Cab. Built in Running Light Relay.

1	82204724	1	1, 5		31, 61, 84				WIRING KIT, Trailer Tow - 7 Way
2	06015756	1							STRAP, Tie
3	00154633	4							SCREW, .164-18x.625

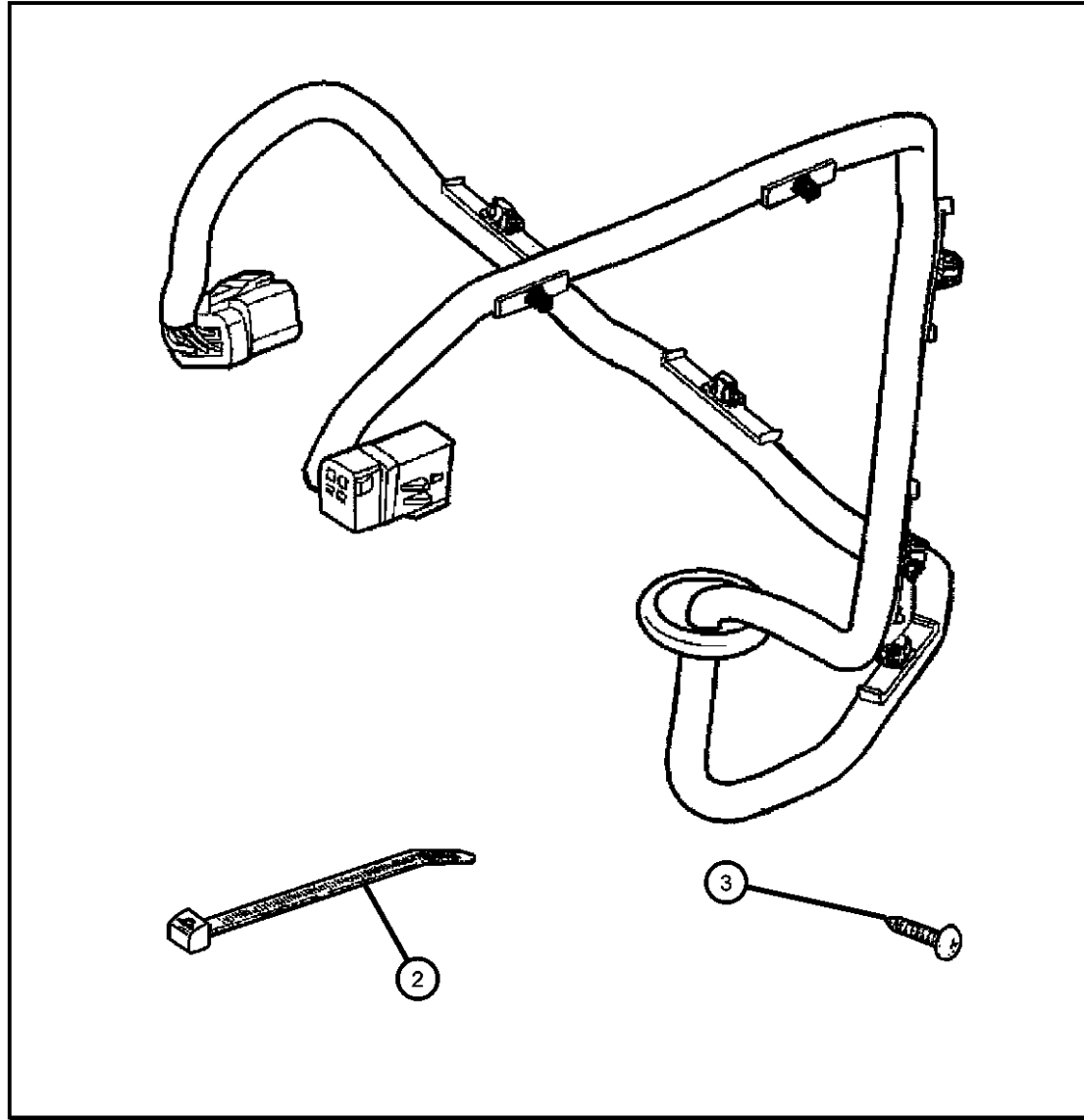

DAKOTA (AN)

SERIES	LINE
L = Quad Cab	1 = Dakota 2WD
L = Regular Cab	5 = Dakota 4WD
L = Club Cab	

BODY
31 = CLUB CAB 2-DR 6.5 FT BOX
61 = REG CAB 6.5 FT BOX
84 = CREW CAB 4-DR W.B.1

ENGINE
EPO = 2.5L 4 Cyl.
EHO = 3.9L 6 Cyl.
EMO = 5.9L 8 Cyl.
EVO = 4.7L Magnum
EHC = 3.9L SMPI V6
EML = 5.9L V8 MPI Engine
EPE = 2.5L POWER TECH I-4 Cyl.
EVA = 4.7L V8 MPI

TRANSMISSION
DDC = TRANSMISSION - 5-SPEED HD MANUAL
DG4 = TRANSMISSION-MULTI-SPEED AUTO, 45RFE
DGK = TRANSMISSION - 4-SPD. AUTOMATIC,42RE
DGT = TRANSMISSION - 4-SPD. AUTOMATIC,46RE
DGO = AUTO. TRANS.

AR = use ase required - = Non illustrated part

2000 AN

Cooler Kit - Transmission Oil
Figure 1-250

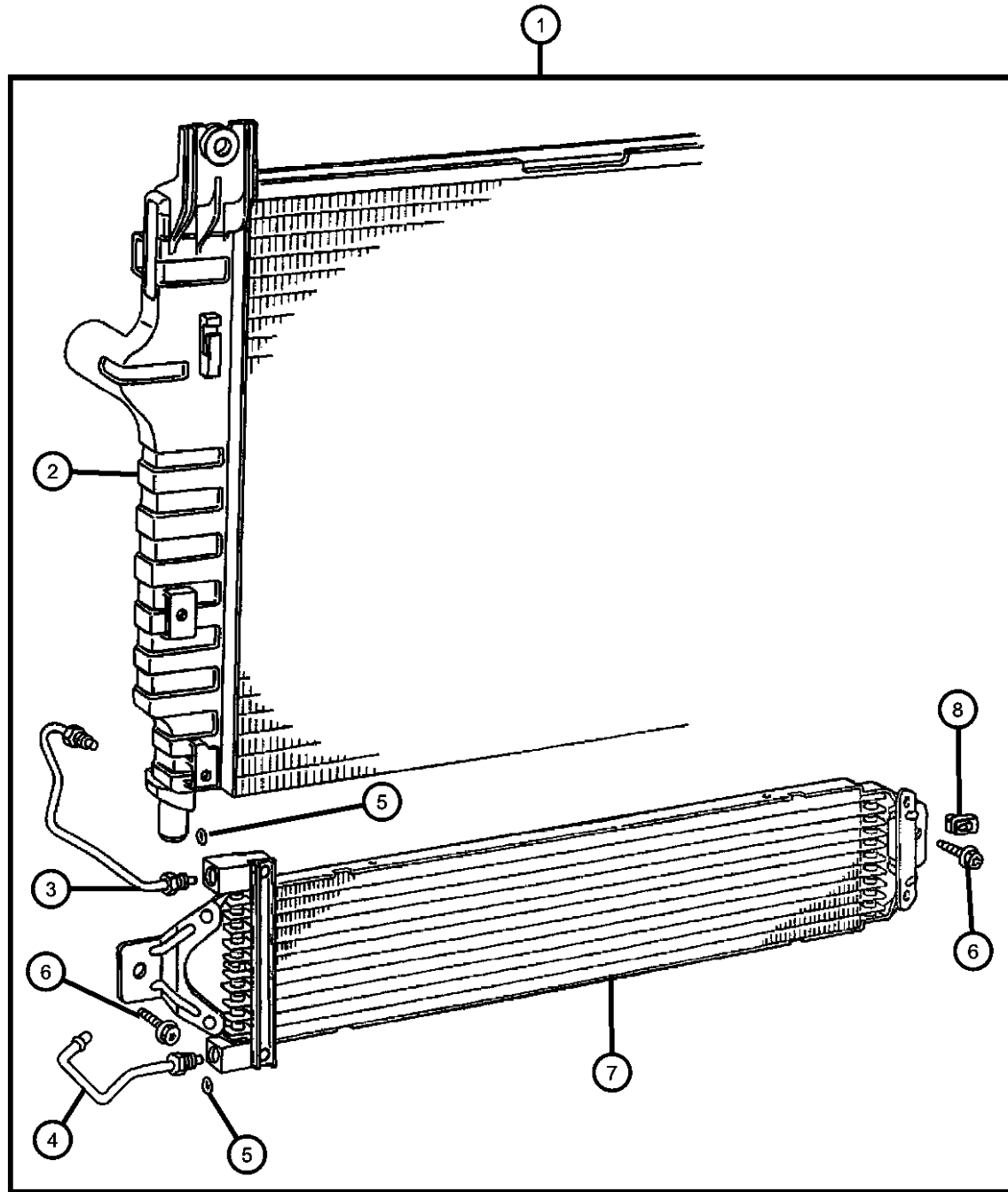

ITEM	PART NUMBER	QTY	LINE	SERIES	BODY	ENGINE	TRANS	TRIM	DESCRIPTION
1	82205677	1	1, 5		31, 61, 84				COOLER KIT, Transmission Oil 3.9L V-6 Engine
	82205678	1	1, 5		31, 61, 84				4.7L, 5.9L V-8 Engines
2	52028816AA	1			31, 61, 84				RADIATOR, Engine Cooling 3.9L V-6 Engine
	04267020AB								Mopar Coolant 3 Year Formula 1 Gallon
	52028818AB	1	1, 5		31, 61, 84				4.7L, 5.9L V-8 Engines
	04267020AB								Mopar Coolant 3 Year Formula 1 Gallon
3	05015416AA	1							TUBE, Oil Cooler, Inlet
4	05015415AA	1							TUBE, Oil Cooler, Outlet
5	05016144AA	2							SEAL, O-Ring
6	04734274	2							SCREW, Decking Bracket
7	52028779AA	1							COOLER, Auxiliary Oil
8	52028779AA	1							U-NUT, M6x1.00, (NOT SERVICED)

DAKOTA (AN)

SERIES	LINE
L = Quad Cab	1 = Dakota 2WD
L = Regular Cab	5 = Dakota 4WD
L = Club Cab	

BODY
31 = CLUB CAB 2-DR 6.5 FT BOX
61 = REG CAB 6.5 FT BOX
84 = CREW CAB 4-DR W.B.1

ENGINE
EPO = 2.5L 4 Cyl.
EHO = 3.9L 6 Cyl.
EMO = 5.9L 8 Cyl.
EVO = 4.7L Magnum
EHC = 3.9L SMPI V6
EML = 5.9L V8 MPI Engine
EPE = 2.5L POWER TECH I-4 Cyl.
EVA = 4.7L V8 MPI

TRANSMISSION
DDC = TRANSMISSION - 5-SPEED HD MANUAL
DG4 = TRANSMISSION-MULTI-SPEED AUTO, 45RFE
DGK = TRANSMISSION - 4-SPD. AUTOMATIC,42RE
DGT = TRANSMISSION - 4-SPD. AUTOMATIC,46RE
DGO = AUTO. TRANS.

AR = use ase required - = Non illustrated part

2000 AN

Cover Kit - Tonneau
Figure 1-260

ITEM	PART NUMBER	QTY	LINE	SERIES	BODY	ENGINE	TRANS	TRIM	DESCRIPTION
------	-------------	-----	------	--------	------	--------	-------	------	-------------

NOTE; Not for use with OverRail Bedliners. Cover Kits have new material and new bow system.

1									COVER, Tonneau
	82202723	1	1, 5		31, 61				Sport Style 6.5' Bed
	82203122	1	1, 5		31, 61				Premium Style 6.5' Bed
-2	05017515AA	1	1, 5		31, 61				SNAP KIT, Tonneau Cover, Replacement Package of 10
3	05018233AA	1	1, 5		31, 61				RAIL KIT, Tonneau - Rear Mounting, Contains: 2 Corner Brackets and Thumb Screws. Rear Rail Mounting.
-4	05018424AA	1	1, 5		31, 61				CLAMP, Cover, 'F' Shaped Clamp is Upper 'J' Shaped Clamp is Lower & 3 Screws for mounting

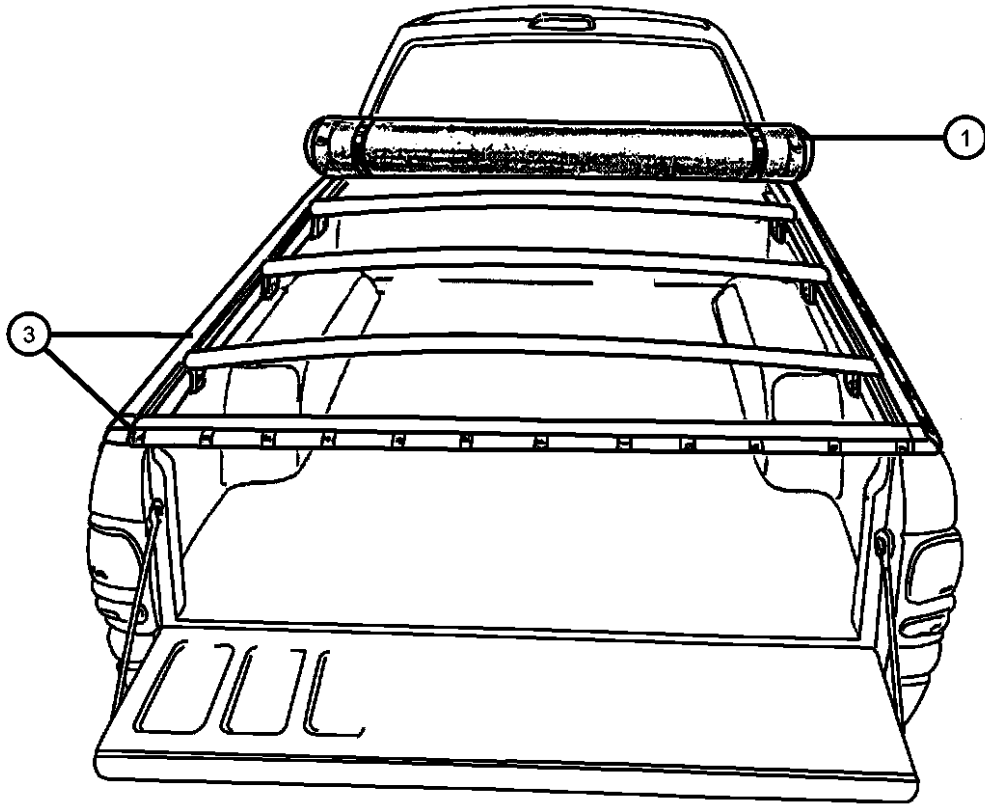

DAKOTA (AN)

SERIES LINE
 L = Quad Cab 1 = Dakota 2WD
 L = Regular Cab 5 = Dakota 4WD
 L = Club Cab

BODY
 31 = CLUB CAB 2-DR 6.5 FT BOX
 61 = REG CAB 6.5 FT BOX
 84 = CREW CAB 4-DR W.B.1

ENGINE
 EPO = 2.5L 4 Cyl.
 EHO = 3.9L 6 Cyl.
 EMO = 5.9L 8 Cyl.
 EVO = 4.7L Magnum
 EHC = 3.9L SMPI V6
 EML = 5.9L V8 MPI Engine
 EPE = 2.5L POWER TECH I-4 Cyl.
 EVA = 4.7L V8 MPI

TRANSMISSION
 DDC = TRANSMISSION - 5-SPEED HD MANUAL
 DG4 = TRANSMISSION-MULTI-SPEED AUTO, 45RFE
 DGK = TRANSMISSION - 4-SPD. AUTOMATIC,42RE
 DGT = TRANSMISSION - 4-SPD. AUTOMATIC,46RE
 DGO = AUTO. TRANS.

AR = use ase required - = Non illustrated part

2000 AN

**Cover Kit - Folding
Figure 1-270**

ITEM	PART NUMBER	QTY	LINE	SERIES	BODY	ENGINE	TRANS	TRIM	DESCRIPTION
------	-------------	-----	------	--------	------	--------	-------	------	-------------

NOTE: The kit contains mounting hardware

1									COVER KIT, Tonneau-Folding
	82202727	1	1, 5		31, 61				
	82205224	1	1, 5		84				
-2									LOCK KIT, Folding-tonneau
	05018118AA	1	1, 5		31, 61				
		1	1, 5		84				
-3									KEY, Master
	05018386AA	1	1, 5		31, 61				
		1	1, 5		84				

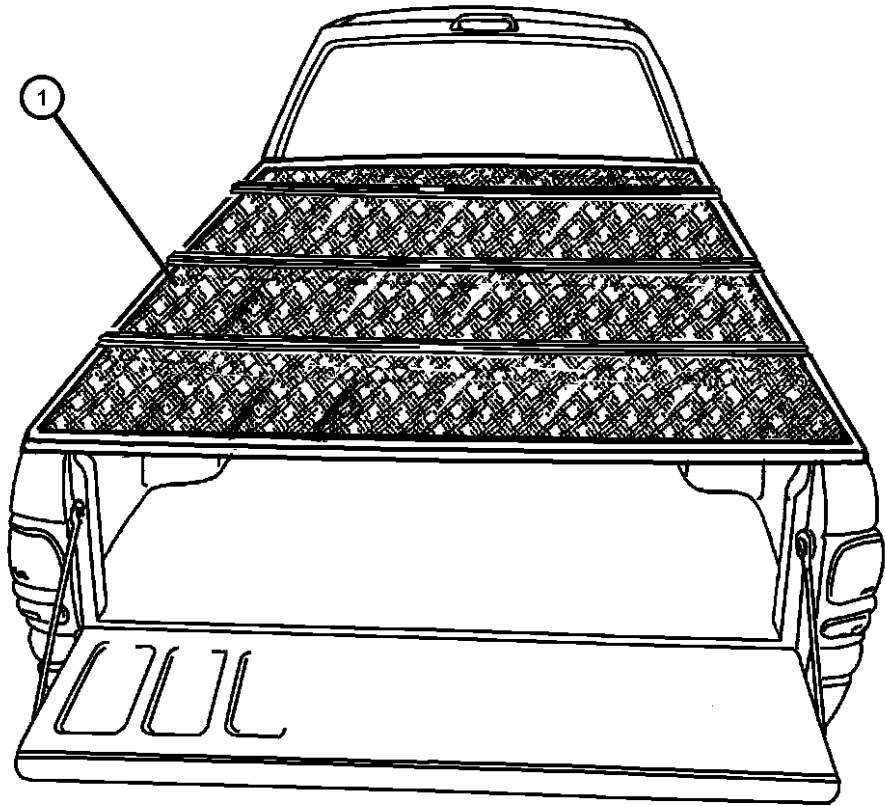

DAKOTA (AN)

SERIES LINE
 L = Quad Cab 1 = Dakota 2WD
 L = Regular Cab 5 = Dakota 4WD
 L = Club Cab

BODY
 31 = CLUB CAB 2-DR 6.5 FT BOX
 61 = REG CAB 6.5 FT BOX
 84 = CREW CAB 4-DR W.B.1

ENGINE
 EPO = 2.5L 4 Cyl.
 EHO = 3.9L 6 Cyl.
 EMO = 5.9L 8 Cyl.
 EVO = 4.7L Magnum
 EHC = 3.9L SMPI V6
 EML = 5.9L V8 MPI Engine
 EPE = 2.5L POWER TECH I-4 Cyl.
 EVA = 4.7L V8 MPI

TRANSMISSION
 DDC = TRANSMISSION - 5-SPEED HD MANUAL
 DG4 = TRANSMISSION-MULTI-SPEED AUTO, 45RFE
 DGK = TRANSMISSION - 4-SPD. AUTOMATIC,42RE
 DGT = TRANSMISSION - 4-SPD. AUTOMATIC,46RE
 DGO = AUTO. TRANS.

AR = use ase required - = Non illustrated part

2000 AN

Cover Kit - Tonneau
Figure 1-280

ITEM	PART NUMBER	QTY	LINE	SERIES	BODY	ENGINE	TRANS	TRIM	DESCRIPTION
------	-------------	-----	------	--------	------	--------	-------	------	-------------

NOTE: Use the Gas Props for the rear only. The kit contains two gas props, gas prop brackets for lid and frame - 2 of each bracket.

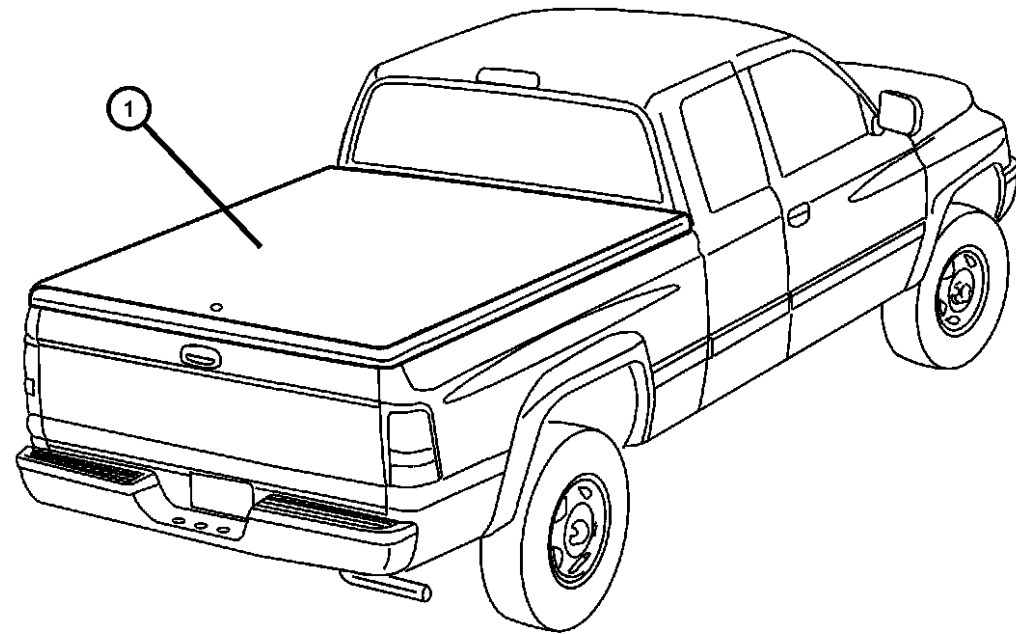

1									COVER KIT, Tonneau-Hard, One Piece, 6.5' Bed
	82204160	1	1, 5		31, 61				Light Weight, w/Hasp on Tailgate, Forrest Green
	82204161	1	1, 5		31, 61				Light Weight, w/Hasp on Tailgate, Deep Amethyst
	82204162	1	1, 5		31, 61				Light Weight, w/Hasp on Tailgate, Intense Blue
	82204366	1	1, 5		31, 61				Black
	82204368	1	1, 5		31, 61				Flame Red
	82204370	1	1, 5		31, 61				White
	82204374	1	1, 5		31, 61				Light Driftwood
	82204376	1	1, 5		31, 61				Radian Red
	82205797	1	1, 5		31, 61				Patriot Blue
	82205798	1	1, 5		31, 61				Dark Garnet Red
	82205799	1	1, 5		31, 61				Sierra Bronze
	82205800	1	1, 5		31, 61				Amber Fire
-2	05018117AA	1	1, 5		31, 61				LOCK KIT, Hard-tonneau
-3	05018343AA	1	1, 5		31, 61				KEY, Master

4									COVER KIT, Tonneau-Hard, Three Piece
	82205069	1			84				Black
	82205070	1	1, 5		84				
	82205071	1			84				Driftwood
	82205072	1			84				Flame Red
	82205073	1			84				Forrest Green
	82205074	1			84				Intense Blue
	82205075	1			84				Solar Yellow
	82205076	1			84				Patriot Blue
	82205077	1			84				Garnet Red
	82205078	1			84				Medium Bronze
	82205079	1			84				Amber Fire
-5									GAS PROP KIT, Tonneau-hard
	05018067AA	1			84				Pair includes brackets

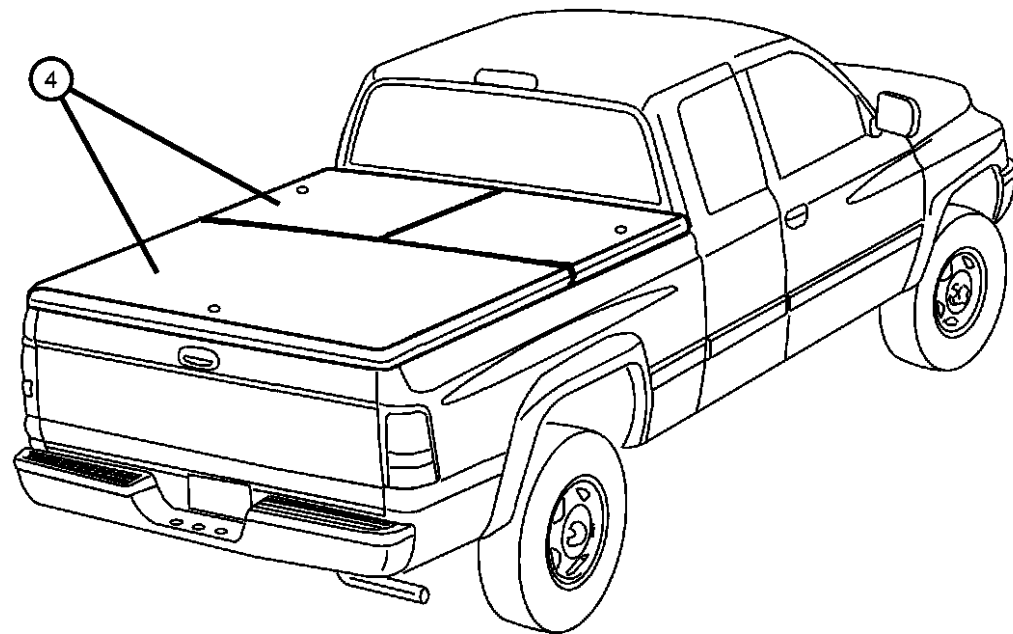

DAKOTA (AN)

SERIES LINE
 L = Quad Cab 1 = Dakota 2WD
 L = Regular Cab 5 = Dakota 4WD
 L = Club Cab

BODY
 31 = CLUB CAB 2-DR 6.5 FT BOX
 61 = REG CAB 6.5 FT BOX
 84 = CREW CAB 4-DR W.B.1

ENGINE
 EPO = 2.5L 4 Cyl.
 EHO = 3.9L 6 Cyl.
 EMO = 5.9L 8 Cyl.
 EVO = 4.7L Magnum
 EHC = 3.9L SMPI V6
 EML = 5.9L V8 MPI Engine
 EPE = 2.5L POWER TECH I-4 Cyl.
 EVA = 4.7L V8 MPI

TRANSMISSION
 DDC = TRANSMISSION - 5-SPEED HD MANUAL
 DG4 = TRANSMISSION-MULTI-SPEED AUTO, 45RFE
 DGK = TRANSMISSION - 4-SPD. AUTOMATIC,42RE
 DGT = TRANSMISSION - 4-SPD. AUTOMATIC,46RE
 DGO = AUTO. TRANS.

AR = use ase required - = Non illustrated part

2000 AN

**Cover Kit - Tonneau
Figure 1-280**

ITEM	PART NUMBER	QTY	LINE	SERIES	BODY	ENGINE	TRANS	TRIM	DESCRIPTION
	05018201AA	1			84				Gas Struts for the front
-6	05018117AA	1							LOCK KIT, Hard-tonneau
-7	05018343AA	1							KEY, Master

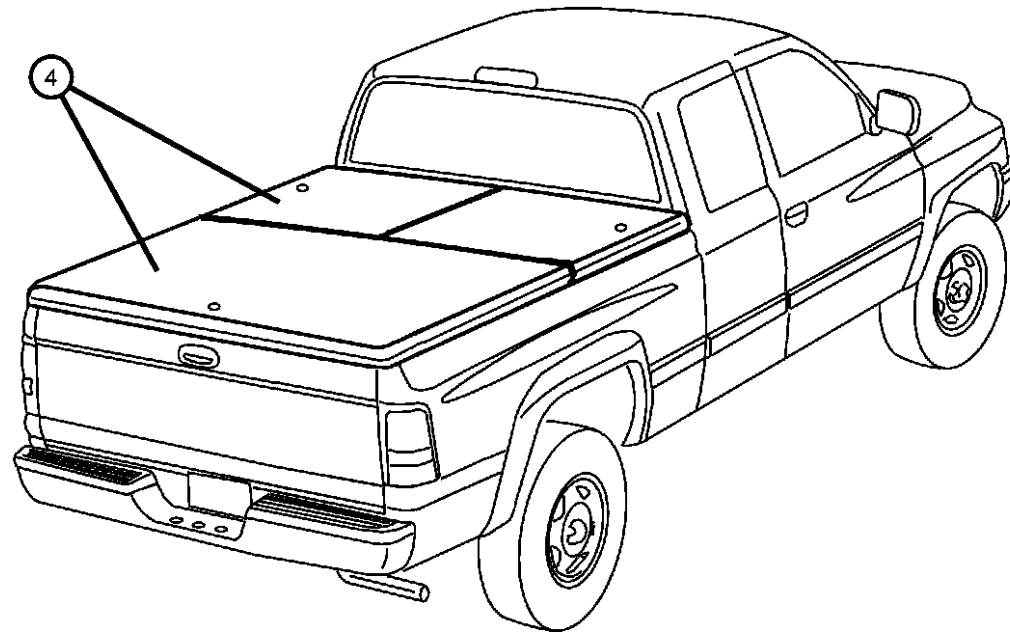
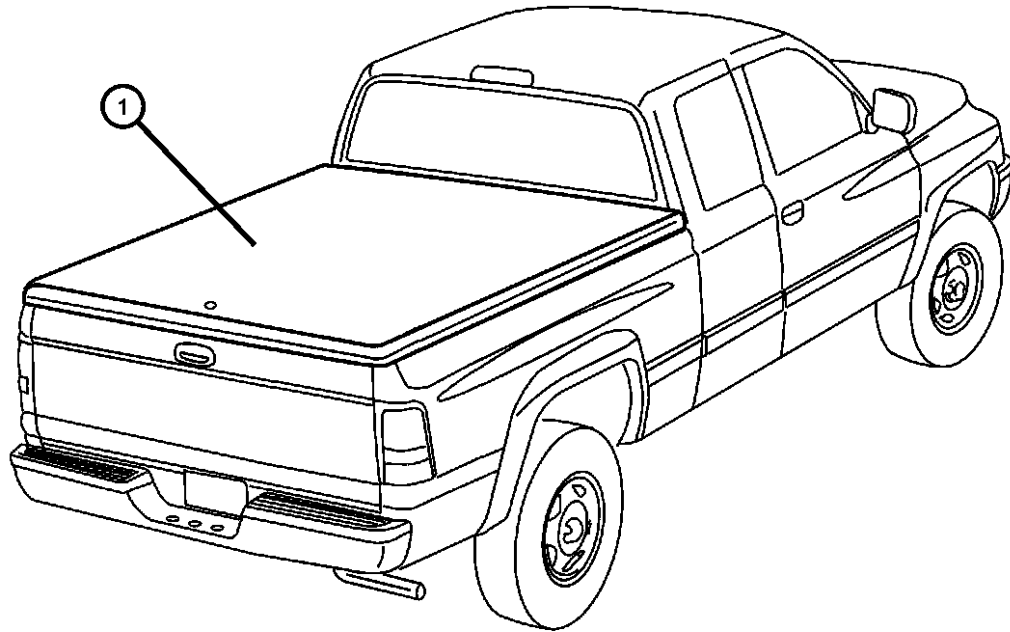

DAKOTA (AN)

SERIES LINE
 L = Quad Cab 1 = Dakota 2WD
 L = Regular Cab 5 = Dakota 4WD
 L = Club Cab

BODY
 31 = CLUB CAB 2-DR 6.5 FT BOX
 61 = REG CAB 6.5 FT BOX
 84 = CREW CAB 4-DR W.B.1

ENGINE
 EPO = 2.5L 4 Cyl.
 EHO = 3.9L 6 Cyl.
 EMO = 5.9L 8 Cyl.
 EVO = 4.7L Magnum
 EHC = 3.9L SMPI V6
 EML = 5.9L V8 MPI Engine
 EPE = 2.5L POWER TECH I-4 Cyl.
 EVA = 4.7L V8 MPI

TRANSMISSION
 DDC = TRANSMISSION - 5-SPEED HD MANUAL
 DG4 = TRANSMISSION-MULTI-SPEED AUTO, 45RFE
 DGK = TRANSMISSION - 4-SPD. AUTOMATIC,42RE
 DGT = TRANSMISSION - 4-SPD. AUTOMATIC,46RE
 DGO = AUTO. TRANS.

AR = use ase required - = Non illustrated part

**Speed Control Kit
Figure 1-310**

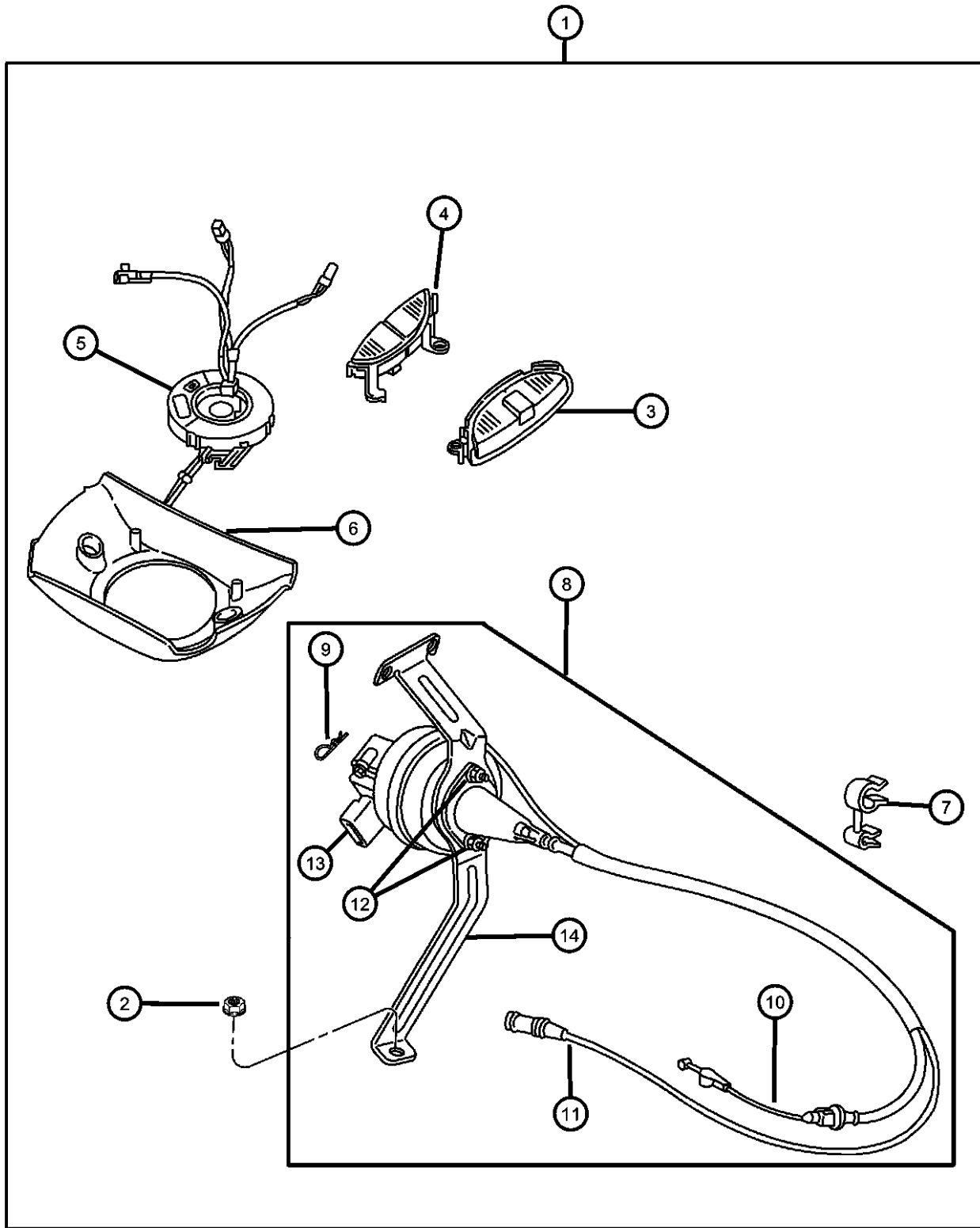

ITEM	PART NUMBER	QTY	LINE	SERIES	BODY	ENGINE	TRANS	TRIM	DESCRIPTION
1									CONTROL PACKAGE, Speed Control
	82205670	1	1, 5		31, 61, 84				3.9L V-6 Engine
	82205855	1	1, 5		31, 61, 84				4.7L V-8 Engine
	82205856	1	1, 5		31, 61, 84				5.9L V-8 Engine
2	82205856	1							NUT AND WASHER, M6x1.00, (NOT SERVICED),
3	56007630AB	1	1, 5		31, 61, 84				SWITCH, Speed ControlRight
4	56007631AB	1	1, 5		31, 61, 84				SWITCH, Speed ControlLeft
5	56045455AD	1							CLOCKSPRING
6	04897002AA	1	1, 5		31, 61, 84				SHROUD, Steering Column
7	53031995AA	1			31, 61, 84				CLIP, Cruise Control
8	53031995AA	1							CONTROL, Speed, Service Component Parts, (NOT SERVICED)
9	06025867	1							CLIP, Cable to Servo Attach
10									CABLE, Speed Control
	05015853AA	1							5.9L V-8 Engine
	05015856AA	1							3.9L V-6 Engine
	05015857AB	1							4.7L V-8 Engine
11									HARNESS, Speed Control Vacuum
	05015845AA	1							5.9L V-8 Engine
		1							3.9L V-6 Engine
	05015846AA	1							4.7L V-8 Engine
12	06500274	2							LOCK NUT, M6x1.0x6
13	04669977	1							SERVO, Speed Control
14	05015843AA	1							BRACKET, Cruise Control Servo

DAKOTA (AN)

SERIES	LINE
L = Quad Cab	1 = Dakota 2WD
L = Regular Cab	5 = Dakota 4WD
L = Club Cab	

BODY
31 = CLUB CAB 2-DR 6.5 FT BOX
61 = REG CAB 6.5 FT BOX
84 = CREW CAB 4-DR W.B.1

ENGINE
EPO = 2.5L 4 Cyl.
EHO = 3.9L 6 Cyl.
EMO = 5.9L 8 Cyl.
EVO = 4.7L Magnum
EHC = 3.9L SMPI V6
EML = 5.9L V8 MPI Engine
EPE = 2.5L POWER TECH I-4 Cyl.
EVA = 4.7L V8 MPI

TRANSMISSION
DDC = TRANSMISSION - 5-SPEED HD MANUAL
DG4 = TRANSMISSION-MULTI-SPEED AUTO, 45RFE
DGK = TRANSMISSION - 4-SPD. AUTOMATIC,42RE
DGT = TRANSMISSION - 4-SPD. AUTOMATIC,46RE
DGO = AUTO. TRANS.

AR = use ase required - = Non illustrated part

2000 AN

Mounting Kit - Cellular Phone
Figure 1-320

ITEM	PART NUMBER	QTY	LINE	SERIES	BODY	ENGINE	TRANS	TRIM	DESCRIPTION
1	82205268	1	1, 5		31, 61, 84				MOUNTING KIT, Cellular Phone
2	05018103AA	1	1, 5		31, 61, 84				HARDWARE KIT, Accessory, Long Support Feet
3	05018104AA	1	1, 5		31, 61, 84				CORD, Cellular Phone

NOTE: Smart Holder and Bracket Assy. Bracket to be black powder coated low gloss.
 NOTE: Holds any wireless handset. Installs to instrument panel.

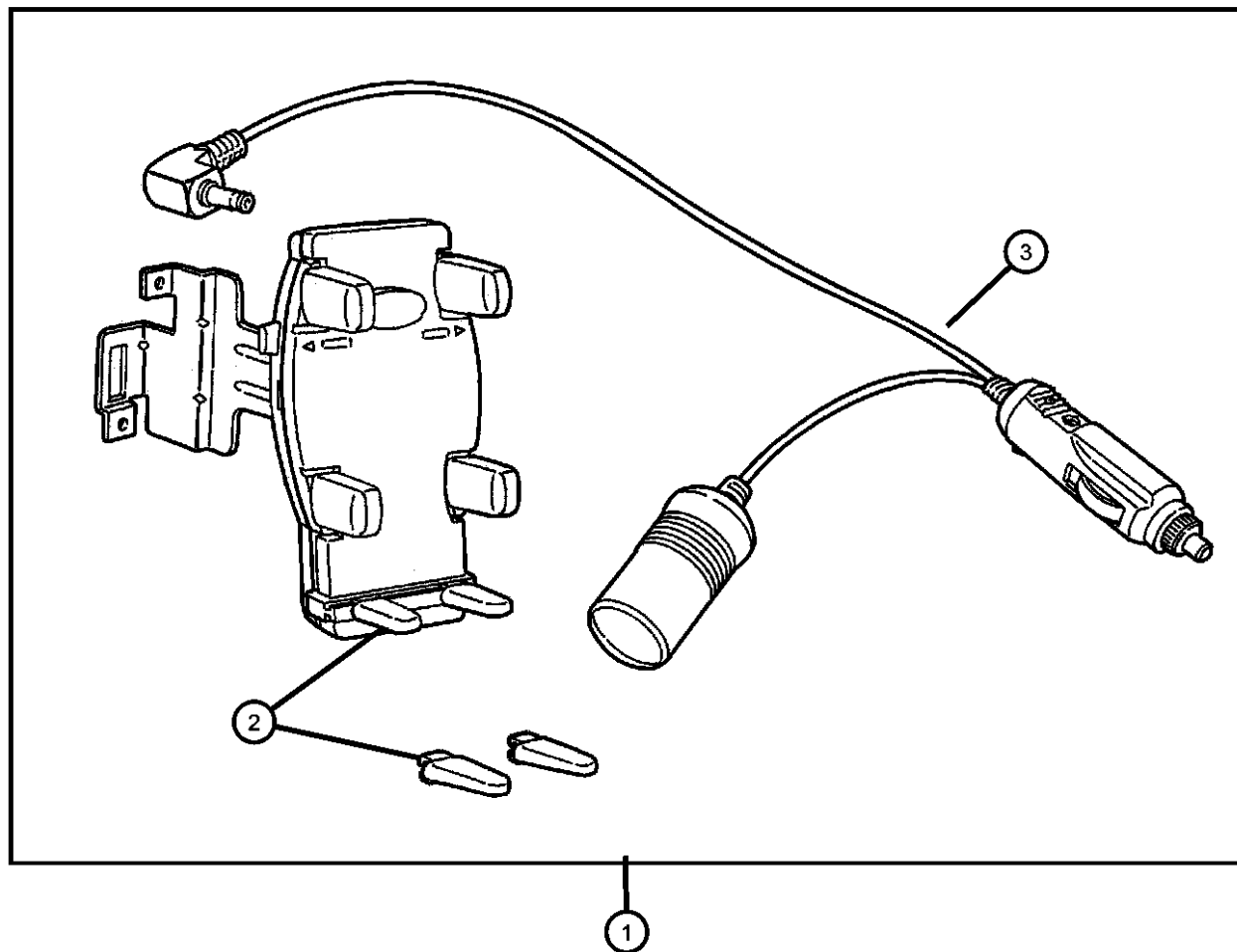

DAKOTA (AN)

SERIES	LINE
L = Quad Cab	1 = Dakota 2WD
L = Regular Cab	5 = Dakota 4WD
L = Club Cab	

BODY
31 = CLUB CAB 2-DR 6.5 FT BOX
61 = REG CAB 6.5 FT BOX
84 = CREW CAB 4-DR W.B.1

ENGINE
EPO = 2.5L 4 Cyl.
EHO = 3.9L 6 Cyl.
EMO = 5.9L 8 Cyl.
EVO = 4.7L Magnum
EHC = 3.9L SMPI V6
EML = 5.9L V8 MPI Engine
EPE = 2.5L POWER TECH I-4 Cyl.
EVA = 4.7L V8 MPI

TRANSMISSION
DDC = TRANSMISSION - 5-SPEED HD MANUAL
DG4 = TRANSMISSION-MULTI-SPEED AUTO, 45RFE
DGK = TRANSMISSION - 4-SPD. AUTOMATIC,42RE
DGT = TRANSMISSION - 4-SPD. AUTOMATIC,46RE
DGO = AUTO. TRANS.

AR = use ase required - = Non illustrated part

**Wheel Lip Mouldings
Figure 1-410**

ITEM	PART NUMBER	QTY	LINE	SERIES	BODY	ENGINE	TRANS	TRIM	DESCRIPTION
------	-------------	-----	------	--------	------	--------	-------	------	-------------

NOTE: Mounting Hardware is included in Wheel Lip Moulding Kits.

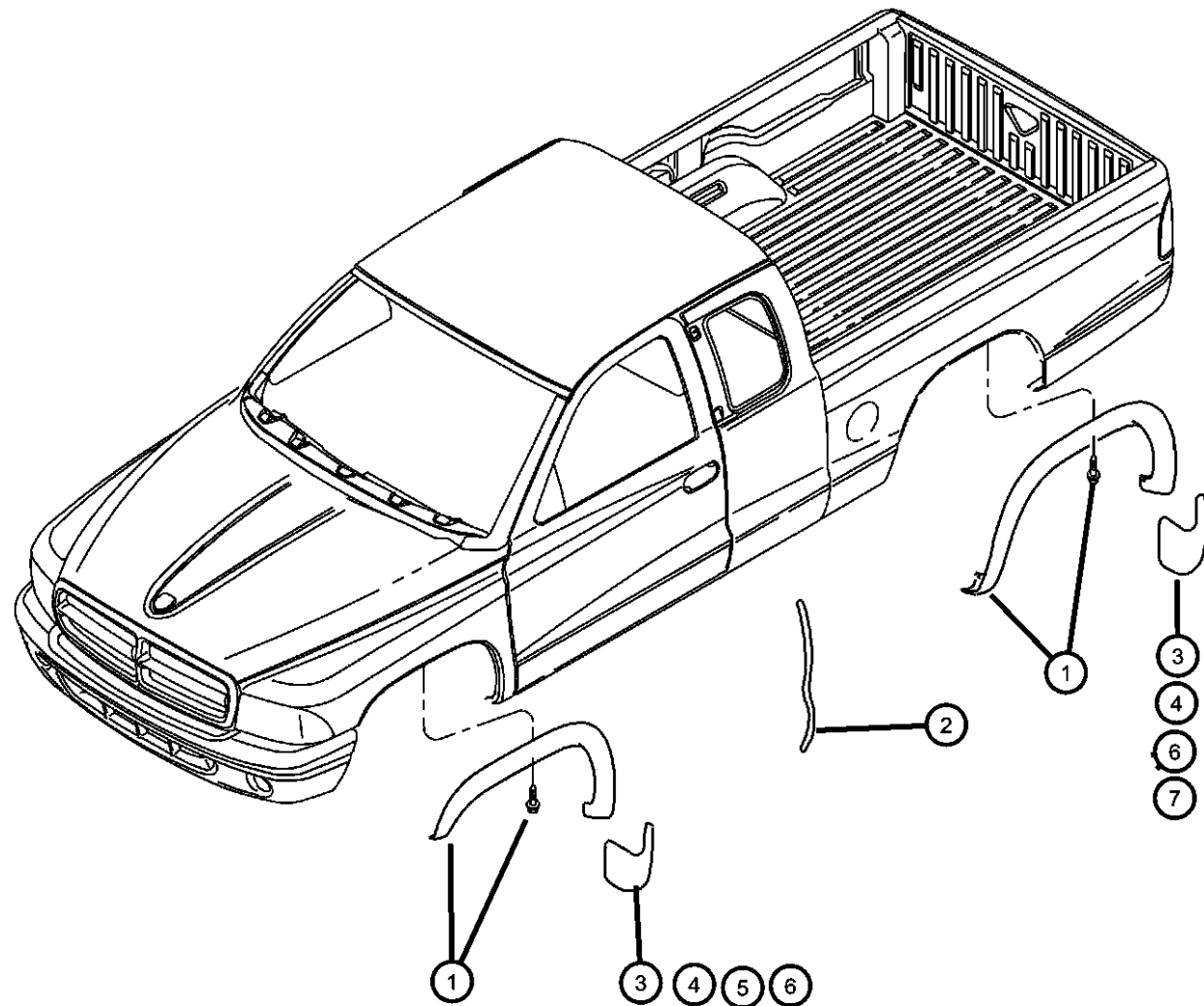

1									MOLDING KIT, Wheel Lip Opening
	82202877	1	1, 5		31, 61				Light Driftwood [PFA]
	82202882	1	1, 5		31, 61				Metallic Red [PRF]
	82202883	1	1, 5		31, 61				Flame Red [PR4]
	82202884	1	1, 5		31, 61				Black [PX8]
	82202885	1	1, 5		31, 61				Bright White [PW7]
	82204179	1	1, 5		31, 61				Forest Green [PG8]
	82204180	1	1, 5		31, 61				Intense Blue [PB3]
	82204181	1	1, 5		31, 61				Deep Amethyst [PCU]
	82205251	1	1, 5		84				Amber Fire [PV3]
	82205252	1	1, 5		84				Black [PX8]
	82205253	1	1, 5		84				Bright White [PW7]
	82205254	1	1, 5		84				Dark Garnet Red [PRV]
	82205255	1	1, 5		84				Flame Red [PR4]
	82205256	1	1, 5		84				Forest Green [PG8]
	82205257	1	1, 5		84				Intense Blue [PB3]
	82205258	1	1, 5		84				Light Driftwood [PFA]
	82205259	1	1, 5		84				Patriot Blue [PBT]
	82205260	1	1, 5		84				Sierra Bronze [PTL]
	82205261	1	1, 5		84				Solar Yellow [PYH]
	82205806	1	1, 5		31, 61				Amber Fire [PV3]
	82205807	1	1, 5		31, 61				Dark Garnet Red [PRV]
	82205808	1	1, 5		31, 61				Patriot Blue [PBT]
	82205809	1	1, 5		31, 61				Sierra Bronze [PTL]
2	82202760	1	1, 5		31, 61, 84				GUARD KIT, Door Edge
3	82202719	1	1, 5		31, 61, 84				GUARD KIT, Splash Molded
4									GUARD KIT, Splash Flat - Front and Rear
	82202909	1	1		31, 61, 84				Black Rubber with Dodge Logo, 2WD
	82202910	1	5		31, 61, 84				Black Rubber with Dodge Logo,4WD

DAKOTA (AN)

SERIES LINE
 L = Quad Cab 1 = Dakota 2WD
 L = Regular Cab 5 = Dakota 4WD
 L = Club Cab

BODY
 31 = CLUB CAB 2-DR 6.5 FT BOX
 61 = REG CAB 6.5 FT BOX
 84 = CREW CAB 4-DR W.B.1

ENGINE
 EPO = 2.5L 4 Cyl.
 EHO = 3.9L 6 Cyl.
 EMO = 5.9L 8 Cyl.
 EVO = 4.7L Magnum
 EHC = 3.9L SMPI V6
 EML = 5.9L V8 MPI Engine
 EPE = 2.5L POWER TECH I-4 Cyl.
 EVA = 4.7L V8 MPI

TRANSMISSION
 DDC = TRANSMISSION - 5-SPEED HD MANUAL
 DG4 = TRANSMISSION-MULTI-SPEED AUTO, 45RFE
 DGK = TRANSMISSION - 4-SPD. AUTOMATIC,42RE
 DGT = TRANSMISSION - 4-SPD. AUTOMATIC,46RE
 DGO = AUTO. TRANS.

AR = use ase required - = Non illustrated part

2000 AN

Wheel Lip Mouldings
Figure 1-410

ITEM	PART NUMBER	QTY	LINE	SERIES	BODY	ENGINE	TRANS	TRIM	DESCRIPTION
	82202911	1	1		31, 61, 84				
	82202912	1	5		31, 61, 84				
5	82203473	1	1, 5		31, 61, 84				GUARD KIT, Splash Molded - Front
6									GUARD KIT, Splash Flat
	82203704	1	1		31, 61, 84				
	82203705	1	1, 5		31, 61, 84				
7									GUARD KIT, Splash Molded - Rear
	82203619	1	1, 5		31, 61				
	82204879	1							

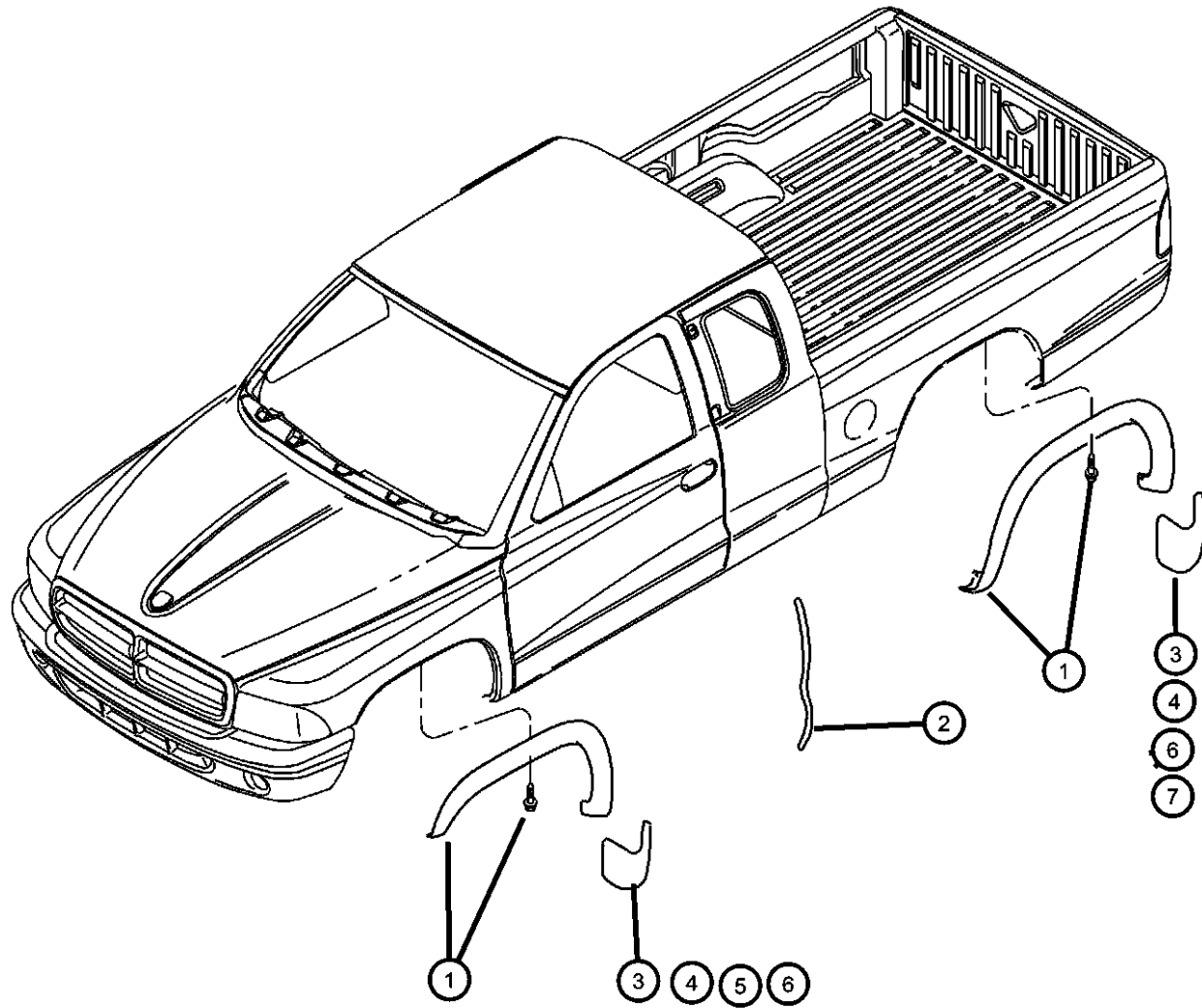

DAKOTA (AN)

SERIES LINE
L = Quad Cab 1 = Dakota 2WD
L = Regular Cab 5 = Dakota 4WD
L = Club Cab

BODY
31 = CLUB CAB 2-DR 6.5 FT BOX
61 = REG CAB 6.5 FT BOX
84 = CREW CAB 4-DR W.B.1

ENGINE
EPO = 2.5L 4 Cyl.
EHO = 3.9L 6 Cyl.
EMO = 5.9L 8 Cyl.
EVO = 4.7L Magnum
EHC = 3.9L SMPI V6
EML = 5.9L V8 MPI Engine
EPE = 2.5L POWER TECH I-4 Cyl.
EVA = 4.7L V8 MPI

TRANSMISSION
DDC = TRANSMISSION - 5-SPEED HD MANUAL
DG4 = TRANSMISSION-MULTI-SPEED AUTO, 45RFE
DGK = TRANSMISSION - 4-SPD. AUTOMATIC,42RE
DGT = TRANSMISSION - 4-SPD. AUTOMATIC,46RE
DGO = AUTO. TRANS.

AR = use ase required - = Non illustrated part

2000 AN

**Grille and Brush Guards
Figure 1-420**

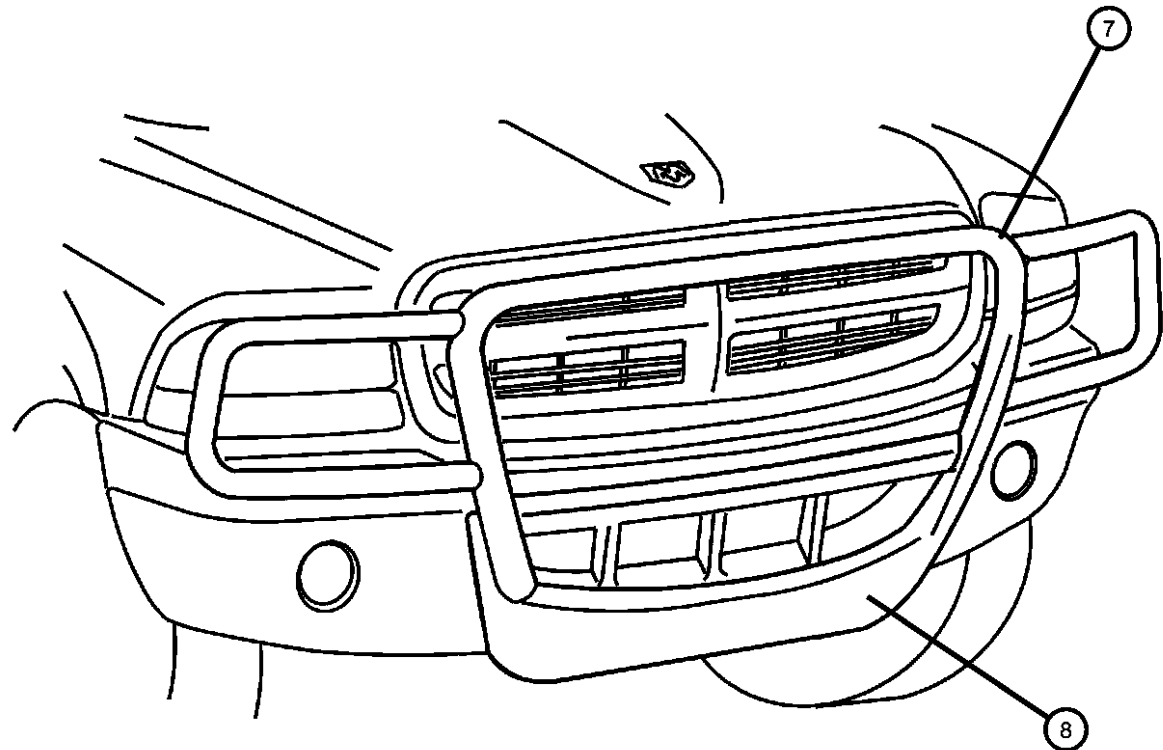
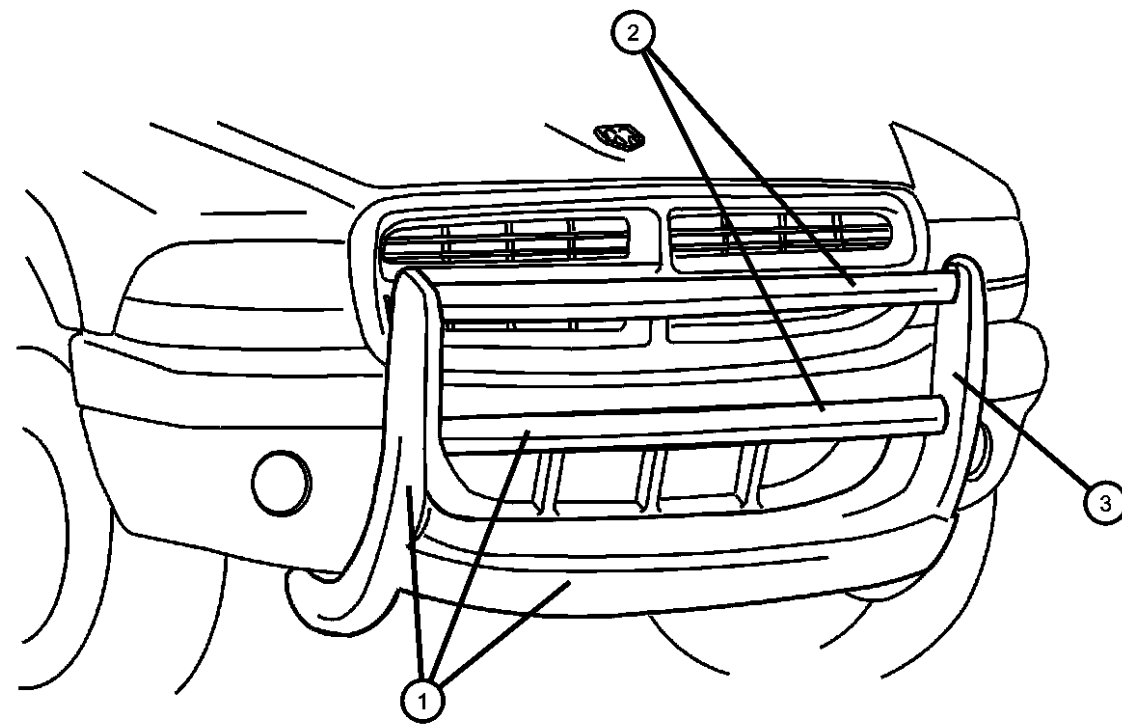

ITEM	PART NUMBER	QTY	LINE	SERIES	BODY	ENGINE	TRANS	TRIM	DESCRIPTION
1									GUARD KIT, Grille, With Lower Fascia
	82202741	1	1, 5		31, 61, 84				Black, Fog Lamp Provision
	82202979	1	1, 5		31, 61, 84				Flame Red, Fog Lamp Provision
	82202980	1	1, 5		31, 61, 84				White, Fog Lamp Provision
	82203796	1	1, 5		31, 61, 84				Chili Pepper Red, Fog Lamp Provision
	82203797	1	1, 5		31, 61, 84				Light Driftwood, Fog Lamp Provision
	82203798	1	1, 5		31, 61, 84				Forest Green, Fog Lamp Provision
	82203799	1	1, 5		31, 61, 84				Deep Amethyst, Fog Lamp Provision
	82203800	1	1, 5		31, 61, 84				Intense Blue, Fog Lamp Provision
2	05018326AA	1	1, 5		31, 61, 84				CROSSTUBE, Grille Guard, Paint as Required
3									END CAP, Grille Guard
	05018328AA	1	1, 5		31, 61, 84				Right
	05018329AA	1	1, 5		31, 61, 84				Left
-4									GUARD KIT, Grille, Without Lower Fascia
	82203185	1	1, 5		31, 61, 84				Black Painted Steel, Fog Lamp Provisions
	82203186	1	1, 5		31, 61, 84				Natural Finish Aluminum, Fog Lamp Provisions
	82203187	1	1, 5		31, 61, 84				Black Anodized Aluminum, Fog Lamp Provisions
	82203188	1	1, 5		31, 61, 84				Chrome Finish Steel, Fog Lamp Provisions
-5									CROSSTUBE, Grille Guard
	05018326AA	1	1, 5		31, 61, 84				Paint as Required, Cross Tubes
	05018438AA	1	1, 5		31, 61, 84				Chrome Finish, Cross Tubes
	05018439AA	1	1, 5		31, 61, 84				Natural Finish Aluminum, Cross Tubes
	05018440AA	1	1, 5		31, 61, 84				Black Anodized, Cross Tubes
-6									END CAP, Grille Guard
	05018328AA	1	1, 5		31, 61, 84				Right
	05018329AA	1	1, 5		31, 61, 84				Left

DAKOTA (AN)

SERIES LINE
 L = Quad Cab 1 = Dakota 2WD
 L = Regular Cab 5 = Dakota 4WD
 L = Club Cab

BODY
 31 = CLUB CAB 2-DR 6.5 FT BOX
 61 = REG CAB 6.5 FT BOX
 84 = CREW CAB 4-DR W.B.1

ENGINE
 EPO = 2.5L 4 Cyl.
 EHO = 3.9L 6 Cyl.
 EMO = 5.9L 8 Cyl.
 EVO = 4.7L Magnum
 EHC = 3.9L SMPI V6
 EML = 5.9L V8 MPI Engine
 EPE = 2.5L POWER TECH I-4 Cyl.
 EVA = 4.7L V8 MPI

TRANSMISSION
 DDC = TRANSMISSION - 5-SPEED HD MANUAL
 DG4 = TRANSMISSION-MULTI-SPEED AUTO, 45RFE
 DGK = TRANSMISSION - 4-SPD. AUTOMATIC,42RE
 DGT = TRANSMISSION - 4-SPD. AUTOMATIC,46RE
 DGO = AUTO. TRANS.

AR = use ase required - = Non illustrated part

**Grille and Brush Guards
Figure 1-420**

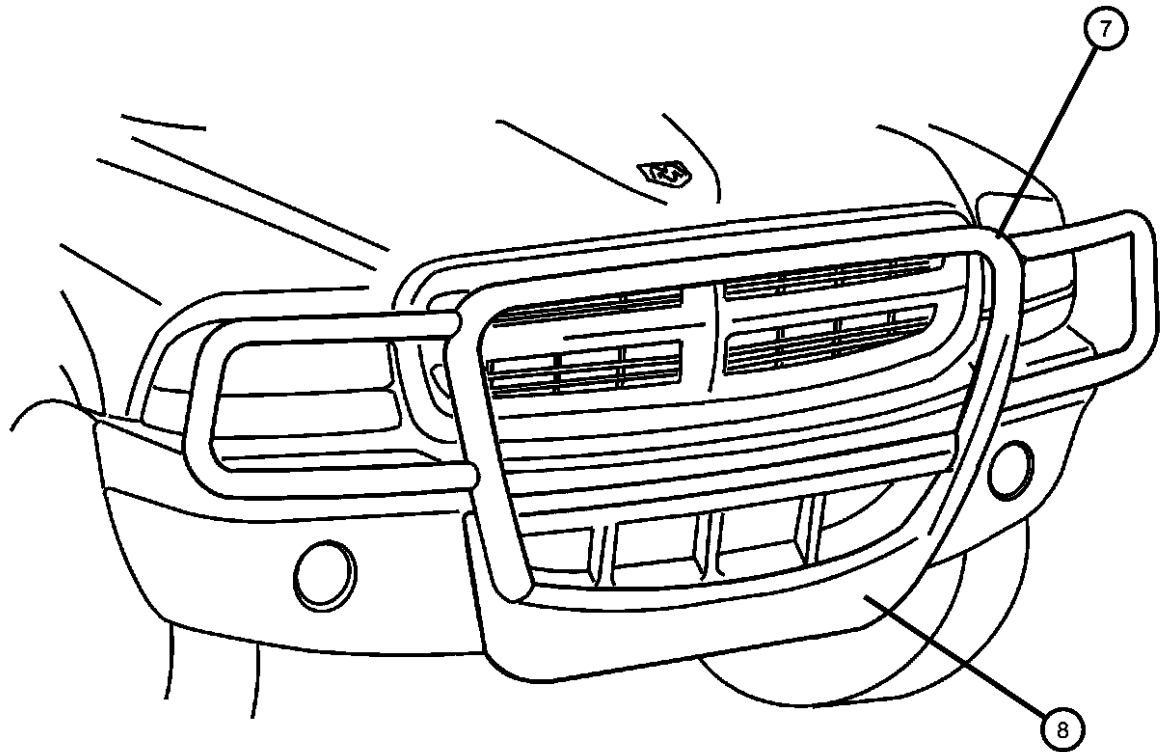
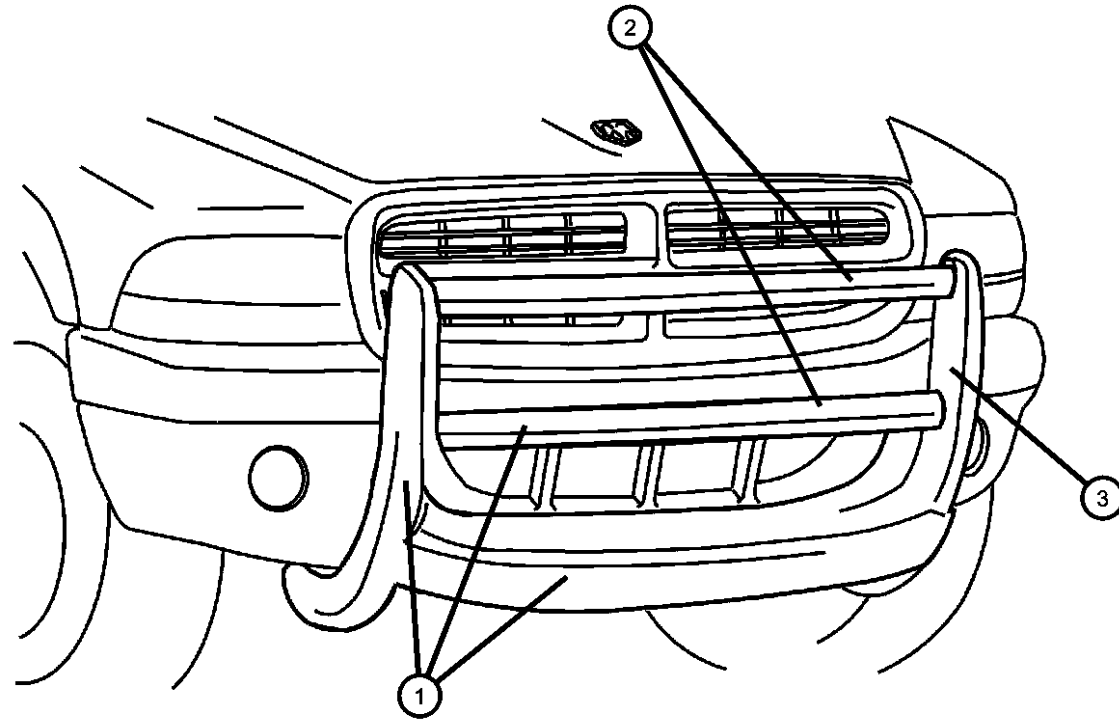

ITEM	PART NUMBER	QTY	LINE	SERIES	BODY	ENGINE	TRANS	TRIM	DESCRIPTION
7									GUARD KIT, Brush/Grille, With Lower Fascia
	82203803	1	1, 5		31, 61, 84				Light Driftwood
	82203804	1	1, 5		31, 61, 84				Deep Amethyst
	82203805	1	1, 5		31, 61, 84				Intense Blue
	82203807	1	1, 5		31, 61, 84				Chromed Steel
	82203922	1	1, 5		31, 61, 84				Black
	82203923	1	1, 5		31, 61, 84				Chili Pepper Red
	82203924	1	1, 5		31, 61, 84				Bright White
	82203925	1	1, 5		31, 61, 84				Flame Red
	82203926	1	1, 5		31, 61, 84				Forest Green
	82204017	1	1, 5		31, 61, 84				Natural Anodized Aluminum
	82205142	1	1, 5		31, 61, 84				Patriot Blue
	82205143	1	1, 5		31, 61, 84				Platinum
	82205762	1	1, 5		31, 61, 84				Aquamarine
	82205763	1	1, 5		31, 61, 84				Sierra Bronze
8	05018364AA	1	1, 5		31, 61, 84				FASCIA, Front, Primed
-9									GUARD KIT, Brush/Grille, Without Lower Fascia
	82202742	1	1, 5		31, 61, 84				Natural Anodized Aluminum
	82202743	1	1, 5		31, 61, 84				Black Anodized Aluminum
	82202744	1	1, 5		31, 61, 84				Black Steel
	82202978	1	1, 5		31, 61, 84				Chromed Steel

DAKOTA (AN)

SERIES LINE
L = Quad Cab 1 = Dakota 2WD
L = Regular Cab 5 = Dakota 4WD
L = Club Cab

BODY
31 = CLUB CAB 2-DR 6.5 FT BOX
61 = REG CAB 6.5 FT BOX
84 = CREW CAB 4-DR W.B.1

ENGINE
EPO = 2.5L 4 Cyl.
EHO = 3.9L 6 Cyl.
EMO = 5.9L 8 Cyl.
EVO = 4.7L Magnum
EHC = 3.9L SMPI V6
EML = 5.9L V8 MPI Engine
EPE = 2.5L POWER TECH I-4 Cyl.
EVA = 4.7L V8 MPI

TRANSMISSION
DDC = TRANSMISSION - 5-SPEED HD MANUAL
DG4 = TRANSMISSION-MULTI-SPEED AUTO, 45RFE
DGK = TRANSMISSION - 4-SPD. AUTOMATIC,42RE
DGT = TRANSMISSION - 4-SPD. AUTOMATIC,46RE
DGO = AUTO. TRANS.

AR = use ase required - = Non illustrated part

Running Board
Figure 1-430

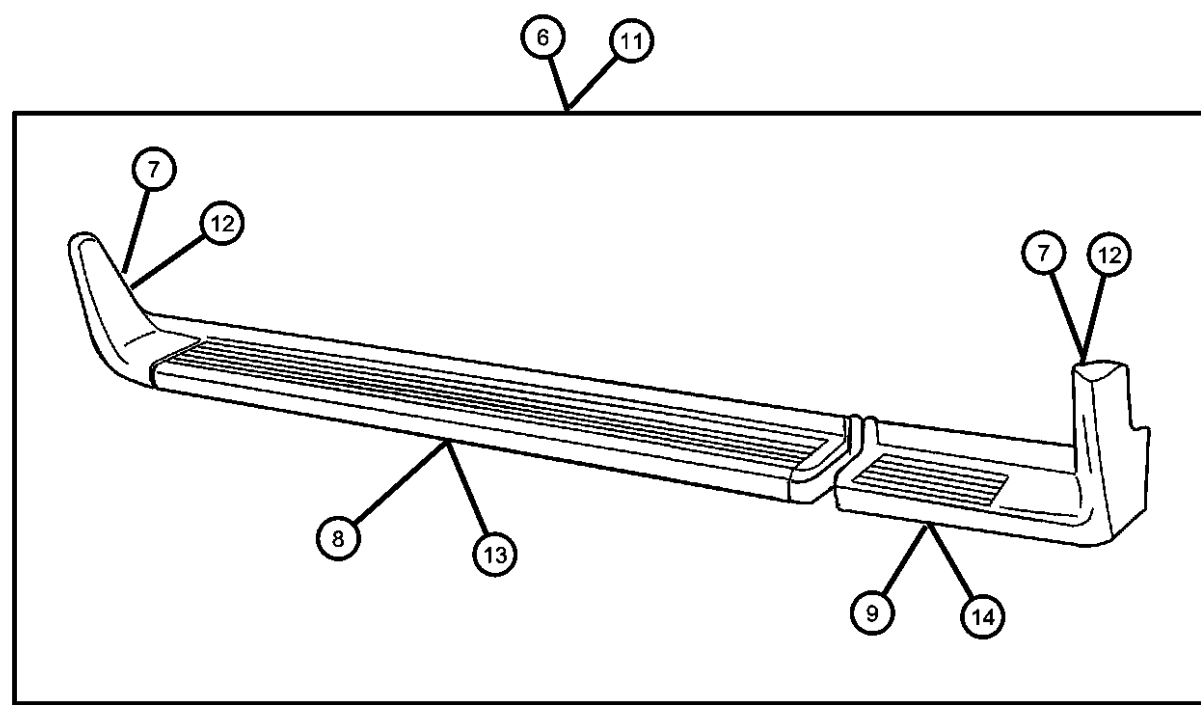
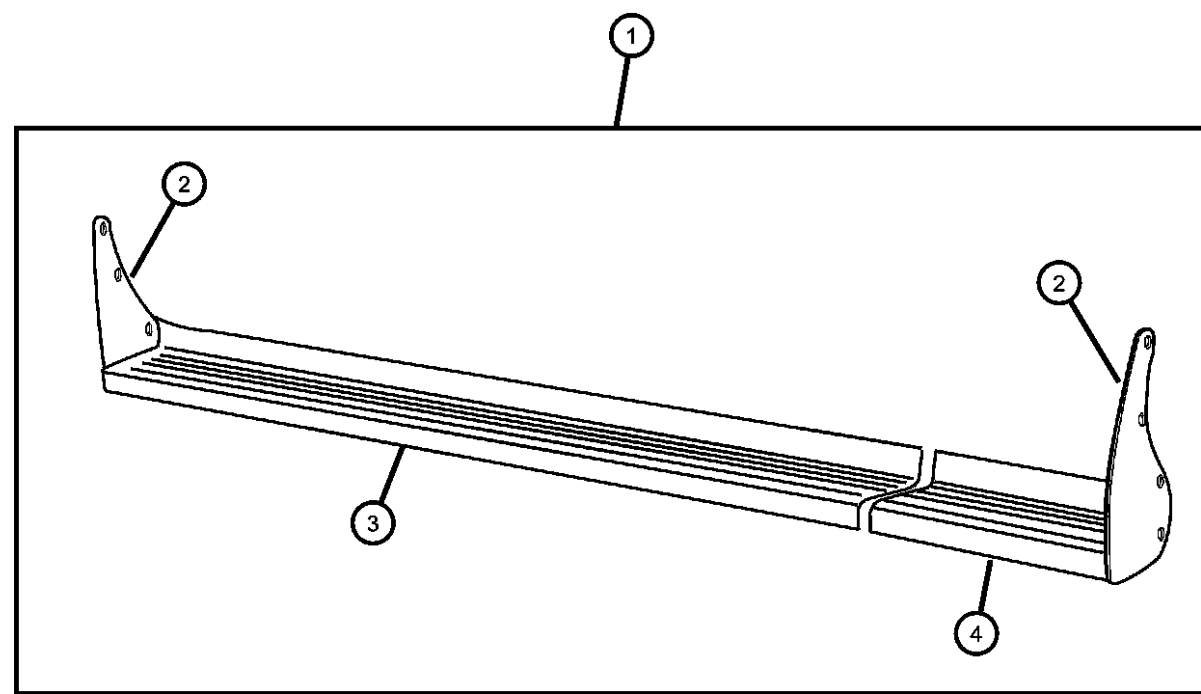

ITEM	PART NUMBER	QTY	LINE	SERIES	BODY	ENGINE	TRANS	TRIM	DESCRIPTION
WILL NOT WORK WITH FRONT SLASHGUARDS.									
1	82202752	1	1, 5		31				RUNNING BOARD KIT, Full, Alumimum
2									END CAP, Running Board
	05010526AA	1			31				Right Rear and Left Front
	05010539AA	1			31				Right Front and Left Rear
3									RUNNING BOARD, Club Cab
	05017038AA	1			31				Right
	05017039AA	1			31				Left
4									RUNNING BOARD, 6.5 Foot box
	05017040AA	1			31				Right
	05017041AA	1			31				Left
-5	05010603AA	1							HARDWARE KIT, Running Board
6									RUNNING BOARD KIT, Full, Molded, Club Cab
	82202649	1			31				Black, [PX8]
	82202654	1			31				Bright White, [PW7]
	82202659	1			31				Emerald Green, [PGF]
	82202669	1			31				Flame Red, [PR4]
	82202674	1			31				Radiant Red, [PRF]
	82204002	1	1, 5		31				Forest Green, [SG8]
	82204003	1	1, 5		31				Deep Amethyst, [TCU]
	82204004	1	1, 5		31				Intense Blue, [VB3]
7									END CAP, Running Board, P.A.R.
	05010526AA	1			31				Right Rear and Left Front
	05010539AA	1							Right Front and Left Rear
8									RUNNING BOARD, Club Cab, P.A.R.
	05017038AA	1			31				Right
	05017039AA	1			31				Left
9									RUNNING BOARD, 6.5 Foot box, P.A.R.
	05017040AA	1			31				Right
	05017041AA	1			31				Left

DAKOTA (AN)				
SERIES	LINE	BODY	ENGINE	TRANSMISSION
L = Quad Cab	1 = Dakota 2WD	31 = CLUB CAB 2-DR 6.5 FT BOX	EPO = 2.5L 4 Cyl.	DDC = TRANSMISSION - 5-SPEED HD MANUAL
L = Regular Cab	5 = Dakota 4WD	61 = REG CAB 6.5 FT BOX	EHO = 3.9L 6 Cyl.	DG4 = TRANSMISSION-MULTI-SPEED AUTO, 45RFE
L = Club Cab		84 = CREW CAB 4-DR W.B.1	EMO = 5.9L 8 Cyl.	DGK = TRANSMISSION - 4-SPD. AUTOMATIC,42RE
			EVO = 4.7L Magnum	DGT = TRANSMISSION - 4-SPD. AUTOMATIC,46RE
			EHC = 3.9L SMPI V6	DGO = AUTO. TRANS.
			EML = 5.9L V8 MPI Engine	
			EPE = 2.5L POWER TECH I-4 Cyl.	
			EVA = 4.7L V8 MPI	

AR = use ase required - = Non illustrated part