

VIN PLATE DECODING INFORMATION

| | | | | | | | | | | | |
|---------|------|--------------|-------|------|--------|------------|--------|-------------|------------|-------------|--------------|
| 1 | 2 | 3 | 4 | 5 | 6 | 7 | 8 | 9 | 10 | 11 | 12 thru 17 |
| Country | Make | Vehicle Type | Other | Line | Series | Body Style | Engine | Check Digit | Model Year | Assy. Plant | Sequence No. |

The following table interprets the VIN Plate position shown above.

| Position | Interpretation | Codes = Description |
|----------|---------------------|--|
| 1 | Country of Origin | 1 = Manufactured By DaimlerChrysler Corporation |
| 2 | Assembler | C = Chrysler B = Dodge |
| 3 | Vehicle Type | 3 = Passenger Car |
| 4 | GVWR & Pass. Safety | E = Restraint System Active Driver & Passenger Air Bags Sales Code (CGW) K = Restraint System Advanced Multistage Front Air Bags Sales Code (CG3) L = Restraint System Advanced Multistage Front Air Bags Sales Code (CG3) A = Restraint System Air Bags Front Next Generation Sales Code (CGW) D = Restraint System With Out Air Bags Sales Code (CGJ) |
| 5 | Vehicle Line | C = Cirrus (FWD) (LHD) Mexico C = Sebring (FWD) (LHD) U.S., Canada, BUX D = Sebring (AWD) (LHD) U.S., Canada 4 = Sebring (FWD) (RHD) BUX C = Avenger (FWD) (LHD) U.S., Canada, Mexico, BUX D = Avenger (AWD) (LHD) U.S., Canada 4 = Avenger (FWD) (RHD) BUX |
| 6 | Series | 4 = Sebring Conv. C-H-27 U.S., Canada 4 = Sebring Sedan C-H-41 U.S., Canada 4 = Cirrus Sedan C-H-41 Mexico 5 = Sebring LXI Conv. C-P-27 U.S., Canada 5 = Sebring LXI Conv. C-P-27 BUX Less Sales Code ABB * = Sebring LXI Conv. C-P-27 BUX With Sales Code ABB 5 = Sebring Touring Conv. Z-P-27 BUX Less Sales Code ABB * = Sebring Touring Conv. Z-P-27 BUX With Sales Code ABB 5 = Sebring LXI Sedan C-P-41 U.S., Canada 5 = Sebring LXI Sedan C-P-41 BUX Less Sales Code ABB * = Sebring LXI Sedan C-P-41 BUX With Sales Code ABB 5 = Cirrus LXI Sedan C-P-41 Mexico 5 = Sebring Touring Sedan Z-P-41 BUX Less Sales Code ABB * = Sebring Touring Sedan Z-P-41 BUX With Sales Code ABB 6 = Sebring Limited Conv. C-S-27 U.S., Canada 6 = Sebring Limited Conv. C-S-27 BUX Less Sales Code ABB * = Sebring Limited Conv. C-S-27 BUX With Sales Code ABB 6 = Cirrus Limited Conv. C-S-27 Mexico 6 = Sebring Limited Conv. Z-S-27 BUX Less Sales Code ABB * = Sebring Limited Conv. Z-S-27 BUX With Sales Code ABB 6 = Sebring Limited Sedan C-S-41 U.S., Canada 6 = Sebring Limited Sedan C-S-41 BUX Less Sales Code ABB * = Sebring Limited Sedan C-S-41 BUX With Sales Code ABB 6 = Cirrus Limited Sedan C-S-41 Mexico |

Group - 2

Front Suspension

Group - 2 Front Suspension

Illustration Title

Group-Fig. No.

Front Suspension, Strut and Cradle

Suspension, Front Fig. 2 - 105

Crossmember, Front Suspension Fig. 2 - 130

Front Stabilizer Bar

Stabilizer Bar, Front Fig. 2 - 205

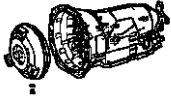
| | | | |
|--|--|--|--|
| <p>002-100 Front Suspension, Strut and Cradle</p>  | <p>002-200 Front Stabilizer Bar</p> | | |
|--|--|--|--|

Suspension, Front
Figure 2-105

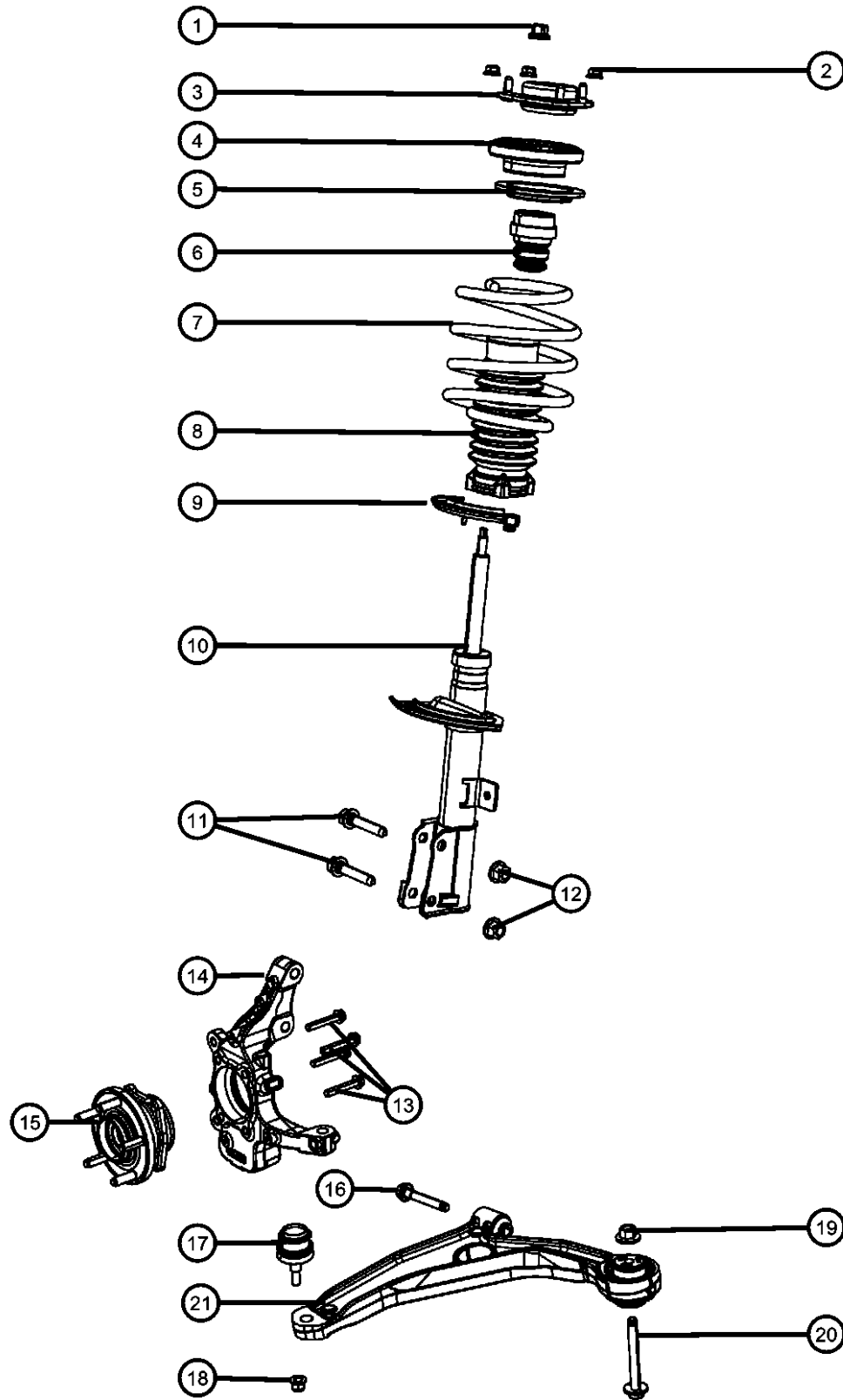

| ITEM | PART NUMBER | QTY | LINE | SERIES | BODY | ENGINE | TRANS | TRIM | DESCRIPTION |
|---|-------------|-----|------------------|--------|--------|--------|-------|------|----------------------|
| Sales Codes [ECN]=2.0L 4 CYL DOHC 16V SMPI [ED3]=2.4L 4 CYL DOHC 16V SMPI [EEE]=2.7L V6 24V FFV [EER]=2.7L V6 24V MPI [EGF]=3.5L V6 HIGH OUTPUT [ECD]=2.0L 4CYL DOHC DIESEL 16V [DGL]=4 SPEED AUTO [DG2]=6 SPEED AUTO | | | | | | | | | |
| 1 | 06508273AA | 2 | | | | | | | NUT AND WASHER, Hex |
| 2 | 06503335 | 6 | C, D, E, F, G | | 27, 41 | | | | NUT, Hex, M10X1.25 |
| 3 | 05171122AC | 2 | C, D, E, F, G | | 27, 41 | | | | MOUNT, Strut |
| 4 | 05171093AB | 2 | C, D, E, G, Z | | 27, 41 | | | | BEARING, Strut Mount |
| 5 | 05006012AA | 2 | C, D, E, G, Z | | 27, 41 | | | | ISOLATOR, Spring |
| 6 | 05171137AB | 2 | C, D, E, F, G | | 27, 41 | | | | BUMPER, Jounce |
| 7 | | | | | | | | | SPRING, Front Coil |
| 10 | 04743917AC | 1 | C, D, E, G, Z | | 41 | | | | [ZAM,ZNM] |
| | | 1 | C, Z | | 27 | | | | [ZAM,ZNM] |
| | 04766057AB | 1 | C, D, E, G, Z | | 41 | | | | [ZBA,ZPA] |
| | | 1 | C, Z | | 27 | | | | [ZBA,ZPA] |
| | 04766058AB | 1 | C, D, E, G, Z | | 41 | | | | [ZBB,ZPB] |
| | | 1 | C, Z | | 27 | | | | [ZBB,ZPB] |
| | 04766059AB | 1 | C, D, E, G, Z | | 41 | | | | [ZBC,ZPC] |
| | | 1 | C, Z | | 27 | | | | [ZBC,ZPC] |
| | 04766060AB | 1 | C, D, E, G, Z | | 41 | | | | [ZBD,ZPD] |
| | | 1 | C, Z | | 27 | | | | [ZBD,ZPD] |
| | 04766061AB | 1 | C, D, E, G, Z | | 41 | | | | [ZBE,ZPE] |
| | | 1 | C, Z | | 27 | | | | [ZBE,ZPE] |

SEBRING/AVENGER (JS)

SERIES LINE
H = HIGHLINE C = CHRYSLER
P = PREMIUM G = CHRYSLER
S = SPORT Z = CHRYSLER (RHD)
X = SPECIAL D = DODGE
E = DODGE AWD
F = CHRYSLER AWD

BODY
27 = 2-DR CONVERTIBLE
41 = SEDAN/QUAD CAB
SWB

ENGINE
EER = 2.7L V6 DOHC 24 Valve MPI Engine
ECD = 2.0L 4 Cyl DOHC Diesel 16V Engine
ECN = 2.0L 4 Cyl DOHC 16V Dual VVT Engine
ED3 = 2.4L 4 Cyl DOHC 16V Dual VVT Engine
EDG = Engine -2.4L I4 PZEV 16V Dual VVT
EGF = 3.5L High Output V6 24V MPI Engine

TRANSMISSION
DFF = 4-Speed Automatic VLP 41TE Trans
DEF = 6-Speed Manual Aisin BG6 Trans
DG2 = 6-Speed Automatic 62TE Transmission
DG5 = 6-Spd Auto Getrag MPS6 Transmission
DD7 = 5-Speed Manual T355 Transmission

AR = use ase required - = Non illustrated part

2008 JS

Suspension, Front
Figure 2-105

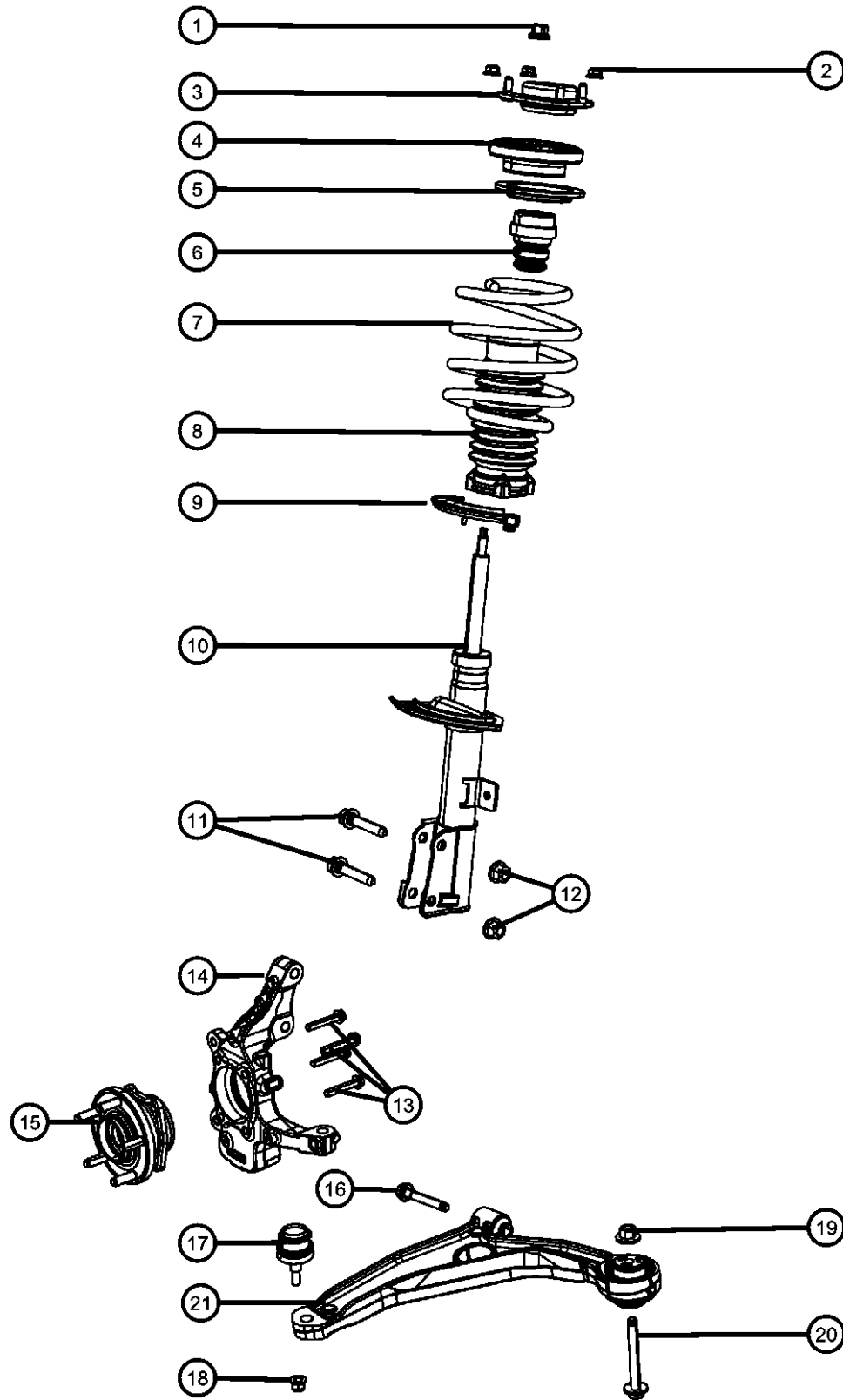

| ITEM | PART NUMBER | QTY | LINE | SERIES | BODY | ENGINE | TRANS | TRIM | DESCRIPTION |
|------|-------------|-----|------------------|--------|--------|--------|-------|------|-------------|
| 1 | | | | | | | | | |
| 2 | | | | | | | | | |
| 3 | 04766062AB | 1 | C, D, E, G, Z | | 41 | | | | [ZBF,ZPF] |
| 4 | | 1 | C, Z | | 27 | | | | [ZBF,ZPF] |
| 5 | 04766063AB | 1 | C, D, E, G, Z | | 41 | | | | [ZBG,ZPG] |
| 6 | | 1 | C, Z | | 27 | | | | [ZBG,ZPG] |
| 7 | 04766064AB | 1 | C, D, E, G, Z | | 41 | | | | [ZBH,ZPH] |
| 8 | | 1 | C, Z | | 27 | | | | [ZBH,ZPH] |
| 9 | 05171994AA | 1 | C, D, E, F, G | | 27, 41 | | | | [ZDD,ZSD] |
| 10 | 05171995AA | 1 | C, D, E, F, G | | 27, 41 | | | | [ZDE,ZSE] |
| 11 | 05272621AC | 1 | C, D, E, G, Z | | 41 | | | | [ZEA,ZTA] |
| 12 | | 1 | C, Z | | 27 | | | | [ZEA,ZTA] |
| 13 | 05272622AC | 1 | C, D, E, G, Z | | 41 | | | | [ZEB,ZTB] |
| 14 | | 1 | C, Z | | 27 | | | | [ZEB,ZTB] |
| 15 | 05272623AC | 1 | C, D, E, G, Z | | 41 | | | | [ZEC,ZTC] |
| 16 | | 1 | C, Z | | 27 | | | | [ZEC,ZTC] |
| 17 | 05272624AC | 1 | C, D, E, G, Z | | 41 | | | | [ZED,ZTD] |
| 18 | | 1 | C, Z | | 27 | | | | [ZED,ZTD] |
| 19 | 05272625AC | 1 | C, D, E, G, Z | | 41 | | | | [ZEE,ZTE] |
| 20 | | 1 | C, Z | | 27 | | | | [ZEE,ZTE] |
| 21 | 05272626AC | 1 | C, D, E, G, Z | | 41 | | | | [ZEF,ZTF] |
| | | 1 | C, Z | | 27 | | | | [ZEF,ZTF] |
| | 05272627AC | 1 | C, D, E, G, Z | | 41 | | | | [ZEG,ZTG] |
| | | 1 | C, Z | | 27 | | | | [ZEG,ZTG] |
| | 05272628AC | 1 | C, D, E, G, Z | | 41 | | | | [ZEH,ZTH] |
| | | 1 | C, Z | | 27 | | | | [ZEH,ZTH] |

SEBRING/AVENGER (JS)

SERIES LINE
H = HIGHLINE C = CHRYSLER
P = PREMIUM G = CHRYSLER
S = SPORT Z = CHRYSLER (RHD)
X = SPECIAL D = DODGE
E = DODGE AWD
F = CHRYSLER AWD

BODY
27 = 2-DR CONVERTIBLE
41 = SEDAN/QUAD CAB
SWB

ENGINE
EER = 2.7L V6 DOHC 24 Valve MPI Engine
ECD = 2.0L 4 Cyl DOHC Diesel 16V Engine
ECN = 2.0L 4 Cyl DOHC 16V Dual VVT Engine
ED3 = 2.4L 4 Cyl DOHC 16V Dual VVT Engine
EDG = Engine -2.4L I4 PZEV 16V Dual VVT
EGF = 3.5L High Output V6 24V MPI Engine

TRANSMISSION
DFF = 4-Speed Automatic VLP 41TE Trans
DEF = 6-Speed Manual Aisin BG6 Trans
DG2 = 6-Speed Automatic 62TE Transmission
DG5 = 6-Spd Auto Getrag MPS6 Transmission
DD7 = 5-Speed Manual T355 Transmission

AR = use ase required - = Non illustrated part

2008 JS

Suspension, Front
Figure 2-105

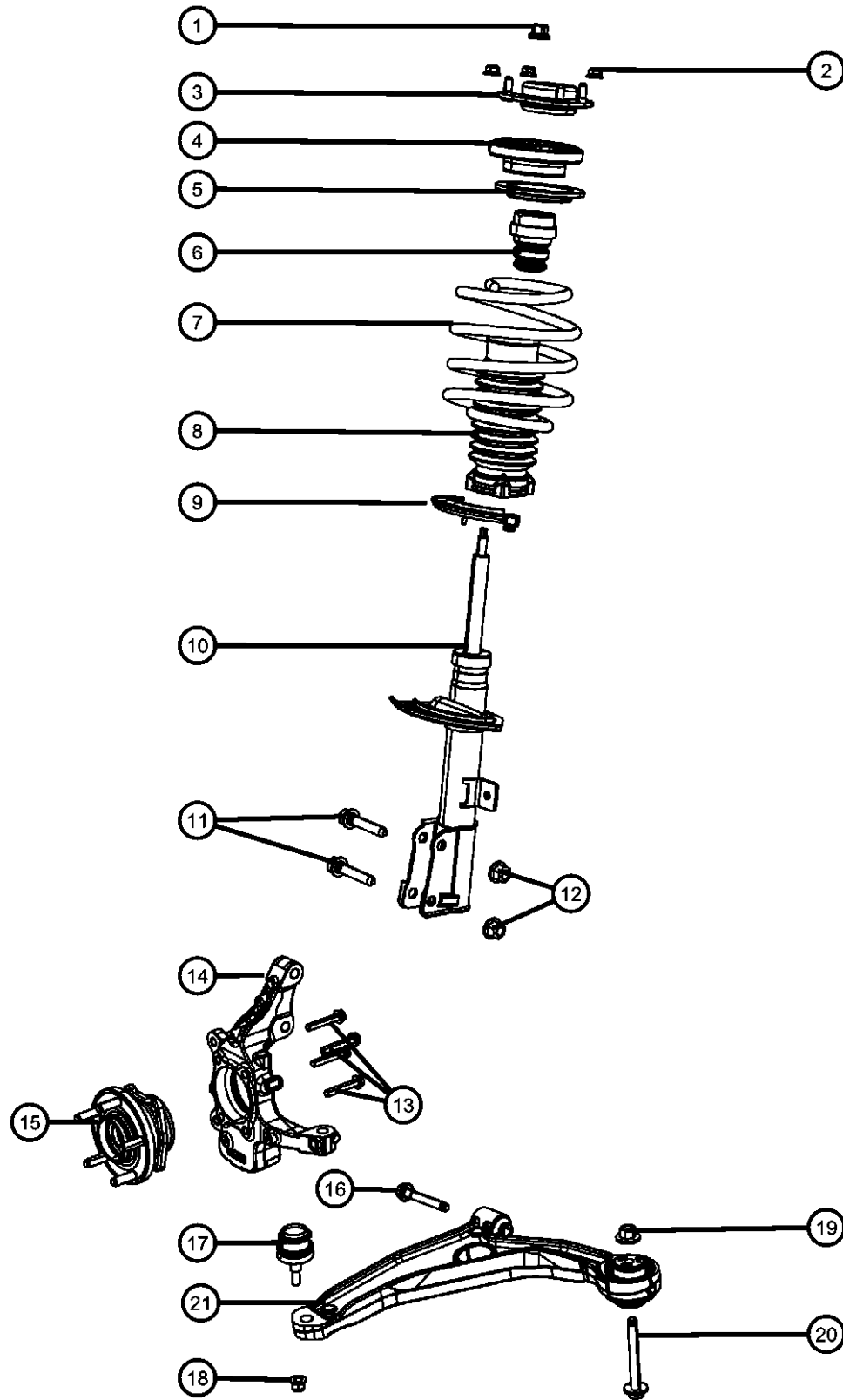

| ITEM | PART NUMBER | QTY | LINE | SERIES | BODY | ENGINE | TRANS | TRIM | DESCRIPTION |
|------|-------------|-----|------------------|--------|------|--------|-------|------|-------------|
| | | | | | | | | | |
| | 05272731AC | 1 | C, D, E, G, Z | | 41 | | | | [ZCA,ZRA] |
| | | 1 | C, Z | | 27 | | | | [ZCA,ZRA] |
| | 05272732AC | 1 | C, D, E, G, Z | | 41 | | | | [ZCB,ZRB] |
| | | 1 | C, Z | | 27 | | | | [ZCB,ZRB] |
| | 05272733AC | 1 | C, D, E, G, Z | | 41 | | | | [ZCC,ZRC] |
| | | 1 | C, Z | | 27 | | | | [ZCC,ZRC] |
| | 05272734AC | 1 | C, D, E, G, Z | | 41 | | | | [ZCD,ZRD] |
| | | 1 | C, Z | | 27 | | | | [ZCD,ZRD] |
| | 05272735AC | 1 | C, D, E, G, Z | | 41 | | | | [ZCE,ZRE] |
| | | 1 | C, Z | | 27 | | | | [ZCE,ZRE] |
| | 05272736AC | 1 | C, D, E, G, Z | | 41 | | | | [ZCF,ZRF] |
| | | 1 | C, Z | | 27 | | | | [ZCF,ZRF] |
| | 05272737AC | 1 | C, D, E, G, Z | | 41 | | | | [ZCG,ZRG] |
| | | 1 | C, Z | | 27 | | | | [ZCG,ZRG] |
| | 05272738AC | 1 | C, D, E, G, Z | | 41 | | | | [ZCH,ZRH] |
| | | 1 | C, Z | | 27 | | | | [ZCH,ZRH] |
| | 05272739AC | 1 | C, D, E, G, Z | | 41 | | | | [ZCJ,ZRJ] |
| | | 1 | C, Z | | 27 | | | | [ZCJ,ZRJ] |
| | 05272761AC | 1 | C, D, E, G, Z | | 41 | | | | [ZAA,ZNA] |
| | | 1 | C, Z | | 27 | | | | [ZAA,ZNA] |
| | 05272762AC | 1 | G, Z, C, D, E | | 41 | | | | [ZAB,ZNB] |
| | | 1 | C, Z | | 27 | | | | [ZAB,ZNB] |
| | 05272763AC | 1 | C, D, E, G, Z | | 41 | | | | [ZAC,ZNC] |
| | | 1 | C, Z | | 27 | | | | [ZAC,ZNC] |

SEBRING/AVENGER (JS)

SERIES

H = HIGHLINE
P = PREMIUM
S = SPORT
X = SPECIAL

LINE

C = CHRYSLER
G = CHRYSLER
Z = CHRYSLER (RHD)
D = DODGE
E = DODGE AWD
F = CHRYSLER AWD

BODY

27 = 2-DR CONVERTIBLE
41 = SEDAN/QUAD CAB
SWB

ENGINE

EER = 2.7L V6 DOHC 24 Valve MPI Engine
ECD = 2.0L 4 Cyl DOHC Diesel 16V Engine
ECN = 2.0L 4 Cyl DOHC 16V Dual VVT Engine
ED3 = 2.4L 4 Cyl DOHC 16V Dual VVT Engine
EDG = Engine -2.4L I4 PZEV 16V Dual VVT
EGF = 3.5L High Output V6 24V MPI Engine

TRANSMISSION

DFF = 4-Speed Automatic VLP 41TE Trans
DEF = 6-Speed Manual Aisin BG6 Trans
DG2 = 6-Speed Automatic 62TE Transmission
DG5 = 6-Spd Auto Getrag MPS6 Transmission
DD7 = 5-Speed Manual T355 Transmission

AR = use ase required - = Non illustrated part

2008 JS

Suspension, Front
Figure 2-105

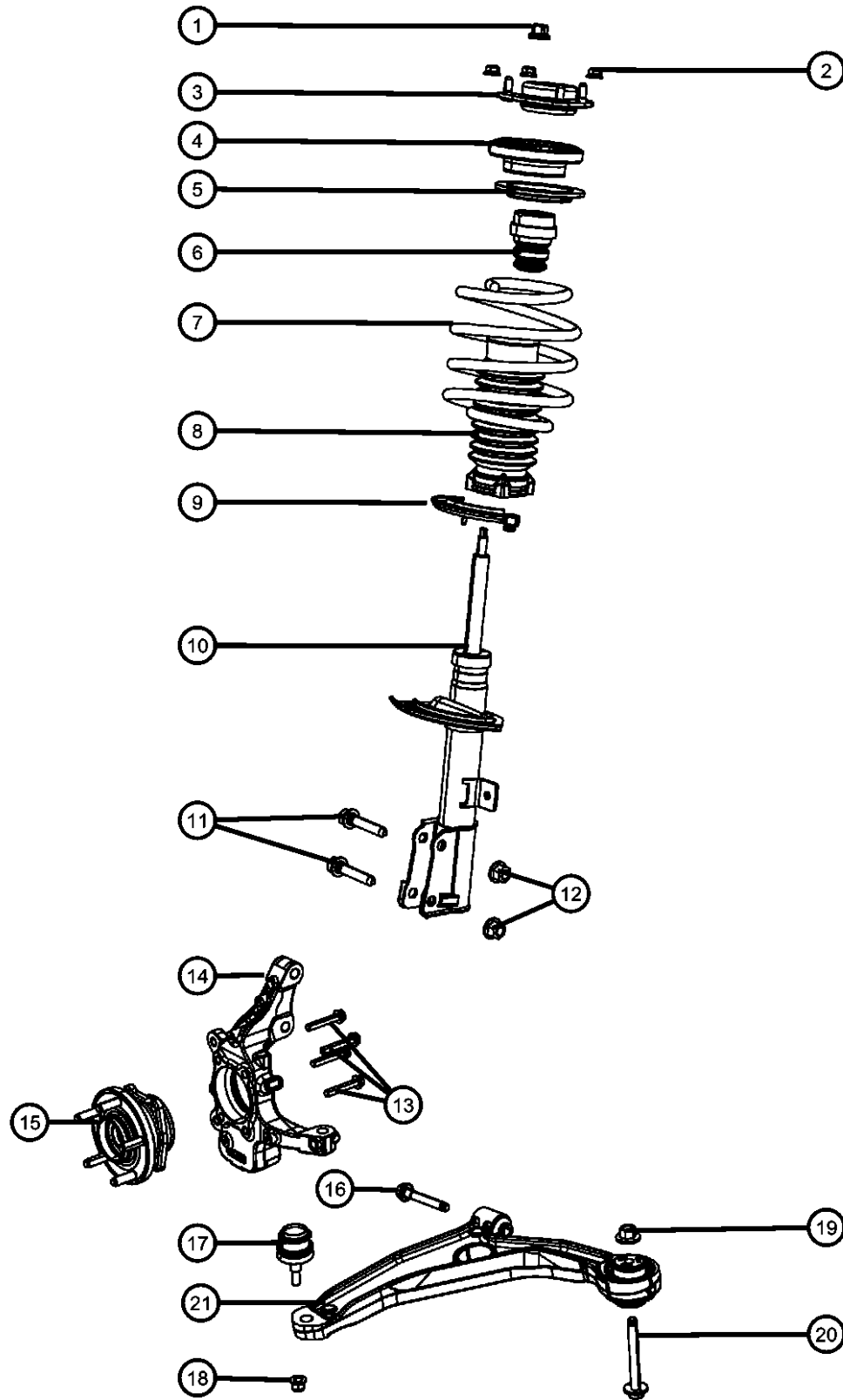

| ITEM | PART NUMBER | QTY | LINE | SERIES | BODY | ENGINE | TRANS | TRIM | DESCRIPTION |
|------|-------------|-----|---------------|--------|--------|--------------------|-------|------|-----------------------------|
| | | | | | | | | | |
| | 05272764AC | 1 | C, D, E, G, Z | | 41 | | | | [ZAD,ZND] |
| | | 1 | C, Z | | 27 | | | | [ZAD,ZND] |
| | 05272765AC | 1 | C, D, E, G, Z | | 41 | | | | [ZAE,ZNE] |
| | | 1 | C, Z | | 27 | | | | [ZAE,ZNE] |
| | 05272766AC | 1 | C, D, E, G, Z | | 41 | | | | [ZAF,ZNF] |
| | | 1 | C, Z | | 27 | | | | [ZAF,ZNF] |
| | 05272767AC | 1 | C, D, E, G, Z | | 41 | | | | [ZAG,ZNG] |
| | | 1 | C, Z | | 27 | | | | [ZAG,ZNG] |
| | 05272768AC | 1 | E, G, Z, C, D | | 41 | | | | [ZAH,ZNH] |
| | | 1 | C, Z | | 27 | | | | [ZAH,ZNH] |
| | 05272769AC | 1 | C, D, E, G, Z | | 41 | | | | [ZAJ,ZNJ] |
| | | 1 | C, Z | | 27 | | | | [ZAJ,ZNJ] |
| 8 | 05171132AC | 2 | C, D, E, F, G | | 27, 41 | | | | SHIELD, Shock Absorber Dust |
| 9 | | | | | | | | | ISOLATOR, Spring |
| | 05085405AB | 2 | C, Z | | 27 | | | | |
| | | 2 | C, D, E, F, G | | 41 | | | | |
| 10 | | | | | | | | | DAMPER, Strut |
| | 04766048AB | 1 | C | | 41 | ED3 | | | [SDA], Right |
| | 04766049AB | 1 | C | | 41 | ED3 | | | [SDA], Left |
| | 05085344AC | 1 | C, D, G, Z | | 41 | | | | [SDC,SHA] |
| | 05085348AD | 1 | C, D, G, Z | | 41 | ECD, ECN, EER, EGF | | | [SDC], Right |
| | 05085349AD | 1 | C, D, G, Z | | 41 | ECD, ECN, EER, EGF | | | [SDC], Left |
| | 05085354AD | 1 | C, D, G, Z | | 41 | | | | [SDF,SDE], Right |
| | 05085355AD | 1 | C, D, G, Z | | 41 | | | | [SDF,SDE], Left |

SEBRING/AVENGER (JS)

SERIES LINE
H = HIGHLINE C = CHRYSLER
P = PREMIUM G = CHRYSLER
S = SPORT Z = CHRYSLER (RHD)
X = SPECIAL D = DODGE
E = DODGE AWD
F = CHRYSLER AWD

BODY
27 = 2-DR CONVERTIBLE
41 = SEDAN/QUAD CAB
SWB

ENGINE
EER = 2.7L V6 DOHC 24 Valve MPI Engine
ECD = 2.0L 4 Cyl DOHC Diesel 16V Engine
ECN = 2.0L 4 Cyl DOHC 16V Dual VVT Engine
ED3 = 2.4L 4 Cyl DOHC 16V Dual VVT Engine
EDG = Engine -2.4L I4 PZEV 16V Dual VVT
EGF = 3.5L High Output V6 24V MPI Engine

TRANSMISSION
DFF = 4-Speed Automatic VLP 41TE Trans
DEF = 6-Speed Manual Aisin BG6 Trans
DG2 = 6-Speed Automatic 62TE Transmission
DG5 = 6-Spd Auto Getrag MPS6 Transmission
DD7 = 5-Speed Manual T355 Transmission

AR = use ase required - = Non illustrated part

2008 JS

Suspension, Front
Figure 2-105

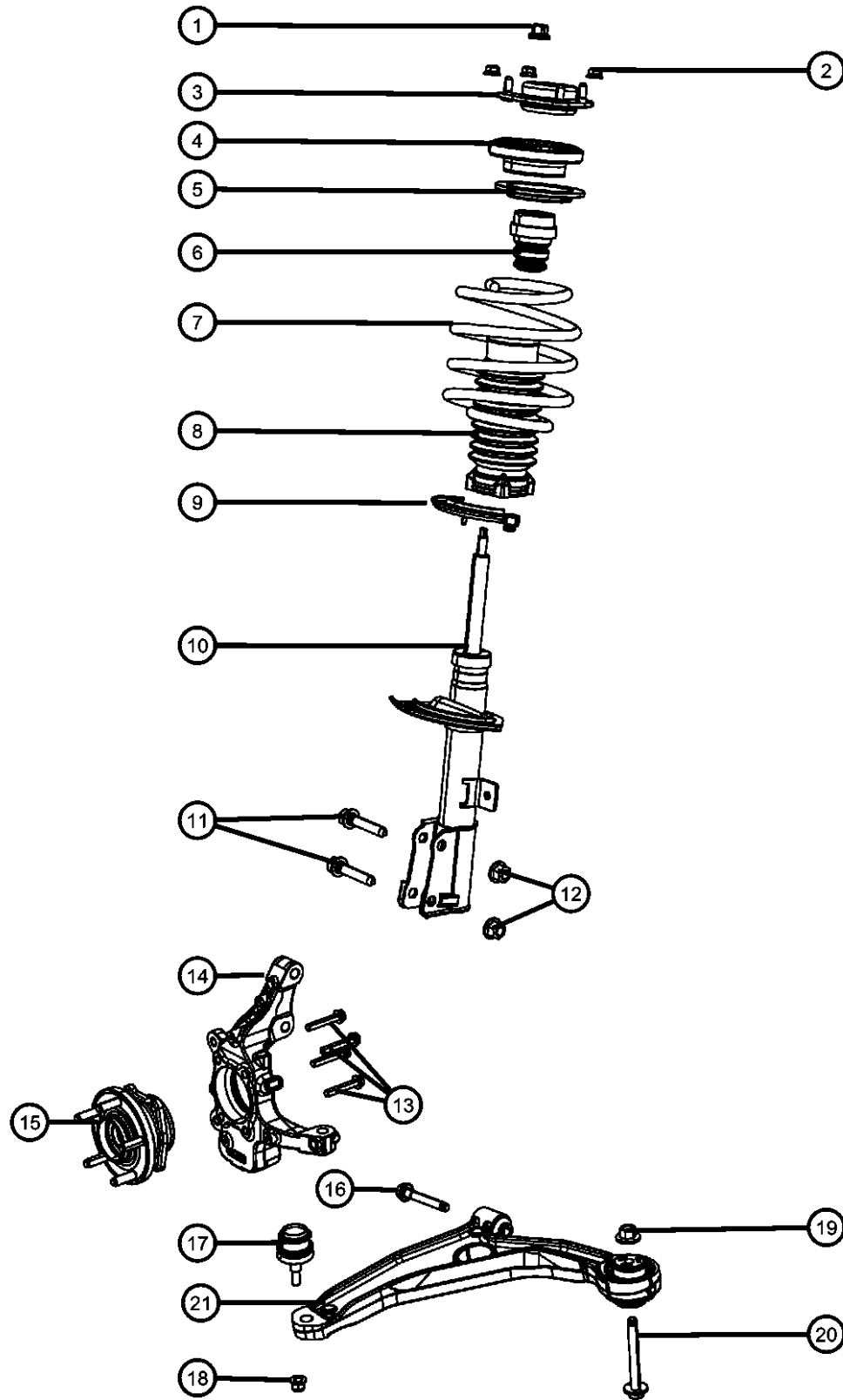

| ITEM | PART NUMBER | QTY | LINE | SERIES | BODY | ENGINE | TRANS | TRIM | DESCRIPTION |
|------|-------------|-----|---------------|--------|--------|--------|-------|------|--------------------------------|
| 11 | 06505664AA | 4 | D, E, F, G, C | | 27, 41 | | | | BOLT, Serrated, M14X2.00X77.0 |
| 12 | | | | | | | | | NUT, Hex Flange Lock, M14x2.00 |
| 13 | 06502698 | 4 | C, D, E, F | | 27, 41 | | | | |
| 14 | | 4 | Z | | 41 | | | | |
| 13 | 06101992 | 8 | | | | | | | BOLT |
| 14 | | | | | | | | | KNUCKLE, Front |
| 14 | 04766037AB | 1 | C, D, E, G, Z | | 27, 41 | | | | [BRA], Left |
| 14 | 04766038AB | 1 | C, D, E, G, Z | | 27, 41 | | | | [BRA], Right |
| 14 | 05085886AB | 1 | C, D, E, G, Z | | 27, 41 | | | | [BRF,BRG,BRJ], Right |
| 14 | 05085887AB | 1 | C, D, E, G, Z | | 27, 41 | | | | [BRF,BRG,BRJ], Left |
| 15 | | | | | | | | | HUB AND BEARING, Wheel |
| 15 | 05105233AB | 1 | C, D, E, G, Z | | 41 | | | | [BRA] |
| 15 | | 1 | C, Z | | 27 | | | | [BRA] |
| 16 | 06508625AA | 2 | C, D, E, F, G | | 27, 41 | | | | SCREW, Hex Head |
| 17 | 05085914AB | 1 | C, D, E, G, Z | | 27, 41 | | | | BALL JOINT, Front Knuckle |
| 18 | 06507676AA | 2 | C, D, E, F, G | | 27, 41 | | | | NUT, Hex Flange Lock, M12X1.50 |
| 19 | 06508884AA | 2 | C, D, E, F, G | | 27, 41 | | | | NUT AND WASHER, Hex |
| 20 | 06105118AA | 2 | C, D, E, F, G | | 27, 41 | | | | SCREW, Hex Head |
| 21 | | | | | | | | | ARM, Lower Control, Front |
| 21 | 05085407AB | 1 | C, D, E, G, Z | | 27, 41 | | | | Left |
| 21 | 05085408AB | 1 | C, D, E, G, Z | | 27, 41 | | | | Right |
| 21 | 55398502AA | 1 | C, D, E, G, Z | | 27, 41 | | | | RHD, Right |
| 21 | 55398503AA | 1 | C, D, E, G, Z | | 27, 41 | | | | RHD, Left |

SEBRING/AVENGER (JS)

| | |
|--------------|--------------------|
| SERIES | LINE |
| H = HIGHLINE | C = CHRYSLER |
| P = PREMIUM | G = CHRYSLER |
| S = SPORT | Z = CHRYSLER (RHD) |
| X = SPECIAL | D = DODGE |
| | E = DODGE AWD |
| | F = CHRYSLER AWD |

| |
|-----------------------|
| BODY |
| 27 = 2-DR CONVERTIBLE |
| 41 = SEDAN/QUAD CAB |
| SWB |

| |
|---|
| ENGINE |
| EER = 2.7L V6 DOHC 24 Valve MPI Engine |
| ECD = 2.0L 4 Cyl DOHC Diesel 16V Engine |
| ECN = 2.0L 4 Cyl DOHC 16V Dual VVT Engine |
| ED3 = 2.4L 4 Cyl DOHC 16V Dual VVT Engine |
| EDG = Engine -2.4L I4 PZEV 16V Dual VVT |
| EGF = 3.5L High Output V6 24V MPI Engine |

| |
|---|
| TRANSMISSION |
| DFF = 4-Speed Automatic VLP 41TE Trans |
| DEF = 6-Speed Manual Aisin BG6 Trans |
| DG2 = 6-Speed Automatic 62TE Transmission |
| DG5 = 6-Spd Auto Getrag MPS6 Transmission |
| DD7 = 5-Speed Manual T355 Transmission |

AR = use ase required - = Non illustrated part

2008 JS

**Crossmember, Front Suspension
Figure 2-130**

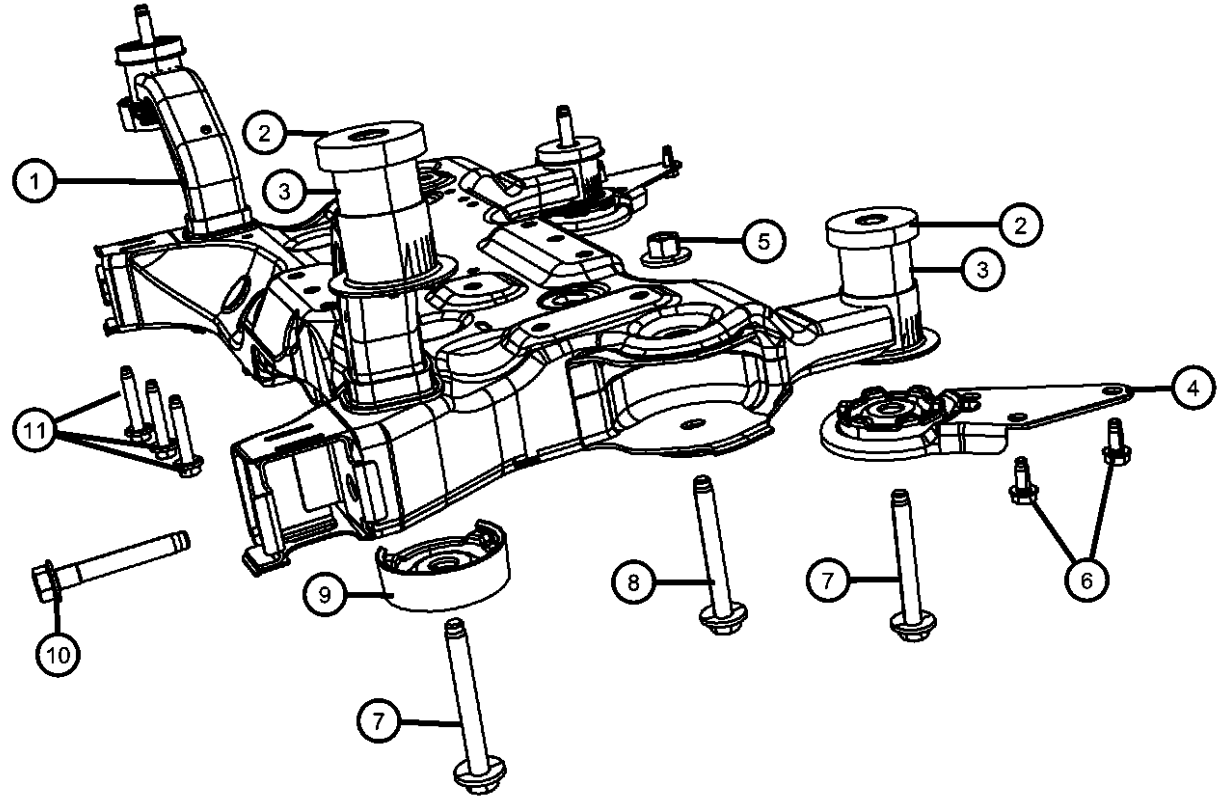

| ITEM | PART NUMBER | QTY | LINE | SERIES | BODY | ENGINE | TRANS | TRIM | DESCRIPTION |
|------|-------------|-----|---------------|--------|------|--------|-------|------|--|
| 1 | 05085819AD | 1 | C, D, E, G, Z | | 41 | | | | CROSSMEMBER, Front Suspension |
| 2 | 04766483AA | 2 | Z, C | | 27 | | | | ISOLATOR, Crossmember Front |
| | 04766484AA | 2 | C, Z | | 27 | | | | ISOLATOR, Crossmember Rear |
| 3 | 04766075AB | 2 | C, D, E, G, Z | | 41 | | | | ISOLATOR, CROSSMEMBER, Front crossmember Front |
| | 04766076AB | 2 | C, D, E, G, Z | | 41 | | | | ISOLATOR, CROSSMEMBER, Front crossmember Rear |
| 4 | 05085865AA | 1 | C, D, E, G, Z | | 41 | | | | BRACKET, Crossmember Left |
| | 05085864AA | 1 | C, D, E, G, Z | | 41 | | | | BRACKET, Crossmember Right |
| 5 | 06508884AA | 2 | C, Z | | 27 | | | | NUT AND WASHER, Hex |
| | | 2 | C, D, E, G, Z | | 41 | | | | |
| 6 | 06105062AA | 4 | C, D, E, G, Z | | 41 | | | | BOLT, Hex Flange Head, M10x1.50x25.00 |
| | | 4 | C, Z | | 27 | | | | |
| 7 | 06105118AA | 4 | C, Z | | 27 | | | | SCREW, Hex Head |
| | | 4 | C, D, E, G, Z | | 41 | | | | |
| 8 | 06105118AA | 2 | C, D, E, G, Z | | 41 | | | | SCREW, Hex Head |
| | | 2 | C, Z | | 27 | | | | |
| 9 | 05085795AB | 2 | C, D, E, G, Z | | 41 | | | | SEAT, Isolator Mount, Front crossmember |
| | | 2 | Z, C | | 27 | | | | |

SEBRING/AVENGER (JS)

| | | | | |
|--------------|--------------------|-----------------------|---|---|
| SERIES | LINE | BODY | ENGINE | TRANSMISSION |
| H = HIGHLINE | C = CHRYSLER | 27 = 2-DR CONVERTIBLE | EER = 2.7L V6 DOHC 24 Valve MPI Engine | DFF = 4-Speed Automatic VLP 41TE Trans |
| P = PREMIUM | G = CHRYSLER | 41 = SEDAN/QUAD CAB | ECD = 2.0L 4 Cyl DOHC Diesel 16V Engine | DEF = 6-Speed Manual Aisin BG6 Trans |
| S = SPORT | Z = CHRYSLER (RHD) | SWB | ECN = 2.0L 4 Cyl DOHC 16V Dual VVT Engine | DG2 = 6-Speed Automatic 62TE Transmission |
| X = SPECIAL | D = DODGE | | ED3 = 2.4L 4 Cyl DOHC 16V Dual VVT Engine | DG5 = 6-Spd Auto Getrag MPS6 Transmission |
| | E = DODGE AWD | | EDG = Engine -2.4L I4 PZEV 16V Dual VVT | DD7 = 5-Speed Manual T355 Transmission |
| | F = CHRYSLER AWD | | EGF = 3.5L High Output V6 24V MPI Engine | |

AR = use ase required - = Non illustrated part

**Crossmember, Front Suspension
Figure 2-130**

| ITEM | PART NUMBER | QTY | LINE | SERIES | BODY | ENGINE | TRANS | TRIM | DESCRIPTION |
|------|-------------|-----|------------------|--------|------|--------|-------|------|------------------------------------|
| 10 | 06508625AA | 2 | C, Z | | 27 | | | | SCREW, Hex Head |
| | | 2 | C, D, E, G, Z | | 41 | | | | |
| 11 | 06104426AA | 3 | C, D, E, G, Z | | 41 | | | | BOLT AND CONED WASHER, Hex Head |
| | | 3 | C, Z | | 27 | | | | |

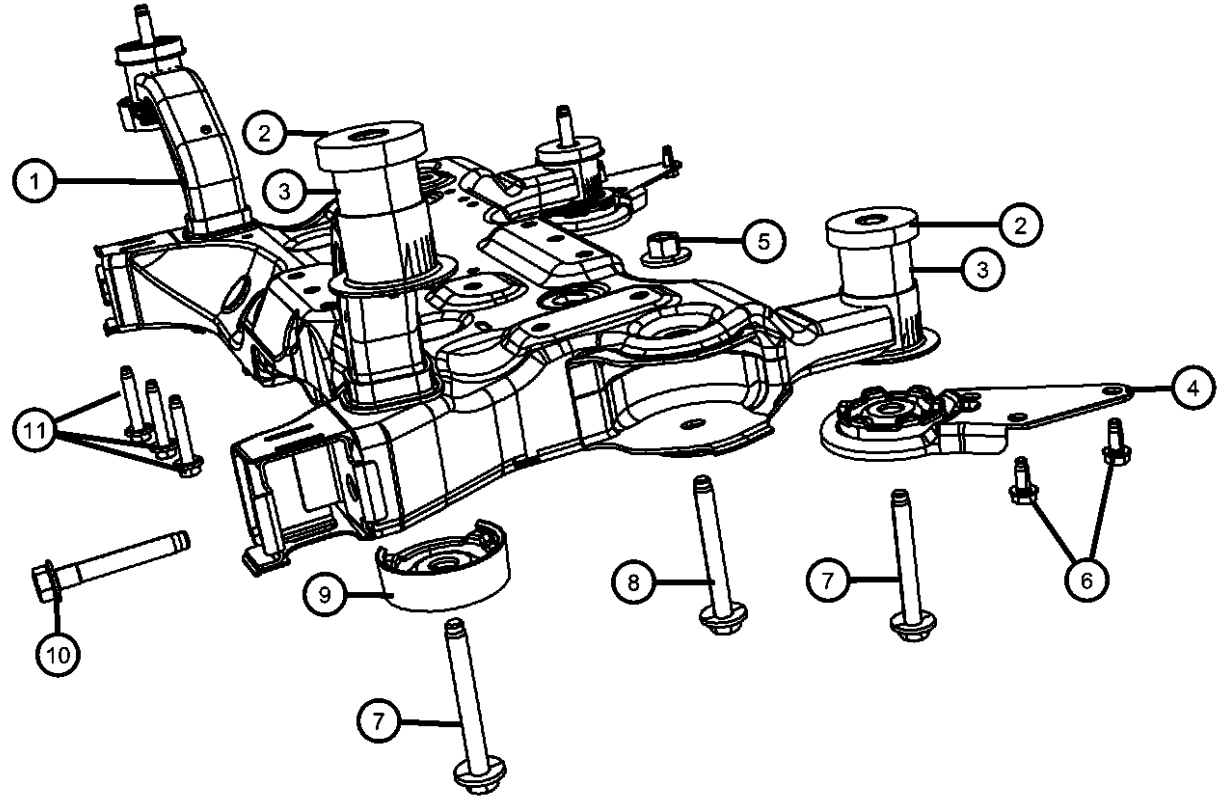

SEBRING/AVENGER (JS)

| SERIES | LINE | BODY | ENGINE | TRANSMISSION |
|--------------|--------------------|-----------------------|---|---|
| H = HIGHLINE | C = CHRYSLER | 27 = 2-DR CONVERTIBLE | EER = 2.7L V6 DOHC 24 Valve MPI Engine | DFF = 4-Speed Automatic VLP 41TE Trans |
| P = PREMIUM | G = CHRYSLER | 41 = SEDAN/QUAD CAB | ECD = 2.0L 4 Cyl DOHC Diesel 16V Engine | DEF = 6-Speed Manual Aisin BG6 Trans |
| S = SPORT | Z = CHRYSLER (RHD) | SWB | ECN = 2.0L 4 Cyl DOHC 16V Dual VVT Engine | DG2 = 6-Speed Automatic 62TE Transmission |
| X = SPECIAL | D = DODGE | | ED3 = 2.4L 4 Cyl DOHC 16V Dual VVT Engine | DG5 = 6-Spd Auto Getrag MPS6 Transmission |
| | E = DODGE AWD | | EDG = Engine -2.4L I4 PZEV 16V Dual VVT | DD7 = 5-Speed Manual T355 Transmission |
| | F = CHRYSLER AWD | | EGF = 3.5L High Output V6 24V MPI Engine | |

AR = use ase required - = Non illustrated part

2008 JS

Stabilizer Bar, Front
Figure 2-205

| ITEM | PART NUMBER | QTY | LINE | SERIES | BODY | ENGINE | TRANS | TRIM | DESCRIPTION |
|------|-------------|-----|------------------|--------|--------|--------|-------|------|--|
| 1 | 05174185AA | 2 | C, D, E, G, Z | | 27, 41 | | | | LINK PACKAGE, Stabilizer Bar |
| 2 | 06504954AA | 2 | C, D, E, G, Z | | 41 | | | | NUT |
| 3 | 06104418AA | 4 | C, D, E, F, G | | 27, 41 | | | | BOLT AND WASHER, Hex Head, M10x1.50x40.00 |
| 4 | 05171050AA | 2 | C, D, E, F, G | | 27, 41 | | | | RETAINER, Stabilizer Bar Grommet |
| 5 | | | | | | | | | BUSHING, Stabilizer Bar |
| | 05272589AB | 2 | C, D, E, F, G | | 27, 41 | | | | [SDC,SDF,SDE] |
| | 05272590AB | 2 | C, D, E, F, G | | 27, 41 | | | | [SDA] |
| 6 | | | | | | | | | STABILIZER BAR, Front |
| | 05105602AB | 1 | C, D, E, F, G | | 27, 41 | | | | 26 MM |
| | 05272644AB | 1 | C, D, E, F, G | | 27, 41 | | | | 24 MM |

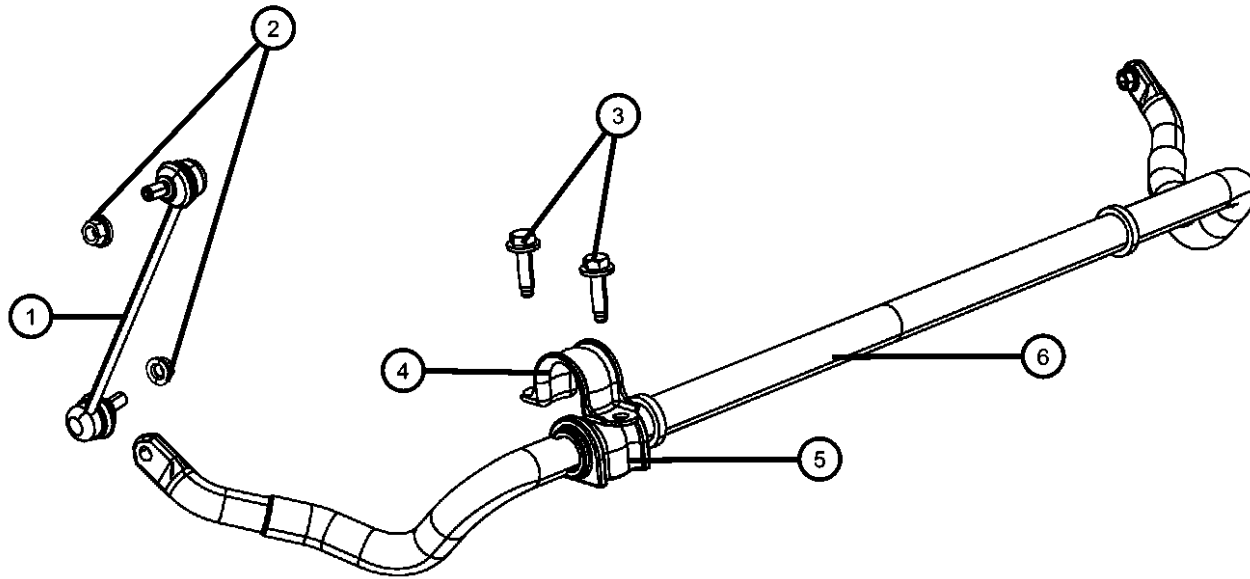

SEBRING/AVENGER (JS)

| | | | | |
|---------------|--------------------|-----------------------|---|---|
| SERIES | LINE | BODY | ENGINE | TRANSMISSION |
| H = HIGHLINE | C = CHRYSLER | 27 = 2-DR CONVERTIBLE | EER = 2.7L V6 DOHC 24 Valve MPI Engine | DFF = 4-Speed Automatic VLP 41TE Trans |
| P = PREMIUM | G = CHRYSLER | 41 = SEDAN/QUAD CAB | ECD = 2.0L 4 Cyl DOHC Diesel 16V Engine | DEF = 6-Speed Manual Aisin BG6 Trans |
| S = SPORT | Z = CHRYSLER (RHD) | SWB | ECN = 2.0L 4 Cyl DOHC 16V Dual VVT Engine | DG2 = 6-Speed Automatic 62TE Transmission |
| X = SPECIAL | D = DODGE | | ED3 = 2.4L 4 Cyl DOHC 16V Dual VVT Engine | DG5 = 6-Spd Auto Getrag MPS6 Transmission |
| | E = DODGE AWD | | EDG = Engine -2.4L I4 PZEV 16V Dual VVT | DD7 = 5-Speed Manual T355 Transmission |
| | F = CHRYSLER AWD | | EGF = 3.5L High Output V6 24V MPI Engine | |

AR = use ase required - = Non illustrated part

2008 JS

Group - 3590

All Wheel Drive; Differential and Drive Line

Group - 3590 All Wheel Drive; Differential and Drive Line

Illustration Title

Group-Fig. No.

Front Axle Drive Shafts

Shafts, Front Axle Fig. 3590 - 305
 Shafts, Front Axle Fig. 3590 - 306

Drive Shaft

Shaft , Drive Fig. 3590 - 605

Rear Axle Assembly

Axle Assembly Fig. 3590 - 705

Rear Axle Shafts

Shafts, Rear Axle Fig. 3590 - 905

| | | | |
|--|----------------------------------|---|---------------------------------------|
| 003590-300 Front Axle Drive Shafts | 003590-600 Drive Shaft | 003590-700 Rear Axle Assembly | 003590-900 Rear Axle Shafts |
|--|----------------------------------|---|---------------------------------------|

Shafts, Front Axle
Figure 3590-305

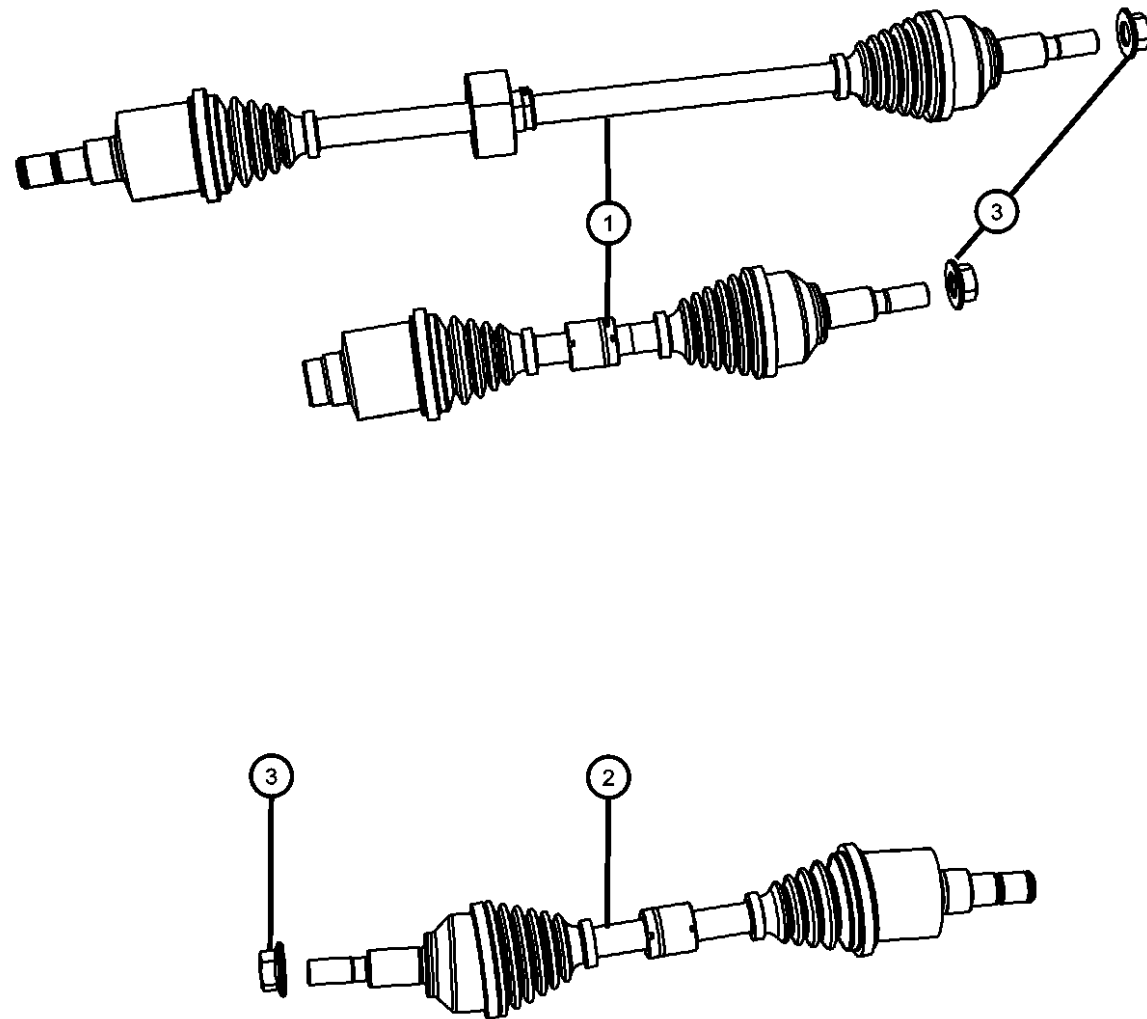

| ITEM | PART NUMBER | QTY | LINE | SERIES | BODY | ENGINE | TRANS | TRIM | DESCRIPTION |
|--|-------------|-----|------------------|--------|--------|--------|-------|------|--------------------------------|
| Sales Codes [ECN]=2.0L 4 CYL DOHC 16V SMPI [ED3]=2.4L 4 CYL DOHC 16V SMPI [EEE]=2.7L V6 24V FFV [EER]=2.7L V6 24V MPI [EGF]=3.5l V6 HIGH OUTPUT [ECD]=2.0L 4CYL DOHC DIESEL 16V [DGL]=4 SPEED AUTO [DG2]=6 SPEED AUTO [DD7] | | | | | | | | | |
| 1 | | | | | | | | | SHAFT, Front Drive |
| | 05085120AE | 1 | C, D, E, G, Z | | 41 | | | | [ECN], Right |
| | 05085185AD | 1 | C, D, E, G, Z | | 41 | | | | [EER], Right |
| | 05273532AD | 1 | C, D, E, G, Z | | 41 | | | | [ECD], Right |
| | 05273546AC | 1 | C, D, E, G, Z | | 41 | | | | [EGF], Right |
| | 05273558AD | 1 | C, D, E, G, Z | | 41 | | | | [ED3], Right |
| 2 | | | | | | | | | SHAFT, Front Drive |
| | 05085180AD | 1 | C, D, E, G, Z | | 41 | | | | [ED3,EER], Left |
| | 05273531AC | 1 | C, D, E, G, Z | | 41 | | | | [ECD], Left |
| | 05273545AC | 1 | C, D, E, G, Z | | 41 | | | | [EGF], Left |
| | 05273763AD | 1 | C, D, E, G, Z | | 41 | | | | [ECN], Left |
| 3 | | | | | | | | | NUT, Hex Flange Lock, M22x1.50 |
| | 06105190AA | 2 | C, D, E, F, G | | 27, 41 | | | | |
| | | 2 | Z | | 27, 41 | | | | |

SEBRING/AVENGER (JS)

| SERIES | LINE | BODY | ENGINE | TRANSMISSION |
|--------------|--------------------|-------------------------|---|---|
| H = HIGHLINE | C = CHRYSLER | 27 = 2-DR CONVERTIBLE | EER = 2.7L V6 DOHC 24 Valve MPI Engine | DFF = 4-Speed Automatic VLP 41TE Trans |
| P = PREMIUM | G = CHRYSLER | 41 = SEDAN/QUAD CAB SWB | ECD = 2.0L 4 Cyl DOHC Diesel 16V Engine | DEF = 6-Speed Manual Aisin BG6 Trans |
| S = SPORT | Z = CHRYSLER (RHD) | | ECN = 2.0L 4 Cyl DOHC 16V Dual VVT Engine | DG2 = 6-Speed Automatic 62TE Transmission |
| X = SPECIAL | D = DODGE | | ED3 = 2.4L 4 Cyl DOHC 16V Dual VVT Engine | DG5 = 6-Spd Auto Getrag MPS6 Transmission |
| | E = DODGE AWD | | EDG = Engine -2.4L I4 PZEV 16V Dual VVT | DD7 = 5-Speed Manual T355 Transmission |
| | F = CHRYSLER AWD | | EGF = 3.5L High Output V6 24V MPI Engine | |

AR = use ase required - = Non illustrated part

2008 JS

Shafts, Front Axle
Figure 3590-306

| ITEM | PART NUMBER | QTY | LINE | SERIES | BODY | ENGINE | TRANS | TRIM | DESCRIPTION |
|------|-------------|-----|---------------|--------|--------|--------|-------|------|---------------------|
| 1 | 05085097AC | 1 | Z | | 27, 41 | | | | SHAFT, Intermediate |
| | | 1 | C, D, E, F, G | | 27, 41 | | | | |
| 2 | 05085094AC | 1 | Z | | 41 | | | | SHAFT, Intermediate |
| | | 1 | C, Z | | 27 | | | | |
| | | 1 | C, D, E, F, G | | 41 | | | | |
| 3 | 05085096AD | 1 | C, Z | | 27 | | | | SHAFT, Intermediate |
| | | 1 | C, D, E, F, G | | 41 | | | | |
| | | 1 | Z | | 41 | | | | |
| 4 | 05085098AB | 1 | C, D, E, F, G | | 27, 41 | | | | SHAFT, Intermediate |
| | | 1 | Z | | 27, 41 | | | | |
| 5 | 05273644AD | 1 | C, D, G, Z | | 27, 41 | | | | SHAFT, Intermediate |
| 6 | 04743817AD | 1 | E | | 41 | | | | SHAFT, Intermediate |
| | | 1 | E, F | | 41 | | | | |
| 7 | 05273469AE | 1 | C, D, E, F, G | | 41 | | | | SHAFT, Intermediate |
| | | 1 | Z | | 41 | | | | |
| | | 1 | C, Z | | 27 | | | | |
| 8 | 06104200AA | 2 | Z | | 27, 41 | | | | SCREW |
| | | 2 | C, Z | | 27 | | | | |
| | | 2 | C, D, E, F, G | | 41 | | | | |
| 9 | 06104179AA | 3 | C, D, E, F, G | | 27, 41 | | | | BOLT |

SEBRING/AVENGER (JS)

SERIES

H = HIGHLINE
P = PREMIUM
S = SPORT
X = SPECIAL

LINE

C = CHRYSLER
G = CHRYSLER
Z = CHRYSLER (RHD)
D = DODGE
E = DODGE AWD
F = CHRYSLER AWD

BODY

27 = 2-DR CONVERTIBLE
41 = SEDAN/QUAD CAB
SWB

ENGINE

EER = 2.7L V6 DOHC 24 Valve MPI Engine
ECD = 2.0L 4 Cyl DOHC Diesel 16V Engine
ECN = 2.0L 4 Cyl DOHC 16V Dual VVT Engine
ED3 = 2.4L 4 Cyl DOHC 16V Dual VVT Engine
EDG = Engine -2.4L I4 PZEV 16V Dual VVT
EGF = 3.5L High Output V6 24V MPI Engine

TRANSMISSION

DFF = 4-Speed Automatic VLP 41TE Trans
DEF = 6-Speed Manual Aisin BG6 Trans
DG2 = 6-Speed Automatic 62TE Transmission
DG5 = 6-Spd Auto Getrag MPS6 Transmission
DD7 = 5-Speed Manual T355 Transmission

AR = use ase required - = Non illustrated part

2008 JS

Shafts, Front Axle
Figure 3590-306

| ITEM | PART NUMBER | QTY | LINE | SERIES | BODY | ENGINE | TRANS | TRIM | DESCRIPTION |
|------|-------------|-----|------|--------|------|--------|-------|------|-------------|
|------|-------------|-----|------|--------|------|--------|-------|------|-------------|

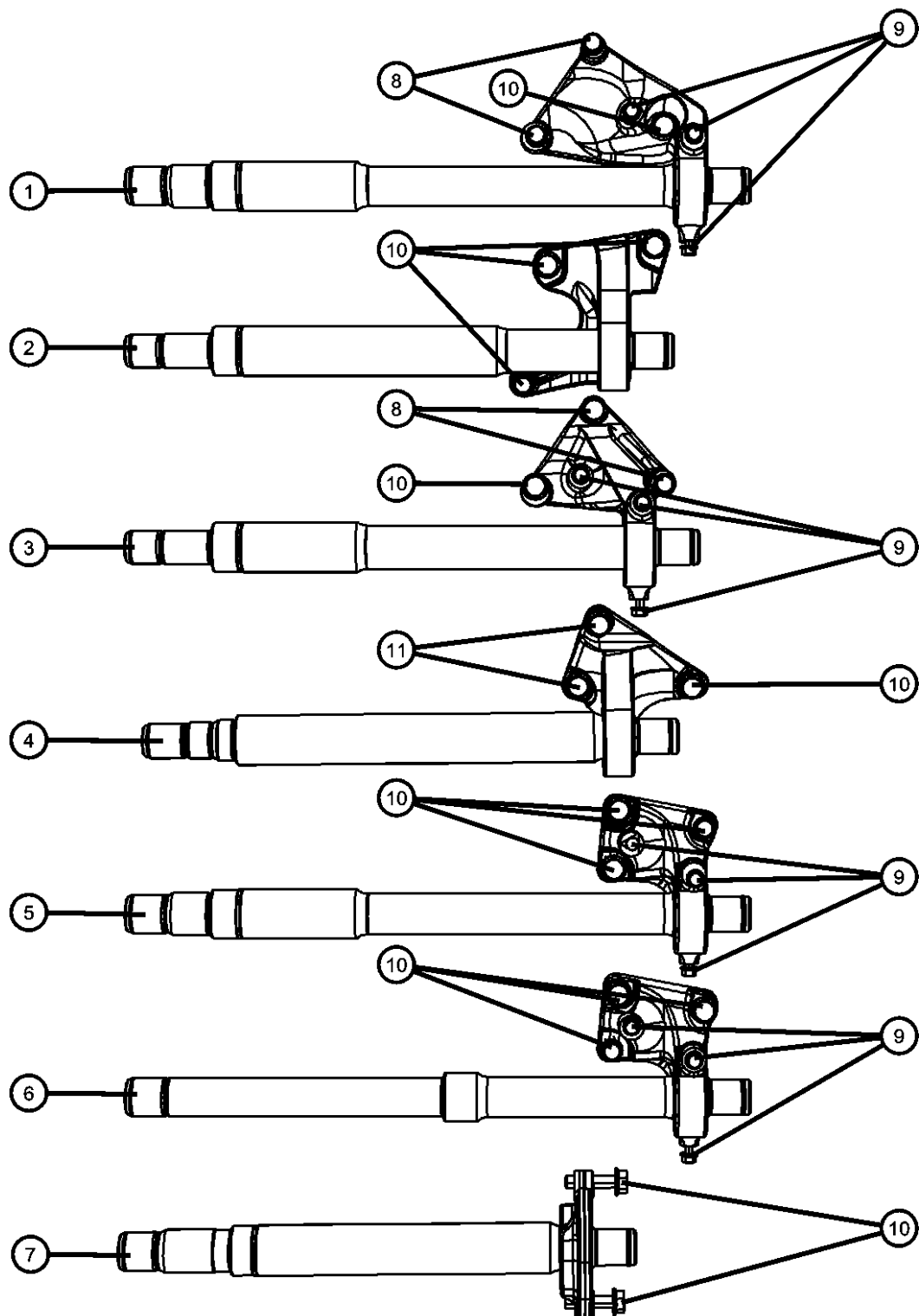

| | | | | | | | | | |
|----|------------|---|---------------|--|--------|--|--|--|---------------------------------------|
| 10 | | | | | | | | | BOLT, Hex Flange Head, M10x1.50x40.00 |
| | 06104218AA | 2 | C, D, E, F, G | | 27, 41 | | | | |
| | | 2 | Z | | 27, 41 | | | | |
| 11 | | | | | | | | | BOLT, Hex Flange Head, M8x1.25x30 |
| | 06104025AA | 2 | C, D, E, F, G | | 27, 41 | | | | |
| | | 2 | Z | | 27, 41 | | | | |

SEBRING/AVENGER (JS)

| SERIES | LINE | BODY | ENGINE | TRANSMISSION |
|--------------|--------------------|-----------------------|---|---|
| H = HIGHLINE | C = CHRYSLER | 27 = 2-DR CONVERTIBLE | EER = 2.7L V6 DOHC 24 Valve MPI Engine | DFF = 4-Speed Automatic VLP 41TE Trans |
| P = PREMIUM | G = CHRYSLER | 41 = SEDAN/QUAD CAB | ECD = 2.0L 4 Cyl DOHC Diesel 16V Engine | DEF = 6-Speed Manual Aisin BG6 Trans |
| S = SPORT | Z = CHRYSLER (RHD) | SWB | ECN = 2.0L 4 Cyl DOHC 16V Dual VVT Engine | DG2 = 6-Speed Automatic 62TE Transmission |
| X = SPECIAL | D = DODGE | | ED3 = 2.4L 4 Cyl DOHC 16V Dual VVT Engine | DG5 = 6-Spd Auto Getrag MPS6 Transmission |
| | E = DODGE AWD | | EDG = Engine -2.4L I4 PZEV 16V Dual VVT | DD7 = 5-Speed Manual T355 Transmission |
| | F = CHRYSLER AWD | | EGF = 3.5L High Output V6 24V MPI Engine | |

AR = use ase required - = Non illustrated part

2008 JS

**Shaft , Drive
Figure 3590-605**

| ITEM | PART NUMBER | QTY | LINE | SERIES | BODY | ENGINE | TRANS | TRIM | DESCRIPTION |
|------|-------------|-----|------|--------|------|--------|-------|------|---|
| 1 | 05157012AD | 1 | E, F | | 41 | | | | SHAFT, Drive, Rear 2-Piece |
| 2 | 05157011AA | 1 | E, F | | 41 | | | | SHIELD, Heat |
| 3 | 68024965AA | 1 | E, F | | 41 | | | | BOLT AND RETAINER KIT, Driveshaft |
| 4 | 06104716AA | 2 | E, F | | 41 | | | | NUT, Hex Flange Lock, M8X1.25 |
| 5 | 06501596 | 3 | E, F | | 41 | | | | SCREW AND WASHER, Hex Head, M10x1.5x45 |
| 6 | 06104416AA | 2 | E, F | | 41 | | | | BOLT AND WASHER, Hex Head, M10X1.50X35.00 |

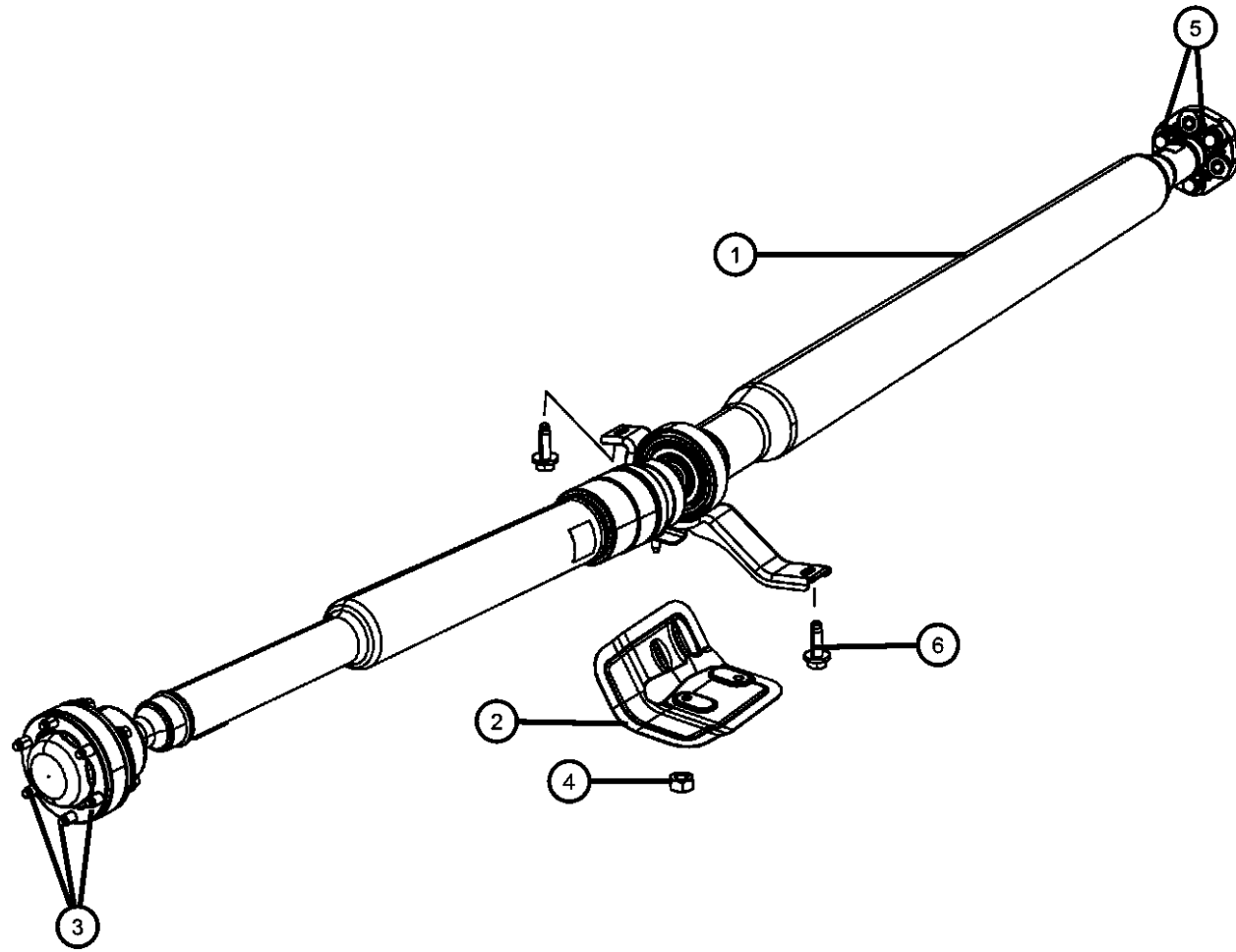

SEBRING/AVENGER (JS)

| SERIES | LINE | BODY | ENGINE | TRANSMISSION |
|--------------|--------------------|-----------------------|---|---|
| H = HIGHLINE | C = CHRYSLER | 27 = 2-DR CONVERTIBLE | EER = 2.7L V6 DOHC 24 Valve MPI Engine | DFF = 4-Speed Automatic VLP 41TE Trans |
| P = PREMIUM | G = CHRYSLER | 41 = SEDAN/QUAD CAB | ECD = 2.0L 4 Cyl DOHC Diesel 16V Engine | DEF = 6-Speed Manual Aisin BG6 Trans |
| S = SPORT | Z = CHRYSLER (RHD) | SWB | ECN = 2.0L 4 Cyl DOHC 16V Dual VVT Engine | DG2 = 6-Speed Automatic 62TE Transmission |
| X = SPECIAL | D = DODGE | | ED3 = 2.4L 4 Cyl DOHC 16V Dual VVT Engine | DG5 = 6-Spd Auto Getrag MPS6 Transmission |
| | E = DODGE AWD | | EDG = Engine -2.4L I4 PZEV 16V Dual VVT | DD7 = 5-Speed Manual T355 Transmission |
| | F = CHRYSLER AWD | | EGF = 3.5L High Output V6 24V MPI Engine | |

AR = use ase required - = Non illustrated part

2008 JS

**Axle Assembly
Figure 3590-705**

| ITEM | PART NUMBER | QTY | LINE | SERIES | BODY | ENGINE | TRANS | TRIM | DESCRIPTION |
|------|-------------|-----|------|--------|------|--------|-------|------|---------------------------------------|
| 1 | 05157002AB | 1 | E, F | | 41 | | | | DIFFERENTIAL, Rear Axle |
| 2 | 06502725 | 3 | E, F | | 41 | | | | BOLT, Hex Flange Head, M12x1.75x90.00 |
| 3 | 06502835 | 3 | E, F | | 41 | | | | NUT, Hex Flange Lock, M12x1.75 |
| 4 | 04809686AA | 1 | E, F | | 41 | | | | VENT |

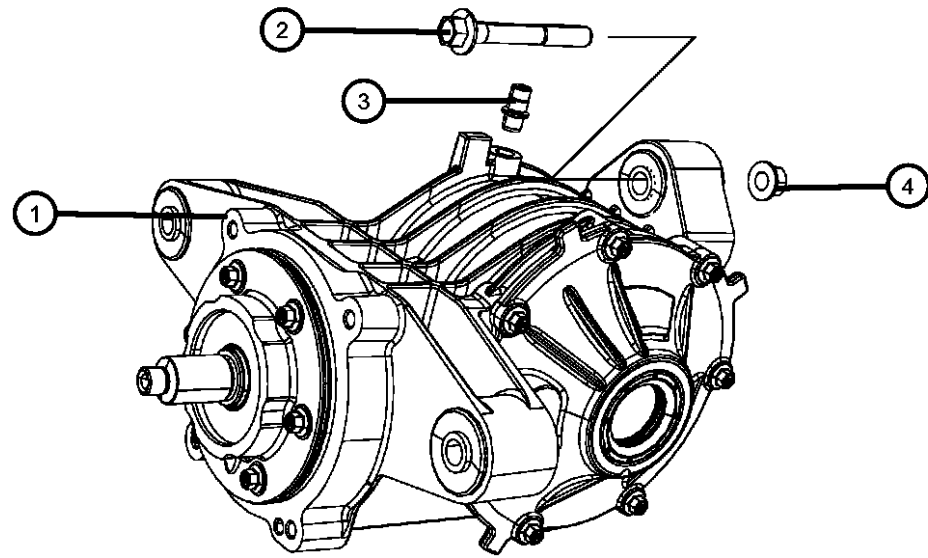

SEBRING/AVENGER (JS)

| SERIES | LINE | BODY | ENGINE | TRANSMISSION |
|--------------|--------------------|-----------------------|---|---|
| H = HIGHLINE | C = CHRYSLER | 27 = 2-DR CONVERTIBLE | EER = 2.7L V6 DOHC 24 Valve MPI Engine | DFF = 4-Speed Automatic VLP 41TE Trans |
| P = PREMIUM | G = CHRYSLER | 41 = SEDAN/QUAD CAB | ECD = 2.0L 4 Cyl DOHC Diesel 16V Engine | DEF = 6-Speed Manual Aisin BG6 Trans |
| S = SPORT | Z = CHRYSLER (RHD) | SWB | ECN = 2.0L 4 Cyl DOHC 16V Dual VVT Engine | DG2 = 6-Speed Automatic 62TE Transmission |
| X = SPECIAL | D = DODGE | | ED3 = 2.4L 4 Cyl DOHC 16V Dual VVT Engine | DG5 = 6-Spd Auto Getrag MPS6 Transmission |
| | E = DODGE AWD | | EDG = Engine -2.4L I4 PZEV 16V Dual VVT | DD7 = 5-Speed Manual T355 Transmission |
| | F = CHRYSLER AWD | | EGF = 3.5L High Output V6 24V MPI Engine | |

AR = use ase required - = Non illustrated part

2008 JS

Shafts, Rear Axle
Figure 3590-905

| ITEM | PART NUMBER | QTY | LINE | SERIES | BODY | ENGINE | TRANS | TRIM | DESCRIPTION |
|------|-------------|-----|------------------|--------|--------|--------|-------|------|--------------------------------|
| 1 | 05085100AB | 1 | E, F | | 41 | | | | SHAFT, Axle HalfRight |
| 2 | 05085099AB | 1 | E, F | | 41 | | | | SHAFT, Axle HalfLeft |
| 3 | 06105190AA | 2 | C, D, E, F, G | | 27, 41 | | | | NUT, Hex Flange Lock, M22x1.50 |

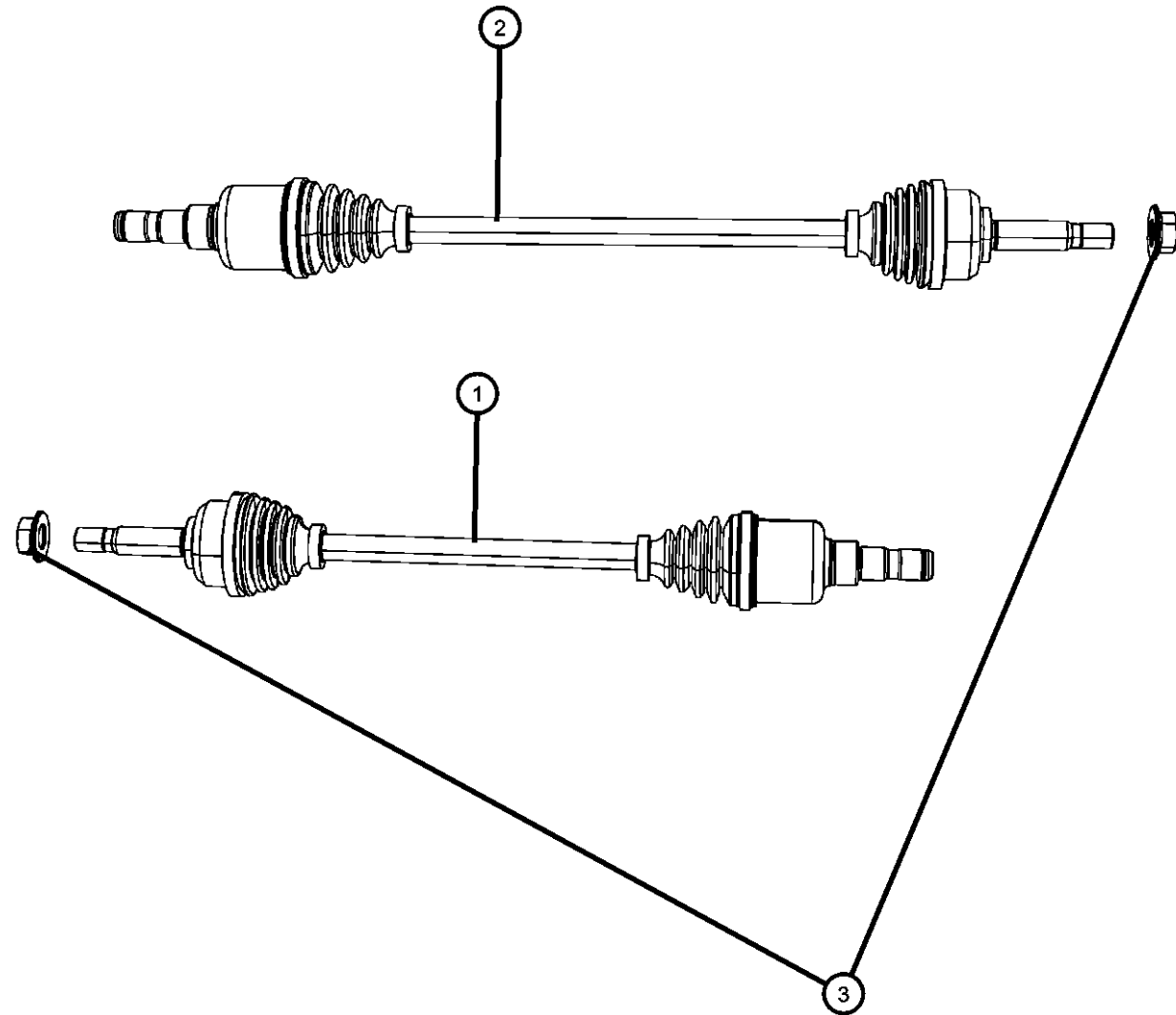

SEBRING/AVENGER (JS)

| SERIES | LINE | BODY | ENGINE | TRANSMISSION |
|--------------|--------------------|-----------------------|---|---|
| H = HIGHLINE | C = CHRYSLER | 27 = 2-DR CONVERTIBLE | EER = 2.7L V6 DOHC 24 Valve MPI Engine | DFF = 4-Speed Automatic VLP 41TE Trans |
| P = PREMIUM | G = CHRYSLER | 41 = SEDAN/QUAD CAB | ECD = 2.0L 4 Cyl DOHC Diesel 16V Engine | DEF = 6-Speed Manual Aisin BG6 Trans |
| S = SPORT | Z = CHRYSLER (RHD) | SWB | ECN = 2.0L 4 Cyl DOHC 16V Dual VVT Engine | DG2 = 6-Speed Automatic 62TE Transmission |
| X = SPECIAL | D = DODGE | | ED3 = 2.4L 4 Cyl DOHC 16V Dual VVT Engine | DG5 = 6-Spd Auto Getrag MPS6 Transmission |
| | E = DODGE AWD | | EDG = Engine -2.4L I4 PZEV 16V Dual VVT | DD7 = 5-Speed Manual T355 Transmission |
| | F = CHRYSLER AWD | | EGF = 3.5L High Output V6 24V MPI Engine | |

AR = use ase required - = Non illustrated part

2008 JS

Group - 0035ZU

Front Wheel Drive; Differential and Drive Line

Group - 0035ZU Front Wheel Drive; Differential and Drive Line

Illustration Title

Group-Fig. No.

Front Axle Drive Shafts

| | |
|--------------------------|-------------------|
| Shafts, Front Axle | Fig. 0035ZU - 305 |
| Shafts, Front Axle | Fig. 0035ZU - 306 |

| | | | |
|--|--|--|--|
| 0035ZU-300 Front Axle Drive Shafts | | | |
|--|--|--|--|

Shafts, Front Axle
Figure 0035ZU-305

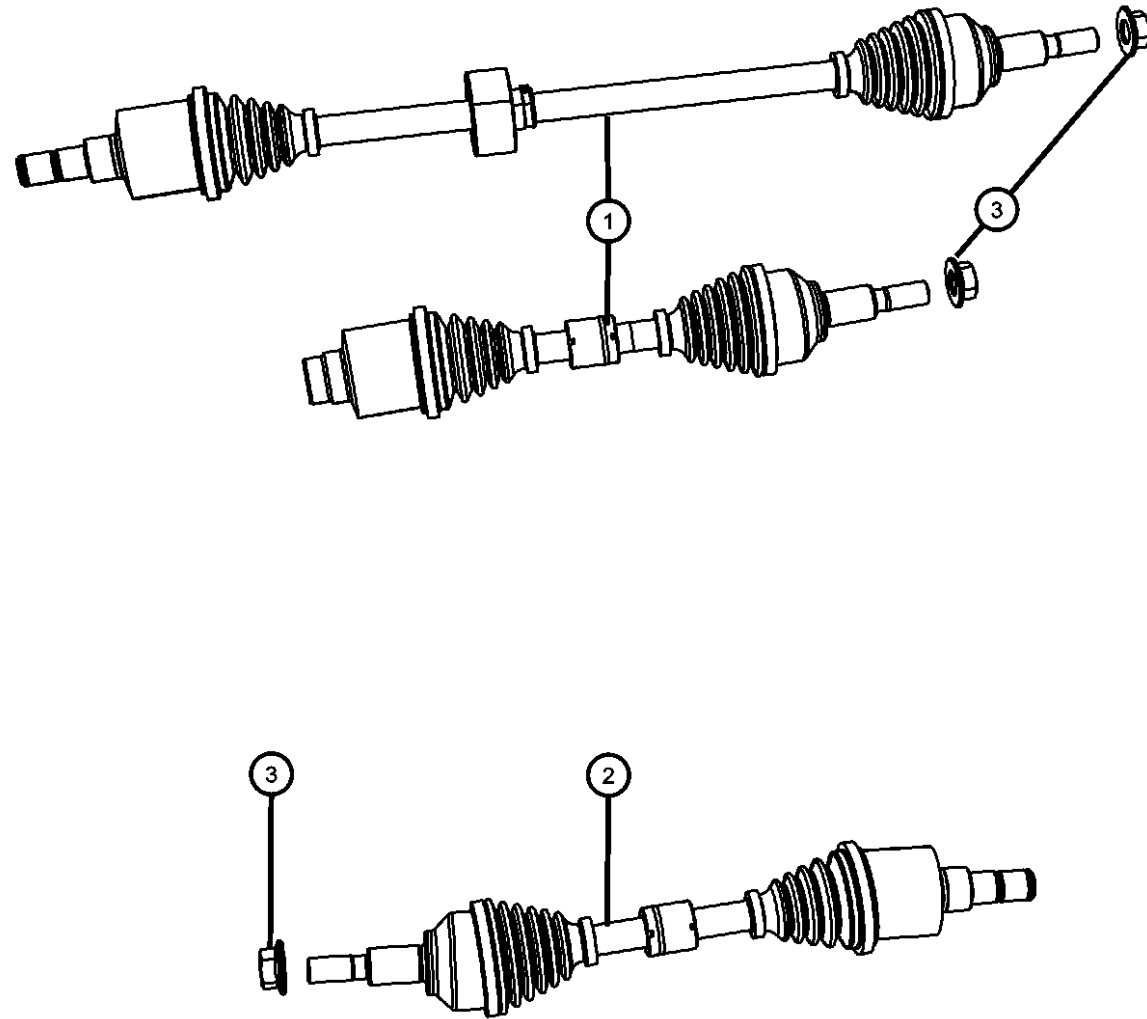

| ITEM | PART NUMBER | QTY | LINE | SERIES | BODY | ENGINE | TRANS | TRIM | DESCRIPTION |
|------|-------------|-----|------|--------|------|--------|-------|------|-------------|
|------|-------------|-----|------|--------|------|--------|-------|------|-------------|

Sales Codes

[ECN]=2.0L 4 CYL DOHC 16V SMPI
 [ED3]=2.4L 4 CYL DOHC 16V SMPI
 [EEE]=2.7L V6 24V FFV
 [EER]=2.7L V6 24V MPI
 [EGF]=3.5L V6 HIGH OUTPUT
 [ECD]=2.0L 4CYL DOHC DIESEL 16V
 [DGL]=4 SPEED AUTO
 [DG2]=6 SPEED AUTO
 [DD7]

| | | | | | | | | | |
|---|------------|---|------------------|--|--------|--|--|--|--------------------------------|
| 1 | | | | | | | | | SHAFT, Front Drive |
| | 05085120AE | 1 | C, D, E, F, G | | 27, 41 | | | | [ECN], Right |
| | 05085185AD | 1 | C, Z | | 27 | | | | [EER], Right |
| | | 1 | C, D, E, F, G | | 41 | | | | [EER], Right |
| | 05273532AC | 1 | C, D, E, G, Z | | 27, 41 | | | | [ECD], Right |
| | 05273546AC | 1 | C, Z | | 27 | | | | [EER,EGF], Right |
| | | 1 | C, D, E, F, G | | 41 | | | | [EER,EGF], Right |
| | 05273558AD | 1 | C, Z | | 27 | | | | [ED3], Right |
| | | 1 | C, D, E, G, Z | | 41 | | | | [ED3], Right |
| 2 | | | | | | | | | SHAFT, Front Drive |
| | 05085180AD | 1 | C, Z | | 27 | | | | [ED3,EER], Left |
| | | 1 | C, D, E, G, Z | | 41 | | | | [ED3,EER], Left |
| | 05273531AC | 1 | C, D, E, F, G | | 41 | | | | [ECD], Left |
| | | 1 | Z | | 41 | | | | [ECD], Left |
| | 05273545AB | 1 | C, D, E, G, Z | | 27, 41 | | | | [EGF], Left |
| | 05273763AD | 1 | C, Z | | 27 | | | | [ECN], Left |
| | | 1 | C, D, E, G, Z | | 41 | | | | [ECN], Left |
| 3 | | | | | | | | | NUT, Hex Flange Lock, M22x1.50 |

SEBRING/AVENGER (JS)

| SERIES | LINE | BODY | ENGINE | TRANSMISSION |
|--------------|--------------------|-----------------------|---|---|
| H = HIGHLINE | C = CHRYSLER | 27 = 2-DR CONVERTIBLE | EER = 2.7L V6 DOHC 24 Valve MPI Engine | DFF = 4-Speed Automatic VLP 41TE Trans |
| P = PREMIUM | G = CHRYSLER | 41 = SEDAN/QUAD CAB | ECD = 2.0L 4 Cyl DOHC Diesel 16V Engine | DEF = 6-Speed Manual Aisin BG6 Trans |
| S = SPORT | Z = CHRYSLER (RHD) | SWB | ECN = 2.0L 4 Cyl DOHC 16V Dual VVT Engine | DG2 = 6-Speed Automatic 62TE Transmission |
| X = SPECIAL | D = DODGE | | ED3 = 2.4L 4 Cyl DOHC 16V Dual VVT Engine | DG5 = 6-Spd Auto Getrag MPS6 Transmission |
| | E = DODGE AWD | | EDG = Engine -2.4L I4 PZEV 16V Dual VVT | DD7 = 5-Speed Manual T355 Transmission |
| | F = CHRYSLER AWD | | EGF = 3.5L High Output V6 24V MPI Engine | |

AR = use ase required - = Non illustrated part

2008 JS

Shafts, Front Axle
Figure 0035ZU-305

| ITEM | PART NUMBER | QTY | LINE | SERIES | BODY | ENGINE | TRANS | TRIM | DESCRIPTION |
|------|-------------|-----|------|--------|------|--------|-------|------|-------------|
|------|-------------|-----|------|--------|------|--------|-------|------|-------------|

| | | | | | | | | | |
|--|------------|---|------------------|--|--------|--|--|--|--|
| | 06105190AA | 2 | C, D, E, F, G | | 27, 41 | | | | |
| | | 2 | Z | | 27, 41 | | | | |

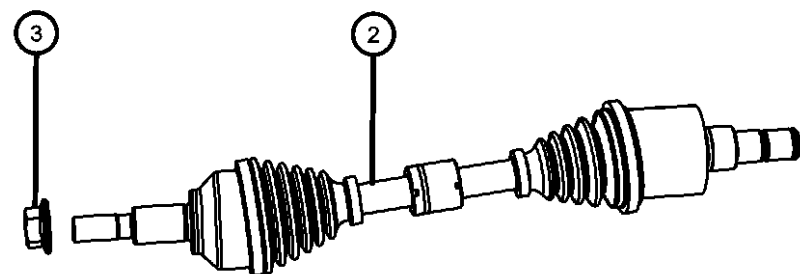
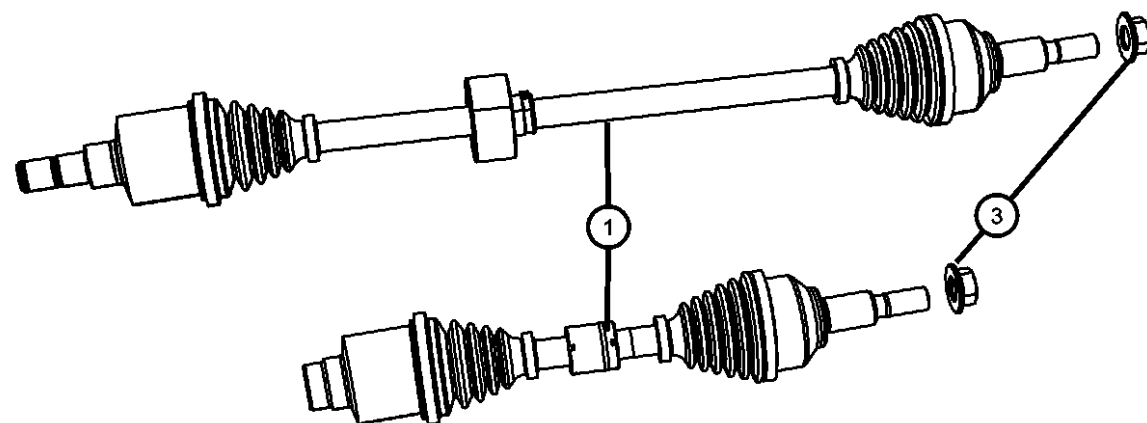

SEBRING/AVENGER (JS)

SERIES

H = HIGHLINE
 P = PREMIUM
 S = SPORT
 X = SPECIAL
 C = CHRYSLER
 G = CHRYSLER
 Z = CHRYSLER (RHD)
 D = DODGE
 E = DODGE AWD
 F = CHRYSLER AWD

LINE

BODY

27 = 2-DR CONVERTIBLE
 41 = SEDAN/QUAD CAB
 SWB

ENGINE

EER = 2.7L V6 DOHC 24 Valve MPI Engine
 ECD = 2.0L 4 Cyl DOHC Diesel 16V Engine
 ECN = 2.0L 4 Cyl DOHC 16V Dual VVT Engine
 ED3 = 2.4L 4 Cyl DOHC 16V Dual VVT Engine
 EDG = Engine -2.4L I4 PZEV 16V Dual VVT
 EGF = 3.5L High Output V6 24V MPI Engine

TRANSMISSION

DFF = 4-Speed Automatic VLP 41TE Trans
 DEF = 6-Speed Manual Aisin BG6 Trans
 DG2 = 6-Speed Automatic 62TE Transmission
 DG5 = 6-Spd Auto Getrag MPS6 Transmission
 DD7 = 5-Speed Manual T355 Transmission

AR = use ase required - = Non illustrated part

2008 JS