

VIN PLATE DECODING INFORMATION

1	2	3	4	5	6	7	8	9	10	11	12 thru 17
Country	Make	Vehicle Type	Other	Line	Series	Body Style	Engine	Check Digit	Model Year	Assy. Plant	Sequence No.

The following table interprets the VIN Plate position shown above.

Position	Interpretation	Codes = Description
1	Country of Origin	1 = Built in U.S. by DaimlerChrysler
2	Assembler	B = Dodge C = Chrysler
3	Vehicle Type	3 = Passenger Car
4	GVWR & Pass. Safety	E = Restraint System Active Driver & Passenger Air Bags (CGW) A = Restraint System Active Front and Side Air Bags (CGS) B = Restraint System Manual/Active Uni-belt (CGA) D = Restraint System w/o Air Bags (CGJ)
5	Vehicle Line	J = Cirrus (Mexico) L = Stratus/Sebring
6	Series	5 = Cirrus LXI (C-P41) 6 = Cirrus/Sebring LIMITED(C-S27) 7 = Sebring GTC (C-X27) * = Sebring LE Bux w/ABB (C-H27 & C-H41) 4 = Sebring LE Bux w/o ABB (C-H27 & C-H41) 4 = Sebring LX (C-H27 & C-H41) * = Sebring LX Bux w/ABB (C-P27 & C-P41) 5 = Sebring LX Bux w/o ABB (C-P27) 5 = Sebring LXI (C-P27 & C-P41)
7	Body Style	2 = 2 Door Convertible - Open Body (27) 6 = 4 Door Sedan (41)
8	Engine	Y = 2.0L 4 Cyl DOHC 16V (ECC) S = 2.4L 4 Cyl 16V DOHC Turbo (EDV) X = 2.4L 4 Cyl DOHC 16V (EDZ) R = 2.7L V6 24V DOHC (EER) T = 2.7L V6 24V Flex Fuel (EEE) U = 2.7L V6 24V With Active Intake (EES) J = 2.4L 4 Cyl. 16V Pzev (ED2)
9	Check Digit	0 = Check Digit 0 = Check Digit
10	Model Year	4 = 2004
11	Assembly Plant	N = Sterling Heights Assembly
12 thru 17	Vehicle Build Sequence	Model Year Assembly Sequence

Group - 1

Component Parts for Mopar Accessories

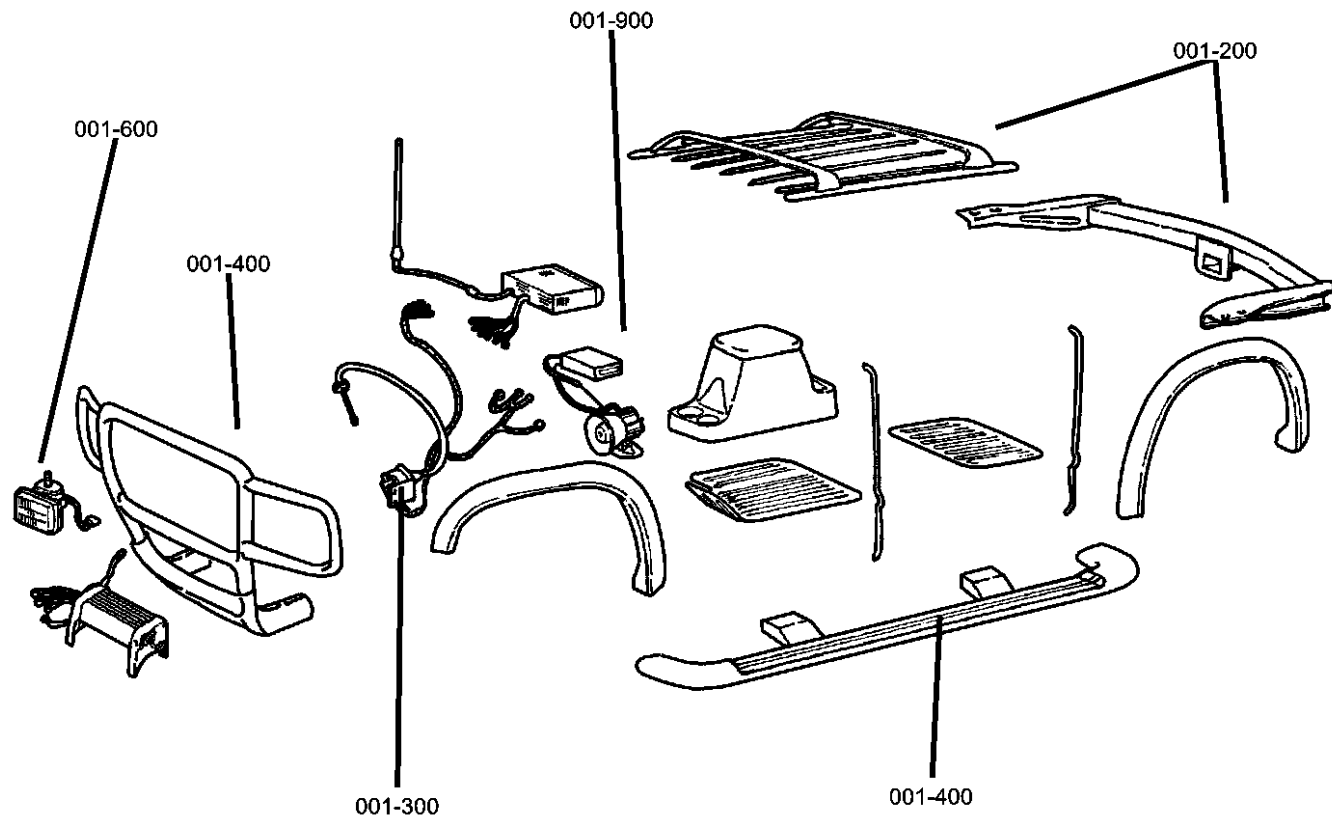

Group - 1 Component Parts for Mopar Accessories

Group-Fig. No.

Illustration Title

Audio & Electronics

CD Changer - 6 Disc.....	Fig. 1 - 110
Satellite Receiver Kit.....	Fig. 1 - 120
Install Kit, Satellite Receiver.....	Fig. 1 - 130
Install Kit, Satellite Receiver.....	Fig. 1 - 140
Navigation Kit.....	Fig. 1 - 150

Carriers & Cargo Hauling

Bike Carrier - Hitch.....	Fig. 1 - 210
Bike Carrier - Roof / Fork Mount Style.....	Fig. 1 - 212
Bike Carrier - Roof / Upright Mount Style.....	Fig. 1 - 214
Carrier Kit - Watersports.....	Fig. 1 - 218
Carrier Kit - Luggage.....	Fig. 1 - 220
Ski Carrier - Roof.....	Fig. 1 - 222

Exterior Appearance

Wheel Kit.....	Fig. 1 - 410
----------------	--------------

Exterior Protection



Screen Kit - Wind.....	Fig. 1 - 510
------------------------	--------------

Fog Lights & Electrical

Heater Kit - Engine and Battery.....	Fig. 1 - 610
--------------------------------------	--------------

Security

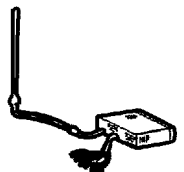
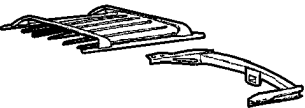
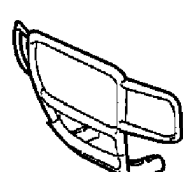
Alarm EVS II.....	Fig. 1 - 910
Factory Keyless Entry.....	Fig. 1 - 914

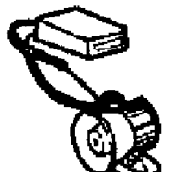
<p>001-100 Audio & Electronics</p> 	<p>001-200 Carriers & Cargo Hauling</p> 	<p>001-400 Exterior Appearance</p> 	<p>001-500 Exterior Protection</p> 
<p>001-600 Fog Lights & Electrical</p> 	<p>001-900 Security</p> 		

**CD Changer - 6 Disc
Figure 1-110**

ITEM	PART NUMBER	QTY	LINE	SERIES	BODY	ENGINE	TRANS	TRIM	DESCRIPTION
------	-------------	-----	------	--------	------	--------	-------	------	-------------

Note: For Warranty Repair on Item 2, Order Through [GPOP] Function 11, Using Z Prefix

1	82207874	1							PLAYER KIT, CD Changer - 6 Disc
2	56038659AE	1							CHANGER, CD 6 Disc
3	04671841AA	1							WIRING, Compact Disc Changer
-4	06032723	2			41				SCREW, Self Tapping, M4.2x1.69x19.05
-5									BEZEL, Compact Disc Changer
	0SZ19WL8AC	1							[L2]
		1							[L5]
	0SZ19XDVAC	1							[DV]
	0SZ19ZP7AC	1							[P7]

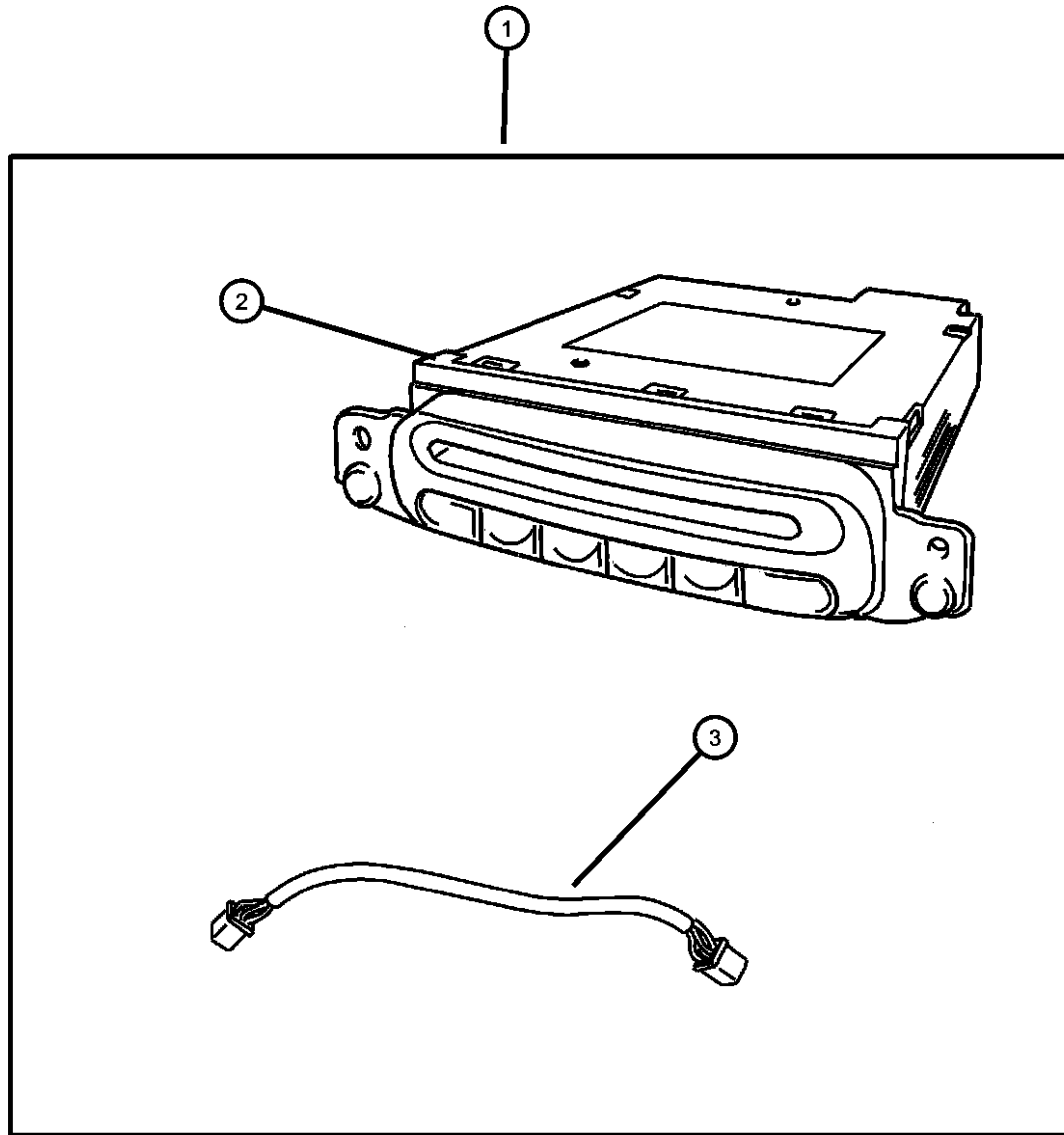

SEBRING, STRATUS, CIRRUS, BREEZE (JR)

SERIES	LINE	BODY	ENGINE	TRANSMISSION
H = HIGHLINE	D = Stratus	27 = Convertible	ECC = Engine - 2.0L 4 Cyl	DD5 = Transmission - 5-Speed Manual
P = PREMIUM	D = R/T (Mexico)	41 = 4 Door	DOHC 16V SMPI	DDR = Transmission - 5-Speed Manual
S = SPORT	C = Sebring		ED2 = Engine - 2.4L 4 Cyl	DGL = Transmission - 4-Spd. Automatic
X = SPECIAL	C = Cirrus (Mexico)		PZEV 16V DOHC	DG0 = All Automatic Transmissions
			EDV = Engine - 2.4L I4 DOHC 16V H.O. Turbo	
			EDZ = Engine - 2.4L 4 Cyl DOHC 16V SMPI	
			EEE = Engine - 2.7L V6 24V	
			FFV	
			EER = Engine - 2.7L V6 DOHC 24 Valve MPI	

AR = use ase required - = Non illustrated part

**Satellite Receiver Kit
Figure 1-120**

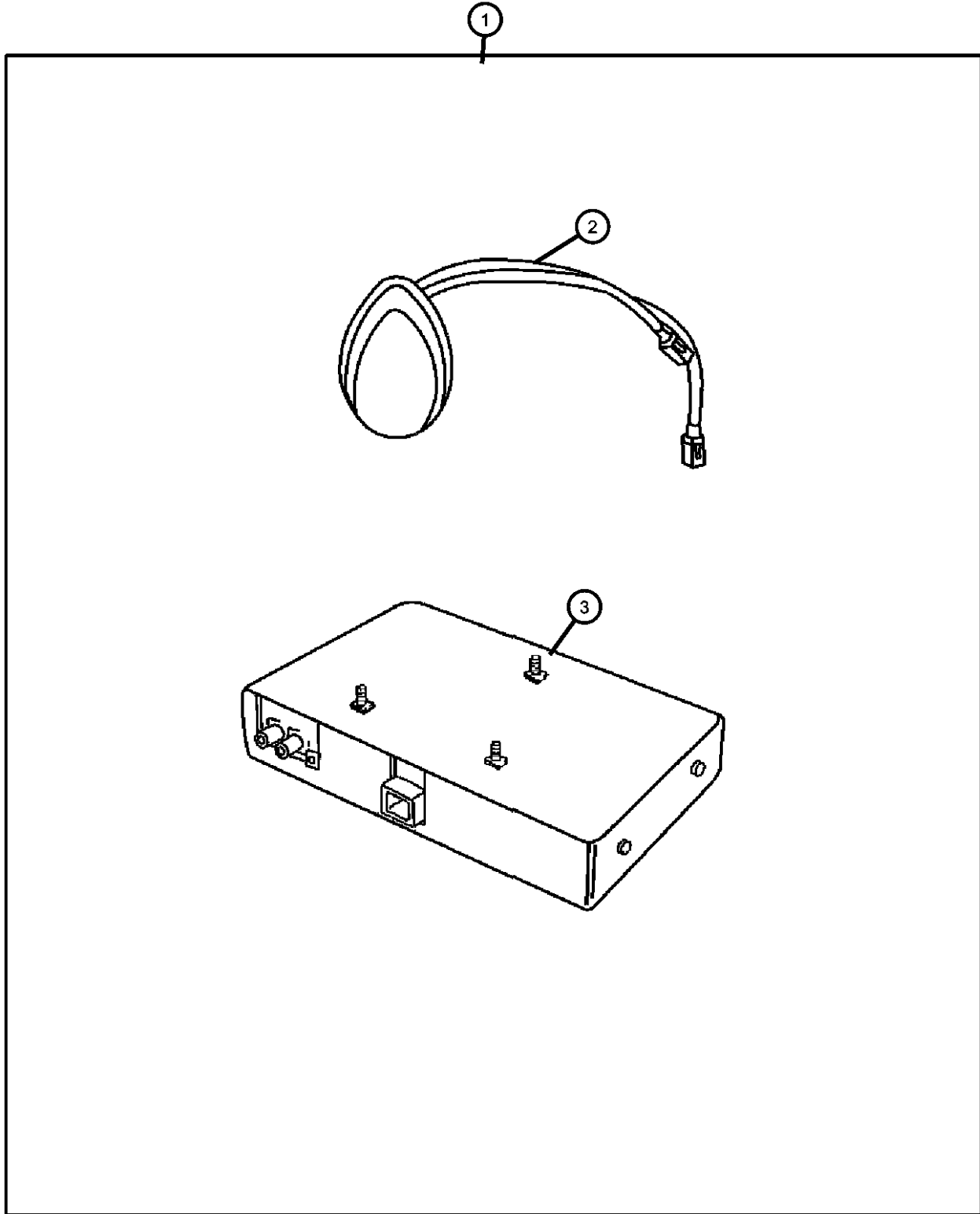

ITEM	PART NUMBER	QTY	LINE	SERIES	BODY	ENGINE	TRANS	TRIM	DESCRIPTION
------	-------------	-----	------	--------	------	--------	-------	------	-------------

Note: For Warranty Repair on Item 3, Order Through [GPOP] Function 11, Using Z Prefix

1	82206488AA	1							RECEIVER, Satellite
2	05066205AC	1							ANTENNA, Satellite
3	05064020AG	1							RECEIVER, Satellite

SEBRING, STRATUS, CIRRUS, BREEZE (JR)

SERIES	LINE	BODY	ENGINE	TRANSMISSION
H = HIGHLINE	D = Stratus	27 = Convertible	ECC = Engine - 2.0L 4 Cyl	DD5 = Transmission - 5-Speed Manual
P = PREMIUM	D = R/T (Mexico)	41 = 4 Door	DOHC 16V SMPI	DDR = Transmission - 5-Speed Manual
S = SPORT	C = Sebring		ED2 = Engine - 2.4L 4 Cyl	DGL = Transmission - 4-Spd.
X = SPECIAL	C = Cirrus (Mexico)		PZEV 16V DOHC	Automatic
			EDV = Engine - 2.4L I4 DOHC	DG0 = All Automatic Transmissions
			16V H.O. Turbo	
			EDZ = Engine - 2.4L 4 Cyl	
			DOHC 16V SMPI	
			EEE = Engine - 2.7L V6 24V	
			FFV	
			EER = Engine - 2.7L V6 DOHC	
			24 Valve MPI	

AR = use ase required - = Non illustrated part

Install Kit, Satellite Receiver
Figure 1-130

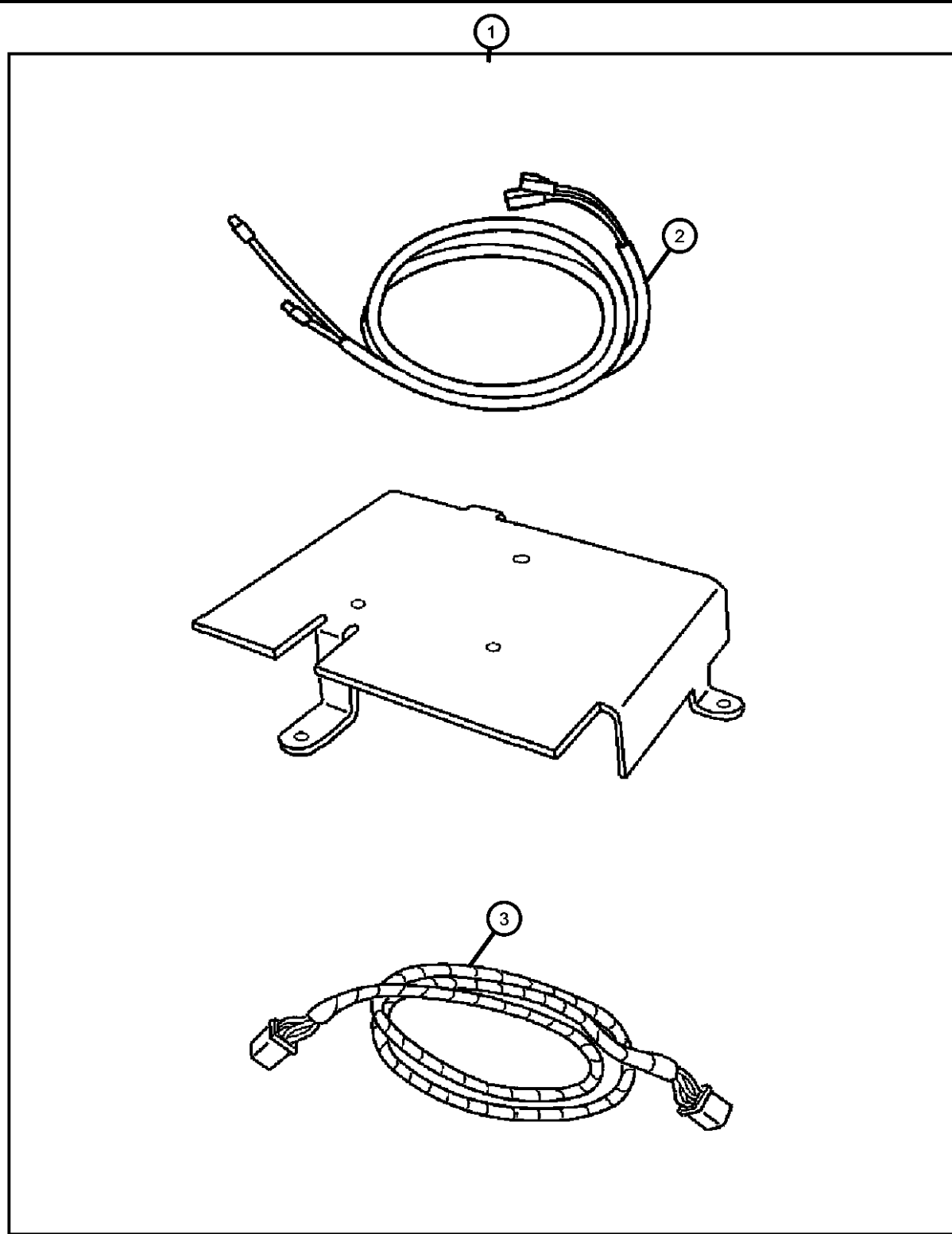

ITEM	PART NUMBER	QTY	LINE	SERIES	BODY	ENGINE	TRANS	TRIM	DESCRIPTION
1	82207925	1			27, 41				INSTALL KIT, Satelite Receiver
2	05066207AA	1			27, 41				CABLE, Antenna
3	05066203AA	1			27, 41				WIRING, Rcvr to Radio

SEBRING, STRATUS, CIRRUS, BREEZE (JR)

SERIES	LINE	BODY	ENGINE	TRANSMISSION
H = HIGHLINE	D = Stratus	27 = Convertible	ECC = Engine - 2.0L 4 Cyl	DD5 = Transmission - 5-Speed Manual
P = PREMIUM	D = R/T (Mexico)	41 = 4 Door	DOHC 16V SMPI	DDR = Transmission - 5-Speed Manual
S = SPORT	C = Sebring		ED2 = Engine - 2.4L 4 Cyl	DGL = Transmission - 4-Spd. Automatic
X = SPECIAL	C = Cirrus (Mexico)		PZEV 16V DOHC	DG0 = All Automatic Transmissions
			EDV = Engine - 2.4L I4 DOHC 16V H.O. Turbo	
			EDZ = Engine - 2.4L 4 Cyl DOHC 16V SMPI	
			EEE = Engine - 2.7L V6 24V FFV	
			EER = Engine - 2.7L V6 DOHC 24 Valve MPI	

AR = use ase required - = Non illustrated part

**Install Kit, Satellite Receiver
Figure 1-140**

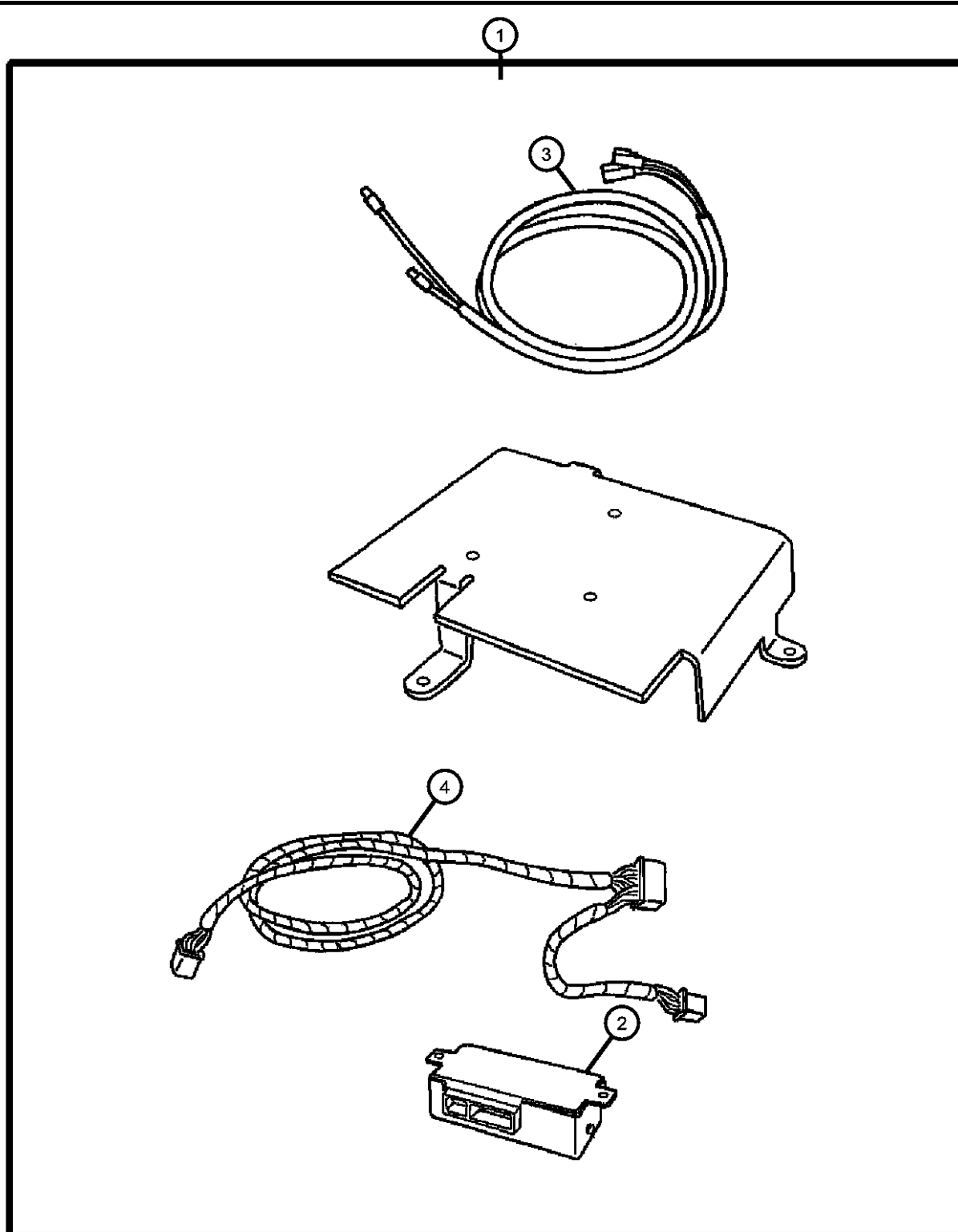

ITEM	PART NUMBER	QTY	LINE	SERIES	BODY	ENGINE	TRANS	TRIM	DESCRIPTION
1	82207779	1			27, 41				INSTALL KIT, Satelite Receiver
2	05059112AC	1			27, 41				MODULE, Radio Control
3	05066207AA	1			27, 41				CABLE, Antenna
4	05086643AA	1			27, 41				WIRING, Rcvr to Radio

SEBRING, STRATUS, CIRRUS, BREEZE (JR)

SERIES	LINE	BODY	ENGINE	TRANSMISSION
H = HIGHLINE	D = Stratus	27 = Convertible	ECC = Engine - 2.0L 4 Cyl	DD5 = Transmission - 5-Speed Manual
P = PREMIUM	D = R/T (Mexico)	41 = 4 Door	DOHC 16V SMPI	DDR = Transmission - 5-Speed Manual
S = SPORT	C = Sebring		ED2 = Engine - 2.4L 4 Cyl	DGL = Transmission - 4-Spd. Automatic
X = SPECIAL	C = Cirrus (Mexico)		PZEV 16V DOHC	DG0 = All Automatic Transmissions
			EDV = Engine - 2.4L I4 DOHC 16V H.O. Turbo	
			EDZ = Engine - 2.4L 4 Cyl DOHC 16V SMPI	
			EEE = Engine - 2.7L V6 24V FFV	
			EER = Engine - 2.7L V6 DOHC 24 Valve MPI	

AR = use ase required - = Non illustrated part

**Navigation Kit
Figure 1-150**

ITEM	PART NUMBER	QTY	LINE	SERIES	BODY	ENGINE	TRANS	TRIM	DESCRIPTION
------	-------------	-----	------	--------	------	--------	-------	------	-------------

Note: For Warranty Repair on Item 2, Order Through [GPOP] Function 11, Using Z Prefix

1	82206406	1							RADIO, AM/FM CD W/NAV/DVD & CD-CTRL
2	56038629AB	1							RADIO, AM/FM CD W/NAV/DVD & CD-CTRL
3	56038630AA	1							ANTENNA, GPS
4	56038642AA	1							DVD, Geographic Database

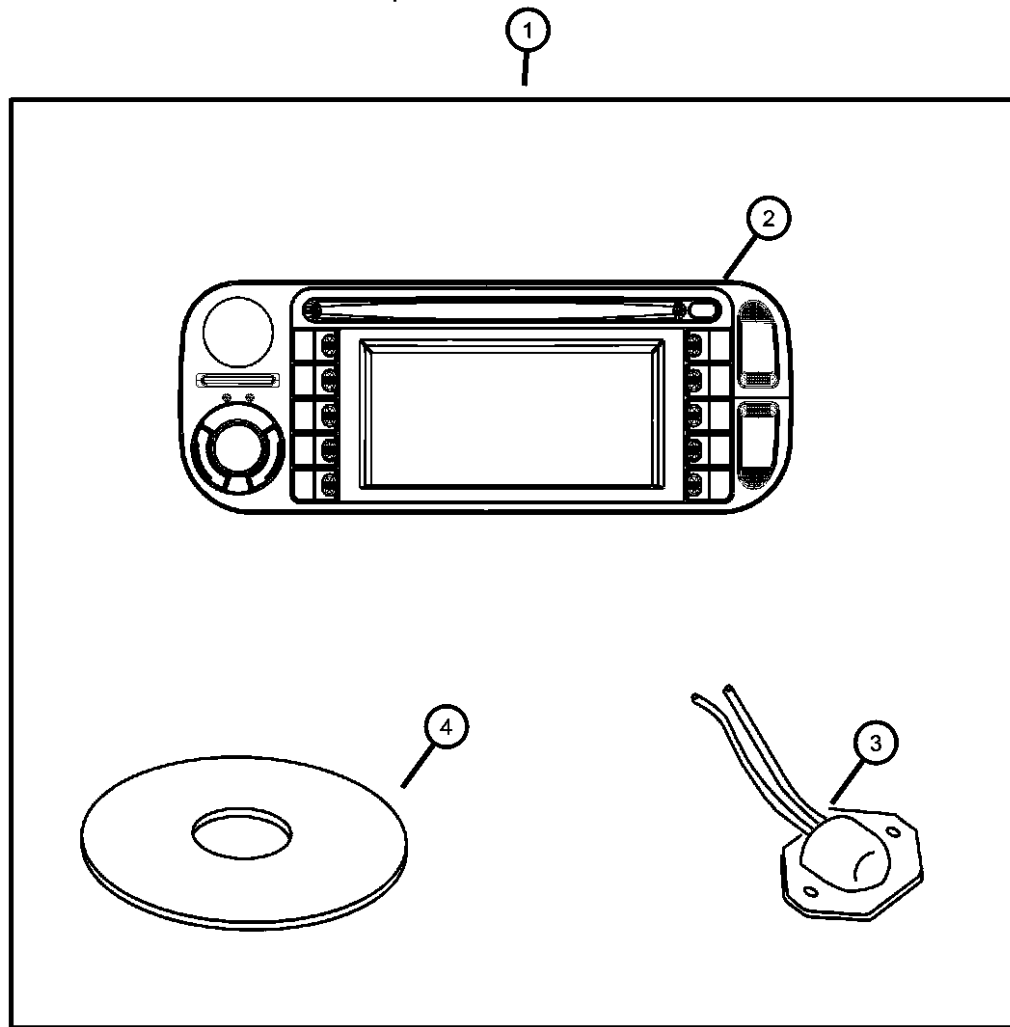

SEBRING, STRATUS, CIRRUS, BREEZE (JR)

SERIES	LINE	BODY	ENGINE	TRANSMISSION
H = HIGHLINE	D = Stratus	27 = Convertible	ECC = Engine - 2.0L 4 Cyl	DD5 = Transmission - 5-Speed Manual
P = PREMIUM	D = R/T (Mexico)	41 = 4 Door	DOHC 16V SMPI	DDR = Transmission - 5-Speed Manual
S = SPORT	C = Sebring		ED2 = Engine - 2.4L 4 Cyl	DGL = Transmission - 4-Spd. Automatic
X = SPECIAL	C = Cirrus (Mexico)		PZEV 16V DOHC	DG0 = All Automatic Transmissions
			EDV = Engine - 2.4L I4 DOHC 16V H.O. Turbo	
			EDZ = Engine - 2.4L 4 Cyl DOHC 16V SMPI	
			EEE = Engine - 2.7L V6 24V	
			FFV	
			EER = Engine - 2.7L V6 DOHC 24 Valve MPI	

AR = use ase required - = Non illustrated part

Bike Carrier - Hitch
Figure 1-210

ITEM	PART NUMBER	QTY	LINE	SERIES	BODY	ENGINE	TRANS	TRIM	DESCRIPTION
------	-------------	-----	------	--------	------	--------	-------	------	-------------

NOTE: Folds down for access to rear hatch, has anti theft bolts.

1	82204452	1							CARRIER KIT, Bike, 2.0 inch Receiver
2	04762880	1							STRAP KIT, Velcro
3	05016775AA	1							STRAP KIT, Bike Carrier Latch
4	05016774AA	1							BOLT KIT, Security
5	05018825AA	1							HARDWARE KIT, Bike Carrier

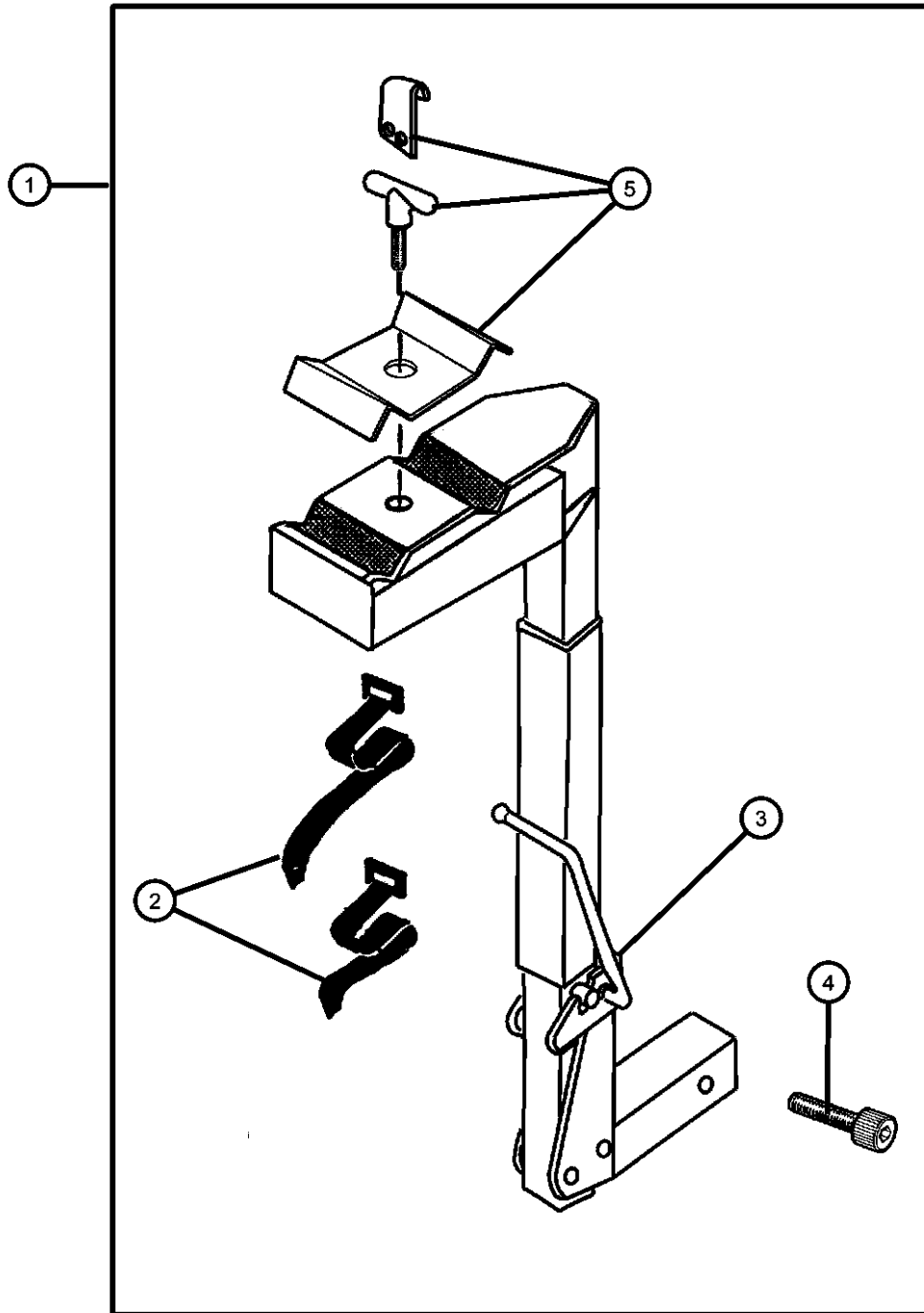

SEBRING, STRATUS, CIRRUS, BREEZE (JR)

SERIES	LINE	BODY	ENGINE	TRANSMISSION
H = HIGHLINE	D = Stratus	27 = Convertible	ECC = Engine - 2.0L 4 Cyl	DD5 = Transmission - 5-Speed Manual
P = PREMIUM	D = R/T (Mexico)	41 = 4 Door	DOHC 16V SMPI	DDR = Transmission - 5-Speed Manual
S = SPORT	C = Sebring		ED2 = Engine - 2.4L 4 Cyl	DGL = Transmission - 4-Spd. Automatic
X = SPECIAL	C = Cirrus (Mexico)		PZEV 16V DOHC	DG0 = All Automatic Transmissions
			EDV = Engine - 2.4L I4 DOHC 16V H.O. Turbo	
			EDZ = Engine - 2.4L 4 Cyl DOHC 16V SMPI	
			EEE = Engine - 2.7L V6 24V FFV	
			EER = Engine - 2.7L V6 DOHC 24 Valve MPI	

AR = use ase required - = Non illustrated part

2004 JR

Bike Carrier - Roof / Fork Mount Style

Figure 1-212

ITEM	PART NUMBER	QTY	LINE	SERIES	BODY	ENGINE	TRANS	TRIM	DESCRIPTION
------	-------------	-----	------	--------	------	--------	-------	------	-------------

NOTE: Hardware Kit also contained in Carrier Kit.

1	82207943	1			41				CARRIER KIT, Bike, Fork - Mount
2	05016389AA	1			27, 41				HARDWARE KIT, Accessory
3	05114532AA	1			41				STRAP, Cargo Tie Down

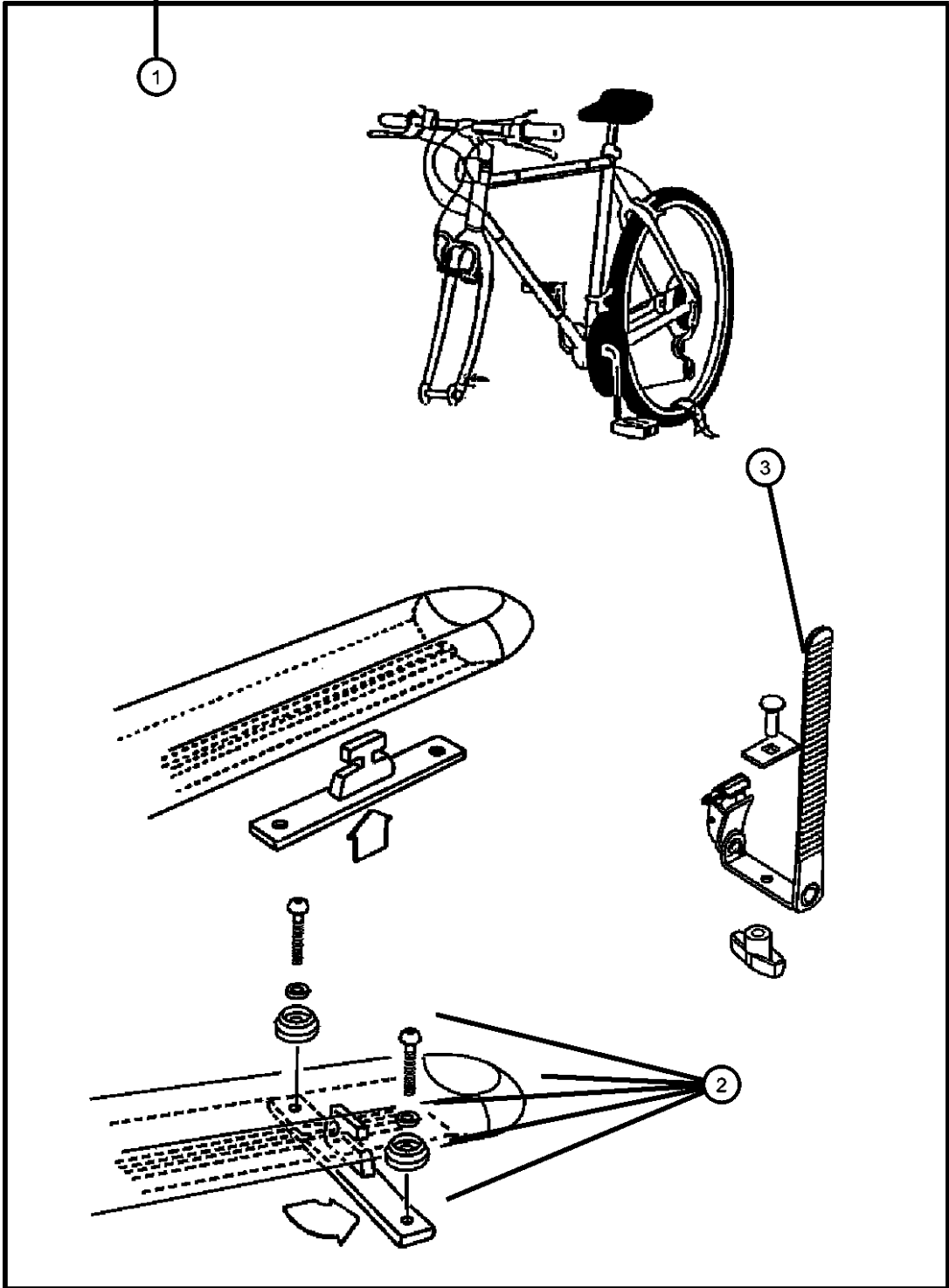

SEBRING, STRATUS, CIRRUS, BREEZE (JR)

SERIES	LINE	BODY	ENGINE	TRANSMISSION
H = HIGHLINE	D = Stratus	27 = Convertible	ECC = Engine - 2.0L 4 Cyl	DD5 = Transmission - 5-Speed Manual
P = PREMIUM	D = R/T (Mexico)	41 = 4 Door	DOHC 16V SMPI	DDR = Transmission - 5-Speed Manual
S = SPORT	C = Sebring		ED2 = Engine - 2.4L 4 Cyl	DGL = Transmission - 4-Spd.
X = SPECIAL	C = Cirrus (Mexico)		PZEV 16V DOHC	EDV = Engine - 2.4L I4 DOHC Automatic
			EDV = Engine - 2.4L I4 DOHC 16V H.O. Turbo	DG0 = All Automatic Transmissions
			EDZ = Engine - 2.4L 4 Cyl DOHC 16V SMPI	
			EEE = Engine - 2.7L V6 24V	
			FFV	
			EER = Engine - 2.7L V6 DOHC 24 Valve MPI	

AR = use ase required - = Non illustrated part

**Bike Carrier - Roof / Upright Mount Style
Figure 1-214**

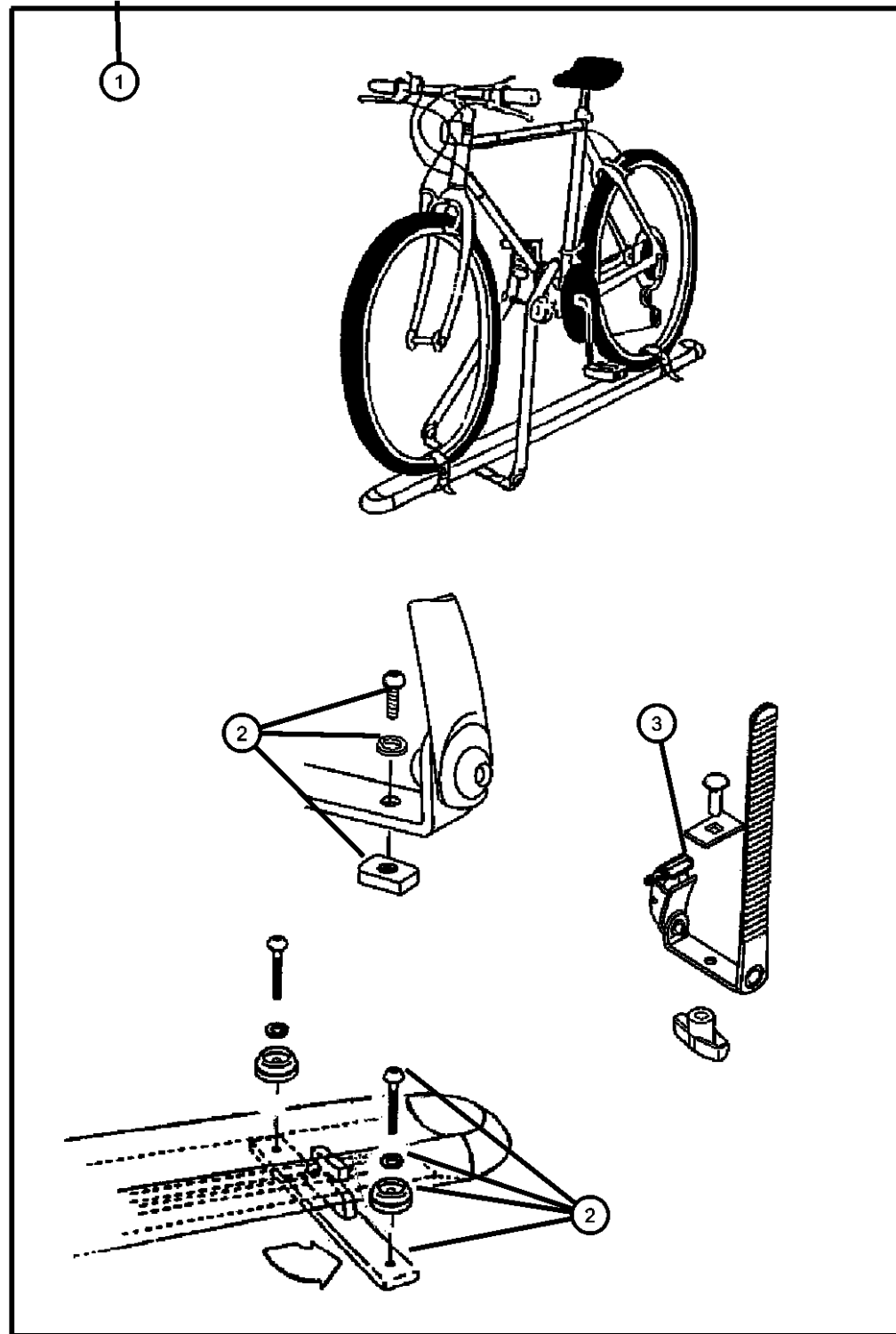

ITEM	PART NUMBER	QTY	LINE	SERIES	BODY	ENGINE	TRANS	TRIM	DESCRIPTION
1	82207942	1			41				CARRIER KIT, Bike, Upright - Mount
2	05093779AA	1			41				HARDWARE KIT, Accessory
3	05114532AA	1			41				STRAP, Cargo Tie Down

SEBRING, STRATUS, CIRRUS, BREEZE (JR)

SERIES	LINE	BODY	ENGINE	TRANSMISSION
H = HIGHLINE	D = Stratus	27 = Convertible	ECC = Engine - 2.0L 4 Cyl	DD5 = Transmission - 5-Speed Manual
P = PREMIUM	D = R/T (Mexico)	41 = 4 Door	DOHC 16V SMPI	DDR = Transmission - 5-Speed Manual
S = SPORT	C = Sebring		ED2 = Engine - 2.4L 4 Cyl	DGL = Transmission - 4-Spd. Automatic
X = SPECIAL	C = Cirrus (Mexico)		PZEV 16V DOHC	DG0 = All Automatic Transmissions
			EDV = Engine - 2.4L I4 DOHC 16V H.O. Turbo	
			EDZ = Engine - 2.4L 4 Cyl DOHC 16V SMPI	
			EEE = Engine - 2.7L V6 24V FFV	
			EER = Engine - 2.7L V6 DOHC 24 Valve MPI	

AR = use ase required - = Non illustrated part

Carrier Kit - Watersports
Figure 1-218

ITEM	PART NUMBER	QTY	LINE	SERIES	BODY	ENGINE	TRANS	TRIM	DESCRIPTION
1	82205416	1			27, 41				CARRIER KIT, Water Sports
2	05016389AA	1			27, 41				HARDWARE KIT, Accessory
3	05016511AA	1			27, 41				STRAP, Cargo Tie Down

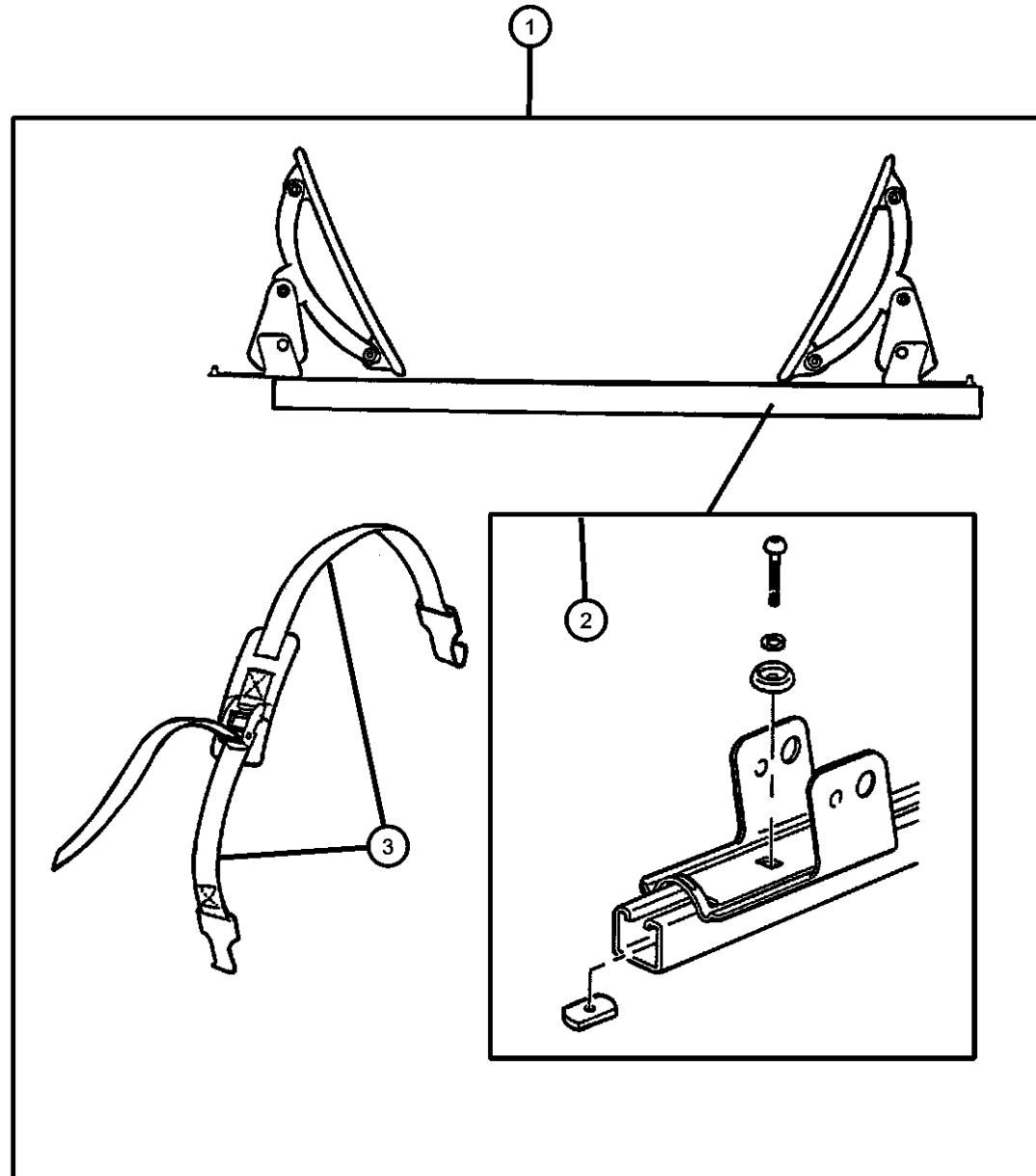

SEBRING, STRATUS, CIRRUS, BREEZE (JR)

SERIES	LINE
H = HIGHLINE	D = Stratus
P = PREMIUM	D = R/T (Mexico)
S = SPORT	C = Sebring
X = SPECIAL	C = Cirrus (Mexico)

BODY
27 = Convertible
41 = 4 Door

ENGINE
ECC = Engine - 2.0L 4 Cyl
DOHC 16V SMPI
ED2 = Engine - 2.4L 4 Cyl
PZEV 16V DOHC
EDV = Engine - 2.4L I4 DOHC
16V H.O. Turbo
EDZ = Engine - 2.4L 4 Cyl
DOHC 16V SMPI
EEE = Engine - 2.7L V6 24V
FFV
EER = Engine - 2.7L V6 DOHC
24 Valve MPI

TRANSMISSION
DD5 = Transmission - 5-Speed Manual
DDR = Transmission - 5-Speed Manual
DGL = Transmission - 4-Spd. Automatic
DG0 = All Automatic Transmissions

AR = use ase required - = Non illustrated part

2004 JR

Carrier Kit - Luggage
Figure 1-220

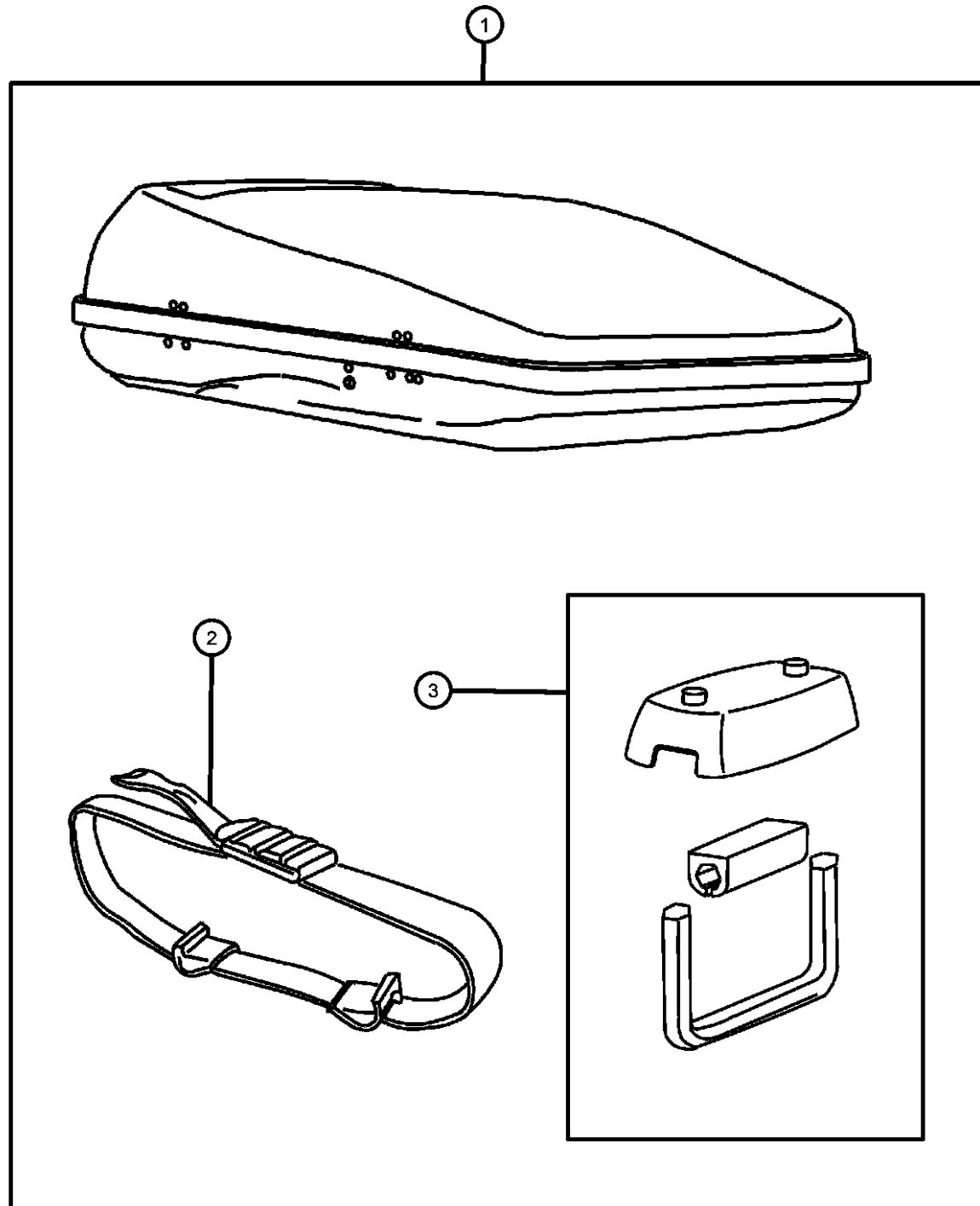

ITEM	PART NUMBER	QTY	LINE	SERIES	BODY	ENGINE	TRANS	TRIM	DESCRIPTION
1									CARRIER KIT, Luggage
	82207341	1			41				Long - 480 Liter Capacity
	82207353	1			41				Short -440 Liter Capacity
2	05086160AA	1			41				STRAP, Cargo Tie Down
3	05086159AA	1			41				HARDWARE KIT

SEBRING, STRATUS, CIRRUS, BREEZE (JR)

SERIES LINE
H = HIGHLINE D = Stratus
P = PREMIUM D = R/T (Mexico)
S = SPORT C = Sebring
X = SPECIAL C = Cirrus (Mexico)

BODY
27 = Convertible
41 = 4 Door

ENGINE
ECC = Engine - 2.0L 4 Cyl
DOHC 16V SMPI
ED2 = Engine - 2.4L 4 Cyl
PZEV 16V DOHC
EDV = Engine - 2.4L I4 DOHC
16V H.O. Turbo
EDZ = Engine - 2.4L 4 Cyl
DOHC 16V SMPI
EEE = Engine - 2.7L V6 24V
FFV
EER = Engine - 2.7L V6 DOHC
24 Valve MPI

TRANSMISSION
DD5 = Transmission - 5-Speed Manual
DDR = Transmission - 5-Speed
Manual
DGL = Transmission - 4-Spd.
Automatic
DG0 = All Automatic Transmissions

AR = use ase required - = Non illustrated part

Ski Carrier - Roof
Figure 1-222

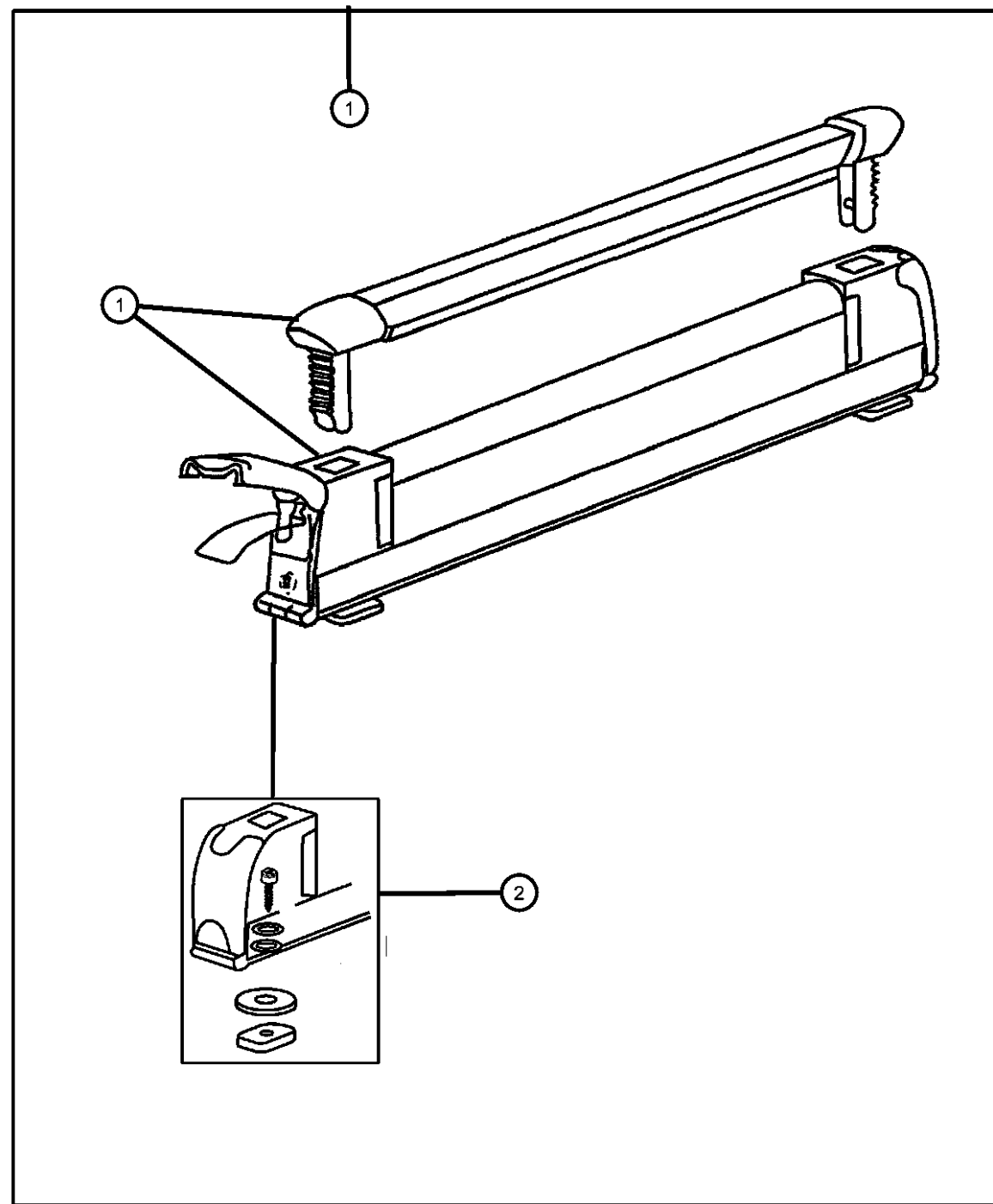

ITEM	PART NUMBER	QTY	LINE	SERIES	BODY	ENGINE	TRANS	TRIM	DESCRIPTION
1									CARRIER KIT, Ski
	82207308	1			41				6 Pair
	82207312	1			41				3 Pair
2	05086158AA	1			41				HARDWARE KIT, Accessory
-3	05066632AA	1			41				TOOL, Screw Driver

SEBRING, STRATUS, CIRRUS, BREEZE (JR)

SERIES	LINE	BODY	ENGINE	TRANSMISSION
H = HIGHLINE	D = Stratus	27 = Convertible	ECC = Engine - 2.0L 4 Cyl	DD5 = Transmission - 5-Speed Manual
P = PREMIUM	D = R/T (Mexico)	41 = 4 Door	DOHC 16V SMPI	DDR = Transmission - 5-Speed Manual
S = SPORT	C = Sebring		ED2 = Engine - 2.4L 4 Cyl	DGL = Transmission - 4-Spd. Automatic
X = SPECIAL	C = Cirrus (Mexico)		PZEV 16V DOHC	DG0 = All Automatic Transmissions
			EDV = Engine - 2.4L I4 DOHC 16V H.O. Turbo	
			EDZ = Engine - 2.4L 4 Cyl DOHC 16V SMPI	
			EEE = Engine - 2.7L V6 24V FFV	
			EER = Engine - 2.7L V6 DOHC 24 Valve MPI	

AR = use ase required - = Non illustrated part

Wheel Kit
Figure 1-410

ITEM	PART NUMBER	QTY	LINE	SERIES	BODY	ENGINE	TRANS	TRIM	DESCRIPTION
1	82206782	1							WHEEL KIT, Cast Aluminum, 16x6 Polish
	82206783	1							Chromed
2	05093239AA	1							CAP, Wheel Center
-3	06502738	20							NUT, Wheel Chrome, M12x1.5

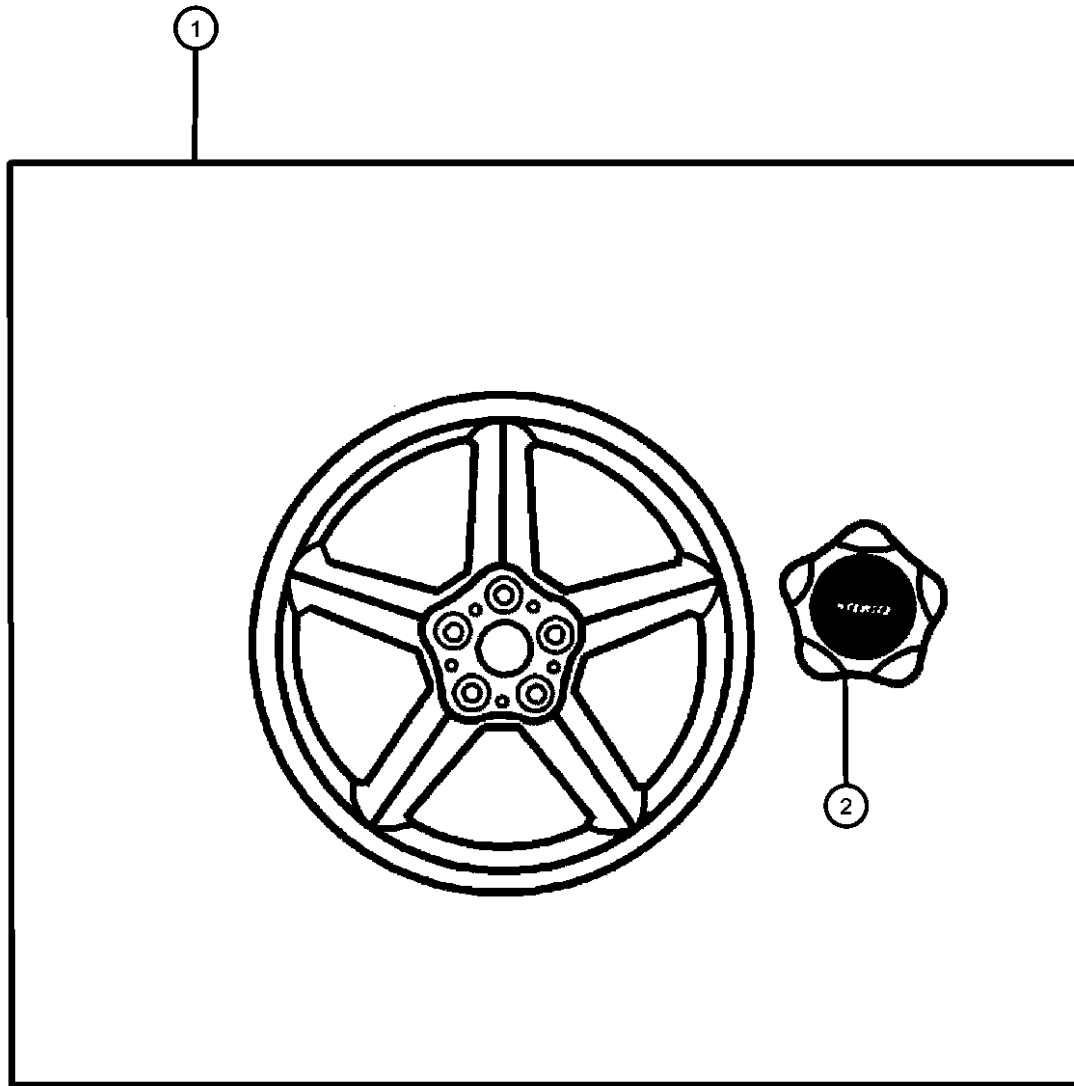

SEBRING, STRATUS, CIRRUS, BREEZE (JR)

SERIES	LINE
H = HIGHLINE	D = Stratus
P = PREMIUM	D = R/T (Mexico)
S = SPORT	C = Sebring
X = SPECIAL	C = Cirrus (Mexico)

BODY
27 = Convertible
41 = 4 Door

ENGINE
ECC = Engine - 2.0L 4 Cyl
DOHC 16V SMPI
ED2 = Engine - 2.4L 4 Cyl
PZEV 16V DOHC
EDV = Engine - 2.4L I4 DOHC
16V H.O. Turbo
EDZ = Engine - 2.4L 4 Cyl
DOHC 16V SMPI
EEE = Engine - 2.7L V6 24V
FFV
EER = Engine - 2.7L V6 DOHC
24 Valve MPI

TRANSMISSION
DD5 = Transmission - 5-Speed Manual
DDR = Transmission - 5-Speed Manual
DGL = Transmission - 4-Spd. Automatic
DG0 = All Automatic Transmissions

AR = use ase required - = Non illustrated part

2004 JR

Screen Kit - Wind
Figure 1-510

ITEM	PART NUMBER	QTY	LINE	SERIES	BODY	ENGINE	TRANS	TRIM	DESCRIPTION
------	-------------	-----	------	--------	------	--------	-------	------	-------------

NOTE: Hardware Kit contains 4 Nuts, 4 Screws, 1 Plastic Bracket and 1 Plastic Spacer
Fastner Kit contains 2 Hooks

1	82206412	1	C		27				SCREEN KIT, Wind
2	05086007AA	1	C		27				HOOK, FASTNER
3	05086006AA	1	C		27				HARDWARE KIT

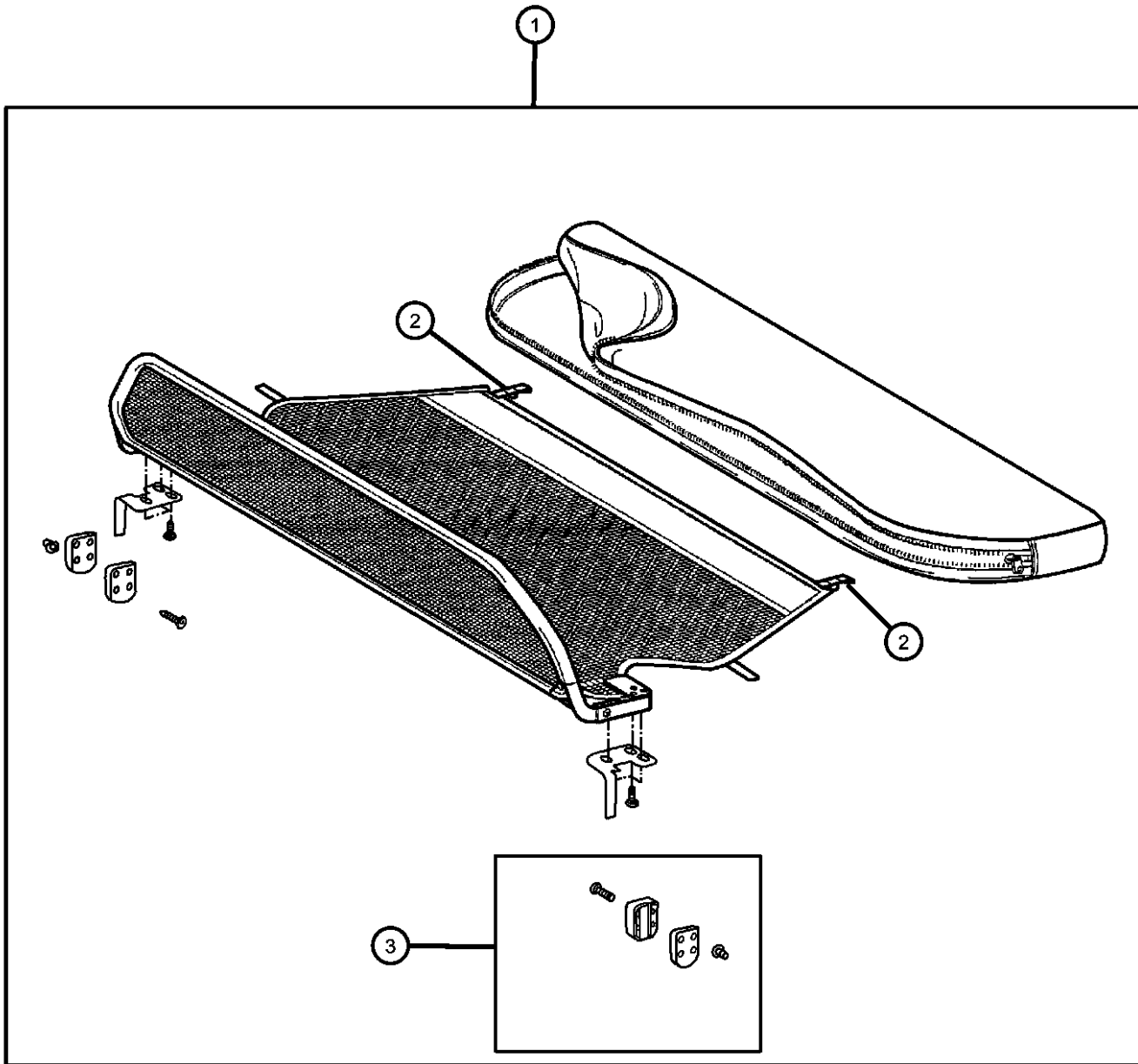

SEBRING, STRATUS, CIRRUS, BREEZE (JR)

SERIES	LINE	BODY	ENGINE	TRANSMISSION
H = HIGHLINE	D = Stratus	27 = Convertible	ECC = Engine - 2.0L 4 Cyl	DD5 = Transmission - 5-Speed Manual
P = PREMIUM	D = R/T (Mexico)	41 = 4 Door	DOHC 16V SMPI	DDR = Transmission - 5-Speed Manual
S = SPORT	C = Sebring		ED2 = Engine - 2.4L 4 Cyl	DGL = Transmission - 4-Spd. Automatic
X = SPECIAL	C = Cirrus (Mexico)		PZEV 16V DOHC	DG0 = All Automatic Transmissions
			EDV = Engine - 2.4L I4 DOHC 16V H.O. Turbo	
			EDZ = Engine - 2.4L 4 Cyl DOHC 16V SMPI	
			EEE = Engine - 2.7L V6 24V FFV	
			EER = Engine - 2.7L V6 DOHC 24 Valve MPI	

AR = use ase required - = Non illustrated part

2004 JR

Heater Kit - Engine and Battery
Figure 1-610

ITEM	PART NUMBER	QTY	LINE	SERIES	BODY	ENGINE	TRANS	TRIM	DESCRIPTION
------	-------------	-----	------	--------	------	--------	-------	------	-------------

NOTES: Sales Codes
 EDZ = 2.4L 4 Cylinder 16V SMPI
 EER = 2.7L V6 DOHC 24V MPI
 E

1	82206642	1			27, 41				HEATER KIT, Engine and Battery
2	04609111AA	1							HEATER, Battery
3	05033157AB	1							HEATER, Engine Block, 2.4L Engine
4	04609113AA	1							CORD, Engine Block Heater

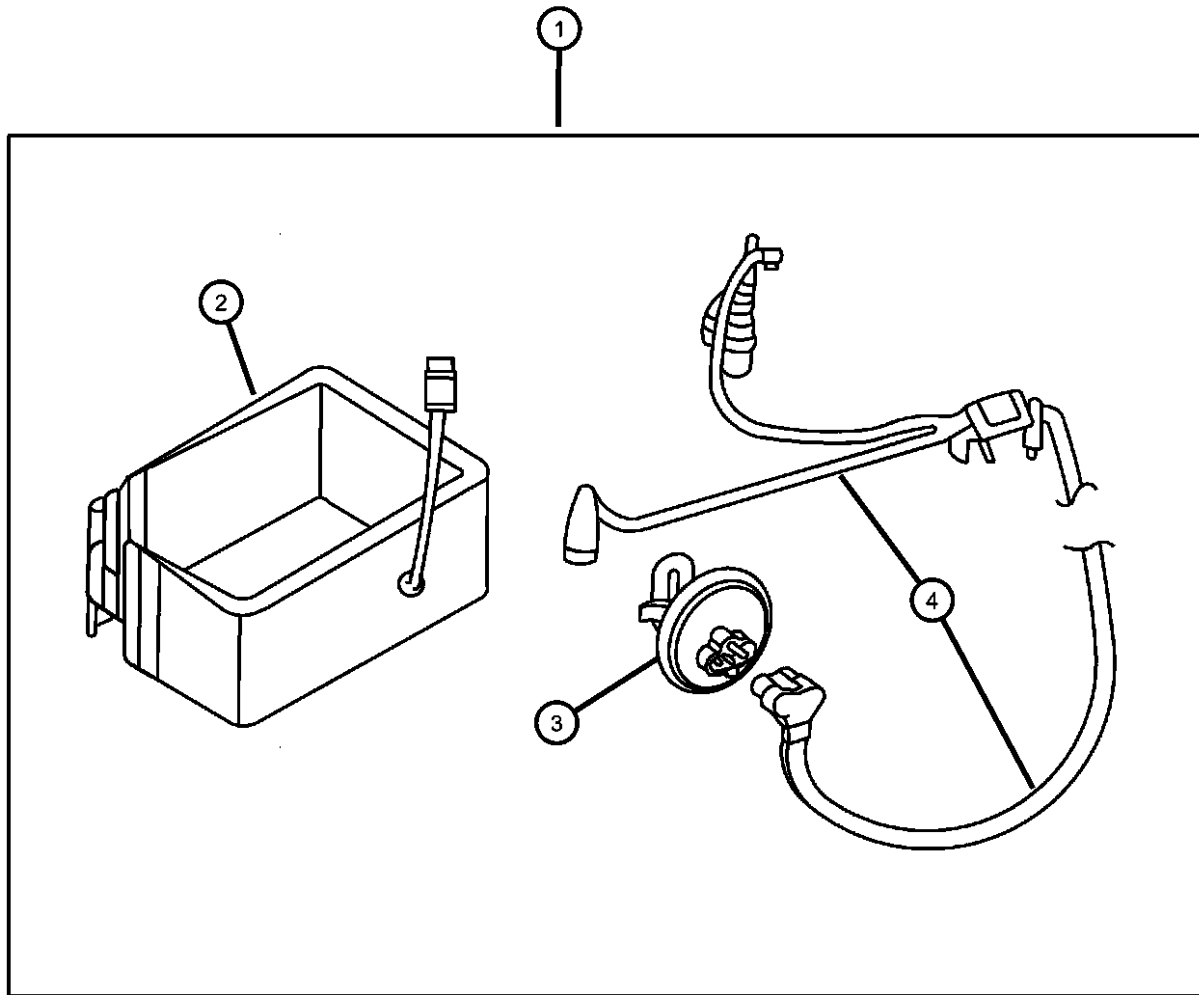

SEBRING, STRATUS, CIRRUS, BREEZE (JR)

SERIES	LINE	BODY	ENGINE	TRANSMISSION
H = HIGHLINE	D = Stratus	27 = Convertible	ECC = Engine - 2.0L 4 Cyl	DD5 = Transmission - 5-Speed Manual
P = PREMIUM	D = R/T (Mexico)	41 = 4 Door	DOHC 16V SMPI	DDR = Transmission - 5-Speed Manual
S = SPORT	C = Sebring		ED2 = Engine - 2.4L 4 Cyl	DGL = Transmission - 4-Spd. Automatic
X = SPECIAL	C = Cirrus (Mexico)		PZEV 16V DOHC	DG0 = All Automatic Transmissions
			EDV = Engine - 2.4L I4 DOHC 16V H.O. Turbo	
			EDZ = Engine - 2.4L 4 Cyl DOHC 16V SMPI	
			EEE = Engine - 2.7L V6 24V FFV	
			EER = Engine - 2.7L V6 DOHC 24 Valve MPI	

AR = use ase required - = Non illustrated part

2004 JR

Alarm EVS II
Figure 1-910

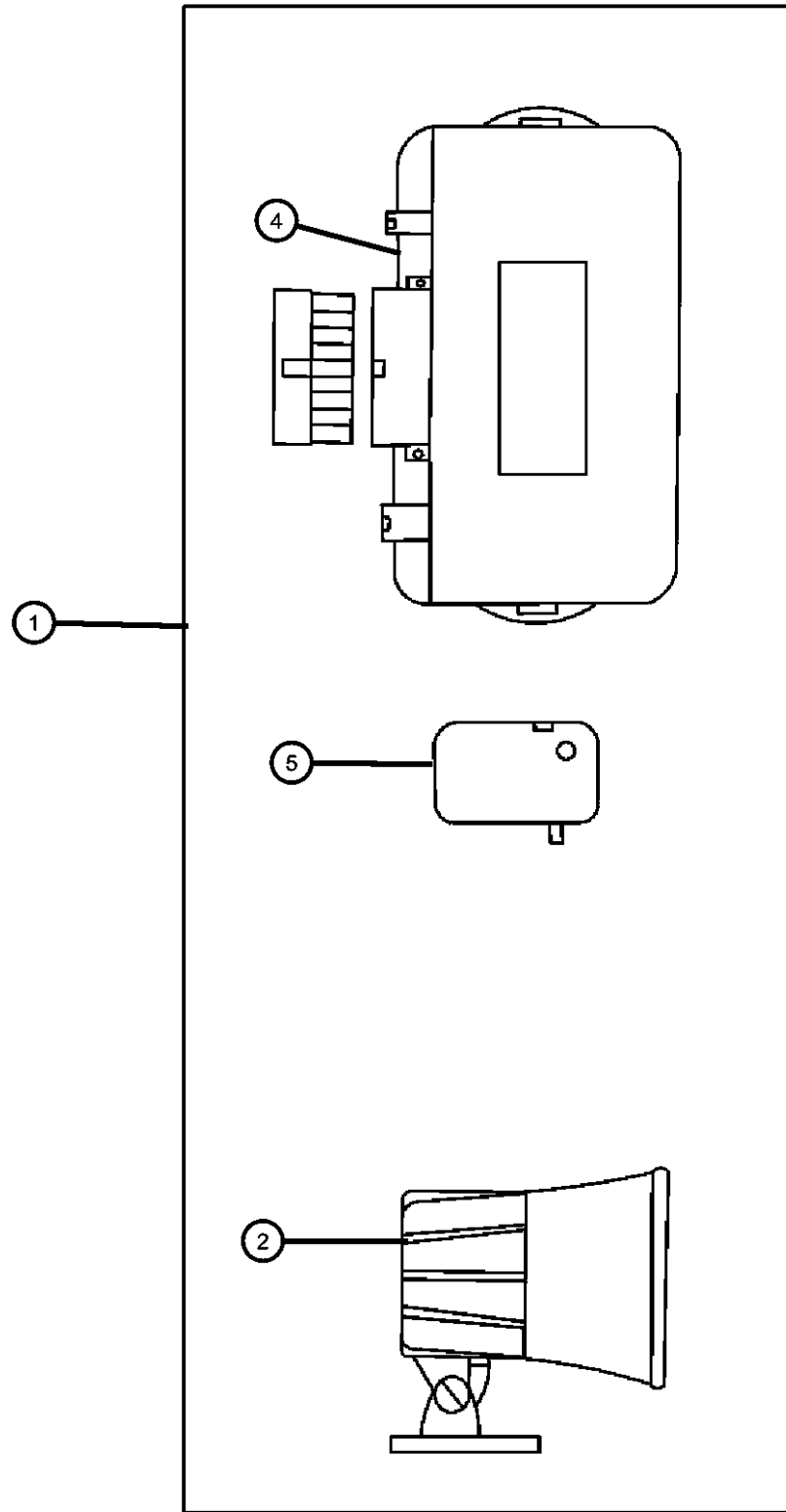

ITEM	PART NUMBER	QTY	LINE	SERIES	BODY	ENGINE	TRANS	TRIM	DESCRIPTION
1	82204268	1							MODULE, Security Alarm
2	82203198	1							SIREN, Alarm
-3	04886259AA	1							INDICATOR, Valet Status
4	05011619AA	1							MODULE, Security Alarm
5	04886260AB	1							SENSOR, Shock, With Terminals
-6	82206773	1							WIRING KIT, Alarm Security Plus

SEBRING, STRATUS, CIRRUS, BREEZE (JR)

SERIES	LINE
H = HIGHLINE	D = Stratus
P = PREMIUM	D = R/T (Mexico)
S = SPORT	C = Sebring
X = SPECIAL	C = Cirrus (Mexico)

BODY
27 = Convertible
41 = 4 Door

ENGINE
ECC = Engine - 2.0L 4 Cyl
DOHC 16V SMPI
ED2 = Engine - 2.4L 4 Cyl
PZEV 16V DOHC
EDV = Engine - 2.4L I4 DOHC
16V H.O. Turbo
EDZ = Engine - 2.4L 4 Cyl
DOHC 16V SMPI
EEE = Engine - 2.7L V6 24V
FFV
EER = Engine - 2.7L V6 DOHC
24 Valve MPI

TRANSMISSION
DD5 = Transmission - 5-Speed Manual
DDR = Transmission - 5-Speed Manual
DGL = Transmission - 4-Spd. Automatic
DG0 = All Automatic Transmissions

AR = use ase required - = Non illustrated part

Factory Keyless Entry
Figure 1-914

ITEM	PART NUMBER	QTY	LINE	SERIES	BODY	ENGINE	TRANS	TRIM	DESCRIPTION
1	82207513	1							MODULE PACKAGE, Keyless Entry
2	04602260AA	2							TRANSMITTER, Keyless Entry
3	56045755AB	1							RECEIVER, Keyless Entry

1



3

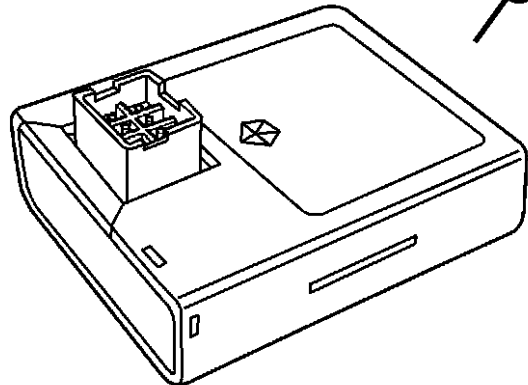

2

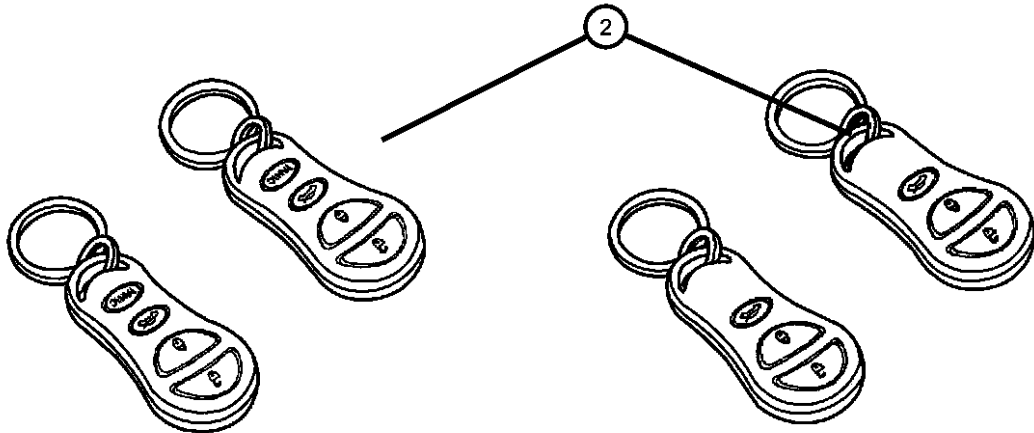

SEBRING, STRATUS, CIRRUS, BREEZE (JR)

SERIES	LINE	BODY	ENGINE	TRANSMISSION
H = HIGHLINE	D = Stratus	27 = Convertible	ECC = Engine - 2.0L 4 Cyl	DD5 = Transmission - 5-Speed Manual
P = PREMIUM	D = R/T (Mexico)	41 = 4 Door	DOHC 16V SMPI	DDR = Transmission - 5-Speed Manual
S = SPORT	C = Sebring		ED2 = Engine - 2.4L 4 Cyl	DGL = Transmission - 4-Spd. Automatic
X = SPECIAL	C = Cirrus (Mexico)		PZEV 16V DOHC	DG0 = All Automatic Transmissions
			EDV = Engine - 2.4L I4 DOHC 16V H.O. Turbo	
			EDZ = Engine - 2.4L 4 Cyl DOHC 16V SMPI	
			EEE = Engine - 2.7L V6 24V FFV	
			EER = Engine - 2.7L V6 DOHC 24 Valve MPI	

AR = use ase required - = Non illustrated part

2004 JR

Group - 2

Front Suspension & Drive

Group - 2 Front Suspension & Drive

Illustration Title

Group-Fig. No.



Front Suspension

Suspension, Front..... Fig. 2 - 120

Front Axle Drive Shafts

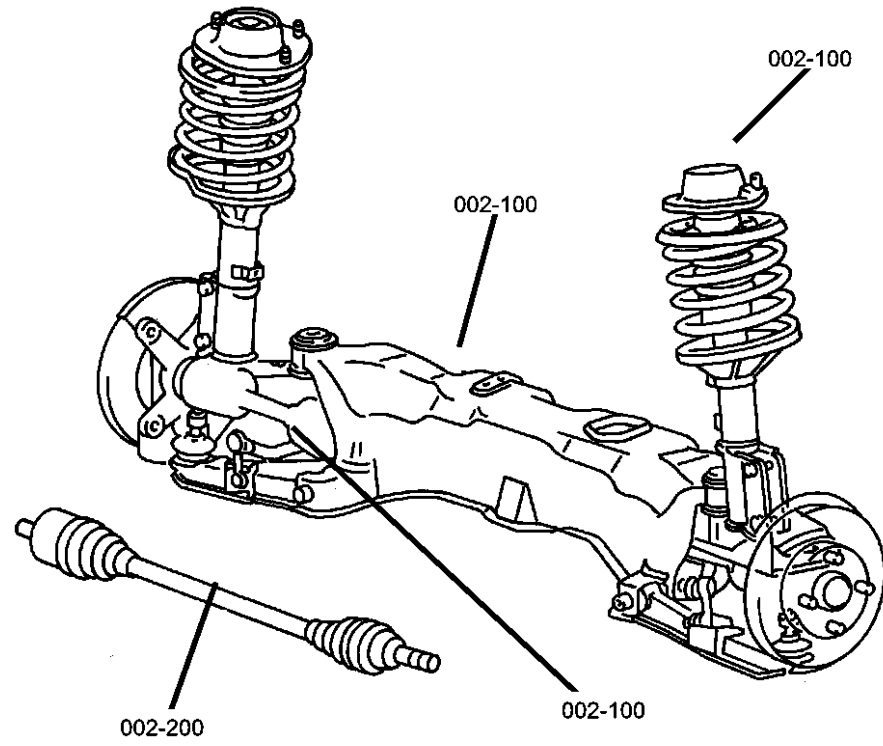
Shaft, Front Drive Fig. 2 - 220

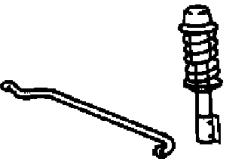

<p>002-100 Front Suspension</p> 	<p>002-200 Front Axle Drive Shafts</p> 		
--	---	--	--

Suspension, Front
Figure 2-120

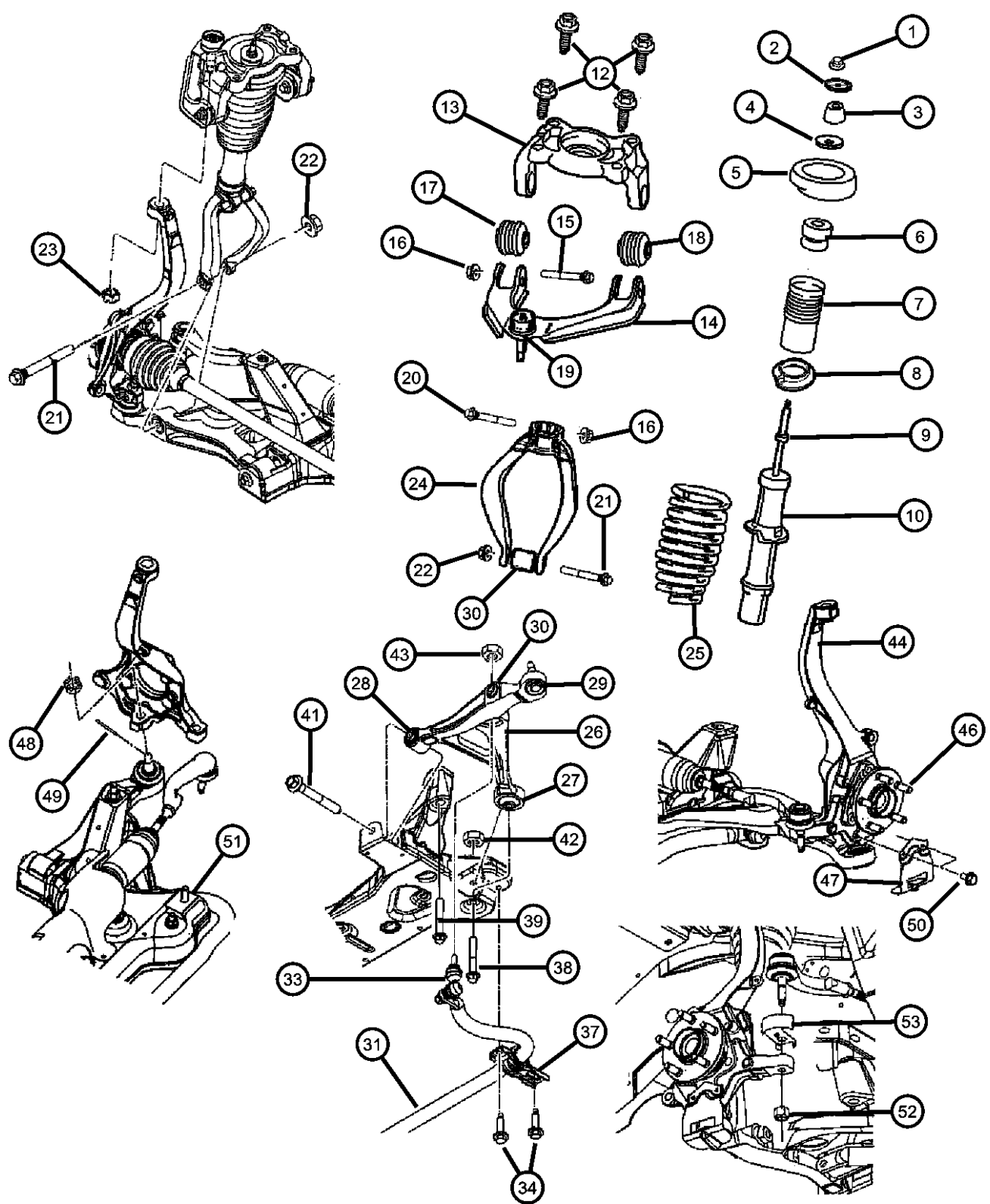

ITEM	PART NUMBER	QTY	LINE	SERIES	BODY	ENGINE	TRANS	TRIM	DESCRIPTION
------	-------------	-----	------	--------	------	--------	-------	------	-------------

NOTE: Sales Codes
 [ECC] = 2.0L 4 Cyl DOHC 16V SMPI Engine
 [EDV] = 2.4L 4 Cyl DOHC 16V Turbo Engine
 [EDZ] = 2.4L 4 Cyl DOHC 16V SMPI Engine
 [EEO] = 2.7L V6 24V FFV
 [SDA] = SUSPENSION - NORMAL DUTY
 [SDC] = SUSPENSION - TOURING
 [SDD] = SUSPENSION - PERFORMANCE
 [SDE] = SUSPENSION - SPORT
 [ZCF Through ZTF] = Spring Group Type's Found on Individual Vehical Sales Code List

1	06503644	2							NUT, Hex Flange Lock, M14x1.50 Shock Absorber Rod RETAINER, Shock Absorber
2	04616934	2							BUSHING, Shock Absorber
3	04764483AA	4							RETAINER, Shock Absorber
4	04695030	2							ISOLATOR, Spring Upper
5	04764505AA	2							BUMPER, Jounce
6	04616931	2							SHIELD, Shock Absorber Dust
7	04695728AB	2							ISOLATOR, Spring Seat Lower
8	04616982AB	2							COLLAR, Shock Absorber Rod
9									
	04695769	1	C		27	EE0			
		1	C		27	ED2, EDZ			
		1	C		27	ECC			
		1			41				
10									SHOCK ABSORBER, Suspension
	04879422AA	2			41	EE0			[SDD]
	0SG81565								Mopar V-Line Alternative Part
	04895028AA	2			41	ECC			[SDE]
	0SG81565								Mopar V-Line Alternative Part
	04895029AA	2			41	ED2, EDZ, EE0			[SDA] [SDC]
	0SG81565								Mopar V-Line Alternative Part
	04895037AA	2			41	EE0			[SDE]
	0SG81565								Mopar V-Line Alternative Part

SEBRING, STRATUS, CIRRU, BREEZE (JR)

SERIES	LINE	BODY	ENGINE	TRANSMISSION
H = HIGHLINE	D = Stratus	27 = Convertible	ECC = Engine - 2.0L 4 Cyl DOHC 16V SMPI	DD5 = Transmission - 5-Speed Manual
P = PREMIUM	D = R/T (Mexico)	41 = 4 Door	ED2 = Engine - 2.4L 4 Cyl PZEV 16V DOHC	DDR = Transmission - 5-Speed Manual
S = SPORT	C = Sebring		EDV = Engine - 2.4L I4 DOHC 16V H.O. Turbo	DGL = Transmission - 4-Spd. Automatic
X = SPECIAL	C = Cirrus (Mexico)		EDZ = Engine - 2.4L 4 Cyl DOHC 16V SMPI	DG0 = All Automatic Transmissions
			EEE = Engine - 2.7L V6 24V FFV	
			EER = Engine - 2.7L V6 DOHC 24 Valve MPI	

AR = use ase required - = Non illustrated part