

11. Remove the snap ring (1) from the terminal body (2) and press the terminal body into the transaxle case.

**CAUTION:** Be careful not to cause damage to the terminal body.

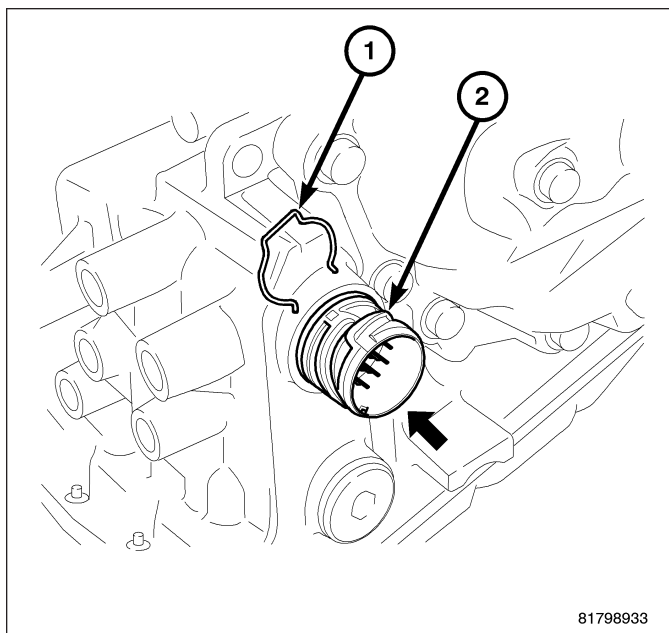

81798933

12. Remove CVT fluid cooler (1) from transaxle case. Remove and discard the CVT fluid cooler o-ring.

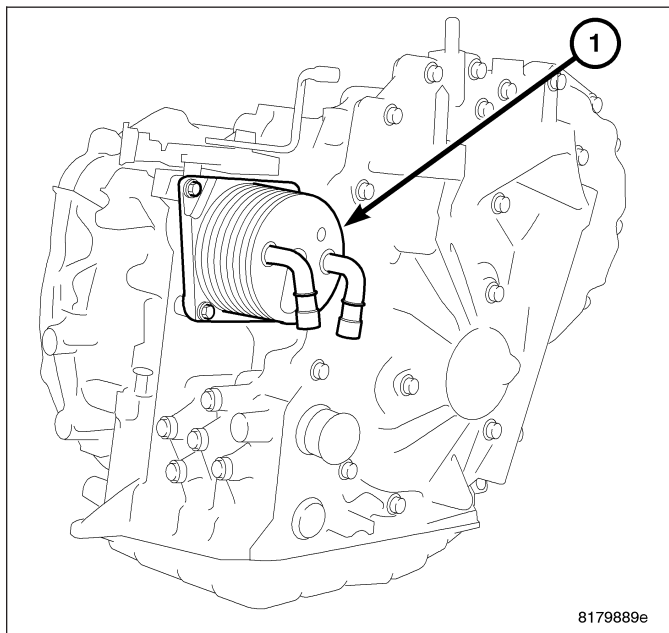

8179889e

- 13. Remove the bolts holding the CVT fluid filter to the transaxle case.
- 14. Remove the CVT fluid filter (1) from the transaxle case.

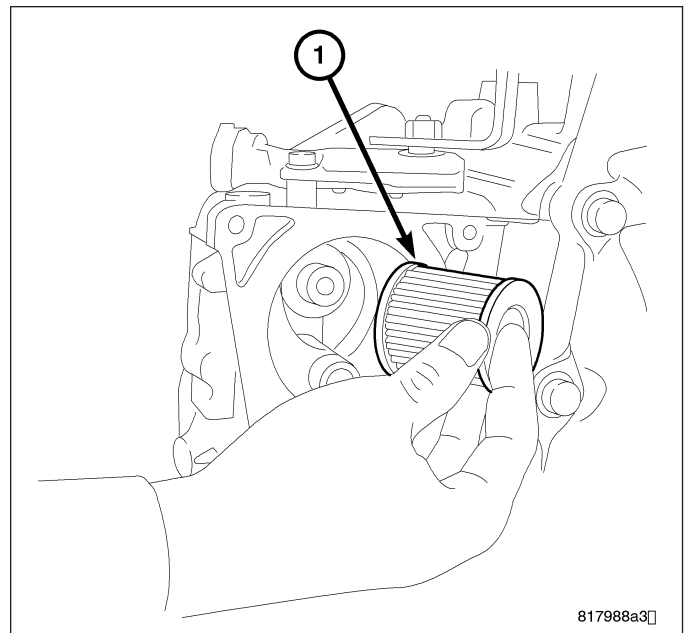

- 15. Remove the converter housing mounting bolts.

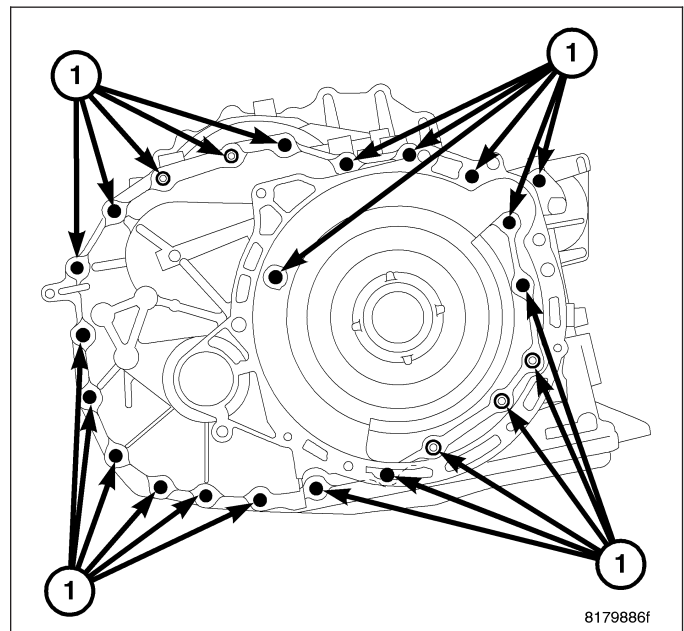

16. Remove the converter housing (1) by tapping with plastic hammer.

**CAUTION:** There is a possibility that the drive sprocket adjusting shim may be dislodged and fall out.

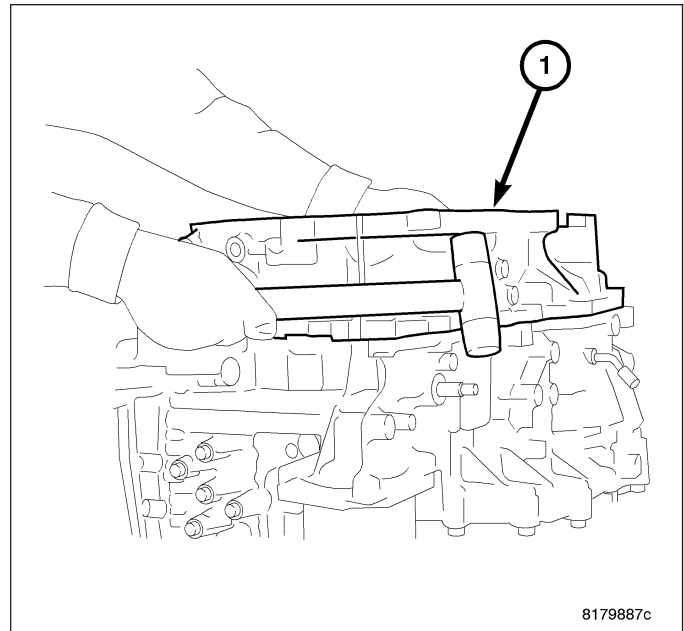

17. Remove outer race of reduction gear bearing (1) from the converter housing using Puller 7794-A and Slide Hammer C-637.

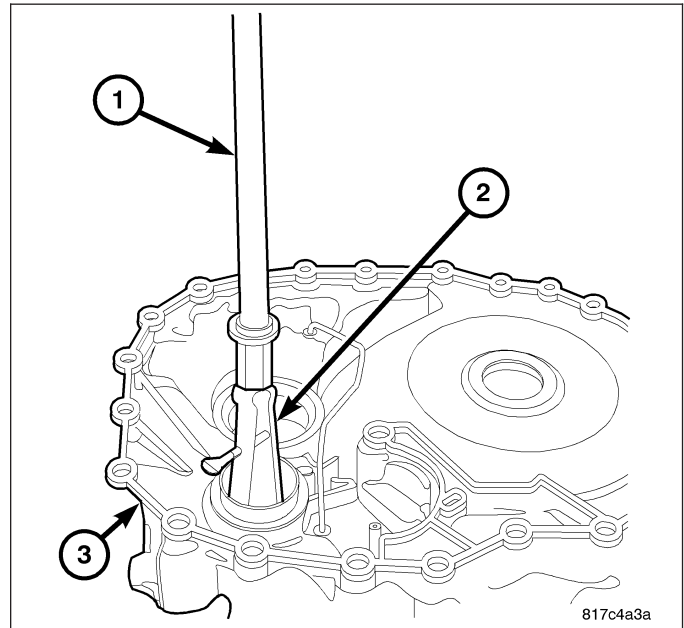

18. Remove differential side oil seal (1) from converter housing using a screwdriver. (2WD)

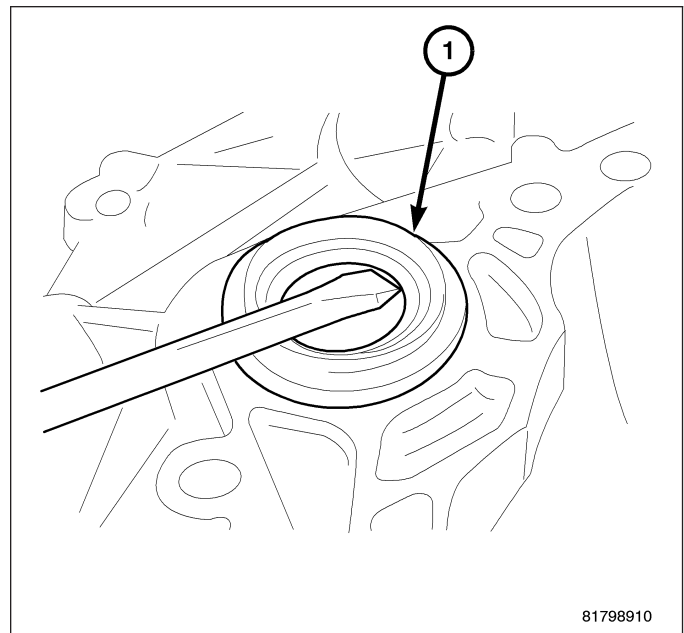

19. Remove converter housing oil seal (1) from converter housing using a screwdriver.

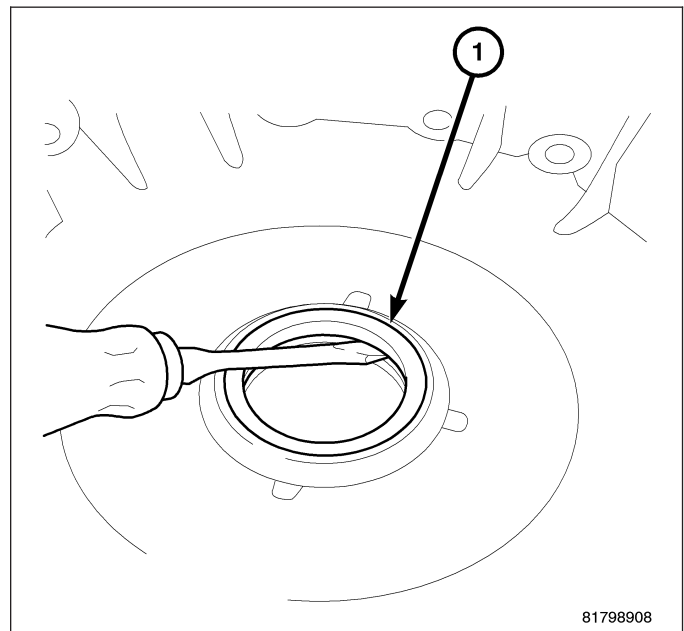

20. Remove outer race (1) of differential side bearing from converter housing using a suitable punch.

**CAUTION:** When removing the outer race, tap the outer race on both sides evenly. When removing the outer race, do not damage the converter housing.

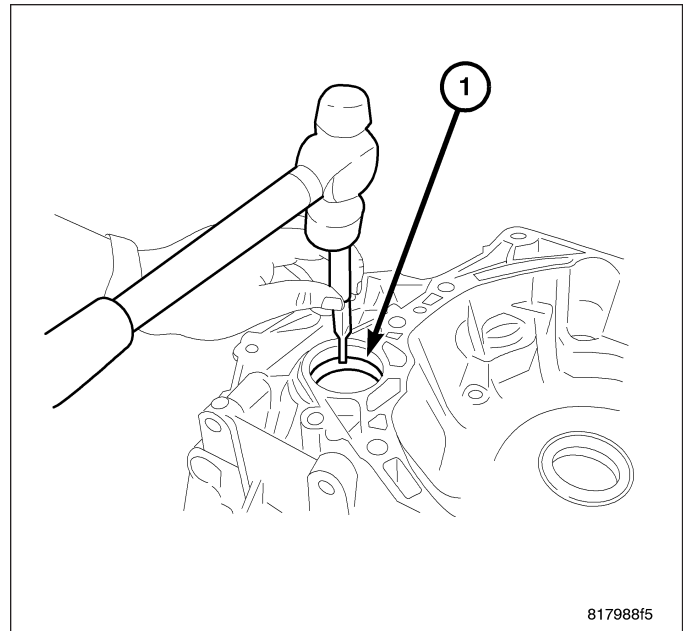

21. Remove and discard the O-ring (1) from the input shaft.

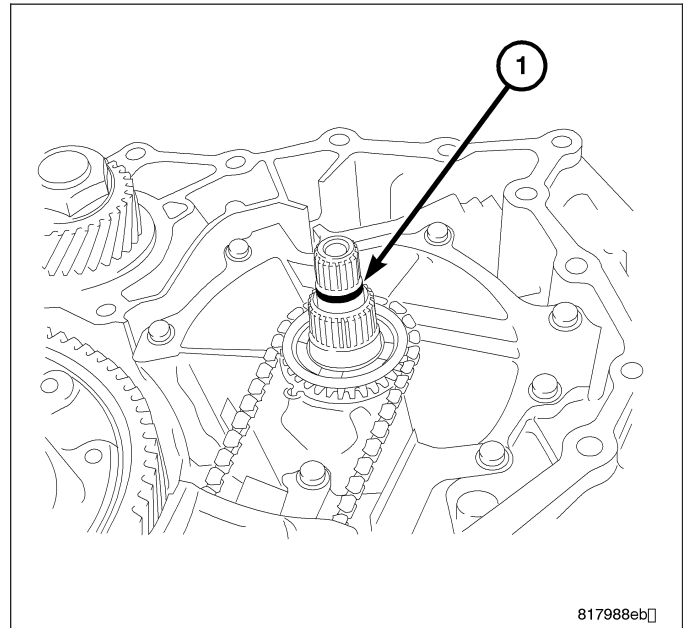

22. Remove the adjusting shim (1) from the drive sprocket, if necessary.

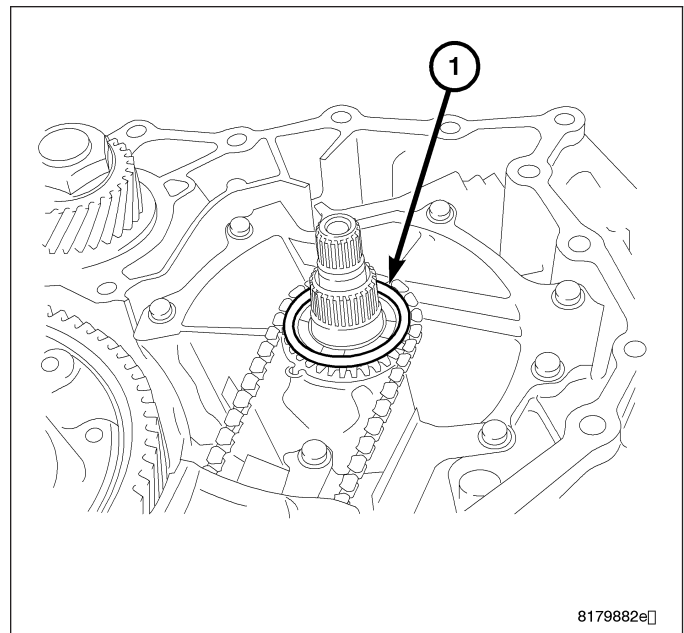

23. Remove the nuts holding the baffle plate (1) to the transaxle.

24. Remove the baffle plate.

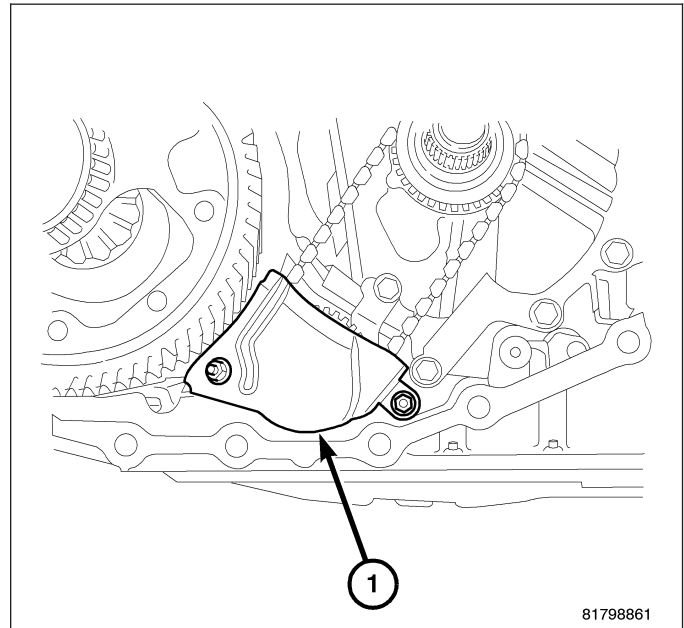

25. Expand the snap ring (1), and remove the driven sprocket (3), the oil pump chain (2), and the drive sprocket.

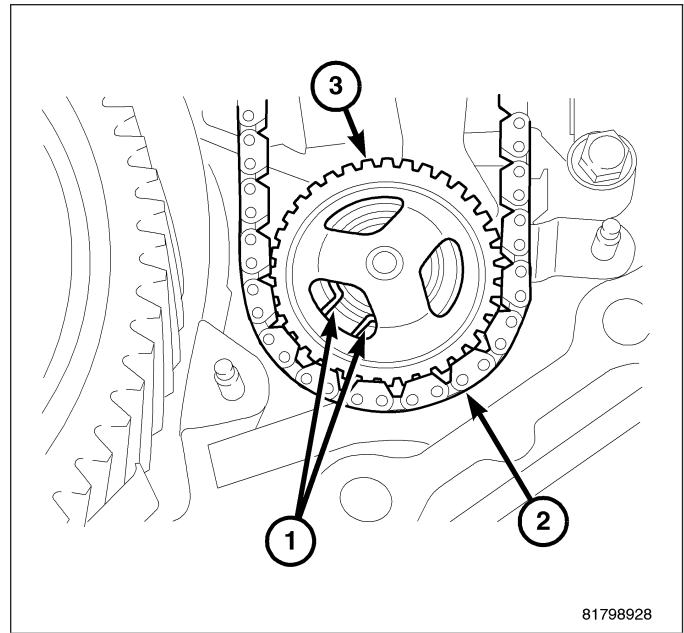

26. Remove the thrust washer (1) from the oil pump cover.

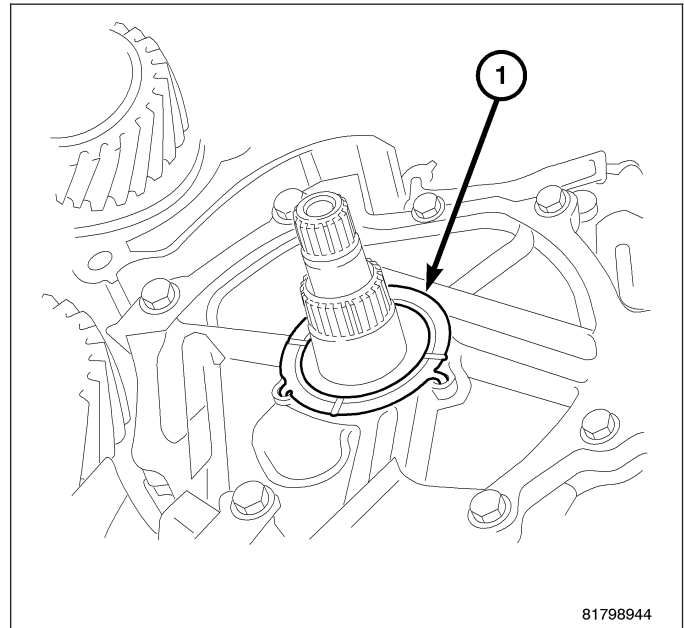

27. Remove the snap ring (1) from the oil pump.

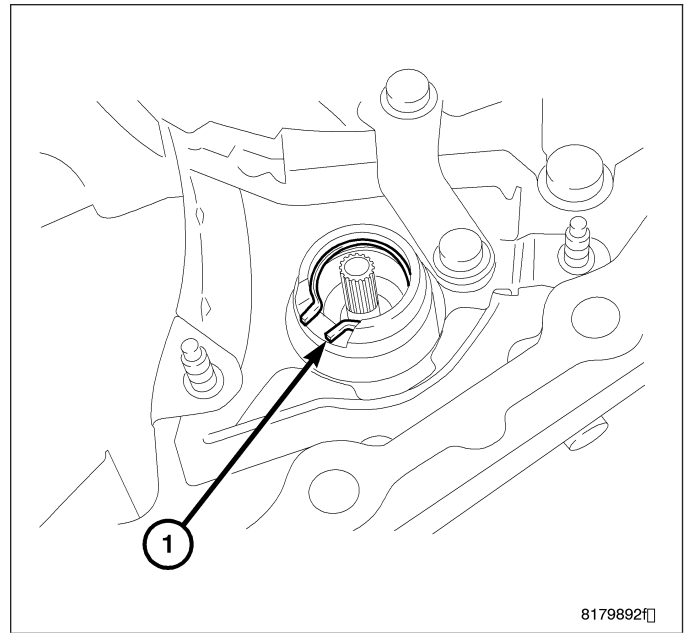

28. Remove the reduction gear assembly (1) from the transaxle case.

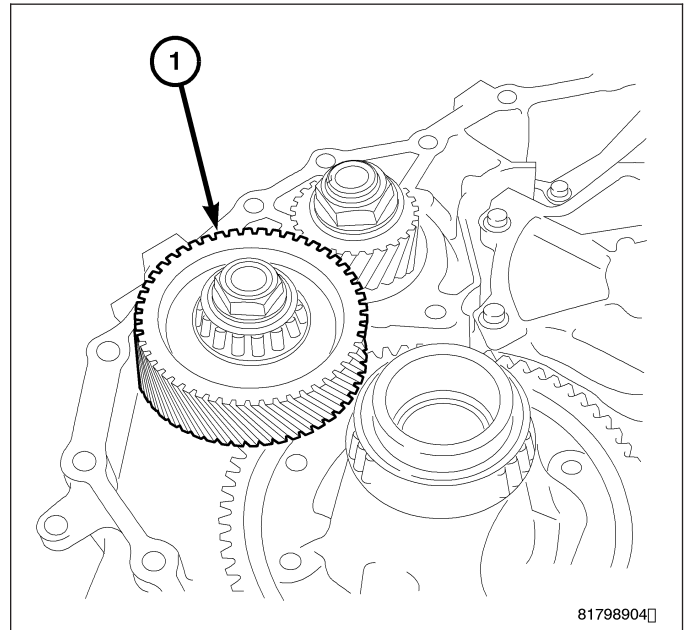



29. Remove the differential assembly (1) from the transaxle case.

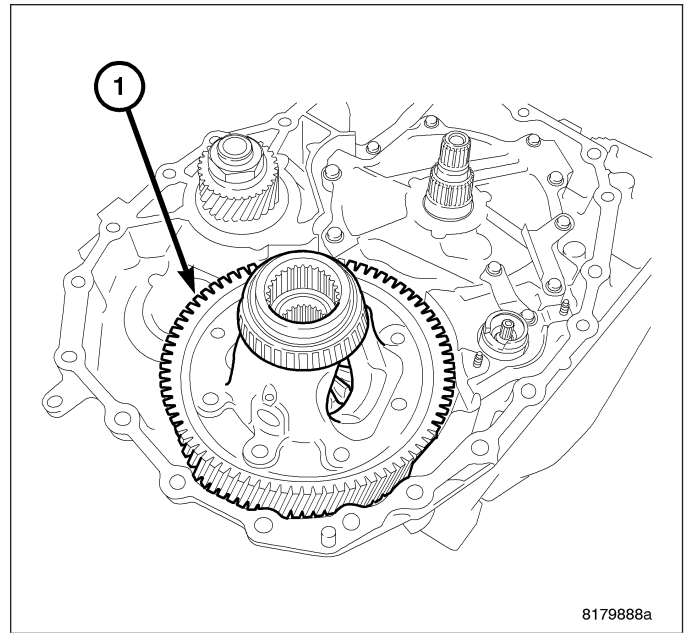

30. Remove the bolts holding the bracket (1) to the oil pump cover and the transaxle.  
31. Remove the bracket (1).

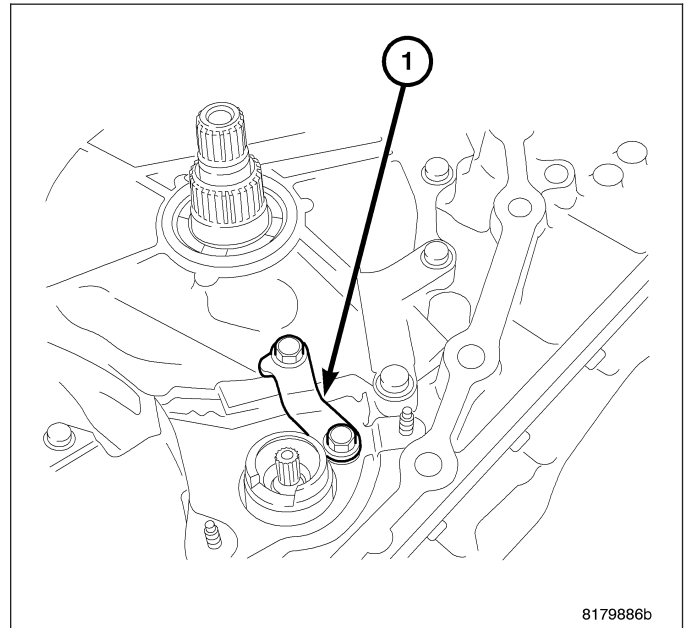

- 32. Remove the bolts holding the baffle plate (1) to the transaxle.
- 33. Remove the baffle plate.

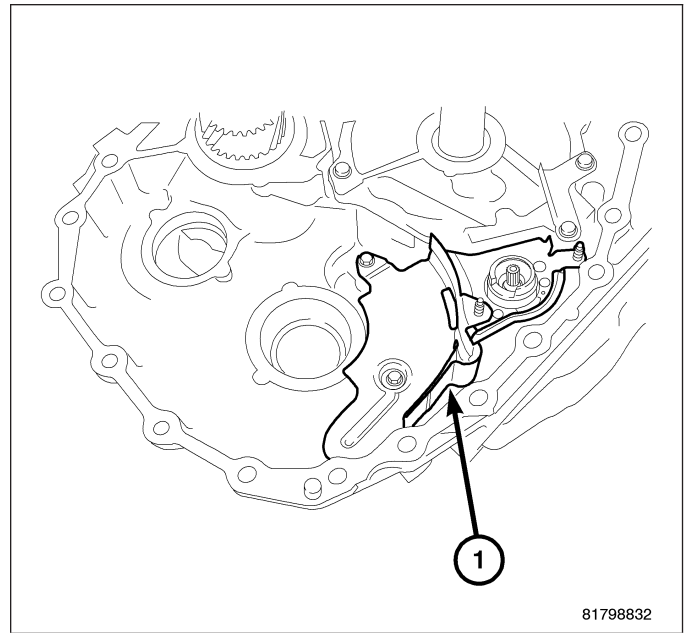

- 34. Remove the bolts holding the reaction shaft support (1) to the transaxle.
- 35. Remove the reaction shaft support from the transaxle case.

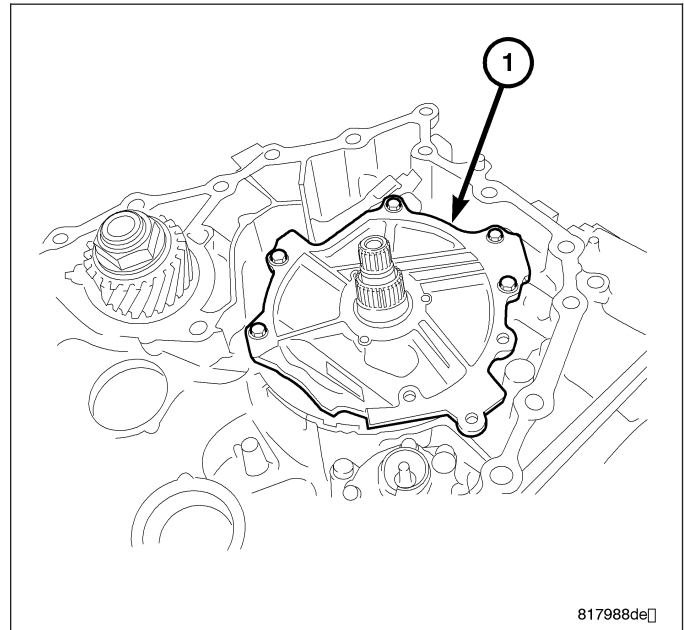

36. Remove and discard the seal rings (1) from the reaction shaft support.

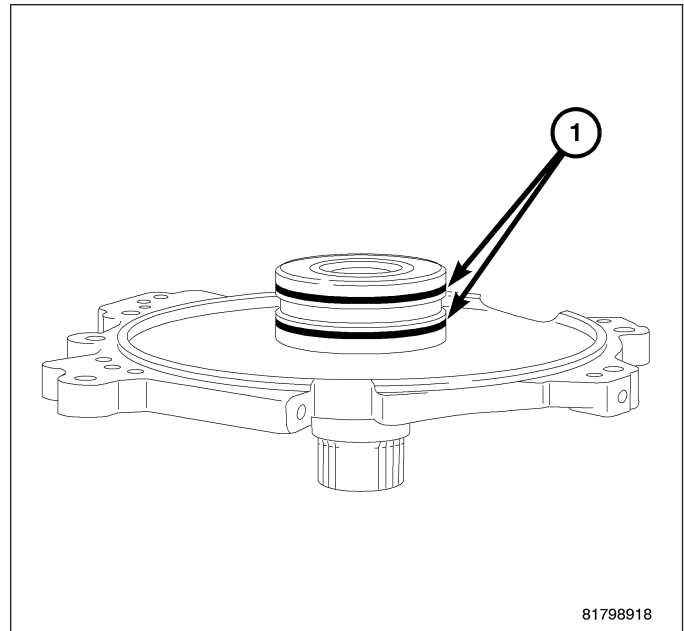

37. Remove the bolts holding the oil pan (1) to the transaxle case.
38. Remove the oil pan from the transaxle case.

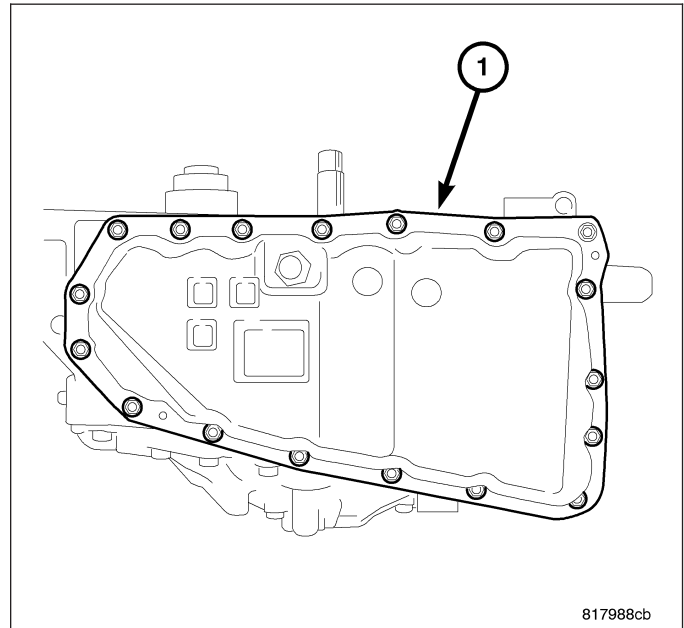

39. Remove the oil pan gasket (1) from the transaxle case.

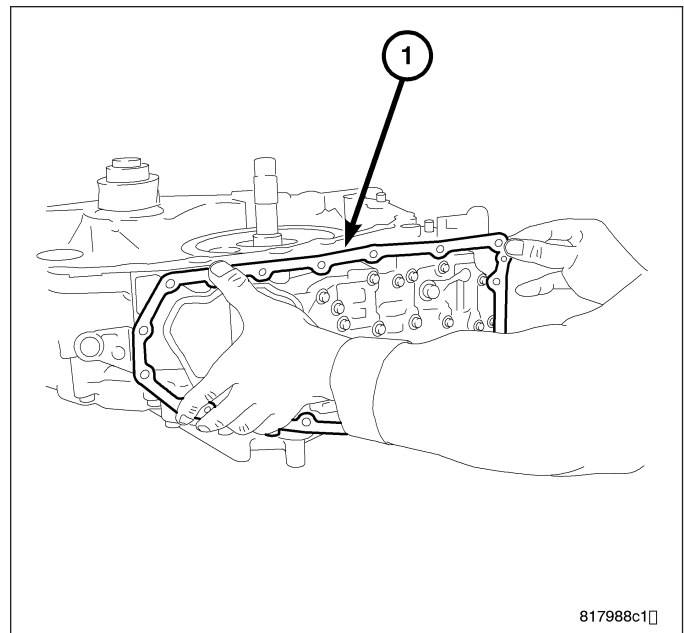

40. Remove the bolts holding the oil strainer (1) to the valve body.

41. Remove the oil strainer.

42. Remove and discard the oil strainer o-ring.

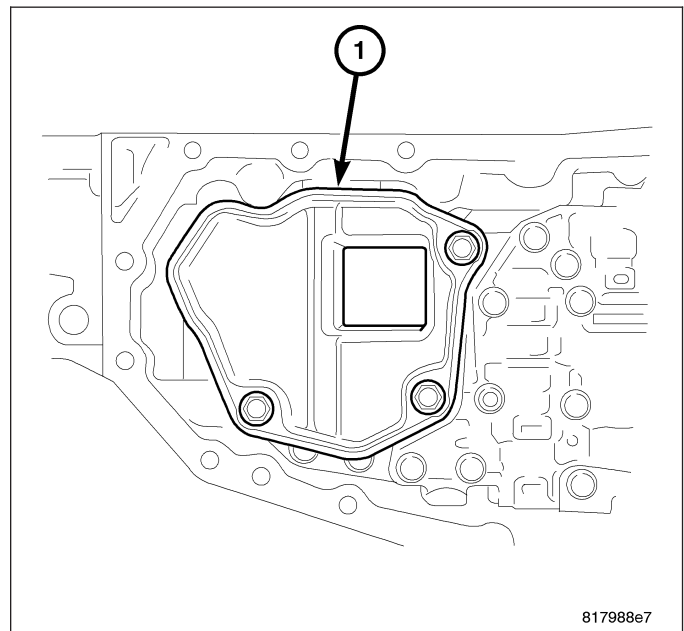

43. Remove the bolt (2) holding the oil pump to the transaxle case from the rear of the transaxle.
44. Remove the bolts (1) holding the oil pump to the transaxle case from inside the transaxle.
45. Remove the oil pump from the transaxle case.

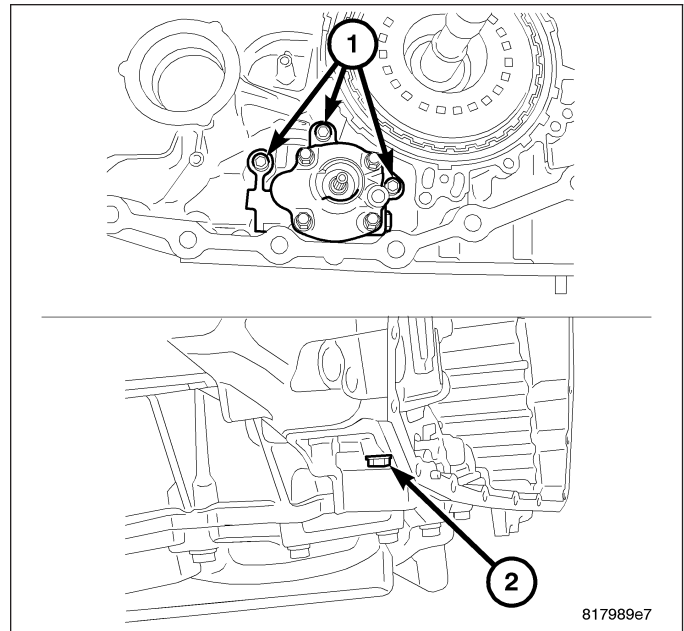

**NOTE:** One of the oil pump retaining bolts is installed from the outside of the transaxle case into the rear part of the oil pump.

46. Remove and discard the o-ring (1) from the oil pump mounting bolt. (Only on bolt installed from the outside of the transaxle case)

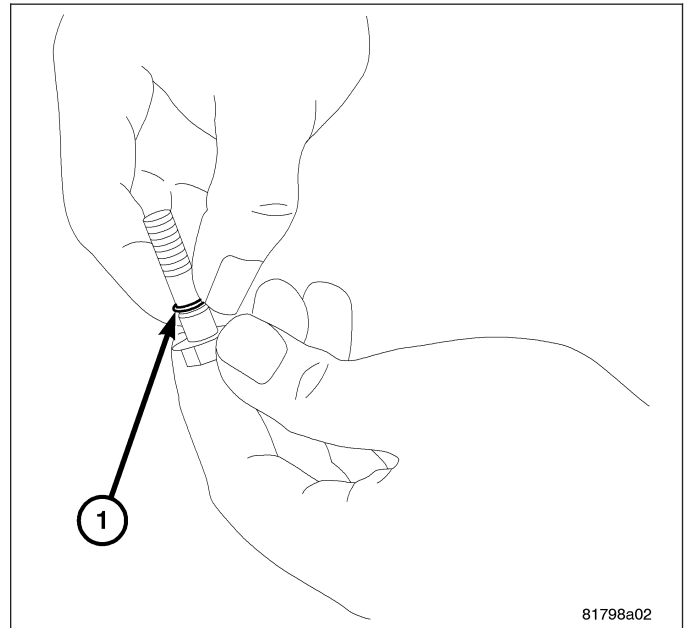

47. Remove and discard the lip seal (1) from the transaxle case.

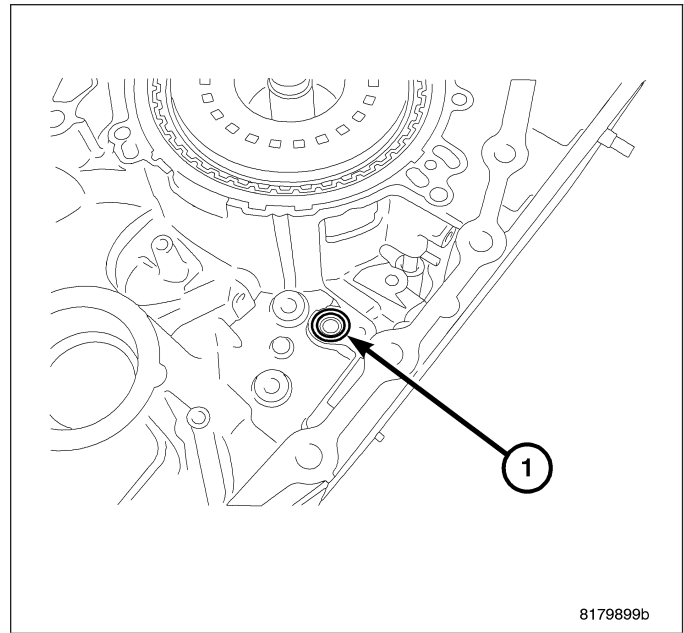

48. Remove the bolt holding the detente spring (1) to the transaxle case.  
49. Remove the detente spring from the transaxle case.

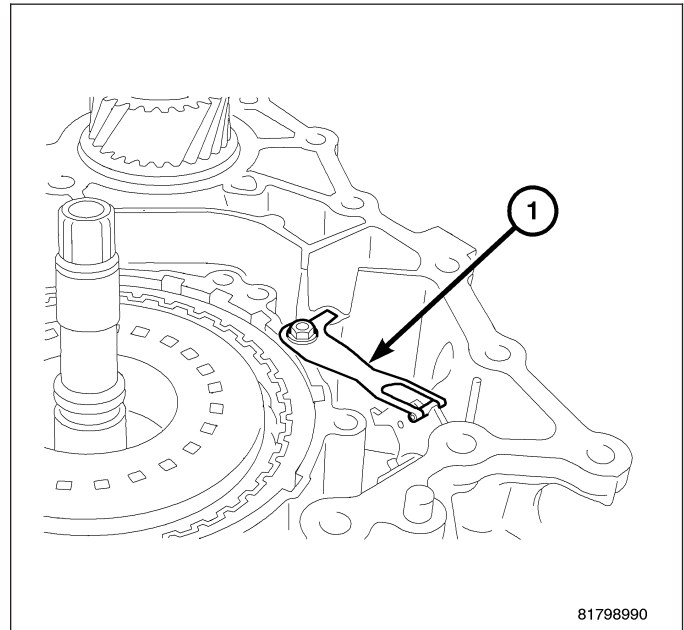

50. Remove the forward clutch assembly (1) from the transaxle case.

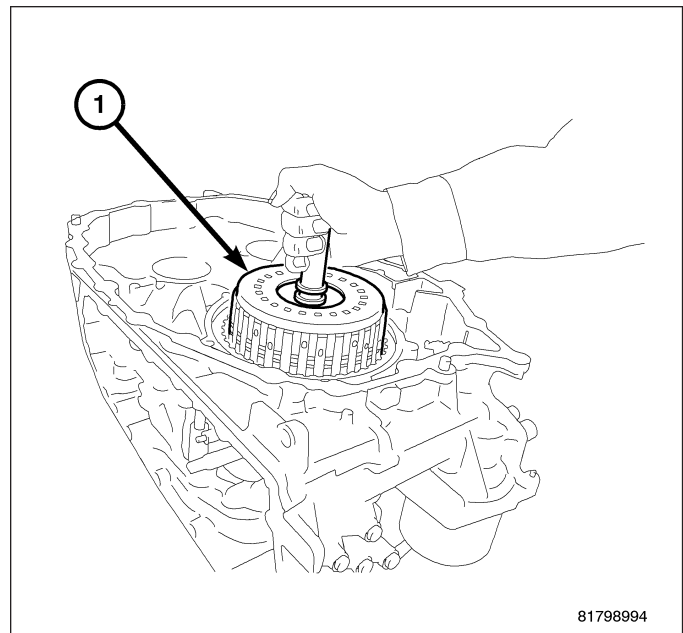

51. Remove needle bearing (1) from forward clutch drum side of the sun gear.

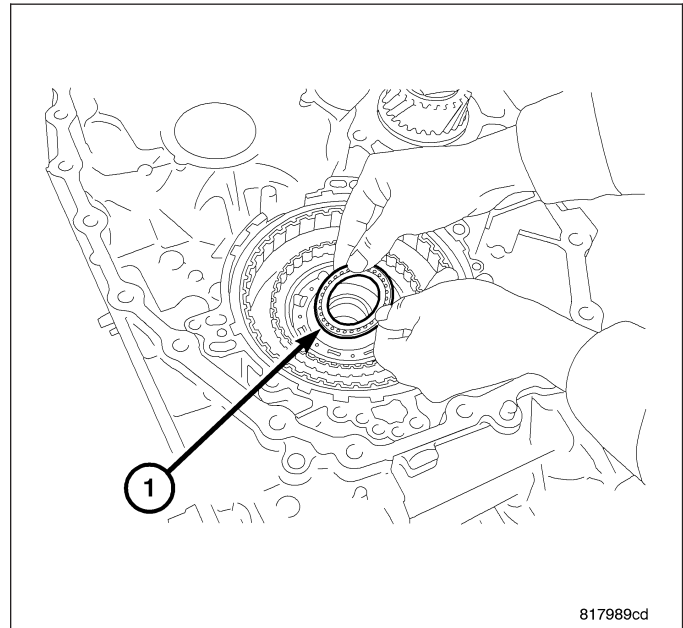

52. Remove the sun gear (1) from the planetary carrier.

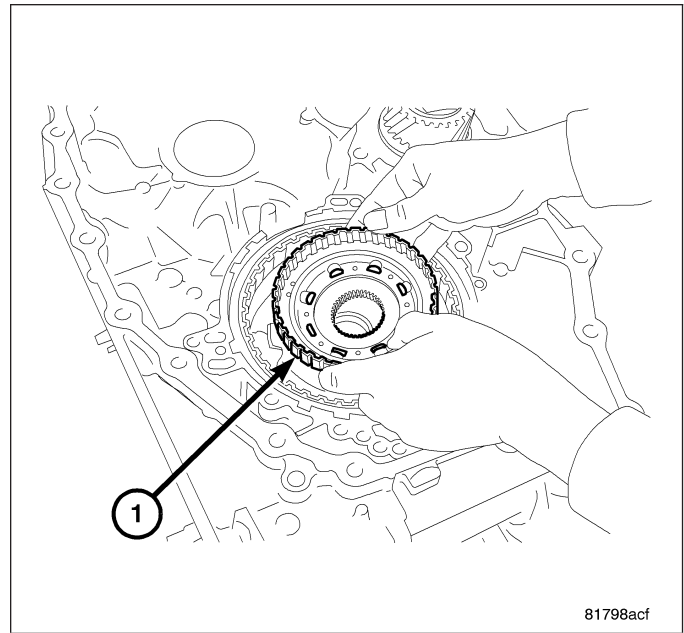

53. Remove the needle bearing (1) from the sun gear.

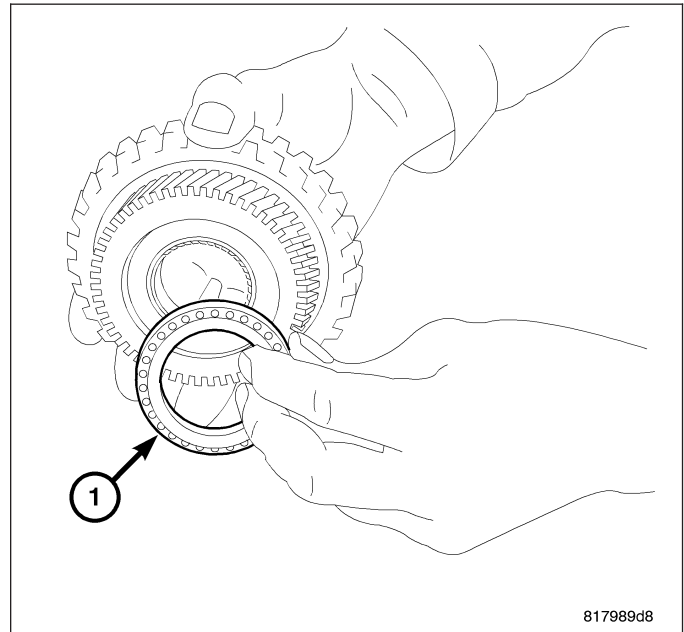



54. Remove the planetary carrier assembly (1) from the transaxle case.

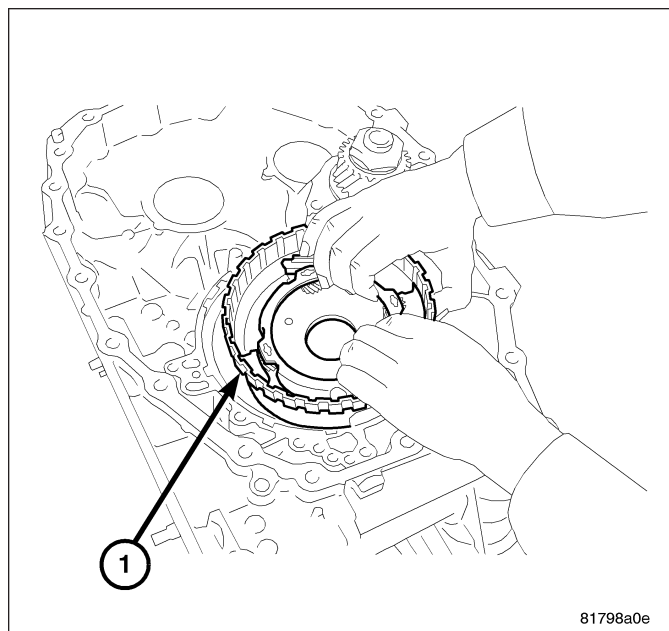

55. Remove the needle bearing (1) from the planetary carrier.

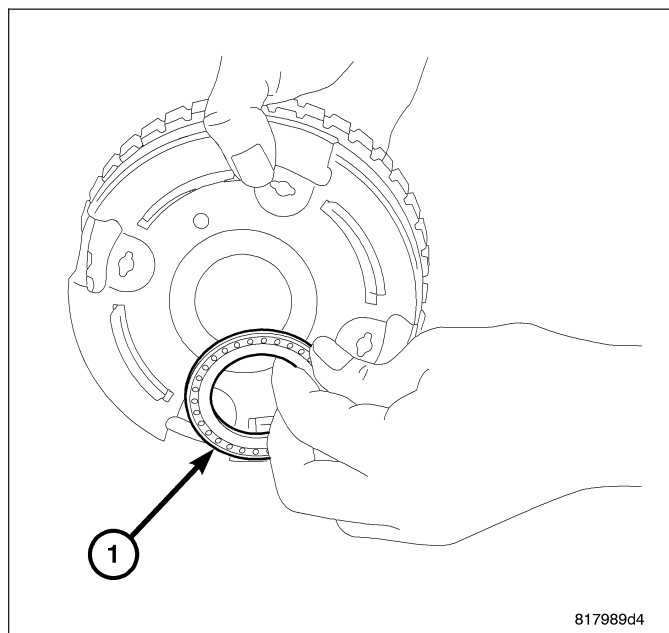

- 56. Remove the bolts holding the bracket (1) to the valve body assembly.
- 57. Remove the bracket from the valve body assembly.

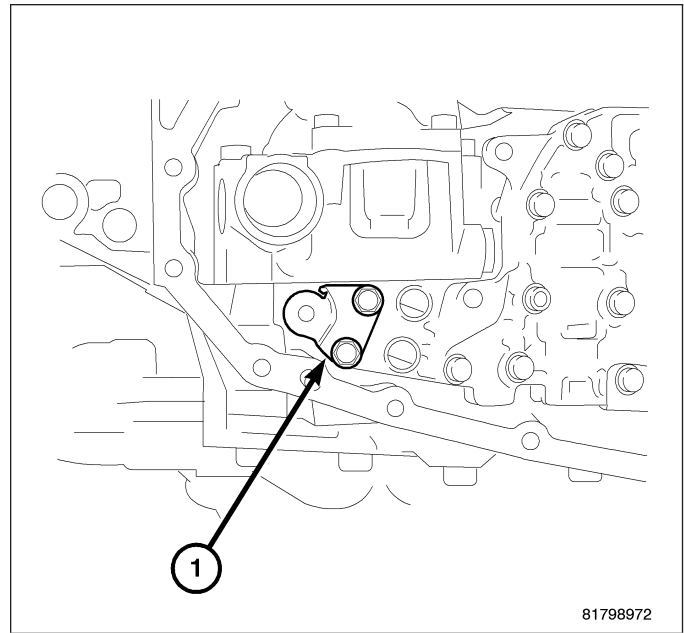

- 58. Remove the nut holding the manual lever (1) to the manual shaft.
- 59. Remove the manual lever.

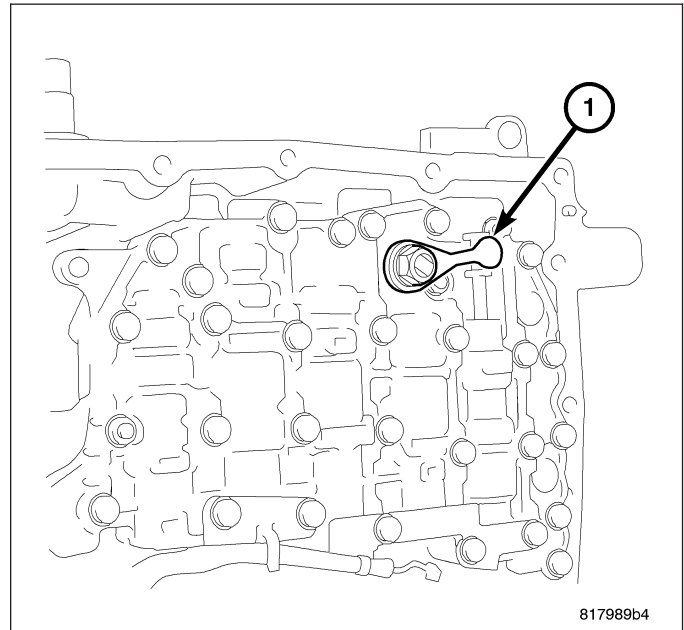

60. Use this picture when removing valve body attaching bolts.

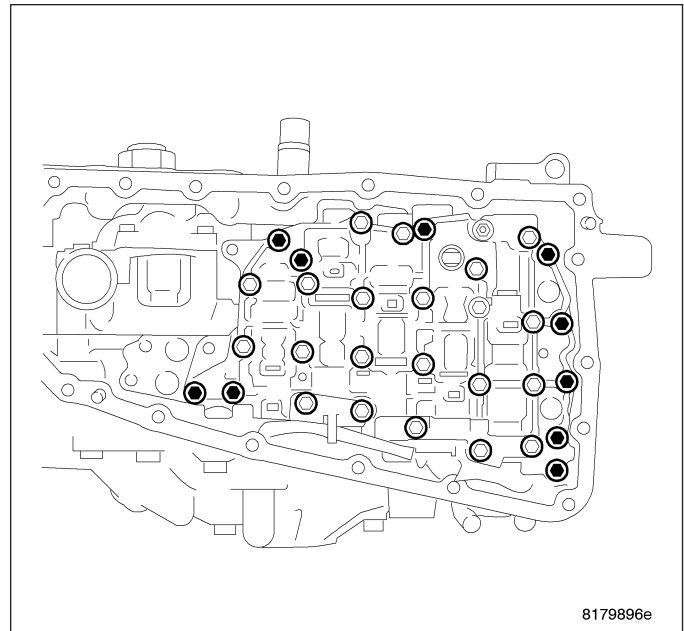

**CAUTION:** Tilt the valve body assembly away from the transaxle case on the manual shaft side to ease removal. Pay attention to completely remove the terminal body from the transaxle case.

61. Remove the valve body assembly from the transaxle case as follows:
- Insert a 75 mm (3 in.) long 3 mm (0.118 in.) rod or wire into the linkage stopper hole of the valve body assembly to fix the pulley ratio linkage (1).
  - Remove the bolts holding the valve body assembly to the transaxle case.
  - Remove the valve body assembly from the transaxle case.

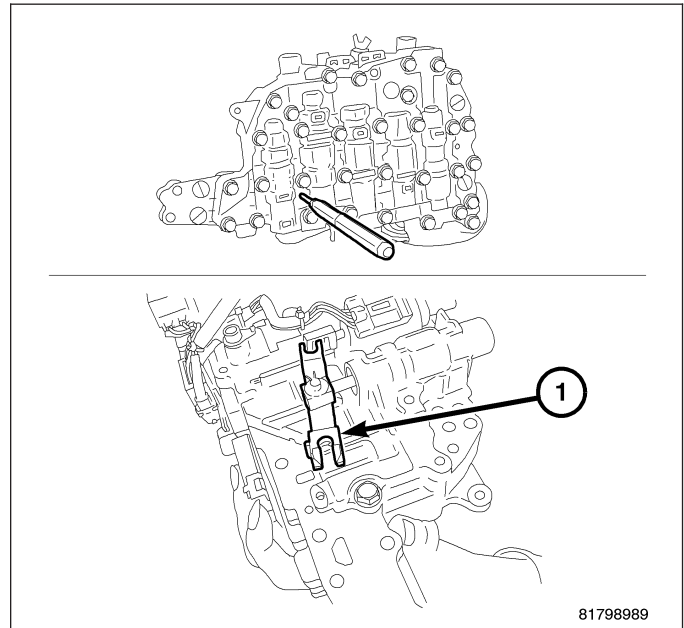

62. Remove and set aside the bushing (1) from the valve body.

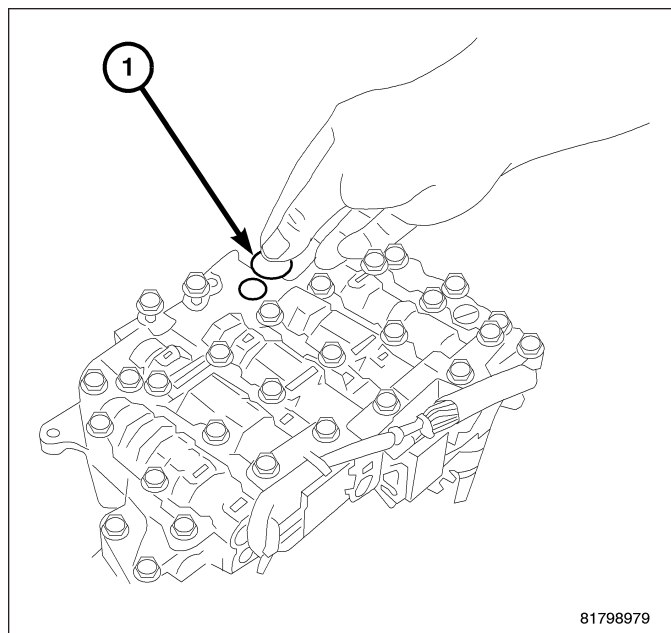

63. Remove the pin at the manual shaft using a punch (2).

64. Remove the manual shaft from case.

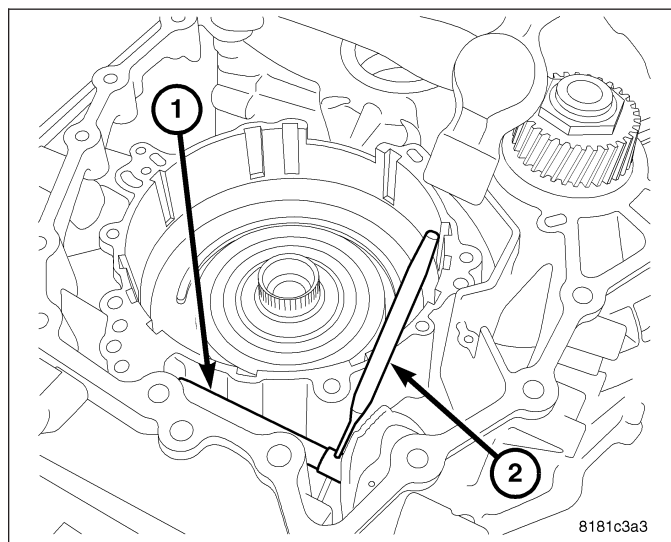

65. Remove and discard the lip seal (1) from the transaxle case.

