

Z48 (1999)
48" Deck Assembly

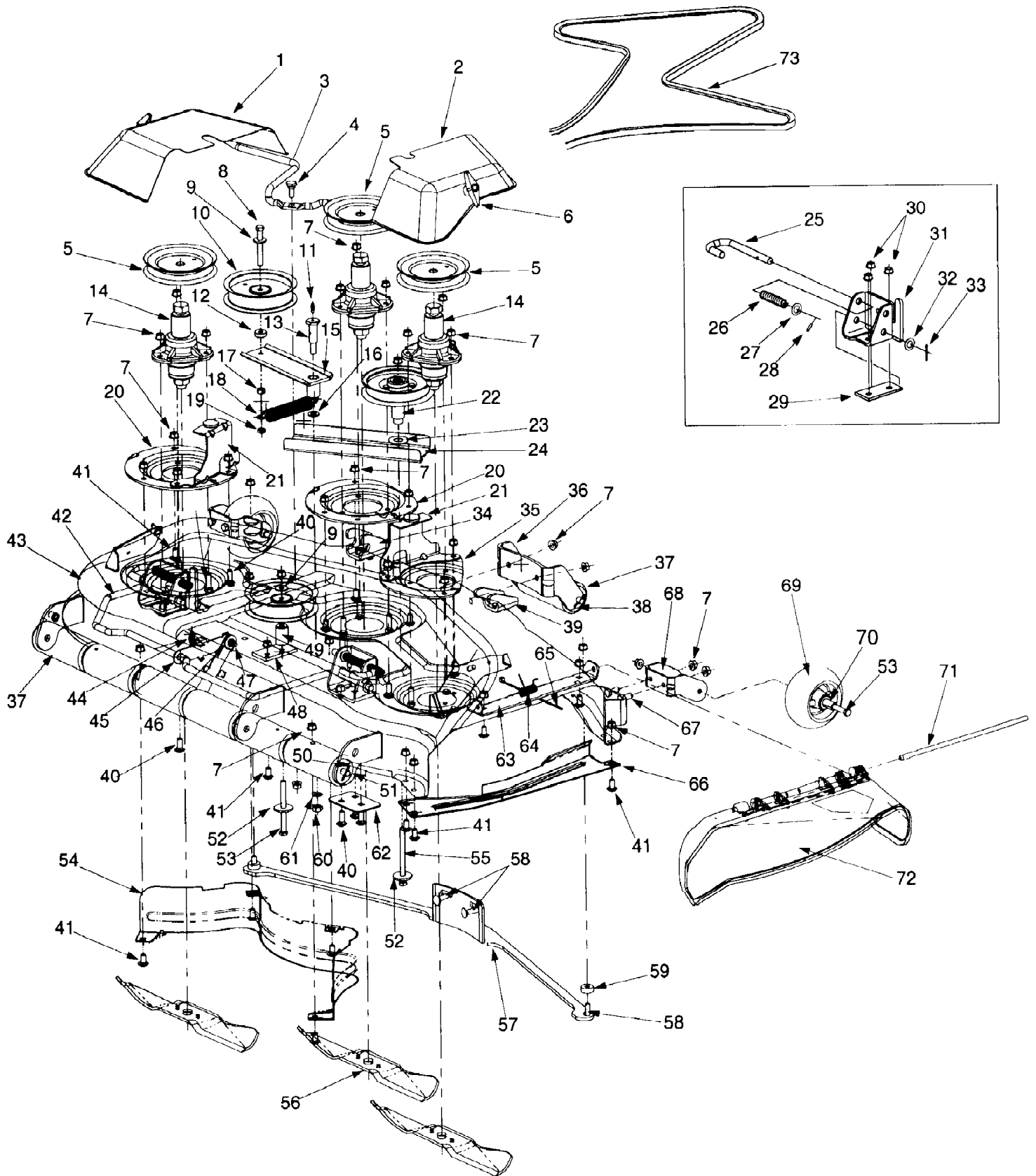

Z48 (1999)
48" Deck Assembly

Page 2 of 39

Ref #	Part Number	Qty	S/P/F	Description
1	703-2817	1		LH Belt Cover
2	703-2816	1		RH Belt Cover
3	747-3306	1		Idler Spring Mounting Rod
4	738-0380	1	S	Shoulder Screw 3/8-16
5	756-3106	1		Pulley
6	720-0241	1	S	Wingnut Knob
7	712-0431	1	S	Flange Lock Nut 3/8-16
8	710-0521	1	/P	Hex Cap Screw 3/8-16 x 3.0
9	736-0258	1	/P	Flat Washer .385 ID x 1.0 OD
10	756-3105	1		Idler Pulley 5.0
11	737-0280	1	S	Grease Fitting
12	711-0242	1	S	Spacer
13	738-3108	1	/P	Shoulder Bolt
14	603-0690	1		Spindle Ass'y
15	603-0469A	1	S	Idler Bearing Arm Ass'y
16	736-3015	1	S	Flat Washer .469 ID x .875 OD
17	712-0375	1	/P	Lock Nut 3/8-16
18	732-0942	1		Extension Spring 1.0 OD x 5.78 Lg
19	712-0342	1	/P	Jam Nut 3/8-16
20	703-2089A	1	S	Reinforcement Disk
21	603-0326	1		Belt Cover Bracket Ass'y
22	603-0407	1		Idler Pulley Ass'y 5.0
23	736-0316	1	S	Flat Washer .78 ID x 1.59 OD
24	703-2849	1	S	Channel
25	747-3013	1	/P	Mower Support Pin
26	732-0802	1		Compression Spring
27	736-0160	1	S	Flat Washer .536 ID X .93 QD
28	715-3003	1	/P	Spirol Spring Pin
29	703-2683	1	S	Rear Deck Hanger Bracket Spacer
30	712-0431	1	S	Hex Flange Lock Nut 3/8-16
31	603-0351	1		Rear Hanger Bracket LH
32	736-0160	1	S	Flat Washer .536 ID x .93 OD
33	714-0115	1	S	Cotter Pin
34	703-2767	1		Front End Deck Bracket LH
35	703-2090	1		Reinforcement Disk RH
36	703-2091A	1	/P	Front Roller Bracket
37	731-3005	1	/P	Front Roller
38	714-0115	1	S	Cotter Pin
39	703-2430	1		Front End Deck Bracket RH
40	710-3168	1	/P	Carriage Bolt 3/8-16
41	710-3178	1	/P	Carriage Bolt 3/8-16 x .75
42	747-3297A	1	/P	Support Deck Rod
43	603-0348	1		Mower Deck Ass'y 48"
44	732-0395	1	S	Extension Spring .50 OD x 2.51 Lg
45	703-2929	1	S	Support Deck Link
46	736-0231	1	S	Flat Washer .344 ID x 1.125 OD
47	731-3005	1	/P	Front Roller
48	703-3381	1		Idler Support Plate
49	750-3243	1		Spacer .380 ID x 1.0 OD
50	714-0115	1	S	Cotter Pin
51	711-1103	1		Roller Pin
52	736-0227	1	S	Flat Washer
53	710-0944	1	/P	Hex Cap Screw 3/8-16 x 4.25

Z48 (1999)

Page 3 of 39

48" Deck Assembly

Ref #	Part Number	Qty	S/P/F	Description
54	703-2161	1	S	Deck Baffle
55	710-0693	1	/P	Hex Cap Screw 3/8-16 x 4.5
56	759-3826	1	/P	Mower Blade
57	603-0154	1		Front Bar
58	710-3034	1	/P	Carriage Screw 3/8-16 x 1.25
59	750-3119	1	/P	Spacer .406 ID x 1.0 OD
60	712-3019	1	S	Hex Nut 7/16-14
61	736-0171	1	S	Lock Washer 7/16
62	703-2988	1	S	Support Plate
63	703-2392	1	S	Bracket
64	732-3070	1	S	Torsion Spring
65	725-0157	1	/P	Cable Tie
66	603-0150	1		Finger Guard
67	710-3001	1	/P	Hex Cap Screw 3/8-16 x .880
68	703-2410	1		Castor Bracket
69	634-3159	1	/P	Wheel Complete
70	750-3193	1	/P	Spacer
71	711-3318	1	/P	Hinge Pin
72	731-3131	1	S	Deflector Chute
73	754-3079	1	S/F	V-Belt