

SM-781 HWX/PWX Service Manual

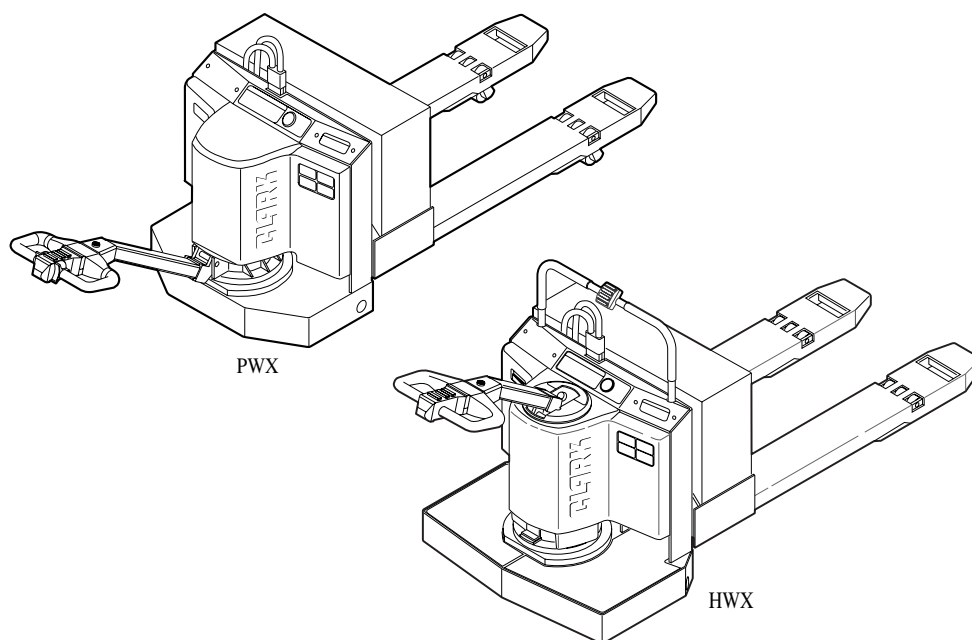

September 2007



Technical
Publications
Lexington, KY 40510
www.Clarkmhc.com

Copyrighted Material
Intended for CLARK dealers only

This is the cut pages sample. Download all 190 page(s) at: ManualPlace.com

NOTE :

Contents by Group

Contents are listed here by Group number :

| | |
|----|------------------------------|
| PS | PERIODIC SERVICE |
| 12 | BATTERY |
| 14 | WIRING |
| 16 | ELECTRIC MOTORS |
| 17 | CONTACTORS |
| 19 | MOTOR CONTROLS |
| 20 | DRIVE UNIT |
| 23 | BRAKE SYSTEM |
| 25 | CASTER ASSEMBLY |
| 28 | HYDRAULIC SYSTEM |
| 34 | LIFT CYLINDERS |
| 35 | LIFT LINKAGE and LOAD WHEELS |
| 39 | SHEET METAL |
| 40 | SPECIFICATIONS |

NOTE :

Truck Models Covered by this Manual

This manual consists of “base” module that pertains to all HWX/PWX models and other modules that pertain only to specific models. Manuals shipped with the truck contain the base module and the modules specific to the purchased truck.

You may, however, purchase specific modules and expand your manual to fully cover multiple models. To do so, order the desired modules as you would any other Clark part.

Arrangement and Use of this Manual

Clark arranges parts and service procedures by standardized *Groups*. In this manual, Groups are similar to “chapters”. Groups are listed in the indexes on the next page.

Each Group begins with a table of contents that shows the *Sections* contained within the Group. Lengthy Sections also begin with a table of contents.

Each Group and Section has an identifying name and number, or “ID”.

Each page also has a unique ID. The page ID consists of three numbers separated by hyphens. The three numbers represent the Group number, the Section number, and the page number. For example, “00-1-2” on the lower corner of the page indicates Group 00, Section 1, page 2.

The Group number sometimes has a letter or letters added to it in parentheses if one or more variations of the Group exist. For example, if the truck has a standard transaxle, Group 06 is expressed as “06(S)”; if the truck has a hydrostatic transmission, Group 06 is expressed as “06(H)”.

You can quickly locate a specific point in the manual by using the headers and footers that appear on every Section page. The following illustration points out these areas.

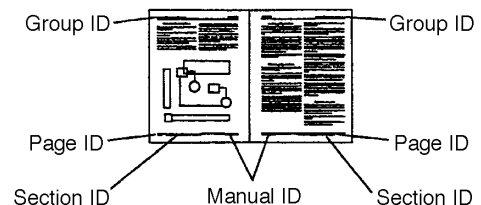

This manual is intended for the use of trained service personnel. Please read Group SA, “Safe Maintenance”, and the *Operator’s Manual* before working on or operating the truck.

NOTE :

GROUP PS PERIODIC SERVICE

| | |
|--|------------------|
| Maintenance Schedule | Section 1 |
| Planned Maintenance Program | Section 2 |
| The PM Inspection Form | Section 3 |

NOTE :

Section 1.

Maintenance Schedule

“Periodic Service” and “Planned Maintenance”

The term “periodic service” includes all maintenance tasks that should be performed on a regularly scheduled basis.

The term “Planned Maintenance” indicates a formalized program of basic inspections, adjustments, and lubrications that the Clark service organization provides customers at a prescribed interval, usually 50-250 hours. The recommended basic “Planned Maintenance” procedure is given in Section 2 of this Group.

The current Section, “Maintenance Schedules,” specifies all maintenance tasks including Planned Maintenance tasks that should be performed periodically, and suggests intervals at which they should be performed.

Determining Maintenance Intervals

Time intervals on the charts on the next four pages and elsewhere in this manual relate to truck operating hours as recorded on the hourmeter, and are based on experience Clark has found to be convenient and suitable under normal operation. Standard operating condition classifications are:

Normal Operation: Eight-hour material handling, mostly in buildings or in clean, open air on clean, paved surfaces.

Severe Operation: Prolonged operating hours or constant usage.

Extreme Operation:

- In sandy or dusty locations, such as cement plants, lumber mills, and coal dust or stone crushing sites.
- High-temperature locations, such as steel mills and foundries.
- Sudden temperature changes, such as constant trips from buildings into the open air, or in refrigeration plants.

If the lift truck is used in severe or extreme operating conditions, the maintenance intervals should be shortened accordingly.

IMPORTANT

MAINTENANCE INTERVALS. If the lift truck is used in severe or extreme operating conditions, the maintenance intervals should be shortened accordingly. Put upright in vertical position and fully lower the forks or attachment.

CLARK

NOTE :