

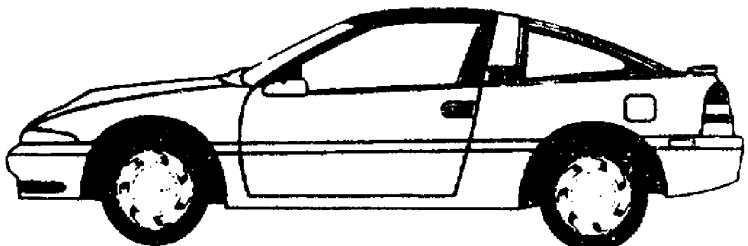

**1990-1994
LASER/EAGLE TALON
PARTS CATALOG**

**ILLUSTRATIONS AND TEXT
CHASSIS-BODY-ELECTRICAL
AND TRIM**



 **CHRYSLER
CORPORATION**
Mopar Parts Division

This publication contains Parts Information for all 1990-94 model year PLYMOUTH LASER
AND EAGLE TALON PASS. CAR product of Diamond-Star Motors. The joint venture between
Chrysler and Mitsubishi.

The use of this Parts Catalog and the arrangement of information herein is explained in the General
Information Section as indexed below.

INDEX TO INFORMATION PAGES

● ABBREVIATIONS	INF-9-13
● ALPHABETICAL INDEX	INF- 6
● BODY NUMBER	INF- 7
● CALIF. ARB	INF-14 - 26
● COLOR CODES	INF- 5
● CONTENTS	INF- 3
● DIMENSIONS	INF- 7
● ENGINE MODEL AND SERIAL NUMBER	INF- 7
● ENGINE MODEL STAMPING	INF- 5
● GROUP 23 INDEX-DEFINITION	INF- 27
● HOW TO LOCATE PARTS	INF- 2
● ILLUSTRATION INDEX	INF- 6
● KEY NUMBERS	INF- 7
● METRIC CONVERSION TABLE	INF- 8
● NEWPART INDEX	INF- 6
● NUMERICAL INDEX	INF- 6
● PAGE NUMBERING	INF- 6
● PARTS CATALOG REVISION SERVICE	INF- 7
● PARTS NUMBER PREFIX	INF- 7
● PRODUCT BULLETINS	INF- 7
● SYMBOLS USED IN THIS CATALOG	INF- 6
● TRANSMISSION MODEL & SERIAL NUMBER	INF- 7
● VEHICLE CERTIFICATION LABEL	INF- 5
● VEHICLE IDENTIFICATION PLATE	INF- 4

HOW TO USE THIS CATALOG AND LOCATE PARTS

This Catalog is divided into Part Groups in which illustrations for parts of a similar function and/or location are published. The Group Contents listing on the next page shows the type of parts contained in each group. Tabs are provided or available to separate each group.

Option 1: From the Group Contents listing, select the group which would most logically contain the part to be found. Or open the catalog to Group 1, Master Group Illustration Index. Select the illustration group most likely to contain the parts associated. Turn to the Illustration Index in front of that group to select illustration and locate the parts item numbers and associated text information.

Option 2: If the "noun" name of the part you seek is known, an alphabetical index of nouns and illustration titles is provided to assist in finding the part. Several keys may be found in this index.

RESERVOIR Power Strng. Oil Pump	Group 19	Group Reference						
ALTERNATOR, Engine	8-200	Illustration Reference						
STARTER	08 105 4	Illustration/Item Reference						
	<table border="0" style="margin-left: 20px;"> <tr> <td>Group</td> <td>_____</td> </tr> <tr> <td>Illustration No.</td> <td>_____</td> </tr> <tr> <td>Item</td> <td>_____</td> </tr> </table>	Group	_____	Illustration No.	_____	Item	_____	
Group	_____							
Illustration No.	_____							
Item	_____							

Option 3: If the part number is known but the applications need to be determined, refer to the numerical index. This index shows the group, illustration number and item for each part listed in the catalog. Multiple references mean the part is listed more than once.

PART GROUP - TITLES & CONTENT

GROUP	CONTENTS
HW	Information Section
AL	Alphabetical Index
NE	Newpart Index
NL	Illustration Index (All Groups)
1	Master Illustration Index
2	Front Suspension & Drive Front Suspension Components Steering Knuckles Front Drive Shafts Axles Locking Hubs Front Differential
3	Rear Axle Rear Axle and Component Parts Rear Axle Mountings
4	Parking Brake Controls
5	Service Brakes Brake Controls and Mechanism Brake Warning Switch Park Brake Components within the Wheel Wheel Hardware Bearings and Seals
6	Clutch Clutch Unit and Components Clutch Pedal Controls
7	Cooling Front Grille Grille Support Radiator Supports Headlamp Supports Radiators Fans and Fan Motors Hoses Thermostats Transmission Cooling Water Pumps Drive Belts and Pulleys Turbocharger Cooling
8	Electrical Switches Relays Solenoids Sensors Battery Trays Engine Electrical Starters Alternators Distributors Front Rear Interior Lamps Body Wiring Horn
8A	Instrument Panel and Console Instrument Panel and Console Electrical Parts Clusters Switches Wiring All Hard and Soft Trim Parts Radio Speakers and Antenna
9E	Engine (By Engine Type) Engine Components Engine Oil System Flywheels Torque Converters Engine Mounting
11	Exhaust Exhaust System Components Heat Shields
13	Frame Bumper & Fascia Frame Components Group Members Bumper and Fascia Components Snow Plow Parts
14	Fuel Accelerator Pedal Linkage Throttle Control Air Cleaner Carburetors Throttle Body and Injection Components Fuel Lines Fuel Tank Fuel Pump Turbocharger Components Speed Control

GROUP	CONTENTS
16	Prop. Shaft and Universal Joint
17	Rear Suspension Rear Suspension Components
18	Service Bulletin Parts
19	Steering Steering Wheels Column Power Steering Pump Steering Gear Steering Linkage Tie Rods
21M	Manual Transmission and Transfer Cases Manual Transmission Transaxle and Components Gearshift Controls Transfer Case Controls Mountings Speedometer Pinion and Cable
21A	Automatic Transmission Automatic Transmission Transaxle and Components Gearshift Controls Speedometer Pinion and Cable
22	Wheels Wheel Rims Wheel Covers Hubcaps Jack and Spare Tire Storage
23	Exterior Ornamentation Exterior Ornamentation Tape Stripes Decals Exterior Moldings Vinyl Roof and Trim Ground Effects Pigs
23A	Body Sheet Metal Except Doors Body Metal Stationary Glass Sunroof Convertible Top Hood and Deck Release
23C	Body Doors and Related Parts Door Metal Door Hardware Door Glass and Regulator Door Mirrors Weatherstrips
23D	Body Miscellaneous Lock Cylinders and Keys Windshield Washer/Wiper System
	Interior Trim (By Body Code) All Interior Trim Except Dash and Console Seats and Seat Belts Seat Adjusters Manual and Power Carpet Interior Panels and Moldings Security/Tonneau Covers
24	Heater and Air Heater Air Conditioning System and Controls
25	Emission Systems Air Pump EGR System Vapor Canister
NU	Numerical Index

VIN PLATE IDENTIFICATION											
1	2	3	4	5	6	7	8	9	10	11	12 thru 17
Country	Make	Vehicle Type	Other	Line	Series	Body Style	Engine	Check Digit	Model Year	Assy. Plant	Sequence No

- 1 COUNTRY**
4 = USA
- 2 MAKE**
P = Plymouth
E = Eagle
- 3 VEHICLE TYPE**
3 = Passenger Car
- 4 OTHER**
C = Automatic Seat Belt
B = Manual
- 5 LINE PASSENGER CAR**
S = Laser Talon FWD
T = Laser Talon AWD
F = Laser Talon FWD
G = Laser Talon AWD
- 6 SERIES**
3 = Medium
4 = High
5 = Premium
6 = Special/Sport
- 7 BODY STYLE**
4 = 3 Door Hatchback

- 8 ENGINE**
T = 1.8L (110 CID) (SOHC - MPI) - P ENG
R = 2.0L (122CID) (DOHC - MPI) - A ENG
U = 2.0L (122CID) (DOHC - MPI Turbo) - A ENG
B = 1.8L (SOHC - MFI) - P ENG
E = 2.0L (DOHC MFI) - A ENG
F = 2.0L (DOHC MFI) - TURBO
- 9 CHECK DIGIT**
0, 1, 2, 3, 4, 5, 6, 7, 8, 9, X
- 10 MODEL YEAR**
L = 1990
M = 1991
N = 1992
P = 1993
R = 1994
- 11 ASSEMBLY PLANT**
E = DSM
Bloomington

12 thru 17
SEQUENCE NO.
Six Digit Number

VEHICLE IDENTIFICATION

Vehicle Identification Number Location
The vehicle identification number (V.I.N.) is located on a plate attached to the left top side of the instrument panel.

VEHICLE IDENTIFICATION CODE PLATE

VEHICLE IDENTIFICATION CODE PLATE
Vehicle information code plate is on the bulkhead in the engine compartment.
The plate shows model code, engine model, transaxle model, and body color code.

1. MODEL **D22AMH HML4[®]**
 ↳ Model series
 ↳ Vehicle model
2. ENGINE **4G63**
 ↳ Engine model
3. TRANSAXLE **KM215**
 ↳ Transaxle model
4. COLOR, TRIM OPT. **B14**
 ↳ Monotone exterior color code

DSM 141820
1129 02657

MODEL	D22AMNGFL4E
ENGINE	4G63 EXT XE3
TRANS	W5M33
COLOR TRIM	X13 04H
OPT	J50
528 MBDFR3464401 DDF U	
APA PX8 QX8 P5FV EBG	
BDFF24 4E3CT64U9ME141820	

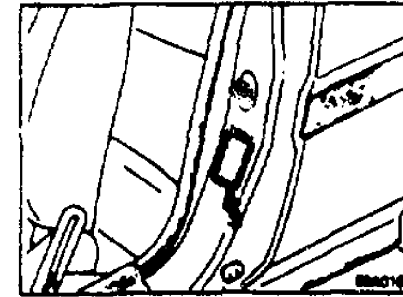

VEHICLE SAFETY CERTIFICATION LABEL

- The vehicle safety certification label is attached to the face of left door pillar.
- This label indicates the month and year of manufacture, Gross Vehicle Weight Rating (G.V.W.R.) front and rear, and Vehicle Identification Number (V.I.N.).

ENGINE MODEL STAMPING

- The engine model number is stamped at the front side on the top edge of the cylinder block as shown in the following:

Engine model	Engine displacement
4G63	2.0 liter (122 CID) (DOHC-MPI) or (DOHC-MPI-Turbo)
A588	2.0 liter (Non-Turbo)
6G73	2.5L (24VALVE) V6

- The engine serial number is stamped near the engine model number, and the serial number cycles, as shown below.

Engine serial number	Number cycling
AA0201 to YY9999	AA0201 AA9999
	AB0001 AY9999
	BA0001 YY9999

PAGE NUMBERING

Two-part page numbers are used throughout this catalog. The first part of the page number identifies the group and the second part of the sequence within the group. For example: 2-3 indicates Group 2, Front Suspension, Page 3.

In the maintenance of the Loose Leaf Parts Catalog it may be necessary to add information beyond the capacity of the page. If this should occur, an "A" page may be provided; e.g.: 2-3A should be filed immediately following page 2-3.

ILLUSTRATIONS

Two part illustration numbers are used to locate the graphic in its proper sequence. The first part is the group number and the second part the sequence within the group. (Note: Illustrations will always be on the left hand page and will be an even numbered page).

A master index of all illustrations follows the INF Section. In addition, each group fly page includes a listing of the graphic illustrations contained within the group.

ALPHABETICAL INDEX

To locate a part by name refer to the Alphabetical Index (located at the back of the catalog with page numbers prefixed "AL"). If the name of the particular item sought is not listed, or is unknown, look for the assembly in which it is contained or to which it is attached. The index refers to the graphic illustration which depicts the part.

NEWPART INDEX

A listing of new part numbers contained in the catalog. The numbers are in group sequence with reference to the illustration and item number where the part is located.

NUMERICAL INDEX

To locate a part by number refer to the Numerical Index (located at the back of the catalog with page number prefixed "NU"). This section contains a listing of all part numbers contained in the catalog with reference to their location.

SYMBOLS USED IN THIS PARTS CATALOG

The following symbols are commonly used with Part Number and quantity information in this Catalog:

- Precedes a new part number to the catalog and remains in subsequent issues until stock is available for shipment.

AR - Indicates the quantity required may vary or is to be determined by the user.

() around a part number following the item being specified indicates interchange with the new number for the part. Prior to ordering, check the current Master Parts List for the bracketed number and, if listed, order that number. Doing so will preclude delay in obtaining the part since the new number may not yet be available when the order is submitted.

SPECIFYING INFORMATION

The following information is included in this Parts Catalog:

1. Part Name.
2. Part Number.
3. Quantity use per Vehicle.
4. Model Application.
5. Description and/or dimensions, colors, etc. for proper identification.
6. Effective points for changes.

PRODUCT BULLETINS

Product Bulletins may be issued when important changes are made in production or when changes are to be made in a catalog between issues. It is important that catalogs be updated in accordance with information contained in Product Bulletins to insure accurate specifying.

PARTS CATALOG REVISION SERVICE

Subscribers to the catalog service will be periodically provided with revision copy incorporating the latest information. Revision may be by Page, Group, or by complete book.

Proper interfiling of the revision copy will assure the subscriber of a complete up-to-date catalog.

PART NUMBER PREFIX

Most Part numbers listed in the catalog are eight characters long and consist of two alpha followed by six numeric characters. Always use both alphas when submitting your parts order.

KEY NUMBERS

Parts are listed in the text by the "key number" which identifies the item as depicted in the illustration.

When the "key number" is a combination; i.e.: "2-5," the part number is assembly consisting of the referenced "key numbers" 2, 3, 4, and 5. If the "key number" appears as 2-5, 9 or 2-5 & 9, the part number contains 2, 3, 4, 5 and 9.

DIMENSIONS

Dimensions listed in this publication are expressed in millimeters. To convert to inches multiply the value shown by .03937. (See Metric Conversion Table)

BODY NUMBER

The Body Number of the Model 24, Passenger Car is stamped on the right top of the fire wall in the engine compartment.

ENGINE MODEL AND SERIAL NUMBER

The Engine Serial Number is stamped on top of the cylinder block at the right front corner.

TRANSMISSION MODEL AND SERIAL NUMBER

Mitsubishi transaxle and manual transmission serial numbers are stamped on the clutch housing. Chrysler built Automatic Transmission Identification numbers are stamped on the left oil pan side rail as follows:

TRANS. ASSY. NUMBER	CHANGE CODE	DATE CODE	SERIAL NUMBER
7 Digits 1234567	1 Digit A (Factory use only of no significance to the field)	4 Digits 8577	4 Digits 0001 (A sequential number for each days' production)

METRIC CONVERSION TABLE

LINEAR MEASUREMENT

1 foot (ft.) = 12 inches (in.)
 1 yard (yd.) = 3 ft. = 36 in.
 1 mile (statute) = 5,280 ft.

1 centimeter (cm) = 10 millimeters (mm)
 1 meter (m) = 100 cm = 1000 mm
 1 kilometer (km) = 1000 meters

To convert	Into	Multiply by	To convert	Into	Multiply by
inches	centimeters	2.5400	centimeters	inches	0.3937
inches	millimeters	25.4000	millimeters	inches	0.0394
feet	meters	0.3048	meters	feet	3.2808
feet	millimeters	304.8000	millimeters	feet	0.0033
yards	meters	0.9144	meters	yards	1.0936
miles	kilometers	1.6093	kilometers	miles	0.6214

AREA MEASUREMENT

1 square foot (sq. ft.) = 144 square inches (sq. in.)
 1 square yard (sq. yd.) = 9 square feet
 1 acre = 4,840 sq. ft.
 1 square mile = 640 acres

1 sq. centimeter (cm²) = 100 sq. millimeters (mm²)
 1 sq. meter (m²) = 10,000 cm²
 1 are (a) = 100 m²
 1 sq. kilometer (km²) = 1,000,000 m²

To convert	Into	Multiply by	To convert	Into	Multiply by
square inches	sq. centimeters	6.4516	sq. centimeters	sq. inches	0.1550
square feet	sq. meters	0.0929	sq. meters	sq. feet	10.7639
square yards	sq. meters	0.8361	sq. meters	sq. yards	1.1960
acres	sq. meters	4.0470	sq. meters	acres	0.0002
square miles	sq. kilometers	2.5900	sq. kilometers	sq. miles	0.3861

CUBIC MEASUREMENT (VOLUME)

1 cubic foot (cu. ft.) = 1.728 cubic inches (cu. in.)
 1 cubic yard (cu. yd.) = 27 cubic feet

1 cu. centimeter (cm³) = 1000 cu. millimeters (mm³)
 1 cubic meter (m³) = 1,000,000 cm³

To convert	Into	Multiply by	To convert	Into	Multiply by
cubic inches	cu. centimeters	16.3872	cu. centimeters	cubic inches	0.0610
cubic feet	cu. meters	0.0283	cubic meters	cubic feet	35.3145
cubic yards	cubic meters	0.7646	cubic meters	cubic yards	1.3079

LIQUID MEASUREMENT (CAPACITY)

1 pint (pt.) = 28.875 cubic inches
 1 quart (qt.) = 2 pints = 57.75 cu. in.
 1 gallon (gal.) = 4 qts. = 231 cu. in.

1 centimeter (cl.) = 10 milliliters (ml.)
 1 liter (l.) = 100 cl. = 1000 ml.
 1 kiloliter (kl.) = 1000 liters

To convert	Into	Multiply by	To convert	Into	Multiply by
cubic inches	liters	0.0164	liters	cubic inches	61.0250
pints	liters	2.1132	liters	pints	0.4732
quarts	liters	0.9463	liters	quarts	1.0566
gallons	liters	3.7853	liters	gallons	0.2642
cubic feet	liters	28.3162	liters	cubic feet	0.0353

WEIGHT MEASUREMENT

1 ounce (oz.) = 16 drams
 1 pound (lb.) = 16 ounces
 1 short ton = 2000 pounds
 1 long ton = 2240 pounds

1 centigram (cg.) = 10 milligrams (mg.)
 1 gram (g.) = 100 cg. = 1000 mg.
 1 kilogram (kg.) = 1000 grams
 1 metric ton (t.) = 1000 kg.

To convert	Into	Multiply by	To convert	Into	Multiply by
drams	grams	1.7718	grams	drams	0.5644
ounces	grams	28.3495	grams	ounces	0.0353
pounds	kilograms	0.4536	kilograms	pounds	2.2046
tons (short)	tons (metric)	0.9072	tons (metric)	tons (short)	1.1023

POWER MEASUREMENT

1 horsepower (hp) = 746 watts = 745.7 kilowatts (kw)
 1 horsepower (ps) = 736 watts = 735.5 kw

To convert	Into	Multiply by	To convert	Into	Multiply by
horsepower (U.S.)	horsepower (met.)	1.0139	horsepower (met.)	horsepower (U.S.)	0.9863
horsepower (U.S.)	kilowatts	0.7457	horsepower (U.S.)	horsepower (met.)	0.7355
kilowatts	horsepower (U.S.)	1.3405	horsepower (met.)	kilowatts	1.2598

ABBREVIATIONS

Abbreviations as used throughout this catalog are interpreted as follows:

A	AMPERE	BRK	BRAKE
A B S	ANTI-SKID BRAKE CTRL SYS	BRKR	BREAKER
AC	ALTERNATING CURRENT	BRKT	BRACKET
A/C	AIR CONDITIONER, ING	BRN	BROWN
ACC	ACCESSORY	BRT	BRIGHT
ACCEL	ACCELERATOR	BRZ	BRONZE
ACCUM	ACCUMULATOR	BSTR	BOOSTER
ACF	ALL COATED FABRIC	BTL	BOTTLE
A/CLNR	AIR CLEANER	BTM	BOTTOM
ACTR	ACTUATOR	BTN	BUTTON
ACV	AIR CONTROL VALVE	B/UP	BACK UP
ADJ	ADJUST. ADJ., ER	BUSH	BUSHING
ADJG	ADJUSTING	C	CLEAR
ADPTR	ADAPTOR	CAB	CABIN
AFCV	AIR FUEL CONTROL VALVE	CAP	CAPACITY
A/IN	AIR INLET	CAP/UP	CAPACITY UP
AIR SPLR	AIR SPOILER	CARB	CARBURETOR
AL	ALUMINUM	CARP	CARPET
ALT	ALTITUDE	CARR	CARRIER
ALTR	ALTERNATOR	CAS	CASSETTE
AL/WHL	ALUMINUM WHEEL	CBL	CABLE
AM	AMPLITUDE MODULATION	C/BRKR	CIRCUIT BREAKER
AMP	AMPERE	C/CASE	CRANKCASE
AMTR	AMMETER	CCF	CLOTH & COATED FABRIC
ANCH	ANCHOR	C/CONV	CATALYTIC CONVERTER
ANT	ANTENNA	C/FAN	COOLING FAN
ANTI-POLL	ANTI-POLLUTION	CHAS	CHASSIS
A/OUT	AIR OUTLET	CHG	CHANGE, ING
AR	AS REQUIRED	CHMBR	CHAMBER
A/REST	ARMREST	CHNL	CHANNEL
ARG	ARGENT	CHR	CHROME
A/RTL	ANTI-RATTLER	CK/SHAFT	CRANKSHAFT
ASC	AUTO SPEED CONTROL	CLINO	CLINO METER
A/SQK	ANTISQUEAK	CLNC	CLEARANCE
ASST	ASSIST. ING/ANT	CLNR	CLEANER
ASSY	ASSEMBLY	CLO	CLOTH
A/SUSP	AIR SUSPENSION	C/LP	COURTESY LAMP
AUD	AUDIO	CLR	COOLER
AUTO	AUTOMATIC	C/LTR	CIGAR OR CIGARETTE LIGHTER
AUTO. LOCK	AUTO DR LOCKING SYSTEM	C/MBR	CROSSMEMBER
AUTO T/A	AUTOMATIC TRANSAXLE	CMPTR	COMPUTER
AUTO T/M	AUTOMATIC TRANSMISSION	CNSL	CONSOLE
B	BRIGHT	COL	COLUMN
BATT	BATTERY	COMB	COMBINATION
BAV	BLEED AIR VALVE	COMP	COMPONENT
B/CRK	BELLCRANK	COMPL	COMPLETE
B/DISC	BRAKE DISC	COMPR	COMPRESSION/OR
B/DR	BACK DOOR	COND	CONDENSER
BGE	BEIGE	CONN	CONNECTOR
BJ	BIRFIELD UNIVERSAL JOINT	CONNG	CONNECTING
B/JNT	BALL JOINT	CONT	CONTROL
BK	BACK	CONV	CONVERTER
BKL	BUCKLE	COR	CORNER
BKT	BUCKET	CO/SHAFT	COUNTERSHAFT
BLA	BLACK	CPLG	COUPLING
BLK	BLACK	C/PLR	CENTER PILLAR
BLU	BLUE	C/ROD	CONNECTING ROD
BLWR	BLOWER	CRTG	CARTRIDGE
BMPR	BUMPER	CRU/CONT	CRUISE CONTROL
BRD	BOARD	CSTR	CLUSTER
BRG	BEARING	CTR	CENTER

ABBREVIATIONS (Cont'd.)

C/VAL	CONTROL VALVE	EVAP	EVAPORATION OR
CVR	COVER	EXC	EXCEPT
CYL	CYLINDER	EXCL	EXCLUDE
C/ZONE	COLD ZONE	EXH	EXHAUST
D	DARK	EXPN	EXPANSION
DBL	DOUBLE	EXT	EXTERIOR
DC	DIRECT CURRENT	EXTN	EXTENSION
D/CON	DIRECT CONTROL	FAB	FABRIC
D/CVR	DUST COVER	F/AXLE	FRONT AXLE
DECAL	DECALCOMANIA	FBC	FEED BACK CARBURETOR
DECOMP	DECOMPRESSION	F/CAP	FUEL CAP
DEFOG	DEFOGGER	FCL	FAN CLUTCH
DEFR	DEFROSTER	F/CPLG	FLUID COUPLING
DIA	DIAMETER	F/DR	FRONT DOOR
DIAPH	DIAPHRAGM	F/FIL	FUEL FILTER
DIE	DIESEL	F/FLR	FRONT FLOOR
DIFF	DIFFERENTIAL	F/GA	FUEL GAUGE
DIR	DIRECT	FIL	FILTER
DIS	DISTRIBUTOR	F/INJ	FUEL INJECTION
DISCH	DISCHARGE	FLEX	FLEXIBLE
D/LINK	DRAGLINK	FLG	FLANGE
DLX	DELUXE	FLR	FLOOR
DMPR	DAMPER	FM	FREQUENCY MODULATION
DOMC	DBL OVERHEAD CAMSHAFT	F/MLDG	FINISH MOULDING
DOJ	DOUBLE OFFSET JOINT	FNDR	FENDER
D/PINION	DRIVE PINION	F/PAN	FLOOR PAN
D/PROOF	DUST PROOF	F/PLR	FRONT PILLAR
DR	DOOR	F/PUMP	FUEL PUMP
DRL	DAY TIME RUNNING LIGHT	FR	FRONT
DRV	DRIVE	FRICT	FRICTION
D/SEAL	DUST SEAL	FRM	FRAME
D/SEAT	DRIVER SEAT	F/RST	FOOT REST
D/SHLD	DUST SHIELD	F/SEAT	FRONT SEAT
DSV	DECEL SOLENOID VALVE	FSTNR	FASTENER
D/SW	DIMMER SWITCH	FT	FOOT
ECI	ELECTRONIC CONTROL INJ	F/TANK	FUEL TANK
ECM	ELECTRONIC CONTROL ENGINE MOUNTING	FTG	FITTING
E/CON	ELECTRIC CONTROL	F/TOP	FOLDING TOP
ECS	ELECTRONIC CONTROL SUSPENSION	F/WHL	FLYWHEEL
EGR	EXHAUST GAS RECIRCULATION	GCC	GULF CORPORATED COUNCIL
E/HZ	EXTRA HOT ZONE	GA	GAUGE
ELC	ELECT CONTROL TRANS	GAL	GALLON
ELEC	ELECTRIC	GARN	GARNISH
ELEM	ELEMENT	GAS	GASOLINE
ELL	ELBOW	G/BOX	GLOVEBOX
ELP	EMERGENCY LOCKING RETRACTOR	GDE	GUIDE
ELTRC	ELECTRONIC	GEN	GENERATOR
EMERG	EMERGENCY	GLA	GLASS
EMIS	EMISSION	GLD	GOLD
ENG	ENGINE	GOV	GOVERNOR
EPS	ELECTRONIC CONTROL POWER STEERING	GR	GEAR
ESC	ESCUTCHEON	G/RATIO	GEAR RATIO
ESV	ENRICHMENT SOLENOID VALVE	GRD	GROUND
ETACS	ELECTRONIC TIME & ALARM CONTROL SYSTEM	GRL	GRILLE
ETR	ELECTRONIC TUNER	GRN	GREEN
		GROM	CROMMET
		GRY	GRAY
		G/SHIFT	GEARSHIFT
		GT	GRAND TOURING
		HAC	HIGH ALTITUDE COMPENSATOR
		HARN	HARNES

ABBREVIATIONS (Cont'd.)

H/BACK	HATCH BACK	LK/WA	LOCK WASHER
HOLE	HANDLE	LP	LAMP
H/DUTY	HEAVY DUTY	LPG	LIQUID PROPANE GAS
HGE	HINGE	LRG	LARGE
HGT	HEIGHT	LSD	LIMITED SLIP DIFFERENTIAL
HI	HIGH	LT	LEFT
HI/ALTI	HIGH ALTITUDE	LTR	LIGHTER
HLG	HALOGEN	LUGG	LUGGAGE
H/LIN	HEADLINING	LVL	LEVEL
H/LP	HEADLAMP	LVR	LEVER
H/LP WSHR	HEADLAMP WASHER	LW	LONG WAVE
HNGR	HANGER	LW/MW	LONG WAVE & MEDIUM WAVE
H/REST	HEAD RESTRAINT	LWR	LOWER
HSG	HOUSING	M	METALLIC
H/T	HIGH TENSION	M	MEDIUM
HTR	HEATER	MAN T/A	MANUAL TRANSAXLE
HVY	HEAVY	MAN T/M	MANUAL TRANSMISSION
HYD	HYDRAULIC	MAN	MANUAL
I/ZONE	HOT ZONE	MANF	MANIFOLD
I/ARM	IDLER ARM	MBR	MEMBER
IC	INTEGRATED CIRCUIT	MCV	MIXTURE CONTROL VALVE
I/CLR	INTER COOLER	M/CYL	MASTER CYLINDER
I/GEAR	IDLER GEAR	MED	MEDIUM
IGN	IGNITION	MIL	MILITARY
I/LP	INDICATOR LAMP	MIR	MIRROR
IN	INCH	MLDG	MOULDING
INCR/TANK	INCREASED TANK	MOD	MODEL
IND	INDICATOR	MODUL	MODULATOR
INJ	INJECTION, OR	MPH	MILES PER HOUR
INL	INLET	MPI	MULTI POINT INJECTION
INR	INNER	MPX	MULTIPLEX
INSP	INSPECTION	MRN	MAROON
INST	INSTRUMENT	MSS	MUSIC SELECT SENSOR
INSUL	INSULATION, OR	MT	MOUNT
INT	INTERIOR	MTG	MOUNTING
INTK	INTAKE	MTR	MOTOR
INTMT	INTERMITTENT	MUFF	MUFFLER
I/PNL	INSTRUMENT PANEL	M/V	MASTER VAC
I/PULL	IDLER PULLEY	MW	MEDIUM WAVE
I/PUMP	INJECTION PUMP	N	NATURAL
I/S	INSIDE	NA	NOT APPLICABLE
ISC	IDLE SPEED CONTROL	NIP	NIPPLE
IYO	IVORY	NO	NUMBER
JNT	JOINT	NORM	NORMAL
JSV	JET MIXTURE SOLENOID VALVE	NOZ	NOZZLE
(KUW)	KUWAIT	NS	NOT SERVICED
KM/H	KILOMETERS PER HOUR	NY	NYLON
L	LIGHT	O	OFF
LAV	LAVENDER	O/C	OIL COOLER
L/C	LOW COMPRESSION	O/D	OVER DRIVE
LCD	LIQUID CRYSTAL DISPLAY METER	O/GA	OIL GAUGE
LEA	LEATHER	O/H	OVERHAUL
L/F	LESS FINISH	OMC	OVERHEAD CAMSHAFT
LG	LENGTH	OHV	OVERHEAD VALVE
L/GLS	LESS GLASS	OLI	OLIVE
LH	LEFT HAND	OP	OPTION, AL
LHD	LEFT HAND DRIVE	OPNG	OPENING
LIC	LICENSE	OPT	OPTION, AL
LIN	LINING	O/PUMP	OIL PUMP
LK	LOCK	ORN	ORANGE
LKG	LOCKING	O/S	OUTSIDE

ABBREVIATIONS (Cont'd.)

O/SIZE	OVERSIZE	REPL	REPLACEABILITY
O/T	OVER TOP	RES	RESISTOR
OTR	OUTER	RET	RETAINER
OUTL	OUTLET	RETN	RETURN
PAR	PARCH	REV	REVERSE
PARTL	PARTIAL	RF	ROOF
PARTN	PARTITION	R/FLR	REAR FLOOR
PASS	PASSENGER	RH	RIGHT HAND
P/BTN	PUSH BUTTON	RHD	RIGHT HAND DRIVE
PCV	PURGE CONTROL VALVE	RHED	RHEOSTAT
PED	PEDAL	RJ	RZEPPA/UNIVERSAL JOINT
PK/BRK	PARKING BRAKE	RLY	RELAY
PKG	PACKAGE	R PART	REPLACEMENT PART
PKT	POCKET	R/PLR	REAR PILLAR
PLC	PLACE	RPM	REVOLUTIONS PER MINUTE
P/LP	PARKING LAMP	RPS	REVOLUTIONS PER SECOND
PLR	PILLAR	R/QTR	REAR QUARTER
PLSTC	PLASTIC	RR	REAR
PLT	PLATE	R/R	REFLEX REFLECTOR
PLTD	PLATED	R/SEAT	REAR SEAT
PLUNG	PLUNGER	R/SHAFT	REAR SHAFT
PNL	PANEL	R/SUSP	REAR SUSPENSION
PNT	PAINT	RSVR	RESERVOIR
PNTD	PAINTED	RT	RIGHT
POL	POINT ON LINE	R/WDO	REAR WINDOW
POLY	POLYESTER	R/WPR	REAR WIPER
PRESS	PRESSURE	S	SUM REQUIRED
P/ROD	PUSH ROD	S/	SOFT
PROP	PROPELLER	S/ABS	SHOCK ABSORBER
PROT	PROTECTOR	SAF	SAFETY
P R. PART	PERIODIC REPLACEMENT PART	S/BACK	SEAT BACK
PRPG/VAL	PROPORTIONING VALVE	S/BELT	SEAT BELT
P/S	POWER STEERING	S/CUSH	SEAT CUSHION
P/SEAT	PASSENGER SEAT	SD	SAND
PT	POINT	SEC. PART	SECURITY PART
PTO	POWER TAKE OFF	SECDY	SECONDARY
PUL	PULLEY	SEMI-M	SEMIMETALLIC
PUR	POLYURETHANE	SEP	SEPARATE
P/W	POWER WINDOW	S/GR	STEERING GEAR
PWR	POWER	SHFT	SHIFT
PTC	PAINT TO COLOR	SHLD	SHIELD
Q/GLOW	QUICK GLOW	SHLF	SHELF
Q/PNL	QUARTER PANEL	SHT	SHORT
QTP	QUARTER	SIA	SERVICED IN ASSY
Q/TRIM	QUARTER TRIM	SIG	SIGNAL
QTY	QUANTITY	S/K	SERVICED IN KIT
Q/WDO	QUARTER WINDOW	SIL	SILVER
RAD	RADIATOR	SIR	SERVICED IN ROLL
R/AXLE	REAR AXLE	SIS	SERVICED IN SET
R/CONT	REMOTE CONTROL	SK	SKIRT
R/DEFOG	REAR DEFOGGER	S/KNU	STEERING KNUCKLE
RDO	RADIO	SLDG	SLIDING
R/DR	REAR DOOR	S/LP	STOP LAMP
RE	RED	SM	SMALL
REC	RECEIVER	S/MKR	SIDE MARKER
RECL	RECLINING	S/METER	SPEEDOMETER
RED	REDUCTION	S/MRK	SIDE MARKER
REFL	REFLECTOR	SNSR	SENSOR
REG	REGULATOR	SOC	SOCKET
REINF	REINFORCEMENT	SOL	SOLENOID
REM	REMOTE	SPA	SPARE

ABBREVIATIONS (Cont'd.)

SPCR	SPACER	U.C.C.	UNDER CATALYTIC CONVERTER
SPD	SPEED	U/JNT	UNIVERSAL JOINT
SPG	SPRING	UND	UNDER
SPKR	SPEAKER	UPR	UPPER
SPL	SPECIAL	URP	UNIFIED REPAIR PANEL
SPLR	SPOILER	U/SIZE	UNDERSIZE
S/PNL	SIDE PANEL	UNIV	UNIVERSAL
SPRKT	SPROCKET	V	VOLT
SP/SHLD	SPLASH SHIELD	VAC	VACUUM
SQ	SQUARE	VAL	VALVE
S/R	SUNROOF	VENT	VENTILATION, OR
S/RAIL	SIDE RAIL	VL	VINYL LEATHER
S/S	SUNSHADE	VIO	VIOLET
S/SHLD	SIDE SHIELD	VOL	VOLUME
S/SILL	SIDE SILL	VNL	VINYL
S/STL	STAINLESS STEEL	VNTY	VANITY
ST	SEAT	V/REG	VOLTAGE REGULATOR
STA	STATION	VSS	VEHICLE SPEED SENSOR
STAB	STABILIZER	V/WING	VENT WING
STAT	STATIONARY	W	WATT
STD	STANDARD	W-	WARM
STL	STEEL	W/	WITH
STN	STONE	WA	WASHER
STRG	STEERING	WAT	WATER
STRKR	STRIKER	WB	WHEELBASE
STRNR	STRAINER	W/BRG	WHEEL BEARING
STRTR	STARTER	W-CAB	DOUBLE CABIN
STRUC	STRUCTURE	WD	WHEEL DRIVE
SUPT	SUPPORT	WDO	WINDOW
SUSP	SUSPENSION	WHL	WHEEL
SW	SWITCH	W/HSE	WHEELHOUSE
SW/MW	SHORT WAVE & MEDIUM WAVE	WHT	WHITE
SYNCH	SYNCHRONIZER	W/O	WITHOUT
SYS	SYSTEM	WPR	WIPER
T	THICKNESS	W/PUMP	WATER PUMP
TA	TAN	W/REG	WINDOW REGULATOR
T/A	TRANSAXLE	WRG	WRING
T/BAR	TORSION BAR	WRNG	WARNING
T/BELT	TIMING BELT	W/SHLD	WINDSHIELD
T/BS	TUBELESS	WSHR	WASHER
T/C	TURBOCHARGER	W/STRIP	WEATHERSTRIP
T/CONV	TORQUE CONVERTER	WT	WEIGHT
TEL	TELEPHONE	W/WPR	WINDSHIELD WIPER
TEMP	TEMPERATURE	W/WSHR	WINDSHIELD WASHER
TERM	TERMINAL	YEL	YELLOW
T/F	TRANSFER	YEL/HLG	YELLOW HALOGEN
T/GA	TEMPERATURE GAUGE	YR	YEAR
T/GATE	TAILGATE	ZN	ZINC
THERMO	THERMOSTAT	&	AND
THROT	THROTTLE	1ST	FIRST
TJ	TRIPOD UNIVERSAL JOINT	2ND	SECOND
TK	TANK	3RD	THIRD
T/LP	TAIL LAMP	4TH	FOURTH
T/M	TRANSMISSION	4WD	4 WHEEL DRIVE
T/METER	TACHOMETER	5TH	FIFTH
TORQ	TORQUE	6TH	SIXTH
T/PNL	TRIM PANEL	7TH	SEVENTH
TRLR	TRAILER	8TH	EIGHTH
T/SIG	TURN SIGNAL	9TH	NINTH
TSTR	TRANSISTOR	10TH	TENTH
T/THROUGH	TRUNK THROUGH		

GROUP 2 - FRONT SUSPENSION & DRIVE

ILLUSTRATION TITLE	GROUP-FIG. NO.
SUSPENSION, FRONT LASER-TALON	Fig. 2-100
ARM, LOWER, FRONT SUSPENSION LASER-TALON	Fig. 2-200
AXLE, FRONT FWD LASER-TALON	Fig. 2-300
AXLE, FRONT AWD LASER-TALON	Fig. 2-350

ILLUSTRATION NOT AVAILABLE AT TIME OF PUBLICATION

SUSPENSION, FRONT LASER-TALON
Figure 2-100

9602 100

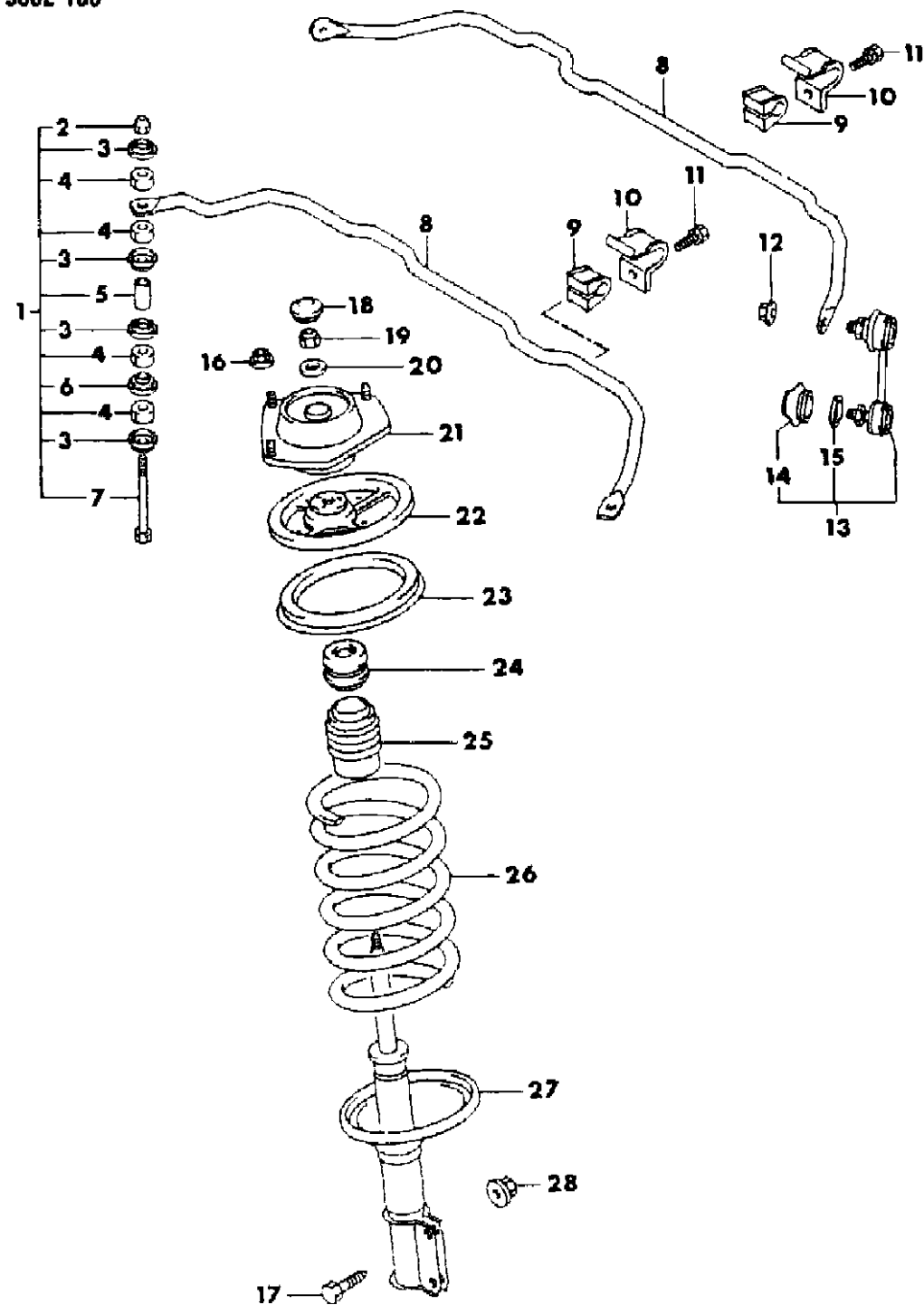

ITEM	PART NUMBER	QTY	BODY	MODEL	DESCRIPTION
1	MB24 1908	2			LINK PACKAGE, w/1.8L Eng.
2		2			NUT, (Serv. Pkg.), (10)
3		8			CUP, (Serv. Pkg.)
4		8			BUSHING, (Serv. Pkg.)
5		2			COLLAR, (Serv. Pkg.), (40)
6		2			CUP, (Serv. Pkg.)
7		2			BOLT, (Serv. Pkg.), (10x130)
8					BAR, Stabilizer
	MB51 8163	1			1.8L Eng., 1990-91, (17.3)
	MB57 3329	1			1.8L Eng., 1992-94, (16)
	MB51 8890	1			2.0L Eng., (19)
	MB57 3384	1		AWD	2.0L Eng., (20)
9					BUSHING, Stabilizer
	MB57 3207	2			1.8L Eng., 1990-91, (17.3)
	MB57 3327	2			1.8L Eng., 1992-94, (16)
	MB57 3054	2			2.0L Eng., (19)
	MB57 3385	2		AWD	2.0L Eng., (20)
10					BRACKET, Stabilizer
	MB57 3053	2			FWD
	MB57 3328	2			AWD
11	MF24 1278	2			BOLT, w/Washer, (10X16)
12					NUT, w/Washer
	MF44 5005	4			1.8L Eng. 1990-91
	MS44 0504	4			1.8L Eng. 1992-93
	MS44 0504	4			2.0L Eng. (10)
13	MB51 8892	2			LINK PACKAGE, w/2.0L Eng.
14	MB51 8785	4			COVER, Dust, w/2.0L Eng.
15	MB63 3060	4			RING, Dust Cover, w/2.0L Eng.
16	MF43 4105	6			NUT, (10)
17	MB51 8761	4			BOLT, (12X55)
18	MB57 3180	2			CAP, Strut Upper, (31.5)
19	MS44 0003	2			NUT, (12)
20	MA15 0669	2			WASHER, (12.5)
21	MB51 8141	2			INSULATOR, Strut
22	MB51 8147	2			SEAT, Upper Spring
23	MB51 8149	2			PAD, Upper Spring
24	MB34 9347	2			DAMPER, Strut
25	MB34 9346	2			COVER, Strut
26					SPRING, Front Suspension

ENGINE: P = 1800cc (1.8L) A = 2000cc (2.0L) Blank = All
 TRANS: A = Automatic M = Manual Blank = All
 SERIES: H = High M = Medium P = Premium S = Special

MODELS:
 24 FWD = 2Dr Hatchback (Laser)
 24 FWD = 2-Dr Hatchback (Talon)
 4WD = (4 Wheel Drive)
 2WD = (2 Wheel Drive)

AR = Use as Required - = Non Illustrated Part P.A.R. = Paint as Required

SUSPENSION, FRONT LASER-TALON
Figure 2-100

9602 100

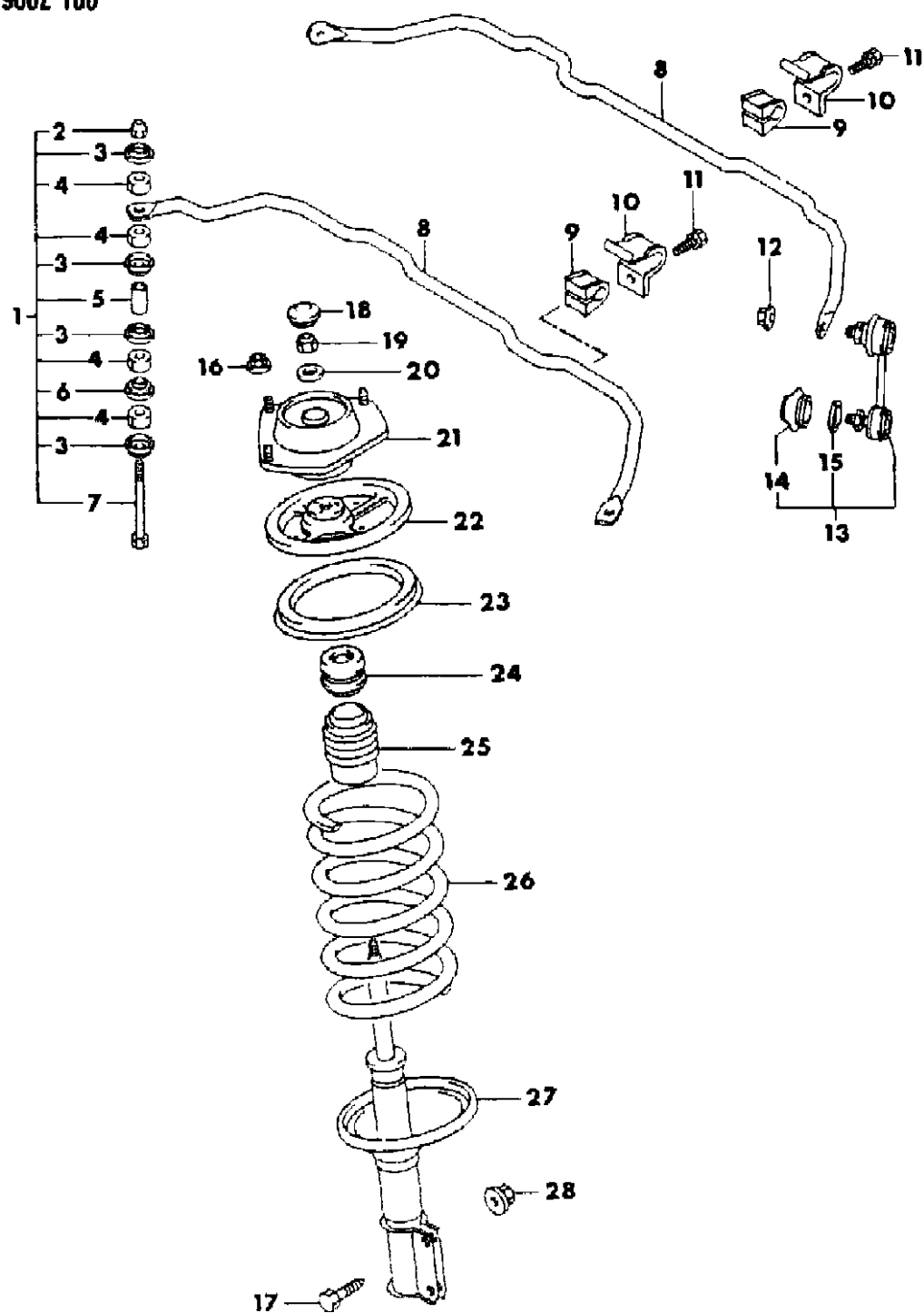

ITEM	PART NUMBER	QTY	BODY	MODEL	DESCRIPTION
	MB51 8294	2			1.8L Eng., w/Man. Trans.
	MB51 8295	2			1.8L Eng., w/Auto Trans.
	MB51 8296	2			2.0L Eng., w/Man. Trans., w/o Turbo
	MB51 8297	2			2.0L Eng., w/Auto Trans., w/o Turbo
	MB51 8297	2			2.0L Eng., w/Man. Trans., w/Turbo
	MB63 3260	2			2.0L Eng., w/Auto Trans., w/Turbo
	MB51 8677	2	AWD		2.0L Eng., w/Man. Trans. 1991-94
	MB51 8678	2	AWD		2.0L Eng., w/Auto Trans. 1991-94
27					STRUT, Front Suspension
	MB51 8290	2			1990
	MB67 2066	2			1991
	MB67 2057	2			1992-94, w/o Turbo
	MB67 2066	2			1992-94, w/o Turbo, w/ABS
	MB89 2683	2			1992-94, w/Turbo
	MB89 2685	2			1993-94, w/Turbo, w/ABS
	MB51 8292	2	AWD		1990
	MB67 2067	2	AWD		1991
	MB67 2058	2	AWD		1992
	MB67 2067	2	AWD		1992, w/ABS
	MB89 2684	2	AWD		1993
	MB89 2686	2	AWD		1993, w/ABS
	MR13 0020	2	AWD		1994, w/Turbo
28	MB57 3720	4			NUT

ENGINE: P = 1800cc (1.8L) A = 2000cc (2.0L) Blank = All
 TRANS: A = Automatic M = Manual Blank = All
 SERIES: H = High M = Medium P = Premium S = Special

MODELS:
 24 FWD = 2Dr Hatchback (Laser)
 24 FWD = 2-Dr Hatchback (Talon)
 4WD = (4 Wheel Drive)
 2WD = (2 Wheel Drive)

AR = Use as Required - = Non Illustrated Part P.A.R. = Paint as Required

ARM, LOWER, FRONT SUSPENSION LASER-TALON

Figure 2-200

9602 200A

ITEM	PART NUMBER	QTY	BODY	MODEL	DESCRIPTION
1	MS45 0044	2			WASHER, (12)
2	MU43 0003	2			NUT, (12)
3	MB30 3751	2			STOPPER, Lower Arm Bolt
4	MB51 8018	2			STOPPER, Lower Arm Bolt
5	MB24 2334	2			BOLT, (12X135)
6	MS44 0003	2			NUT, (12)
7					ARM, Lower
	MB51 8205	1			Lt. w/1.8L Eng.
	MB51 8206	1			Rt. w/1.8L Eng.
	MB57 3095	1			Lt. w/2.0L Eng.
	MB57 3096	1			Rt. w/2.0L Eng.
8	MB17 6047	2			COVER, Dust
9					BUSHING, Lower Arm
	MB51 8220	1			1.8L Eng. (52)
	MB51 8221	2			2.0L Eng. (60)

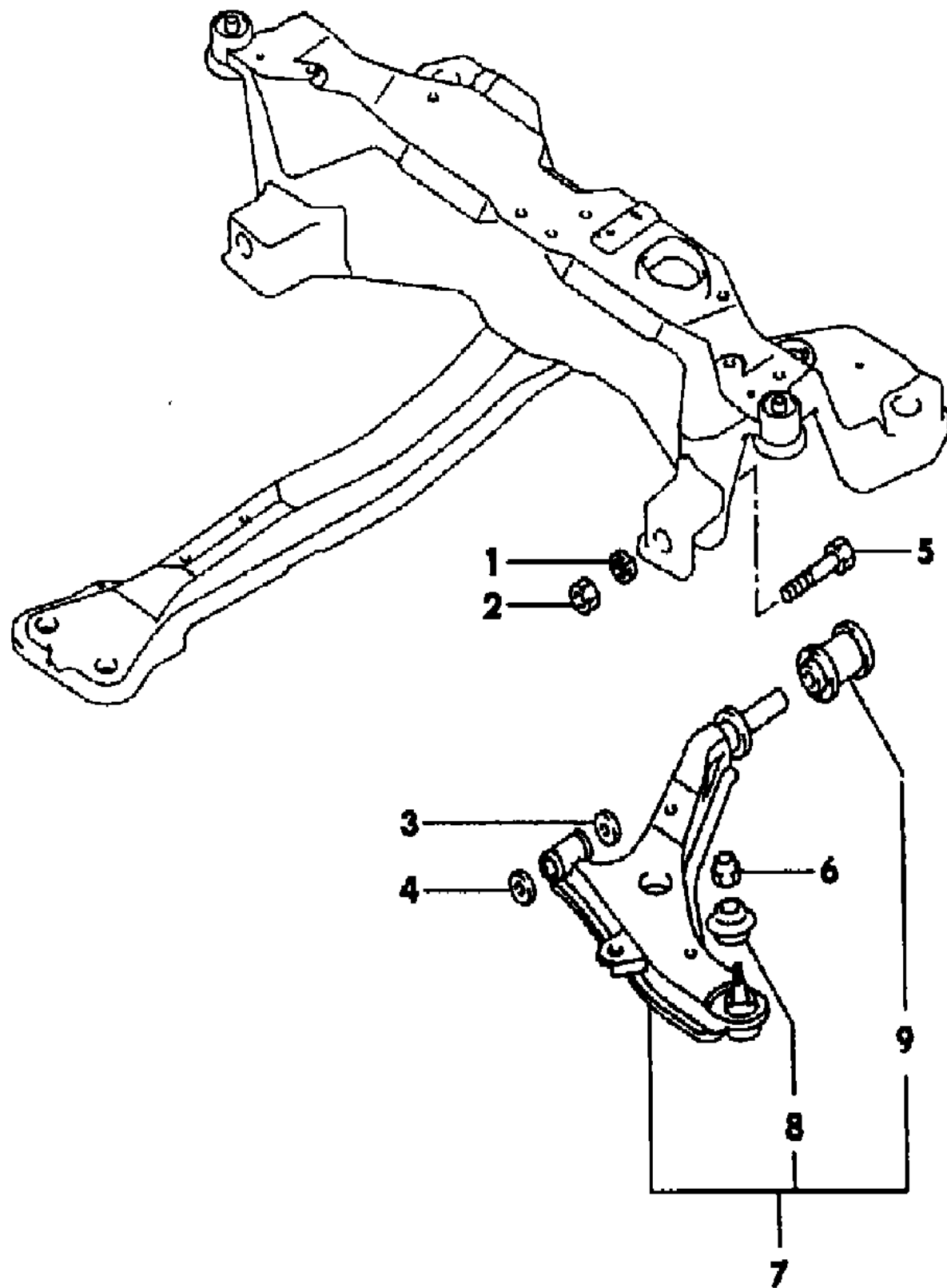

ENGINE: P = 1800cc (1.8L) A = 2000cc (2.0L) Blank = All
 TRANS: A = Automatic M = Manual Blank = All
 SERIES: H = High M = Medium P = Premium S = Special

MODELS:
 24 FWD = 2Dr Hatchback (Laser)
 24 FWD = 2-Dr Hatchback (Talon)
 4WD = (4 Wheel Drive)
 2WD = (2 Wheel Drive)

AR = Use as Required - = Non Illustrated Part P.A.R. = Paint as Required

AXLE, FRONT FWD LASER-TALON

Figure 2-300

9602 300A

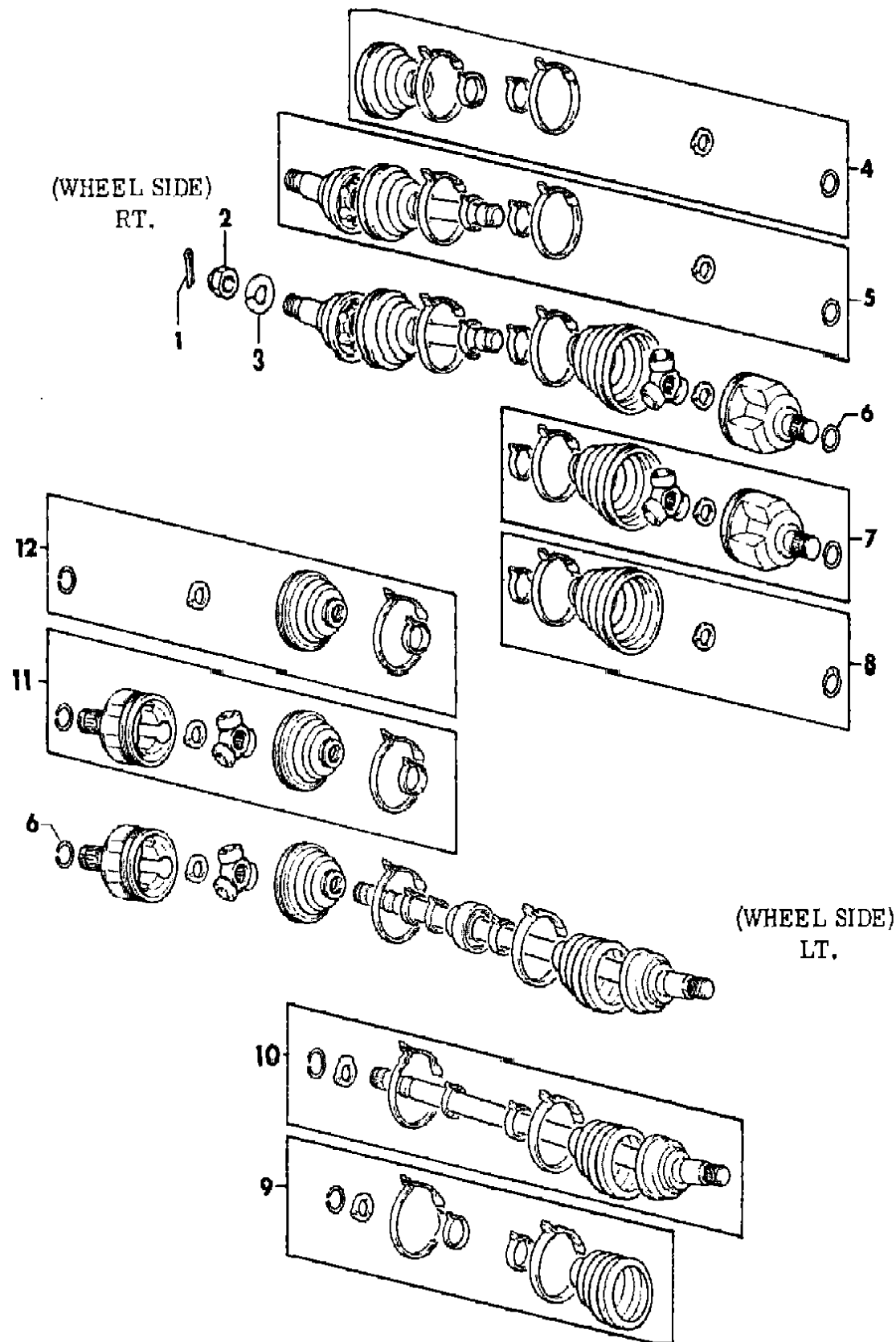

ITEM	PART NUMBER	QTY	BODY	MODEL	DESCRIPTION
1-12					AXLE SHAFT, Assy. ***
					LEFT ***
	MB29 7987	1			1.8L Eng. 1990-91
	MB29 7991	1	LASER		1.8L Eng. 1992
	MB29 7987	1			1.8L Eng. (BJ),(TJ) 1993-94
	MB29 7991	1			1.8L Eng. (RJ),(TJ) 1993-94
					RIGHT ***
	MB52 6438	1			1.8L Eng. 1990-91
	MB29 7992	1	LASER		1.8L Eng. 1992
	MB52 6438	1			1.8L Eng. (BJ),(TJ) 1993-94
	MB29 7992	1			1.8L Eng. (RJ),(TJ) 1993-94
					LEFT ***
	MB52 6101	1			2.0L Eng. w/o Turbo 1990-92
	MB29 7871	1			2.0L Eng. w/Man. Trans w/Turbo 1990-92
	MB62 0611	1			2.0L Eng. w/Auto Trans w/Turbo 1990-92
	MB29 7871	1			2.0L Eng. w/o Turbo 1993-94
	MB88 6799	1			2.0L Eng. w/Man. Trans w/Turbo 1993-94
	MB88 6801	1			2.0L Eng. w/Auto Trans w/Turbo 1993-94
					RIGHT ***
	MB29 7872	1			2.0L Eng. w/Man. Trans w/o Turbo 1990-92
	MB62 0612	1			2.0L Eng. w/Auto Trans w/o Turbo 1990-92
	MB29 7872	1			2.0L Eng. w/Turbo 1990-92
	MB29 7872	1			2.0L Eng. w/o Turbo 1993-94
	MB88 6798	1			2.0L Eng. w/Man. Trans w/Turbo 1993-94
	MB88 6800	1			2.0L Eng. w/Auto Trans w/Turbo 1993-94
1	MF47 2087	2			PIN, (4X40)
2	MB10 9029	2			NUT, Front Axle
3	MB10 9025	2			WASHER
4					BOOT PACKAGE, Outer Rt.
	MB62 0240	1			1.8L Eng. 1990-91
	MB62 0168	1	LASER		1.8L Eng. 1992
	MB62 0240	1			1.8L Eng. (BJ) 1993-94
	MB62 0168	1			1.8L Eng. (RJ) 1993-94
	MB52 6905	1			2.0L Eng. (BJ) 1990-91
	MB52 6905	1			2.0L Eng. w/o Turbo (BJ) 1993-94
	MR11 0011	1			2.0L Eng. w/Turbo (BJ) 1993-94
	MB62 0168	1			2.0L Eng. w/Turbo (RJ) 1993
5					JOINT and SHAFT PKG, Outer, Rt. ***
	MB52 6914	1			1.8L Eng., 1990-91

ENGINE: P = 1800cc (1.8L) A = 2000cc (2.0L) Blank = All
 TRANS: A = Automatic M = Manual Blank = All
 SERIES: H = High M = Medium P = Premium S = Special

MODELS:
 24 FWD = 2Dr Hatchback (Laser)
 24 FWD = 2-Dr Hatchback (Talon)
 4WD = (4 Wheel Drive)
 2WD = (2 Wheel Drive)

AR = Use as Required - = Non Illustrated Part P.A.R. = Paint as Required

AXLE, FRONT FWD LASER-TALON

Figure 2-300

9602 300A

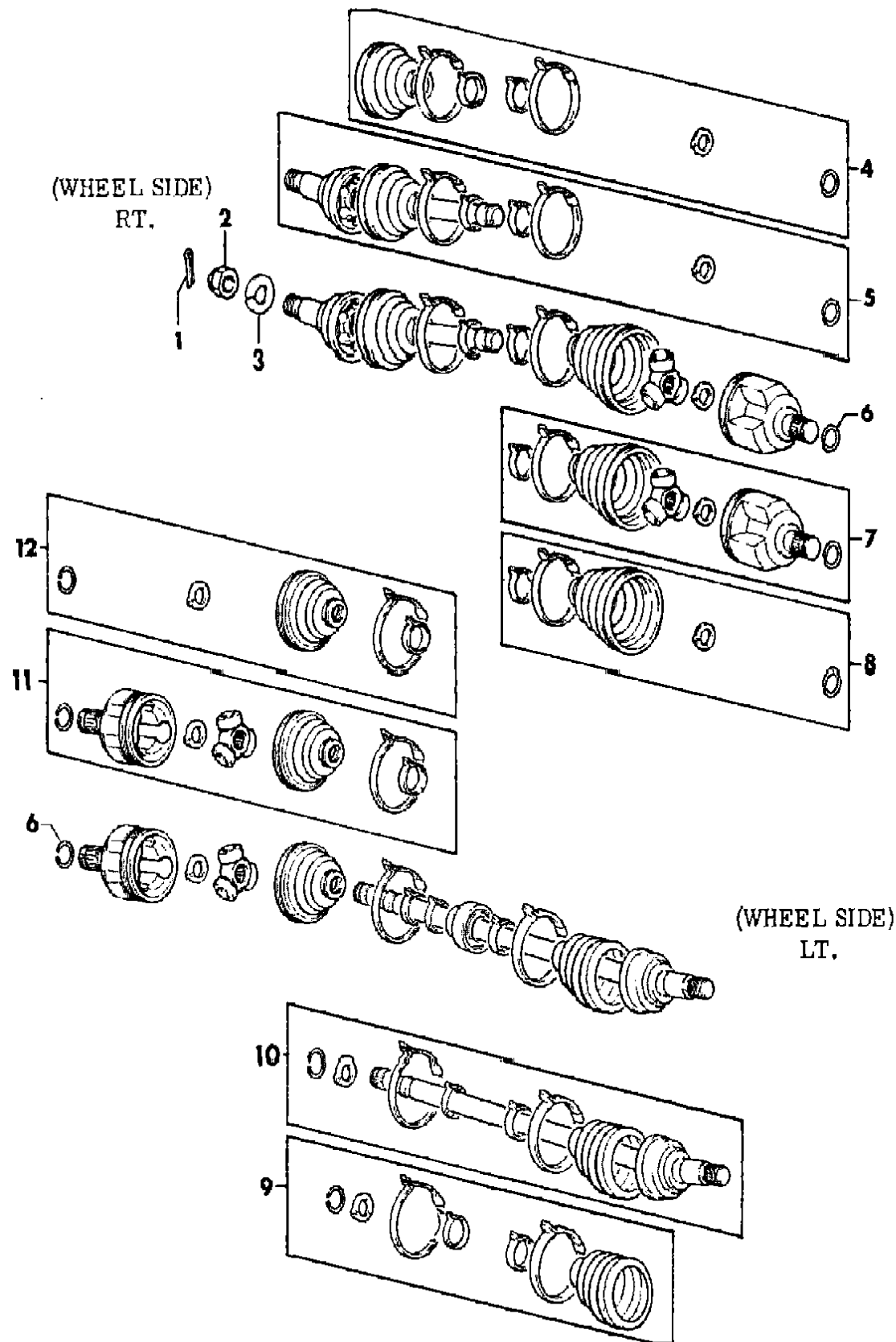

ITEM	PART NUMBER	QTY	BODY	MODEL	DESCRIPTION
	MB52 6974	1			1.8L Eng., 1992, (BJ)
	MB52 6973	1			1.8L Eng., 1992, (RJ)
	MB52 6914	1			1.8L Eng., 1993-94, (BJ)
	MB52 6973	1			1.8L Eng., 1993-94, (RJ)
	MB52 6909	1			2.0L Eng., w/Turbo, 1990
	MB52 6909	1			2.0L Eng., w/o Turbo, 1991-92
	MB52 6909	1	H,P		2.0L Eng., w/Turbo, w/Man. Trans., 1991-92
	MB83 7374	1	H,P		2.0L Eng., w/Turbo, w/Auto Trans., 1991-92
	MB52 6909	1			2.0L Eng., w/o Turbo, 1993
	MB52 6914	1			2.0L Eng., w/Turbo, w/Man. Trans., 1993
	MB83 7164	1			2.0L Eng., w/Turbo, w/Auto Trans., 1993
	MB52 6909	1			2.0L Eng., w/FWD, w/o Turbo, 1994
	MR11 0007	1			2.0L Eng., w/FWD, w/Turbo, w/Man. Trans., 1994
	MR11 0009	1			2.0L Eng., w/FWD, w/Turbo, w/Auto Trans., 1994
	MB52 6914	1	H,S		2.0L Eng., w/AWD, w/Man. Trans., (BJ), 1994
	MB52 6973	1	S		2.0L Eng., w/AWD, w/Man. Trans., (RJ), 1994
	MB83 7164	1	H,S		2.0L Eng., w/AWD, w/Auto Trans., 1994
6					CLIP
	MB16 0387	2			1990-92
	MB29 7844	2	LASER		1.8L Eng. 1992
	MB29 7844	2			1.8L Eng. (BJ) 1993-94
	MB16 0387	2			1.8L Eng. (RJ) 1993-94
	MB16 0387	2			2.0L Eng. w/o Turbo 1993-94
	MB62 0144	2			2.0L Eng. w/Turbo 1993-94
7					JOINT PACKAGE, Inner Rt.
	MB52 6892	1			1.8L Eng. 1990-91
	MB52 6975	1	LASER		1.8L Eng. 1992
	MB52 6892	1			1.8L Eng. (BJ),(TJ) 1993-94
	MB52 6975	1			1.8L Eng. (RJ),(TJ) 1993-94
	MB52 6919	1			2.0L Eng. w/Man. Trans 1990-92
	MB83 7375	1			2.0L Eng. w/Auto Trans 1990-92
	MR11 0012	1			2.0L Eng. w/o Turbo 1993
	MB52 6919	1			2.0L Eng. w/o Turbo 1994
	MB52 6975	1			2.0L Eng. w/Turbo w/Man. Trans (TJ) 1993
	MB52 6892	1			2.0L Eng. w/Turbo w/Man. Trans (TJ) 1993
	MB83 7166	1			2.0L Eng. w/Turbo w/Auto Trans 1993
	MR11 0012	1			2.0L Eng. w/Turbo (TJ) 1994
8					BOOT PACKAGE, Inner Rt.
	MB52 6894	1			1.8L Eng. 1990-91

ENGINE: P = 1800cc (1.8L) A = 2000cc (2.0L) Blank = All
 TRANS: A = Automatic M = Manual Blank = All
 SERIES: H = High M = Medium P = Premium S = Special

MODELS:
 24 FWD = 2Dr Hatchback (Laser)
 24 FWD = 2-Dr Hatchback (Talon)
 4WD = (4 Wheel Drive)
 2WD = (2 Wheel Drive)

AR = Use as Required - = Non Illustrated Part P.A.R. = Paint as Required

AXLE, FRONT FWD LASER-TALON

Figure 2-300

9602 300A

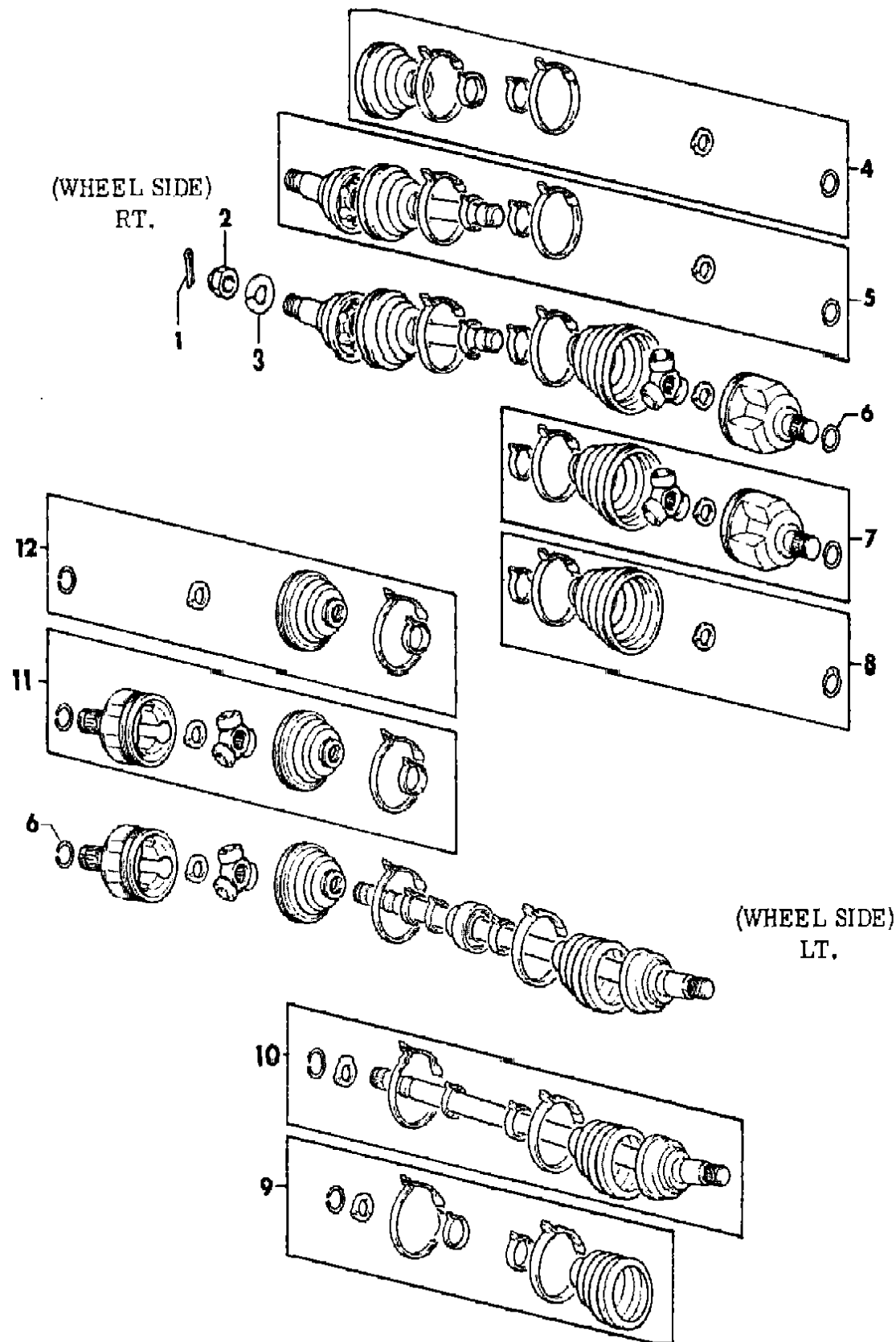

ITEM	PART NUMBER	QTY	BODY	MODEL	DESCRIPTION
	MB52 6977	1		LASER	1.8L Eng. 1992
	MB52 6894	1			1.8L Eng. (TJ) 1993-94
	MB52 6977	1			1.8L Eng. (TJ) 1993-94
	MB52 6907	1			2.0L Eng. 1990-92
	MB52 6907	1			2.0L Eng. w/o Turbo 1993-94
	MB52 6894	1			2.0L Eng. w/Turbo (BJ) 1993
9	MR11 0013	1			2.0L Eng. w/Turbo (RJ) 1993-94
					BOOT PACKAGE, Outer Lt.
	MB62 0240	1			1.8L Eng. 1990-91
	MB62 0168	1		LASER	1.8L Eng. 1992
	MB62 0240	1			1.8L Eng. (BJ) 1993-94
	MB62 0168	1			1.8L Eng. (RJ) 1993-94
	MB52 6905	1			2.0L Eng. 1990-92
	MR11 0011	1			2.0L Eng. 1993
	MB52 6905	1			2.0L Eng. w/o Turbo (BJ) 1994
	MR11 0011	1			2.0L Eng. w/Turbo (BJ) 1994
10					JOINT And SHAFT PACKAGE, Outer Lt. ***
	MB62 0363	1			1.8L Eng. 1990-91
	MB52 6972	1		LASER	1.8L Eng. 1992
	MB62 0363	1			1.8L Eng. (BJ) 1993-94
	MB52 6972	1			1.8L Eng. (RJ) 1993-94
	MB52 6908	1			2.0L w/o Turbo Eng. 1990-94
	MB62 0362	1			2.0L w/Turbo Eng. w/Man. Trans 1990-92
	MB83 7373	1			2.0L w/Turbo Eng. w/Auto Trans 1990-92
	MR11 0008	1			2.0L w/Turbo Eng. w/Man. Trans (BJ) 1993-94
	MB52 6972	1			2.0L w/Turbo Eng. w/Man. Trans (RJ) 1993
	MR11 0010	1			2.0L w/Turbo Eng. w/Auto Trans 1993-94
11					JOINT PACKAGE, Inner Lt.
	MB52 6892	1			1.8L Eng. 1990-91
	MB52 6975	1		LASER	1.8L Eng. 1992
	MB52 6892	1			1.8L Eng. (TJ) 1993-94
	MB52 6975	1			1.8L Eng. (TJ) 1993-94
	MB52 6919	1			2.0L Eng. 1990-93
	MR11 0012	1			2.0L Eng. w/o Turbo 1993
	MB52 6919	1			2.0L Eng. w/o Turbo (TJ) 1994
	MB52 6915	1			2.0L Eng. w/Turbo w/Man. Trans (BJ) 1993
	MB52 6975	1			2.0L Eng. w/Turbo w/Man. Trans (RJ) 1993
	MB83 7165	1			2.0L Eng. w/Turbo w/Auto Trans 1993
	MR11 0012	1			2.0L Eng. w/Turbo (TJ) 1994

ENGINE: P = 1800cc (1.8L) A = 2000cc (2.0L) Blank = All
 TRANS: A = Automatic M = Manual Blank = All
 SERIES: H = High M = Medium P = Premium S = Special

MODELS:
 24 FWD = 2Dr Hatchback (Laser)
 24 FWD = 2-Dr Hatchback (Talon)
 4WD = (4 Wheel Drive)
 2WD = (2 Wheel Drive)

AR = Use as Required - = Non Illustrated Part P.A.R. = Paint as Required

AXLE, FRONT FWD LASER-TALON

Figure 2-300

9602 300A

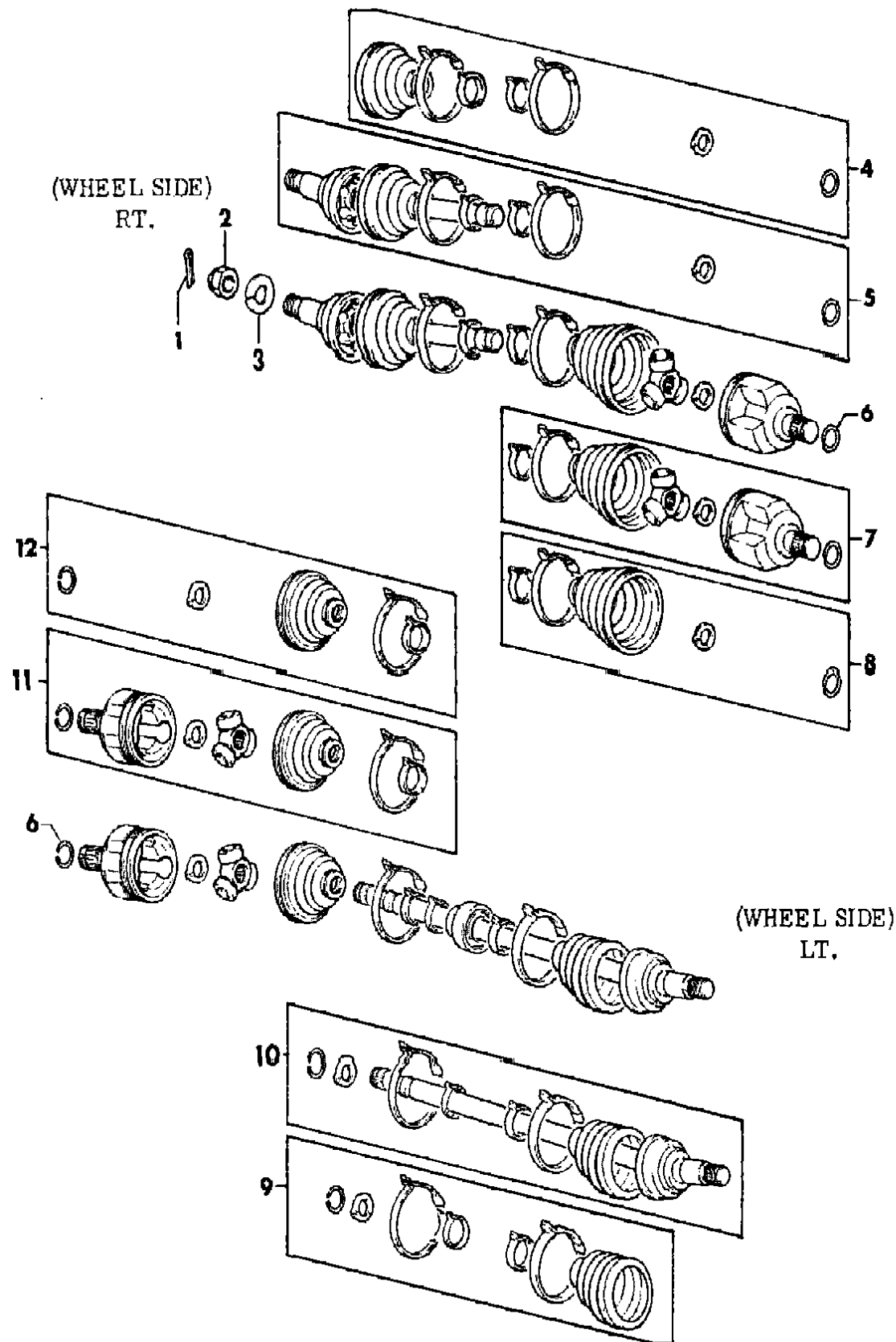

ITEM	PART NUMBER	QTY	BODY	MODEL	DESCRIPTION
12					BOOT PACKAGE, Inner Lt.
	MB52 6894	1			1.8L Eng. 1990-91
	MB52 6977	1	LASER		1.8L Eng. 1992
	MB52 6894	1			1.8L Eng. (TJ) 1993-94
	MB52 6977	1			1.8L Eng. (TJ) 1993-94
	MB52 6907	1			2.0L Eng. 1990-92
	MB52 6977	1			2.0L Eng. w/o Turbo 1993
	MB52 6907	1			2.0L Eng. w/o Turbo (TJ) 1994
	MR11 0013	1			2.0L Eng. w/Turbo 1993-94

ENGINE: P = 1800cc (1.8L) A = 2000cc (2.0L) Blank = All
 TRANS: A = Automatic M = Manual Blank = All
 SERIES: H = High M = Medium P = Premium S = Special

MODELS:
 24 FWD = 2Dr Hatchback (Laser)
 24 FWD = 2-Dr Hatchback (Talon)
 4WD = (4 Wheel Drive)
 2WD = (2 Wheel Drive)

AR = Use as Required - = Non Illustrated Part P.A.R. = Paint as Required

AXLE, FRONT AWD LASER-TALON

Figure 2-350

9602 350

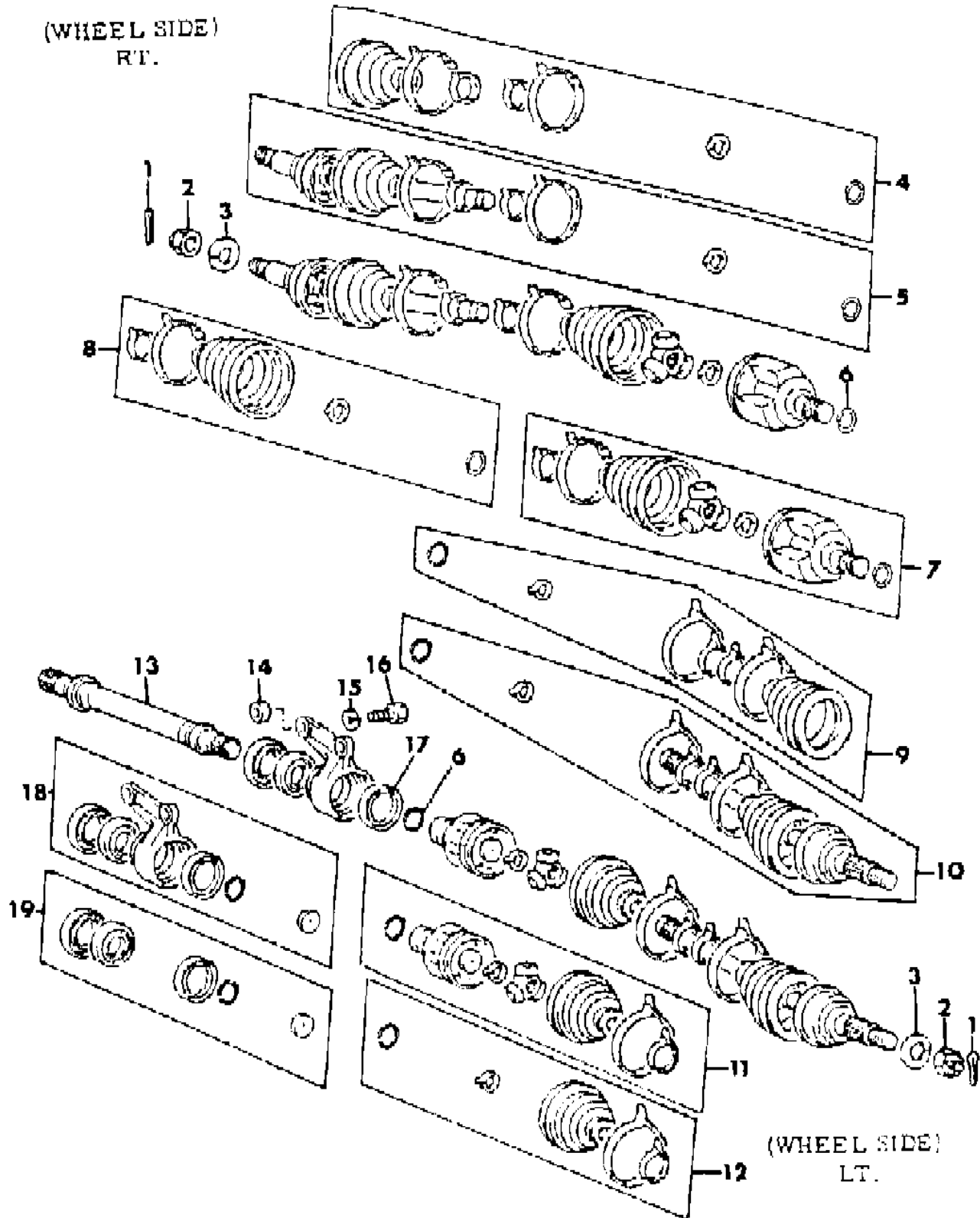

ITEM	PART NUMBER	QTY	BODY	MODEL	DESCRIPTION
1-12					AXLE SHAFT, Assy. ***
	MB29 7992	1			Rt. w/Man. Trans. (RJ), 1992-93
	MB29 7992	1	TALON		Rt. (RJ), 1994
	MB52 6438	1			Rt. w/Man. Trans. (BJ)
	MB62 0314	1			Rt. w/Auto Trans. (BJ),(TJ)
	MB52 6437	1			Lt. w/Man. Trans. (BJ),(TJ)
	MB29 7991	1			Lt. w/Man. Trans. (RJ),(TJ) 1992-93
	MB62 0313	1			Lt. w/Auto Trans. (BJ),<TJ)
1	MF47 2087	AR			PIN, (4X40)
2	MB10 9029	2			NUT, (22)
3	MB10 9025	2			WASHER, (22.4)
4					BOOT PACKAGE, Rt.
	MB62 0240	1			(BJ)
	MB62 0168	1			(RJ), 1992-93
	MB62 0168	1	TALON		(RJ), 1994
5					JOINT and SHAFT PACKAGE, Rt.
	MB52 6914	1			w/Man. Trans. (BJ)
	MB52 6973	1			w/Man. Trans. (RJ), 1992-93
	MB52 6973	1	TALON		(RJ), 1994
	MB83 7164	1			w/Auto Trans. (BJ)
6					CLIP
	MB16 0387	2			(27)
	MB29 7844	2			w/Auto Trans., 1992-93, (27.2)
	MB29 7844	1	TALON		(RJ), 1994, (27.2)
	MB52 6340	1			(BJ), 1994, (27)
7					JOINT PACKAGE, Rt.
	MB52 6892	1			w/Man. Trans. (TJ)
	MB52 6975	1			w/Man. Trans. (tJ), 1992-93
	MB52 6975	1	TALON		(RJ), 1994
	MB83 7166	1			Auto Trans. <TJ)
8					BOOT PACKAGE, Rt.
	MB52 6894	1			(TJ)
	MB52 6977	1	TALON		(RJ), 1994
9					BOOT PACKAGE, Lt.
	MB62 0240	1			(BJ) ***
10					JOINT and SHAFT PACKAGE, Lt.
	MB52 6914	1			w/Man. Trans. (BJ)
	MB83 7163	1			w/Auto Trans. <BJ)
11					JOINT PACKAGE, Lt.

ENGINE: P = 1800cc (1.8L) A = 2000cc (2.0L) Blank = All
 TRANS: A = Automatic M = Manual Blank = All
 SERIES: H = High M = Medium P = Premium S = Special

MODELS:
 24 FWD = 2Dr Hatchback (Laser)
 24 FWD = 2-Dr Hatchback (Talon)
 4WD = (4 Wheel Drive)
 2WD = (2 Wheel Drive)

AR = Use as Required - = Non Illustrated Part P.A.R. = Paint as Required

AXLE, FRONT AWD LASER-TALON

Figure 2-350

9602 350

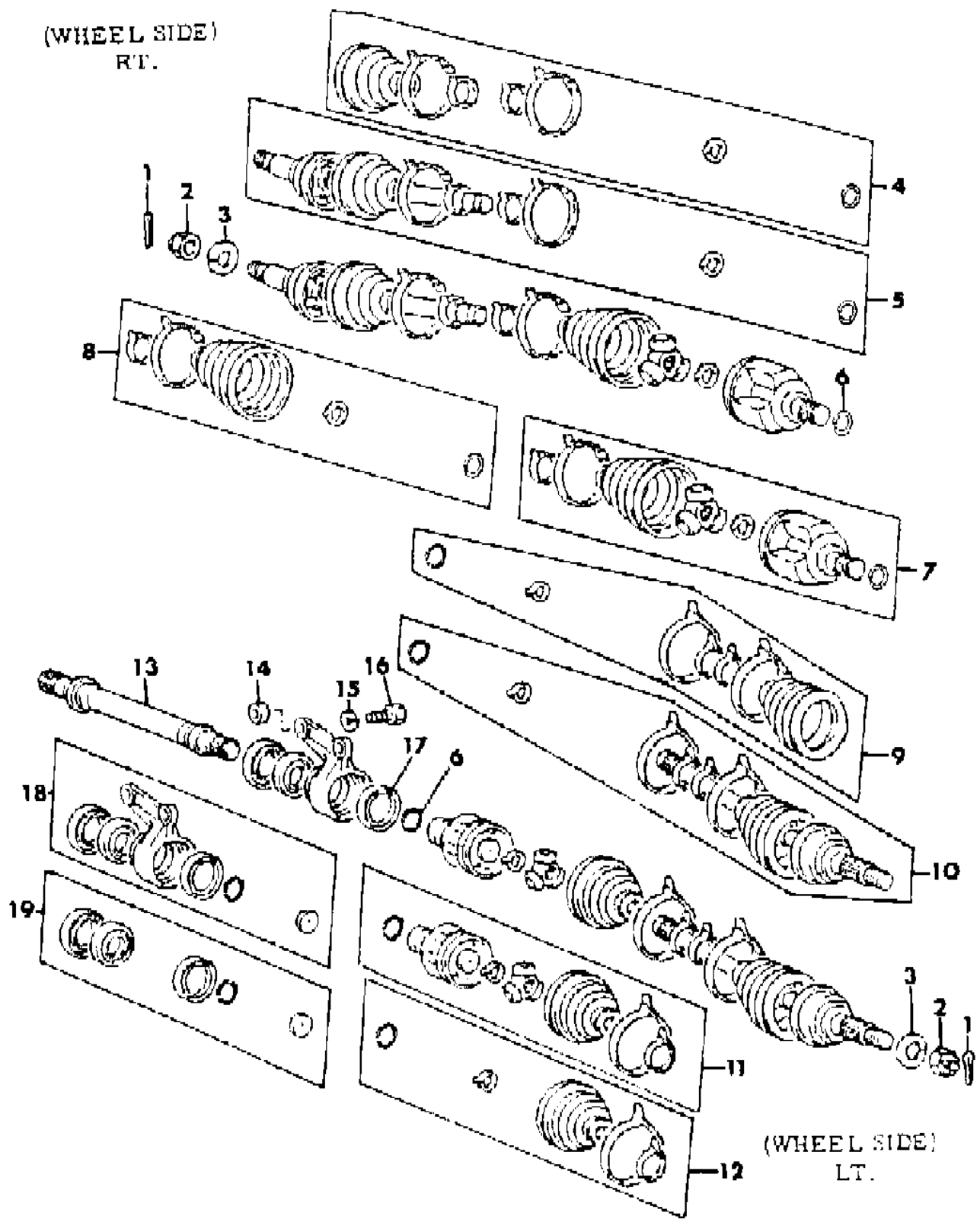

ITEM	PART NUMBER	QTY	BODY	MODEL	DESCRIPTION
	MB52 6915	1			w/Man. Trans. (TJ)
	MB83 7165	1			w/Auto Trans. (TJ)
12	MB52 6894	1			BOOT PACKAGE, Lt.
13	MB52 6845	1			SHAFT, Inner
14	MB29 7732	1			SPACER, (13)
15	MF45 0406	2			WASHER, (10)
16	MB29 7860	2			BOLT, (10X41.5)
17	MB52 6535	1			SEAL, Dust
18					BRACKET PACKAGE
	MB52 6981	1			w/Man. Trans.
	MB62 0417	1			w/Auto Trans.
19	MB52 6956	1			BEARING PACKAGE

ENGINE: P = 1800cc (1.8L) A = 2000cc (2.0L) Blank = All
 TRANS: A = Automatic M = Manual Blank = All
 SERIES: H = High M = Medium P = Premium S = Special

MODELS:
 24 FWD = 2Dr Hatchback (Laser)
 24 FWD = 2-Dr Hatchback (Talon)
 4WD = (4 Wheel Drive)
 2WD = (2 Wheel Drive)

AR = Use as Required - = Non Illustrated Part P.A.R. = Paint as Required

GROUP 3 - REAR AXLE

ILLUSTRATION TITLE	GROUP-FIG. NO.
REAR AXLE HOUSING AND SHAFT LASER-TALON	Fig. 3-100
REAR AXLE DIFFERENTIAL W/O LIMITED SLIP TALON	Fig. 3-200
REAR AXLE DIFFERENTIAL W/LIMITED SLIP LASER-TALON	Fig. 3-250
REAR AXLE DRIVE SHAFT LASER-TALON	Fig. 3-300

ILLUSTRATION NOT AVAILABLE AT TIME OF PUBLICATION

REAR AXLE HOUSING AND SHAFT LASER-TALON

Figure 3-100

9603 100 A

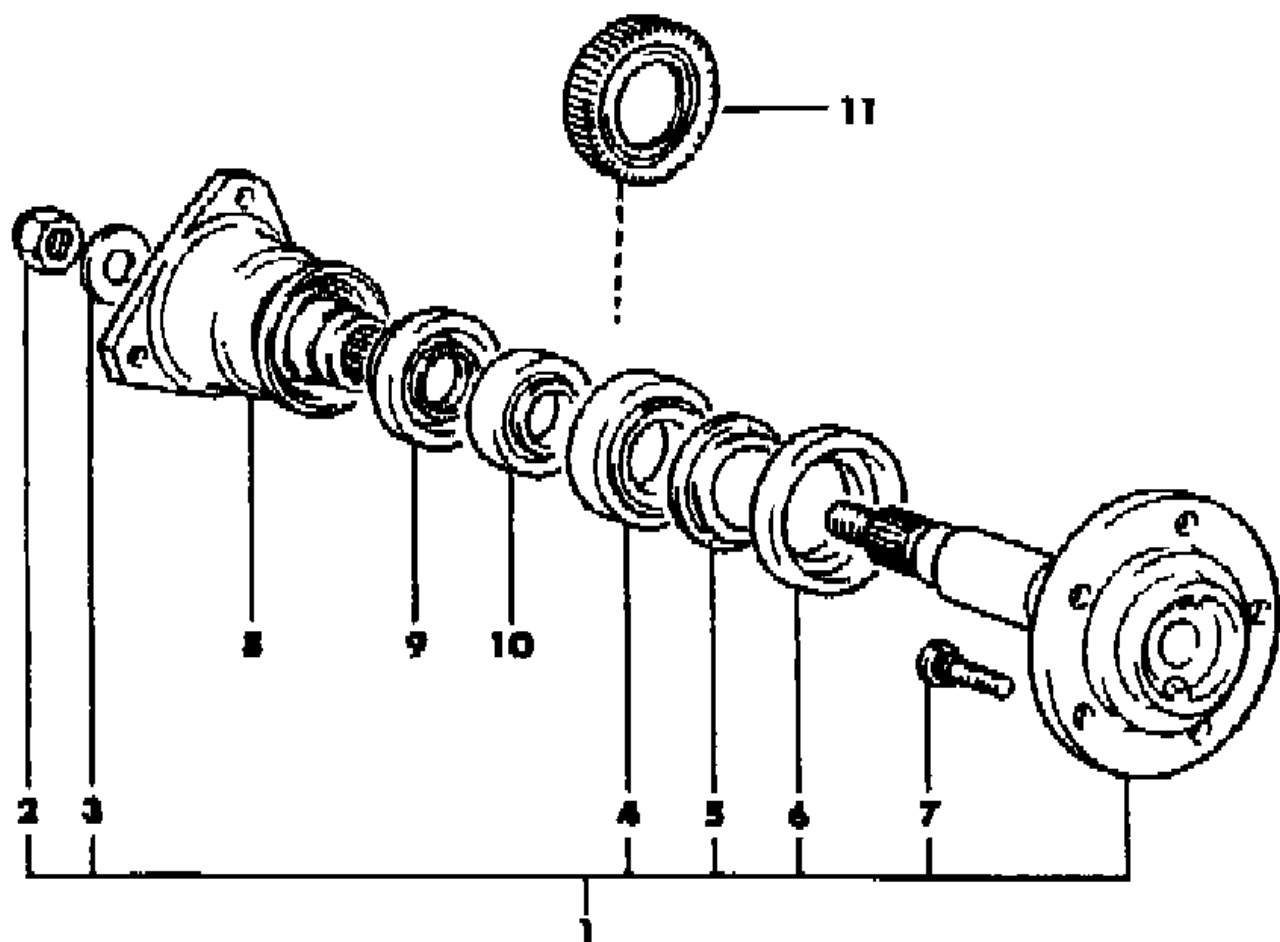

ITEM	PART NUMBER	QTY	BODY	MODEL	DESCRIPTION
1					SHAFT ASSY, Rear Axle ***
	MB56 9255	1			w/o ABS
	MB66 4332	1			w/ABS
2	MA14 3517	2			NUT
3	MT20 3641	2			WASHER, (18.5)
4	MB56 9972	2			BEARING, Outer
5	MB29 0428	2			COVER, Dust
6	MB39 3803	2			COVER, Dust
7	MA12 3234	10			BOLT, (12x41)
8					FLANGE, Rear Differential Companion
	MB39 3808	2			1990-91
	MB56 9618	2			1992-94
9	MB39 3807	2			SEAL, Dust, Inner Bearing
10	MT19 1613	2			BEARING, (Ball)
11	MB66 8573	2			ROTOR, w/ABS ***

ENGINE: P = 1800cc (1.8L) A = 2000cc (2.0L) Blank = All
 TRANS: A = Automatic M = Manual Blank = All
 SERIES: H = High M = Medium P = Premium S = Special

MODELS:
 24 FWD = 2Dr Hatchback (Laser)
 24 FWD = 2-Dr Hatchback (Talon)
 4WD = (4 Wheel Drive)
 2WD = (2 Wheel Drive)

AR = Use as Required - = Non Illustrated Part P.A.R. = Paint as Required

9603 200A

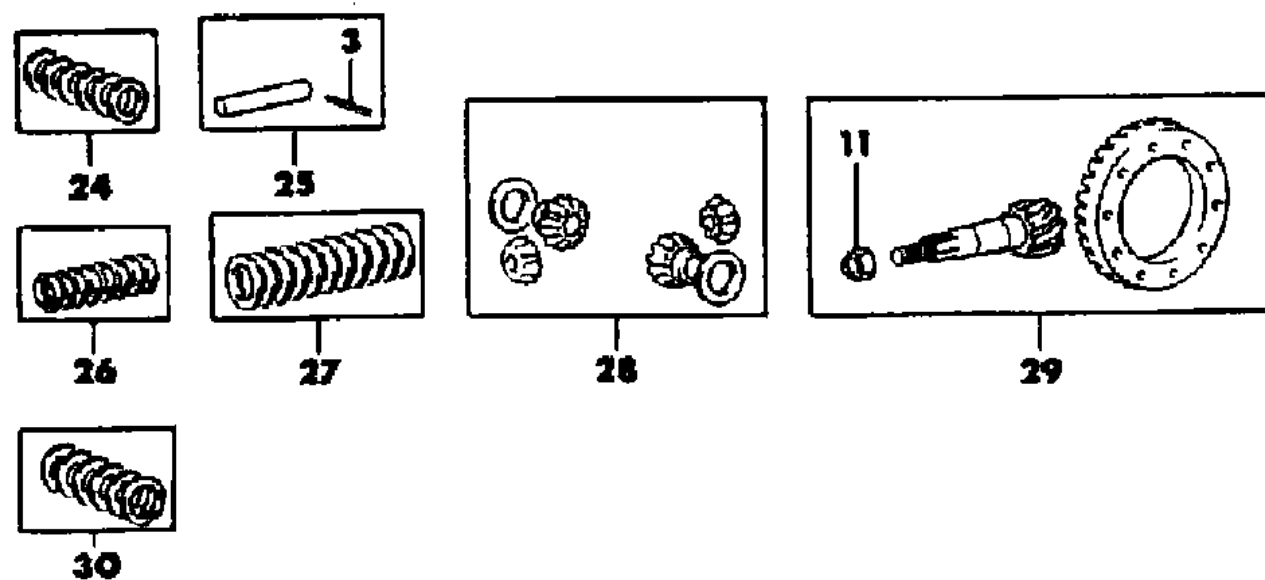
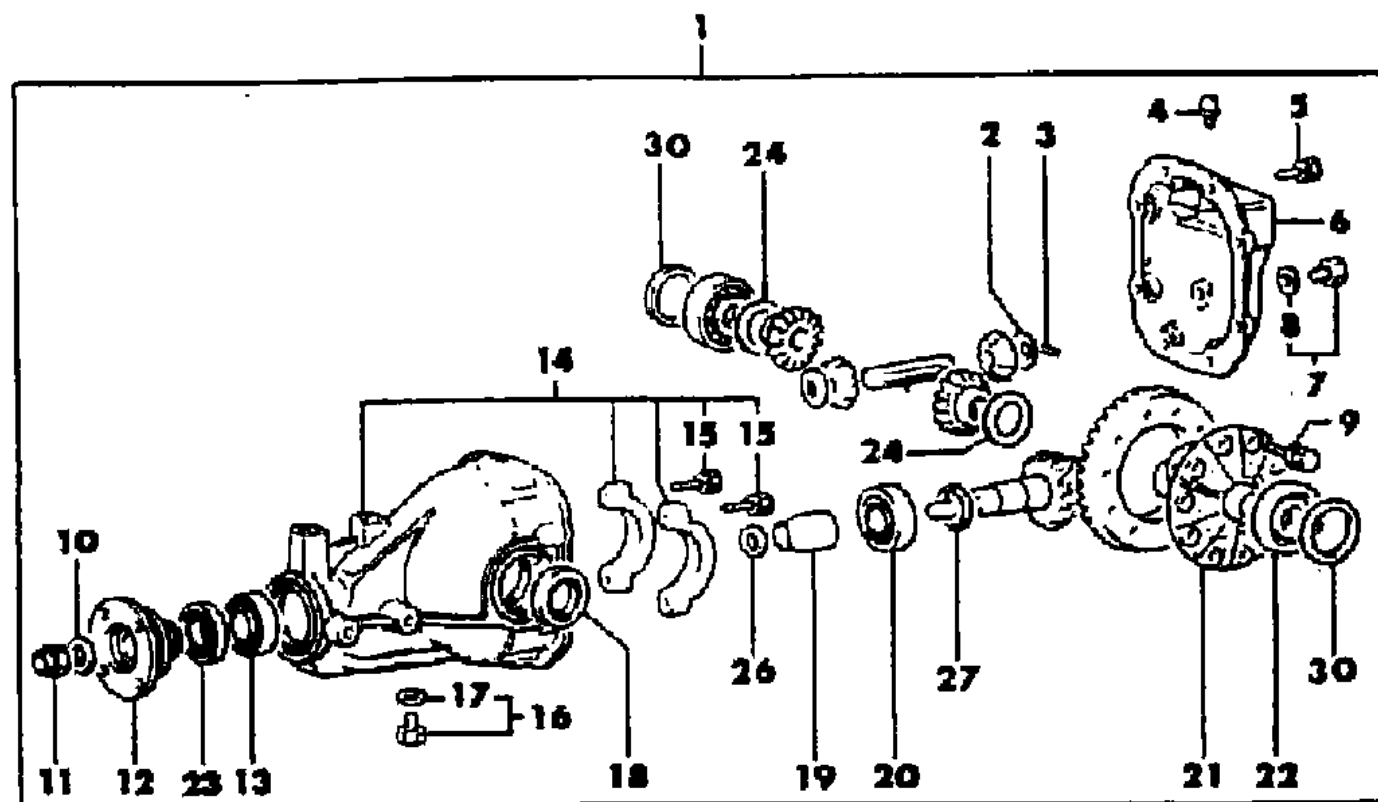

ITEM	PART NUMBER	QTY	BODY	MODEL	DESCRIPTION
1					CARRIER ASSY, Rear Differential ***
	MB59 7591	1			3.54, w/Man. Trans.
	MB69 8803	1			3.30, w/Auto Trans.
2	MA14 5188	2			WASHER, (Spring 17.3)
3	MD70 6557	1			PIN, (Lock 5x54)
4	MB39 3530	1			PLUG
5	MF24 4881	8			BOLT, w/Washer, (10x30)
6	MB56 9153	1			COVER
7	MB00 1261	1			PLUG
8	MF66 0066	1			GASKET
9	MB09 2220	8			BOLT, (10x17.5)
10	MT20 3641	1			WASHER, (18.5)
11	MA14 3517	1			NUT, (18)
12	MB39 3977	1			FLANGE, Companion
13	MB39 3955	1			BEARING, Drive Pinion, Front
14	MB56 9042	1			CARRIER, Rear Differential
15	MS24 0915	4			BOLT, (10x50)
16	MB56 9390	1			PLUG
17	MB00 1294	1			GASKET
18	MB39 3932	1			SEAL, Oil, Drive Pinion
19					SPACER, Pinion Bearing
	MB04 4434	1			57.08
	MA18 0841	1			57.72
20	MB39 3956	1			BEARING, Drive Pinion, Rear
21	MB39 3864	1			CASE, Rear Differential
22	MB39 3957	2			BEARING, Side
23	MB39 3929	1			SEAL, Oil, Side Bearing
24	MB18 5340	2			SPACER SET
25	MB28 3146	1			SHAFT KIT, Pinion ***
26	MB18 5360	1			SHIM SET, Drive Pinion, Front
27	MB18 5350	1			SHIM SET, Drive Pinion, Rear
28	MB28 3556	1			GEAR SET
29					GEAR KIT, Final Drive ***
	MB18 5307	1			3.54
	MB18 5312	1			3.30
30	MB24 1903	2			SPACER SET

ENGINE: P = 1800cc (1.8L) A = 2000cc (2.0L) Blank = All
 TRANS: A = Automatic M = Manual Blank = All
 SERIES: H = High M = Medium P = Premium S = Special

MODELS:
 24 FWD = 2Dr Hatchback (Laser)
 24 FWD = 2-Dr Hatchback (Talon)
 4WD = (4 Wheel Drive)
 2WD = (2 Wheel Drive)

AR = Use as Required - = Non Illustrated Part P.A.R. = Paint as Required