



# Parts Manual



See "General Information"  
for New Parts Manual  
Features.

---

## D8T TRACK-TYPE TRACTOR

---

J8B1-Up (Machine)  
LHX1-Up (Engine)  
DZH1-Up (Transmission)  
A5G1-Up (Bulldozer)  
B8S1-Up (Bulldozer)  
D1E1-Up (Bulldozer)  
D1F1-Up (Bulldozer)  
DZR1-Up (Bulldozer)  
DZS1-Up (Bulldozer)  
DZX1-Up (Bulldozer)  
L1J1-Up (Ripper)  
R8S1-Up (Ripper)  
BZC1-Up (Torque Converter)

**Powered By C15 Engine**

This Parts Manual is also available in .PDF format on Compact Disc  
(CD-ROM)-Caterpillar Form No. SERP4195-44



# Product and Dealer Information

Note: For product identification plate locations, see the section "Product Identification Information" in the Operation and Maintenance Manual.

Delivery Date: \_\_\_\_\_

## Product Information

Model: \_\_\_\_\_

Product Identification Number: \_\_\_\_\_

Engine Serial Number: \_\_\_\_\_

Transmission Serial Number: \_\_\_\_\_

Generator Serial Number: \_\_\_\_\_

Attachment Serial Numbers: \_\_\_\_\_

Attachment Information: \_\_\_\_\_

Customer Equipment Number: \_\_\_\_\_

Dealer Equipment Number: \_\_\_\_\_

## Dealer Information

Name: \_\_\_\_\_ Branch: \_\_\_\_\_

Address: \_\_\_\_\_

\_\_\_\_\_

\_\_\_\_\_

Dealer Contact

Phone Number

Hours

Sales: \_\_\_\_\_

Parts: \_\_\_\_\_

Service: \_\_\_\_\_

# MEMORANDA

# TABLE OF CONTENTS

Name	Page	Name	Page
<b>GENERAL INFORMATION</b> .....	A5	PLUG GP-CYLINDER BLOCK .....	100
<b>REPAIR ALTERNATIVES</b> .....	A8	PLUG GP-CYLINDER HEAD .....	103
<b>SUPPLEMENTAL COOLANT ADDITIVES</b> .....	A9	ROCKER ARM GP .....	104
<b>MAINTENANCE PARTS</b> .....	A10	SEAL GP-CRANKSHAFT .....	110
<b>INDEX</b> .....	A16	SUPPORT GP-ENGINE .....	111
<b>MACHINE ARRANGEMENT</b> .....	1	SUPPRESSION AR-SOUND .....	113
CHASSIS AR .....	1	TRUNNION GP-ENGINE .....	114
COLD WEATHER AR .....	2	<b>LUBRICATION SYSTEM</b> .....	115
GENERAL AR .....	2	BREATHER GP .....	115
MACHINE AR-HIGH AMBIENT TEMP .....	3	FASTENER GP-OIL PUMP MOUNTING .....	117
MODIFICATION AR-WOODCHIP .....	3	FILLER GP-ENGINE OIL .....	118
WASTE HANDLING AR .....	5	FILTER GP-ENGINE OIL .....	119
<b>ENGINE ARRANGEMENT</b> .....	11	FUMES DISPOSAL GP .....	121
ENGINE AR-COMPLETE .....	11	GAUGE GP-OIL LEVEL (DIPSTICK) .....	123
ENGINE AR-CORE .....	15	LINES GP-TURBOCHARGER OIL .....	124
INSTALLATION AR-ENGINE .....	17	OIL CHANGE GP-HIGH SPEED .....	126
<b>BASIC ENGINE</b> .....	18	PRELUBRICATION AR-ENGINE .....	128
ADAPTER GP-PUMP DRIVE .....	18	PUMP GP-ENGINE OIL .....	130
BASE GP-VALVE COVER & INJ HARN .....	19	<b>COOLING SYSTEM</b> .....	131
CAMSHAFT GP .....	22	CORE GP-OIL COOLER .....	131
COVER GP-CYLINDER BLOCK .....	23	FAN AR-REVERSIBLE .....	132
COVER GP-FLYWHEEL HOUSING .....	25	FAN GP-SUCTION .....	136
COVER GP-FRONT HOUSING .....	27	LINES GP-WATER .....	138
COVER GP-SOUND SUPPRESSION .....	28	PUMP GP-WATER .....	146
COVER GP-VALVE MECHANISM .....	29	RADIATOR AR .....	148
CRANKSHAFT GP .....	35	RADIATOR GP .....	150
CYLINDER BLOCK AS .....	36	TANK GP-COOLANT .....	155
CYLINDER BLOCK GP .....	38	<b>AIR INLET AND EXHAUST SYSTEM</b> .....	157
CYLINDER HEAD AS .....	46	AFTERCOOLER GP-AIR .....	157
CYLINDER HEAD GP .....	52	AIR CLEANER GP .....	159
DAMPER & PULLEY GP .....	58	DUST EJECTOR GP .....	161
FASTENER GP-ENGINE WIRING .....	59	LINES GP-AIR .....	162
FASTENER GP-FRONT HOUSING .....	60	MANIFOLD GP-EXHAUST .....	164
FASTENER GP-VALVE MECHANISM .....	62	MOUNTING GP-AIR CLEANER .....	165
FLYWHEEL GP .....	63	MUFFLER GP .....	166
GEAR GP-CAMSHAFT .....	64	PRECLEANER AR .....	167
GEAR GP-FRONT .....	65	PRECLEANER GP .....	169
GEAR GP-REAR .....	67	SHIELD GP-MANIFOLD .....	177
HOUSING GP-FLYWHEEL .....	69	TURBOCHARGER GP .....	178
HOUSING GP-FRONT .....	71	<b>FUEL SYSTEM</b> .....	180
LIFTING GP-ENGINE .....	75	ADAPTER GP-FAST FILL FUEL .....	180
MECHANISM GP-FUEL PUMP & VALVE .....	77	FILTER GP-PRIMARY FUEL .....	182
MOUNTING GP-ALTERNATOR & COMPR .....	81	FILTER GP-SECONDARY FUEL .....	186
PAN GP-OIL .....	82	FILTER GP-WATER SEP & FUEL .....	192
PISTON & ROD GP .....	94	LINES GP-FUEL .....	193
		LINES GP-FUEL FILTER .....	195
		PUMP & MTG GP-FUEL TRANSFER .....	203
		PUMP GP-FUEL INJECTION .....	204
		PUMP GP-FUEL PRM & WATER SEP .....	205
		TANK GP-FUEL .....	206
		VALVE GP-CHECK .....	212

# TABLE OF CONTENTS

Name	Page	Name	Page
<b>ELECTRICAL AND STARTING SYSTEM</b> . . . . .	214	SWITCH GP-MAGNETIC . . . . .	378
ALARM GP . . . . .	214	SWITCH GP-PRESSURE . . . . .	380
ALTERNATOR GP-CHARGING . . . . .	215	SWITCH GP-PUSH BUTTON . . . . .	381
BATTERY & WIRING GP . . . . .	226	SWITCH GP-WIPER . . . . .	382
BATTERY GP . . . . .	234	VALVE GP-ETHER STARTING . . . . .	383
BLOCK GP-JUNCTION . . . . .	235	WIRING GP-CAB . . . . .	384
CAMERA AR . . . . .	236	WIRING GP-ELECTRONIC CONTROL . . . . .	386
CONNECTION GP-ELECTRICAL . . . . .	238	WIRING GP-ENGINE . . . . .	388
CONTROL & MTG GP-ENGINE ELEK . . . . .	239	WIRING GP-GRADE CONTROL . . . . .	395
CONTROL & MTG GP-IMPLEMENT . . . . .	242	WIRING GP-PLATFORM . . . . .	402
CONTROL GP-COMMUNICATION . . . . .	243		
CONTROL GP-IMPLEMENT . . . . .	244	<b>POWER TRAIN</b> . . . . .	411
CONTROL GP-SWITCH . . . . .	246	AXLE GP . . . . .	411
CONTROL GP-UNPROGRAMMED . . . . .	248	BRAKE & DIFFERENTIAL DRIVE GP . . . . .	413
CONVERTER GP-ELECTRICAL . . . . .	250	BRAKE & PLANETARY GP . . . . .	417
ELECTRONICS AR-MACHINE . . . . .	251	CASE & PARTS GP-PLANETARY . . . . .	419
ELECTRONICS GP-		CASE GP-TRANSMISSION . . . . .	422
COMMUNICATION . . . . .	251	CONTROL GP-TRANSMISSION HYD . . . . .	424
ELECTRONICS GP-IMPLEMENT . . . . .	252	COUPLING GP-PUMP . . . . .	428
ELECTRONICS GP-MACHINE . . . . .	252	DIFFERENTIAL & BEVEL GEAR GP . . . . .	429
ELECTRONICS GP-MONITOR . . . . .	252	DRAIN GP-ECOLOGY . . . . .	431
ELECTRONICS GP-POWER TRAIN . . . . .	252	DRIVE GP-FINAL . . . . .	432
GRADE CONTROL AR . . . . .	253	FINAL DRIVE GP . . . . .	444
GRADE CONTROL AR-LASER . . . . .	253	DRIVE GP-PUMP . . . . .	446
GRADE CONTROL AR-SATELLITE . . . . .	254	LINES GP-POWER TRAIN OIL . . . . .	447
HEATER GP-JACKET WATER . . . . .	256	MOUNTING GP-FINAL DRIVE . . . . .	471
INSTALLATION GP-COMMUNICATION . . . . .	259	MOUNTING GP-TRANSMISSION . . . . .	472
INSTALLATION GP-SECURITY . . . . .	265	PLANETARY GP-TRANSMISSION . . . . .	473
LAMP GP-FLOOD . . . . .	267	POWER TRAIN AR . . . . .	478
LIGHTING GP-FLOOD . . . . .	273	PUMP GP-GEAR . . . . .	479
LIGHTING GP-RIPPER . . . . .	313	SCREEN GP . . . . .	483
LIGHTING GP-WARNING BEACON . . . . .	314	SEGMENT GP-SPROCKET . . . . .	484
LINES GP-ALTERNATOR AIR . . . . .	317	SHAFT GP-DRIVE . . . . .	488
MAST GP . . . . .	319	SLIP JOINT GP . . . . .	489
MOUNTING GP-CONNECTOR . . . . .	320	TORQUE CONVERTER GP . . . . .	490
MOUNTING GP-GRADE CONTROL . . . . .	322	TRANSMISSION AR . . . . .	495
MOUNTING GP-RECEIVER . . . . .	323	UNIVERSAL JOINT GP . . . . .	497
MOUNTING GP-SENSOR . . . . .	326	VALVE GP-MODULATING . . . . .	498
PANEL GP-FUSE . . . . .	327	VALVE GP-PRIORITY . . . . .	500
RADIO GP-COMMUNICATION . . . . .	331	VALVE GP-RELIEF . . . . .	505
RECEIVER GP-LASER . . . . .	331	VALVE GP-SOLENOID . . . . .	508
RECEIVER GP-SATELLITE . . . . .	331		
RESISTOR GP-CAB HEATER . . . . .	334	<b>FRAME AND BODY</b> . . . . .	510
SENSOR & MOUNTING GP . . . . .	335	ACTUATOR GP-POWER . . . . .	510
SENSOR GP-ENGINE . . . . .	338	BAR AR-STRIKER . . . . .	512
SENSOR GP-POSITION . . . . .	342	BAR GP-STRIKER . . . . .	514
SENSOR GP-PRESSURE . . . . .	347	BOX GP-BATTERY . . . . .	516
SENSOR GP-SPEED . . . . .	356	CASE & FRAME GP . . . . .	518
SENSOR GP-TEMPERATURE . . . . .	361	COUNTERWEIGHT GP . . . . .	522
STARTING AID GP-ETHER . . . . .	367	COUNTERWEIGHT GP-FRONT . . . . .	525
STARTING MOTOR GP-ELECTRIC . . . . .	368	COVER GP-HOOD . . . . .	526
SWITCH GP-BYPASS . . . . .	372	DOOR GP-ACCESS . . . . .	527
SWITCH GP-DISCONNECT . . . . .	373	DRAWBAR GP . . . . .	539
SWITCH GP-FLOW . . . . .	376	ENCLOSURE GP-ENGINE . . . . .	540
SWITCH GP-LIMIT . . . . .	377	ENCLOSURE GP-HYDRAULIC TANK . . . . .	547

# TABLE OF CONTENTS

Name	Page	Name	Page
FENDER GP .....	548	PUMP GP-PISTON .....	712
FLOORPLATE GP .....	552	ROTATING GP-MOTOR .....	714
FRAME & BEARING AS .....	553	ROTATING GP-PUMP .....	716
GRILL GP-RADIATOR .....	555	VALVE GP-BRAKE CONTROL .....	718
GUARD AR-BOTTOM .....	560	VALVE GP-FLUSHING .....	720
GUARD AR-FINAL DRIVE .....	564	VALVE GP-PUMP CONTROL .....	721
GUARD GP-BOTTOM .....	565	VALVE GP-RELIEF .....	723
GUARD GP-BRUSH .....	568	VALVE GP-SOLENOID .....	724
GUARD GP-DRIVE SHAFT .....	570	VALVE GP-STEERING & BRAKE CONT .....	726
GUARD GP-FINAL DRIVE .....	571		
GUARD GP-FUEL TANK .....	573	<b>HYDRAULIC SYSTEM</b> .....	728
GUARD GP-POWER TRAIN .....	575	ACCUMULATOR GP-PILOT OIL .....	728
GUARD GP-RADIATOR .....	576	ACTUATOR GP-PUMP .....	730
GUARD GP-REAR .....	582	ADAPTER GP-MOTOR .....	731
GUARD GP-ROCK .....	583	CONTROL AR-HYD PIN PULLER .....	732
GUARD GP-SEAL .....	585	CONTROL AR-HYDRAULIC .....	734
LATCH GP .....	586	COOLER GP-HYDRAULIC OIL .....	736
PANEL GP-SOUND SUPPRESSION .....	587	CYLINDER & LINES GP-LIFT .....	737
SEAL GP-WASTE HANDLING .....	588	CYLINDER AR-DUAL TILT .....	741
STEP GP .....	592	CYLINDER GP-BULLDOZER LIFT .....	744
SWEEP GP .....	593	CYLINDER GP-RIPPER LIFT .....	746
		CYLINDER GP-RIPPER PIN PULLER .....	748
<b>UNDERCARRIAGE</b> .....	595	CYLINDER GP-TILT .....	749
BAR AS-EQUALIZER .....	595	HYDRAULIC AR .....	759
BAR GP-EQUALIZER .....	596	LINES GP-BULLDOZER MANIFOLD .....	760
CAP GP-TRACK IDLER .....	598	LINES GP-HYDRAULIC .....	762
CAP GP-TRACK ROLLER .....	601	LINES GP-HYDRAULIC FAN .....	763
FRAME AS-TRACK ROLLER .....	603	LINES GP-PIN PULLER CYLINDER .....	772
FRAME GP-TELESCOPING RECOIL .....	604	LINES GP-PUMP .....	773
GAUGE AR-TRACK .....	618	LINES GP-RIPPER .....	776
GAUGE AR-UNDERCARRIAGE .....	618	LINES GP-TILT CYLINDER .....	779
GUARD AR-IDLER .....	618	MANIFOLD GP-CONTROL .....	798
GUARD GP-IDLER .....	620	MANIFOLD GP-HYDRAULIC .....	803
IDLER GP-TRACK .....	623	MANIFOLD GP-VALVE .....	804
LINK AS-TRACK .....	633	MOTOR & MTG GP-HYDRAULIC FAN .....	806
LINK AS-TRACK BOX .....	639	MOTOR GP-PISTON .....	807
LUBRICATION GP-PIVOT SHAFT .....	641	MOUNTING GP-CYLINDER .....	809
ROLLER AR-TRACK CARRIER .....	643	PLUG GP-CONTROL VALVE .....	810
ROLLER GP-TRACK-DOUBLE		PUMP & MOUNTING GP .....	811
FLANGE .....	646	PUMP GP-PISTON .....	813
ROLLER GP-TRACK-SINGLE FLANGE .....	650	ROTATING GP-MOTOR .....	821
SUSPENSION GP-BOGIE .....	655	ROTATING GP-PUMP .....	823
TRACK ADJUSTER & RECOIL GP .....	661	TANK & MTG GP-HYDRAULIC .....	825
TRACK GP .....	667	VALVE & MTG GP-CONTROL .....	834
UNDERCARRIAGE AR .....	691	VALVE & MTG GP-HYDRAULIC FAN .....	838
		VALVE & MTG GP-IMPLEMENT CONT .....	839
<b>STEERING AND BRAKING SYSTEM</b> .....	695	VALVE GP-BANK 3 .....	840
ACTUATOR GP-PUMP .....	695	VALVE GP-BANK 4 .....	854
CONTROL GP-PARKING BRAKE .....	696	VALVE GP-BYPASS .....	862
FILTER GP-OIL .....	698	VALVE GP-CHECK .....	863
HEAD GP-PUMP .....	701	VALVE GP-CONTROL .....	867
LINES GP-STEERING .....	703	VALVE GP-FAN REVERSING .....	894
MANIFOLD & VALVE GP .....	707	VALVE GP-PRESSURE REDUCING .....	896
MOTOR GP-PISTON .....	710	VALVE GP-PUMP CONTROL .....	897
PUMP GP-CHARGE .....	711	VALVE GP-QUICK-DROP .....	901

# TABLE OF CONTENTS

Name	Page	Name	Page
VALVE GP-RELIEF .....	903	CONTROL GP-HANDLE .....	1041
VALVE GP-SHUTTLE .....	908	CONTROL GP-JOYSTICK .....	1054
VALVE GP-SOLENOID .....	909	CONTROL GP-RIPPER .....	1072
<b>IMPLEMENTS</b> .....	916	CONTROL GP-STEER CLUTCH & BRK .....	1074
BRACE GP-BULLDOZER .....	916	CONTROL GP-STEERING .....	1075
BULLDOZER AR-ANGLING .....	919	CONTROL GP-STEERING & XMSN .....	1076
BULLDOZER AR-SEMI-UNIVERSAL .....	921	CONVERSION AR-OPEN ROPS .....	1080
BULLDOZER AR-UNIVERSAL .....	924	CONVERSION AR-ROPS .....	1080
C-FRAME GP .....	926	COVER GP-ACCESS .....	1081
LINK GP-STABILIZER .....	928	DISPLAY GP-MONITOR .....	1083
MODIFICATION AR-BULLDOZER .....	931	DOOR GP-CAB .....	1084
PUSH ARM GP .....	932	FILTER GP-CAB AIR .....	1091
PUSH ARM GP-STABILIZER .....	935	HEATER GP-CAB .....	1093
TRUNNION GP-BULLDOZER .....	939	HOUSING GP-SEAT SUSPENSION .....	1099
<b>WORK TOOLS</b> .....	941	INSTALLATION GP-RADIO .....	1102
BLADE & EDGE GP-ANGLING .....	941	KIT-WINDOW .....	1104
BLADE & EDGE GP-SEMI-UNIVERSAL .....	942	LINER GP-CAB .....	1105
BLADE & EDGE GP-UNIVERSAL .....	949	LINES GP-AIR CONDITIONER .....	1107
BLADE AS-SEMI-UNIVERSAL .....	954	LINES GP-HEATER .....	1137
BLADE AS-UNIVERSAL .....	962	MIRROR GP-REAR VIEW .....	1139
BLADE GP .....	966	MONITOR AS .....	1142
BLADE GP-ANGLING .....	968	MOUNTING GP-ANTENNA .....	1143
BLADE GP-SEMI-UNIVERSAL .....	969	MOUNTING GP-CAB .....	1146
BLADE GP-UNIVERSAL .....	976	MOUNTING GP-CONDENSER .....	1147
EDGE GP-BIT & CUTTING .....	981	MOUNTING GP-MONITOR .....	1150
FRAME AR-STRIKER .....	985	MOUNTING GP-RADIO .....	1152
FRAME GP-RIPPER .....	987	MOUNTING GP-ROPS .....	1153
LINES GP-WINCH .....	990	OPERATOR AR .....	1155
MOUNTING GP-MAST .....	992	PAN GP-BACKREST .....	1157
MOUNTING GP-RIPPER .....	994	PANEL GP-CONTROL .....	1163
PLATE AS-WEAR .....	995	PEDAL GP-GOVERNOR & BRAKE .....	1165
PULLER AR-PIN .....	997	PLATFORM AR .....	1171
PULLER GP-PIN .....	998	PLATFORM GP-OPERATOR .....	1174
RIPPER AR .....	999	RECLINER GP-SEAT .....	1176
RIPPER GP .....	1001	ROPS GP .....	1177
TOOTH GP-RIPPER .....	1003	ROPS GP-OPEN .....	1178
<b>OPERATOR STATION</b> .....	1006	SCREEN GP-PROTECTION .....	1180
ADJUSTER GP-SEAT .....	1006	SEAT & MOUNTING GP .....	1182
AIR COMPRESSOR GP-SEAT .....	1007	SEAT GP .....	1183
AIR CONDITIONER AR .....	1009	SEAT GP-SUSPENSION .....	1194
BOX GP-STORAGE .....	1010	SUSPENSION GP-SEAT .....	1200
BRACKET GP-MOUNTING .....	1011	TANK GP-WINDOW WASHER .....	1204
CAB AR .....	1014	WASHER GP-WINDOW .....	1206
CAB GP .....	1017	WINDOW GP-CAB .....	1208
CANOPY AR-OPEN ROPS .....	1026	WINDOW GP-SLIDING .....	1212
COMPRESSOR GP-REFRIGERANT .....	1027	WIPER GP-WINDOW .....	1215
CONDENSER & MTG GP-REFRIGERANT .....	1029	WIPER PIVOT GP .....	1224
CONDENSER GP-REFRIGERANT .....	1031	<b>SERVICE EQUIPMENT AND SUPPLIES</b> .....	1226
CONSOLE GP-FRONT .....	1033	FILM GP .....	1226
CONSOLE GP-OPERATOR .....	1034	PLATE & FILM GP .....	1230
CONTROL & MTG GP-PEDAL .....	1036	PLATE GP-ENGINE IDENTIFICATION .....	1233
		<b>PART NUMBER INDEX</b> .....	B1



# GENERAL INFORMATION

## 1. MACHINE IDENTIFICATION

Caterpillar machines are identified by Product Identification Numbers (PIN). Some components included in a machine may be identified by Serial Numbers (S/N). Typical components that will be serialized include engines, transmissions, bulldozers, and rippers. The machine and engine are further identified by arrangement numbers and in some cases modification numbers. These numbers are shown on the product identification plate(s) and on the master plate in the operator's compartment.

Caterpillar dealers need all of these numbers to determine accurate parts identification.

### **New Feature**

Effective First Quarter 2001 the Caterpillar Product Identification Number (PIN) changed from 8 to 17 characters. In an effort to provide uniform equipment identification, Caterpillar and other construction equipment manufacturers are moving to comply with the latest version of the product identification numbering standard. Non-road machine PINs are defined by ISO 10261. The new PIN format will apply to all Caterpillar machines and generator sets. The PIN plates and frame marking will display the 17 character PIN. The new format will look like the following:

**\*CAT 0789BG 6SL 12345\***

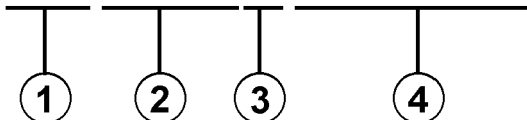

The diagram shows the PIN format \*CAT 0789BG 6SL 12345\* with a horizontal line underneath. Below the line, four vertical lines connect to circles containing the numbers 1, 2, 3, and 4. Line 1 connects to 'CAT', line 2 connects to '0789BG', line 3 connects to '6SL', and line 4 connects to '12345'.

Where:

1. Caterpillar's World Manufacturing Code (characters 1-3)
2. Machine Descriptor (characters 4-8)
3. Check Character (character 9)
4. Machine Indicator Section (MIS) or Product Sequence Number (characters 10-17). These were previously referred to as the Serial Number.

Machines and generator sets produced before First Quarter 2001 will maintain their 8 character PIN format.

Components such as engines, transmissions, axles, etc. and work tools will continue to use an 8 character Serial Number (S/N).

## 2. ORDERING PARTS

### **WARNING**

**When replacement parts are required for this product Caterpillar recommends using Caterpillar replacement parts or parts with equivalent specifications including, but not limited to, physical dimensions, type, strength and material.**

**Failure to heed this warning can lead to premature failures, product damage, personal injury or death.**

Quality Caterpillar replacement parts are available from Caterpillar dealers throughout the world. Their parts inventories are up to date and include all parts normally required to protect your investment in Caterpillar machines. Dealers may offer repair kits or remanufactured parts to allow selection of the most effective repair alternative for a particular situation. When ordering parts, your order should specify the quantity, part number, part name, and the serial number/product identification number of the machine for which the parts are needed.

## 3. PARTS MANUAL ORGANIZATION

Product information in this manual is presented as "information elements" that represent all of the components for the specific model. Engine Arrangement and Seat Group are examples of information elements. The information elements are organized alphabetically by part name and secondarily by part number within each major section of the manual.

## 4. TABLE OF CONTENTS

A table of contents (TOC) is found at the beginning of the manual. The TOC lists each section of the manual with a complete list of all information elements organized as they appear in the manual. Page numbers are provided for quick reference to detailed parts identification illustrations and serviceable consist lists.

## 5. MAINTENANCE PARTS INDEX

The Maintenance Parts Index, located near the beginning of the manual, references most frequently used maintenance part numbers, providing description, quantity, usage and page number. This information is organized alphabetically by part description.

# GENERAL INFORMATION

## 6. INDEX

The index located near the front of the manual is an alphabetical listing of all information elements included in the manual. Page numbers are provided for quick reference to detailed parts identification illustrations and serviceable consist lists.

## 7. PART NUMBER INDEX

A numerical index listing all part numbers and the corresponding page number(s) appears at the back of the manual.

## 8. CAPTIONS

Captions located at the beginning of each information element identify the part number and part name along with additional descriptive information. PIN and S/N information found in each caption should be used to select correct information for a specific machine. Field replacement options, identification of optional attachment components, and where used ("part of") information is also provided.

The first line of a caption is shown in larger type font to indicate the beginning of an information element. Captions for additional pages that may be required to illustrate an information element will be shown in standard type font and will include the term (*contd.*) .

## 9. NON-SERVICED PARTS

In some instances it is necessary to display non-serviced parts that are a link to a lower level serviceable consist lists. These non-serviced part numbers are shown in *italic* type indicating that they are not available.

## 10. PARTS LIST REFERENCE NUMBERS

Numbers shown in the Ref No column correspond to numbers used in the associated graphic(s). An alphabetic suffix may be added to a reference number to identify lower level consist items. Numbers shown in the Graphic Ref column refer to the graphic number identifier displayed in the lower left corner of each illustration. The Graphic Ref number may be used in combination with the item Ref No to determine the correct part number. There may be intentional omission of a Ref No in a consist list as information is updated to reflect the latest serviceable part numbers.

## 11. INDENTED PART NAMES

When a part name is indented in a parts list, it is part of (included in) the group or assembly under which it is indented.

## 12. ILLUSTRATION REFERENCE LETTERS

When necessary, illustrations contain reference letters (A, B, C etc.) that are intended to track lines and harnesses from one point to another. They are also used to show where to reconnect illustrations that have been separated.

## 13. ABBREVIATIONS AND SYMBOLS

**O.D.** – Outside Diameter  
**I.D.** – Inside Diameter  
**A** – Not Part Of This Group  
**B** – Use As Required  
**C** – Change From Previous Type  
**D** – Order By The Meter  
**E** – Order By The Centimeter  
**F** – Not Shown  
**G** – Order By The Inch  
**I** – Refer To Hydraulic Information System  
**M** – Metric Part  
**R** – Remfg Part May Be Available  
**Y** – Separate Illustration  
**Z** – Not Serviced Separately

 **New Feature**

## 14. DESCRIPTION OF TYPE CHANGES

Type - A type is defined as any configuration change that requires an additional Information Element for an Arrangement, Group, or Assembly. If serial number breaks for types are not available, a type # ( Type 1, Type 2, etc.) will be displayed in the caption. These "type" changes are identified with a "C" note (change from previous type) in the Parts List. Only the "types" that apply to this Parts Manual will be included. Additional types may exist causing "C" notes to appear on an Information Element when no other types are shown.

## 15.<END>

This symbol indicates the end of an information element.

### NOTE:

**Continuing improvement and advancement of product design may cause changes to your machine which may not be included in this publication. Whenever a question arises regarding your caterpillar product or this publication, please consult your caterpillar dealer for the latest available information.**

# GENERAL INFORMATION

8 FRAME AND BODY						1	
BE-3299 PLATFORM GP-CAB						100090751	
SNCB-7283						REV 0000	
PIN 3841-99999							
NOTE	REF NO	GRAPHIC REF	PART NUMBER	QTY	PART NAME	REV	PAGE
	1		31-2982	1	PLATE AS		
	2		68-2092	25	BOLT (3/8-18X.750IN)		
	3		68-1078	41	WASHER-HARD (3MM THK)		
	4		68-1444	2	SUPPORT AS-FOOT		
	5		77-2229	19	BOLT (1/2-13X1IN)		
	6		68-1136	2	COVER AS-LH		
	7		78-2411	4	COVER		
	8		64-0486	18	SCREW-HEAD (3/8-18X.875IN)		
	9		77-0774	1	COVER		
	10		68-0372	1	GASKET		
	11		68-2280	1	GASKET		
	12		31-3492	1	HANDHOLD		
	13		68-0372	8	NUT-WELD (3/8-16 THD)		
	14		77-0131	1	FLOORPLATE AS		
	15		17-0752	4	NUT-WELD (1/2-13 THD)		
	16		77-0087	1	PLUS-BUTTON		
	17		77-0136	1	PLATE AS		
	18		68-0372	5	NUT-WELD (3/8-16 THD)		
	19		77-0089	1	COVER		
	20		77-0770	1	GASKET		
	21		31-2981	1	PLATE AS		
	22		68-0484	4	BOLT (1/4-20X.625IN)		
	23		68-0484	4	WASHER-HARD (2MM THK)		
	24		61-0484	1	FLOOR MAT		
	25		68-0484	1	MODULE AS-OPERATOR		
	26		31-3494	1	HANDHOLD		
	27		68-0271	2	PLUS		
	28		68-0384	4	BOLT (1/4-20X.625IN)		
	29		68-0298	4	WASHER-HARD (2MM THK)		
	30		68-1078	21	WASHER-HARD (3MM THK)		
	31		77-0136	1	SEAL		
	32		78-0378	2	BOLT (3/4-10X5IN)		
	33		78-0382	2	WASHER-HARD (5MM THK)		
	34		31-3482	2	PLATE AS		
	35		31-3480	1	PLATE AS		
	36		78-0288	8	SPACER		
	37		31-3381	1	SEAL		
	38		78-0817	1	GASKET		
	39		78-0816	1	COVER AS		
	40		68-0372	2	WASHER		
	41		68-0228	2	SCREW-KNURLED		
	42		68-2428	1	COVER		
	43		68-0887	1	COVER		
	44		68-0021	8	SCREW-BOCKET HEAD		
	45		68-3142	8	MOUNTING		
	46		68-0027	2	PLATE		
	47		78-0289	2	BOLT (1/2-8X5IN)		
	48		78-0272	2	WASHER-HARD		
	49		64-0484	4	BOLT (3/8-18X1.02IN)		
	50		31-6783	1	COVER		

12 FRAME AND BODY 1 of 4 SELP 170-01

FRAME AND BODY						100090751	
BE-3299 PLATFORM GP-CAB (contd.)							
NOTE	REF NO	GRAPHIC REF	PART NUMBER	QTY	PART NAME	REV	PAGE
	41		68-0816	1	COVER		
	42		77-0134	1	PLATE		
	43		77-0128	1	GASKET		
	44		78-0724	1	GASKET		
	45		78-0723	1	COVER		
	46		68-1069	2	PLUS-BUTTON		

M-METRIC PART

SELPA670-01 2 of 4

FRAME AND BODY 13

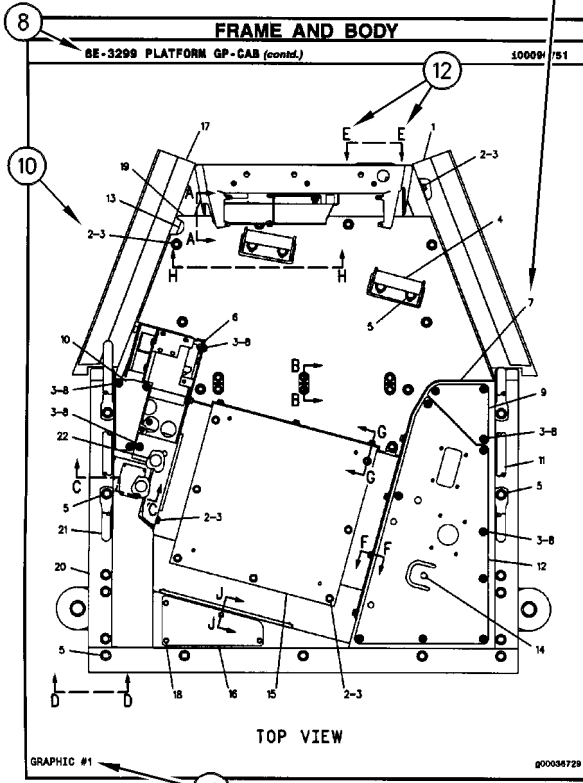

14 FRAME AND BODY 3 of 4 SELPA670-01

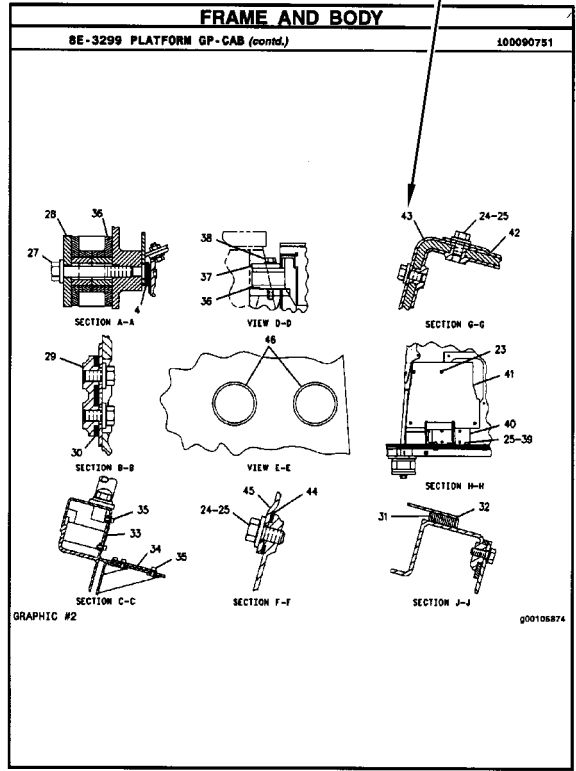

SELPA670-01 4 of 4

FRAME AND BODY 15

# REPAIR ALTERNATIVES

## REMANUFACTURED COMPONENTS

As an option when making repairs consider Caterpillar Remanufactured Components. Components that are available through the Caterpillar Remanufactured Program are identified three ways in the parts book:

- with the letter R in the note field of the parts list
- with an R\* at the beginning of the first line of the caption
- with an \*R at the end of the first line of the caption

Typical components included in the Remanufacturing Program include:

ALTERNATORS  
CONNECTING RODS  
CRANKSHAFTS - UNDERSIZE  
CRANKSHAFTS - UPGRADE TO NEW  
CYLINDER HEADS  
ELECTRONIC CONTROL MODULES (ECM)  
ELECTRONIC SENSORS  
FUEL INJECTORS  
FUEL NOZZLES  
FUEL PUMPS  
GOVERNORS  
OIL PUMPS  
PISTONS  
SHORT BLOCKS  
STARTERS  
TURBOCHARGERS - COMPLETE  
TURBOCHARGER CARTRIDGES  
WATER PUMPS

Caterpillar Remanufactured engines for many engine arrangements are also available.

# SUPPLEMENTAL COOLANT ADDITIVES

## CUSTOMER BENEFITS:

Protects against cavitation, foam, erosion, corrosion, and scale buildup in cooling systems.

- Provides measured coolant conditioner.

## DESCRIPTION:

Additives deplete from the coolant with normal operation. For this reason, Supplemental Coolant Additives (SCA) must be added to all heavy duty coolants at regular intervals. In addition, when not using a fully formulated, pre-charged antifreeze, like Caterpillar's DEAC, an initial charge of SCA must be added to the cooling system. The amount of SCA added to the system is dependent on the capacity of the system.

The SCA for initial fill is provided as a liquid. SCA's for maintenance intervals are available in liquid form and as a spin-on element. (No Spin-on available for 3600 Family of Engines)

## NOTE:

The amount of SCA added at initial fill is not the same as the amount added at maintenance intervals.

The coolant additive elements can be used with any ethylene or propylene glycol type antifreeze which meets ASTM D4985 or ASTM D5345 Specifications.

## NOTE:

For use with standard heavy duty coolant only, not for use with Extended Life Coolant.

## PARTS NEEDED:

Cooling System Capacity		Liquid SCA at Initial Fill	Liquid SCA at Maintenance*	Spin-on SCA Maintenance Element*
Liters	Gallons			
22-30	(6-8)	3P-2044 (1)	6V-3542 (1)	111-2370 (1)
30-38	(8-10)	3P-2044 (1) 6V-3542 (1)	111-2372 (1)	111-2369 (1)
38-49	(10-13)	3P-2044 (1) 8T-1589 (1)	111-2372 (1)	111-2369 (1)
49-64	(13-17)	3P-2044 (2)	8T-1589 (1)	9N-3368 (1)
64-83	(17-22)	3P-2044 (2) 8T-1589 (1)	111-2372 (1) 6V-3542 (1)	111-2371 (1)
83-114	(22-30)	3P-2044 (3) 8T-1589 (1)	3P-2044 (1)	9N-3718 (1)
114-163	(30-43)	3P-2044 (5)	3P-2044 (1) 6V-3542 (1)	111-2371 (2)
163-242	(43-64)	3P-2044 (8)	3P-2044 (2)	9N-3718 (2)

\* Normal maintenance period is 250 hrs. See your Operation and Maintenance Manual for complete coolant maintenance instructions.

( ) Indicates quantity required.

# MAINTENANCE PARTS

DESCRIPTION	PART NUMBER	QTY	WHERE USED	PAGE
<b>AIR INLET AND EXHAUST SYSTEM</b>				
FILTER ELEMENT AS-AIR (PRIMARY)	6I - 2505	1	AIR CLEANER GP	160
FILTER ELEMENT AS-AIR (SECONDARY)	6I - 2506	1	AIR CLEANER GP	160
FILTER ELEMENT-AIR (ADVANCED EFFICIENCY)	311 - 4065	1	PRECLEANER GP	175
<b>BASIC ENGINE</b>				
PLUG-DRAIN (ENGINE OIL PAN)	109 - 5839	1	PAN GP-OIL	82
		1	PAN GP-OIL	85
		1	PAN GP-OIL	90
PLUG-DRAIN (ENGINE OIL)	109 - 5839	1	PAN GP-OIL	88
SEAL-INTEGRAL	155 - 9524	1	HOUSING GP-FRONT	71
SEAL-VALVE COVER	242 - 9537	1	COVER GP-VALVE MECHANISM	30
		1	COVER GP-VALVE MECHANISM	33
<b>COOLING SYSTEM</b>				
CAP AS-RADIATOR	031 - 1119	1	TANK GP-COOLANT	155
FILTER-WATER PUMP	136 - 3742	1	PUMP GP-WATER	146
REGULATOR-TEMPERATURE (92-DEG C) (COOLANT)	248 - 5513	2	LINES GP-WATER	140
SEAL (WATER TEMPERATURE REGULATOR)	166 - 2340	1	LINES GP-WATER	140

# MAINTENANCE PARTS

DESCRIPTION	PART NUMBER	QTY	WHERE USED	PAGE
<b>ELECTRICAL AND STARTING SYSTEM</b>				
BATTERY (12-VOLT, MAINTENANCE FREE, WET)	3T-5760	4	BATTERY & WIRING GP	226
BATTERY GP (12-VOLT, MAINTENANCE FREE, DRY) (COLD WEATHER)	115-2421	4	BATTERY GP	234
BELT-SERPENTINE	185-5872	1	ALTERNATOR GP-CHARGING	219
BELT-SERPENTINE (ALTERNATOR)	185-5872	1	ALTERNATOR GP-CHARGING	224
CAP AS-FILLER (BATTERY)	123-1373	6	BATTERY GP	234
CIRCUIT BREAKER AS (15-AMPERE) (MAIN POWER)	6T-3643	1	PANEL GP-FUSE	327
FUSE (10-AMPERE)	9W-1442	5	PANEL GP-FUSE	327
FUSE (15-AMPERE)	133-9012	1	RESISTOR GP-CAB HEATER	334
FUSE (175-AMPERE) (ALTERNATOR, MAIN)	239-8107	2	PANEL GP-FUSE	327
FUSE (20-AMPERE)	9W-1446	4	PANEL GP-FUSE	327
KEY (BATTERY DISCONNECT)	8H-5306	1	SWITCH GP-DISCONNECT	373
KEY AS-ELECTRONIC (SECURITY) (GRAY)	206-5165	1	INSTALLATION GP-SECURITY	265
KEY AS-ELECTRONIC (SECURITY) (YELLOW)	206-5162	2	INSTALLATION GP-SECURITY	265
LAMP	249-5592	1	LIGHTING GP-WARNING BEACON	314
LAMP (24-VOLT) (ACTION LIGHT)	7N-1996	1	WIRING GP-PLATFORM	402
LAMP (24-VOLT) (MSS)	240-5475	1	INSTALLATION GP-SECURITY	265
LAMP (24-VOLT, 21-WATT)	9X-4493	1	WIRING GP-CAB	384
LAMP AS-DOME	226-2811	1	WIRING GP-CAB	384
LAMP AS-FLOOD	213-4998	1	LAMP GP-FLOOD	270
LAMP AS-INDICATOR (REAR ACTION)	170-3461	1	WIRING GP-PLATFORM	402
LAMP-HALOGEN (24-VOLT, 35-WATT) (HID)	209-6638	1	WIRING GP-PLATFORM	406
LAMP-HALOGEN (24-VOLT, 65-WATT)	9X-3463	1	LAMP GP-FLOOD	272
SCREEN (PRECLEANER)	226-4909	1	LAMP GP-FLOOD	267
		1	LAMP GP-FLOOD	268
		1	LAMP GP-FLOOD	269
		1	LAMP GP-FLOOD	271
		1	LINES GP-ALTERNATOR AIR	317
<b>FRAME AND BODY</b>				
CAP	2B-0176	2	GUARD GP-RADIATOR	576
PLUG-DRAIN (TRANSMISSION)	106-8187	1	CASE & FRAME GP	518
		1	CASE & FRAME GP	520
		1	CASE & FRAME GP	521
SCREEN AS (LH)	274-3652	1	GRILL GP-RADIATOR	558
SCREEN AS (RH)	274-3653	1	GRILL GP-RADIATOR	558

# MAINTENANCE PARTS

DESCRIPTION	PART NUMBER	QTY	WHERE USED	PAGE
<b>FUEL SYSTEM</b>				
CAP AS-FILLER (FUEL TANK)	7X-7700	1	TANK GP-FUEL	208
		1	TANK GP-FUEL	211
FILTER AS-WATER SEP & FUEL (PRIMARY)	326-1644	1	FILTER GP-WATER SEP & FUEL	192
FILTER-FUEL (ADVANCED EFFICIENCY)	1R-0762	1	FILTER GP-SECONDARY FUEL	186
		1	FILTER GP-SECONDARY FUEL	188
		1	FILTER GP-SECONDARY FUEL	190
STRAINER-FUEL	9P-7121	1	TANK GP-FUEL	208
		1	TANK GP-FUEL	211
<b>HYDRAULIC SYSTEM</b>				
CAP-FILLER (HYDRAULIC TANK OIL)	7H-1447	1	TANK & MTG GP-HYDRAULIC	825
		1	TANK & MTG GP-HYDRAULIC	829
FILTER ELEMENT AS-OIL (ADVANCED EFFICIENCY)	1R-0777	1	TANK & MTG GP-HYDRAULIC	825
		1	TANK & MTG GP-HYDRAULIC	829
FILTER ELEMENT AS-OIL (FIRE RESISTANT FLUID)	104-6931	1	TANK & MTG GP-HYDRAULIC	825
		1	TANK & MTG GP-HYDRAULIC	829
FILTER ELEMENT AS-OIL (ULTRA HIGH EFFICIENCY)	139-1537	1	TANK & MTG GP-HYDRAULIC	825
		1	TANK & MTG GP-HYDRAULIC	829
FILTER-OIL (ULTRA HIGH EFFICIENCY)	126-1813	1	VALVE GP-BANK 3	842
		1	VALVE GP-BANK 3	844
		1	VALVE GP-BANK 3	846
		1	VALVE GP-BANK 3	848
		1	VALVE GP-BANK 3	850
		1	VALVE GP-BANK 3	852
		1	VALVE GP-BANK 4	856
		1	VALVE GP-BANK 4	859
PLUG-DRAIN (HYDRAULIC TANK)	9J-7031	1	TANK & MTG GP-HYDRAULIC	825
		1	TANK & MTG GP-HYDRAULIC	829
SCREEN (CONTROL VALVE MANIFOLD)	6E-5066	1	MANIFOLD GP-CONTROL	798
SCREEN (HYDRAULIC TANK)	6E-1752	1	TANK & MTG GP-HYDRAULIC	825
		1	TANK & MTG GP-HYDRAULIC	829
SCREEN (PILOT MANIFOLD)	6E-5066	1	MANIFOLD GP-CONTROL	800
STRAINER AS-OIL (HYDRAULIC TANK FILL)	5D-7927	1	TANK & MTG GP-HYDRAULIC	825
		1	TANK & MTG GP-HYDRAULIC	829
<b>LUBRICATION SYSTEM</b>				
BREATHER AS (CRANKCASE)	162-2266	1	BREATHER GP	115
CAP AS-FILLER (ENGINE OIL)	6N-2985	1	FILLER GP-ENGINE OIL	118
FILTER AS-ENGINE OIL (STANDARD EFFICIENCY)	1R-0716	1	FILTER GP-ENGINE OIL	119



# MAINTENANCE PARTS

DESCRIPTION	PART NUMBER	QTY	WHERE USED	PAGE
<b>OPERATOR STATION</b>				
BELT-SERPENTINE (A/C COMPRESSOR PULLEY)	219-8689	1	COMPRESSOR GP-REFRIGERANT	1028
BLADE AS-WIPER (330-MM) (DOOR, RH, LH)	128-5040	4	WIPER GP-WINDOW	1218
BLADE AS-WIPER (330-MM) (SIDE)	128-5040	4	WIPER GP-WINDOW	1215
BLADE AS-WIPER (400-MM) (FRONT)	6V-5851	1	WIPER GP-WINDOW	1215
		1	WIPER GP-WINDOW	1218
BLADE AS-WIPER (500-MM) (REAR)	5C-8811	1	WIPER GP-WINDOW	1215
BLADE AS-WIPER (600-MM) (RH, LH, REAR)	6V-6864	2	WIPER GP-WINDOW	1222
CAP-VENTED (WASHER FLUID)	8E-8292	1	TANK GP-WINDOW WASHER	1205
CIRCUIT BREAKER AS (15-AMPERE) (A/C, HEATER CONTROL)	6T-3643	1	LINES GP-AIR CONDITIONER	1116
CIRCUIT BREAKER AS (15-AMPERE) (AIR CONDITIONER)	6T-3643	1	LINES GP-AIR CONDITIONER	1122
		1	LINES GP-AIR CONDITIONER	1125
CIRCUIT BREAKER AS (15-AMPERE) (CONDENSOR FAN MOTOR)	6T-3643	1	LINES GP-AIR CONDITIONER	1107
		1	LINES GP-AIR CONDITIONER	1110
		1	LINES GP-AIR CONDITIONER	1113
		1	LINES GP-AIR CONDITIONER	1119
FILTER ELEMENT-AIR (ADVANCED EFFICIENCY)	311-4065	1	FILTER GP-CAB AIR	1091
FILTER ELEMENT-AIR (STANDARD) (CAB)	238-0479	1	HEATER GP-CAB	1097
FILTER ELEMENT-CAB AIR (STANDARD EFFICIENCY) (CAB)	209-8217	1	HEATER GP-CAB	1097
RECEIVER-REFRIGERANT DRYER	175-7162	1	LINES GP-AIR CONDITIONER	1107
		1	LINES GP-AIR CONDITIONER	1110
		1	LINES GP-AIR CONDITIONER	1113
		1	LINES GP-AIR CONDITIONER	1116
		1	LINES GP-AIR CONDITIONER	1119
		1	LINES GP-AIR CONDITIONER	1122
		1	LINES GP-AIR CONDITIONER	1125
		1	LINES GP-AIR CONDITIONER	1128
		1	LINES GP-AIR CONDITIONER	1131
		1	LINES GP-AIR CONDITIONER	1134
SEAT BELT GP (RETRACTABLE)	222-0345	1	SEAT GP	1187
		1	SEAT GP	1192

# MAINTENANCE PARTS

DESCRIPTION	PART NUMBER	QTY	WHERE USED	PAGE
<b>POWER TRAIN</b>				
BREATHER (POWER TRAIN OIL)	183-3873	1	LINES GP-POWER TRAIN OIL	447
			LINES GP-POWER TRAIN OIL	453
			LINES GP-POWER TRAIN OIL	459
			LINES GP-POWER TRAIN OIL	465
CAP AS-FILLER (POWER TRAIN OIL)	6N-2985	1	LINES GP-POWER TRAIN OIL	447
			LINES GP-POWER TRAIN OIL	453
			LINES GP-POWER TRAIN OIL	459
			LINES GP-POWER TRAIN OIL	465
FILTER ELEMENT AS-OIL (ADVANCED EFFICIENCY) (TORQUE CONVERTER CHARGING)	1R-0778	1	VALVE GP-PRIORITY	500
FILTER ELEMENT AS-OIL (FIRE RESISTANT FLUID) (TORQUE CONVERTER CHARGING)	4T-3132	1	VALVE GP-PRIORITY	501
FILTER ELEMENT AS-OIL (FIRE RESISTANT FLUID) (TRANSMISSION CHARGING)	4T-3132	1	VALVE GP-PRIORITY	500
FILTER ELEMENT AS-OIL (ULTRA HIGH EFFICIENCY) (TORQUE CONVERTER CHARGING)	132-8876	1	VALVE GP-PRIORITY	500
FILTER ELEMENT AS-OIL (ULTRA HIGH EFFICIENCY) (TRANSMISSION CHARGING)	132-8876	1	VALVE GP-PRIORITY	500
FILTER ELEMENT-OIL (ULTRA HIGH EFFICIENCY) (TORQUE CONVERTER CHARGING)	1R-1809	1	VALVE GP-PRIORITY	503
FILTER ELEMENT-OIL (ULTRA HIGH EFFICIENCY) (TRANSMISSION CHARGING)	1R-1809	1	VALVE GP-PRIORITY	503
PLUG-DRAIN (TORQUE CONVERTER)	4B-7739	1	TORQUE CONVERTER GP	493
PLUG-MAGNETIC (FINAL DRIVE, OIL FILL)	6V-3298	1	DRIVE GP-FINAL	432
			DRIVE GP-FINAL	434
			DRIVE GP-FINAL	436
			DRIVE GP-FINAL	439
			DRIVE GP-FINAL	441
			FINAL DRIVE GP	444
SCREEN AS (TORQUE CONVERTER SCAVENGE)	3T-6471	1	LINES GP-POWER TRAIN OIL	447
			LINES GP-POWER TRAIN OIL	453
			LINES GP-POWER TRAIN OIL	459
			LINES GP-POWER TRAIN OIL	465
SCREEN-SUCTION (POWER TRAIN OIL SUMP)	3S-3875	1	SCREEN GP	483
SCREEN-SUCTION (TRANSMISSION SCAVENGE)	8S-9130	1	CASE & PARTS GP-PLANETARY	419

# MAINTENANCE PARTS

DESCRIPTION	PART NUMBER	QTY	WHERE USED	PAGE
<b>STEERING AND BRAKING SYSTEM</b>				
FILTER-OIL (ADVANCED EFFICIENCY)	1G-8878	1	FILTER GP-OIL	698
		1	FILTER GP-OIL	699
FILTER-OIL (FIRE RESISTANT FLUID)	156-0214	1	FILTER GP-OIL	698
		1	FILTER GP-OIL	699
FILTER-OIL (ULTRA HIGH EFFICIENCY)	102-2828	1	FILTER GP-OIL	698
		1	FILTER GP-OIL	699
SEAL-O-RING	6V-6228	2	VALVE GP-PUMP CONTROL	722
<b>UNDERCARRIAGE</b>				
BEARING-SLEEVE (BURNISHED)	9W-9844	2	ROLLER GP-TRACK-DOUBLE FLANGE	646
		2	ROLLER GP-TRACK-DOUBLE FLANGE	647
		2	ROLLER GP-TRACK-SINGLE FLANGE	650
		2	ROLLER GP-TRACK-SINGLE FLANGE	651
BREATHER (PIVOT SHAFT OIL TANK)	9G-5127	1	LUBRICATION GP-PIVOT SHAFT	641
CAP-OIL FILLER (PIVOT SHAFT LUBRICATION)	221-0812	1	LUBRICATION GP-PIVOT SHAFT	641
PLUG-DRAIN (PIVOT SHAFT OIL FILL)	4T-2069	2	FRAME GP-TELESCOPING RECOIL	607
PLUG-DRAIN (PIVOT SHAFT OIL)	4T-2069	4	FRAME GP-TELESCOPING RECOIL	607
PLUG-DRAIN (PIVOT SHAFT, OIL DRAIN)	4T-2069	4	FRAME GP-TELESCOPING RECOIL	610
		4	FRAME GP-TELESCOPING RECOIL	615
PLUG-DRAIN (PIVOT SHAFT, OIL FILL)	4T-2069	2	FRAME GP-TELESCOPING RECOIL	610
		2	FRAME GP-TELESCOPING RECOIL	615
PLUG-DRAIN (RECOIL FRAME)	4T-2069	6	FRAME GP-TELESCOPING RECOIL	604
PLUG-DRAIN (RECOIL SPRING)	4T-2069	6	FRAME GP-TELESCOPING RECOIL	612

# INDEX

Name	Page	Name	Page
<b>A</b>			
ACCUMULATOR GP-PILOT OIL-CHARGED . . . .	729	ARM GP-WINDOW WIPER (RH, FRONT) . . . . .	1215
ACCUMULATOR GP-PILOT OIL- UNCHARGED . . . . .	728	AXLE GP . . . . .	411 412
ACCUMULATOR-REFRIGERANT . . . . .	1107	<b>B</b>	
	1110	BAR AR-STRIKER-LANDFILL . . . . .	513
	1113	BAR AR-STRIKER-REAR ONLY . . . . .	512
	1116	BAR AS-EQUALIZER . . . . .	595
	1119	BAR GP-EQUALIZER . . . . .	596
	1122	BAR GP-EQUALIZER- LOW GROUND PRESSURE . . . . .	597
	1125	BAR GP-STRIKER . . . . .	514
	1128	BASE GP-VALVE COVER & INJ HARN . . . . .	19 20 21
	1131	BATTERY & WIRING GP . . . . .	226 230
	1134	BATTERY (12-VOLT, MAINTENANCE FREE, WET) . . . . .	226 230
ACTUATOR GP-POWER . . . . .	510	BATTERY GP (12-VOLT, MAINTENANCE FREE, DRY) (COLD WEATHER) . . . . .	234
ACTUATOR GP-PUMP-STEERING . . . . .	695	BATTERY GP-COLD WEATHER . . . . .	234
	730	BEARING-SLEEVE (BURNISHED) . . . . .	646 647 650 651
ADAPTER GP-FAST FILL FUEL . . . . .	180	BELT-SERPENTINE . . . . .	219 224
	181	BELT-SERPENTINE (A/C COMPRESSOR PULLEY) . . . . .	1028
ADAPTER GP-MOTOR . . . . .	731	BELT-SERPENTINE (ALTERNATOR) . . . . .	217
ADAPTER GP-PUMP DRIVE . . . . .	18	BLADE & EDGE GP-ANGLING . . . . .	941
ADJUSTER GP-SEAT . . . . .	1006	BLADE & EDGE GP-SEMI-UNIVERSAL . . . . .	942 943 944 947 948
AFTERCOOLER AS . . . . .	158	BLADE & EDGE GP-SEMI-UNIVERSAL- ACCUGRADE . . . . .	947
AFTERCOOLER GP-AIR . . . . .	157 158	BLADE & EDGE GP-SEMI-UNIVERSAL- LANDFILL . . . . .	946 948
AIR CLEANER GP . . . . .	159 160	BLADE & EDGE GP-SEMI-UNIVERSAL-LGP . . . . .	948
AIR COMPRESSOR GP-SEAT . . . . .	1008	BLADE & EDGE GP-SEMI-UNIVERSAL- LOW GROUND PRESSURE . . . . .	945
AIR COMPRESSOR GP-SEAT-HEAVY-DUTY . . . . .	1007	BLADE & EDGE GP-UNIVERSAL . . . . .	949 950 951 952
AIR CONDITIONER AR . . . . .	1009	BLADE & EDGE GP-UNIVERSAL- ACCUGRADE . . . . .	951
AIR CONDITIONER AR- REMOTE MOUNTED CONDENSER . . . . .	1009	BLADE & EDGE GP-UNIVERSAL-LANDFILL . . . . .	949
AIR CONDITIONER AR- ROPS MOUNTED CONDENSER . . . . .	1009		
ALARM GP . . . . .	227 231		
ALARM GP-FAULT INDICATOR . . . . .	214		
ALTERNATOR GP-CHARGING . . . . .	215 217 219 221 222 224		
ALTERNATOR GP-CHARGING (24-VOLT, 150-AMPERE) . . . . .	224		
ARM GP-WINDOW WIPER (DOOR, LH) . . . . .	1218		
ARM GP-WINDOW WIPER (DOOR, RH) . . . . .	1218		
ARM GP-WINDOW WIPER (FRONT) . . . . .	1218		
ARM GP-WINDOW WIPER (FRONT, CENTER) . . . . .	1215		
ARM GP-WINDOW WIPER (LH, FRONT) . . . . .	1215		
ARM GP-WINDOW WIPER (REAR) . . . . .	1215		
ARM GP-WINDOW WIPER (REAR, LH) . . . . .	1222		
ARM GP-WINDOW WIPER (REAR, RH) . . . . .	1222		