



Parts Manual



See "General Information"
for New Parts Manual
Features.

416E Backhoe Loader Single Tilt, Center Pivot

CBD1-Up (Machine)
MFG1-Up (Machine)
C4Z1-Up (Engine)
CRS1-Up (Engine)
G4D1-Up (Engine)

Powered By 3054C and C4.4 Engine

SAFETY.CAT.COM

Product and Dealer Information

Note: For product identification plate locations, see the section "Product Identification Information" in the Operation and Maintenance Manual.

Delivery Date: _____

Product Information

Model: _____

Product Identification Number: _____

Engine Serial Number: _____

Transmission Serial Number: _____

Generator Serial Number: _____

Attachment Serial Numbers: _____

Attachment Information: _____

Customer Equipment Number: _____

Dealer Equipment Number: _____

Dealer Information

Name: _____ Branch: _____

Address: _____

Dealer Contact

Phone Number

Hours

Sales: _____

Parts: _____

Service: _____

MEMORANDA

TABLE OF CONTENTS

Name	Page	Name	Page
GENERAL INFORMATION	A5	COOLER GP-ENGINE OIL	119
REPAIR ALTERNATIVES	A8	COOLER GP-FLTR BASE & ENG OIL ...	122
SUPPLEMENTAL COOLANT ADDITIVES	A9	FAN GP-SUCTION	128
MAINTENANCE PARTS	A10	LINES GP-POWER TRAIN COOLER	134
INDEX	A14	LINES GP-RADIATOR	136
MACHINE ARRANGEMENT	1	LINES GP-TRANSMISSION COOLER ...	138
BACKHOE AR-EXTENDABLE STICK	1	MOUNTING & LINES GP-RADIATOR ...	140
BACKHOE AR-STANDARD STICK	1	MOUNTING GP-RAD & OIL COOLER ...	141
CHASSIS AR	2	PUMP GP-WATER	143
COMMON AR	3	RADIATOR & HYD OIL COOLER GP	149
DISTRIBUTION AR	4	RADIATOR & OIL COOLER GP	151
DISTRIBUTION AR	9	TANK GP-EXPANSION	155
DISTRIBUTION AR	10	AIR INLET AND EXHAUST SYSTEM	156
DRIVE AR-BACKHOE LOADER	16	AIR CLEANER GP	156
LOADER AR	17	CONNECTION GP-INLET	167
ENGINE ARRANGEMENT	19	COVER GP-INLET MANIFOLD	168
ENGINE AR	19	EXTENSION GP-EXHAUST	171
ENGINE AR-PRIMARY	23	INDICATOR GP-AIR FILTER CHANGE	172
BASIC ENGINE	27	LINES GP-AIR	174
CAMSHAFT GP	27	MANIFOLD GP-EXHAUST	175
COVER GP-VALVE MECHANISM	29	MUFFLER & CONVERTER	176
CRANKSHAFT GP	41	MUFFLER GP	177
CYLINDER BLOCK GP	50	TURBOCHARGER GP	180
CYLINDER HEAD GP	57	FUEL SYSTEM	184
DRIVE GP-FAN	63	CONTROL GP-GOVERNOR	184
FLYWHEEL GP	65	FILTER GP-WATER SEP & FUEL	192
HOUSING GP-FLYWHEEL	67	LINES GP-FUEL	193
HOUSING GP-FRONT	69	LINES GP-FUEL FILTER	203
LIFTING GP-ENGINE	73	PUMP GP-FUEL INJECTION	204
MOUNTING GP-ENGINE	75	PUMP GP-FUEL PRM & PRIM FILTER	214
MOUNTING GP-ENGINE & XMSN	77	TANK & MTG GP-FUEL	218
PAN GP-OIL	79	TANK GP-FUEL	219
PISTON & ROD GP	85	ELECTRICAL AND STARTING SYSTEM	223
PLUG GP-CYLINDER HEAD	93	ALTERNATOR GP-CHARGING	223
PLUG GP-ENGINE	94	BATTERY & WIRING GP	226
PULLEY GP-CRANKSHAFT	99	ELECTRONICS GP-	
ROCKER ARM GP	102	COMMUNICATION	246
VALVE MECHANISM GP	104	GLOW PLUG GP	247
LUBRICATION SYSTEM	107	HEATER GP-JACKET WATER	249
BREATHER GP	107	INSTALLATION GP-COMMUNICATION	250
FILLER GP-ENGINE OIL	110	LAMP GP-FLOOD	254
GAUGE GP-OIL LEVEL & FILLER	111	LAMP GP-WARNING BEACON	257
PUMP GP-ENGINE OIL	113	LIGHTING GP-FLOOD & SIGNAL	259
COOLING SYSTEM	115	LIGHTING GP-WARNING BEACON	266
CONNECTION GP-WATER	115	PANEL GP-FUSE	268
COOLER AS-OIL	118	RELAY GP	269
		STARTING MOTOR GP-ELECTRIC	273
		SWITCH GP-ALL WHEEL DRIVE	277
		SWITCH GP-DIFFERENTIAL LOCK	278
		SWITCH GP-DISCONNECT	279
		SWITCH GP-PRESSURE	280
		WIRING GP-AIR CONDITIONER	282

TABLE OF CONTENTS

Name	Page	Name	Page
WIRING GP-CONSOLE	291	FENDER GP-FRONT	474
WIRING GP-ENGINE	299	FENDER GP-REAR	475
WIRING GP-HEATER	313	FLOORPLATE GP	480
WIRING GP-KICKOUT & POSITIONER	317	FRAME AS-SWING	483
WIRING GP-PLATFORM	323	FRAME GP-LOADER	484
WIRING GP-REAR	344	FRAME GP-SWING	494
WIRING GP-RIDE CONTROL	345	GUARD GP-CYLINDER	500
POWER TRAIN	347	GUARD GP-DRIVE SHAFT	502
AXLE GP-DRIVE & STEERING	347	GUARD GP-RADIATOR	503
AXLE GP-REAR	350	HOOD & GUARD GP	504
CASE AS-TRANSMISSION	353	HOOD GP-ENGINE	512
CASE GP-TRANSMISSION	360	HYDRAULIC SYSTEM	520
DIFFERENTIAL & BEVEL GEAR GP	363	ACCUMULATOR GP-RIDE CONTROL	520
DIFFERENTIAL GP	365	CONTROL AR-RIDE	524
DRIVE GP-FLEXIBLE COUPLING	367	CONVERSION AR-CUSHION SWING	525
FILLER GP-POWER TRAIN OIL	368	COOLER GP-HYD & XMSN OIL	527
FLANGE GP-WHEEL	375	CYLINDER & LINES GP-THUMB	528
HOUSING & FLANGE GP-AXLE	377	CYLINDER GP-BACKHOE BUCKET	531
HOUSING GP-AXLE	381	CYLINDER GP-BOOM	535
LINES GP-POWER TRAIN OIL	383	CYLINDER GP-HYDRAULIC	537
MOUNTING GP-AXLE	384	CYLINDER GP-LIFT	541
MOUNTING GP-TRANSMISSION	385	CYLINDER GP-MULTIPURPOSE	544
PLANETARY GP-FINAL DRIVE	386	BUKT	547
POWER TRAIN AR	388	CYLINDER GP-STABILIZER	547
SHAFT GP-DRIVE	392	CYLINDER GP-STICK	553
SHAFT GP-INPUT	393	CYLINDER GP-THUMB	555
SHAFT GP-OUTPUT	397	CYLINDER GP-TILT	556
TRANSMISSION & MOUNTING GP	401	DRIVE & MTG GP-PUMP	558
TRANSMISSION AR-DIRECT DRIVE	403	FASTENER GP-VALVE	559
TRANSMISSION GP-DIRECT DRIVE	404	FILTER GP-OIL	560
VALVE GP-RELIEF	424	FITTING GP-HYDRAULIC	561
VALVE GP-TIRE	425	HYDRAULIC AR	562
WHEEL & TIRE AR	426	KICKOUT & POSITIONER GP	563
WHEEL & TIRE GP	428	LINES GP-BACKHOE AUXILIARY	569
BRAKING SYSTEM	440	LINES GP-BOOM	599
CONTROL GP-PARKING BRAKE	440	LINES GP-BUCKET	605
CONTROL GP-SERVICE BRAKE	442	LINES GP-CONNECTING	620
CYLINDER GP-BRAKE	448	LINES GP-DRAIN	621
LEVER GP-HAND CONTROL	450	LINES GP-EXTENDABLE STICK	622
RESERVOIR GP-BRAKE	451	LINES GP-HYDRAULIC OIL COOLER	626
STEERING SYSTEM	453	LINES GP-LIFT CYLINDER	630
AXLE GP-FRONT	453	LINES GP-LOADER AUXILIARY	634
KNOB GP-STEERING	455	LINES GP-MULTIPURPOSE BUCKET	638
LINES GP-STEERING	456	LINES GP-PILOT	648
PUMP GP-METERING	464	LINES GP-PUMP	652
FRAME AND BODY	465	LINES GP-RIDE CONTROL	654
BOX GP-BATTERY	465	LINES GP-STABILIZER	660
COUNTERWEIGHT GP	468	LINES GP-STICK	664
DOOR GP-BATTERY	471	LINES GP-SWING	667
DRAWBAR GP	472	LINES GP-TILT CYLINDER	668
EXTENSION GP-FENDER	473	MANIFOLD GP-CONTROL	672
		MANIFOLD GP-RIDE CONTROL	674
		MOUNTING GP-BANK VALVE	675
		MOUNTING GP-CYLINDER	679

TABLE OF CONTENTS

Name	Page	Name	Page
MOUNTING GP-LINES	681	OPERATOR STATION	897
PUMP GP-PISTON	684	ADJUSTER GP-SEAT	897
SHAFT GP-PUMP DRIVE	691	AIR CONDITIONER & MOUNTING GP	898
TANK & MTG GP-HYDRAULIC	692	CAB AR-ENCLOSED ROPS	901
VALVE AR-BANK 2	696	CAB AS	905
VALVE AR-BANK 3	696	CAB GP-ENCLOSED ROPS	908
VALVE AR-BANK 6	696	CANOPY AR-OPEN ROPS	922
VALVE AR-BANK 7	697	CANOPY AS	926
VALVE AR-BANK 8	697	CANOPY GP-OPEN ROPS	927
VALVE GP-BANK 2	698	COMPARTMENT GP-LITERATURE	932
VALVE GP-BANK 3	699	COMPRESSOR & MTG GP-REFRIG	933
VALVE GP-BANK 6	700	COMPRESSOR GP-REFRIGERANT	937
VALVE GP-BANK 7	702	CONDENSER & MTG GP- REFRIGERANT	940
VALVE GP-BANK 8	704	CONSOLE GP-OPERATOR	942
VALVE GP-CONTROL	706	CONTROL & MTG GP-STABILIZER	948
VALVE GP-PUMP CONTROL	720	CONTROL GP-HYDRAULIC HAND	954
VALVE GP-SHUTTLE	721	CONTROL GP-HYDRAULIC PEDAL	968
IMPLEMENTS	722	CONTROL GP-STEERING	974
ARM GP-LIFT	722	CONTROL GP-TRANSMISSION	979
BOOM & BEARING AS	724	COVER GP-CAB	981
BOOM GP	725	COVER GP-WIPER MOTOR	982
BRACE GP-LIFT CYLINDER	726	DOOR GP-CAB	983
GUARD GP-BOOM	727	FLOOR MAT GP	991
LINKAGE GP-BACKHOE BUCKET	729	HEATER & AIR CONDITIONER GP	993
LINKAGE GP-LOADER BUCKET	731	HEATER GP-CAB	995
LOCK GP-TRANSPORT	734	LATCH GP-CAB DOOR & WINDOW	1003
MOUNTING GP-STICK	738	LEVER GP-GOVERNOR	1005
PAD & GUARD GP-STABILIZER	739	LINER GP-CAB	1006
PAD & MTG GP-STABILIZER	762	LINES GP-HEATER	1010
PAD GP-STABILIZER	769	LINES GP-HEATER & AIR COND	1011
STABILIZER GP-BACKHOE	771	MIRROR GP-REAR VIEW	1015
STICK AS	773	MOTOR GP-WINDOW WIPER	1018
STICK GP	774	MOUNTING GP-CAB	1020
STICK GP-HOE	778	PEDAL GP-GOVERNOR	1021
WORK TOOLS	780	RADIO GP-COMMUNICATION	1023
ADJUSTER GP-MANUAL	780	ROOF GP-CAB	1024
BUCKET AR-MULTIPURPOSE	781	SEAT BELT GP	1027
BUCKET AS-GENERAL PURPOSE	783	SEAT GP	1029
BUCKET AS-HOE	788	SEAT GP-STATIC	1032
BUCKET GP-GENERAL PURPOSE	827	SEAT GP-SUSPENSION	1034
BUCKET GP-HOE	832	SUSPENSION GP-SEAT	1036
BUCKET GP-MULTIPURPOSE	855	SWIVEL & SLIDE GP-SEAT	1043
BULLDOZER AS	865	SWIVEL GP-SEAT	1045
CLAM AS-MULTIPURPOSE BUCKET	869	TACHOMETER GP-ELECTRIC	1046
COUPLER AR-QUICK	872	TRIM GP-CAB	1047
COUPLER GP-QUICK	873	WASHER GP-WINDOW	1049
EDGE GP-CUTTING	878	WINDOW GP-CAB	1053
FORK GP	879	WINDOW GP-DOOR	1062
MOUNTING GP-BUCKET	880	WIPER & WASHER GP-WINDOW	1064
PIN GP-COUPLER	881	WIPER GP-WINDOW	1068
THUMB AR	883	SERVICE EQUIPMENT AND SUPPLIES	1072
THUMB GP	894	FILM GP	1072
TOOTH GP-UNI	896	LINK GP-SHIPPING	1074

TABLE OF CONTENTS

Name	Page	Name	Page
LOCK GP-VANDALISM	1075		
PLATE & FILM GP	1075		
PROTECTION GP-VANDALISM	1081		
TRANSPORT AR-MACHINE	1082		
TRANSPORT GP-MACHINE	1083		
PART NUMBER INDEX	B1		

GENERAL INFORMATION

1. MACHINE IDENTIFICATION

Caterpillar machines are identified by Product Identification Numbers (PIN). Some components included in a machine may be identified by Serial Numbers (S/N). Typical components that will be serialized include engines, transmissions, bulldozers, and rippers. The machine and engine are further identified by arrangement numbers and in some cases modification numbers. These numbers are shown on the product identification plate(s) and on the master plate in the operator's compartment.

Caterpillar dealers need all of these numbers to determine accurate parts identification.

New Feature

Effective First Quarter 2001 the Caterpillar Product Identification Number (PIN) changed from 8 to 17 characters. In an effort to provide uniform equipment identification, Caterpillar and other construction equipment manufacturers are moving to comply with the latest version of the product identification numbering standard. Non-road machine PINs are defined by ISO 10261. The new PIN format will apply to all Caterpillar machines and generator sets. The PIN plates and frame marking will display the 17 character PIN. The new format will look like the following:

CAT 0789BG 6SL12345

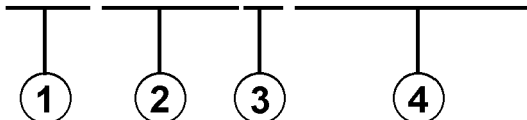

The diagram shows the PIN format: *CAT 0789BG 6SL12345*. Below the first four characters (C, A, T, 0), there are four vertical lines leading to circles containing the numbers 1, 2, 3, and 4 respectively.

Where:

1. Caterpillar's World Manufacturing Code (characters 1-3)
2. Machine Descriptor (characters 4-8)
3. Check Character (character 9)
4. Machine Indicator Section (MIS) or Product Sequence Number (characters 10-17). These were previously referred to as the Serial Number.

Machines and generator sets produced before First Quarter 2001 will maintain their 8 character PIN format.

Components such as engines, transmissions, axles, etc. and work tools will continue to use an 8 character Serial Number (S/N).

2. ORDERING PARTS

WARNING

When replacement parts are required for this product Caterpillar recommends using Caterpillar replacement parts or parts with equivalent specifications including, but not limited to, physical dimensions, type, strength and material.

Failure to heed this warning can lead to premature failures, product damage, personal injury or death.

Quality Caterpillar replacement parts are available from Caterpillar dealers throughout the world. Their parts inventories are up to date and include all parts normally required to protect your investment in Caterpillar machines. Dealers may offer repair kits or remanufactured parts to allow selection of the most effective repair alternative for a particular situation. When ordering parts, your order should specify the quantity, part number, part name, and the serial number/product identification number of the machine for which the parts are needed.

3. PARTS MANUAL ORGANIZATION

Product information in this manual is presented as "information elements" that represent all of the components for the specific model. Engine Arrangement and Seat Group are examples of information elements. The information elements are organized alphabetically by part name and secondarily by part number within each major section of the manual.

4. TABLE OF CONTENTS

A table of contents (TOC) is found at the beginning of the manual. The TOC lists each section of the manual with a complete list of all information elements organized as they appear in the manual. Page numbers are provided for quick reference to detailed parts identification illustrations and serviceable consist lists.

5. MAINTENANCE PARTS INDEX

The Maintenance Parts Index, located near the beginning of the manual, references most frequently used maintenance part numbers, providing description, quantity, usage and page number. This information is organized alphabetically by part description.

GENERAL INFORMATION

6. INDEX

The index located near the front of the manual is an alphabetical listing of all information elements included in the manual. Page numbers are provided for quick reference to detailed parts identification illustrations and serviceable consist lists.

7. PART NUMBER INDEX

A numerical index listing all part numbers and the corresponding page number(s) appears at the back of the manual.

8. CAPTIONS

Captions located at the beginning of each information element identify the part number and part name along with additional descriptive information. PIN and S/N information found in each caption should be used to select correct information for a specific machine. Field replacement options, identification of optional attachment components, and where used ("part of") information is also provided.

The first line of a caption is shown in larger type font to indicate the beginning of an information element. Captions for additional pages that may be required to illustrate an information element will be shown in standard type font and will include the term (*contd.*) .

9. NON-SERVICED PARTS

In some instances it is necessary to display non-serviced parts that are a link to a lower level serviceable consist lists. These non-serviced part numbers are shown in *italic* type indicating that they are not available.

10. PARTS LIST REFERENCE NUMBERS

Numbers shown in the Ref No column correspond to numbers used in the associated graphic(s). An alphabetic suffix may be added to a reference number to identify lower level consist items. Numbers shown in the Graphic Ref column refer to the graphic number identifier displayed in the lower left corner of each illustration. The Graphic Ref number may be used in combination with the item Ref No to determine the correct part number. There may be intentional omission of a Ref No in a consist list as information is updated to reflect the latest serviceable part numbers.

11. INDENTED PART NAMES

When a part name is indented in a parts list, it is part of (included in) the group or assembly under which it is indented.

12. ILLUSTRATION REFERENCE LETTERS

When necessary, illustrations contain reference letters (A, B, C etc.) that are intended to track lines and harnesses from one point to another. They are also used to show where to reconnect illustrations that have been separated.

13. ABBREVIATIONS AND SYMBOLS

O.D. – Outside Diameter
I.D. – Inside Diameter
A – Not Part Of This Group
B – Use As Required
C – Change From Previous Type
D – Order By The Meter
E – Order By The Centimeter
F – Not Shown
G – Order By The Inch
I – Refer To Hydraulic Information System
M – Metric Part
R – Remfg Part May Be Available
Y – Separate Illustration
Z – Not Serviced Separately

 **New Feature**

14. DESCRIPTION OF TYPE CHANGES

Type - A type is defined as any configuration change that requires an additional Information Element for an Arrangement, Group, or Assembly. If serial number breaks for types are not available, a type # (Type 1, Type 2, etc.) will be displayed in the caption. These "type" changes are identified with a "C" note (change from previous type) in the Parts List. Only the "types" that apply to this Parts Manual will be included. Additional types may exist causing "C" notes to appear on an Information Element when no other types are shown.

15.<END>

This symbol indicates the end of an information element.

NOTE:

Continuing improvement and advancement of product design may cause changes to your machine which may not be included in this publication. Whenever a question arises regarding your Caterpillar product or this publication, please consult your Caterpillar dealer for the latest available information.

GENERAL INFORMATION

FRAME AND BODY					
8E-3299 PLATFORM GP-CAB					
PIN 3841-99999					
100090751					
NOTE	REF NO	GRAPHIC REF	PART NUMBER	QTY	PART NAME & PRODUCT LEVEL
	1		31-2993	1	PLATE AS
	2		68-2996	85	BOLT (3/8-18X.750IN)
	3		6F-1078	41	WASHER-HARD (3MM THK)
	4		6F-1444	2	SUPPORT AS-FOOT
	5		7F-2229	19	BOLT (1/2-13X1IN)
	6		7F-2229	19	WASHER-HARD (4MM THK)
	8		6E-8136	2	COVER AS-LH
	9		6F-9278	6	NUT-WELD (3/8-16 THD)
	10		1F-8188	1	CLIP
	11		7B-2411	4	COVER
	12		6J-8486	18	SCREW-HEAD (3/8-18X.875IN)
	13		7F-0774	1	COVER
	14		6E-8272	1	GASKET
	15		6E-2890	1	GASKET
	16		31-3496	1	HANDHOLD
	17		6F-9278	8	NUT-WELD (3/8-16 THD)
	18		6E-8278	1	GASKET
	19		71-0131	1	FLOORPLATE AS
	20		1F-0758	4	NUT-WELD (1/2-13 THD)
	21		7V-8087	1	PLUS-BUTTON
	22		71-0136	1	PLATE AS
	23		6F-9278	5	NUT-WELD (3/8-16 THD)
	24		71-0509	1	COVER
	25		71-0770	1	GASKET
	26		31-2981	1	PLATE AS
	27		81-8484	4	BOLT (1/4-20X.625IN)
	28		81-8484	4	WASHER-HARD (2MM THK)
	29		61-8484	1	FLOOR MAT
	30		6E-8484	1	MODULE AS-OPERATOR
	31		31-3496	1	HANDHOLD
	32		6F-0271	2	PLUS
	33		81-8384	4	BOLT (1/4-20X.625IN)
	34		6F-4208	4	WASHER-HARD (2MM THK)
	35		6F-5982	17	BOLT (3/8-18X.750IN)
	36		6F-1078	21	WASHER-HARD (3MM THK)
	37		71-0136	1	SEAL
	38		7A-0378	2	BOLT (3/4-10X5IN)
	39		7A-0382	2	WASHER-HARD (5MM THK)
	40		31-3489	2	PLATE AS
	41		31-3490	1	PLATE AS
	42		7B-0888	8	SPACER
	43		31-3581	1	SEAL
	44		7B-8817	1	GASKET
	45		7B-8818	1	COVER AS
	46		6F-8278	2	WASHER
	47		6F-9228	2	SCREW-KNOBBLED
	48		6F-3428	1	COVER
	49		6E-8887	1	COVER
	50		6E-9021	8	SCREW-BOCKET HEAD
	51		6F-3148	8	MOUNTING
	52		6F-0087	2	PLATE
	53		7A-0389	2	BOLT (1/2-8X5IN)
	54		7A-0373	2	WASHER-HARD
	55		4L-6484	4	BOLT (3/8-18X1.02IN)
	56		31-6783	1	COVER

12 FRAME AND BODY 1 of 4 SELP 170-01

FRAME AND BODY					
8E-3299 PLATFORM GP-CAB (contd.)					
100090751					
NOTE	REF NO	GRAPHIC REF	PART NUMBER	QTY	PART NAME & PRODUCT LEVEL
	41		6E-8818	1	COVER
	42		71-0134	1	PLATE
	43		71-0128	1	GASKET
	44		7B-8724	1	GASKET
	45		7B-8723	1	COVER
	46		6F-1069	2	PLUS-BUTTON

M-METRIC PART

SELPA670-01 2 of 4 FRAME AND BODY 13

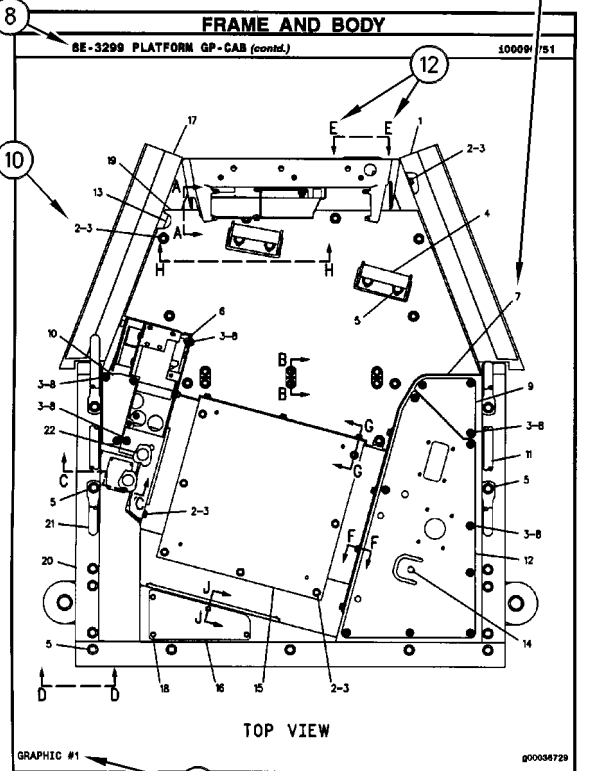

14 FRAME AND BODY 3 of 4 SELPA670-01

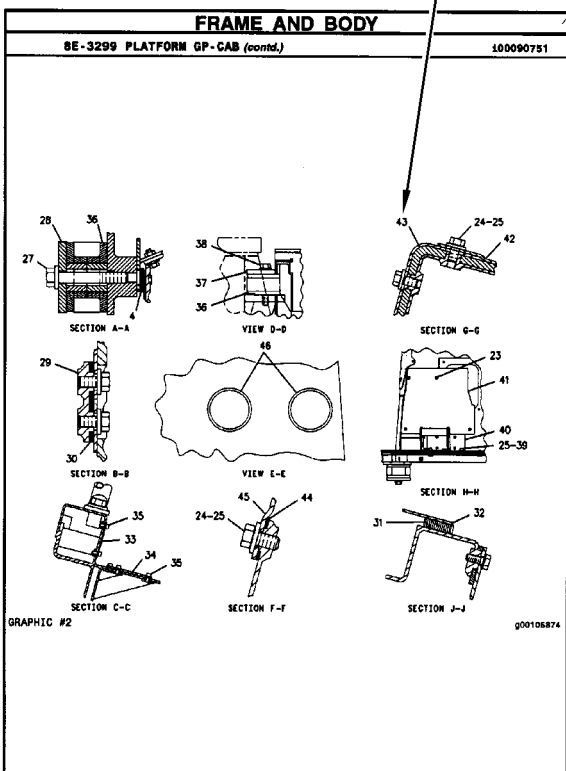

SELPA670-01 4 of 4 FRAME AND BODY 15

REPAIR ALTERNATIVES

REMANUFACTURED COMPONENTS

As an option when making repairs consider Caterpillar Remanufactured Components. Components that are available through the Caterpillar Remanufactured Program are identified three ways in the parts book:

- with the letter R in the note field of the parts list
- with an R* at the beginning of the first line of the caption
- with an *R at the end of the first line of the caption

Typical components included in the Remanufacturing Program include:

ALTERNATORS
CONNECTING RODS
CRANKSHAFTS - UNDERSIZE
CRANKSHAFTS - UPGRADE TO NEW
CYLINDER HEADS
ELECTRONIC CONTROL MODULES (ECM)
ELECTRONIC SENSORS
FUEL INJECTORS
FUEL NOZZLES
FUEL PUMPS
GOVERNORS
OIL PUMPS
PISTONS
SHORT BLOCKS
STARTERS
TURBOCHARGERS - COMPLETE
TURBOCHARGER CARTRIDGES
WATER PUMPS

Caterpillar Remanufactured engines for many engine arrangements are also available.

SUPPLEMENTAL COOLANT ADDITIVES

CUSTOMER BENEFITS:

Protects against cavitation, foam, erosion, corrosion, and scale buildup in cooling systems.

- Provides measured coolant conditioner.

DESCRIPTION:

Additives deplete from the coolant with normal operation. For this reason, Supplemental Coolant Additives (SCA) must be added to all heavy duty coolants at regular intervals. In addition, when not using a fully formulated, pre-charged antifreeze, like Caterpillar's DEAC, an initial charge of SCA must be added to the cooling system. The amount of SCA added to the system is dependent on the capacity of the system.

The SCA for initial fill is provided as a liquid. SCA's for maintenance intervals are available in liquid form and as a spin-on element. (No Spin-on available for 3600 Family of Engines)

NOTE:

The amount of SCA added at initial fill is not the same as the amount added at maintenance intervals.

The coolant additive elements can be used with any ethylene or propylene glycol type antifreeze which meets ASTM D4985 or ASTM D5345 Specifications.

NOTE:

For use with standard heavy duty coolant only, not for use with Extended Life Coolant.

PARTS NEEDED:

Cooling System Capacity		Liquid SCA at Initial Fill	Liquid SCA at Maintenance*	Spin-on SCA Maintenance Element*
Liters	Gallons			
22-30	(6-8)	3P-2044 (1)	6V-3542 (1)	111-2370 (1)
30-38	(8-10)	3P-2044 (1) 6V-3542 (1)	111-2372 (1)	111-2369 (1)
38-49	(10-13)	3P-2044 (1) 8T-1589 (1)	111-2372 (1)	111-2369 (1)
49-64	(13-17)	3P-2044 (2)	8T-1589 (1)	9N-3368 (1)
64-83	(17-22)	3P-2044 (2) 8T-1589 (1)	111-2372 (1) 6V-3542 (1)	111-2371 (1)
83-114	(22-30)	3P-2044 (3) 8T-1589 (1)	3P-2044 (1)	9N-3718 (1)
114-163	(30-43)	3P-2044 (5)	3P-2044 (1) 6V-3542 (1)	111-2371 (2)
163-242	(43-64)	3P-2044 (8)	3P-2044 (2)	9N-3718 (2)

* Normal maintenance period is 250 hrs. See your Operation and Maintenance Manual for complete coolant maintenance instructions.

() Indicates quantity required.

MAINTENANCE PARTS

DESCRIPTION	PART NUMBER	QTY	WHERE USED	PAGE
AIR INLET AND EXHAUST SYSTEM				
FILTER ELEMENT-AIR (PRIMARY)	293 - 4053	1	AIR CLEANER GP	164
FILTER ELEMENT-AIR (SECONDARY)	227 - 7449	1	AIR CLEANER GP	164
BASIC ENGINE				
GASKET (VALVE COVER)	225 - 6451	1	COVER GP-VALVE MECHANISM	29
		1	COVER GP-VALVE MECHANISM	31
		1	COVER GP-VALVE MECHANISM	33
		1	COVER GP-VALVE MECHANISM	35
		1	COVER GP-VALVE MECHANISM	37
		1	COVER GP-VALVE MECHANISM	39
PLUG-DRAIN (ENGINE OIL)	7C - 0351	2	PAN GP-OIL	79
		2	PAN GP-OIL	81
		2	PAN GP-OIL	83
COOLING SYSTEM				
BELT-SERPENTINE	212 - 9353	1	FAN GP-SUCTION	133
CAP AS-COOLANT TANK	251 - 3227	1	LINES GP-RADIATOR	136
CAP AS-COOLANT TANK (RADIATOR)	251 - 3227	1	TANK GP-EXPANSION	155
HOSE-RADIATOR (LOWER)	210 - 6139	1	MOUNTING GP-RAD & OIL COOLER	141
HOSE-RADIATOR (UPPER)	210 - 6141	1	MOUNTING GP-RAD & OIL COOLER	141
	325 - 5855	1	LINES GP-RADIATOR	136
REGULATOR GP-TEMPERATURE (INCLUDES CONNECTOR)	254 - 2267	1	CONNECTION GP-WATER	115
REGULATOR GP-TEMPERATURE (INCLUDES CONNECTOR) (WATER)	254 - 2267	1	CONNECTION GP-WATER	117
V-BELT (AIR CONDITIONER)	1P - 4334	1	FAN GP-SUCTION	131
	3P - 0130	1	FAN GP-SUCTION	129
V-BELT SET (INCLUDES 2-BELTS)	130 - 3216	1	FAN GP-SUCTION	128
V-BELT SET (INCLUDES 2-BELTS) (ALTERNATOR)	130 - 3216	1	FAN GP-SUCTION	129
		1	FAN GP-SUCTION	131
ELECTRICAL AND STARTING SYSTEM				
BATTERY (12-VOLT, MAINTENANCE FREE)	230 - 6368	1	BATTERY & WIRING GP	226
		1	BATTERY & WIRING GP	228
		1	BATTERY & WIRING GP	233
		1	BATTERY & WIRING GP	236
		1	BATTERY & WIRING GP	238
		1	BATTERY & WIRING GP	240
BATTERY (12-VOLT, MAINTENANCE FREE, WET)	3T - 5760	1	BATTERY & WIRING GP	229
		1	BATTERY & WIRING GP	231
		1	BATTERY & WIRING GP	242
		1	BATTERY & WIRING GP	244
BELT-DRIVE	9X - 8139	1	LAMP GP-WARNING BEACON	257
		1	LAMP GP-WARNING BEACON	258
FLASHER AS (12-VOLT)	7T - 4848	1	WIRING GP-PLATFORM	323
		1	WIRING GP-PLATFORM	327
		1	WIRING GP-PLATFORM	330
		1	WIRING GP-PLATFORM	334
FLASHER AS (12-VOLT) (HAZARD)	7T - 4848	1	WIRING GP-PLATFORM	339
FUSE (10-AMPERE)	113 - 8490	11	PANEL GP-FUSE	268

MAINTENANCE PARTS

DESCRIPTION	PART NUMBER	QTY	WHERE USED	PAGE
	3K-8782	1	LAMP GP-WARNING BEACON	257
FUSE (15-AMPERE)	113-8491	13	PANEL GP-FUSE	268
FUSE (20-AMPERE)	113-8492	10	PANEL GP-FUSE	268
FUSE (40-AMPERE)	278-6377	1	RELAY GP	269
		1	RELAY GP	272
FUSE (60-AMPERE)	267-2701	2	RELAY GP	270
		1	RELAY GP	271
		1	RELAY GP	272
		1	WIRING GP-PLATFORM	324
		1	WIRING GP-PLATFORM	327
		1	WIRING GP-PLATFORM	330
		1	WIRING GP-PLATFORM	335
		1	WIRING GP-PLATFORM	339
GLOW PLUG (12-VOLT)	232-6662	4	GLOW PLUG GP	247
		4	GLOW PLUG GP	248
KEY (BATTERY DISCONNECT)	8H-5306	1	SWITCH GP-DISCONNECT	279
LAMP (12-VOLT)	7X-9065	1	WIRING GP-CONSOLE	291
		1	WIRING GP-CONSOLE	292
LAMP (12-VOLT) (COOLANT TEMPERATURE)	7X-9065	1	WIRING GP-CONSOLE	296
LAMP (12-VOLT) (FUEL LEVEL INDICATOR)	7X-9065	1	WIRING GP-CONSOLE	296
LAMP (12-VOLT) (OIL TEMPERATURE)	7X-9065	1	WIRING GP-CONSOLE	296
LAMP (12-VOLT, 21-WATT)	3C-4883	1	LIGHTING GP-FLOOD & SIGNAL	259
		1	LIGHTING GP-FLOOD & SIGNAL	263
	9W-3326	1	LIGHTING GP-FLOOD & SIGNAL	259
		1	LIGHTING GP-FLOOD & SIGNAL	263
LAMP (12-VOLT, 5-WATT)	084-4348	1	LIGHTING GP-FLOOD & SIGNAL	259
		1	LIGHTING GP-FLOOD & SIGNAL	263
LAMP (12-VOLT, 55-WATT)	9W-0607	1	LAMP GP-FLOOD	254
		1	LAMP GP-FLOOD	255
		1	LAMP GP-FLOOD	256
	9X-8118	1	LAMP GP-WARNING BEACON	257
		1	LAMP GP-WARNING BEACON	258
LAMP GP (12-VOLT)	270-2728	1	WIRING GP-CONSOLE	291
LAMP GP (12-VOLT) (FAULT INDICATOR)	270-2728	1	WIRING GP-CONSOLE	296
ENGINE ARRANGEMENT				
FILTER AS-ENGINE OIL	7W-2326	1	ENGINE AR-PRIMARY	23
FUEL SYSTEM				
CAP-FUEL	284-9039	1	TANK GP-FUEL	220
CAP-FUEL (LOCKABLE, VENTED)	284-9039	1	TANK GP-FUEL	222
ELEMENT-WATER SEPARATOR (FUEL FILTER)	361-9554	1	PUMP GP-FUEL PRM & PRIM FILTER	217
FILTER AS-WATER SEP & FUEL	228-9130	1	PUMP GP-FUEL PRM & PRIM FILTER	214
FILTER ELEMENT-FUEL (WATER SEPARATOR)	156-1200	1	FILTER GP-WATER SEP & FUEL	192
		1	LINES GP-FUEL	200
STRAINER-FUEL (FILLER NECK SCREEN)	180-3730	1	TANK GP-FUEL	220
		1	TANK GP-FUEL	222

MAINTENANCE PARTS

DESCRIPTION	PART NUMBER	QTY	WHERE USED	PAGE		
HYDRAULIC SYSTEM						
CAP AS	6V-9830	1	FILTER GP-OIL	560		
		1	LINES GP-LIFT CYLINDER	630		
		1	LINES GP-LIFT CYLINDER	632		
		2	LINES GP-LOADER AUXILIARY	634		
		2	LINES GP-LOADER AUXILIARY	636		
		6V-9832	2	LINES GP-BACKHOE AUXILIARY	587	
			2	LINES GP-BACKHOE AUXILIARY	590	
		CAP-FILL (HYDRAULIC OIL)	237-3797	1	TANK & MTG GP-HYDRAULIC	692
				1	TANK & MTG GP-HYDRAULIC	694
		FILTER ELEMENT-BREATHER (HYDRAULIC TANK)	9R-9925	1	TANK & MTG GP-HYDRAULIC	692
1	TANK & MTG GP-HYDRAULIC			694		
FILTER-OIL (ULTRA HIGH EFFICIENCY) (HYDRAULIC)	126-1817	1	TANK & MTG GP-HYDRAULIC	694		
		1	FILTER GP-OIL	560		
LUBRICATION SYSTEM						
CAP AS-FILLER (ENGINE OIL FILLER)	236-6651	1	GAUGE GP-OIL LEVEL & FILLER	111		
		1	GAUGE GP-OIL LEVEL & FILLER	112		
FILTER AS-ENGINE OIL	7W-2326	1	GAUGE GP-OIL LEVEL & FILLER	111		
		1	GAUGE GP-OIL LEVEL & FILLER	112		
MACHINE ARRANGEMENT						
SEAT BELT GP (RETRACTABLE, 51-MM)	206-1747	1	DISTRIBUTION AR	4		
		1	DISTRIBUTION AR	5		
		1	DISTRIBUTION AR	6		
		1	DISTRIBUTION AR	7		
		1	DISTRIBUTION AR	8		
		1	DISTRIBUTION AR	10		
		1	DISTRIBUTION AR	11		
		1	DISTRIBUTION AR	12		
		1	DISTRIBUTION AR	13		
		1	DISTRIBUTION AR	14		
		1	DISTRIBUTION AR	15		
		1	DISTRIBUTION AR	16		
		1	DISTRIBUTION AR.	9		

MAINTENANCE PARTS

DESCRIPTION	PART NUMBER	QTY	WHERE USED	PAGE
OPERATOR STATION				
BLADE AS-WIPER (500-MM) (REAR)	5C-8811	1	WIPER GP-WINDOW	1068
		1	WIPER GP-WINDOW	1070
BLADE AS-WIPER (600-MM) (FRONT)	101-0745	1	WIPER & WASHER GP-WINDOW	1064
		1	WIPER & WASHER GP-WINDOW	1066
		1	WIPER GP-WINDOW	1068
		1	WIPER GP-WINDOW	1070
DRYER-REFRIGERANT (IN-LINE)	283-4237	1	LINES GP-HEATER & AIR COND	1011
DRYER-REFRIGERANT (IN-LINE) (AIR CONDITIONER)	283-4237	1	LINES GP-HEATER & AIR COND	1013
FILTER ELEMENT AS-AIR (CAB HEATER)	211-2661	1	AIR CONDITIONER & MOUNTING GP	898
		1	HEATER GP-CAB	995
		1	HEATER GP-CAB	997
FILTER ELEMENT-AIR (CAB HEATER)	211-2660	1	HEATER GP-CAB	1001
FILTER ELEMENT-AIR (CAB HEATER, AIR CONDITIONER)	211-2660	1	HEATER & AIR CONDITIONER GP	993
FILTER ELEMENT-AIR (RECIRCULATION)	211-2660	1	HEATER GP-CAB	999
LAMP (12-VOLT)	122-7137	1	TACHOMETER GP-ELECTRIC	1046
	210-8754	1	LINER GP-CAB	1006
		1	LINER GP-CAB	1008
SEAT BELT (2-IN)	206-1749	1	SEAT BELT GP	1027
SEAT BELT (3-IN)	206-1750	1	SEAT BELT GP	1028
POWER TRAIN				
BREATHER (AXLE, REAR)	197-9155	1	AXLE GP-REAR	350
BREATHER (FRONT AXLE)	253-5024	1	AXLE GP-DRIVE & STEERING	347
BREATHER (TRANSMISSION)	7T-3251	1	TRANSMISSION GP-DIRECT DRIVE	404
		1	TRANSMISSION GP-DIRECT DRIVE	410
		1	TRANSMISSION GP-DIRECT DRIVE	414
		1	TRANSMISSION GP-DIRECT DRIVE	420
BREATHER AS (TRANSMISSION)	293-2147	1	TRANSMISSION GP-DIRECT DRIVE	415
		1	TRANSMISSION GP-DIRECT DRIVE	419
	294-9822	1	TRANSMISSION GP-DIRECT DRIVE	409
FILTER-OIL (STANDARD EFFICIENCY)	119-4740	1	POWER TRAIN AR	388
		1	POWER TRAIN AR	389
		1	POWER TRAIN AR	391
FILTER-OIL (STANDARD EFFICIENCY) (HYDRAULIC)	119-4740	1	POWER TRAIN AR	390
FILTER-OIL (STANDARD EFFICIENCY) (POWER TRAIN)	119-4740	1	POWER TRAIN AR	390
		1	POWER TRAIN AR	391
PLUG AS-DRAIN	6Y-1896	1	TRANSMISSION GP-DIRECT DRIVE	404
		1	TRANSMISSION GP-DIRECT DRIVE	410
PLUG AS-DRAIN (DRAIN)	6Y-1896	1	TRANSMISSION GP-DIRECT DRIVE	420
PLUG AS-DRAIN (MAGNETIC)	152-6144	1	DIFFERENTIAL & BEVEL GEAR GP	363
PLUG AS-DRAIN (MAGNETIC) (AXLE,REAR)	152-6144	4	AXLE GP-REAR	350
PLUG AS-DRAIN (MAGNETIC) (DIFFERENTIAL)	152-6144	4	AXLE GP-DRIVE & STEERING	347
STRAINER-SUCTION (SUCTION)	7T-2651	1	CASE AS-TRANSMISSION	355
		1	CASE GP-TRANSMISSION	360

INDEX

Name	Page	Name	Page
A			
ACCUMULATOR GP-RIDE CONTROL- CHARGED	520 522	BATTERY (12-VOLT, MAINTENANCE FREE)	226 228 233 236 238 240
ACCUMULATOR GP-RIDE CONTROL- UNCHARGED	521 523	BATTERY (12-VOLT, MAINTENANCE FREE, WET)	229 231 242 244
ACCUMULATOR-REFRIGERANT (AIR CONDITIONER)	1011 1013	BELT-DRIVE	257 258
ADJUSTER GP-MANUAL	780	BELT-SERPENTINE	133
ADJUSTER GP-SEAT	897	BLADE AS-WIPER (500-MM) (REAR)	1068 1070
AFTERCOOLER GP-AIR	149	BLADE AS-WIPER (600-MM) (FRONT)	1064 1066 1068 1070
AIR CLEANER GP	156 158 160 162 164 165	BLOWER GP-CAB	999
AIR CLEANER GP-TURBO	165	BLOWER GP-CAB (HEATER)	993 1001
AIR COMPRESSOR GP (SUSPENSION SEAT)	1036 1039	BOOM & BEARING AS	724
AIR CONDITIONER & MOUNTING GP	898	BOOM GP	725
ALTERNATOR GP-CHARGING	223 224 225	BOX GP-BATTERY-WITH STORAGE	465 466
ALTERNATOR GP-CHARGING (100-AMPERE, WITH MOUNTING)	23 25	BRACE GP-LIFT CYLINDER	726
ALTERNATOR GP-CHARGING- 100-AMPERE, WITH MOUNTING	224	BRAKE GP-MECH CALIPER PARKING	350
ALTERNATOR GP-CHARGING- 120-AMPERE, WITH MOUNTING	223	BREATHER (AXLE, REAR)	350
ARM GP-LIFT	722	BREATHER (FRONT AXLE)	347
ARMREST AS (LH)	1034	BREATHER (TRANSMISSION)	404 410 414 420
ARMREST AS (RH)	1034	BREATHER AS (TRANSMISSION)	409 415 419
AXLE GP-DRIVE & STEERING-FRONT	347	BREATHER GP	107
AXLE GP-FRONT	453	BREATHER GP-CRANKCASE	109
AXLE GP-REAR	350	BUCKET AR-MULTIPURPOSE	781 782
B			
BACKHOE AR-EXTENDABLE STICK	1	BUCKET AS-GENERAL PURPOSE	783 784 785 786 787
BACKHOE AR-STANDARD STICK	1	BUCKET AS-HOE	788 789 790 791
BATTERY & WIRING GP	236 238 240 242 244	BATTERY & WIRING GP-DISCONNECT	233
BATTERY & WIRING GP-HEAVY-DUTY	228 231	BATTERY & WIRING GP-STANDARD	226 229

INDEX

Name	Page	Name	Page
	796	BUCKET GP-HOE-ROCK	848
	797		849
BUCKET AS-HOE-HEAVY-DUTY	798		850
	799		854
	800	BUCKET GP-MULTIPURPOSE	855
	801		856
	802		858
	803		859
	804		860
	805		861
	806		862
	807		863
	808		864
BUCKET AS-HOE-HIGH CAPACITY	809	BULLDOZER AS	865
	810		867
	811		868
	812	BULLDOZER AS-FORKS	866
	813		
	814		
	815	C	
	816		
BUCKET AS-HOE-ROCK	817	CAB AR-ENCLOSED ROPS- DOUBLE DOOR, WITH A/C	903
	818		904
	819		
	820	CAB AR-ENCLOSED ROPS- DOUBLE DOOR, WITHOUT A/C	902
	821		
	822	CAB AR-ENCLOSED ROPS- SINGLE DOOR, WITHOUT A/C	901
	823		
	824	CAB AS	905
	825		906
BUCKET GP-GENERAL PURPOSE	826	CAB GP-ENCLOSED ROPS	920
	827	CAB GP-ENCLOSED ROPS-DOUBLE DOOR ...	912
	828		915
	829	CAB GP-ENCLOSED ROPS-SINGLE DOOR ...	908
	830		910
	831		918
BUCKET GP-HOE	832	CAMSHAFT GP	27
	833		28
	834	CANOPY AR-OPEN ROPS- WITH FRONT WINDOW	923
	835		924
	836		
	837	CANOPY AR-OPEN ROPS- WITHOUT FRONT WINDOW	922
	838		925
	839	CANOPY AS	926
	840		
	841	CANOPY GP-OPEN ROPS- WITH FRONT WINDOW	929
	842		931
	843		
	844	CANOPY GP-OPEN ROPS- WITHOUT FRONT WINDOW	927
	845		930
	846		
	847	CAP AS	560
	851		587
	852		590
BUCKET GP-HOE-HEAVY-DUTY	853		630
			632

INDEX

Name	Page	Name	Page
	634		957
	636	CONTROL GP-HYDRAULIC HAND-	
CAP AS-COOLANT TANK	136	STABILIZER	967
CAP AS-COOLANT TANK (RADIATOR)	155	CONTROL GP-HYDRAULIC PEDAL-	
CAP AS-FILLER (ENGINE OIL FILLER)	111	SINGLE FUNCTION, LH	968
	112		969
CAP-FILL (HYDRAULIC OIL)	692	CONTROL GP-HYDRAULIC PEDAL-	
	694	SINGLE FUNCTION, RH	970
CAP-FUEL	220		972
CAP-FUEL (LOCKABLE, VENTED)	222	CONTROL GP-PARKING BRAKE	440
CARRIER AS-DIFFERENTIAL	363		441
CASE AS-TRANSMISSION-FRONT	355	CONTROL GP-SERVICE BRAKE	442
CASE AS-TRANSMISSION-REAR	353		445
	356	CONTROL GP-STEERING	974
	358	CONTROL GP-STEERING-TILT	975
CASE GP-TRANSMISSION-FRONT	360		977
CASE GP-TRANSMISSION-REAR	361	CONTROL GP-TRANSMISSION	979
CHASSIS AR	2	CONTROL GP-TRANSMISSION	
CHASSIS AR-NACD	3	(FORWARD, NEUTRAL, REVERSE)	979
CLAM AS-MULTIPURPOSE BUCKET	869	CONVERSION AR-CUSHION SWING-KIT	525
	870	COOLER AS-OIL-	
	871	HYDRAULIC, TRANSMISSION	118
COMMON AR	3	COOLER GP-ENGINE OIL	119
COMMON AR-NACD	4		120
COMPARTMENT GP-LITERATURE-			121
STORAGE BOX	932		122
COMPRESSOR & MTG GP-REFRIG	933	COOLER GP-FLTR BASE & ENG OIL	122
	935		123
COMPRESSOR GP-REFRIGERANT	937		124
	938		126
	939	COOLER GP-HYD & XMSN OIL	527
CONDENSER & MTG GP-REFRIGERANT	940	CORE AS-OIL COOLER (HYDRAULIC)	118
	941		527
CONNECTION GP-INLET	167	CORE AS-OIL COOLER (TRANSMISSION)	118
CONNECTION GP-WATER	115		527
	117	CORE AS-OIL COOLER	
CONSOLE GP-OPERATOR-FRONT	946	(TRANSMISSION, 9-ROW)	153
CONSOLE GP-OPERATOR-LH	944	COUNTERWEIGHT GP	468
CONSOLE GP-OPERATOR-RH	942		469
CONTROL & MTG GP-STABILIZER	948		470
	950	COUPLER AR-QUICK-PIN-LOCK	872
	952	COUPLER GP-QUICK	874
CONTROL AR-RIDE	524		876
CONTROL GP-GOVERNOR	184		877
	186	COUPLER GP-QUICK-HOE	873
	188	COUPLER GP-QUICK-PIN-LOCK	875
	190	COVER GP-CAB	981
CONTROL GP-HYDRAULIC HAND	948	COVER GP-INLET MANIFOLD	168
CONTROL GP-HYDRAULIC HAND-			169
4-FUNCTION, EXCAVATOR	963	COVER GP-VALVE MECHANISM	29
	965		31
CONTROL GP-HYDRAULIC HAND-			33
BACKHOE	959		35
	961		37
CONTROL GP-HYDRAULIC HAND-LOADER	954		39