



---

# **345B 345BL Track-Type Excavators**

---

**Powered by 3176C Engine**

**Hammer Arrangement  
Quarry Arrangement**

**SERIAL NUMBER**

**6MW1 To Last Built(Vehicle)**

**8RW1 To Last Built(Vehicle)**

**7ZR00403 To Last Installed(Engine)**

## HOW TO USE THE PARTS MANUAL

Caterpillar Parts Manuals include illustrations of the groups or assemblies which make up the machine. These illustrations show the standard components plus many of the attachments available for the machine.

The alphabetical index located in the front part of the book should be used to determine the page number on which specific illustrations are shown. Reference to those pages will identify each of the individual serviceable parts.

### Captions

The caption under each illustration identifies the part number and name of the group or assembly shown. If more than one illustration is included for any group, the caption identifies the specific machine serial numbers to which each illustration applies. In some cases it is not possible to determine the specific machine serial numbers to which different illustrations are applicable. In those cases the caption identifies the illustration as "First Type", "Second Type", etc. Reference to the actual group or assembly is necessary in those cases to determine which illustration should be used.

Captions provide additional information such as page numbers where illustrations of sub assemblies are shown, information regarding quantities used and other information intended to assist the user in determining parts needs.

This information indicates the effective serial number or effective date on which changes became effective.

Example :

D95.05- : Applicable on and after May 1995

↑  
D indicates the nineteen hundreds.

T00.05- : Applicable on and after May 2000

↑  
T indicates the two thousands.

## Indented Part Names

Within each illustration is a parts list identifying each serviceable part in the illustration. When a part name is indented in this list, it means that serviceable item is a part of the serviceable item under which it is indented.

### Abbreviations and Symbols

R.H.	Right Hand	} Refers to the side of the machine as viewed from the operator's compartment.
L.H.	Left Hand	

L	Length
T	Thickness
Z	Number of Gear Teeth
O.D.	Outside Diameter
I.D.	Inside Diameter
O.S.	Over Size
U.S.	Under Size
N/S	Not Serviced
AS	Assembly
NOM	Nominal

#### Abbreviations of Wire Colors

RD :Red	BR :Brown
WH :White	GN :Green
OR :Orange	BU :Blue
YL :Yellow	T :Tan
PK :Pink	DK/BU :Dark Blue
BK :Black	DK/GN :Dark Green
GY :Gray	LT/BU :Light Blue
PU :Purple	LT/GN :Light Green

### Note

Continuing improvement and advancement of product design may cause changes to your machine which may not be included in this publication. Each publication is reviewed and revised, as required, to update and include these changes in later editions.

Whenever a question arises regarding your Caterpillar product, or this publication, please consult your Caterpillar dealer for the latest available information.

# MODEL VIEW

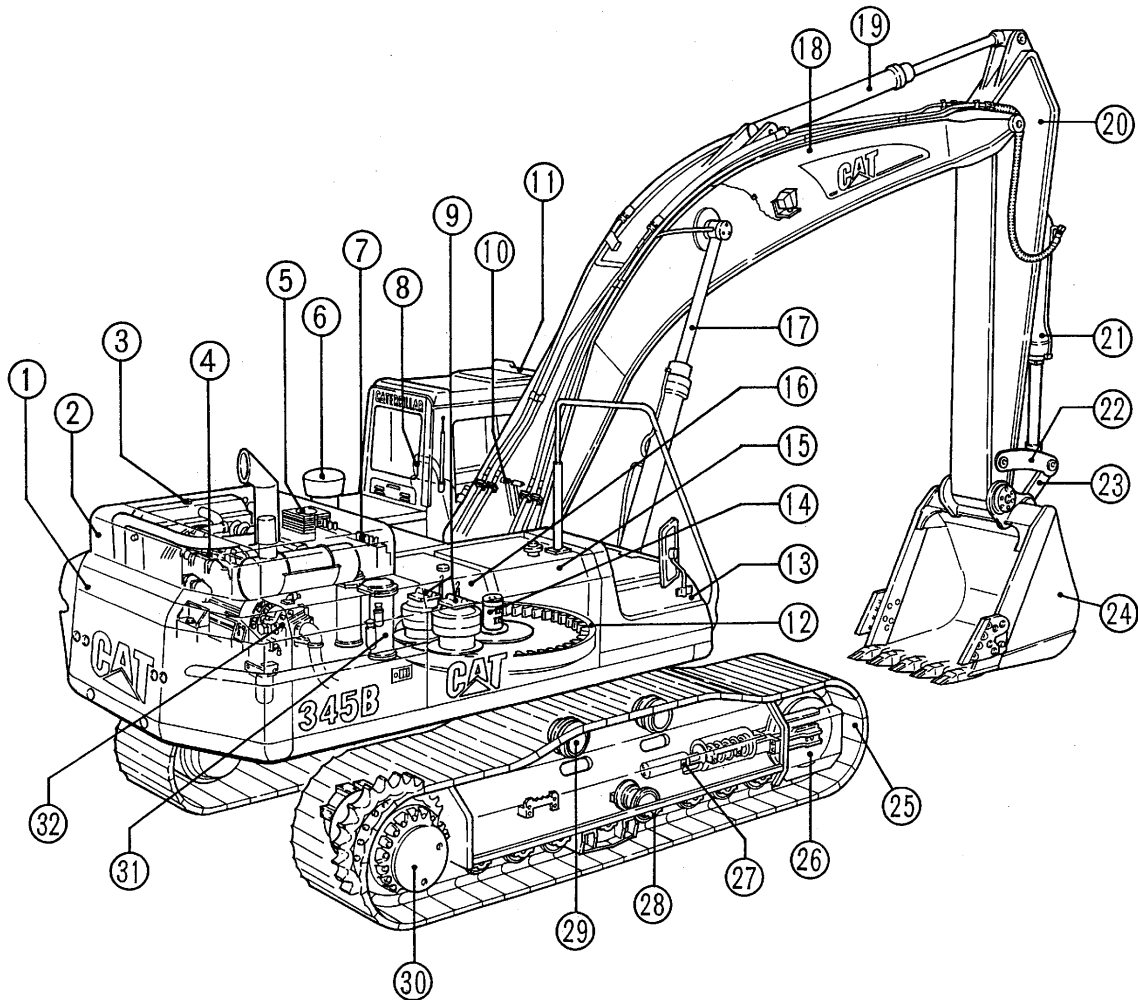

	PAGE		PAGE		PAGE
① Counterweight .....	222	⑫ Swing Bearing .....	224	⑳ Rod .....	541
② Engine Hood .....	194	⑬ Storage Box .....	214	㉑ Bucket .....	552.02
③ Radiator & Oil Cooler.....	64	⑭ Swivel .....	385	㉒ Track .....	248
④ Engine .....	11	⑮ Fuel Tank.....	100	㉓ Idler.....	235
⑤ Battery .....	104	⑯ Hydraulic Tank.....	263	㉔ Track Adjuster.....	237
⑥ Air Cleaner .....	79	⑰ Boom Cylinder.....	297	㉕ Track Roller .....	240
⑦ Control Valve.....	396	⑱ Boom .....	521	㉖ Carrier Roller .....	240
⑧ Operator Seat.....	483	㉑ Stick Cylinder .....	298	㉗ Final Drive .....	190
⑨ Swing Drive .....	367	㉒ Stick.....	525	㉘ Return Filter.....	285
⑩ Control Lever .....	393	㉓ Bucket Cylinder .....	299	㉙ Pump.....	267
⑪ Cab.....	441	㉔ Link.....	541		

# REPLACEMENT ITEMS

The following chart provides a convenient listing of those items which require occasional replacement during normal operation or maintenance.

DESCRIPTION	PART NO.	QTY. USED	PAGE NO.
Filter			
Air Conditioner Filter	147-4851	1	508
Air Filter			
Primary Filter Assembly	142-1340	1	80
Secondary Filter Assembly	142-1403	1	80
Cab Air Filter	41-1278	1	507
Engine Oil Filter	1R-0716	1	53
Fuel Filter	1R-0762	1	99
Hydraulic Oil Drain Filter	093-7521	1	285
Hydraulic Oil Pilot Filter	184-3931	1	285
Hydraulic Tank Return Filter	126-2081	1	288
Water Separator Element	133-5673	1	99
V-Belt			
Alternator & Fan V-Belt	146-0894	1	39

# LIST OF ATTACHMENTS

The following chart provides a convenient listing of attachments with their reference page numbers as a quick reference for parts ordering.

<b>Consists of:</b>		<b>Page</b>
128-8915	<b>ALARM, TRAVEL</b> .....	178
	<b>AUTOMATIC LUBRICATOR</b>	
140-1491	M-BOOM/M3.0U STICK .....	516
140-1490	R-BOOM/R2.9T STICK .....	515
140-1489	R-BOOM/R3.35T STICK .....	515
	<b>BOOM</b>	
158-0058	M-BOOM, MASS 6.55M .....	514.01
158-0057	R-BOOM, REACH 6.9M .....	514
	<b>BUCKET</b>	
	EXCAVATION (X)	
6I-5048	G Family 1655MM Wide-2.2Cu.M.-Adapter Size J550 .....	547.02
	TRENCHING (T)	
6I-5040	F Family 1218MM Wide-1.6Cu.M.-Adapter Size J460 .....	547.02
	V-TYPE EXCAVATION (VX)	
	G Family	
149-9673	1750MM Wide-2.2Cu.M.-Adapter Size J550 (6MW1-D99.07, 8RW1-D99.07) .....	546.01
168-2713	1740MM Wide-2.2Cu.M.-Adapter Size J550 (6MW D99.08-Up, 8RW D99.08-Up) .	546.01
6I-5071	1880MM Wide-2.4Cu.M.-Adapter Size J550 (6MW1-D99.07, 8RW1-D99.07) .....	548
168-2733	1880MM Wide-2.4Cu.M.-Adapter Size J550 (6MW D99.08-Up, 8RW D99.08-Up) .	546.02
	<b>BUCKET (W/Long Teeth, Adapters &amp; Sidebar Protector)</b>	
	EXTREME SERVICE EXCAVATION (EX)	
	T Family	
141-3737	1580MM Wide-1.9Cu.M.-Adapter Size J550 (6MW1-D98.10, 8RW1-D98.10) .....	545.02
163-3549	1525MM Wide-1.9Cu.M.-Adapter Size J550 (6MW D98.11-Up, 8RW D98.11-Up) .	546
149-9668	1645MM Wide-2.0Cu.M.-Adapter Size J550 (6MW1-D98.11, 8RW1-D98.11) .....	543.02
163-3550	1590MM Wide-2.0Cu.M.-Adapter Size J550 (6MW D98.12-Up, 8RW D98.12-Up) .	544
149-9669	1710MM Wide-2.1Cu.M.-Adapter Size J550 (6MW1-D99.04, 8RW1-D99.04) .....	543.02
165-0844	1655MM Wide-2.1Cu.M.-Adapter Size J550 (6MW D99.05-Up, 8RW D99.05-Up) .	544
	V-TYPE EXCAVATION (VX)	
	U Family	
149-9672	1830MM Wide-2.1Cu.M.-Adapter Size J550 (6MW1-D99.05, 8RW1-D99.05) .....	545
165-0816	1830MM Wide-2.1Cu.M.-Adapter Size J550 (6MW D99.06-Up, 8RW D99.06-Up) .	545.01

# LIST OF ATTACHMENTS

Consists of:		Page
	<b>BUCKET (W/Long Teeth, Adapters &amp; Sidecutter)</b>	
	EXCAVATION (X)	
	F Family	
149-9665	1590MM Wide-2.0Cu.M.-Adapter Size J460 (6MW1-D99.05, 8RW1-D99.05) .....	543
168-2696	1555MM Wide-2.0Cu.M.-Adapter Size J460 (6MW D99.06-Up, 8RW D99.06-Up) .	543.01
149-9666	1735MM Wide-2.2Cu.M.-Adapter Size J460 (6MW1-D99.05, 8RW1-D99.05) .....	543
165-0953	1735MM Wide-2.2Cu.M.-Adapter Size J460 (6MW D99.06-Up, 8RW D99.06-Up) .	543.01
	T Family	
141-3736	1580MM Wide-1.9Cu.M.-Adapter Size J460 (6MW1-D99.04, 8RW1-D99.04) .....	545.02
165-0845	1580MM Wide-1.9Cu.M.-Adapter Size J460 (6MW D99.05-Up, 8RW D99.05-Up) .	546
	U Family	
149-9670	1650MM Wide-2.1Cu.M.-Adapter Size J550 (6MW1-D99.04, 8RW1-D99.04) .....	545
165-0846	1605MM Wide-2.1Cu.M.-Adapter Size J550 (6MW D99.05-Up, 8RW D99.05-Up) .	545.01
	<b>BUCKET LINKAGE</b>	
127-7521	T FAMILY .....	520
127-7522	U FAMILY .....	520
133-4410	<b>COUNTERWEIGHT</b> .....	223
	<b>FILM</b>	
150-2815	Single Function/Combined Function .....	587
111-6310	<b>FRONT WINDSHIELD, ELEC. OPENABLE (6MW1-D98.04, 8RW1-D98.04)</b> .....	455
155-7061	<b>FRONT WINDSHIELD, ELEC. OPENABLE (6MW D98.05-Up, 8RW D98.05-Up)</b> .....	455
	<b>GUARD</b>	
150-5765	BUCKET CYLINDER LINES .....	307
140-1468	FOGS .....	473
	TRACK GUIDE	
153-1591	Full Length (6MW1-Up) .....	238
153-1592	Full Length (8RW1-Up) .....	239
128-2156	WINDSHIELD, FRONT .....	450.02
140-1455	<b>HAND CONTROL PATTERN CHANGER (4 Ways)</b> .....	423
	<b>HYDRAULIC SYSTEMS, AUXILIARY</b>	
	BASIC ARRANGEMENTS	
127-6685	Combined Function .....	339
127-6684	Single Function .....	338
	BOOM LINE GROUPS	
146-1441	R-Boom (6.9M) Auxiliary Lines .....	318

# LIST OF ATTACHMENTS

<b>Consists of:</b>		<b>Page</b>
	<b>STICK LINE GROUPS-R-BOOM STICK ONLY</b>	
135-3910	R2.9T Stick Auxiliary Lines .....	328
127-6690	R3.35T Stick Auxiliary Lines .....	326
135-4096	R3.9T Stick Auxiliary Lines .....	325.01
	<b>OPTIONAL SEAT</b>	
124-3927	KAB 524 SEAT (With Seat Heater) .....	484
122-9648	HEADREST (For KAB 525 Seat) .....	496
140-1470	<b>PRECLEANER</b> .....	78
	<b>RADIO</b>	
111-4693	AM/FM .....	470
153-2506	AM/FM (With Cassette) (6MW00260-Up, 8RW00217-Up) .....	470
6I-5387	<b>RAIN PROTECTOR, CAB FRONT</b> .....	475
184-3995	<b>RETURN FILTER-HYDRAULIC TANK</b> .....	291
	<b>SIDEBAR PROTECTOR</b>	
101-3083	T FAMILY .....	571
112-2493	U FAMILY .....	571
	<b>SIDECUTTER</b>	
7Y-2147	E, F FAMILY (Combination) .....	562
7Y-2148	F, T FAMILY .....	561
7Y-0919	U FAMILY .....	561
	<b>STARTING, COLD WEATHER</b>	
163-6723	STARTING AID .....	110
124-1690	STARTING AID, ETHER .....	168
	<b>STICK</b>	
	<b>FOR THE MASS (6.55M) BOOM ONLY</b>	
158-0067	M2.5U Stick .....	519
158-0066	M3.0U Stick .....	518
	<b>FOR THE REACH (6.9M) BOOM ONLY</b>	
158-0064	R2.9T Stick .....	517
158-0062	R3.35T Stick .....	517
158-0060	R3.9T Stick .....	518
111-6313	<b>SUN VISOR, WINDSHIELD</b> .....	474

# LIST OF ATTACHMENTS

<b>Consists of:</b>		<b>Page</b>
	<b>TIP</b>	
	<b>ADAPTER SIZE J460</b>	
8E-3758	Abrasion, Heavy Duty .....	564
9N-4562	Long .....	563
9N-4563	Long, Heavy Duty .....	563
9N-4564	Penetration .....	565
9N-4566	Sharp-Center .....	565
9N-4565	Sharp-Corner .....	566
9N-4561	Short .....	564
9N-4560	Wide .....	566
	<b>ADAPTER SIZE J550</b>	
8E-3759	Abrasion, Heavy Duty .....	568
8J-9842	Long .....	567
6Y-5373	Long, Heavy Duty .....	567
3G-3352	Penetration .....	569
9W-6476	Sharp-Center .....	569
9W-6477	Sharp-Corner .....	570
8J-9841	Short .....	568
8J-9840	Wide .....	570
146-4941	<b>TOOL KIT</b> .....	572
	<b>TRACK</b>	
	<b>DOUBLE GROUSER</b>	
150-4761	600MM (6MW1-Up) .....	249
150-4756	600MM (8RW1-Up) .....	252
150-4758	750MM (6MW1-Up) .....	250
150-4752	750MM (8RW1-Up) .....	253
	<b>TRIPLE GROUSER</b>	
150-4755	600MM (8RW1-Up) .....	253
150-4760	750MM (6MW1-Up) .....	251
127-7550	900MM (6MW1-Up) .....	248
127-7551	900MM (8RW1-Up) .....	248
116-0159	<b>12V-5A POWER SUPPLY SOCKET</b> .....	136



# INDEX

Name	Page	Name	Page
<b>A</b>			
ADJUSTER GP - BUCKET .....	559	CONNECTION GP - ELECTRICAL.....	177.03
ADJUSTMENT GP - HYDRAULIC TRACK.....	237	CONSOLE GP.....	479
AIR CLEANER GP.....	80	CONSOLE GP - OPERATOR .....	477.02
AIR CONDITIONER & MOUNTING GP.....	500	CONTROL & MTG GP - ELECTRONIC.....	130
AIR CONDITIONER GP.....	499	CONTROL & MTG GP - ENGINE ELEK.....	158
	502	CONTROL & MTG GP - WINDSHIELD .....	131
ALARM AS - BACKUP.....	179	CONTROL AR - AUXILIARY.....	338
ALARM GP - TRAVEL.....	178	CONTROL GP - ENGINE ELECTRONIC.....	159
ALTERNATOR GP - CHARGING.....	165	CONTROL GP - HYDRAULIC.....	394
ARM AS - WIPER .....	462	CONTROL GP - PILOT OPERATED HYD.....	390
			393
		CONVERSION AR - PRECLEANER .....	78
		COOLER GP - ENGINE OIL .....	70
		COUNTERWEIGHT GP .....	222
		COUPLING GP - PUMP.....	269
		COVER GP .....	202
			208
			453.02
			469.04
		COVER GP - AIR COMPRESSOR.....	21
		COVER GP - CYLINDER BLOCK .....	20
		COVER GP - FLYWHEEL HOUSING.....	20
		COVER GP - FRONT HOUSING .....	36
		COVER GP - HOOD .....	200
		COVER GP - OIL FILTER BASE .....	60
		COVER GP - PUMP CONTROL .....	282
		COVER GP - STORAGE .....	453
		CRANKSHAFT GP.....	22
		CYLINDER & LINES GP - BOOM.....	294
		CYLINDER & LINES GP - BUCKET.....	296
		CYLINDER & LINES GP - STICK.....	295
		CYLINDER & SEAL GP - BOOM.....	297
		CYLINDER & SEAL GP - BUCKET.....	299
		CYLINDER & SEAL GP - STICK.....	298
		CYLINDER BLOCK AS .....	19
		CYLINDER BLOCK GP .....	18
		CYLINDER GP - BOOM.....	302
		CYLINDER GP - BUCKET .....	304
		CYLINDER GP - STICK .....	303
		CYLINDER HEAD AS .....	28
		CYLINDER HEAD GP .....	26
<b>B</b>			
BASE GP - OIL FILTER .....	58.02		
BATTERY & WIRING GP.....	104		
BATTERY & WIRING GP - COLD WEATH .....	110		
BLOCK GP - HYDRAULIC.....	289		
BLOWER GP .....	511		
BOOM AR .....	514		
BOOM GP .....	521		
BOTTLE GP - WINDSHIELD WASHER.....	469		
BOX & MTG GP - STORAGE.....	214		
BOX GP - STORAGE .....	215		
	453.03		
BRAKE AS.....	382		
BREATHER GP .....	54		
BUCKET & ADJUSTER GP.....	545.02		
	547		
BUCKET AR .....	543		
	546		
BUCKET AS - EXCAVATION.....	552.02		
BUCKET AS - TRENCHING.....	554		
BUMPER GP - SIDE.....	230		
<b>C</b>			
CAB GP.....	441		
CAB GP (BASIC).....	444		
CABLE AS .....	121		
CAMSHAFT GP.....	24		
COMPRESSOR GP - REFRIGERANT.....	472		
CONDENSER & MOUNTING GP .....	471		

# INDEX

Name	Page	Name	Page
<b>D</b>			
DAMPER GP .....	34	FRAME GP - UNDERCARRIAGE .....	232
DISTRIBUTOR AS.....	510	FRAME GP - UPPER .....	228
DOOR GP - CAB.....	448	FUMES DISPOSAL GP .....	62
DOOR GP - HOOD .....	203	<b>G</b>	
	207	GAUGE GP - OIL LEVEL (DIPSTICK).....	56
DRIVE AS - WINDSHIELD - AUTO.....	466	GEAR & BEARING GP .....	224
DRIVE GP - FAN.....	41	GEAR GP - FRONT .....	37
DRIVE GP - SWING .....	367	GUARD AR - OVERHEAD .....	473
DRIVE GP - WINDSHIELD - AUTO .....	464	GUARD GP - BOTTOM .....	209
DUCT AS.....	508	GUARD GP - CYLINDER .....	307
DUCT GP - AIR .....	507	GUARD GP - OVERHEAD .....	473.01
DUCT GP - DEFROST .....	506	GUARD GP - SWIVEL.....	210
<b>E</b>			
ELBOW GP - AIR INLET.....	92	GUARD GP - TRACK GUIDE.....	238
ENGINE AR.....	11	GUARD GP - TRAVEL MOTOR .....	247
ENGINE AR - COMPLETE .....	13	GUARD GP - WINDOW .....	450.02
ENGINE AR - CORE.....	16	<b>H</b>	
EXTENSION GP - EXHAUST .....	92	HANDHOLD GP .....	212
<b>F</b>			
FASTENER GP - CYLINDER HEAD.....	48	HANDLE GP - STORAGE DOOR .....	220
FASTENER GP - DAMPER.....	29	HARNES AS.....	126
FASTENER GP - FLYWHEEL .....	29		140
FASTENER GP - OIL COOLER.....	71		170
FASTENER GP - SWING & FINAL DR.....	188		186
FENDER & COVER GP .....	221	HARNES AS - CONSOLE .....	138
FILLER GP - ENGINE OIL.....	57		144
FILM GP .....	586	HARNES AS - ENGINE.....	162
FILTER AR.....	291	HARNES AS - WIRING.....	155
FILTER GP - ENGINE OIL .....	53	HATCH GP .....	451
FILTER GP - FUEL .....	99	HEAD GP - PUMP CONTROL.....	279
FILTER GP - HYDRAULIC .....	285	HEADREST AS.....	496
	292	HOOD & GUARD GP.....	194
FINAL DRIVE GP.....	190		199.16
	192		206.02
FITTING GP - FUEL LINES .....	102	HOOD AS.....	201
FITTING GP - FUEL RETURN.....	103	HOOD AS - ENGINE .....	202.02
FITTING GP - FUEL SUPPLY .....	102	HOOD GP.....	199.15
FLYWHEEL GP.....	38	HORN GP - ELECTRIC.....	472.02
		HOUSING & REGULATOR GP.....	75.02
		HOUSING GP - FILTER .....	290
		HOUSING GP - FLYWHEEL .....	40

# INDEX

Name	Page	Name	Page
HOUSING GP - FRONT .....	35	LINES GP - TRAVEL MOTOR .....	330
<b>I</b>		LINES GP - TURBOCHARGER OIL .....	58
IDLER GP - FRONT .....	235	LINES GP - WATER .....	73
INDICATOR AS .....	290	LINK AS - TRACK .....	256
INSTALLATION AR - ENGINE .....	12	LINKAGE AR - BUCKET .....	520
<b>K</b>		LINKAGE GP - BUCKET .....	541
KNOB AS .....	391	LITERATURE GP .....	498
<b>L</b>		LUBRICATION AR - AUTOMATIC .....	515
LAMP GP - FLOOD .....	183.02	<b>M</b>	
	185	MANIFOLD GP - EXHAUST .....	87
LEVER AS .....	481	MANIFOLD GP - INLET .....	86
LIFTER GP - VALVE .....	32	MIRROR GP - REAR VIEW .....	476
LIFTING GP - ENGINE .....	34	MONITOR GP - OPERATOR .....	454
LIGHTING GP - BOOM .....	180	MOTOR & MTG GP - SWING .....	370
LIGHTING GP - CAB .....	182	MOTOR & MTG GP - TRAVEL .....	379
LIGHTING GP - CHASSIS .....	183.01	MOTOR AS - WINDOW WIPER .....	463
	184		469.03
LINES GP - AIR .....	81	MOTOR GP - FAN DRIVE .....	437
LINES GP - AIR CONDITIONER .....	512	MOTOR GP - SWING .....	372
LINES GP - AUXILIARY HYDRAULIC .....	318	MOTOR GP - TRAVEL .....	380
	325.01	MOUNTING GP - AIR CLEANER .....	79
LINES GP - BOOM .....	314	MOUNTING GP - ENGINE .....	46
LINES GP - BOOM CYLINDER .....	309	MOUNTING GP - ENGINE OIL FILTER .....	61
LINES GP - BUCKET CYLINDER .....	312	MOUNTING GP - FAN DRIVE .....	50
LINES GP - DRAIN .....	91	MOUNTING GP - GREASE GUN .....	208
LINES GP - FAN DRIVE PUMP PILOT .....	365	MOUNTING GP - REFRIGERANT COMPR .....	49
LINES GP - FRONT .....	356	MOUNTING GP - VALVE .....	395
LINES GP - FUEL .....	98	MOUNTING GP - VALVE MECHANISM .....	47
LINES GP - FUEL INJECTION .....	96	MUFFLER GP .....	89
LINES GP - GREASE .....	528	<b>P</b>	
LINES GP - HYDRAULIC OIL COOLER .....	340	PAN GP - OIL .....	42
LINES GP - OIL DRAIN .....	53.02	PANEL GP - CIRCUIT BREAKER .....	124
LINES GP - PILOT .....	344	PISTON & ROD GP .....	25
LINES GP - PUMP .....	336	PLATE & FILM GP .....	574
LINES GP - RETURN & FILTER .....	362	PLATFORM GP - OPERATOR .....	477
LINES GP - STICK .....	320	PLUG GP .....	408
LINES GP - STICK CYLINDER .....	311	PLUG GP - CYLINDER BLOCK .....	43
LINES GP - SWING MOTOR .....	364	PLUG GP - FRONT HOUSING .....	45
		PLUG GP - WATER LINES .....	77
		PROTECTOR GP .....	571



# INDEX

Name	Page	Name	Page
<b>V</b>			
VALVE AR - 4 WAY .....	423	WIRING GP - CAB .....	152
VALVE AS.....	422	WIRING GP - CONSOLE.....	134
VALVE AS - BALL.....	421		141
	439	WIRING GP - ELECTRONIC CONTROL .....	160
VALVE GP .....	413	WIRING GP - LOWER WIPER .....	154
VALVE GP - CHECK.....	412	WIRING GP - RADIO .....	133
	426	WIRING GP - UNIT INJECTOR .....	161
	436		
VALVE GP - CONTROL.....	398		
VALVE GP - CUSHION CROSSOVER RLF.....	366		
VALVE GP - FLOW CONTROL.....	434		
VALVE GP - MAIN CONTROL.....	396		
VALVE GP - MANIFOLD & REDUCING .....	427		
VALVE GP - PILOT .....	388		
	392		
	414		
VALVE GP - PRESS & FLOW CMPNSTR .....	382		
VALVE GP - PRESS REDUCING SOL .....	430		
VALVE GP - PRESSURE CONTROL.....	397		
VALVE GP - RELIEF .....	376		
	384		
	409		
	425		
	435		
VALVE GP - SELECTOR .....	424		
VALVE GP - SHUTTLE .....	420		
VALVE GP - SOLENOID.....	430		
VALVE GP - TRACTION CONTROL.....	383		
VALVE MECHANISM GP.....	30		
VISOR GP - PROTECTION - RAIN.....	475		
VISOR GP - SUN.....	474		

## W

WASHER GP - WINDOW .....	468
WINDOW AS - DOOR .....	450
WINDOW GP.....	456
WINDSHIELD AR - AUTO .....	455
WIPER & WASHER GP .....	469.01
WIPER GP - WINDOW .....	460
WIRING GP .....	132
	136



# ENGINE ARRANGEMENT

Consists of :

		Page
1	148-2005 ENGINE AR-COMPLETE.....	13
1	124-1680 MUFFLER GP.....	89

H58180E 00

147-7107 ENGINE AR

## ENGINE ARRANGEMENT

Consists of :

			Page
1	61-6347	LINES GP-OIL DRAIN .....	53.02
1	124-1684	MOUNTING GP-ENGINE .....	46
1	124-1685	LINES GP-DRAIN .....	91
1	124-1687	LINES GP-AIR .....	81
1	124-1689	COMPRESSOR GP-REFRIGERANT .....	472
1	128-2147	CONDENSER & MOUNTING GP .....	471
1	131-8849	EXTENSION GP-EXHAUST.....	92
1	131-8913	MOUNTING GP-ENGINE OIL FILTER.....	61
1	131-8914	MOUNTING GP-ENGINE OIL FILTER.....	61.02
1	131-8931	LINES GP-AIR .....	82
1	139-8791	LINES GP-AIR .....	84
1	139-8839	MOUNTING GP-AIR CLEANER.....	79
1	151-6538	FUMES DISPOSAL GP .....	62

H84570E 06

### 124-1681 INSTALLATION AR-ENGINE



# ENGINE ARRANGEMENT

Consists of :

			Page
		ENGINE ARRANGEMENT	
1	126-0052	ENGINE AR-CORE.....	16
		BASIC ENGINE	
1	132-3215	COVER GP-AIR COMPRESSOR.....	21
1	115-2985	COVER GP-CYLINDER BLOCK.....	20
1	127-5728	COVER GP-FLYWHEEL HOUSING.....	20
1	117-2766	DAMPER GP.....	34
1	117-2771	FASTENER GP-DAMPER.....	29
1	117-2794	FASTENER GP-FLYWHEEL.....	29
1	128-0392	FLYWHEEL GP.....	38
1	138-1989	HOUSING GP-FLYWHEEL.....	40
1	138-2550	MOUNTING GP-FAN DRIVE.....	50
1	141-6156	MOUNTING GP-REFRIGERANT COMPR.....	49
1	116-5408	MOUNTING GP-VALVE MECHANISM.....	47
1	131-6678	PAN GP-OIL.....	42
1	115-2984	PLUG GP-CYLINDER BLOCK.....	43
1	117-0185	PLUG GP-CYLINDER BLOCK.....	44
1	117-0165	PLUG GP-CYLINDER BLOCK.....	44
1	116-5452	PLUG GP-FRONT HOUSING.....	45
1	117-2795	PULLEY GP-CRANKSHAFT.....	38

H58181E 00

## 148-2005 ENGINE AR-COMplete (1/3)

S/N 6MW 1-00212, 8RW 1-00272  
Part of 147-7107-Page11

## ENGINE ARRANGEMENT

Consists of :

			Page
BASIC ENGINE			
1	141-6158	PULLEY GP-REF COMPRESSOR & ALT.....	39
1	116-1091	SEAL GP-CRANKSHAFT .....	23
1	132-3240	SUPPORT GP-ENGINE.....	36
1	117-2748	LIFTING GP-ENGINE .....	34
LUBRICATION SYSTEM			
1	117-2786	COVER GP-OIL FILTER BASE .....	60
1	133-7003	FILLER GP-ENGINE OIL .....	57
1	144-6648	FILTER GP-ENGINE OIL .....	53
1	133-7001	GAUGE GP-OIL LEVEL (DIPSTICK) .....	56
1	130-0825	LINES GP-TURBOCHARGER OIL .....	58
COOLING SYSTEM			
1	115-2990	COOLER GP-ENGINE OIL.....	70
1	117-2792	FASTENER GP-OIL COOLER .....	71
1	116-5460	LINES GP-WATER.....	73
1	117-2778	LINES GP-WATER.....	74
1	143-2521	LINES GP-WATER.....	75
1	117-2789	PLUG GP-WATER LINES .....	77

H58182E 00

### 148-2005 ENGINE AR-COMplete (2/3)

S/N 6MW 1-00212, 8RW 1-00272  
Part of 147-7107-Page11

# ENGINE ARRANGEMENT

Consists of :

			Page
AIR INLET AND EXHAUST SYSTEM			
1	127-3288	ELBOW GP-AIR INLET .....	92
1	126-0081	LINES GP-AIR .....	85
1	117-2688	MANIFOLD GP-EXHAUST .....	87
FUEL SYSTEM			
1	116-5436	FILTER GP-FUEL.....	99
1	123-0783	FITTING GP-FUEL LINES .....	102
1	117-0184	FITTING GP-FUEL RETURN .....	103
1	117-0183	FITTING GP-FUEL SUPPLY .....	102
1	116-5403	LINES GP-FUEL INJECTION .....	96
1	116-5438	PUMP GP-FUEL PRIMING .....	94
1	116-5428	PUMP & MTG GP-FUEL TRANSFER.....	95
ELECTRICAL AND STARTING SYSTEM			
1	149-6092	ALTERNATOR GP-CHARGING .....	165
1	124-2673	CONTROL & MTG GP-ENGINE ELEK.....	158
1	102-5836	STARTING MOTOR GP-ELECTRIC .....	170

H58183E 00

## 148-2005 ENGINE AR-COMplete (3/3)

S/N 6MW 1-00212, 8RW 1-00272  
Part of 147-7107-Page11

## ENGINE ARRANGEMENT

Consists of :

			Page
		ENGINE ARRANGEMENT	
1	126-0052	ENGINE AR-CORE.....	16
		BASIC ENGINE	
1	132-3215	COVER GP-AIR COMPRESSOR.....	21
1	115-2985	COVER GP-CYLINDER BLOCK.....	20
1	127-5728	COVER GP-FLYWHEEL HOUSING.....	20
1	117-2766	DAMPER GP.....	34
1	117-2771	FASTENER GP-DAMPER.....	29
1	117-2794	FASTENER GP-FLYWHEEL.....	29
1	128-0392	FLYWHEEL GP.....	38
1	138-1989	HOUSING GP-FLYWHEEL.....	40
1	138-2550	MOUNTING GP-FAN DRIVE.....	50
1	141-6156	MOUNTING GP-REFRIGERANT COMPR.....	49
1	116-5408	MOUNTING GP-VALVE MECHANISM.....	47
1	131-6678	PAN GP-OIL.....	42
1	115-2984	PLUG GP-CYLINDER BLOCK.....	43
1	117-0185	PLUG GP-CYLINDER BLOCK.....	44
1	117-0165	PLUG GP-CYLINDER BLOCK.....	44
1	116-5452	PLUG GP-FRONT HOUSING.....	45
1	117-2795	PULLEY GP-CRANKSHAFT.....	38

H75068E 07

**148-2005 ENGINE AR-COMPLETE (1/3)**

S/N 6MW 00213-Up, 8RW 00273-Up

Part of 147-7107-Page11