



Parts Manual



See "General Information"
for New Parts Manual
Features.

323D, 323D L & 323D LN Excavators

CWG1-Up (Machine)
WNE1-Up (Machine)
ZMF1-Up (Machine)
GDC1874-Up (Engine)

Powered By C6.4 Engine

SAFETY.CAT.COM

Product and Dealer Information

Note: For product identification plate locations, see the section "Product Identification Information" in the Operation and Maintenance Manual.

Delivery Date: _____

Product Information

Model: _____

Product Identification Number: _____

Engine Serial Number: _____

Transmission Serial Number: _____

Generator Serial Number: _____

Attachment Serial Numbers: _____

Attachment Information: _____

Customer Equipment Number: _____

Dealer Equipment Number: _____

Dealer Information

Name: _____ Branch: _____

Address: _____

Dealer Contact

Phone Number

Hours

Sales: _____

Parts: _____

Service: _____

MEMORANDA

TABLE OF CONTENTS

Name	Page	Name	Page
GENERAL INFORMATION	A5	COOLING SYSTEM	67
REPAIR ALTERNATIVES	A8	COOLER GP-ENGINE OIL	67
SUPPLEMENTAL COOLANT ADDITIVES	A9	FAN GP-BLOWER	68
MAINTENANCE PARTS	A10	FAN GP-SUCTION	72
INDEX	A13	HOUSING & REGULATOR GP	74
MACHINE ARRANGEMENT	1	PUMP GP-WATER	75
CHASSIS AR	1	RADIATOR & HYD OIL COOLER GP	77
DISTRIBUTION AR	3	AIR INLET AND EXHAUST SYSTEM	88
GENERAL AR	4	AIR CLEANER & MOUNTING GP	88
OPTION AR-CAB	5	AIR CLEANER AR	89
OPTION AR-CONTROL	6	AIR CLEANER GP	90
OPTION AR-HYDRAULIC	7	CARTRIDGE AS-TURBOCHARGER	95
OPTION AR-LIGHTING	8	DRAIN GP-MUFFLER	96
OPTION AR-LINKAGE	8	LINES GP-AIR	97
OPTION AR-UNDERCARRIAGE	13	MANIFOLD GP-EXHAUST	104
ENGINE ARRANGEMENT	15	MANIFOLD GP-INLET	106
ENGINE AR	15	MUFFLER GP	109
ENGINE AR-COMPLETE	19	TURBOCHARGER GP	113
INSTALLATION AR-ENGINE	21	FUEL SYSTEM	116
BASIC ENGINE	23	CAP GP-FUEL FILLER	116
CAMSHAFT GP	23	FILTER GP-FUEL	117
COVER GP-VALVE MECHANISM	24	FILTER GP-WATER SEP & FUEL	123
CRANKSHAFT GP	26	INJECTOR GP-FUEL	124
CYLINDER BLOCK GP	27	LINES GP-FUEL	126
CYLINDER HEAD AS	31	MOUNTING GP-FUEL FILTER	133
CYLINDER HEAD GP	32	MOUNTING GP-PUMP	136
FLYWHEEL GP	33	PUMP & MOTOR GP-REFUELING	137
GEAR GP-FRONT	34	PUMP AR-FUEL TRANSFER	138
HOUSING GP-FLYWHEEL	35	PUMP GP-FUEL	139
HOUSING GP-FRONT	36	PUMP GP-REFUELING	140
MOUNTING GP-ALTERNATOR	39	TANK & MTG GP-FUEL	142
MOUNTING GP-ENGINE	40	TANK GP-FUEL	144
MOUNTING GP-STARTING MOTOR	41	VALVE GP-FUEL SHUTOFF	154
PAN GP-OIL	42	ELECTRICAL AND STARTING SYSTEM	155
PISTON & ROD GP	46	ALARM GP	155
PULLEY GP-ENGINE	48	ALARM GP-TRAVEL	156
PULLEY GP-IDLER	50	ALTERNATOR GP-CHARGING	157
VALVE MECHANISM GP	52	BATTERY & WIRING GP	158
LUBRICATION SYSTEM	54	BLOCK GP-JUNCTION	181
ADAPTER GP-REMOTE OIL FILTER	54	CAMERA & MOUNTING GP	183
BREATHER GP	56	CAMERA & WIRING GP	186
FILTER & MTG GP-ENGINE OIL	58	CAMERA GP	187
LINES GP-ENGINE OIL	62	CONTROL & MTG GP-COMMUNICATION	188
LINES GP-ENGINE OIL DRAIN	64	CONTROL & MTG GP-ENGINE ELEK	191
LINES GP-TURBOCHARGER OIL	66	CONTROL & MTG GP-MACHINE	192
		CONTROL AR-MACHINE	193
		ELECTRONICS GP- COMMUNICATION	193
		ELECTRONICS GP-MACHINE	193
		ELECTRONICS GP-MONITOR	194
		FASTENER GP-WIRING HARNESS	195

TABLE OF CONTENTS

Name	Page	Name	Page
GRADE CONTROL AR	199	COUNTERWEIGHT GP	344
INSTALLATION AR-COMMUNICATION	199	COVER AS-ACCESS	349
INSTALLATION GP-COMMUNICATION	199	COVER AS-SOUND SUPPRESSION	350
INSTALLATION GP-SECURITY	200	COVER GP-HOOD	354
LAMP GP-FLOOD	202	DOOR AS-ACCESS	356
LIGHTING GP-CHASSIS	205	DOOR GP-ACCESS	358
LIGHTING GP-FLOOD	206	FENDER & COVER GP	363
PANEL & MTG GP-CIRCUIT BREAKER	220	FRAME GP-UPPER	367
PANEL GP-CIRCUIT BREAKER	222	GEAR & BEARING GP-SWING	371
PANEL GP-SWITCH	225	GUARD AR	380
SENSOR GP-ENGINE	229	GUARD GP-BOTTOM	381
SENSOR GP-LIQUID LEVEL	230	GUARD GP-SWIVEL	385
STARTING MOTOR GP-ELECTRIC	233	HANDRAIL GP	386
SWITCH GP-DISCONNECT	235	HOOD & GUARD GP	388
SWITCH GP-MAGNETIC	236	HOOD GP-ENGINE	397
SWITCH GP-POSITION	239	SHEET AS-SOUND SUPPRESSION	406
SWITCH GP-PUSH BUTTON	240	STEP GP	423
SWITCH GP-ROTARY	242	SUPPORT AS-ENCLOSURE	426
SWITCH GP-START	243		
SWITCH GP-TOGGLE	244	UNDERCARRIAGE	435
SWITCH GP-WIPER	247	FRAME AR-UNDERCARRIAGE	435
WARNING AR-OVERLOAD	248	FRAME AS-UNDERCARRIAGE	436
WIRING GP-AUXILIARY CONTROL	249	GUARD GP-TRACK GUIDE	439
WIRING GP-BOOM FLOAT	258	GUARD GP-TRAVEL MOTOR	443
WIRING GP-CAB	263	IDLER GP-FRONT	445
WIRING GP-CAMERA	276	LINK AS-TRACK	449
WIRING GP-CHASSIS	278	ROLLER AR-TRACK & CARRIER	451
WIRING GP-COMMUNICATION	284	ROLLER GP-TRACK CARRIER	454
WIRING GP-CONSOLE	288	ROLLER GP-TRACK-SINGLE FLANGE	455
WIRING GP-CONVERTER	292	TRACK ADJUSTER & RECOIL GP	458
WIRING GP-ELECTRONIC CONTROL	294	TRACK AR	462
WIRING GP-ENGINE	296	TRACK GP	463
WIRING GP-FAN	298		
WIRING GP-FINE SWING	302	HYDRAULIC SYSTEM	471
WIRING GP-MEDIUM PRESSURE	303	ACCUMULATOR GP-HYDRAULIC	471
WIRING GP-OVERLOAD WARNING	305	BASE GP-OIL FILTER	478
WIRING GP-PLATFORM	306	CONTROL AR-AUXILIARY	479
WIRING GP-QUICK COUPLER	309	CONTROL AR-BOOM	482
WIRING GP-RADIO	314	CONTROL AR-COUPLER	483
WIRING GP-REFUELING PUMP	316	COUPLING GP-FLEXIBLE	484
		COUPLING GP-PUMP	485
POWER TRAIN	318	CYLINDER & LINES GP-BOOM	486
FINAL DRIVE GP	318	CYLINDER & LINES GP-BUCKET	487
DRIVE GP-FINAL	319	CYLINDER & LINES GP-STICK	488
GEAR GP-RING	323	CYLINDER & SEAL GP-BOOM	490
GEAR GP-TRANSFER	326	CYLINDER & SEAL GP-BUCKET	495
POWER TRAIN AR	326	CYLINDER & SEAL GP-STICK	503
SPROCKET GP	327	CYLINDER GP-BOOM	510
		CYLINDER GP-STICK	512
FRAME AND BODY	328	DRIVE GP-SWING	514
BOX & MTG GP-STORAGE	328	FASTENER GP-SWING & FINAL DR	517
BOX GP-STORAGE	330	FILTER & VALVE GP-PILOT	521
BUMPER GP	334	FILTER GP-OIL	522
BUMPER GP-FRONT	336	FITTING GP-HYDRAULIC	527
COUNTERWEIGHT & MOUNTING GP	338	GAUGE GP-SIGHT	528

TABLE OF CONTENTS

Name	Page	Name	Page
HEAD GP-PUMP	529	VALVE GP-TRAVEL	
HOSE GP-HYDRAULIC	536	COUNTERBALANCE	904
HYDRAULIC AR	545		
HYDRAULIC AR-BIODEGRADABLE		IMPLEMENTS	905
OIL	546	BOOM AR-1 PIECE LONG	905
LINES GP-AUXILIARY HYDRAULIC	547	BOOM AR-1 PIECE SHORT	906
LINES GP-BOOM	570	BOOM AR	906
LINES GP-BOOM CYLINDER	577	BOOM GP	907
LINES GP-BUCKET CYLINDER	595	BOOM GP-1 PIECE	915
LINES GP-COUPLER	603	CONVERSION GP-LINKAGE	917
LINES GP-FRONT	611	LINES GP-GREASE	918
LINES GP-HYDRAULIC OIL COOLER	650	LINKAGE AR-BUCKET	921
LINES GP-PILOT	655	LINKAGE GP-BUCKET	923
LINES GP-PUMP	730	STICK AR-HOE	927
LINES GP-RETURN	747	STICK GP-HOE	929
LINES GP-SENSOR	758		
LINES GP-STICK CYLINDER	759	WORK TOOLS	938
LINES GP-TRAVEL MOTOR	765	ADJUSTER GP-BUCKET	938
MANIFOLD GP-CONTROL	772	BUCKET & ADJUSTER GP	939
MOTOR & MTG GP-SWING	775	BUCKET AS-EXCAVATION	945
MOTOR & MTG GP-TRAVEL	776	BUCKET AS-EXTREME EXCAVATION	952
MOTOR GP-PISTON	778	SIDECUTTER GP	955
MOTOR GP-SWING	786	TIP GP-DOUBLE SPIKE	956
MOUNTING GP-MAIN CONTROL		TIP GP-EXTRA-DUTY	957
VALVE	789	TIP GP-GENERAL PURPOSE	958
PLUG GP-CONTROL VALVE	790	TIP GP-PENETRATION	959
PUMP & MTG GP-AUXILIARY	791	TIP GP-PENETRATION PLUS	960
PUMP & MTG GP-MAIN HYDRAULIC	792	TIP GP-SPIKE	962
PUMP GP-GEAR	793	TIP GP-WIDE	963
PUMP GP-MAIN HYDRAULIC	794		
SCREEN GP-HYDRAULIC	799	OPERATOR STATION	964
SWIVEL GP	800	AIR CONDITIONER & MOUNTING GP	964
TANK & FILTER GP-HYDRAULIC	802	AIR CONDITIONER AR	966
TANK & MTG GP-HYDRAULIC	806	AIR CONDITIONER GP	967
VALVE & MTG GP-CONTROL	809	ARMREST GP	969
VALVE AR-CHECK & RELIEF	812	CAB GP	971
VALVE AR-LOAD CONTROL	813	CAMERA & MIRROR AR	977
VALVE AR-SWING	813	COIL GP-EVAPORATOR	978
VALVE GP-CHECK	814	COMPRESSOR GP-REFRIGERANT	980
VALVE GP-CONTROL	821	CONDENSER & MTG GP-	
VALVE GP-FLOW CONTROL	840	REFRIGERANT	983
VALVE GP-LOAD CONTROL	841	CONDENSER GP-REFRIGERANT	988
VALVE GP-MAIN CONTROL	850	CONSOLE GP-OPERATOR	989
VALVE GP-MANUAL	851	CONTROL & MTG GP-JOYSTICK	995
VALVE GP-PILOT	852	CONTROL GP-FOOT	999
VALVE GP-PRESSURE REDUCING	861	CONTROL GP-HANDLE	1000
VALVE GP-PRIORITY	863	CONTROL GP-HEAT & AIR COND	1006
VALVE GP-RELIEF	864	CONTROL GP-HYDRAULIC PEDAL	1007
VALVE GP-SELECTOR	876	CONTROL GP-JOYSTICK	1009
VALVE GP-SHUTTLE	878	CONTROL GP-PILOT OPERATED	
VALVE GP-SOLENOID	885	HYD	1011
VALVE GP-SOLENOID & PRESS		COVER GP-CAB	1016
REDC	896	COVER GP-STORAGE	1018
VALVE GP-SOLENOID & RELIEF	897	DOOR GP-CAB	1019
VALVE GP-SWING CUSHION	900	DUCT GP-CAB AIR	1021

TABLE OF CONTENTS

Name	Page	Name	Page
FLOOR MAT	1022		
GUARD GP-CAB	1028		
GUARD GP-WINDOW	1029		
HATCH GP-ROOF	1034		
HEATER & MTG GP-CAB	1037		
HEATER AR-CAB	1039		
HORN GP-ELECTRIC	1040		
INSTALLATION AR	1042		
INSTALLATION GP-RADIO	1043		
KIT-SEAT SUSPENSION	1047		
LATCH GP-FRONT WINDOW	1049		
LEVER GP-CAB DOOR	1050		
LINES GP-AIR CONDITIONER	1052		
LINES GP-HEATER	1062		
LITERATURE GP	1065		
MIRROR AR-DOWN VIEW	1065		
MIRROR AR-REAR VIEW	1065		
MIRROR GP-DOWN VIEW	1066		
MIRROR GP-REAR VIEW	1067		
MONITOR & MTG GP-OPERATOR	1072		
MONITOR GP-OPERATOR	1073		
MOTOR AS-WINDOW WIPER	1074		
MOUNTING GP-ANTENNA	1075		
MOUNTING GP-MIRROR	1079		
MOUNTING GP-PLATFORM	1080		
MOUNTING GP-ROPS	1081		
OPERATOR AR	1082		
PEDAL AR-THIRD	1082		
PLATFORM GP-OPERATOR	1083		
RADIO GP	1084		
RADIO GP-COMMUNICATION	1085		
SCREEN GP-SUN	1086		
SEAT & MOUNTING GP	1087		
SEAT BELT GP	1090		
SEAT GP	1091		
SEAT GP-SUSPENSION	1093		
STRIKER GP-LATCH	1096		
SUPPORT AS	1098		
SUPPORT GP-SEAT	1099		
SUSPENSION GP-SEAT	1100		
TRIM GP-CAB	1102		
VISOR GP-CAB	1106		
VISOR GP-PROTECTION	1108		
WASHER GP-WINDOW	1109		
WINDOW GP-CAB	1111		
WINDOW GP-DOOR	1115		
WINDOW GP-FRONT	1116		
WIPER & WASHER GP-WINDOW	1118		
WIPER GP-WINDOW	1120		
SERVICE EQUIPMENT AND SUPPLIES	1121		
FILM GP	1121		
PLATE & FILM GP	1134		
PART NUMBER INDEX	B1		

GENERAL INFORMATION

1. MACHINE IDENTIFICATION

Caterpillar machines are identified by Product Identification Numbers (PIN). Some components included in a machine may be identified by Serial Numbers (S/N). Typical components that will be serialized include engines, transmissions, bulldozers, and rippers. The machine and engine are further identified by arrangement numbers and in some cases modification numbers. These numbers are shown on the product identification plate(s) and on the master plate in the operator's compartment.

Caterpillar dealers need all of these numbers to determine accurate parts identification.

New Feature

Effective First Quarter 2001 the Caterpillar Product Identification Number (PIN) changed from 8 to 17 characters. In an effort to provide uniform equipment identification, Caterpillar and other construction equipment manufacturers are moving to comply with the latest version of the product identification numbering standard. Non-road machine PINs are defined by ISO 10261. The new PIN format will apply to all Caterpillar machines and generator sets. The PIN plates and frame marking will display the 17 character PIN. The new format will look like the following:

*** C A T 0 7 8 9 B G 6 S L 1 2 3 4 5 ***

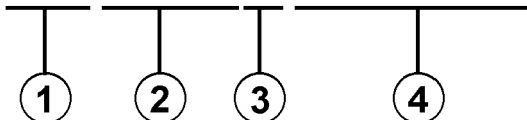

The diagram shows the 17-character PIN format: * C A T 0 7 8 9 B G 6 S L 1 2 3 4 5 *. Below the characters, a horizontal line spans from the first character to the last. Four vertical lines connect this horizontal line to four numbered circles below. The circles are labeled 1, 2, 3, and 4. Circle 1 is under 'C', circle 2 is under 'A', circle 3 is under 'T', and circle 4 is under '5'. This indicates that the first three characters (CAT) are grouped as 1, characters 4-8 (0789BG) as 2, character 9 (6) as 3, and characters 10-17 (SL12345) as 4.

Where:

1. Caterpillar's World Manufacturing Code (characters 1-3)
2. Machine Descriptor (characters 4-8)
3. Check Character (character 9)
4. Machine Indicator Section (MIS) or Product Sequence Number (characters 10-17). These were previously referred to as the Serial Number.

Machines and generator sets produced before First Quarter 2001 will maintain their 8 character PIN format.

Components such as engines, transmissions, axles, etc. and work tools will continue to use an 8 character Serial Number (S/N).

2. ORDERING PARTS

WARNING

When replacement parts are required for this product Caterpillar recommends using Caterpillar replacement parts or parts with equivalent specifications including, but not limited to, physical dimensions, type, strength and material.

Failure to heed this warning can lead to premature failures, product damage, personal injury or death.

Quality Caterpillar replacement parts are available from Caterpillar dealers throughout the world. Their parts inventories are up to date and include all parts normally required to protect your investment in Caterpillar machines. Dealers may offer repair kits or remanufactured parts to allow selection of the most effective repair alternative for a particular situation. When ordering parts, your order should specify the quantity, part number, part name, and the serial number/product identification number of the machine for which the parts are needed.

3. PARTS MANUAL ORGANIZATION

Product information in this manual is presented as "information elements" that represent all of the components for the specific model. Engine Arrangement and Seat Group are examples of information elements. The information elements are organized alphabetically by part name and secondarily by part number within each major section of the manual.

4. TABLE OF CONTENTS

A table of contents (TOC) is found at the beginning of the manual. The TOC lists each section of the manual with a complete list of all information elements organized as they appear in the manual. Page numbers are provided for quick reference to detailed parts identification illustrations and serviceable consist lists.

5. MAINTENANCE PARTS INDEX

The Maintenance Parts Index, located near the beginning of the manual, references most frequently used maintenance part numbers, providing description, quantity, usage and page number. This information is organized alphabetically by part description.

GENERAL INFORMATION

6. INDEX

The index located near the front of the manual is an alphabetical listing of all information elements included in the manual. Page numbers are provided for quick reference to detailed parts identification illustrations and serviceable consist lists.

7. PART NUMBER INDEX

A numerical index listing all part numbers and the corresponding page number(s) appears at the back of the manual.

8. CAPTIONS

Captions located at the beginning of each information element identify the part number and part name along with additional descriptive information. PIN and S/N information found in each caption should be used to select correct information for a specific machine. Field replacement options, identification of optional attachment components, and where used ("part of") information is also provided.

The first line of a caption is shown in larger type font to indicate the beginning of an information element. Captions for additional pages that may be required to illustrate an information element will be shown in standard type font and will include the term (*contd.*) .

9. NON-SERVICED PARTS

In some instances it is necessary to display non-serviced parts that are a link to a lower level serviceable consist lists. These non-serviced part numbers are shown in *italic* type indicating that they are not available.

10. PARTS LIST REFERENCE NUMBERS

Numbers shown in the Ref No column correspond to numbers used in the associated graphic(s). An alphabetic suffix may be added to a reference number to identify lower level consist items. Numbers shown in the Graphic Ref column refer to the graphic number identifier displayed in the lower left corner of each illustration. The Graphic Ref number may be used in combination with the item Ref No to determine the correct part number. There may be intentional omission of a Ref No in a consist list as information is updated to reflect the latest serviceable part numbers.

11. INDENTED PART NAMES

When a part name is indented in a parts list, it is part of (included in) the group or assembly under which it is indented.

12. ILLUSTRATION REFERENCE LETTERS

When necessary, illustrations contain reference letters (A, B, C etc.) that are intended to track lines and harnesses from one point to another. They are also used to show where to reconnect illustrations that have been separated.

13. ABBREVIATIONS AND SYMBOLS

O.D. – Outside Diameter
I.D. – Inside Diameter
A – Not Part Of This Group
B – Use As Required
C – Change From Previous Type
D – Order By The Meter
E – Order By The Centimeter
F – Not Shown
G – Order By The Inch
I – Refer To Hydraulic Information System
M – Metric Part
R – Remfg Part May Be Available
Y – Separate Illustration
Z – Not Serviced Separately

 **New Feature**

14. DESCRIPTION OF TYPE CHANGES

Type - A type is defined as any configuration change that requires an additional Information Element for an Arrangement, Group, or Assembly. If serial number breaks for types are not available, a type # (Type 1, Type 2, etc.) will be displayed in the caption. These "type" changes are identified with a "C" note (change from previous type) in the Parts List. Only the "types" that apply to this Parts Manual will be included. Additional types may exist causing "C" notes to appear on an Information Element when no other types are shown.

15.<END>

This symbol indicates the end of an information element.

NOTE:

Continuing improvement and advancement of product design may cause changes to your machine which may not be included in this publication. Whenever a question arises regarding your Caterpillar product or this publication, please consult your Caterpillar dealer for the latest available information.

GENERAL INFORMATION

8 FRAME AND BODY					
8E-3299 PLATFORM GP-CAB					
PIN 3841-99999					
100090751					
NOTE	REF NO	GRAPHIC REF	PART NUMBER	QTY	PART NAME
	1		31-2982	1	PLATE AS
	2		68-2982	25	BOLT (3/8-18X.750IN)
	3		68-1078	41	WASHER-HARD (3MM THK)
	4		68-1444	2	SUPPORT AS-FOOT
	5		77-2229	19	BOLT (1/2-13X1IN)
	6		77-2229	19	WASHER-HARD (4MM THK)
	8		68-8136	2	COVER AS-LH
	8		68-8136	2	COVER AS-RH
	7		17-8189	1	CLIP
	7		78-2411	4	COVER
	8		64-8486	18	SCREW-HEAD (3/8-18X.875IN)
	9		77-0774	1	COVER
	10		68-8136	1	GASKET
	10		68-2280	1	GASKET
	11		31-3496	1	HANDHOLD
	12		68-8136	1	COVER AS
	13		68-8136	8	NUT-WELD (3/8-16 THD)
	13		68-8136	1	GASKET
	14		77-0131	1	FLOORPLATE AS
	14		17-0752	4	NUT-WELD (1/2-13 THD)
	14		77-8087	1	PLUS-BUTTON
	16		77-0136	1	PLATE AS
	18		68-8136	5	NUT-WELD (3/8-16 THD)
	18		77-8089	1	COVER
	17		77-0770	1	GASKET
	17		31-2981	1	PLATE AS
	18		81-8484	4	BOLT (1/4-20X.825IN)
	18		81-8484	4	WASHER-HARD (2MM THK)
	19		61-8484	1	FLOOR MAT
	20		68-8136	1	MODULE AS-OPERATOR
	21		31-3494	1	HANDHOLD
	22		68-8136	2	PLUS
	22		81-8384	4	BOLT (1/4-20X.825IN)
	24		68-8136	4	WASHER-HARD (2MM THK)
	24		68-2982	17	BOLT (3/8-18X.750IN)
	26		68-1078	21	WASHER-HARD (3MM THK)
	26		77-0136	1	SEAL
	27		78-0378	2	BOLT (3/4-10X5IN)
	27		78-0382	2	WASHER-HARD (5MM THK)
	28		31-3482	2	PLATE AS
	29		31-3480	1	PLATE AS
	30		78-0388	8	SPACER
	30		31-3581	1	SEAL
	31		78-8817	1	GASKET
	32		78-8816	1	COVER AS
	32		68-8136	2	WASHER
	32		68-8136	2	SCREW-KNURLED
	33		68-2428	1	COVER
	34		68-8887	1	COVER
	35		68-8881	8	SCREW-BOCKET HEAD
	38		68-3142	8	MOUNTING
	37		68-0027	2	PLATE
	38		78-0389	2	BOLT (1/2-8X5IN)
	39		78-0373	2	WASHER-HARD
	39		41-8484	4	BOLT (3/8-18X1.02IN)
	40		31-6783	1	COVER

12 FRAME AND BODY 1 of 4 SELP 170-01

8E-3299 PLATFORM GP-CAB (contd.)					
100090751					
NOTE	REF NO	GRAPHIC REF	PART NUMBER	QTY	PART NAME
	41		68-8816	1	COVER
	42		77-0134	1	PLATE
	43		77-0128	1	GASKET
	44		78-8724	1	GASKET
	45		78-8723	1	COVER
	48		68-1069	2	PLUS-BUTTON

M-METRIC PART

SELPA670-01 2 of 4

FRAME AND BODY 13

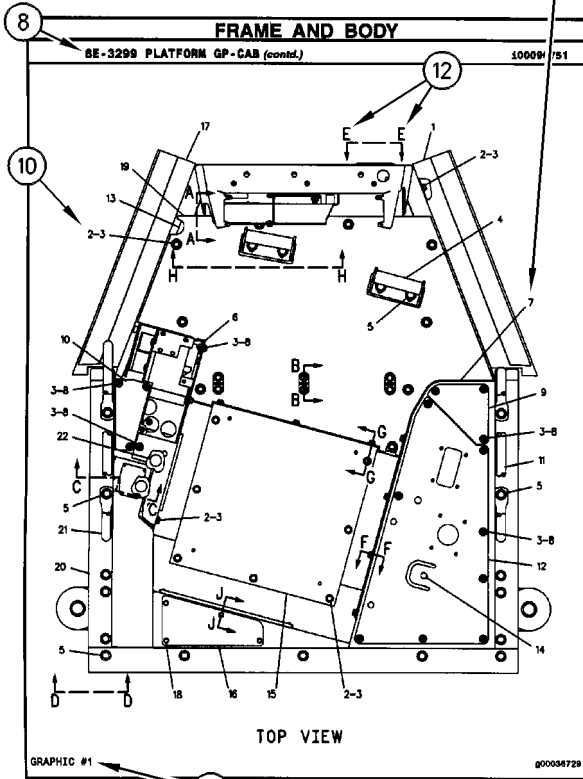

14 FRAME AND BODY 3 of 4 SELPA670-01

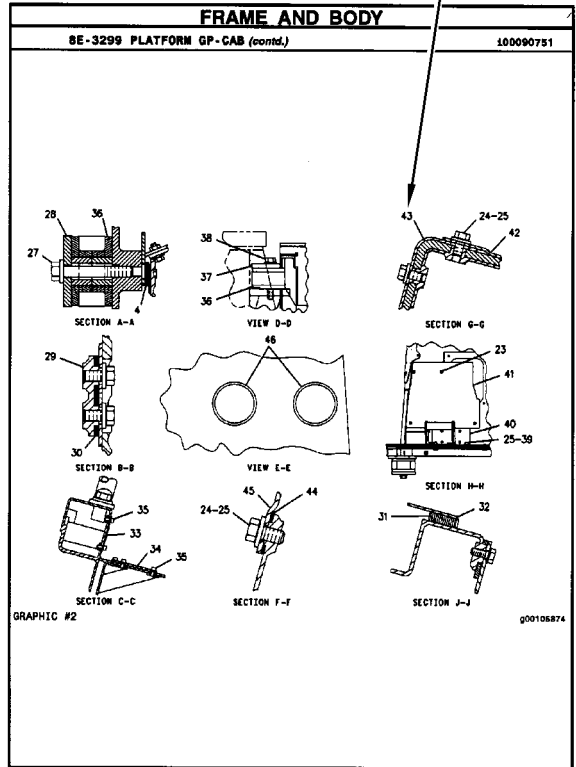

SELPA670-01 4 of 4

FRAME AND BODY 15

REPAIR ALTERNATIVES

REMANUFACTURED COMPONENTS

As an option when making repairs consider Caterpillar Remanufactured Components. Components that are available through the Caterpillar Remanufactured Program are identified three ways in the parts book:

- with the letter R in the note field of the parts list
- with an R* at the beginning of the first line of the caption
- with an *R at the end of the first line of the caption

Typical components included in the Remanufacturing Program include:

ALTERNATORS
CONNECTING RODS
CRANKSHAFTS - UNDERSIZE
CRANKSHAFTS - UPGRADE TO NEW
CYLINDER HEADS
ELECTRONIC CONTROL MODULES (ECM)
ELECTRONIC SENSORS
FUEL INJECTORS
FUEL NOZZLES
FUEL PUMPS
GOVERNORS
OIL PUMPS
PISTONS
SHORT BLOCKS
STARTERS
TURBOCHARGERS - COMPLETE
TURBOCHARGER CARTRIDGES
WATER PUMPS

Caterpillar Remanufactured engines for many engine arrangements are also available.

SUPPLEMENTAL COOLANT ADDITIVES

CUSTOMER BENEFITS:

Protects against cavitation, foam, erosion, corrosion, and scale buildup in cooling systems.

- Provides measured coolant conditioner.

DESCRIPTION:

Additives deplete from the coolant with normal operation. For this reason, Supplemental Coolant Additives (SCA) must be added to all heavy duty coolants at regular intervals. In addition, when not using a fully formulated, pre-charged antifreeze, like Caterpillar's DEAC, an initial charge of SCA must be added to the cooling system. The amount of SCA added to the system is dependent on the capacity of the system.

The SCA for initial fill is provided as a liquid. SCA's for maintenance intervals are available in liquid form and as a spin-on element. (No Spin-on available for 3600 Family of Engines)

NOTE:

The amount of SCA added at initial fill is not the same as the amount added at maintenance intervals.

The coolant additive elements can be used with any ethylene or propylene glycol type antifreeze which meets ASTM D4985 or ASTM D5345 Specifications.

NOTE:

For use with standard heavy duty coolant only, not for use with Extended Life Coolant.

PARTS NEEDED:

Cooling System Capacity		Liquid SCA at Initial Fill	Liquid SCA at Maintenance*	Spin-on SCA Maintenance Element*
Liters	Gallons			
22-30	(6-8)	3P-2044 (1)	6V-3542 (1)	111-2370 (1)
30-38	(8-10)	3P-2044 (1) 6V-3542 (1)	111-2372 (1)	111-2369 (1)
38-49	(10-13)	3P-2044 (1) 8T-1589 (1)	111-2372 (1)	111-2369 (1)
49-64	(13-17)	3P-2044 (2)	8T-1589 (1)	9N-3368 (1)
64-83	(17-22)	3P-2044 (2) 8T-1589 (1)	111-2372 (1) 6V-3542 (1)	111-2371 (1)
83-114	(22-30)	3P-2044 (3) 8T-1589 (1)	3P-2044 (1)	9N-3718 (1)
114-163	(30-43)	3P-2044 (5)	3P-2044 (1) 6V-3542 (1)	111-2371 (2)
163-242	(43-64)	3P-2044 (8)	3P-2044 (2)	9N-3718 (2)

* Normal maintenance period is 250 hrs. See your Operation and Maintenance Manual for complete coolant maintenance instructions.

() Indicates quantity required.

MAINTENANCE PARTS

DESCRIPTION	PART NUMBER	QTY	WHERE USED	PAGE
AIR INLET AND EXHAUST SYSTEM				
FILTER ELEMENT AS-AIR (PRIMARY)	131 - 8822	1	AIR CLEANER GP	93
FILTER ELEMENT AS-AIR (PRIMARY, STANDARD EFFICIENCY)	6I - 2501	1	AIR CLEANER GP	94
FILTER ELEMENT AS-AIR (PRIMARY, ULTRA HIGH EFFICIENCY)	128 - 2686	1	AIR CLEANER GP	94
FILTER ELEMENT AS-AIR (SECONDARY)	131 - 8821	1	AIR CLEANER GP	93
	6I - 2502	1	AIR CLEANER GP	94
FILTER ELEMENT AS-AIR (ULTRA HIGH EFFICIENCY) (PRIMARY)	134 - 0685	1	AIR CLEANER GP	93
BASIC ENGINE				
BELT-SERPENTINE	294 - 1781	1	PULLEY GP-ENGINE	48
CAP (ENGINE OIL FILLER)	294 - 1708	1	COVER GP-VALVE MECHANISM	24
GASKET (VALVE COVER)	294 - 1706	1	COVER GP-VALVE MECHANISM	24
PLUG (ENGINE OIL DRAIN)	222 - 8235	1	PAN GP-OIL	44
COOLING SYSTEM				
CAP AS (COOLANT RECOVERY)	171 - 3369	1	RADIATOR & HYD OIL COOLER GP	82
			RADIATOR & HYD OIL COOLER GP	84
CAP AS-RADIATOR	245 - 9212	1	RADIATOR & HYD OIL COOLER GP	77
			RADIATOR & HYD OIL COOLER GP	79
CAP-RADIATOR	341 - 2143	1	RADIATOR & HYD OIL COOLER GP	86
GASKET (WATER TEMPERATURE REGULATOR)	294 - 1780	1	HOUSING & REGULATOR GP	74
	5I - 7735	1	HOUSING & REGULATOR GP	74
HOSE-LOWER RADIATOR	245 - 9178	1	RADIATOR & HYD OIL COOLER GP	82
HOSE-RADIATOR (LOWER)	245 - 9194	1	RADIATOR & HYD OIL COOLER GP	84
HOSE-RADIATOR (UPPER)	265 - 3673	1	RADIATOR & HYD OIL COOLER GP	84
HOSE-UPPER RADIATOR	265 - 3602	1	RADIATOR & HYD OIL COOLER GP	82
SCREEN AS (OIL COOLER)	265 - 3634	1	RADIATOR & HYD OIL COOLER GP	77
			RADIATOR & HYD OIL COOLER GP	79
	313 - 3764	1	RADIATOR & HYD OIL COOLER GP	86
SCREEN AS (RADIATOR)	265 - 3635	1	RADIATOR & HYD OIL COOLER GP	77
			RADIATOR & HYD OIL COOLER GP	79
	313 - 3763	1	RADIATOR & HYD OIL COOLER GP	86

MAINTENANCE PARTS

DESCRIPTION	PART NUMBER	QTY	WHERE USED	PAGE
ELECTRICAL AND STARTING SYSTEM				
BATTERY (12-VOLT, MAINTENANCE FREE, WET)	3T-5760	2	BATTERY & WIRING GP	160
		2	BATTERY & WIRING GP	170
	9X-3404	4	BATTERY & WIRING GP	158
		4	BATTERY & WIRING GP	168
		4	BATTERY & WIRING GP	179
CAP AS-FILLER (BATTERY)	123-1373	6	BATTERY & WIRING GP	160
CIRCUIT BREAKER AS (120-AMPERE) (HEATER)	216-4970	1	PANEL GP-CIRCUIT BREAKER	222
CIRCUIT BREAKER AS (60-AMPERE) (ALTERNATOR)	171-2208	1	PANEL GP-CIRCUIT BREAKER	222
CIRCUIT BREAKER AS (80-AMPERE) (MAIN)	171-2210	1	PANEL GP-CIRCUIT BREAKER	222
FUSE (10-AMPERE)	113-8490	20	WIRING GP-CAB	264
FUSE (15-AMPERE)	113-8491	1	WIRING GP-CAB	263
		5	WIRING GP-CAB	264
FUSE (20-AMPERE)	113-8492	3	WIRING GP-CAB	264
FUSE (25-AMPERE)	113-8493	3	WIRING GP-CAB	264
FUSE (30-AMPERE)	124-3548	2	WIRING GP-CAB	264
FUSE (5-AMPERE)	141-2759	1	PANEL GP-CIRCUIT BREAKER	222
		7	WIRING GP-CAB	264
KEY (BATTERY DISCONNECT)	8H-5306	1	SWITCH GP-DISCONNECT	235
KEY AS-ELECTRONIC (SECURITY)	206-5162	2	INSTALLATION GP-SECURITY	200
LAMP AS (24-VOLT, 3-WATT)	170-9324	1	PANEL GP-SWITCH	225
LAMP-HALOGEN (24-VOLT, 70-WATT)	9X-3463	1	LAMP GP-FLOOD	202
		1	LAMP GP-FLOOD	203
		1	LAMP GP-FLOOD	204
		1	LIGHTING GP-FLOOD	214
		1	LIGHTING GP-FLOOD	218
FUEL SYSTEM				
CAP GP-FUEL FILLER (EXTREME SERVICE, LOCKABLE)	164-4858	1	TANK GP-FUEL	145
		1	TANK GP-FUEL	147
		1	TANK GP-FUEL	150
		1	TANK GP-FUEL	152
COVER AS-FILTER	190-9775	1	CAP GP-FUEL FILLER	116
FILTER (ADVANCED EFFICIENCY) (FUEL)	1R-0751	2	FILTER GP-FUEL	117
		2	FILTER GP-FUEL	120
FILTER AS-WATER SEP & FUEL (PRIMARY)	326-1644	1	FILTER GP-WATER SEP & FUEL	123
GASKET (FUEL PRIMING PUMP)	294-1820	1	FILTER GP-FUEL	117
		1	FILTER GP-FUEL	120
SEAL-RING (FUEL, WATER SEPARATOR)	220-8678	1	FILTER GP-WATER SEP & FUEL	123
STRAINER AS-FUEL	229-1860	1	PUMP GP-REFUELING	140
STRAINER AS-FUEL (FLOAT GAUGE)	303-9933	1	TANK GP-FUEL	145
		1	TANK GP-FUEL	147
		1	TANK GP-FUEL	150
		1	TANK GP-FUEL	152

MAINTENANCE PARTS

DESCRIPTION	PART NUMBER	QTY	WHERE USED	PAGE
HYDRAULIC SYSTEM				
BREATHER (SWING DRIVE)	4H-6112	1	DRIVE GP-SWING	516
BREATHER AS (SWING DRIVE)	227-6221	1	DRIVE GP-SWING	516
FILTER ELEMENT AS-OIL (ULTRA HIGH EFFICIENCY) (HYDRAULIC RETURN)	179-9806	1	FILTER GP-OIL	524
FILTER-OIL (ADVANCED EFFICIENCY) (HYDRAULIC)	5I-8670	1	FILTER & VALVE GP-PILOT	521
FILTER-OIL (ADVANCED EFFICIENCY) (HYDRAULIC, CASE DRAIN)	093-7521	1	FILTER GP-OIL	526
PLUG-DRAIN (HYDRAULIC OIL)	4B-7739	1	TANK & FILTER GP-HYDRAULIC	802
PLUG-DRAIN (HYDRAULIC TANK)	4B-7739	1	TANK & FILTER GP-HYDRAULIC	804
PLUG-O-RING	9S-4185	1	LINES GP-BOOM CYLINDER	587
		1	LINES GP-BOOM CYLINDER	589
		1	LINES GP-FRONT	632
		1	LINES GP-PILOT	683
		1	LINES GP-PILOT	703
		1	LINES GP-PUMP	737
		1	LINES GP-RETURN	747
		1	LINES GP-RETURN	749
		1	LINES GP-RETURN	751
		1	LINES GP-RETURN	757
		1	MOTOR GP-PISTON	782
		2	PUMP GP-MAIN HYDRAULIC	795
SCREEN AS (HYDRAULIC TANK)	209-6000	1	SCREEN GP-HYDRAULIC	799
LUBRICATION SYSTEM				
BREATHER (CRANKCASE)	5I-7725	1	BREATHER GP	56
		1	BREATHER GP	57
FILTER AS-ENGINE OIL (STANDARD EFFICIENCY)	1R-0739	1	FILTER & MTG GP-ENGINE OIL	58
		1	FILTER & MTG GP-ENGINE OIL	60
MACHINE ARRANGEMENT				
SEAT BELT GP (RETRACTABLE, 43-MM)	305-0467	1	OPTION AR-CAB	5
OPERATOR STATION				
BLADE AS-WIPER (300-MM)	336-1203	1	WIPER & WASHER GP-WINDOW	1118
BLADE AS-WIPER (600-MM)	161-3670	1	WIPER GP-WINDOW	1120
CAP AS (WINDOW WASHER)	178-5431	1	WASHER GP-WINDOW	1109
FILTER ELEMENT-CAB AIR	245-7823	1	AIR CONDITIONER GP	967
FILTER ELEMENT-CAB AIR (AIR INTAKE)	327-6618	1	DUCT GP-CAB AIR	1021
FILTER GP-AIR (AIR CONDITIONER)	293-1137	1	AIR CONDITIONER GP	967
LAMP (24-VOLT, 10-WATT)	201-4417	1	CAB GP	971
RECEIVER-REFRIGERANT DRYER	176-1902	1	LINES GP-AIR CONDITIONER	1052
		1	LINES GP-AIR CONDITIONER	1055
		1	LINES GP-AIR CONDITIONER	1059
SEAT BELT GP	327-6541	1	SEAT BELT GP	1090
V-BELT (AIR CONDITIONER COMPRESSOR)	255-2927	1	COMPRESSOR GP-REFRIGERANT	980

INDEX

Name	Page	Name	Page
A			
ACCUMULATOR GP-HYDRAULIC- CHARGED	471	BOOM AR-1 PIECE LONG-HIGH AMBIENT	906
	472	BOOM AR-1 PIECE SHORT	906
	473	BOOM GP	907
	474		911
	475	BOOM GP-ACCUGRADE	909
	476	BOOM GP-ACCUGRADE READY	913
ACCUMULATOR GP-HYDRAULIC- UNCHARGED	477	BOOM GP-1 PIECE	915
ADAPTER GP-REMOTE OIL FILTER-ENGINE ...	54	BOX & MTG GP-STORAGE	328
ADJUSTER GP-BUCKET-B-FAMILY	938		329
AIR CLEANER & MOUNTING GP	88	BOX GP-STORAGE	330
AIR CLEANER AR-PRECLEANER, FILTER	89		332
AIR CLEANER GP	90	BREATHER (CRANKCASE)	56
	92		57
	93	BREATHER (SWING DRIVE)	516
	94	BREATHER AS (SWING DRIVE)	516
AIR CONDITIONER & MOUNTING GP	964	BREATHER GP (HYDRAULIC TANK)	802
AIR CONDITIONER AR	966		804
AIR CONDITIONER AR-CHASSIS	966	BREATHER GP-CRANKCASE	56
AIR CONDITIONER GP	967		57
ALARM GP-FAULT	155	BUCKET & ADJUSTER GP- EXCAVATION, B-FAMILY	939
ALARM GP-TRAVEL-BACKUP	156		940
ALTERNATOR GP-CHARGING	157		942
ARMREST GP-LH	970		943
ARMREST GP-RH	969		944
B			
BASE AS (FUSE, RELAY PANEL)	265	BUCKET & ADJUSTER GP- EXTREME EXCAVATION, B-FAMILY	943
BASE GP-OIL FILTER-HYDRAULIC	478		944
BATTERY & WIRING GP	160		945
	170	BUCKET AS-EXCAVATION-B-FAMILY	946
BATTERY & WIRING GP-COLD WEATHER	158		947
	168		948
	179		949
BATTERY			950
(12-VOLT, MAINTENANCE FREE, WET)	158	BUCKET AS-EXTREME EXCAVATION- B-FAMILY	952
	160		953
	168		954
	170	BUMPER GP-SIDE	334
	179		335
BELT-SERPENTINE	48	BUMPER GP-FRONT-WIPER, LOWER	337
BLADE AS-WIPER (300-MM)	1118	BUMPER GP-FRONT- WITHOUT LOWER WIPER	336
BLADE AS-WIPER (600-MM)	1120	C	
BLOCK GP-JUNCTION	182	CAB GP	973
BLOCK GP-JUNCTION (BATTERY)	181		975
	182	CAB GP-EXTERIOR	971
BLOCK GP-JUNCTION-BATTERY	181	CAMERA & MIRROR AR	977
BOOM AR-1-PIECE SHORT	906	CAMERA & MOUNTING GP	185
BOOM AR-1 PIECE LONG	905	CAMERA & MOUNTING GP- WORK AREA VISUAL SYSTEM, REAR	183
BOOM AR-1 PIECE LONG- ACCUGRADE READY	905	CAMERA & WIRING GP	186

INDEX

Name	Page	Name	Page
CAMERA GP	187	CONTROL AR-AUXILIARY–	
CAMSHAFT GP	23	COOLING CIRCUIT, HYDRAULIC OIL	479
CAP (ENGINE OIL FILLER)	24	CONTROL AR-AUXILIARY–FOOT SWITCH	481
CAP AS (COOLANT RECOVERY)	82	CONTROL AR-AUXILIARY–	
	84	MEDIUM PRESSURE	479
CAP AS (WINDOW WASHER)	1109		480
CAP AS-FILLER (BATTERY)	160	CONTROL AR-AUXILIARY–	
CAP AS-RADIATOR	77	SYSTEM 16, 1-WAY, 2-PUMP	479
	79		480
CAP GP-FUEL FILLER		CONTROL AR-AUXILIARY–	
(EXTREME SERVICE, LOCKABLE)	145	SYSTEM 17, COMBINED FN, MED PR	481
	147	CONTROL AR-BOOM–SMARTBOOM	482
	150	CONTROL AR-COUPLER	483
	152	CONTROL AR-COUPLER–HIGH PRESSURE ...	483
CAP GP-FUEL FILLER–		CONTROL AR-MACHINE–	
EXTREME SERVICE, LOCKABLE	116	SYSTEM 17, COMBINED FUNCTION	193
CAP-RADIATOR	86	CONTROL GP-FOOT–LEFT ON/OFF SWITCH ...	999
CARTRIDGE AS-TURBOCHARGER	95	CONTROL GP-HANDLE–JOYSTICK, LH	1000
CHASSIS AR	1		1003
	2		1005
	3	CONTROL GP-HANDLE–JOYSTICK, RH	1001
CIRCUIT BREAKER AS (120-AMPERE)			1002
(HEATER)	222		1004
CIRCUIT BREAKER AS (60-AMPERE)		CONTROL GP-HEAT & AIR COND–AIR INLET ...	1006
(ALTERNATOR)	222	CONTROL GP-HYDRAULIC PEDAL	1007
CIRCUIT BREAKER AS (80-AMPERE) (MAIN) ...	222		1008
COIL GP-EVAPORATOR	978	CONTROL GP-JOYSTICK–LH	1010
COMPRESSOR GP-REFRIGERANT	980	CONTROL GP-JOYSTICK–RH	1009
	982	CONTROL GP-PILOT OPERATED HYD–LH	1013
CONDENSER & MTG GP-REFRIGERANT	983		1015
	984	CONTROL GP-PILOT OPERATED HYD–RH ...	1012
	986		1014
CONDENSER GP-REFRIGERANT	988	CONTROL GP-PILOT OPERATED HYD–	
CONSOLE GP-OPERATOR	989	TRAVEL	1011
CONSOLE GP-OPERATOR–LH	993	CONTROL GP-UNPROGRAMMED	191
CONSOLE GP-OPERATOR–RH	991		192
CONTROL & MTG GP-COMMUNICATION–		CONVERSION GP-LINKAGE	917
PRODUCT LINK 121SR	189	CONVERTER-POWER	
	190	(24-VOLT TO 12-VOLT)	314
CONTROL & MTG GP-COMMUNICATION–			1043
PRODUCT LINK 321SR	188		1045
CONTROL & MTG GP-ENGINE ELEK	191	COOLER GP-ENGINE OIL	67
CONTROL & MTG GP-JOYSTICK	998	CORE AS-HEATER	967
CONTROL & MTG GP-JOYSTICK–		CORE AS-OIL COOLER (ENGINE)	67
2-BUTTON, SLIDE, TRIGGER SW	996	CORE AS-OIL COOLER (HYDRAULIC)	77
CONTROL & MTG GP-JOYSTICK–			79
3-BUTTON, TRIGGER SWITCH	997		86
CONTROL & MTG GP-JOYSTICK–		CORE AS-RADIATOR	77
JOYSTICK, 2-BN, SLIDE, TRIG SW	995		79
CONTROL & MTG GP-JOYSTICK–			86
JOYSTICK, 3-BUTTON, TRIGGER SW	995	COUNTERWEIGHT & MOUNTING GP	338
CONTROL & MTG GP-MACHINE	192		339
CONTROL AR-AUXILIARY–BOOM FLOAT	482		340
CONTROL AR-AUXILIARY–COOLING	480		341
			343

INDEX

Name	Page	Name	Page
COUNTERWEIGHT GP	344	DOOR GP-ACCESS-	
	345	FUEL, HYDRAULIC TANKS	360
	346	DOOR GP-ACCESS-PUMP COMPARTMENT ...	359
	347		362
	348	DOOR GP-ACCESS-RADIATOR	361
COUPLING GP-FLEXIBLE	484	DOOR GP-ACCESS-	
COUPLING GP-PUMP	485	RADIATOR, AFTCLR, HYD COOLER	358
COVER AS-ACCESS-		DOOR GP-CAB	1019
FUEL, HYDRAULIC TANKS	349	DRAIN GP-MUFFLER-PLUG	96
COVER AS-FILTER	116	DRIVE GP-FINAL-WITH MOTOR	322
COVER AS-SOUND SUPPRESSION	351	DRIVE GP-FINAL-WITHOUT MOTOR	319
	352	DRIVE GP-SWING-WITH MOTOR	516
	353	DRIVE GP-SWING-WITHOUT MOTOR	514
COVER AS-SOUND SUPPRESSION-		DUCT GP-CAB AIR	1021
MAIN CONTROL VALVE	350		
COVER GP-CAB-EXTERIOR	1017	E	
COVER GP-CAB-REAR	1016	ELECTRONICS GP-COMMUNICATION-	
COVER GP-HOOD-PRECLEANER	354	PRODUCT LINK 300	193
	355	ELECTRONICS GP-ENGINE RATINGS	15
COVER GP-STORAGE	1018	ELECTRONICS GP-MACHINE-HIGH POWER ...	193
COVER GP-VALVE MECHANISM	24	ELECTRONICS GP-MONITOR	194
CRANKSHAFT GP	26	ENGINE AR	15
CYLINDER & LINES GP-BOOM-LH	486		16
	487		17
CYLINDER & LINES GP-BOOM-RH	486	ENGINE AR-COMplete	19
	487		20
CYLINDER & LINES GP-BUCKET	487		
	488	F	
CYLINDER & LINES GP-STICK	488	FAN GP-BLOWER	68
	489		70
CYLINDER & SEAL GP-BOOM	490	FAN GP-SUCTION	72
	492	FASTENER GP-SWING & FINAL DR	517
	493		519
CYLINDER & SEAL GP-BUCKET	495	FASTENER GP-WIRING HARNESS-	
	497	FOOT SWITCH	197
	499	FASTENER GP-WIRING HARNESS-	
	501	HEAVY LIFT	196
CYLINDER & SEAL GP-STICK	503	FASTENER GP-WIRING HARNESS-	
	505	JOYSTICK	198
	507	FASTENER GP-WIRING HARNESS-	
CYLINDER BLOCK GP	27	STRAIGHT TRAVEL	195
	30	FENDER & COVER GP	363
CYLINDER GP-BOOM	510		364
CYLINDER GP-STICK	512		365
CYLINDER HEAD AS	31		366
CYLINDER HEAD GP	32	FILM GP	1127
			1128
D		FILM GP-FUEL TRANSFER PUMP	1129
DISTRIBUTION AR	3	FILM GP-	
	4	HAMMER CONTROL, FOOT SWITCH	1124
DOOR AS-ACCESS-		FILM GP-OPERATOR CONTROLS, NOTICE ...	1121
AIR CLEANER, BATTERY	356		1123
	357		

INDEX

Name	Page	Name	Page
FILM GP-OVERLOAD WARNING DEVICE	1133	FILTER ELEMENT AS-OIL (ULTRA HIGH EFFICIENCY) (HYDRAULIC RETURN)	524
FILM GP-QUICK COUPLER	1125	FILTER ELEMENT-CAB AIR	967
	1126	FILTER ELEMENT-CAB AIR (AIR INTAKE)	1021
FILM GP-SMARTBOOM	1130	FILTER GP-AIR (AIR CONDITIONER)	967
FILM GP- WORK AREA VISUAL SYSTEM, REAR	1132	FILTER GP-FUEL	117
FILM-CERTIFICATION (OPS GUARD, READ OMM, ENGLISH)	1029		120
FILM-CERTIFICATION (OPS GUARD, READ OMM, JAPANESE)	1029	FILTER GP-OIL-HYDRAULIC RETURN	522
FILM-IDENTIFICATION (BIODEGRADABLE HYDRAULIC OIL)	1134		524
	1135	FILTER GP-OIL-HYDRAULIC, CASE DRAIN	526
FILM-INFORMATION (PRODUCT LINK, READ OMM)	189	FILTER GP-WATER SEP & FUEL	123
	190	FILTER-OIL (ADVANCED EFFICIENCY) (HYDRAULIC)	521
FILM-INSTRUCTION (HYDRAULIC OIL RETURN FILTER)	524	FILTER-OIL (ADVANCED EFFICIENCY) (HYDRAULIC, CASE DRAIN)	526
FILM-INSTRUCTION (MACHINE SECURITY, CONSOLE)	227	FINAL DRIVE GP	319
FILM-INSTRUCTION (OPERATOR CONTROLS, READ OMM)	1082		322
FILM-INSTRUCTION (REFUELING PUMP)	140	FINAL DRIVE GP-WITH MOTOR	318
FILM-INSTRUCTION (TOP, AIR CLEANER COVER)	93	FITTING GP-HYDRAULIC	527
	94	FITTING GP-HYDRAULIC-4-BOLT FLANGE	527
FILM-WARNING (HIGH PRESSURE CYLINDER)	475	FLOOR MAT	1022
FILM-WARNING (NO WELD, NO DRILL, READ OMM)	1028		1024
	1029	FLOOR MAT-ACCUGRADE READY	1027
FILM-WARNING (PRODUCT LINK RADIO, INTL)	189	FLOOR MAT-PEDAL, LH	1025
	190	FLOOR MAT-PEDAL, RH	1023
FILM-WARNING (PRODUCT LINK RADIO, U.S.)	189	FLYWHEEL GP	33
	190	FRAME AR-UNDERCARRIAGE	435
FILTER & MTG GP-ENGINE OIL	58	FRAME AS-UNDERCARRIAGE	436
	60		437
FILTER & VALVE GP-PILOT-HYDRAULIC OIL	521		438
FILTER (ADVANCED EFFICIENCY) (FUEL)	117	FRAME GP-UPPER	367
	120		369
FILTER AS-ENGINE OIL (STANDARD EFFICIENCY)	58	FUSE (10-AMPERE)	264
	60	FUSE (15-AMPERE)	263
FILTER AS-WATER SEP & FUEL (PRIMARY)	123		264
FILTER ELEMENT AS-AIR (PRIMARY)	93	FUSE (20-AMPERE)	264
FILTER ELEMENT AS-AIR (PRIMARY, STANDARD EFFICIENCY)	94	FUSE (25-AMPERE)	264
FILTER ELEMENT AS-AIR (PRIMARY, ULTRA HIGH EFFICIENCY)	94	FUSE (30-AMPERE)	264
FILTER ELEMENT AS-AIR (SECONDARY)	93	FUSE (5-AMPERE)	222
	94		264
FILTER ELEMENT AS-AIR (ULTRA HIGH EFFICIENCY) (PRIMARY)	93	G	
		GASKET (FUEL PRIMING PUMP)	117
			120
		GASKET (VALVE COVER)	24
		GASKET (WATER TEMPERATURE REGULATOR)	74
		GAUGE AS-OIL LEVEL (DIPSTICK) (ENGINE)	42
			44
		GAUGE GP-SIGHT-HYDRAULIC OIL LEVEL	528
		GAUGE-OIL LEVEL (SWING DRIVE)	516
		GEAR & BEARING GP-SWING	371