

---

# **320C 320C L Track-Type Excavators**

---

**Powered by 3066 Engine**

**SERIAL NUMBER**

**FBA1 To Last Built(Vehicle)  
GAA1 To Last Built(Vehicle)  
MAA1 To Last Built(Vehicle)  
PAA1 To Last Built(Vehicle)  
7JK52509 To Last Installed(Engine)**

## HOW TO USE THE PARTS MANUAL

Caterpillar Parts Manuals include illustrations of the groups or assemblies which make up the machine. These illustrations show the standard components plus many of the attachments available for the machine.

The alphabetical index located in the front part of the book should be used to determine the page number on which specific illustrations are shown. Reference to those pages will identify each of the individual serviceable parts.

### Captions

The caption under each illustration identifies the part number and name of the group or assembly shown. If more than one illustration is included for any group, the caption identifies the specific machine serial numbers to which each illustration applies. In some cases it is not possible to determine the specific machine serial numbers to which different illustrations are applicable. In those cases the caption identifies the illustration as "First Type", "Second Type", etc. Reference to the actual group or assembly is necessary in those cases to determine which illustration should be used.

Captions provide additional information such as page numbers where illustrations of sub assemblies are shown, information regarding quantities used and other information intended to assist the user in determining parts needs.

This information indicates the effective serial number or effective date on which changes became effective.

Example :

D95.05- : Applicable on and after May 1995

↑  
—— D indicates the nineteen hundreds.

T00.05- : Applicable on and after May 2000

↑  
—— T indicates the two thousands.

## Indented Part Names

Within each illustration is a parts list identifying each serviceable part in the illustration. When a part name is indented in this list, it means that serviceable item is a part of the serviceable item under which it is indented.

### Abbreviations and Symbols

R.H. Right Hand  
L.H. Left Hand

} Refers to the side of the machine as viewed from the operator's compartment.

L Length  
T Thickness  
Z Number of Gear Teeth  
O.D. Outside Diameter  
I.D. Inside Diameter  
O.S. Over Size  
U.S. Under Size  
N/S Not Serviced  
AS Assembly  
NOM Nominal

#### Abbreviations of Wire Colors

RD :Red	BR :Brown
WH :White	GN :Green
OR :Orange	BU :Blue
YL :Yellow	T :Tan
PK :Pink	DK/BU :Dark Blue
BK :Black	DK/GN :Dark Green
GY :Gray	LT/BU :Light Blue
PU :Purple	LT/GN :Light Green

### Note

Continuing improvement and advancement of product design may cause changes to your machine which may not be included in this publication. Each publication is reviewed and revised, as required, to update and include these changes in later editions.

Whenever a question arises regarding your Caterpillar product, or this publication, please consult your Caterpillar dealer for the latest available information.

# MODEL VIEW

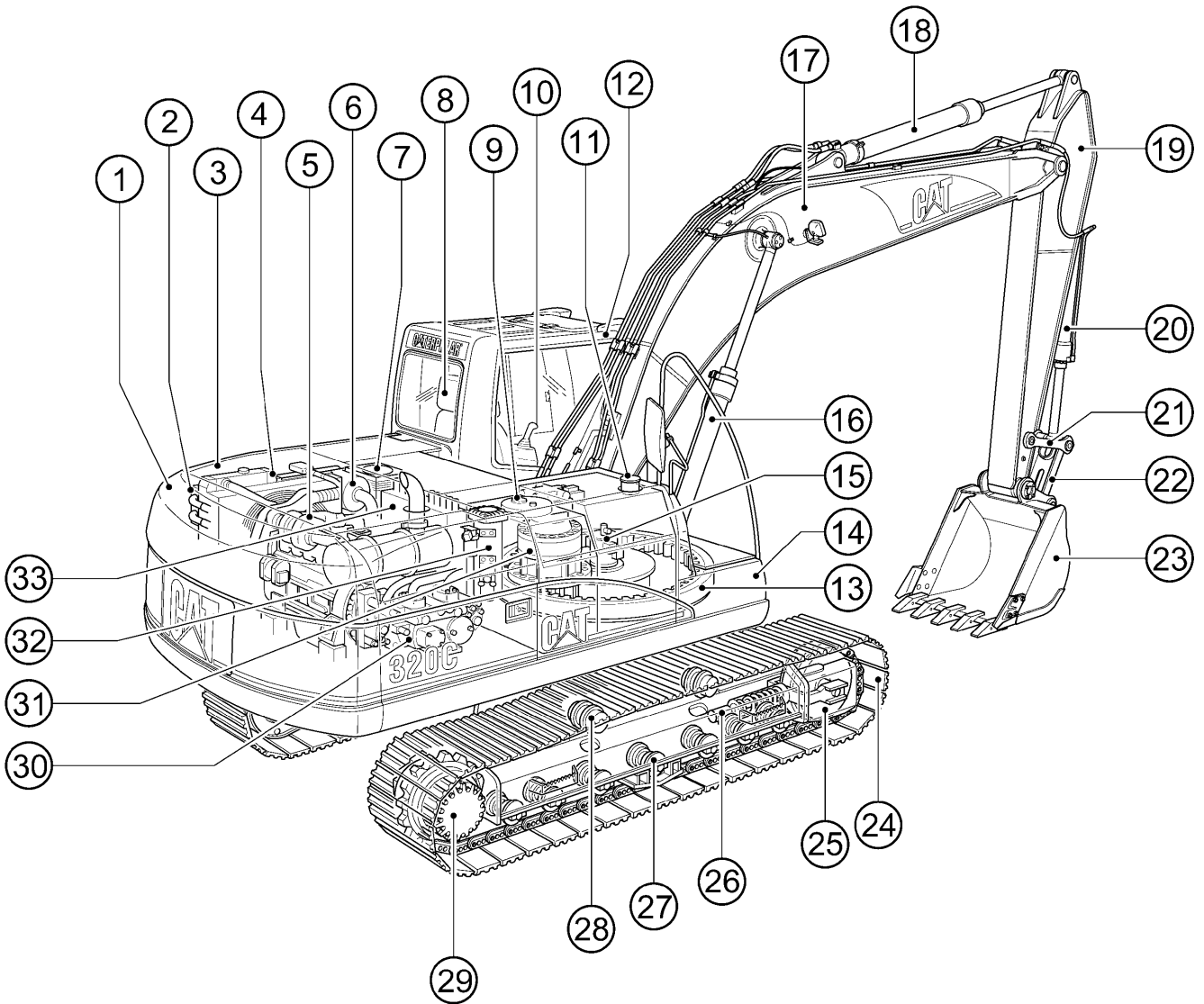

PAGE		PAGE		PAGE	
① Counterweight .....	220	⑫ Cab .....	560	⑳ Bucket .....	726
② Aftercooler .....	40	⑬ Swing Bearing .....	226	㉑ Track .....	264
③ Engine Cover .....	198	⑭ Storage Box .....	215	㉒ Idler .....	242
④ Radiator & Oil Cooler.....	38	⑮ Swivel .....	472	㉓ Track Adjuster.....	246
⑤ Engine .....	11	⑯ Boom Cylinder.....	306	㉔ Track Roller .....	255
⑥ Air Cleaner .....	48	⑰ Boom .....	682	㉕ Carrier Roller .....	255
⑦ Battery .....	72	⑱ Stick Cylinder .....	310	㉖ Final Drive .....	193
⑧ Operator Seat.....	637	⑲ Stick.....	689	㉗ Pump.....	285
⑨ Hydraulic Tank .....	274	㉑ Bucket Cylinder .....	318	㉘ Swing Drive .....	458
⑩ Control Lever .....	474	㉒ Link .....	708	㉙ Capsule Filter .....	300
⑪ Fuel Tank .....	69	㉓ Rod .....	708	㉚ Control Valve .....	490

# REPLACEMENT ITEMS

The following chart provides a convenient listing of those items which require occasional replacement during normal operation or maintenance.

DESCRIPTION	PART NO.	QTY. USED	PAGE NO.
<b>Belt</b>			
Alternator & Fan Belt	212-8585	1	31.01
Refrigerant Compressor V-Belt	8L-8646	1	671
<b>Filter</b>			
Air Conditioner Filter	178-5479	1	653
Air Filter			
Primary Filter Assembly	131-8822	1	49
Secondary Filter Assembly	131-8821	1	49
Cab Air Filter	4I-1278	1	655
Engine Oil Filter	1R-0739	1	35
Fuel Filter	1R-0751	1	63
Hydraulic Oil Drain Filter	093-7521	1	298
Hydraulic Oil Pilot Filter	5I-8670	1	299
Hydraulic Tank Return Filter	126-2081	1	302
	179-9806	1	303
Water Separator Element	287-0222	1	68.03

# LIST OF ATTACHMENTS

The following chart provides a convenient listing of attachments with their reference page numbers as a quick reference for parts ordering.

<b>Consists of:</b>		<b>Page</b>
179-9614	<b>ADDITIONAL GEAR TRAIN FOR AUXILIARY PUMP</b> .....	296
214-4442	<b>AIR PREFILTER</b> .....	50
183-1037	<b>ALARM, TRAVEL</b> .....	175
	<b>BOOM</b>	
163-7738	M-BOOM, MASS 5.2M .....	673
163-7737	R-BOOM, REACH 5.7M .....	672
176-2713	R-BOOM, REACH 5.7M (Heavy Duty) .....	672
	<b>BUCKET</b>	
	EXCAVATION (X)	
165-0958	B Family 1100MM Wide-0.8Cu.M.-Adapter Size J300 .....	716
165-0960	B Family 1220MM Wide-0.9Cu.M.-Adapter Size J300 .....	716
168-2998	B Family 1280MM Wide-1.0Cu.M.-Adapter Size J300 .....	717
123-5473	C Family 1370MM Wide-1.1Cu.M.-Adapter Size J350 .....	719
123-5474	C Family 1470MM Wide-1.2Cu.M.-Adapter Size J350 .....	719
	For Demolition	
168-3029	B Family 1230MM Wide-0.9Cu.M.-Adapter Size J350 .....	718
	For Hammer	
165-0959	B Family 1110MM Wide-0.8Cu.M.-Adapter Size J350 .....	718
	EXTREME SERVICE EXCAVATION (EX)	
123-5472	B Family 1100MM Wide-0.8Cu.M.-Adapter Size J350 .....	720
	<b>BUCKET LINKAGE</b>	
163-7739	B FAMILY (Casting Type) .....	678
176-2848	B FAMILY (Fabrication Type) .....	679
163-7741	C FAMILY .....	678
176-2732	FOR DEMOLITION .....	679
	<b>CAB</b>	
171-7345	METAL ROOF HATCH CAB .....	561
161-3739	SKYLIGHT HATCH CAB .....	560
164-0555	WITH ELECTRIC OPENABLE FRONT WINDSHIELD .....	562
	<b>COUNTERWEIGHT</b>	
199-7289	EXTRA COUNTERWEIGHT (GAA1-Up) .....	222
199-7439	WITHOUT LIFTING EYE (FBA1-Up, GAA1-Up) .....	224
218-5378	<b>EXTRA PINS (FBA1-Up, GAA1-Up)</b> .....	751.01

# LIST OF ATTACHMENTS

	Consists of:	Page
	<b>FILM</b>	
176-2699	DEMOLITION (MAA1-Up) .....	768
176-2700	DEMOLITION (PAA1-Up) .....	769
176-2703	HAMMER (MAA1-Up) .....	770
176-2704	HAMMER (PAA1-Up) .....	771
	<b>GUARD</b>	
204-3729	BOTTOM, HEAVY DUTY (FBA1-Up, GAA1-Up) .....	209
134-8875	SWIVEL (FBA1-Up, GAA1-Up) .....	212
126-2170	BUCKET CYLINDER (For Demolition) .....	328
126-2120	BUCKET CYLINDER (For Hammer) .....	329
164-0534	CAB FRONT (Full Net) .....	622
164-0535	CAB FRONT (Half Net) .....	624
201-3035	SIDE RUBBER BUMPER (FBA1-Up, GAA1-Up) .....	236
	<b>TRACK GUIDE</b>	
120-7165	Full Length (FBA1-Up, MAA1-Up) .....	253
120-7168	Full Length (GAA1-Up, PAA1-Up) .....	254
120-7164	Track End Guide (FBA1-Up, MAA1-Up) .....	251
120-7167	Track End Guide (GAA1-Up, PAA1-Up) .....	252
199-7430	<b>HAND CONTROL PATTERN CHANGER (4 Ways)</b> .....	399.02
201-4480	<b>HEATER &amp; DEFROSTER</b> .....	661
	<b>HYDRAULIC SYSTEMS, AUXILIARY</b>	
	<b>BOOM LINE GROUPS</b>	
	M-Boom (5.2M)	
173-7952	Drain Lines .....	384
173-7959	High Pressure Lines .....	360
173-7951	Medium Pressure Lines .....	364
	R-Boom (5.7M)	
173-7993	Drain Lines .....	382
153-8793	High Pressure Lines .....	358
153-8828	Medium Pressure Lines .....	362
177-8390	Quick Coupler Lines (FBA1-Up, GAA1-Up) .....	339.01
179-5146	With Slow Return Valve .....	344
216-6668	<b>QUICK COUPLER LINES (On Upper Frame And Control) (FBA1-Up, GAA1-Up)</b> .....	399.01
	<b>STICK LINE GROUPS</b>	
	M2.4C Stick	
173-8082	Drain Lines .....	389
173-7962	High Pressure Lines .....	357
173-8081	Medium Pressure Lines .....	380

# LIST OF ATTACHMENTS

	Consists of:		Page
	<b>R2.5B Stick</b>		
173-7954	Drain Lines .....		388
173-7955	High Pressure Lines .....		356
197-2142	High Pressure Lines (Heavy Duty) .....		357
173-7948	Medium Pressure Lines .....		378
	<b>R2.9B Stick</b>		
173-8033	Drain Lines .....		387
173-8027	High Pressure Lines .....		355
153-8862	High Pressure Lines (For Demolition) .....		368
153-8864	Medium Pressure Lines .....		376
187-9902	Quick Coupler Lines (FBA1-Up, GAA1-Up) .....		677
	<b>R3.9B Stick</b>		
173-8076	Drain Lines .....		386
173-7968	High Pressure Lines .....		355
173-8075	Medium Pressure Lines .....		374
	<b>TOOL CONTROL</b>		
	<b>Combined Function</b>		
173-7974	2 Pump .....		397
179-5092	2 Pump (For Demolition) .....		399
173-7978	2 Pump + Additional Valve .....		398
210-9682	Correspond With Additional Pump .....		399
	<b>Double Function</b>		
173-7977	1 Pump .....		397
	<b>Single Function</b>		
173-7973	1 Pump .....		396
173-7983	2 Pump .....		396
187-6773	<b>HYDRAULIC TANK (FBA1-03380, GAA1-00480, MAA1-00313, PAA1-00340) .....</b>		<b>275</b>
196-1420	<b>LARGE BOX COVER .....</b>		<b>608</b>
	<b>LIGHT</b>		
116-0215	M-BOOM, RIGHT SIDE .....		182
116-0214	R-BOOM, RIGHT SIDE .....		180
	<b>WORKING, CAB MOUNTED (Time Delay)</b>		
204-1810	For Use With Cab Guard .....		185.01
163-6631	Without Cab Guard .....		184
	<b>LONG REACH FRONT (15.6M)</b>		
	<b>BUCKET</b>		
7Y-6402	810MM Wide-0.45Cu.M.-Backhoe (GAA1-Up) .....		731
121-1807	1140MM Wide-0.6Cu.M.-Ditch Cleaning (GAA1-Up) .....		732

# LIST OF ATTACHMENTS

	Consists of:	Page
210-2790	LONG REACH FRONT (GAA1-Up) .....	680
	<b>OPTIONAL SEAT</b>	
164-0502	KAB 527P SEAT .....	639
171-7352	KAB T1P SEAT .....	641
178-5624	KAB T8P SEAT .....	640
164-0477	HEADREST (For KAB 528P, KAB T8P Seat) .....	647
200-7294	<b>QUICK COUPLER (FBA1-Up, GAA1-Up) .....</b>	<b>681</b>
	<b>RADIO</b>	
163-6634	AM .....	619
163-6633	AM/FM .....	620
163-6636	AM/FM (With Cassette) .....	621
161-3750	<b>RAIN PROTECTOR, CAB FRONT .....</b>	<b>626</b>
112-2482	<b>SIDEBAR PROTECTOR .....</b>	<b>738</b>
	<b>SIDECUTTER</b>	
7Y-0729	B FAMILY .....	736
112-2481	B FAMILY (Heavy Duty) .....	737
7Y-0366	C FAMILY .....	736
	<b>STARTING, COLD WEATHER</b>	
176-2789	FILM (32WR Hydraulic Oil Package) .....	777
204-1924	STARTING AID (FBA1-02355, GAA1-00408, MAA1-T03.06, PAA1-T03.06) .....	80
213-0914	STARTING AID (FBA02356-Up, GAA00409-Up, MAA T03.07-Up, PAA T03.07-Up) ....	83.01
204-1933	STARTING AID (Semi) .....	84
	<b>STICK</b>	
	FOR THE MASS (5.2M) BOOM ONLY	
163-7768	M2.4C Stick .....	677
	FOR THE REACH (5.7M) BOOM ONLY	
163-7766	R2.5B Stick .....	676
176-2716	R2.5B Stick (Heavy Duty) .....	676
163-7765	R2.9B Stick .....	674
176-2731	R2.9B Stick (For Demolition) .....	675
176-2715	R2.9B Stick (Heavy Duty) .....	675
163-7764	R3.9B Stick .....	674
161-3751	<b>SUN VISOR .....</b>	<b>627</b>
222-0152	<b>SWING OUT CONDENSER .....</b>	<b>649</b>



# LIST OF ATTACHMENTS

Consists of:

Page

## TIP

### ADAPTER SIZE J300

8E-3756	Abrasion, Heavy Duty .....	742
9J-3167	Long .....	740
8E-3751	Long, Heavy Duty .....	740
3G-3237	Penetration .....	742
9W-9188	Sharp-Center .....	743
9W-9189	Sharp-Corner .....	743
9J-3175	Short .....	741
4T-2215	Wide .....	741

### ADAPTER SIZE J350

8E-3757	Abrasion, Heavy Duty .....	746
8J-4955	Long .....	744
8E-3752	Long, Heavy Duty .....	744
3G-3236	Penetration .....	746
9W-6472	Sharp-Center .....	747
9W-6473	Sharp-Corner .....	747
8J-4954	Short .....	745
8J-4953	Wide .....	745

### ADAPTER SIZE J400

8E-0837	Abrasion, Heavy Duty .....	750
127-0716	Long .....	748
6Y-5472	Long, Heavy Duty .....	748
8E-0838	Penetration .....	750
8E-0840	Sharp-Center .....	751
8E-0839	Sharp-Corner .....	751
127-0715	Short .....	749
8E-0836	Wide .....	749

## TOOL

176-2676	TOOL KIT .....	752
7I-0776	TOOL KIT (Deluxe) .....	752
117-4166	WRENCH (For Demolition) .....	755

## TRACK

### DOUBLE GROUSER

194-1914	600MM (GAA1-Up, PAA1-Up) .....	268
194-1915	700MM (GAA1-Up, PAA1-Up) .....	268

# LIST OF ATTACHMENTS

<b>Consists of:</b>		<b>Page</b>
	<b>TRIPLE GROUSER</b>	
194-1910	600MM (GAA1-Up, PAA1-Up) .....	266
5I-6136	600MM (Long Bush Type) (FBA1-Up, MAA1-Up) .....	269
5I-6138	600MM (Long Bush Type) (GAA1-Up, PAA1-Up) .....	269
194-1917	700MM (FBA1-Up, MAA1-Up) .....	265
194-1911	700MM (GAA1-Up, PAA1-Up) .....	266
194-1921	800MM (FBA1-Up, MAA1-Up) .....	265
196-1795	900MM (GAA1-Up, PAA1-Up) .....	267
217-9429	<b>WIPER, LOWER WINDSHIELD</b> .....	611
163-6698	<b>12V-2 x 7A POWER SUPPLY SOCKET</b> .....	155
163-6629	<b>12V-7A POWER SUPPLY SOCKET</b> .....	154

# INDEX

Name	Page	Name	Page
<b>A</b>			
ADJUSTER GP - BUCKET .....	733	CONDENSER & MTG GP - REFRIGERANT .....	668
AIR CLEANER GP .....	49	CONSOLE GP .....	631
	51		633.01
AIR CONDITIONER & MOUNTING GP .....	650	CONSOLE GP - OPERATOR .....	630
AIR CONDITIONER AR .....	649	CONTROL & MTG GP - ELECTRONIC .....	167
AIR CONDITIONER GP .....	649	CONTROL AR - AUXILIARY .....	396
	652	CONTROL AR - QUICK COUPLER .....	399.01
ALARM GP .....	152	CONTROL GP - ELECTRONIC .....	174
ALARM GP - TRAVEL .....	175	CONTROL GP - GOVERNOR .....	66
ALTERNATOR GP - CHARGING .....	173	CONTROL GP - HYDRAULIC .....	482
ARM AS - WIPER .....	606	CONTROL GP - PILOT OPERATED HYD .....	476
			480
<b>B</b>			
BATTERY & WIRING GP .....	72	COOLER GP - ENGINE OIL .....	44
BATTERY & WIRING GP - COLD WEATH .....	80	COUNTERWEIGHT GP .....	220
BLOCK GP - HYDRAULIC .....	304	COUPLER AR - QUICK .....	681
BOOM AR .....	673	COUPLER GP - QUICK .....	715.04
BOOM AR - 1 PIECE LONG .....	672	COUPLING GP - FLEXIBLE .....	287
BOOM GP .....	682	COUPLING GP - PUMP .....	286
BOX & MTG GP - STORAGE .....	215	COVER GP .....	586
BOX GP - STORAGE .....	216		607
BREATHER GP .....	33	COVER GP - VALVE MECHANISM .....	20
BUCKET & ADJUSTER GP .....	720	CRANKSHAFT GP .....	21
BUCKET AR .....	716	CYLINDER & LINES GP - BOOM .....	305
BUCKET AS - DITCH CLEANING .....	732	CYLINDER & LINES GP - BUCKET .....	316
BUCKET AS - EXCAVATION .....	726	CYLINDER & LINES GP - STICK .....	308
BUCKET AS - GENERAL PURPOSE .....	731	CYLINDER & SEAL GP .....	327.05
BUCKET GP .....	731	CYLINDER & SEAL GP - BOOM .....	306
BUMPER GP - SIDE .....	236	CYLINDER & SEAL GP - BUCKET .....	318
		CYLINDER & SEAL GP - STICK .....	310
		CYLINDER BLOCK GP .....	18
		CYLINDER GP - BUCKET .....	326
		CYLINDER HEAD GP .....	14
<b>C</b>			
CAB GP .....	560	<b>D</b>	
CAB GP (BASIC) .....	563	DOOR GP - CAB .....	587
CAB GP - EXTERIOR .....	584	DOOR GP - HOOD .....	206
CAB GP - INTERIOR .....	572	DRIVE AS - WINDSHIELD - AUTO .....	598
CABLE AS .....	93	DRIVE GP - PUMP .....	296
CAMSHAFT GP .....	22	DRIVE GP - SWING .....	458
CARTRIDGE AS - TURBOCHARGER .....	56	DUCT AS .....	656
CLEANER AR .....	50	DUCT GP - AIR .....	654
COMPRESSOR GP - REFRIGERANT .....	670		

# INDEX

Name	Page	Name	Page
<b>E</b>			
ELECTRONICS GP .....	168	HARNES AS - WIRING.....	145
ENGINE AR.....	12		153.01
ENGINE AR - COMPLETE .....	11.02		156
<b>F</b>			
FAN GP - SUCTION .....	42	HATCH AS.....	593
	47	HATCH GP .....	591
FASTENER GP - SWING & FINAL DR.....	196	HEAD GP - PUMP CONTROL.....	292
FENDER & COVER GP.....	218	HEADREST AS.....	647
FILM GP.....	768	HEATER & MTG GP - CAB.....	662
FILTER GP - ENGINE OIL.....	34	HEATER AR - CAB .....	661
FILTER GP - FUEL .....	62	HEATER GP - CAB.....	664
FILTER GP - HYDRAULIC .....	298	HOOD & GUARD GP.....	198
FINAL DRIVE GP.....	193	HOOD GP.....	205
FLYWHEEL GP.....	27	HOOD GP - ENGINE.....	204
FRAME AS - UNDERCARRIAGE .....	238	HORN GP - ELECTRIC.....	625
FRAME GP - UPPER.....	232	HOUSING GP - FLYWHEEL .....	28
<b>G</b>			
GEAR & BEARING GP - SWING.....	226	HOUSING GP - FRONT.....	24
GEAR GP - FRONT .....	26	<b>I</b>	
GUARD AR - BOTTOM .....	209	IDLER GP - FRONT .....	242
GUARD GP - BOTTOM.....	210	<b>K</b>	
GUARD GP - CYLINDER.....	328	KNOB AS.....	478
GUARD GP - FRONT WINDOW.....	622	<b>L</b>	
GUARD GP - SNOW .....	214	LAMP GP - FLOOD.....	186
GUARD GP - SWIVEL .....	212	LEVER GP .....	634
GUARD GP - TRACK GUIDE .....	250	LIGHTING GP - BOOM.....	178
GUARD GP - TRAVEL MOTOR.....	262	LIGHTING GP - CAB .....	184
<b>H</b>			
HANDHOLD GP.....	213	LIGHTING GP - CHASSIS.....	177
HARNES AS .....	86	LINES AR - AUXILIARY HYDRAULIC.....	355
	108	LINES GP - AIR.....	53
	189	LINES GP - AIR CONDITIONER.....	658
HARNES AS - CONSOLE.....	130	LINES GP - AUXILIARY HYDRAULIC .....	358
		LINES GP - BOOM.....	340
		LINES GP - BOOM CYLINDER .....	330
		LINES GP - BUCKET CYLINDER .....	335
		LINES GP - COOLING.....	43
		LINES GP - DRAIN .....	54
			382
			453

# INDEX

Name	Page	Name	Page
LINES GP - ENGINE OIL .....	32	MUFFLER GP .....	57
LINES GP - FRONT .....	430		
LINES GP - FUEL .....	64	<b>N</b>	
	68		
LINES GP - GREASE .....	702	NOZZLE GP - UNIT INJECTOR .....	60
LINES GP - HEATER .....	666		
LINES GP - OIL DRAIN .....	37	<b>P</b>	
LINES GP - PILOT .....	400		
LINES GP - PUMP .....	394	PAN GP - OIL .....	29
LINES GP - QUICK COUPLER .....	339.01	PANEL GP - CIRCUIT BREAKER .....	96
	389.01	PIN GP .....	751.01
LINES GP - RETURN & FILTER .....	454	PISTON & ROD GP .....	23
LINES GP - STICK .....	350	PLATE & FILM GP .....	756
LINES GP - STICK CYLINDER .....	332	PLATFORM GP - OPERATOR .....	629
LINES GP - SWING MOTOR .....	457	PLUG GP .....	511
LINES GP - TRAVEL MOTOR .....	390	PROTECTOR GP .....	738
LINES GP - TURBOCHARGER OIL .....	36	PULLEY GP .....	31.01
LINES GP - WATER .....	46	PUMP & MOUNTING GP .....	285
LINK AS .....	633	PUMP AS - WATER .....	45.01
LINK AS - TRACK .....	270	PUMP GP - FUEL INJECTION .....	65.01
LINKAGE AR - BUCKET .....	678	PUMP GP - MAIN HYDRAULIC .....	288
LINKAGE AR - FRONT .....	680	PUMP GP - WATER .....	45
LINKAGE GP - BUCKET .....	708		
LITERATURE GP .....	648	<b>R</b>	
LOCK GP - TRANSPORT .....	707		
		RADIATOR & HYD OIL COOLER GP .....	38
<b>M</b>		RADIO GP - AM .....	619
		RADIO GP - AM/FM .....	620
MANIFOLD GP - EXHAUST .....	59	ROLLER AR - TRACK & CARRIER .....	255
MANIFOLD GP - INLET .....	58	ROLLER GP - TRACK CARRIER .....	259
MIRROR GP - REAR VIEW .....	628	ROLLER GP - TRACK - DOUBLE FLANGE .....	261
MONITOR & MTG GP - OPERATOR .....	614	ROLLER GP - TRACK - SINGLE FLANGE .....	260
MONITOR GP - OPERATOR .....	615	ROTOR GP - SWIVEL .....	473
MOTOR & MTG GP - SWING .....	464		
MOTOR & MTG GP - TRAVEL .....	468	<b>S</b>	
MOTOR AS - WINDOW WIPER .....	605		
MOTOR GP - SWING .....	465	SCREEN GP .....	284
MOTOR GP - TRAVEL .....	470	SEAT BELT GP .....	645
MOUNTING GP - AIR CLEANER .....	48	SEAT GP .....	637
MOUNTING GP - ALTERNATOR .....	31	SEPARATOR - WATER .....	68.03
MOUNTING GP - ENGINE .....	30	SERVICE KIT .....	348
MOUNTING GP - GREASE GUN .....	208	SIDECUTTER GP .....	736
MOUNTING GP - STARTING MOTOR .....	169	SPROCKET GP - NONSEGMENTED .....	192
MOUNTING GP - VALVE .....	486	STARTING MOTOR GP - ELECTRIC .....	170



# INDEX

Name	Page	Name	Page
WINDOW GP.....	594		
	599		
WINDOW GP - DOOR.....	590		
WIPER & WASHER GP - WINDOW .....	612		
WIPER AR - WINDOW .....	611		
WIPER GP - WINDOW .....	604		
WIRING GP .....	153		
	154		
	158		
WIRING GP - CAB.....	142		
WIRING GP - CONSOLE .....	127		
WIRING GP - LOWER WIPER.....	125		
WIRING GP - QUICK COUPLER.....	162.02		
WRENCH .....	755		

# ENGINE ARRANGEMENT

Consists of :

			Page
1	222-8187	ENGINE AR.....	11.01
1	205-6683	FAN GP-SUCTION .....	42

H83444E 01

## 201-3831 ENGINE AR

S/N FBA 1-(T06.02), GAA 1-(T06.02), MAA 1-(T06.02), PAA 1-(T06.02)

Consists of :

			Page
1	287-0068	ENGINE AR-COMPLETE.....	11.02
1	205-6683	FAN GP-SUCTION .....	42

H95189E 02

## 201-3831 ENGINE AR

S/N FBA (T06.03)-Up, GAA (T06.03)-Up, MAA (T06.03)-Up, PAA (T06.03)-Up



# ENGINE ARRANGEMENT

Consists of :

		Page
1	201-3877 ENGINE AR.....	12
1	222-8199 PULLEY GP.....	31.01

THE FOLLOWING REPAIR KIT IS AVAILABLE:

1	272-4690 LONG BLOCK KIT	
---	-------------------------	--

H91399E 00

## 222-8187 ENGINE AR

S/N FBA 1-04189, GAA 1-00550, MAA 1-00360, PAA 1-00350  
Part of 201-3831-Page11

Consists of :

		Page
1	201-3877 ENGINE AR.....	12
1	239-6664 PULLEY GP.....	31.02

THE FOLLOWING REPAIR KIT IS AVAILABLE:

1	272-4690 LONG BLOCK KIT	
---	-------------------------	--

H91400E 02

## 222-8187 ENGINE AR

S/N FBA 04190-(T06.02), GAA 00551-(T06.02), MAA 00361-(T06.02), PAA 00351-(T06.02)  
Part of 201-3831-Page11

# ENGINE ARRANGEMENT

Consists of :

			Page
1	287-0091	ENGINE AR.....	13.03
1	239-6664	PULLEY GP.....	31.02

H95190E 01

## **287-0068 ENGINE AR-COMPLETE**

S/N FBA (T06.03)-Up, GAA (T06.03)-Up, MAA (T06.03)-Up, PAA (T06.03)-Up  
Part of 201-3831-Page11

# ENGINE ARRANGEMENT

Consists of :

			Page
BASIC ENGINE			
1	178-6516	PAN GP-OIL.....	29
1	178-6512	CAMSHAFT GP.....	22
1	212-8549	CRANKSHAFT GP .....	21
1	212-8546	CYLINDER BLOCK GP .....	18
1	212-8543	CYLINDER HEAD GP.....	14
1	212-8544	VALVE MECHANISM GP .....	16
1	212-8545	COVER GP-VALVE MECHANISM .....	20
1	205-6792	FLYWHEEL GP.....	27
1	196-7972	HOUSING GP-FLYWHEEL.....	28
1	212-8550	GEAR GP-FRONT .....	26
1	212-8547	HOUSING GP-FRONT .....	24
1	212-8548	PISTON & ROD GP.....	23
1	178-6531	MOUNTING GP-ALTERNATOR.....	31
LUBRICATION SYSTEM			
1	212-8554	FILTER GP-ENGINE OIL .....	34
1	178-6524	LINES GP-ENGINE OIL.....	32
1	178-6502	BREATHER GP .....	33
1	51-7770	LINES GP-TURBOCHARGER OIL .....	36

H95201E 05

## ENGINE ARRANGEMENT

Consists of :

			Page
COOLING SYSTEM			
1	212-8555	PUMP GP-WATER.....	45
1	212-8557	LINES GP-WATER.....	46
1	178-6584	COOLER GP-ENGINE OIL.....	44
1	212-8556	FAN GP-SUCTION .....	47
AIR INLET AND EXHAUST SYSTEM			
1	212-8551	MANIFOLD GP-INLET.....	58
1	212-8552	MANIFOLD GP-EXHAUST .....	59
1	205-6741	TURBOCHARGER GP .....	55
1	212-8553	MUFFLER GP.....	57
FUEL SYSTEM			
1	212-8559	PUMP GP-FUEL INJECTION .....	65.01
1	212-8560	FILTER GP-FUEL.....	62
1	212-8558	LINES GP-FUEL .....	64
6	212-8470	NOZZLE GP-UNIT INJECTOR.....	60
ELECTRICAL AND STARTING SYSTEM			
1	125-2963	MOUNTING GP-STARTING MOTOR.....	169
1	125-2988	STARTING MOTOR GP-ELECTRIC .....	170
-OR-			
1	272-4774	STARTING MOTOR GP-ELECTRIC .....	171.03
1	212-8561	ALTERNATOR GP-CHARGING .....	173

H95202E 05

### 201-3877 ENGINE AR (2/2)

S/N FBA 1-04189, GAA 1-00550, MAA 1-00360, PAA 1-00350  
Part of 222-8187-Page11.01