320C 320C L Track-Type Excavators

Powered by 3066 Engine

SERIAL NUMBER

FBA1-Up(Vehicle)

GAA1-Up(Vehicle)

MAA1-Up(Vehicle)

PAA1-Up(Vehicle)

7JK52509-Up(Engine)

HOW TO USE THE PARTS MANUAL

Caterpillar Parts Manuals include illustrations of the groups or assemblies which make up the machine. These illustrations show the standard components plus many of the attachments available for the machine.

The alphabetical index located in the front part of the book should be used to determine the page number on which specific illustrations are shown. Reference to those pages will identify each of the individual serviceable parts.

Captions

The caption under each illustration identifies the part number and name of the group or assembly shown. If more than one illustration is included for any group, the caption identifies the specific machine serial numbers to which each illustration applies. In some cases it is not possible to determine the specific machine serial numbers to which different illustrations are applicable. In those cases the caption identifies the illustration as "First Type", "Second Type", etc. Reference to the actual group or assembly is necessary in those cases to determine which illustration should be used.

Captions provide additional information such as page numbers where illustrations of sub assemblies are shown, information regarding quantities used and other information intended to assist the user in determining parts needs.

This information indicates the effective serial number or effective date on which changes became effective.

Example :

D95.05- : Applicable on and after May 1995

↑ D indicates the nineteen hundreds.

T00.05- : Applicable on and after May 2000

↑ T indicates the two thousands.

Indented Part Names

Within each illustration is a parts list identifying each serviceable part in the illustration. When a part name is indented in this list, it means that serviceable item is a part of the serviceable item under which it is indented.

Abbreviations and Symbols

R.H. Right Hand
L.H. Left Hand

} Refers to the side of the machine as viewed from the operator's compartment.

L Length
T Thickness
Z Number of Gear Teeth
O.D. Outside Diameter
I.D. Inside Diameter
O.S. Over Size
U.S. Under Size
N/S Not Serviced
AS Assembly
NOM Nominal

Abbreviations of Wire Colors

RD :Red	BR :Brown
WH :White	GN :Green
OR :Orange	BU :Blue
YL :Yellow	T :Tan
PK :Pink	DK/BU :Dark Blue
BK :Black	DK/GN :Dark Green
GY :Gray	LT/BU :Light Blue
PU :Purple	LT/GN :Light Green

Note

Continuing improvement and advancement of product design may cause changes to your machine which may not be included in this publication. Each publication is reviewed and revised, as required, to update and include these changes in later editions.

Whenever a question arises regarding your Caterpillar product, or this publication, please consult your Caterpillar dealer for the latest available information.

MODEL VIEW

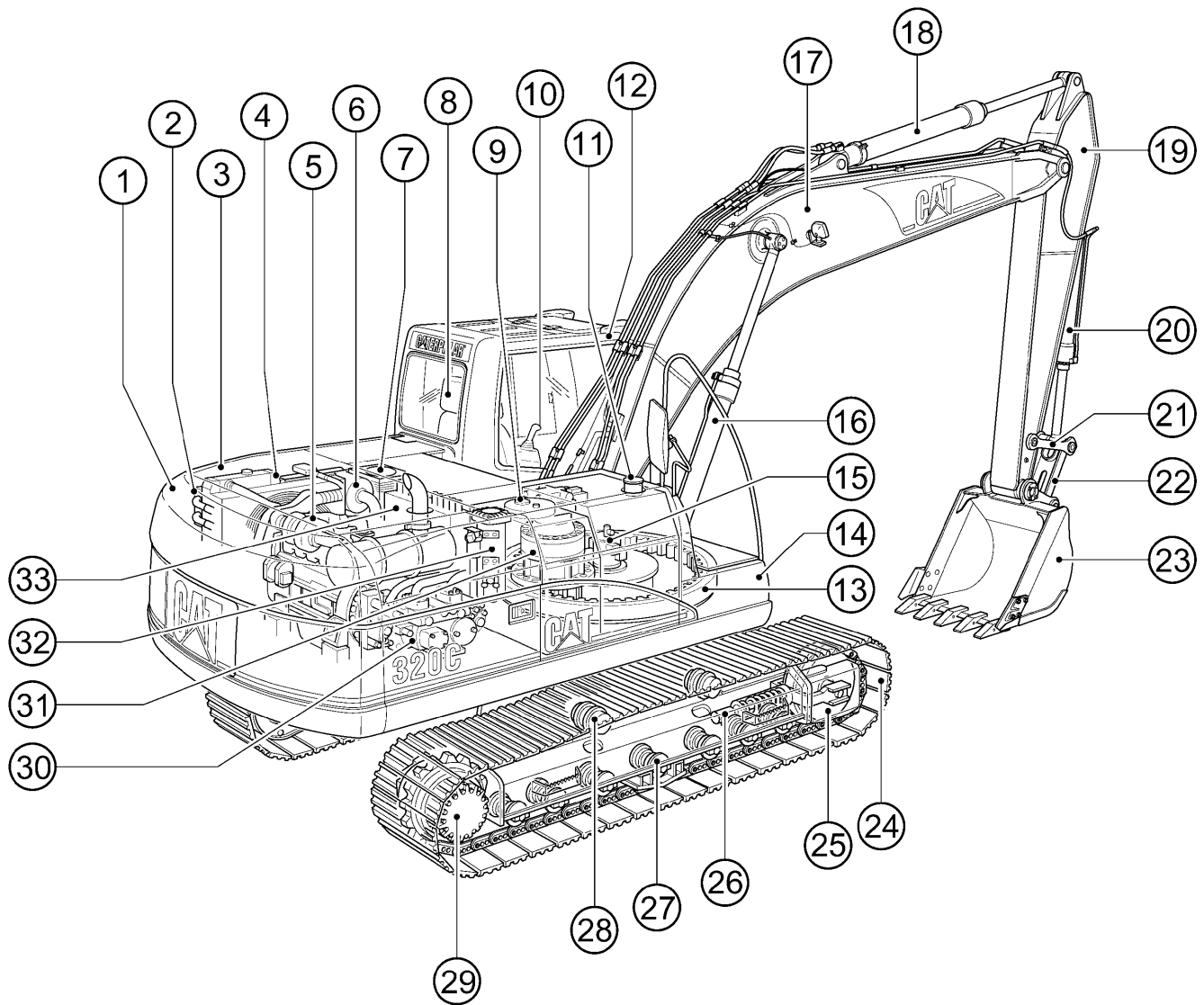

	PAGE		PAGE		PAGE
① Counterweight	220	⑫ Cab	560	⑳ Bucket	726
② Aftercooler	40	⑬ Swing Bearing	228	㉑ Track	264
③ Engine Cover	198	⑭ Storage Box	215	㉒ Idler	242
④ Radiator & Oil Cooler	38	⑮ Swivel	472	㉓ Track Adjuster	246
⑤ Engine	11	⑯ Boom Cylinder	306	㉔ Track Roller	255
⑥ Air Cleaner	48	⑰ Boom	682	㉕ Carrier Roller	255
⑦ Battery	72	⑱ Stick Cylinder	310	㉖ Final Drive	193
⑧ Operator Seat	637	⑲ Stick	689	㉗ Pump	285
⑨ Hydraulic Tank	274	㉑ Bucket Cylinder	318	㉘ Swing Drive	458
⑩ Control Lever	474	㉒ Link	708	㉙ Capsule Filter	300
⑪ Fuel Tank	69	㉓ Rod	708	㉚ Control Valve	490

REPLACEMENT ITEMS

The following chart provides a convenient listing of those items which require occasional replacement during normal operation or maintenance.

DESCRIPTION	PART NO.	QTY. USED	PAGE NO.
Belt			
Alternator & Fan Belt	212-8585	1	31.01
Refrigerant Compressor V-Belt	8L-8646	1	671
Filter			
Air Conditioner Filter	178-5479	1	653
Air Filter			
Primary Filter Assembly	131-8822	1	49
Secondary Filter Assembly	131-8821	1	49
Cab Air Filter	4I-1278	1	655
Engine Oil Filter	1R-0739	1	35
Fuel Filter	1R-0751	1	63
Hydraulic Oil Drain Filter	093-7521	1	298
Hydraulic Oil Pilot Filter	5I-8670	1	299
Hydraulic Tank Return Filter	126-2081	1	302
	179-9806	1	303

LIST OF ATTACHMENTS

The following chart provides a convenient listing of attachments with their reference page numbers as a quick reference for parts ordering.

Consists of:	Page
179-9614 ADDITIONAL GEAR TRAIN FOR AUXILIARY PUMP	296
214-4442 AIR PREFILTER	50
183-1037 ALARM, TRAVEL	175
 BOOM	
163-7738 M-BOOM, MASS 5.2M	673
163-7737 R-BOOM, REACH 5.7M	672
176-2713 R-BOOM, REACH 5.7M (Heavy Duty)	672
 BUCKET	
EXCAVATION (X)	
165-0958 B Family 1100MM Wide-0.8Cu.M.-Adapter Size J300	716
165-0960 B Family 1220MM Wide-0.9Cu.M.-Adapter Size J300	716
168-2998 B Family 1280MM Wide-1.0Cu.M.-Adapter Size J300	717
123-5473 C Family 1370MM Wide-1.1Cu.M.-Adapter Size J350	719
123-5474 C Family 1470MM Wide-1.2Cu.M.-Adapter Size J350	719
For Demolition	
168-3029 B Family 1230MM Wide-0.9Cu.M.-Adapter Size J350	718
For Hammer	
165-0959 B Family 1110MM Wide-0.8Cu.M.-Adapter Size J350	718
EXTREME SERVICE EXCAVATION (EX)	
123-5472 B Family 1100MM Wide-0.8Cu.M.-Adapter Size J350	720
 BUCKET LINKAGE	
163-7739 B FAMILY (Casting Type)	678
176-2848 B FAMILY (Fabrication Type)	679
163-7741 C FAMILY	678
176-2732 FOR DEMOLITION	679
 CAB	
171-7345 METAL ROOF HATCH CAB	561
161-3739 SKYLIGHT HATCH CAB	560
164-0555 WITH ELECTRIC OPENABLE FRONT WINDSHIELD	562
 COUNTERWEIGHT	
199-7289 EXTRA COUNTERWEIGHT (GAA1-Up)	222
199-7439 WITHOUT LIFTING EYE (FBA1-Up, GAA1-Up)	224
218-5378 EXTRA PINS (FBA1-Up, GAA1-Up)	751.01

LIST OF ATTACHMENTS

Consists of:		Page
FILM		
176-2699	DEMOLITION (MAA1-Up)	768
176-2700	DEMOLITION (PAA1-Up)	769
176-2703	HAMMER (MAA1-Up)	770
176-2704	HAMMER (PAA1-Up)	771
GUARD		
204-3729	BOTTOM, HEAVY DUTY (FBA1-Up, GAA1-Up)	209
134-8875	SWIVEL (FBA1-Up, GAA1-Up)	212
126-2170	BUCKET CYLINDER (For Demolition)	328
126-2120	BUCKET CYLINDER (For Hammer)	329
164-0534	CAB FRONT (Full Net)	622
164-0535	CAB FRONT (Half Net)	624
201-3035	SIDE RUBBER BUMPER (FBA1-Up, GAA1-Up)	236
TRACK GUIDE		
120-7165	Full Length (FBA1-Up, MAA1-Up)	253
120-7168	Full Length (GAA1-Up, PAA1-Up)	254
120-7164	Track End Guide (FBA1-Up, MAA1-Up)	251
120-7167	Track End Guide (GAA1-Up, PAA1-Up)	252
199-7430	HAND CONTROL PATTERN CHANGER (4 Ways)	399.02
201-4480	HEATER & DEFROSTER	661
HYDRAULIC SYSTEMS, AUXILIARY		
BOOM LINE GROUPS		
M-Boom (5.2M)		
173-7952	Drain Lines	384
173-7959	High Pressure Lines	360
173-7951	Medium Pressure Lines	364
R-Boom (5.7M)		
173-7993	Drain Lines	382
153-8793	High Pressure Lines	358
153-8828	Medium Pressure Lines	362
177-8390	Quick Coupler Lines (FBA1-Up, GAA1-Up)	339.01
179-5146	With Slow Return Valve	344
216-6668	QUICK COUPLER LINES (On Upper Frame And Control) (FBA1-Up, GAA1-Up)	399.01
STICK LINE GROUPS		
M2.4C Stick		
173-8082	Drain Lines	389
173-7962	High Pressure Lines	357
173-8081	Medium Pressure Lines	380

LIST OF ATTACHMENTS

Consists of:		Page
	R2.5B Stick	
173-7954	Drain Lines	388
173-7955	High Pressure Lines	356
197-2142	High Pressure Lines (Heavy Duty)	357
173-7948	Medium Pressure Lines	378
	R2.9B Stick	
173-8033	Drain Lines	387
173-8027	High Pressure Lines	355
153-8862	High Pressure Lines (For Demolition)	368
153-8864	Medium Pressure Lines	376
187-9902	Quick Coupler Lines (FBA1-Up, GAA1-Up)	677
	R3.9B Stick	
173-8076	Drain Lines	386
173-7968	High Pressure Lines	355
173-8075	Medium Pressure Lines	374
	TOOL CONTROL	
	Combined Function	
173-7974	2 Pump	397
179-5092	2 Pump (For Demolition)	399
173-7978	2 Pump + Additional Valve	398
210-9682	Correspond With Additional Pump	399
	Double Function	
173-7977	1 Pump	397
	Single Function	
173-7973	1 Pump	396
173-7983	2 Pump	396
187-6773	HYDRAULIC TANK (FBA1-03380, GAA1-00480, MAA1-00313, PAA1-00340)	275
196-1420	LARGE BOX COVER	608
	LIGHT	
116-0215	M-BOOM, RIGHT SIDE	182
116-0214	R-BOOM, RIGHT SIDE	180
	WORKING, CAB MOUNTED (Time Delay)	
204-1810	For Use With Cab Guard	185.01
163-6631	Without Cab Guard	184
	LONG REACH FRONT (15.6M)	
	BUCKET	
7Y-6402	810MM Wide-0.45Cu.M.-Backhoe (GAA1-Up)	731
121-1807	1140MM Wide-0.6Cu.M.-Ditch Cleaning (GAA1-Up)	732

LIST OF ATTACHMENTS

Consists of:		Page
210-2790	LONG REACH FRONT (GAA1-Up)	680
	OPTIONAL SEAT	
164-0502	KAB 527P SEAT	639
171-7352	KAB T1P SEAT	641
178-5624	KAB T8P SEAT	640
164-0477	HEADREST (For KAB 528P, KAB T8P Seat)	647
200-7294	QUICK COUPLER (FBA1-Up, GAA1-Up)	681
	RADIO	
163-6634	AM	619
163-6633	AM/FM	620
163-6636	AM/FM (With Cassette)	621
161-3750	RAIN PROTECTOR, CAB FRONT	626
112-2482	SIDEBAR PROTECTOR	738
	SIDECUTTER	
7Y-0729	B FAMILY	736
112-2481	B FAMILY (Heavy Duty)	737
7Y-0366	C FAMILY	736
	STARTING, COLD WEATHER	
176-2789	FILM (32WR Hydraulic Oil Package)	777
204-1924	STARTING AID (FBA1-02355, GAA1-00408, MAA1-T03.06, PAA1-T03.06)	80
213-0914	STARTING AID (FBA02356-Up, GAA00409-Up, MAA T03.07-Up, PAA T03.07-Up)	83.01
204-1933	STARTING AID (Semi)	84
	STICK	
	FOR THE MASS (5.2M) BOOM ONLY	
163-7768	M2.4C Stick	677
	FOR THE REACH (5.7M) BOOM ONLY	
163-7766	R2.5B Stick	676
176-2716	R2.5B Stick (Heavy Duty)	676
163-7765	R2.9B Stick	674
176-2731	R2.9B Stick (For Demolition)	675
176-2715	R2.9B Stick (Heavy Duty)	675
163-7764	R3.9B Stick	674
161-3751	SUN VISOR	627
222-0152	SWING OUT CONDENSER	649

LIST OF ATTACHMENTS

Consists of:		Page
TIP		
ADAPTER SIZE J300		
8E-3756	Abrasion, Heavy Duty	742
9J-3167	Long	740
8E-3751	Long, Heavy Duty	740
3G-3237	Penetration	742
9W-9188	Sharp-Center	743
9W-9189	Sharp-Corner	743
9J-3175	Short	741
4T-2215	Wide	741
ADAPTER SIZE J350		
8E-3757	Abrasion, Heavy Duty	746
8J-4955	Long	744
8E-3752	Long, Heavy Duty	744
3G-3236	Penetration	746
9W-6472	Sharp-Center	747
9W-6473	Sharp-Corner	747
8J-4954	Short	745
8J-4953	Wide	745
ADAPTER SIZE J400		
8E-0837	Abrasion, Heavy Duty	750
127-0716	Long	748
6Y-5472	Long, Heavy Duty	748
8E-0838	Penetration	750
8E-0840	Sharp-Center	751
8E-0839	Sharp-Corner	751
127-0715	Short	749
8E-0836	Wide	749
TOOL		
176-2676	TOOL KIT	752
7I-0776	TOOL KIT (Deluxe)	752
117-4166	WRENCH (For Demolition)	755
TRACK		
DOUBLE GROUSER		
194-1914	600MM (GAA1-Up, PAA1-Up)	268
194-1915	700MM (GAA1-Up, PAA1-Up)	268

LIST OF ATTACHMENTS

Consists of:		Page
	TRIPLE GROUSER	
194-1910	600MM (GAA1-Up, PAA1-Up)	266
5I-6136	600MM (Long Bush Type) (FBA1-Up, MAA1-Up)	269
5I-6138	600MM (Long Bush Type) (GAA1-Up, PAA1-Up)	269
194-1917	700MM (FBA1-Up, MAA1-Up)	265
194-1911	700MM (GAA1-Up, PAA1-Up)	266
194-1921	800MM (FBA1-Up, MAA1-Up)	265
196-1795	900MM (GAA1-Up, PAA1-Up)	267
217-9429	WIPER, LOWER WINDSHIELD	611
163-6698	12V-2 × 7A POWER SUPPLY SOCKET	155
163-6629	12V-7A POWER SUPPLY SOCKET	154

INDEX

Name	Page	Name	Page
A			
ADJUSTER GP - BUCKET	733	CONDENSER & MTG GP - REFRIGERANT	668
AIR CLEANER GP	49	CONSOLE GP	631
	51		633.01
AIR CONDITIONER & MOUNTING GP	650	CONSOLE GP - OPERATOR	630
AIR CONDITIONER AR	649	CONTROL & MTG GP - ELECTRONIC	167
AIR CONDITIONER GP	649	CONTROL AR - AUXILIARY	396
	652	CONTROL AR - QUICK COUPLER	399.01
ALARM GP	152	CONTROL GP - ELECTRONIC	174
ALARM GP - TRAVEL	175	CONTROL GP - GOVERNOR	66
ALTERNATOR GP - CHARGING	173	CONTROL GP - HYDRAULIC	482
ARM AS - WIPER	606	CONTROL GP - PILOT OPERATED HYD	476
			480
B			
BATTERY & WIRING GP	72	COOLER GP - ENGINE OIL	44
BATTERY & WIRING GP - COLD WEATH	80	COUNTERWEIGHT GP	220
BLOCK GP - HYDRAULIC	304	COUPLER AR - QUICK	681
BOOM AR	673	COUPLER GP - QUICK	715.02
BOOM AR - 1 PIECE LONG	672	COUPLING GP - FLEXIBLE	287
BOOM GP	682	COUPLING GP - PUMP	286
BOX & MTG GP - STORAGE	215	COVER GP	586
BOX GP - STORAGE	216		607
BREATHER GP	33	COVER GP - VALVE MECHANISM	20
BUCKET & ADJUSTER GP	720	CRANKSHAFT GP	21
BUCKET AR	716	CYLINDER & LINES GP - BOOM	305
BUCKET AS - DITCH CLEANING	732	CYLINDER & LINES GP - BUCKET	316
BUCKET AS - EXCAVATION	726	CYLINDER & LINES GP - STICK	308
BUCKET AS - GENERAL PURPOSE	731	CYLINDER & SEAL GP	327.01
BUCKET GP	731	CYLINDER & SEAL GP - BOOM	306
BUMPER GP - SIDE	236	CYLINDER & SEAL GP - BUCKET	318
		CYLINDER & SEAL GP - STICK	310
		CYLINDER BLOCK GP	18
		CYLINDER GP - BUCKET	326
		CYLINDER HEAD GP	14
C			
CAB GP	560	D	
CAB GP (BASIC)	563	DOOR GP - CAB	587
CAB GP - EXTERIOR	584	DOOR GP - HOOD	206
CAB GP - INTERIOR	572	DRIVE AS - WINDSHIELD - AUTO	598
CABLE AS	93	DRIVE GP - PUMP	296
CAMSHAFT GP	22	DRIVE GP - SWING	458
CARTRIDGE AS - TURBOCHARGER	56	DUCT AS	656
CLEANER AR	50	DUCT GP - AIR	654
COMPRESSOR GP - REFRIGERANT	670		

INDEX

Name	Page	Name	Page
E			
ELECTRONICS GP	168	HATCH GP	591
F			
FAN GP - SUCTION	42	HEAD GP - PUMP CONTROL	292
	47	HEADREST AS	647
FASTENER GP - SWING & FINAL DR	196	HEATER & MTG GP - CAB	662
FENDER & COVER GP	219	HEATER AR - CAB	661
FILM GP	768	HEATER GP - CAB	664
FILTER GP - ENGINE OIL	34	HOOD & GUARD GP	198
FILTER GP - FUEL	62	HOOD GP	205
FILTER GP - HYDRAULIC	298	HOOD GP - ENGINE	204
FINAL DRIVE GP	193	HORN GP - ELECTRIC	625
FLYWHEEL GP	27	HOUSING GP - FLYWHEEL	28
FRAME AS - UNDERCARRIAGE	238	HOUSING GP - FRONT	24
FRAME GP - UPPER	232	I	
G			
GEAR & BEARING GP - SWING	228	IDLER GP - FRONT	242
GEAR GP - FRONT	26	K	
GUARD AR - BOTTOM	209	KNOB AS	478
GUARD GP - BOTTOM	210	L	
GUARD GP - CYLINDER	328	LAMP GP - FLOOD	186
GUARD GP - FRONT WINDOW	622	LEVER GP	634
GUARD GP - SNOW	214	LIGHTING GP - BOOM	178
GUARD GP - SWIVEL	212	LIGHTING GP - CAB	184
GUARD GP - TRACK GUIDE	250	LIGHTING GP - CHASSIS	177
GUARD GP - TRAVEL MOTOR	262	LINES AR - AUXILIARY HYDRAULIC	355
H			
HANDHOLD GP	213	LINES GP - AIR	53
HARNESS AS	86	LINES GP - AIR CONDITIONER	658
	108	LINES GP - AUXILIARY HYDRAULIC	358
	189	LINES GP - BOOM	340
HARNESS AS - CONSOLE	130	LINES GP - BOOM CYLINDER	330
HARNESS AS - WIRING	145	LINES GP - BUCKET CYLINDER	335
	153.01	LINES GP - COOLING	43
	156	LINES GP - DRAIN	54
	163		382
HATCH AS	593		453
		LINES GP - ENGINE OIL	32
		LINES GP - FRONT	430
		LINES GP - FUEL	64
			68
		LINES GP - GREASE	702

INDEX

Name	Page	Name	Page
LINES GP - HEATER.....	666	P	
LINES GP - OIL DRAIN	37	PAN GP - OIL.....	29
LINES GP - PILOT.....	400	PANEL GP - CIRCUIT BREAKER	96
LINES GP - PUMP.....	394	PIN GP.....	751.01
LINES GP - QUICK COUPLER	339.01	PISTON & ROD GP	23
	389.01	PLATE & FILM GP	756
LINES GP - RETURN & FILTER	454	PLATFORM GP - OPERATOR.....	629
LINES GP - STICK	350	PLUG GP.....	511
LINES GP - STICK CYLINDER.....	332	PROTECTOR GP.....	738
LINES GP - SWING MOTOR.....	457	PULLEY GP	31.01
LINES GP - TRAVEL MOTOR	390	PUMP & MOUNTING GP	285
LINES GP - TURBOCHARGER OIL.....	36	PUMP AS - WATER	45.01
LINES GP - WATER.....	46	PUMP GP - FUEL INJECTION	65.01
LINK AS.....	633	PUMP GP - MAIN HYDRAULIC	288
LINK AS - TRACK.....	270	PUMP GP - WATER.....	45
LINKAGE AR - BUCKET.....	678	R	
LINKAGE AR - FRONT.....	680	RADIATOR & HYD OIL COOLER GP	38
LINKAGE GP - BUCKET	708	RADIO GP - AM.....	619
LITERATURE GP.....	648	RADIO GP - AM/FM.....	620
LOCK GP - TRANSPORT.....	707	ROLLER AR - TRACK & CARRIER.....	255
M		ROLLER GP - TRACK CARRIER	259
MANIFOLD GP - EXHAUST	59	ROLLER GP - TRACK - DOUBLE FLANGE.....	261
MANIFOLD GP - INLET.....	58	ROLLER GP - TRACK - SINGLE FLANGE	260
MIRROR GP - REAR VIEW.....	628	ROTOR GP - SWIVEL.....	473
MONITOR & MTG GP - OPERATOR	614	S	
MONITOR GP - OPERATOR.....	615	SCREEN GP.....	284
MOTOR & MTG GP - SWING	464	SEAT BELT GP	645
MOTOR & MTG GP - TRAVEL	468	SEAT GP.....	637
MOTOR AS - WINDOW WIPER	605	SERVICE KIT	348
MOTOR GP - SWING.....	465	SIDECUTTER GP	736
MOTOR GP - TRAVEL.....	470	SPROCKET GP - NONSEGMENTED.....	192
MOUNTING GP - AIR CLEANER	48	STARTING MOTOR GP - ELECTRIC	170
MOUNTING GP - ALTERNATOR.....	31	STICK AR - COUPLER	677
MOUNTING GP - ENGINE.....	30	STICK AR - HOE.....	674
MOUNTING GP - GREASE GUN.....	208	STICK GP	692
MOUNTING GP - STARTING MOTOR.....	169		696
MOUNTING GP - VALVE.....	486		698
MUFFLER GP.....	57		700
N		STICK GP - COUPLER.....	701.01
NOZZLE GP - UNIT INJECTOR.....	61		

INDEX

Name	Page	Name	Page
WIRING GP	153		
	154		
	158		
WIRING GP - CAB.....	142		
WIRING GP - CONSOLE	127		
WIRING GP - LOWER WIPER	125		
WIRING GP - QUICK COUPLER.....	162.02		
WRENCH	755		

ENGINE ARRANGEMENT

Consists of :

			Page
1	222-8187	ENGINE AR.....	11
1	205-6683	FAN GP-SUCTION	42

H83444E 01

201-3831 ENGINE AR

Consists of :

			Page
1	201-3877	ENGINE AR.....	12
1	222-8199	PULLEY GP.....	31.01

H83446E 00

222-8187 ENGINE AR

S/N FBA 1-04484, GAA 1-00579, MAA 1-00379, PAA 1-00354
Part of 201-3831-Page11

ENGINE ARRANGEMENT

Consists of :

		Page
1	201-3877 ENGINE AR.....	13.01
1	239-6664 PULLEY GP.....	31.02

H87874E 01

222-8187 ENGINE AR

S/N FBA 04485-Up, GAA 00580-Up, MAA 00380-Up, PAA 00355-Up
Part of 201-3831-Page11

MEMORANDA

ENGINE ARRANGEMENT

Consists of :

			Page
BASIC ENGINE			
1	178-6516	PAN GP-OIL.....	29
1	178-6512	CAMSHAFT GP.....	22
1	212-8549	CRANKSHAFT GP	21
1	212-8546	CYLINDER BLOCK GP	18
1	212-8543	CYLINDER HEAD GP.....	14
1	212-8544	VALVE MECHANISM GP	16
1	212-8545	COVER GP-VALVE MECHANISM	20
1	205-6792	FLYWHEEL GP.....	27
1	196-7972	HOUSING GP-FLYWHEEL.....	28
1	212-8550	GEAR GP-FRONT	26
1	212-8547	HOUSING GP-FRONT	24
1	212-8548	PISTON & ROD GP.....	23
1	178-6531	MOUNTING GP-ALTERNATOR.....	31
LUBRICATION SYSTEM			
1	212-8554	FILTER GP-ENGINE OIL	34
1	178-6524	LINES GP-ENGINE OIL.....	32
1	178-6502	BREATHER GP	33
1	51-7770	LINES GP-TURBOCHARGER OIL	36

H83447E 05

201-3877 ENGINE AR (1/2)

S/N FBA 1-04484, GAA 1-00579, MAA 1-00379, PAA 1-00354
Part of 222-8187-Page11

ENGINE ARRANGEMENT

Consists of :

			Page
COOLING SYSTEM			
1	212-8555	PUMP GP-WATER.....	45
1	212-8557	LINES GP-WATER.....	46
1	178-6584	COOLER GP-ENGINE OIL.....	44
1	212-8556	FAN GP-SUCTION	47
AIR INLET AND EXHAUST SYSTEM			
1	212-8551	MANIFOLD GP-INLET.....	58
1	212-8552	MANIFOLD GP-EXHAUST	59
1	205-6741	TURBOCHARGER GP	55
1	212-8553	MUFFLER GP.....	57
FUEL SYSTEM			
1	212-8559	PUMP GP-FUEL INJECTION	65.01
1	212-8560	FILTER GP-FUEL.....	62
1	212-8558	LINES GP-FUEL.....	64
6	212-8470	NOZZLE GP-UNIT INJECTOR.....	61
ELECTRICAL AND STARTING SYSTEM			
1	125-2963	MOUNTING GP-STARTING MOTOR.....	169
1	125-2988	STARTING MOTOR GP-ELECTRIC	170
1	212-8561	ALTERNATOR GP-CHARGING	173

H83448E 05

201-3877 ENGINE AR (2/2)

S/N FBA 1-04484, GAA 1-00579, MAA 1-00379, PAA 1-00354
Part of 222-8187-Page11