



# Operation and Maintenance Manual

**Product: MINI HYD EXCAVATOR**

**Model: 301.8C MINI HYD EXCAVATOR JSB**

**Configuration: 301.6C & 301.8C Mini Hydraulic**

**Excavators JSB00001-UP (MACHINE) POWERED BY  
L3E Engine**

## Safety Messages 01/08/2008

- (1) Do Not Operate
- (2) Seat Belt
- (3) Tip Over Hazard
- (4) Tip Over Hazard
- (5) Electrical Power Lines
- (6) Crushing Hazard
- (7) Jump Start Cables
- (8) Ether Starting Aid
- (9) Do Not Weld
- (10) Hot Surface
- (11) Pressurized System

## General Hazard Information 01/08/2008

Pressurized Air and Water

Trapped Pressure

Fluid Penetration

Containing Fluid Spillage

Asbestos Information

Dispose of Waste Properly

Crushing Prevention and Cutting Prevention 01/08/2008

Burn Prevention 01/08/2008

Coolant

Oils

Batteries

Fire Prevention and Explosion Prevention 01/08/2008

General

Battery and Battery Cables

Wiring

Lines, Tubes and Hoses

Ether

Fire Extinguisher

Fire Extinguisher Location 01/08/2008

Track Information 01/08/2008

Electrical Storm Injury Prevention 01/08/2008

Before Starting Engine 01/08/2008

Visibility Information 01/08/2008

Engine Starting 01/08/2008

Before Operation 01/08/2008

Work Tools 01/08/2008

Operation 01/08/2008

Machine Operating Temperature Range

Operating Information

Operating Procedure

Engine Stopping 01/08/2008

Lifting Objects 01/08/2008

Parking 01/08/2008

Slope Operation 01/08/2008

Equipment Lowering with Engine Stopped 01/08/2008

Sound Information and Vibration Information 01/08/2008

Sound Level Information

Sound Level Information for Machines in European Union Countries and in Countries that Adopt the "EU Directives"

301.6C and 301.8C

302.5C

"The European Union Physical Agents (Vibration) Directive 2002/44/EC"

Vibration Data for Compact Track Excavator

Information Concerning Hand/Arm Vibration Level

Information Concerning Whole Body Vibration Level

Guidelines for Reducing Vibration Levels on Earthmoving Equipment

Sources

Operator Station 01/08/2008

Guards - Operator Protection 01/08/2008

Rollover Protective Structure (ROPS), Falling Object Protective Structure (FOPS) or Tip Over Protection Structure (TOPS)

Other Guards (If Equipped)

## Product Information Section

## Specifications 01/08/2008

Intended Use

Specification Data

Boom/Stick/Bucket Combinations 01/08/2008

Lifting Capacities 01/08/2008

301.6C  
301.8C  
302.5C  
Identification Information 01/08/2008  
Plate Locations and Film Locations 01/08/2008  
Certification  
TOPS Plate (7)  
Sound Certification  
Emissions Certification Film 01/08/2008

## Operation Section

106

Mounting and Dismounting 01/08/2008  
Daily Inspection 01/08/2008  
Machine Operation 01/08/2008  
Alternate Exit 01/08/2008  
Seat 01/08/2008  
Basic Seat  
Suspension Seat  
Seat Belt 01/08/2008  
Seat Belt Adjustment for Non-Retractable Seat Belts  
Lengthening the Seat Belt  
Shortening the Seat Belt  
Fastening The Seat Belt  
Releasing The Seat Belt  
Seat Belt Adjustment for Retractable Seat Belts  
Fastening The Seat Belt  
Releasing The Seat Belt  
Extension of the Seat Belt  
Operator Controls 01/08/2008  
Operator Control  
(1) Operator's Seat  
(2) Hydraulic Lockout Control  
(3) Joystick Controls  
(4, 4A) Swing Boom Control  
Pedal ( 301.6C and 301.8C)  
Joystick ( 302.5C)  
(5, 5A) Auxiliary Control  
(6) Travel Controls  
Right Travel Lever  
Left Travel Lever  
(7) Monitoring Panel  
(8) Travel Speed Control  
(9) Dozer Blade Control  
(10) Governor Control Lever  
(11) Power Port  
(12) Air Conditioning Switch ( 302.5C)  
(13) Blower Fan Switch  
(14) Window Wiper/Washer Switch  
(15) Temperature Control Knob  
(16) Engine Start Switch  
(17) Extender Carriage Switch  
(18) Work Light Switch  
Beacon  
Monitoring System 01/08/2008  
Alert Indicators  
Gauges  
Service Hour Meter  
LCD Display  
Adjusting the Clock  
Storage and Literature Compartment 01/08/2008  
Window (Front) 01/08/2008  
Front Window  
Side Window  
Mirror - If Equipped 01/08/2008  
Mirror Adjustment  
Right Side Rear View Mirror (1)  
Left Side Rear View Mirror (2)  
Cab Door 01/08/2008  
Joystick Controls 01/08/2008  
Control Pattern 1 (Factory Set Position)  
Joystick Control Selector (If Equipped)  
Control Pattern 2 (Alternate Position)

Work Tool Control 01/08/2008  
 Primary Auxiliary Hydraulic Circuit  
 Secondary Auxiliary Hydraulic Circuit  
 Work Tool Flow Mode Control  
 Auxiliary Control  
 Pedal ( 301.6C and 301.8C)  
 Joystick ( 302.5C)  
 Hammer Control  
 Pedal ( 301.6C and 301.8C)  
 Joystick ( 302.5C)  
 Engine Starting 01/08/2008  
 Engine Starting 01/08/2008  
 Engine and Machine Warm-Up 01/08/2008  
 Operation 01/08/2008  
 Operation Information 01/08/2008  
 Operating Procedure  
 Frozen Ground Conditions 01/08/2008  
 Equipment Lowering with Engine Stopped 01/08/2008  
 302.5C with an Accumulator  
 Machines without an Accumulator  
 Operating Techniques 01/08/2008  
 Operating Technique Information 01/08/2008  
 Digging  
 Lifting Objects  
 Travel in Water and Mud 01/08/2008  
 Procedure for Removing the Machine from Water or Mud  
 Quick Coupler Operation - Manual Pin Grabber Quick Coupler (If Equipped) 01/08/2008  
 Securing the Work Tool  
 Releasing the Work Tool  
 Securing the Hammer  
 Releasing the Hammer  
 Hammer Operation - If Equipped 01/08/2008  
 Rubber Belt Track Operation - If Equipped 01/08/2008  
 Parking 01/08/2008  
 Stopping the Machine 01/08/2008  
 Freezing Conditions 01/08/2008  
 Stopping the Engine 01/08/2008  
 Stop the Engine if an Electrical Malfunction Occurs  
 Leaving the Machine 01/08/2008  
 Transportation Information 01/08/2008  
 Shipping the Machine 01/08/2008  
 Loading The Machine  
 Unloading The Machine  
 Adjustable Gage Undercarriage Frame 01/08/2008  
 Expanding the Undercarriage and Retracting the Undercarriage  
 Lifting and Tying Down the Machine 01/08/2008  
 Positioning the Machine for Lifting  
 Lifting the Machine  
 First Alternative Lifting Procedure  
 Second Alternative Lifting Procedure  
 Tying Down the Machine  
 Towing Information 01/08/2008  
 Towing the Machine 01/08/2008  
 Retrieval of Machine  
 Engine Starting (Alternate Methods) 01/08/2008  
 Engine Starting with Jump Start Cables 01/08/2008

## Maintenance Section

212

Access Door and Cover Locations 01/08/2008  
 Engine Door 301.6C and 301.8C  
 Engine Doors 302.5C  
 Right Access Door 302.5C  
 Access Cover (Control Pattern Selector)  
 Lubricant Viscosities and Refill Capacities 01/08/2008  
 Lubricant Viscosities 01/08/2008  
 Capacities (Refill) 01/08/2008  
 S-O-S Information 01/08/2008  
 Maintenance Interval Schedule 01/08/2008  
 Maintenance Interval Schedule 01/08/2008  
 Battery - Recycle 01/08/2008  
 Battery Hold-Down - Tighten 01/08/2008  
 Battery or Battery Cable - Inspect/Replace 01/08/2008

Belt - Inspect/Adjust/Replace 01/08/2008  
Checking the Belt Tension  
Adjusting the Belt Tension ( 301.6C and 301.8C)  
Adjusting the Belt Tension ( 302.5C)  
Air Conditioner Belt (If Equipped)  
302.5C  
Blade Linkage - Lubricate 01/08/2008  
Dozer  
Boom and Stick Linkage - Lubricate 01/08/2008  
Boom, Stick, and Frame - Inspect 01/08/2008  
Boom  
Stick  
Blade  
Lifting Points  
Upper Frame  
Lower Frame  
Bucket Linkage - Lubricate 01/08/2008  
Cab Air Filter (Fresh Air) - Clean/Replace 01/08/2008  
301.6C and 301.8C  
302.5C  
Cooling System Coolant (ELC) - Change 01/08/2008  
Cooling System Coolant Extender (ELC) - Add 01/08/2008  
Cooling System Coolant Level - Check 01/08/2008  
Cooling System Coolant Sample - Obtain 01/08/2008  
Engine Air Filter Element - Clean/Replace 01/08/2008  
Cleaning the Air Filter Element  
Pressurized Air  
Vacuum Cleaning  
Replacing the Air Filter Element  
Engine Air Filter Service Indicator - Inspect 01/08/2008  
Engine Oil Level - Check 01/08/2008  
Engine Oil Sample - Obtain 01/08/2008  
Engine Oil and Filter - Change 01/08/2008  
Engine Valve Lash - Check 01/08/2008  
Final Drive Oil - Change 01/08/2008  
Final Drive Oil Level - Check 01/08/2008  
Final Drive Oil Sample - Obtain 01/08/2008  
Fuel System Primary Filter (Water Separator) Element - Replace 01/08/2008  
Fuel System Water Separator - Drain 01/08/2008  
Fuel Tank Cap and Strainer - Clean 01/08/2008  
Fuel Tank Water and Sediment - Drain 01/08/2008  
Fuses - Replace 01/08/2008  
Hydraulic System Oil - Change 01/08/2008  
Cat HYDO Oil Change Interval  
Cat HYDO Advanced 10 Oil Change Interval  
Procedure to Change the Hydraulic Oil  
Hydraulic System Oil Cooler Core - Clean 01/08/2008  
Hydraulic System Oil Filter (Return) - Replace 01/08/2008  
Hydraulic System Oil Level - Check 01/08/2008  
Hydraulic System Oil Sample - Obtain 01/08/2008  
Oil Filter - Inspect 01/08/2008  
Inspect a Used Filter for Debris  
Quick Coupler - Clean 01/08/2008  
Quick Coupler - Lubricate - If Equipped 01/08/2008  
Radiator Core - Clean 01/08/2008  
Receiver Dryer (Refrigerant) - Replace 01/08/2008  
Seat Belt - Inspect 01/08/2008  
Seat Belt - Replace 01/08/2008  
Swing Frame and Cylinder Bearings - Lubricate 01/08/2008  
Swing Gear and Bearing - Lubricate 01/08/2008  
Tip-Over Protective Structure (TOPS) - Inspect 01/08/2008  
Track Adjustment - Adjust 01/08/2008  
Tightening the Tracks  
Loosening the Track  
Track Adjustment - Inspect 01/08/2008  
Measuring Rubber Track Tension  
Measuring Steel Track Tension  
Travel Alarm - Test 01/08/2008  
Undercarriage - Check 01/08/2008  
Window Washer Reservoir - Fill 01/08/2008  
Window Wiper - Inspect/Replace 01/08/2008  
Windows - Clean 01/08/2008  
Cleaning Methods  
Aircraft Windshield Cleaner

Soap and Water  
Stubborn Dirt and Grease

## Reference Information Section

---

322

Reference Material 01/08/2008  
Caterpillar Reference Material  
Additional Reference Material  
Decommissioning and Disposal 01/08/2008  
Caterpillar Approved Work Tools 01/08/2008



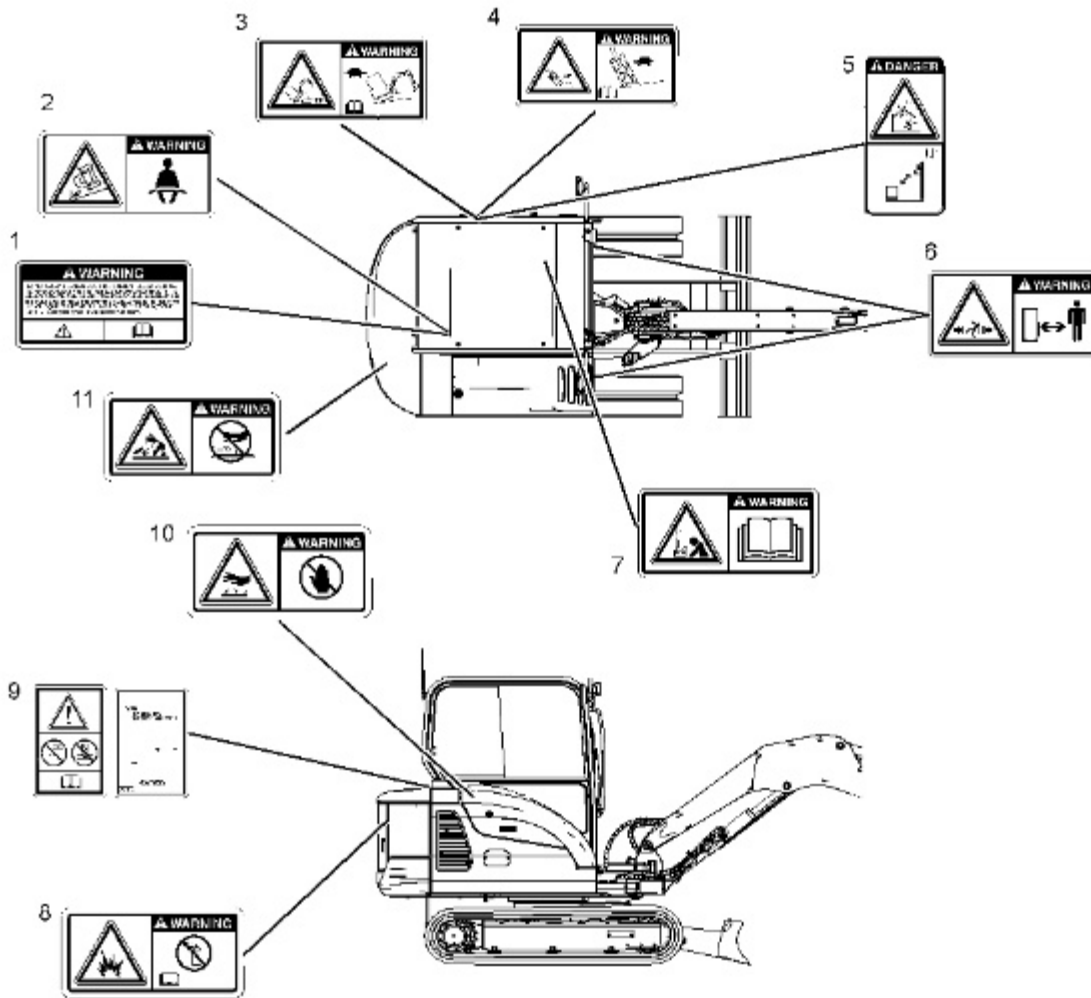

Illustration 3  
302.5C

There are several specific safety messages on this machine. The exact location of the hazards and the description of the hazards are reviewed in this section. Please become familiar with all safety messages.

Make sure that all of the safety messages are legible. Clean the safety messages or replace the safety messages if you cannot read the words. Replace the illustrations if the illustrations are not legible. When you clean the safety messages, use a cloth, water and soap. Do not use solvent, gasoline, or other harsh chemicals to clean the safety messages. Solvents, gasoline, or harsh chemicals could loosen the adhesive that secures the safety message. Loose adhesive will allow the safety message to fall.

Replace any safety message that is damaged, or missing. If a safety message is attached to a part that is replaced, install a new safety message on the replacement part. Any Caterpillar dealer can provide new safety messages.

### (1) Do Not Operate

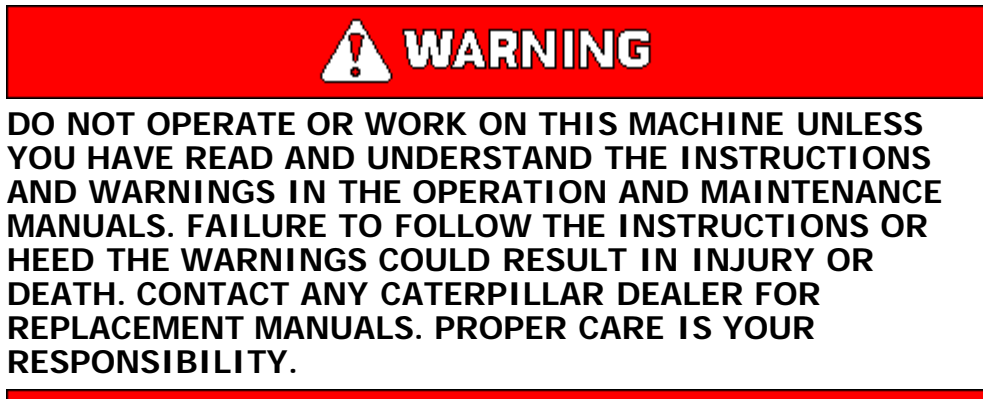



Illustration 4

g00930652

This safety message is positioned in the cab on the right side of the operator's seat.



(2) Seat Belt



Illustration 5

g00994396

This safety message is positioned in the cab on the right side of the operator's seat.

## **WARNING**

**DO NOT OPERATE OR WORK ON THIS MACHINE UNLESS YOU HAVE READ AND UNDERSTAND THE INSTRUCTIONS AND WARNINGS IN THE OPERATION AND MAINTENANCE MANUALS. FAILURE TO FOLLOW THE INSTRUCTIONS OR HEED THE WARNINGS COULD RESULT IN INJURY OR DEATH. CONTACT ANY CATERPILLAR DEALER FOR REPLACEMENT MANUALS. PROPER CARE IS YOUR RESPONSIBILITY.**

### (3) Tip Over Hazard



Illustration 6

g01183204

This safety message is located on the inside of the cab on the left side.

## **WARNING**

**When traveling up or down a slope, travel slowly. The machine can tip at angles that are 15 degrees or more, which could cause serious injury or death. Refer to the Operation and Maintenance Manual for the proper traveling procedure.**

### (4) Tip Over Hazard

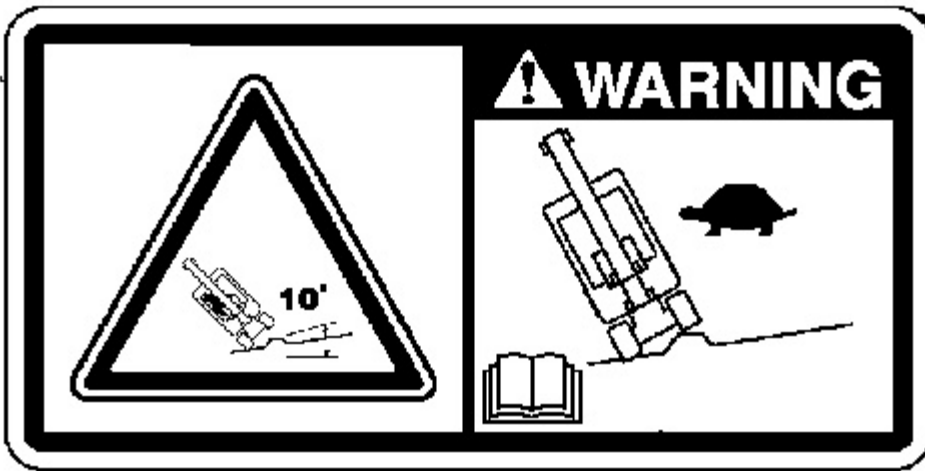

Illustration 7

g01183209

This safety message is located on the inside of the cab on the left side.

## **WARNING**

When traveling across a slope, travel slowly. The machine can tip at angles that are 10 degrees or more, which could cause serious injury or death. Refer to the Operation and Maintenance Manual for the proper traveling procedure.

## (5) Electrical Power Lines



This safety message is located on the inside of the cab on the left side.

DANGER

**Electrocution Hazard! Keep the machine and attachment a safe distance from electric power. The owner of the electric line should advise a minimum clearance distance. The minimum clearance is 6 m (20 ft) for 220V to 33 kV (Europe) and 5 m (10 ft) for 50kV (USA). Read and understand the instructions and warnings in the Operation and Maintenance Manual. Failure to follow the instructions and warnings will cause serious injury or death.**

---

Refer to Operation and Maintenance Manual, "Specifications" for additional information.

**(6) Crushing Hazard**

---

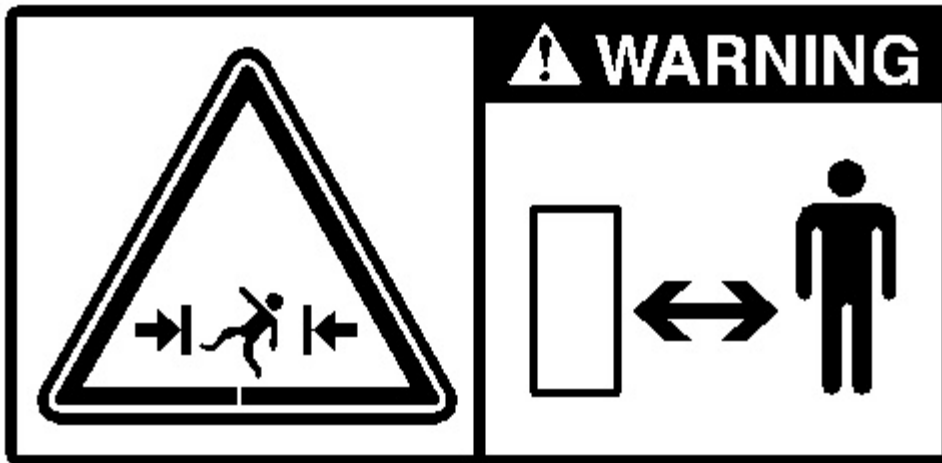

This safety message is located on the frame on both sides of the boom.

WARNING

**Crushing Hazard! Stay back a safe distance. There is no clearance for a person in this area when the machine turns. Failure to follow these instructions could cause serious injury or death.**

---

**(7) Jump Start Cables**

---

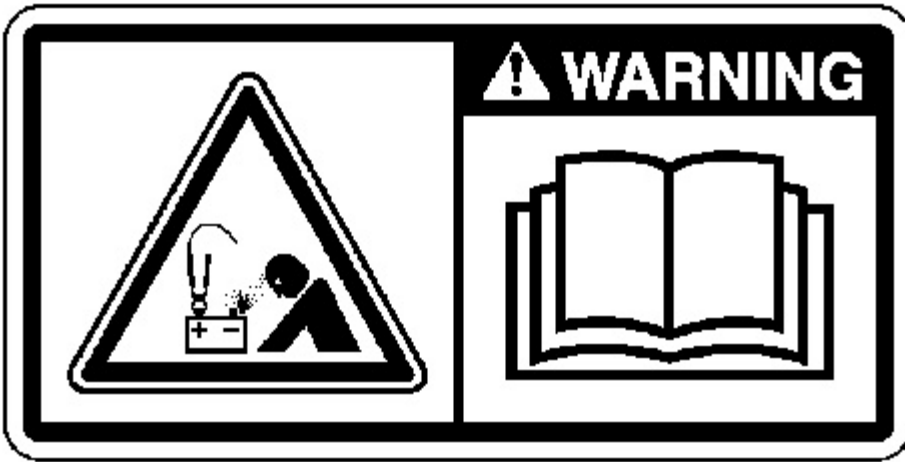

Illustration 10

g01067366

This safety message is located in the battery compartment.

**! WARNING**

**Explosion Hazard! Improper jumper cable connections can cause an explosion resulting in serious injury or death. Batteries may be located in separate compartments. Refer to the Operation and Maintenance Manual for the correct jump starting procedure.**

Refer to Operation and Maintenance Manual, "Engine Starting with Jump Start Cables" for additional information.

### (8) Ether Starting Aid



Illustration 11

g01067463

This safety message is located next to the air intake.

## **WARNING**

**Explosion hazard! Do not use ether! This machine is equipped with an air inlet heater. Using ether can create explosions or fires that can cause personal injury or death. Read and follow the starting procedure in the Operation and Maintenance Manual.**

### (9) Do Not Weld

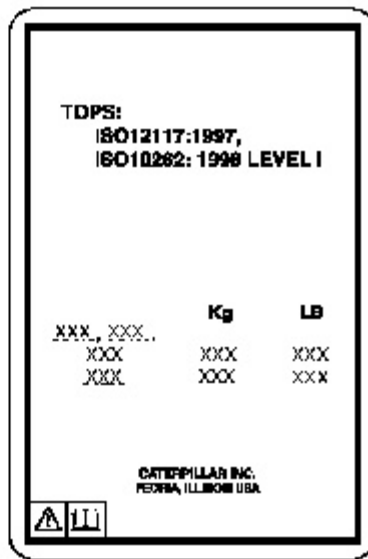
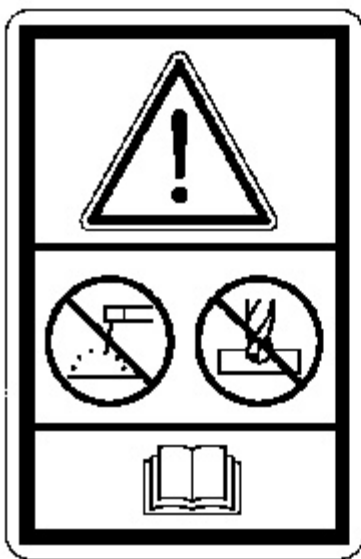

Illustration 12

g01122056

This safety message is located at the left rear of the post.

## **WARNING**

**Structural damage, an overturn, modification, alteration, or improper repair can impair this structure's protection capability thereby voiding this certification. Do not weld on or drill holes in the structure. Consult a Caterpillar dealer to determine this structure's limitations without voiding its certification.**

### (10) Hot Surface



Illustration 13

g01085603

This safety message is located near the hydraulic tank.

**! WARNING**

Hot parts or hot components can cause burns or personal injury. Do not allow hot parts or components to contact your skin. Use protective clothing or protective equipment to protect your skin.

(11) Pressurized System



Illustration 14

g00996533

This safety message is located on the inside of the engine hood near the cooling system filler cap.

 **WARNING**

**Pressurized system: Hot coolant can cause serious burn. To open cap, stop engine, wait until radiator is cool. Then loosen cap slowly to relieve the pressure.**





Product: MINI HYD EXCAVATOR  
 Model: 301.8C MINI HYD EXCAVATOR JSB  
 Configuration: 301.6C & 301.8C Mini Hydraulic Excavators JSB00001-UP  
 (MACHINE) POWERED BY L3E Engine

## Operation and Maintenance Manual 301.6C, 301.8C and 302.5C Mini Hydraulic Excavators

Media Number -SEBU7940-04

Publication Date -01/08/2008

Date Updated -01/08/2008

i03557602

# General Hazard Information

SMCS - 7000

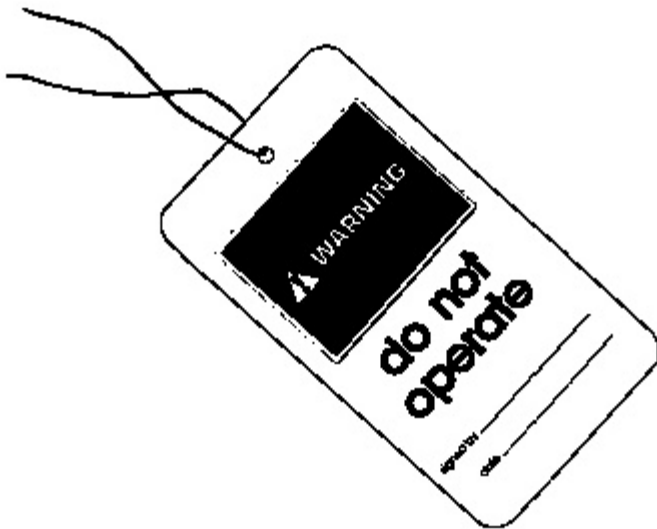

Illustration 1

g00104545

Attach a "Do Not Operate" warning tag or a similar warning tag to the start switch or to the controls before you service the equipment or before you repair the equipment. These warning tags (Special Instruction, SEHS7332) are available from your Caterpillar dealer.

Know the width of your equipment in order to maintain proper clearance when you operate the equipment near fences or near boundary obstacles.

Be aware of high voltage power lines and power cables that are buried. If the machine comes in contact with these hazards, serious injury or death may occur from electrocution.

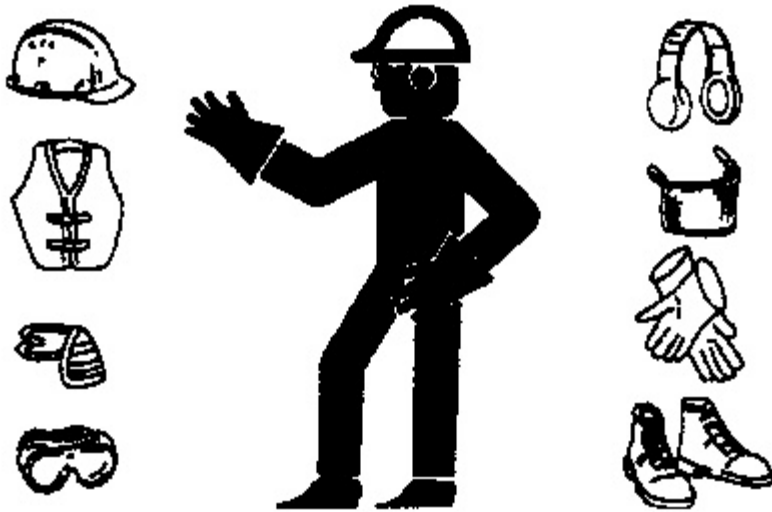

Illustration 2

g00702020

Wear a hard hat, protective glasses, and other protective equipment, as required.

Do not wear loose clothing or jewelry that can snag on controls or on other parts of the equipment.

Make sure that all protective guards and all covers are secured in place on the equipment.

Keep the equipment free from foreign material. Remove debris, oil, tools, and other items from the deck, from walkways, and from steps.

Secure all loose items such as lunch boxes, tools, and other items that are not a part of the equipment.

Know the appropriate work site hand signals and the personnel that are authorized to give the hand signals. Accept hand signals from one person only.

Do not smoke when you service an air conditioner. Also, do not smoke if refrigerant gas may be present. Inhaling the fumes that are released from a flame that contacts air conditioner refrigerant can cause bodily harm or death. Inhaling gas from air conditioner refrigerant through a lighted cigarette can cause bodily harm or death.

Never put maintenance fluids into glass containers. Drain all liquids into a suitable container.

Obey all local regulations for the disposal of liquids.

Use all cleaning solutions with care. Report all necessary repairs.

Do not allow unauthorized personnel on the equipment.

Unless you are instructed otherwise, perform maintenance with the equipment in the servicing position. Refer to Operation and Maintenance Manual for the procedure for placing the equipment in the servicing position.

When you perform maintenance above ground level use appropriate devices such as ladders or man lift machines. If equipped, use the machine tie-downs and use approved fall arrest harnesses and lanyards.

## Pressurized Air and Water

Pressurized air and/or water can cause debris and/or hot water to be blown out. This could result in personal injury.

When pressurized air and/or pressurized water is used for cleaning, wear protective clothing, protective shoes, and eye protection. Eye protection includes goggles or a protective face shield.

The maximum air pressure for cleaning purposes must be reduced to 205 kPa (30 psi) when the nozzle is deadheaded and the nozzle is used with an effective chip deflector and personal protective equipment. The maximum water pressure for cleaning purposes must be below 275 kPa (40 psi).

## Trapped Pressure

Pressure can be trapped in a hydraulic system. Releasing trapped pressure can cause sudden machine movement or attachment movement. Use caution if you disconnect hydraulic lines or fittings. High pressure oil that is released can cause a hose to whip. High pressure oil that is released can cause oil to spray. Fluid penetration can cause serious injury and possible death.

## Fluid Penetration

Pressure can be trapped in the hydraulic circuit long after the engine has been stopped. The pressure can cause hydraulic fluid or items such as pipe plugs to escape rapidly if the pressure is not relieved correctly.

Do not remove any hydraulic components or parts until pressure has been relieved or personal injury may occur. Do not disassemble any hydraulic components or parts until pressure has been relieved or personal injury may occur. Refer to the Service Manual for any procedures that are required to relieve the hydraulic pressure.

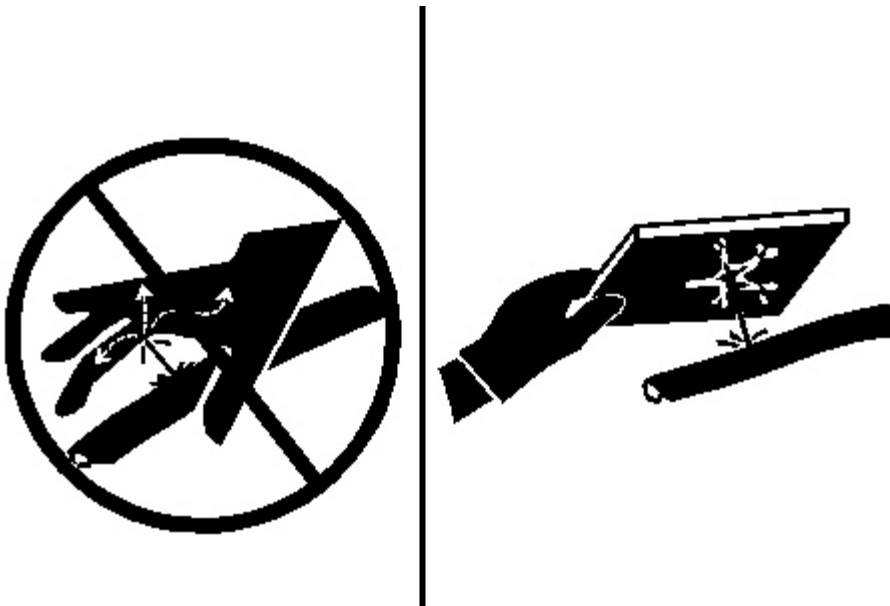

Illustration 3

g00687600

Always use a board or cardboard when you check for a leak. Leaking fluid that is under pressure can penetrate body tissue. Fluid penetration can cause serious injury and possible death. A pin hole leak can cause severe injury. If fluid is injected into your skin, you must get treatment immediately. Seek treatment from a doctor that is familiar with this type of injury.

## Containing Fluid Spillage

Care must be taken in order to ensure that fluids are contained during performance of inspection, maintenance, testing, adjusting and repair of the equipment. Prepare to collect the fluid with suitable containers before opening any compartment or disassembling any component that contains fluids.

Refer to Special Publication, NENG2500, "Caterpillar Dealer Service Tool Catalog" for the following items:

- Tools that are suitable for collecting fluids and equipment that is suitable for collecting fluids
- Tools that are suitable for containing fluids and equipment that is suitable for containing fluids

Obey all local regulations for the disposal of liquids.

## Asbestos Information

---

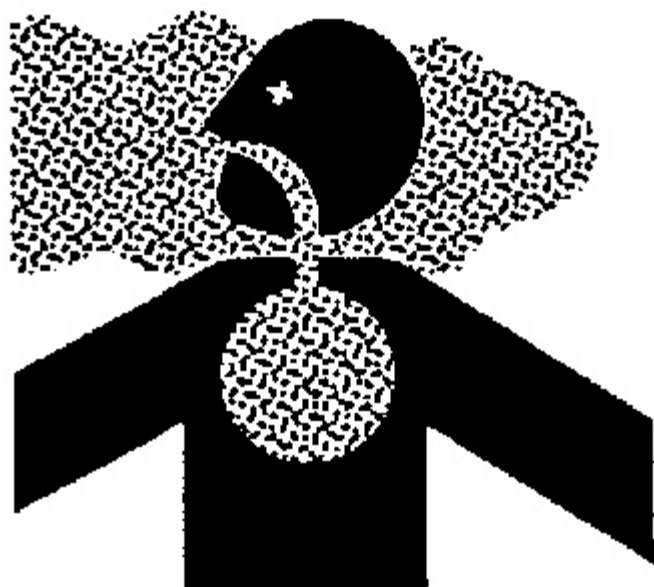

Illustration 4

g00702022

Caterpillar equipment and replacement parts that are shipped from Caterpillar are asbestos free. Caterpillar recommends the use of only genuine Caterpillar replacement parts. Use the following guidelines when you handle any replacement parts that contain asbestos or when you handle asbestos debris.

Use caution. Avoid inhaling dust that might be generated when you handle components that contain asbestos fibers. Inhaling this dust can be hazardous to your health. The components that may contain asbestos fibers are brake pads, brake bands, lining material, clutch plates, and some gaskets. The asbestos that is used in these components is usually bound in a resin or sealed in some way. Normal handling is not hazardous unless airborne dust that contains asbestos is generated.

If dust that may contain asbestos is present, there are several guidelines that should be followed:

- Never use compressed air for cleaning.
- Avoid brushing materials that contain asbestos.
- Avoid grinding materials that contain asbestos.