

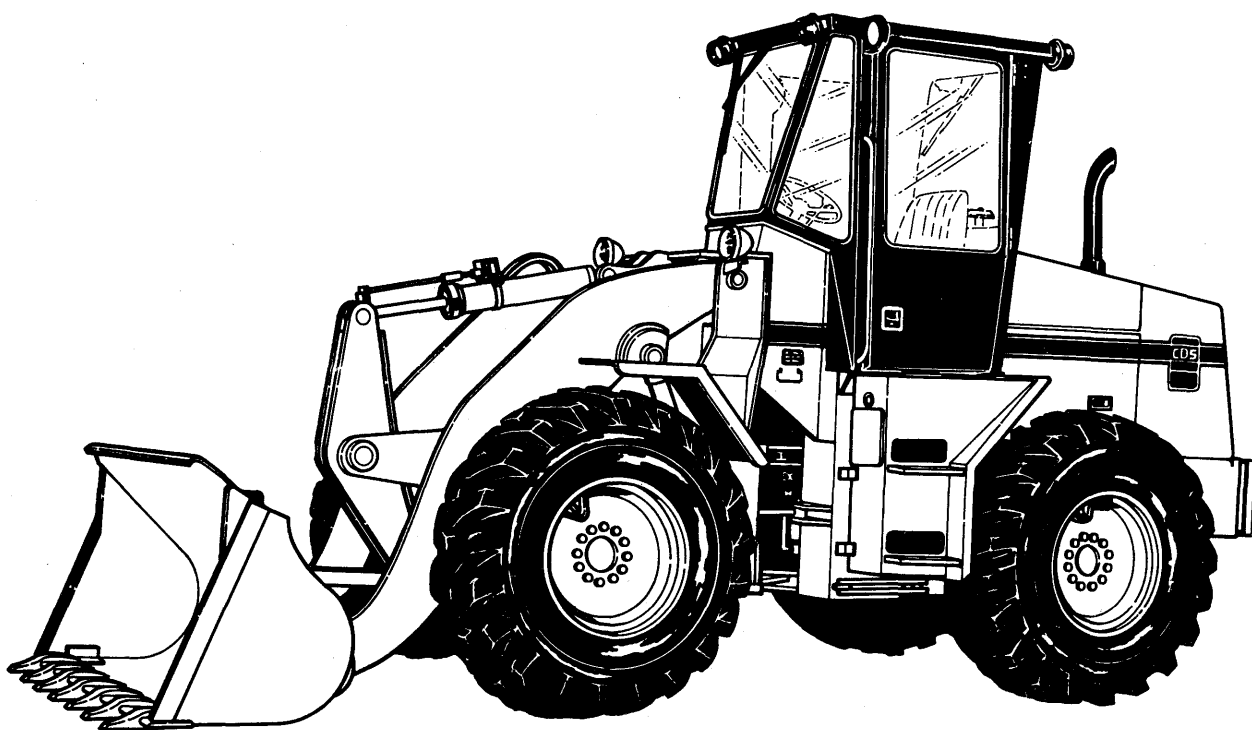

PARTS CATALOG



MODEL 840D WHEEL LOADER
MODEL 844D FORKLIFT

PART NO. 6800253

FORWARD

THIS PARTS CATALOGUE CONTAINS ALL SERVICE PARTS FOR THE CONTINENTAL DIVERSIFIED SALES, INC. MODEL 840D WHEEL LOADER AND 844D FORKLIFT.

THIS PARTS CATALOGUE APPLIES TO VEHICLE SERIAL NUMBER 1 AND BEYOND.

WARNING: This product contains parts dimensioned in the Metric Systems as well as in the U.S. Inch System. It is important to note that during any repair or maintenance procedures, replacement fasteners must have the same measurements and strength as those removed, whether metric or U.S. Inch System. Mismatched or incorrect fasteners can result in damage or malfunction, or possible personal injury. Therefore, fasteners removed from the machine should be saved for reuse in the same locations. Where the fasteners are not satisfactory for reuse, care should be taken to select a replacement that matches the original. For information and assistance, see your authorized dealer.

SERIAL NO. LOCATION

SERIAL NUMBER LOCATIONS

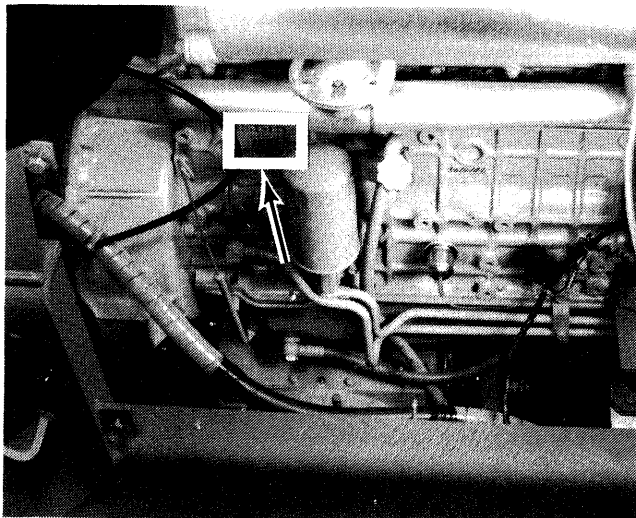

ENGINE SERIAL NUMBER

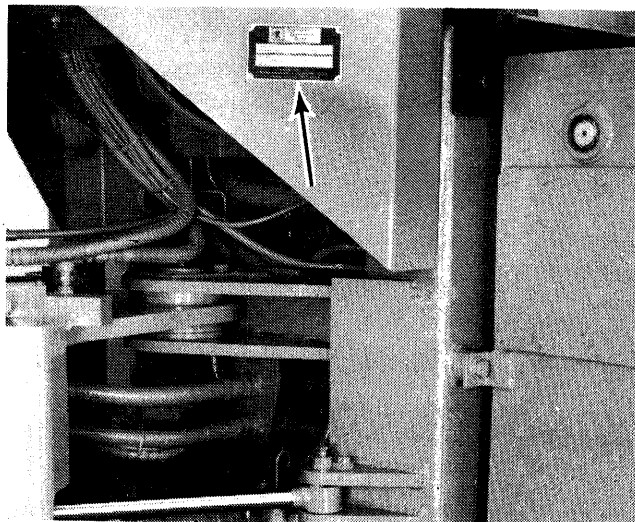

PRODUCT IDENTIFICATION NUMBER

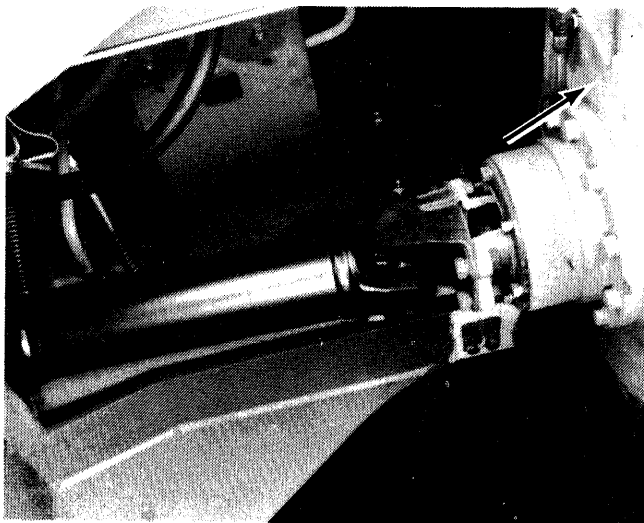

AXLE SERIAL NUMBER

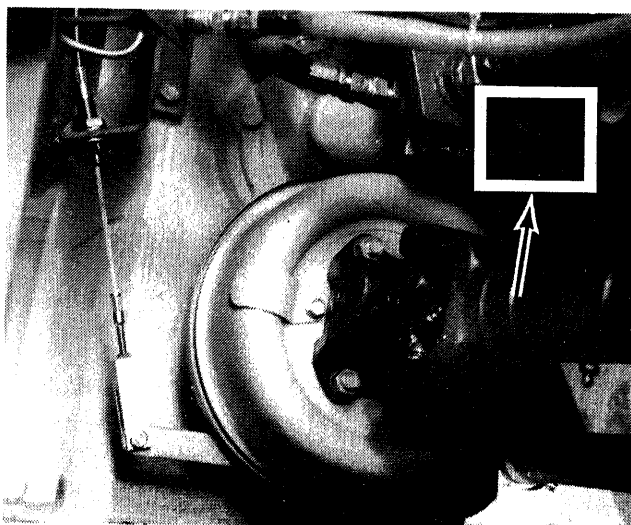

TRANSMISSION SERIAL NUMBER

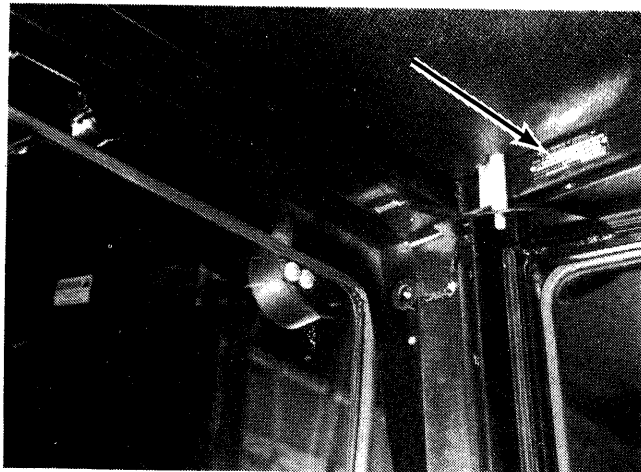

**CAB SERIAL NUMBER
SIMILAR FOR ROPS CANOPY**

LOCATION OF SERIAL NUMBERS

When you order parts or need information from your CDS dealer, you must give the model and serial number of your machine or equipment.

Basic machine – the Product Identification Number (PIN) is stamped on pin plate, left side front of rear module

Engine – on the left side of the engine

Transmission – above to the right of transmission brake drum

Axles – above to the right input shaft

ROPS cab – upper rear left surface of cab roof edge

ROPS canopy – on the upper rear surface of the canopy

Use this chart to keep a record of the machine model, serial numbers or part numbers.

	Make and Model	Serial Number
Basic machine	<u>CDS</u>	<u>(PIN)</u>
Engine	<u>MITSUBISHI S6E2</u>	<u></u>
	<u>MITSUBISHI S6E2-T (TURBO)</u>	<u></u>
Transmission and Torque Converter	<u>OKAMURA Y50881B</u>	<u></u>
Front axle	<u>DAIKIN</u>	<u></u>
Rear axle	<u>DAIKIN</u>	<u></u>
ROPS cab	<u>CUSTOM PRODUCTS</u>	<u></u>
ROPS canopy	<u>CDS</u>	<u></u>

NUMERICAL INDEX

The numerical index appears at the rear of this publication. It indicates grid location, reference number and page number a part appears.

ILLUSTRATIONS

All illustrations are located on the left hand page with the text on the right. Except for some common hardware, all parts are identified with an item number which corresponds to the "item" column on the text page. This is followed by the part number, quantity and description.

ORDERING PARTS

Be sure to refer to both the text and the illustration to assure ordering the correct part. Also indicate the following information:

1. Part Numbers
2. Part Names
3. Quantity
4. Vehicle Serial Number

If an ordered part is obsolete a new substitutable part will be supplied.

RECOMMENDED DEALER STOCK

A recommended dealer stock listing appears at the end of this publication.

ABBREVIATIONS AND SYMBOLS ARE USED IN THIS PARTS CATALOGUE
IN THE SENSE INDICATED.

ASSY	:	ASSEMBLY
AR	:	AS REQUIRED
SEL	:	SELECT
L.H.	:	LEFT HAND
R.H.	:	RIGHT HAND
U.S.	:	OVERSIZE
O.S.	:	UNDERSIZE
N.S.S.	:	NOT SERVICED SEPARATELY
PLTD	:	PLATED HARDWARE
GRD	:	HARDWARE GRADE RATING
M	:	METRIC
OPT.	:	OPTIONAL
QTY.	:	QUANTITY
STD.	:	STANDARD
t	:	THICKNESS
w/	:	WITH
w/o	:	WITHOUT
incl.	:	INCLUDES
S/N	:	SERIAL NO.

PARTS CATALOG INDEX

Section 01	Engine	1
Section 02	Loader - General Arrangement	102
Section 03	Electrical	144
Section 04	Hydraulics	156
Section 05	Attachments	198
section 06	Options	228
Section 07	Drive Train	256
Section 08	Miscellaneous Information	300

NOTES

SECTION 01 -ENGINE INDEX

Air Filter Assembly	55
Alternator - General Arrangement	97
Alternator	99
Cam Shaft	19
Connecting Rod	35
Cooling System	71
Crankcase Assembly	21
Crankcase Assembly - Turbo	23
Crank Case	25
Crank Shaft	37
Cylinder Head	11
Cylinder Head Turbo	13
Engine - General Arrangement	5
Engine w/o Turbo	7
Engine w/Turbo	9
Exhaust System	45
Exhaust System - Turbo	45
Flywheel Housing	31
Flywheel	39
Fuel Feed Pump	77
Fuel System	87
Fuel Nozzel	89
Fuel Filter Assembly	91
Governor	85
Injection Pump	81
Inlet and Exhaust System (S/N 63-)	47
Inlet and Exhaust System (S/N 1-62)	49
Inlet and Exhaust System - Turbo (S/N 63-)	51
Inlet and Exhaust System - Turbo (S/N 1-62)	53
Inlet System	43
Inlet System - Turbo	43
Injection Pump - General Arrangement	75
Main Bearing	27
Oil Cooler and Oil Pipe	65
Oil Filler and Oil Level Gauge	69
Oil Filter	67
Oil Pan	33
Oil Pipe and Breather - Turbo	63
Oil Pipe	61
Oil Pump assembly	57
Oil Pump and Strainer - Turbo	59
Oil Strainer Assembly	57
Piston	35
Radiator and Cooler Piping	73
Rocker Cover	17
Starter - General Arrangement	93
Starter	95
Timing Gear Cover	29
Timing Gear Cover - Turbo	29
Timing Gear	41
Turbo Charger	101
Valve Mechanism	15
Water Pump	71

840D WHEEL LOADER

ENGINE

5

GENERAL ARRANGEMENT

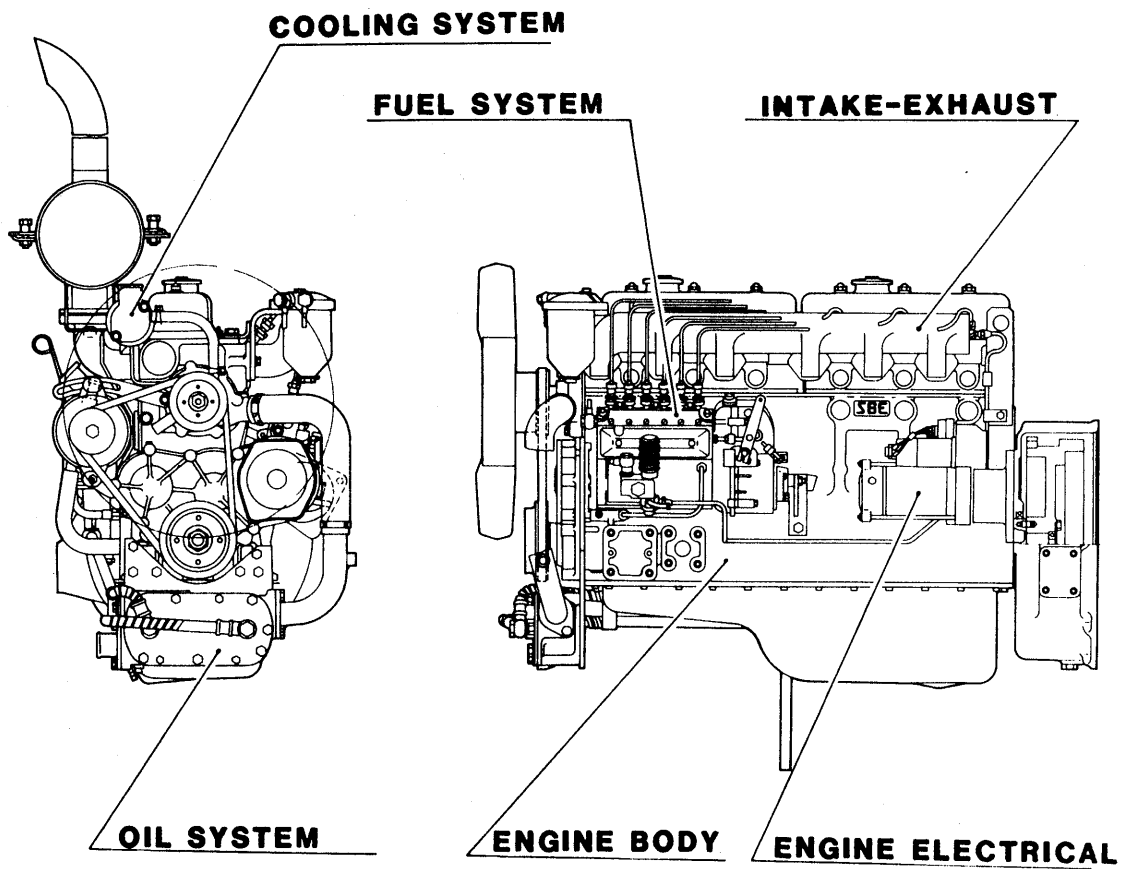

6

840D WHEEL LOADER

ENGINE

ENGINE W/TURBO

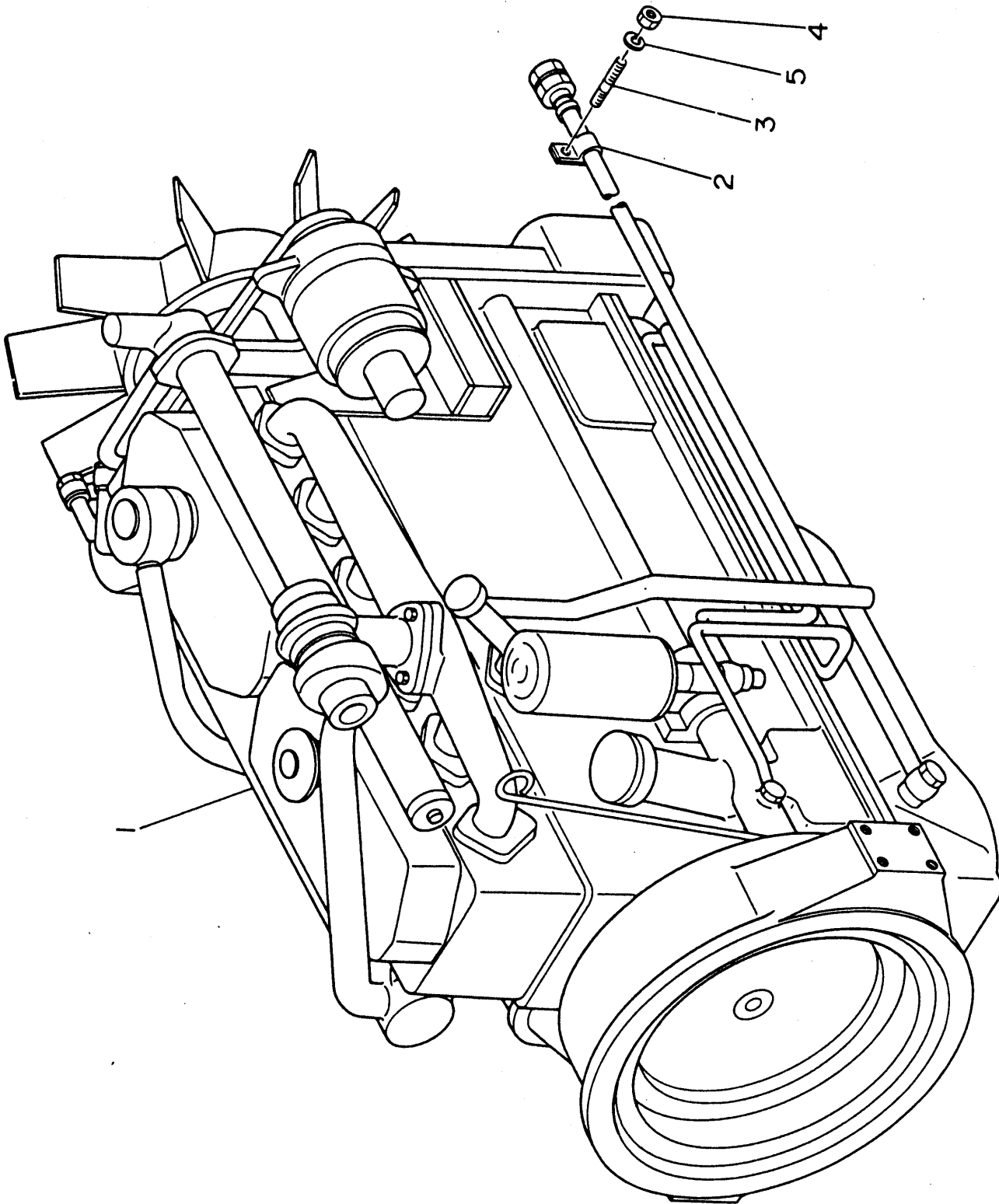

840D WHEEL LOADER
ENGINE

7

ENGINE W/TURBO

ITEM	NUMBER	QTY	DESCRIPTION
	6810408	1	ENGINE, w/turbo (incl. 1-5) (S/N 1-62)
1	6811151	1	ENGINE, w/turbo (S/N 1-18)
	6811152	1	ENGINE, w/turbo (S/N 19-62)
2	6811132	1	CLIP
3	6811123	1	BOLT, stud
4	950209	1	NUT, hex M6-1, PLTD.
5	950218	1	WASHER, lock M6, PLTD.

840D WHEEL LOADER

ENGINE

ENGINE

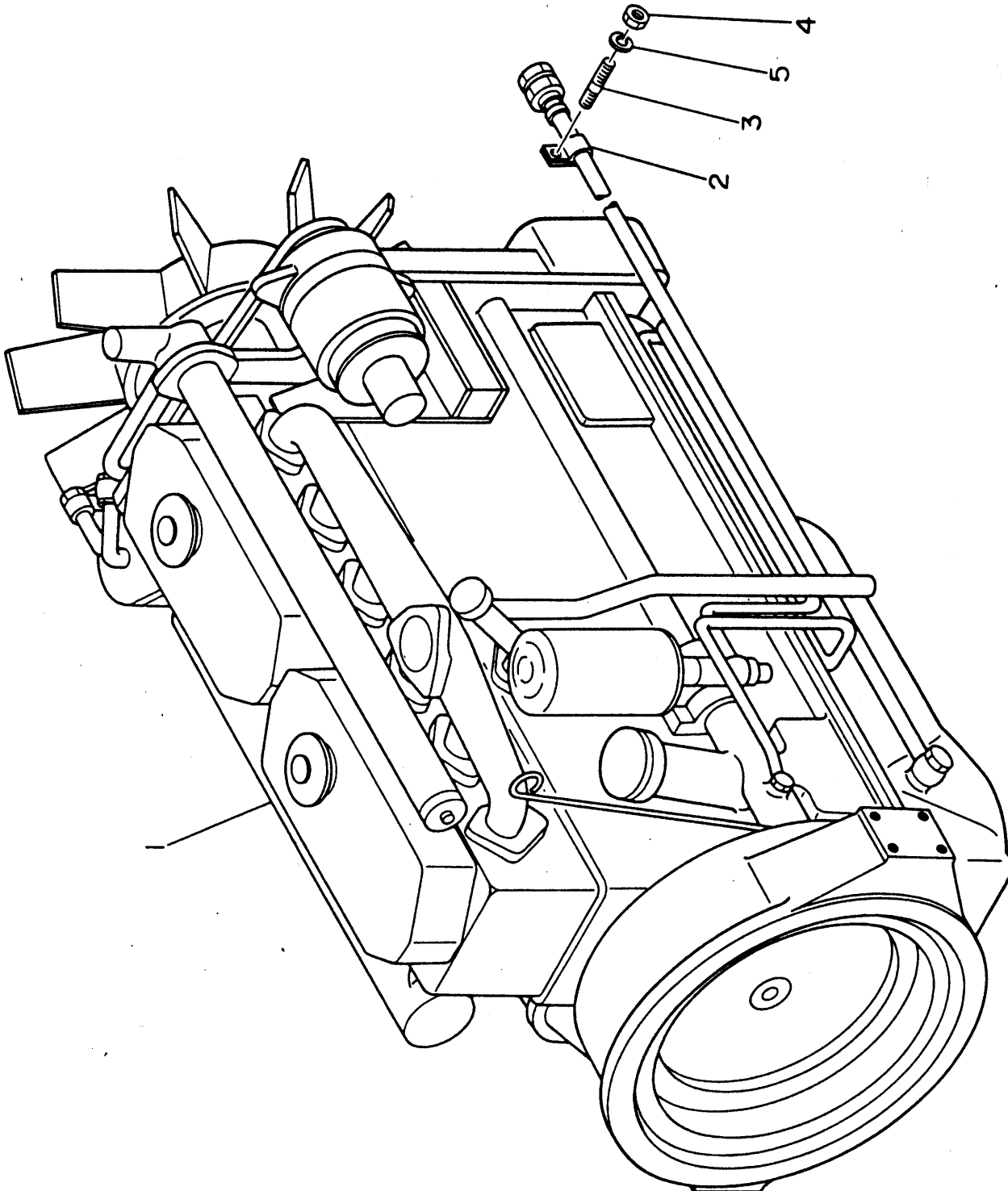

840D WHEEL LOADER

9

ENGINE

ENGINE

ITEM	NUMBER	QTY	DESCRIPTION
	6810409	1	ENGINE, w/o turbo (incl. 1-5)
1	6811154	1	ENGINE (S/N 1-18)
	6811155	1	ENGINE (S/N 19-62)
	681160	1	ENGINE (S/N 63-)
2	6811132	1	CLIP
3	6811156	1	BOLT, stud
4	950209	1	NUT, hex M6-1, PLTD.
5	950218	1	WASHER, lock M6, PLTD.

**840D WHEEL LOADER
ENGINE**

CYLINDER HEAD

ITEM	NUMBER	QTY	DESCRIPTION
1A	4530919	1	CYLINDER HEAD ASSY., front (incl. 2, 3, 8-11, 14-20)
1B	6800106	1	CYLINDER HEAD ASSY., rear (incl. 2, 3, 7, 9-11, 14 & 21)
2	4530142	24	CAP, sealing
3	4530159	12	GUIDE, valve
7	4531027	1	PLUG, expansion
8	N.S.S.	2	HEAD, cylinder
9	4920092	6	INSERT, valve seat, inlet
10	4920093	6	INSERT, valve seat, exhaust
11	4530885	6	JET, combustion
12	4530884	26	BOLT, cylinder head
13	4530917	2	GASKET, cylinder head
14	4921140	1	GASKET
15	6810189	1	PLATE
16	950219	2	WASHER, lock M6, PLTD.
17	950018	1	BOLT, hex M8-1.25 x 20mm, PLTD.
18	950210	2	NUT, hex M8-1.25, PLTD.
19	950219	1	WASHER, lock M6, PLTD.
20	6900122	1	STUD
21	6811165	1	PLUG

ENGINE

CYLINDER HEAD

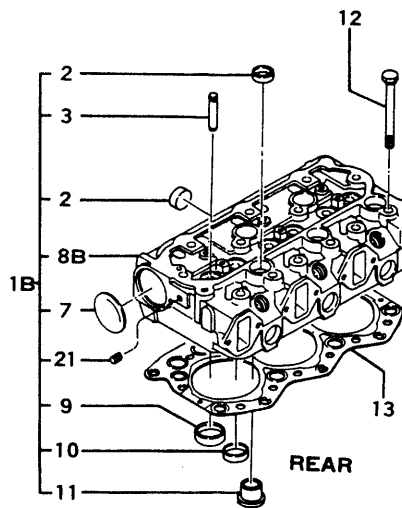
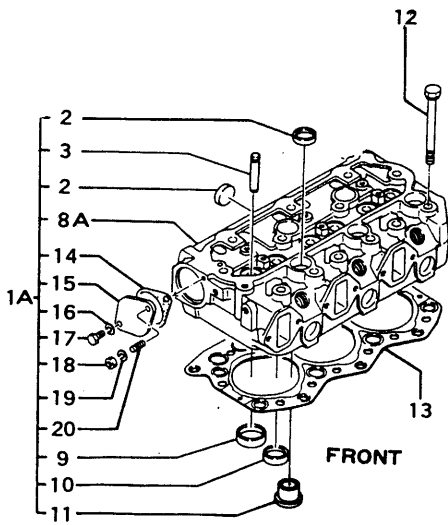

840D WHEEL LOADER

ENGINE

CYLINDER HEAD (TURBO)

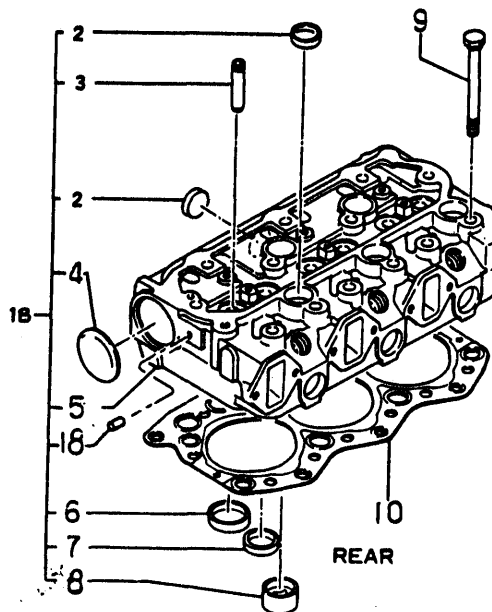
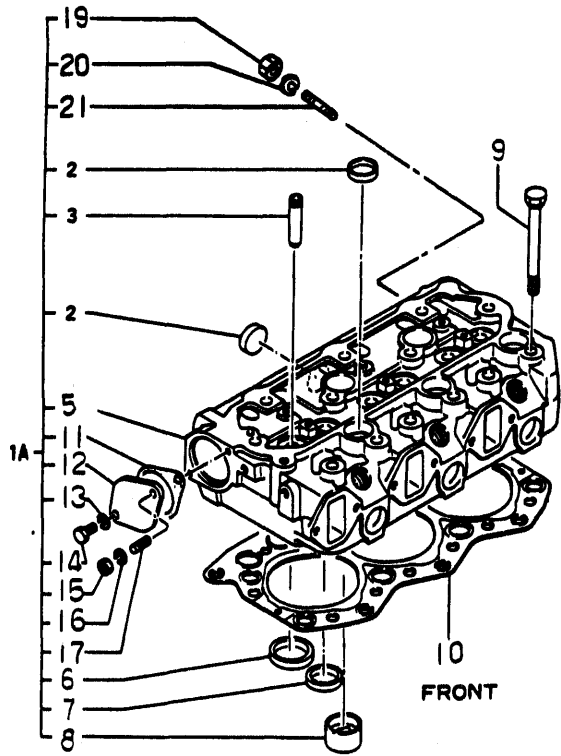

840D WHEEL LOADER
ENGINE

13

CYLINDER HEAD (TURBO)

ITEM	NUMBER	QTY	DESCRIPTION
1A	6810185	1	CYLINDER HEAD ASSY., front (incl. 2, 3, 5-8, 10-12, 14-17, 19-21)
1B	6810186	1	CYLINDER HEAD ASSY., rear (incl. 2-8, 10, 18)
2	4530142	24	CAP, sealing
3	4530159	12	GUIDE, valve
4	4531027	1	PLUG, expansion
5	N.S.S.	2	HEAD, cylinder
6	4920092	2	INSERT, valve seat, inlet
7	4920093	6	INSERT, valve seat, exhaust
8	6810187	6	JET, combustion
9	4530884	26	BOLT, cylinder head
10	6810188	2	GASKET, cylinder head
11	4921140	1	GASKET
12	6810189	1	PLATE
13	950219	2	WASHER, lock M8, PLTD.
14	950018	1	BOLT, hex M8-1.25 x 20mm, PLTD.
15	950210	1	NUT, hex M8-1.25, PLTD.
16	950219	1	WASHER, lock M6, PLTD.
17	6900122	1	STUD
18	N.S.S.	1	PLUG
19	950210	1	NUT, hex M8-1.25, PLTD.
20	950219	1	WASHER, lock M6, PLTD.
21	6900123	1	STUD

840D WHEEL LOADER

ENGINE

VALVE MECHANISM

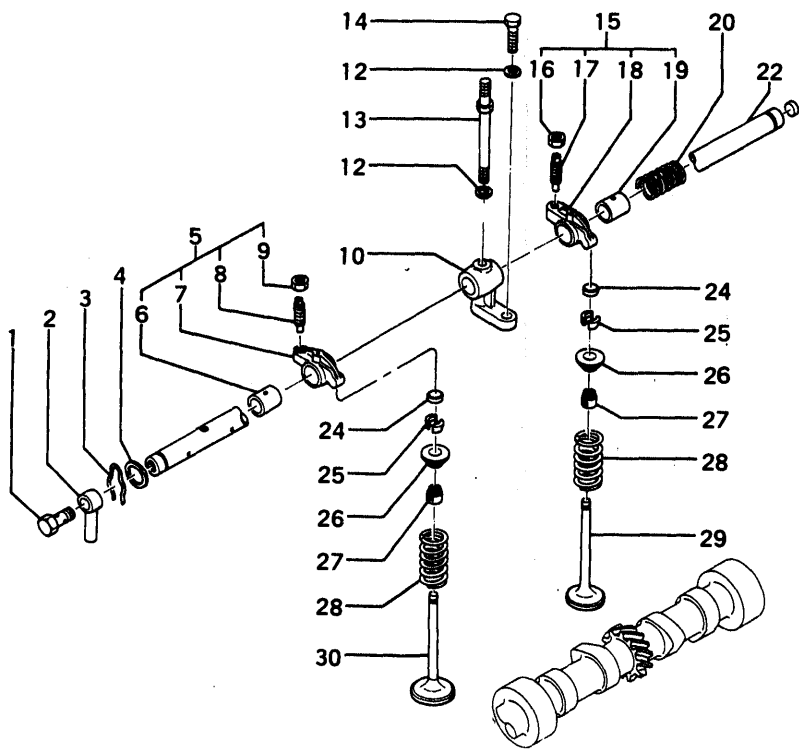

840D WHEEL LOADER

15

ENGINE

VALVE MECHANISM

ITEM	NUMBER	QTY	DESCRIPTION
1	4530515	2	BOLT, eye
2	4530437	2	PIPE, oil
3	4530151	4	RING, snap
4	4921110	4	WASHER
5	4530436	6	ROCKER ASSY., inlet (incl. 6-9)
6	4530199	6	BUSHING
7	N.S.S.	6	ROCKER, inlet
8	4530109	6	SCREW, adjusting
9	4920382	6	NUT, jam
10	4530253	6	BRACKET, rocker shaft
12	950219	12	WASHER, lock M6, PLTD.
13	4530396	6	BOLT, rocker
14	950018	6	BOLT, hex M8-1.25 x 20mm, PLTD.
15	6810190	6	ROCKER ASSY., exhaust (incl. 16-19)
16	4920382	6	NUT, jam
17	4530109	6	SCREW, adjusting
18	N.S.S.	6	ROCKER, exhaust
19	4530199	6	BUSHING
20	4921112	4	SPRING, rocker shaft
22	6810191	2	SHAFT, rocker
24	4530198	12	CAP
25	4530197	24	COTTER, valve
26	4530162	12	RETAINER, upper
27	4530164	12	SEAL, valve outer
28	4530160	12	SPRING, valve outer
29	4920108	6	VALVE, exhaust
30	4530725	6	VALVE, inlet